

Lower Falls Pedestrian Bridge Approaches



**DCR Public Meeting
August 19, 2009, 6:30 – 8 p.m.
Lower Falls Community Center
Newton Lower Falls, MA**



Commonwealth of Massachusetts

Governor

Deval L. Patrick

Lieutenant Governor

Timothy Murray

Energy and Environmental Secretary

Ian A. Bowles

Department of Conservation and Recreation Commissioner

Richard K. Sullivan, Jr.



DCR Mission Statement

*To protect, promote and enhance our
common wealth of natural, cultural and
recreational resources.*

DCR Partnerships Matching Funds Program

- DCR Allocates \$755,000 for new parks project for FY 2009
- Applications are accepted from Friends groups and other park advocacy groups, civic and community organizations, institutions, businesses and individuals
- Program is funded through DCR's five year capital budget



Lower Falls Pedestrian Bridge Approaches

- Design Funding in Partnership with:
 - Wellesley NRC gift funds
 - Wellesley trails funds
 - Newton Conservators
 - Newton Bicycle/ Pedestrian Task Force
 - Charles River Watershed Association



Project Goals

- Convert an unusable DCR property into a safe, passive recreation area
- Provide car-free access from Wellesley Lower Falls to Newton Lower Falls
- Community Cohesion
- Maintain historic integrity



Design Consultant

BEALS AND THOMAS, INC.

- Founded in 1984, Massachusetts based firm
- Engineering, Landscape Architecture, design, planning, and surveying services
- Specializing in supporting the development and conservation of land and water resources

Scope of Work

- Phase I
 - Conduct a property line survey of the route from Wellesley to Concord Street
 - Create conceptual drawings of the approaches
 - Provide planning information necessary to implement Phase II
- Phase II
 - Complete detailed design and construction efforts to restore the approaches from Wellesley to Concord Street
 - Install amenities

Project Location

DCR Bridge at Wellesley - Newton Border



Existing Conditions - Newton



Existing Conditions - Newton



Existing Conditions – DCR Bridge



Existing Conditions - Wellesley



Existing Conditions - Wellesley



Existing Conditions - Wellesley



Considering the Design Elements

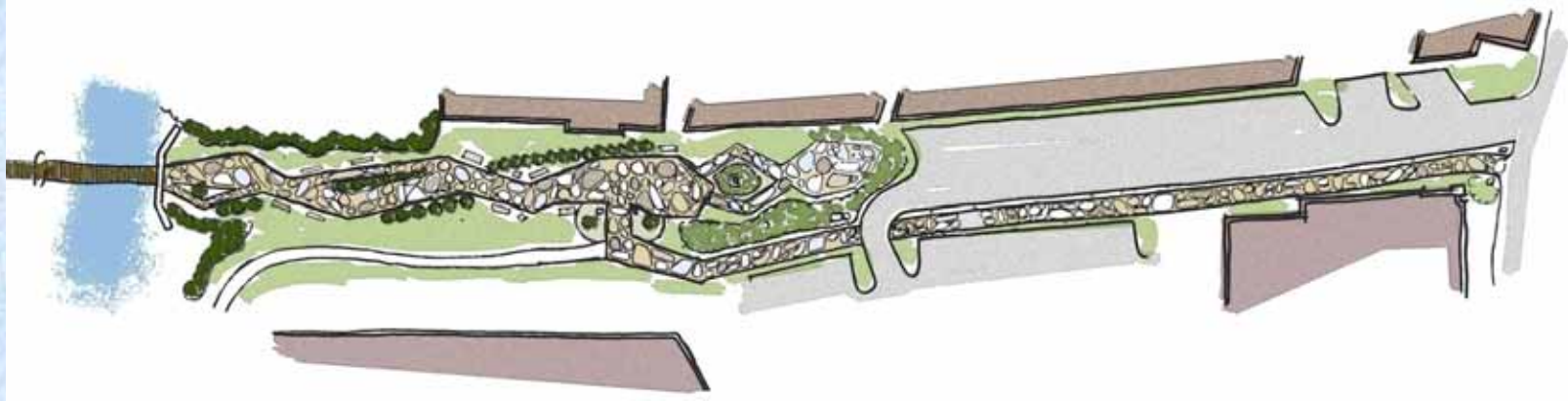

Path Form and Layout
Historic Interpretation
Ecological Interpretation
Hardscape
Softscape
Site Furnishings
Low Impact Development

Path Form and Layout

Geometric

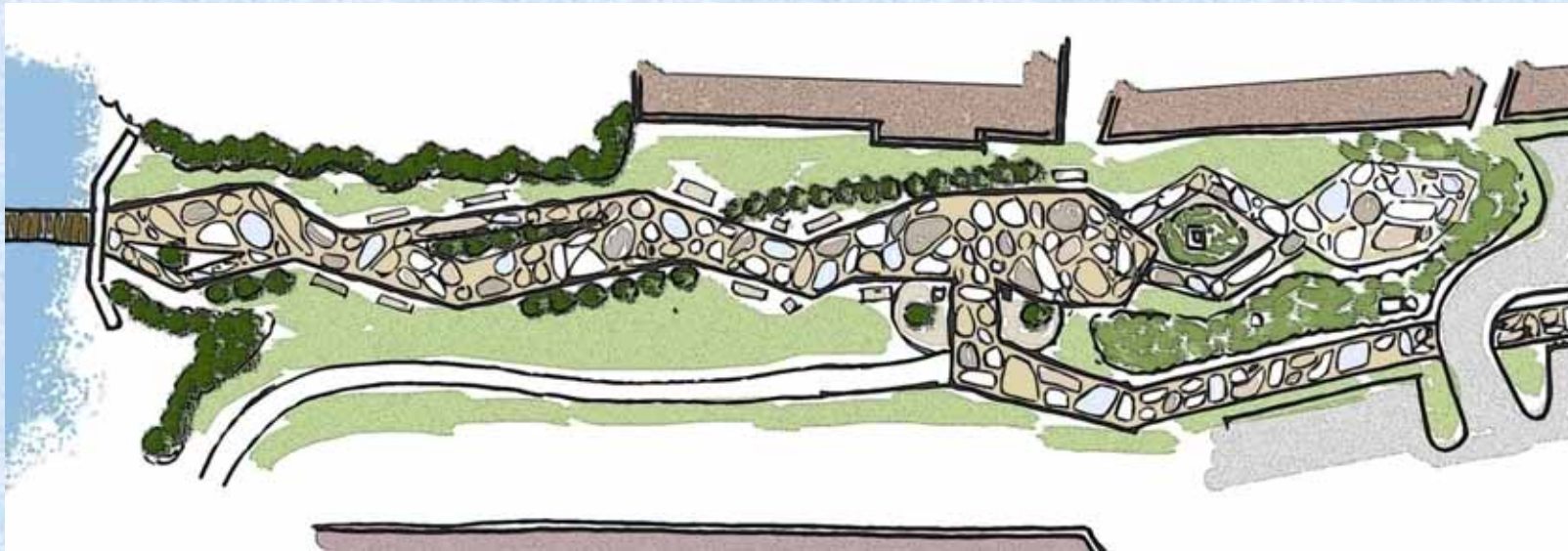

Path Form and Layout

Natural

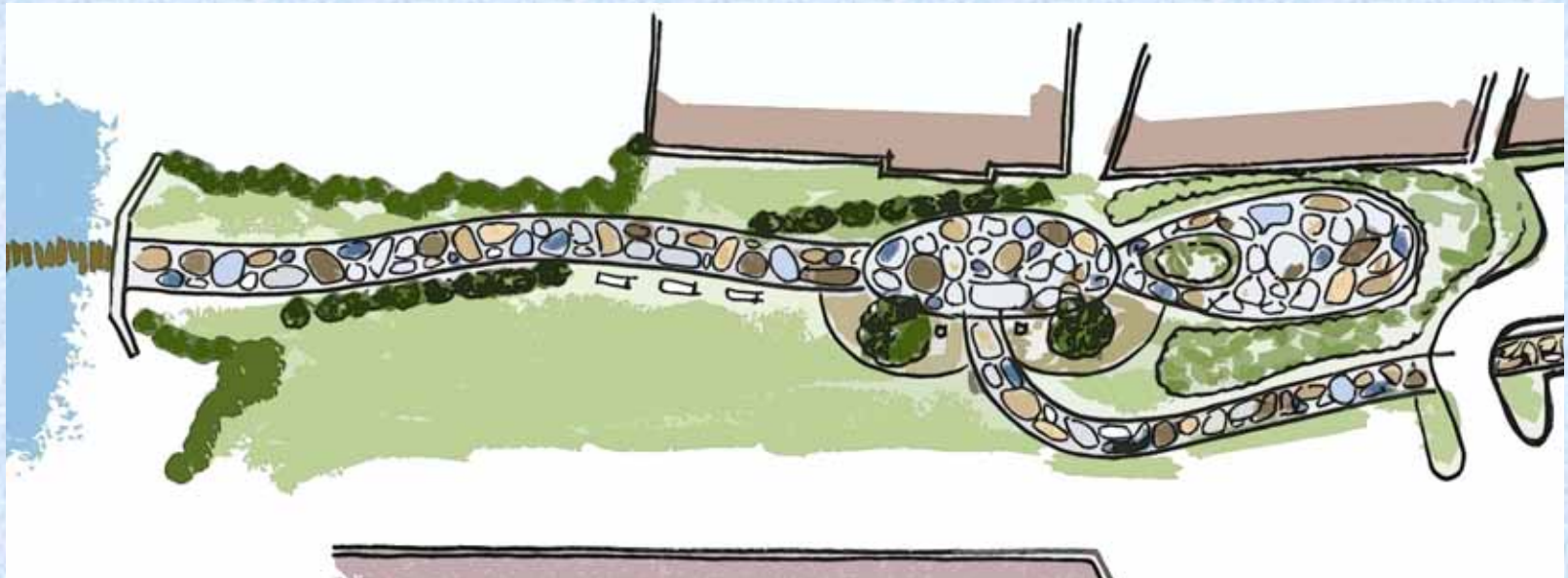







Education and Historic Interpretation



Ecological Interpretation

AQUATIC LIFE IDENTIFICATION CHART

WHAT'S IN THE WATER?

<p>GOLDEN SHINER <i>Notropis crysoleucas</i></p> 	<p>LENGTH: up to 10 inches PHYSICAL DESCRIPTION: "Silver body, with an olive-colored back and yellowish or reddish fins." "Golden coloration seen on adult fish."</p>	<p>FACTS: "A common minnow that is frequently used as bait for larger fish." "Golden Shiners stay close to aquatic plants for protection, but at night they move out into open water."</p>
<p>FATHEAD MINNOW <i>Pimephales promelas</i></p> 	<p>LENGTH: up to 2.5 inches PHYSICAL DESCRIPTION: "Rounded snout and fins with a dark spot at the base of the tail fin." "During spawning season males assume a dark color around their heads."</p>	<p>FACTS: "This species tolerates a wide range of environmental conditions." "Fathead Minnows are most often raised as a bait fish or used as forage, especially for many trout species."</p>
<p>EMERALD SHINER <i>Notropis atherinoides</i></p> 	<p>LENGTH: up to 4 inches PHYSICAL DESCRIPTION: "Slender body, with a distinctive silver lateral band across the back, white belly, and silvery blue and emerald sides."</p>	<p>FACTS: "Emerald Shiners prefer large, deep water bodies, yet generally stay near the surface in open water." "Shiners provide excellent forage for many trout species."</p>
<p>NORTHERN CRAYFISH <i>Decapoda</i></p> 	<p>LENGTH: up to 5 inches PHYSICAL DESCRIPTION: "Two pairs of long antennae and green-green pincer legs known as chelae." "Muddy green to reddish-brown in color."</p>	<p>FACTS: "Often used as bait or as an aquatic weed killer." "Crayfish require shelter in the form of rocks, logs, or thick vegetation in order to hide from predators during the day."</p>
<p>RED SPOTTED NEWT <i>Pleurodeles waltl</i></p> 	<p>LENGTH: up to 5 inches PHYSICAL DESCRIPTION: "Juvenile newts, or "efts," are red-orange with red spots outlined in black." "Adults turn olive green and retain their signature red spots."</p>	<p>FACTS: "The Red Spotted Newt prefers a muddy, wet environment and can survive in both an aquatic and terrestrial environment." "A poisonous skin secretion is their first form of defense against any predators."</p>
<p>LEOPARD FROG <i>Rana pipiens</i></p> 	<p>LENGTH: up to 5 inches PHYSICAL DESCRIPTION: "Green-brown coloration with distinct light-edged dark spots over entire body." "Characteristic dorsolateral ridge from each eye to the groin."</p>	<p>FACTS: "Often used as an environmental indicator species due to its sensitivity to chemical pollutants in the air and water." "Females lay 3,500-6,500 eggs in a large flattened mass just below the water surface."</p>
<p>NORTH AMERICAN BULLFROG <i>Rana catesbeiana</i></p> 	<p>LENGTH: up to 20 inches PHYSICAL DESCRIPTION: "Brown to green in color with dark spots around the back." "During breeding season, males' throats are yellow while females' are white."</p>	<p>FACTS: "Known for their enormous legs, bullfrogs are some of the best jumpers in the world." "Bullfrogs prefer warm weather and hibernate during cold weather, often burying themselves in the mud during the winter."</p>

PREPARED BY DEALE AND THOMAS, INC.



Softscape



Hardscape



Site Furnishings



Signage

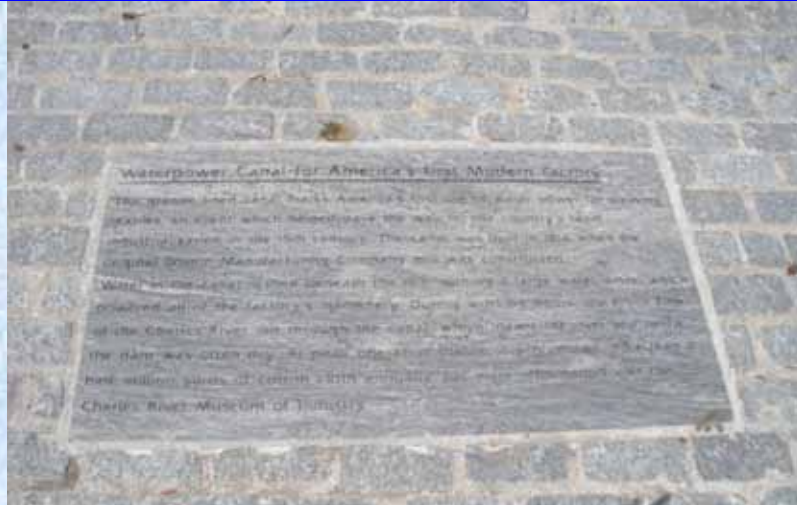

Low Impact Development

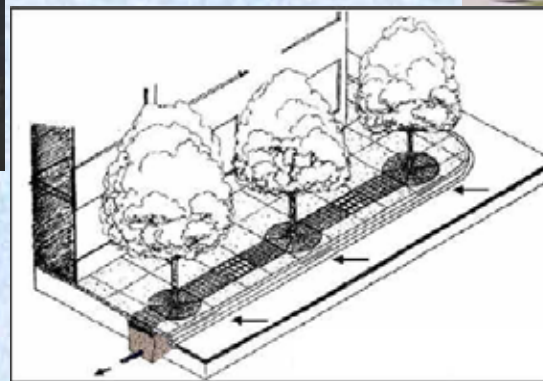
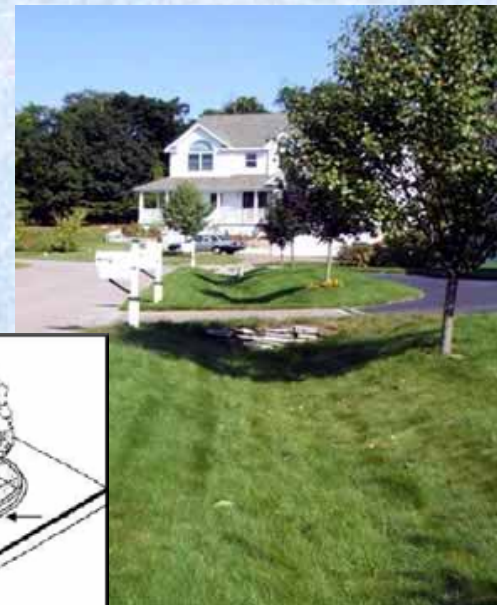
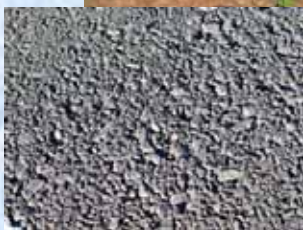
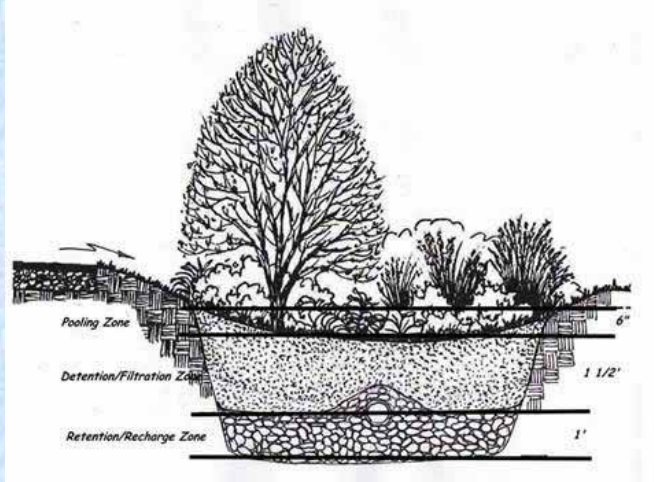

Entry Views



View from Washington Street, Wellesley

**Architectural rendering of proposed retail facility courtesy of NDNE Lower Falls, LLC*

Entry Views



View of proposed entry on Concord Street, Newton side

Approach View



View looking toward proposed entry on Concord Street,
Newton side

Bridge Views



View of Charles River at renovated bridge

Public Discussion & Summary

- Break out into groups to provide input on options
- Groups report back on input received
- Summary of Group report findings

Lower Falls Pedestrian Bridge Approaches

Questions

- What surfaces would you like to see for the sections of the approaches?
- Do you want the approaches to be accessible in the winter?
- What is the desired character of the approaches?
 - Curvilinear/ Naturalistic?
 - Geometric?
- What interpretive elements are desired?
 - Historical?
 - Ecological?
 - None?

Additional Information

- Design comments due to DCR by **September 2, 2009**
 - Email - Reference: bridge approaches
dcr.updates@state.ma.us
- Additional Information can be found at:
 - Web: www.mass.gov/dcr
 - Email: dcr.updates@state.ma.us
 - Phone: (617) 626-4974