

Massachusetts Department of Conservation and Recreation
Division of Water Supply Protection, Office of Watershed Management
Forest Management Project Summary

Project Title: Coldbrook Rd Gypsy Moth Salvage

DWSP Harvest Permit Number: S3WR
DCR Forest Cutting Plan File Number: 021-9502-19

Site Information

Watershed: Ware River Watershed	Town(s): Barre
Acres: 15.2	Nearest Road: Coldbrook Rd
Natural Heritage Atlas overlap?: No	Public Drinking Water Supply Watershed?: Yes
Forest Types: Mixed Oak	ACEC¹?: No
Soils: 910C Woodbridge-Paxton association, 902E Charlton-Paxton association	
Wetland Resources: Several seasonal streams and a wetland are near the harvest area.	
Vernal Pools present or within 200 feet of harvest : Yes – 2 vernal pools present outside of the harvest area, but within 200 feet of the edge of the harvest.	

Harvest Information

Harvest Start Date: 11/7/18	Harvest End Date: 2/14/19
Number of Wetland Crossings: None	Number of Stream Crossings: None

Best Management Practices Applied

Stream Crossings	There are no stream crossings.
Filter Strips	There is harvesting in a filter strip.
Wetland Crossings	There are no wetland crossings.
Harvesting in Wetlands	There is no harvesting in wetlands.

DWSP Forester supervising this harvest
Name: Ken Canfield
Forester License # 431
Phone #: 508-882-3636 X 1603
Email: kenneth.canfield@state.ma.us

¹ACEC: Area of Critical Environmental Concern

NARRATIVE

General Description/Forest Composition/History:

The harvest area is located east of Coldbrook Rd and north of Reuben Walker Rd in Barre. This oak stand was last thinned in 1995. Recent defoliation by Gypsy Moth caterpillars has left many trees dead or dying. Diverse natural regeneration is abundant throughout the stand.

Tree species present are red, black, scarlet, and white oak, red maple, hickory, eastern white pine, red pine, hemlock, black cherry, sugar maple, and quaking aspen.

Invasive shrubs, particularly glossy buckthorn, are present. Some invasive shrubs were hand-pulled during the marking of this lot. Harvesting trees in patches puts enough sunlight on the ground to create conditions that will help native tree species out-compete invasive shrubs over time.

The soil is moderately well drained.

Site Selection:

The primary goal of the watershed forest management program is to create and maintain a forest that provides high quality drinking water to current users and future generations. A healthy and resilient forest is comprised of diverse native tree and shrub species and multiple age classes of trees.

This area was chosen because of the patches of oak trees that have been recently killed by gypsy moth caterpillars. A combination of stress from a multi-year drought along with repeated extreme gypsy moth defoliation events has resulted in widespread oak mortality throughout the Quabbin and Ware River forests. The degree of damage varies from place to place, but there are unfortunately some significant areas with near complete mortality. While a large amount of the dead oak will remain in place to add to wildlife habitat and forest structural diversity, DWSP intends to temporarily shift its forest management focus to harvesting in areas of significant oak mortality. These areas would have otherwise been harvested through normal practices many years from now.

Silvicultural Objectives:

Salvage dead and dying oak stems, particularly where they occur in groups. Also remove low quality/vigor trees within those groups. There are three patches that are 2.6, 3.2, and 3.4 acres in size. There is also approximately 6 acres adjacent to the patches where the mortality is more sporadic where the salvage will resemble a thinning. The diverse natural regeneration that exists in the area will be released.

Cultural Resources:

Standard practice dictates that every effort is made to avoid disturbing stone walls and other cultural resources. One minor stonewall will have to be breached to establish a landing on Coldbrook Rd.

Wildlife/Rare or Endangered Species:

Two vernal pools are present adjacent to the harvest area. They will be buffered and protected.

FIGURES

Figure 1 Final Forest Cutting Plan

Figure 1 Final Forest Cutting Plan

Forest Cutting Plan

and Notice of Intent under M.G.L.
Chapter 132 – The Forest Cutting
Practices Act, 304 CMR 11.00 AUG 28 2018
(Effective Date: 3/15/16)

For DCR Use Only:

File Number 021-9502-19 Case No. _____
Date Rec'd 8/13/18 Nat. Hert. NO
Earliest Start 9/13/18 Pub. Dr. Wat. YES
River Basin CHICOPEE ACEC NO
Gen. Obj. LT

Site Information

Location

Town Barre
Road Coldbrook Rd
Acres 15 Proposed Start Date 9/1/18
Vol. MBF 83.1 Vol. Cds. 111 Vol. Tons _____

Plan Preparer

Name Kenneth W. Canfield
Address 578 Old Turnpike Rd
Town, State, Zip Oakham, MA 01068
Phone (508) 882-3636
Type of Preparer LF
*Mass. Forester License # 431
*Required for land under Ch61, Ch61A or Forest Stewardship

Landowner

Name DCR Division of Water Supply Protection
Mailing Address 485 Ware Rd
Town, State, Zip Belchertown, MA 01007
Phone (413) 323 - 6921
Ch61 ☐ 61A ☐ 61B ☐ Stew ☐ *Case #
FSC ☐ CR ☐ CR Holder

Licensed Timber Harvester**

Name TBA PIRNER LOGGING
Address 152 WILLIAMSVILLE ROAD
Town, State, Zip HUBBARDSTON MA 01452
Phone (978) 270-9916
Mass. Lic. Harvester # 2019-587 (MULTIPLE)
**This information may be supplied after the plan is approved, but before work begins.

Best Management Practices

Stream Crossings

Indicate location on map	SC-1	SC-2	SC-3	SC-4
Type of Crossing				
Existing Structure				
Type of Bottom				
Bank Height (ft)				
Stabilization				

Wetland Crossings

Indicate location on map	WC-1	WC-2	WC-3	WC-4
Length of Crossing				
Mitigation				
Stabilization				

Filter Strips

Indicate location on map	FS-1	FS-2	FS-3	FS-4
Width (50', 100', or VA)	VA	VA		

Harvesting in Wetlands

Indicate location on map	HW-1	HW-2	HW-3	HW-4
Forest Type (see pg 2)				
Acres to be Harvested				
Resid. Basal Area (>50%?)				

Service Forester Comments

• PLEASE NOTIFY DCR SERVICE FORESTER AT START OF OPERATION
• MAINTAIN 50' BA WITHIN BUFFER STRIP

Codes

Type of Preparer	Type of Crossing	Stabilization	Mitigation	Type of Bottom
LF Mass. Lic. For.	CU Culvert	SE Seed	FR Frozen	LE Ledge
TH Lic. Tim. Har	BR Bridge	MU Mulch	DR Dry	ST Stony
TB Timber Buyer	FO Ford	CO Corduroy	OT Other	MU Mud
LO Landowner	PO Poled	ST Stone		GR Gravel
OT Other	OT Other	HB Hay Bales		OT Other

Note:
Applicant must provide DCR with all relevant information before plan may be approved and cutting may begin.
Some forestry activities, such as prescribed burning and pesticide or fertilizer application may require additional permits. Consult MA Forestry BMP Manual for further information.

If Other (OT) is used in any category an explanation must be given on an attached narrative page

Products to be Harvested*

Species	Mbf/Cds		Mbf/Cds
White Pine		Red Maple	
Red Pine		Sugar Maple	
Pitch Pine		Red Oak	60.7
Hemlock		Black Oak	21.6
Spruce		White Oak	0.8
Other Sftwd.		Other Hdwd.	
White Ash		Total Mbf	83.1
Beech		Cordwood (Cds)	111
White Birch		SW Pulp (Tons)	
B & Y Birch		HW Pulp (Tons)	
Black Cherry		Chips (Tons)	

*Note: Volumes indicated in the Plan are as reported by the plan preparer and have not been independently verified by the service forester upon approval. Mbf = thousand board feet.

Cutting Standards

Indicate location on map	ST-1	ST-2	ST-3	ST-4
Forest Type	OM	OM		
Acres	9.2	6		
Landowner Objective	LT	LT		
Designation of Trees	CT	CT		
Type of Cut	SA	SA		
Source of Regeneration	SE	SE		

Landowner Signature

The most important information on a cutting plan is the Landowner's objective, as this will determine which trees will be harvested and which will remain; this decision will also determine the future condition of the forest for decades to come. After having read the Massachusetts Forest Cutting Plan Information Sheet on page one, indicate your objective by checking the appropriate box below.



LT - Long-term Forest Management

Planned management of the forest to achieve one or more of the following objectives: produce immediate and maximize long-term income, enhance wildlife habitat, improve recreational opportunities, protect soil and water quality, or produce forest specialty products.



ST - Short-term Harvest

Harvest of trees with the main intention of producing short-term income with minimal consideration given to improving the future forest condition, which often results in a forest dominated by poor quality and low value species.

I (we) have read the Massachusetts Cutting Plan Information Sheet, and am aware of my (our) management options.

I (we) hereby certify that I (we) have the legal authority to carry out the operation described above.

I (we) certify that I (we) have notified the Conservation Commission in the town in which the operation is to take place and the abutters of record within two hundred feet of the area to be harvested.

I (we) understand that the volumes in this plan have not been independently verified by the service forester upon approval and will report final values and volumes to the Director or his/her agent if the final figures differ from those reported.

Signature of landowner(s)

Date

Determination and Status

021-9502-19

Final Report and Comments

Approved

Disapproved

Expires

Cutting Plan



8/28/20

Signature of Service Forester/Director's Agent

Date

I hereby certify that the afore described Forest Cutting Plan and all relevant statutes have been substantially complied with.

Signature of Service Forester/Director's Agent

Date

Extension

1

2

Expires

Ser. For. Ints.

Amendment

App 1

Dis 1

App 2

Dis 2

Forest Types				Designation of Trees		Type of Cut		Source of Regeneration
WP White Pine	HK Hemlock	OM Mixed Oak	CT Cut Tree	SH Shelterwood	Intermediate Harveys:	AD Advanced		
WK WP/Hem	HH Hem/Hdwd.	RM Red Maple	LT Leave Tree	ST Seed Tree	CT Commercial Thin	SE Natural Seed		
WH WP/Hdwd	BC Black Cherry	BE Beech	SB Stand Boundary	CC Clear Cut	NT Non Com Thin	PL Plant		
WO WP/Oak	BB Bee/Bir/Map	SF Spruce/Fir	OT Other	SE Selection	Non-Standard Systems:*	CO Coppice		
RP Red Pine	OH Oak/Hdwd	SM Sugar Maple	Landowner Objective	SA Salvage	HG Highgrade*	DS Direct Seed		
SR Red Spruce	OR N Red Oak	PP Pitch Pine	LT Long-term Mgt.	SN Sanitation	DL Diameter Limit*	OT Other		
			ST Short-term Har.		OT Other*			

*If Other (OT) or a non-standard system is used an explanation must be given on attached narrative page pg 4 of 5

Forest Cutting Plan

Narrative Page (Effective Date: 3/15/16)

Use this page to provide further explanation or if Other (OT) was used in any category on pages 3 or 4.

Landowner DCR - DWSP

Town Barre

File Number 021-9502-19

BMPs

Use this Section to provide further explanation or if Other (OT) was used in any category in the Best Management Practices Section on Page 3.

This is a salvage harvest of dead and dying oak caused by a gypsy moth infestation. ST-1 consists of 3 openings that are 2.6, 3.4, and 3.2 acres (see stand map) in size. ST-2 consists of thinning areas adjacent to the openings and along skid trails.

Designation of Trees

Use this Section to describe the types of trees to be harvested and/or retained if Other (OT) was used for "Designation of Trees" in the Stand Treatment Section on page 4. Additional narrative description may be added on a separate page.

Describe Trees to be Cut				Describe Trees to be Left			% BA/AC	
Stand No.	Species	Size	Quality	Species	Size	Quality	Cut	Left

Regeneration & Future Condition

Use this Section to describe how Chapter 132 requirements will be met if a non standard system (HG, DL, or OT) was used for the "Type of Cut" in the Cutting Standards Section on page 4.

Stand No. Source of Regeneration (ex. AD, SE) How will Regeneration be obtained/protected?
If using AD - Describe the species present and how the regeneration will be protected
If using SE - Describe the source of the seed and the number of seed trees/acre

Stand No. Desired Future Condition
Describe what the stand is expected to look like five years from the harvest, including the condition of the overstory & understory

Coldbrook Rd, Barre, MA
Harding Hill Gypsy Moth Salvage
Lot # S3WR - 15.2 acres
MA DCR DWSP
Map by Kenneth W. Canfield
8/14/18
Not a legal survey

Legend

-  Landing
-  Skid Trail
-  Filter Strip
-  ST-2 Thinning
-  ST-1 Openings
-  Mid-State Trail
-  Stone Wall
-  Seasonal Stream
-  Stream
-  Wetland
-  Vernal Pool

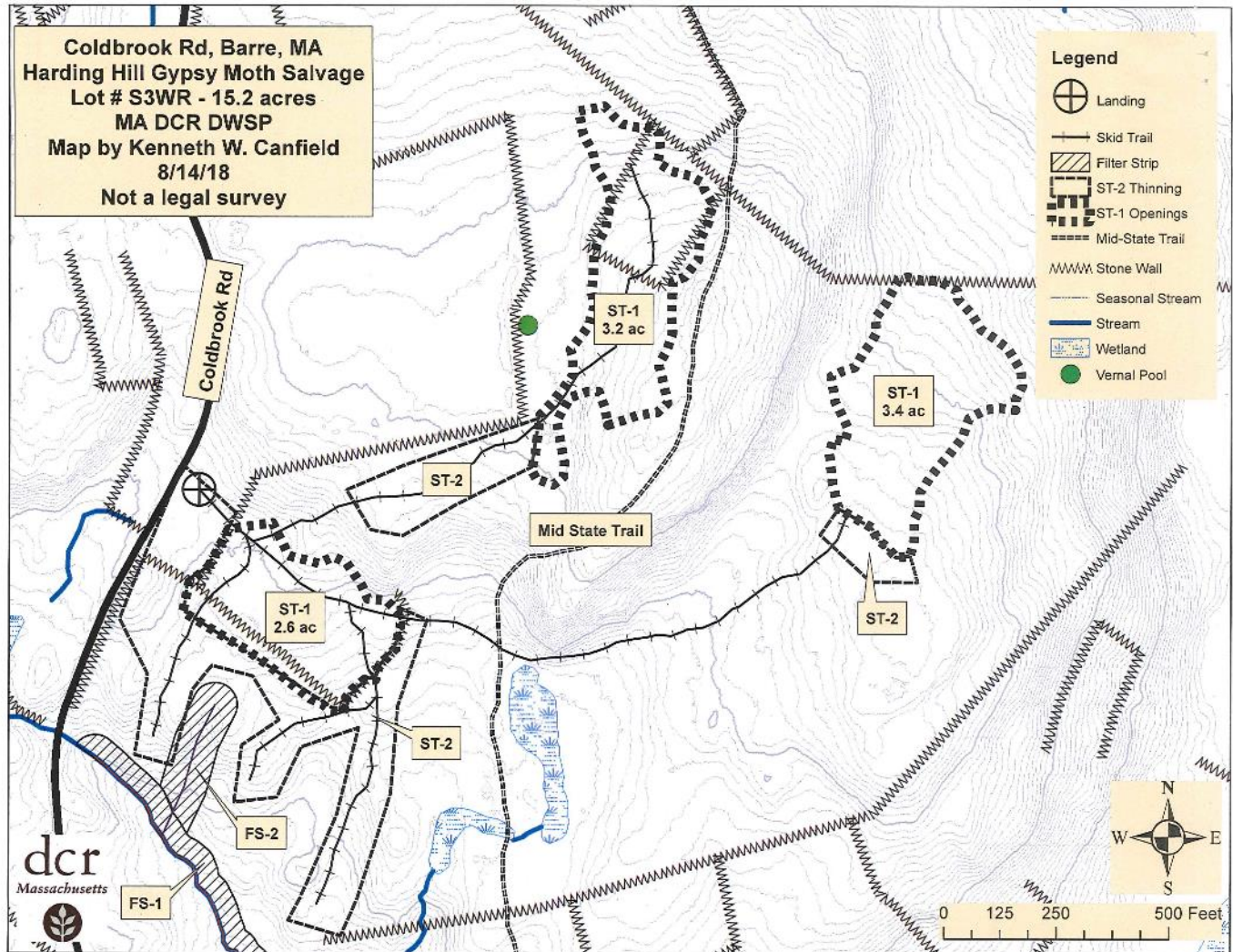

Coldbrook Rd, Barre, MA
Lot # S3WR
Harding Hill Gypsy Moth Salvage
15.2 Acres
MA DCR
Division of Water Supply Protection
Prepared by Kenneth W Canfield 8/14/18
Data Sources: MassGIS, DCR & EOEAA

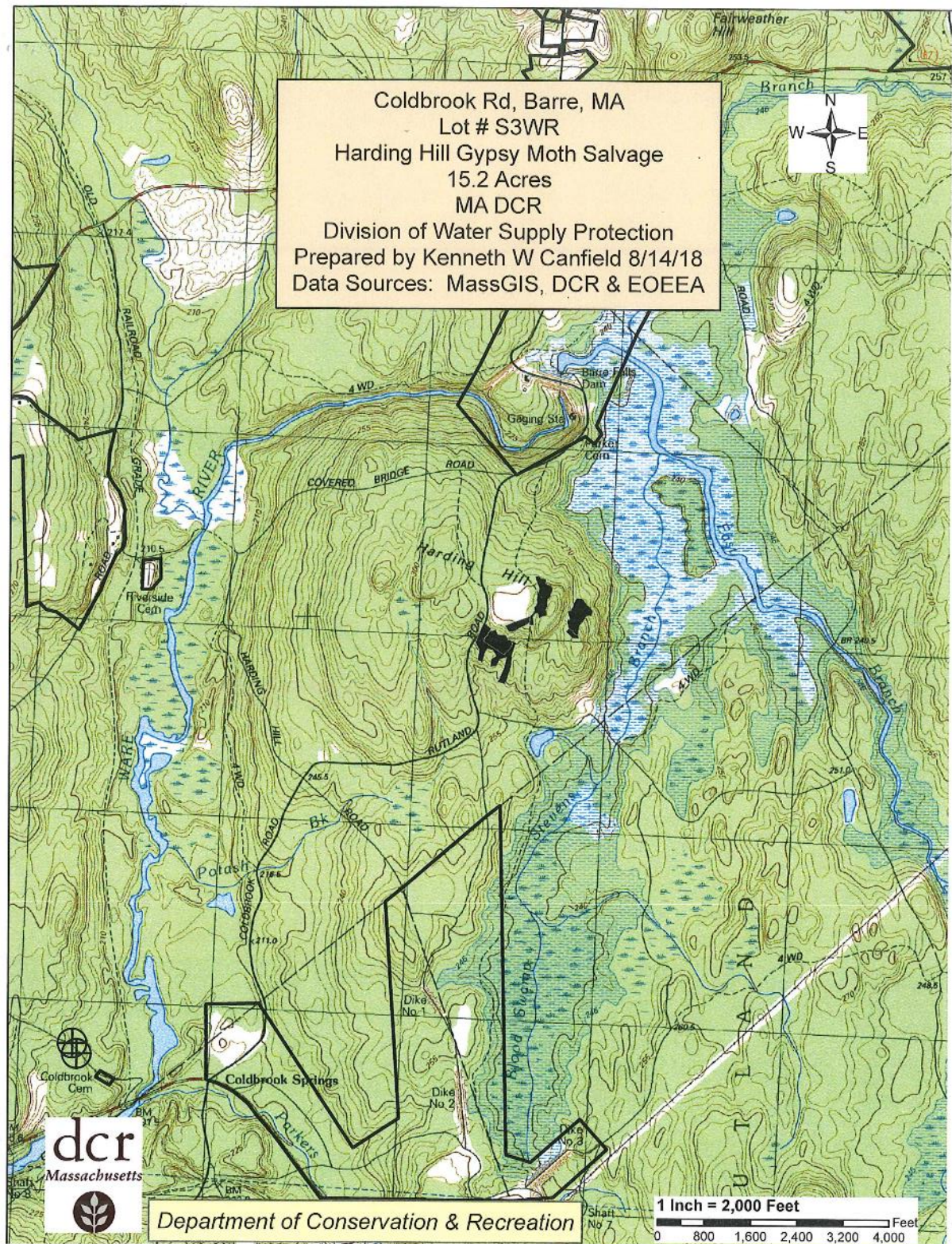

Department of Conservation & Recreation

1 Inch = 2,000 Feet

0 800 1,600 2,400 3,200 4,000 Feet

dc



COMMONWEALTH OF MASSACHUSETTS
Department of Conservation and Recreation
Division of State Parks and Recreation

FILE # 021-9502-19

W

FOREST CUTTING PLAN CERTIFICATE

Post this in a conspicuous place within the area in which the harvesting operation is to take place.

This certifies that DCR 485 WARE ROAD
DIVISION OF WATER SUPPLY PROTECTION BELCHERTOWN MA 01007 in accordance with the
(Name of Owner) (Address)

provision of M.G.L. Chapter 132, Section 40-46, filed in CLINTON with the Dept. of Conservation
and Recreation, Division of State Parks and Recreation, a Notice of Intent to cut forest products upon the
COLD BROOK ROAD lot.

Approval Date 8/31/2018

Director's Agent CHRIS CAPONE

DCR Phone No. (857) 406-0175

ISSUED BY:

Priscilla E. Geigis, Director
Division of State Parks and Recreation