



IV. PILOT PROJECTS*

- 4.1 LAKE WYOLA STATE PARK
- 4.2 HOLYOKE HERITAGE STATE PARK
- 4.3 CHICOPEE MEMORIAL STATE PARK
- 4.4 QUINSIGAMOND STATE PARK - LAKE PARK
- 4.5 COCHITUATE STATE PARK
- 4.6 LAWRENCE RIVERFRONT STATE PARK
- 4.7 CONSTITUTION BEACH PARK
- 4.8 MELNEA A. CASS RECREATIONAL COMPLEX
- 4.9 POPE JOHN PAUL II PARK
- 4.10 FORT PHOENIX STATE RESERVATION

*The methodology used to identify the 10 Pilot Project sites is described in Section 1.1. Concept plans, descriptions of the proposals and lessons learned for each site follow.



Figure 4-1. Key map of ten pilot project sites

4.1 LAKE WYOLA STATE PARK | SHUTESBURY



Figure 4.1-1. Existing conditions plan

Proposed:

- (1) Small pavilion
- (2) Medium pavilions
- Tree planting

A small pavilion is proposed adjacent to the waterfront and restrooms and along an accessible route; pavilion to match the existing restroom architecture. Tree plantings proposed to enlarge the existing grove of trees. Per the guidelines, the trees will be protected by a fence. In addition, medium pavilions are proposed for 2 locations that are currently underutilized but offer beautiful views, a grassy area adjacent to the remote parking and a woodland clearing. Both locations would require the installation of accessible paths.

Lessons Learned:

An abutter to the park has complained about noise; structures were not proposed in that vicinity at this time. Accessible connections in resource areas may be expensive to permit and construct. Some beachfront area was formerly a parking lot, which may impact current drainage and planting. The farmhouse may become a Historic Curatorship Project, therefore, increased coordination with Office of Cultural Resources will be essential to balance future improvements and appropriate shade installations in the area.



Figure 4.1-2. Site plan with proposed elements

4.2 HOLYOKE HERITAGE STATE PARK | HOLYOKE



Figure 4.2-1. Existing conditions plan

Proposed:

- (1) Custom large pergola
- (1) Custom small pergola
- (2) Shelters

One of the hottest areas shown by the data-driven suitability assessment was the grassy lawn on site, however during the site visit it was revealed that modifications to the grassy lawn would be in conflict with staging for annual summer concerts.

Following Operations staff recommendations, bench shelters around the lawn perimeter were proposed for this area. A large pergola to match existing is proposed at the west end of the park, overlooking the canal, as a senior housing project is under development across the street. In the center of the park, a small pergola is proposed between 2-5- and 5-12-year-old play areas.

Lessons Learned:

Proposed shade structures will need to match very distinctive custom pergolas which reference the industrial history of the site. Community events like concerts—and the staging and sight lines they require—may preclude installing shade structures.



PERGOLA
(To match existing)



CUSTOM SHADE STRUCTURE
(Existing)



SHELTER

Preferred Proposed Structure

Alternative Proposed Structure

4.3 CHICOPEE MEMORIAL STATE PARK | CHICOPEE



Figure 4.3-1. Existing conditions plan

Proposed:

- (2) Medium pavilions
- (2) Shelters

Two pavilions are proposed, one along the reservoir, adjacent to amenities and the other next to remote parking to activate a lawn. In addition, bench shelters are proposed along the road to the restrooms.

Lessons Learned:

The pavilions should match the CCC-inspired existing pavilions on site. DCR considered eliminating this design, as birds and bees can roost on the joists, but Ops felt this is not a concern and design consistency is a priority. Areas close to amenities are crowded and siting shade structures is a challenge. The riverfront area is next to freshwater wetlands, which should be reviewed by Office of Natural Resources.



Figure 4.3-2. Site plan with proposed elements

4.4 QUINSIGAMOND STATE PARK - LAKE PARK | WORCESTER



Figure 4.4-1. Existing conditions plan

Proposed:

- (1) Large canopy
- (2) Cantilevered canopies
- Tree planting

One large canopy is proposed for spectators and practices at the west end of the field. Two canopies are proposed for sports participants. Tree planting is proposed along Lake Ave. and adjacent to parking.

Lessons Learned:

Tree planting adjacent to synthetic turf field increases maintenance significantly. Proposed scope of capital projects required coordination. Spectator seating coordinated with Recreational Fields Program. Some tree planting coordinated with Greening the Gateway Cities demonstration planting.

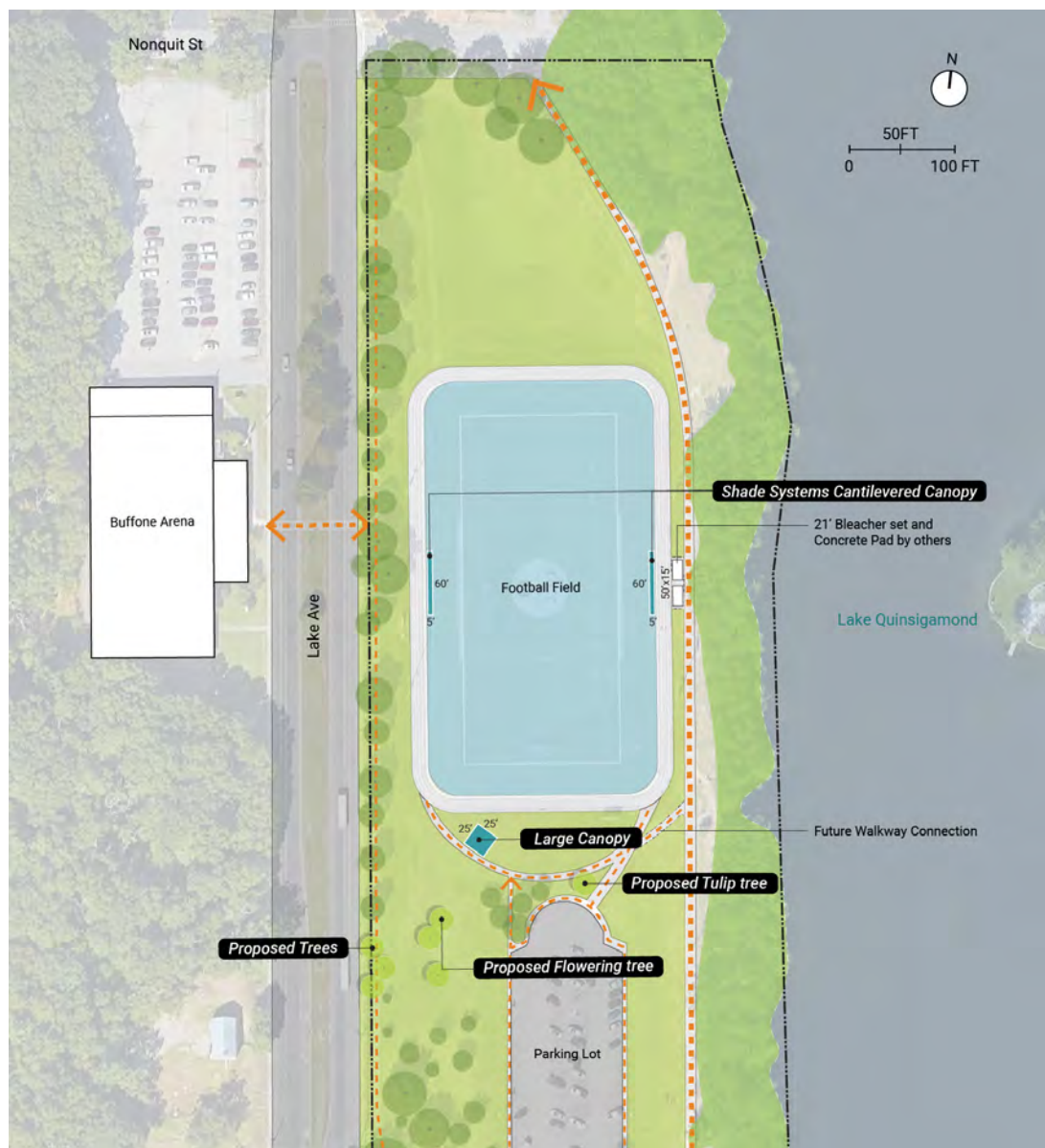

Figure 4.4-2. Site plan with proposed elements



LARGE CANOPY



FLOWERING TREE



CANTILEVERED
CANOPY



COLUMNAR TREE



TULIP TREE

4.5 COCHITUATE STATE PARK | NATICK



Figure 4.5-1. Existing conditions plan

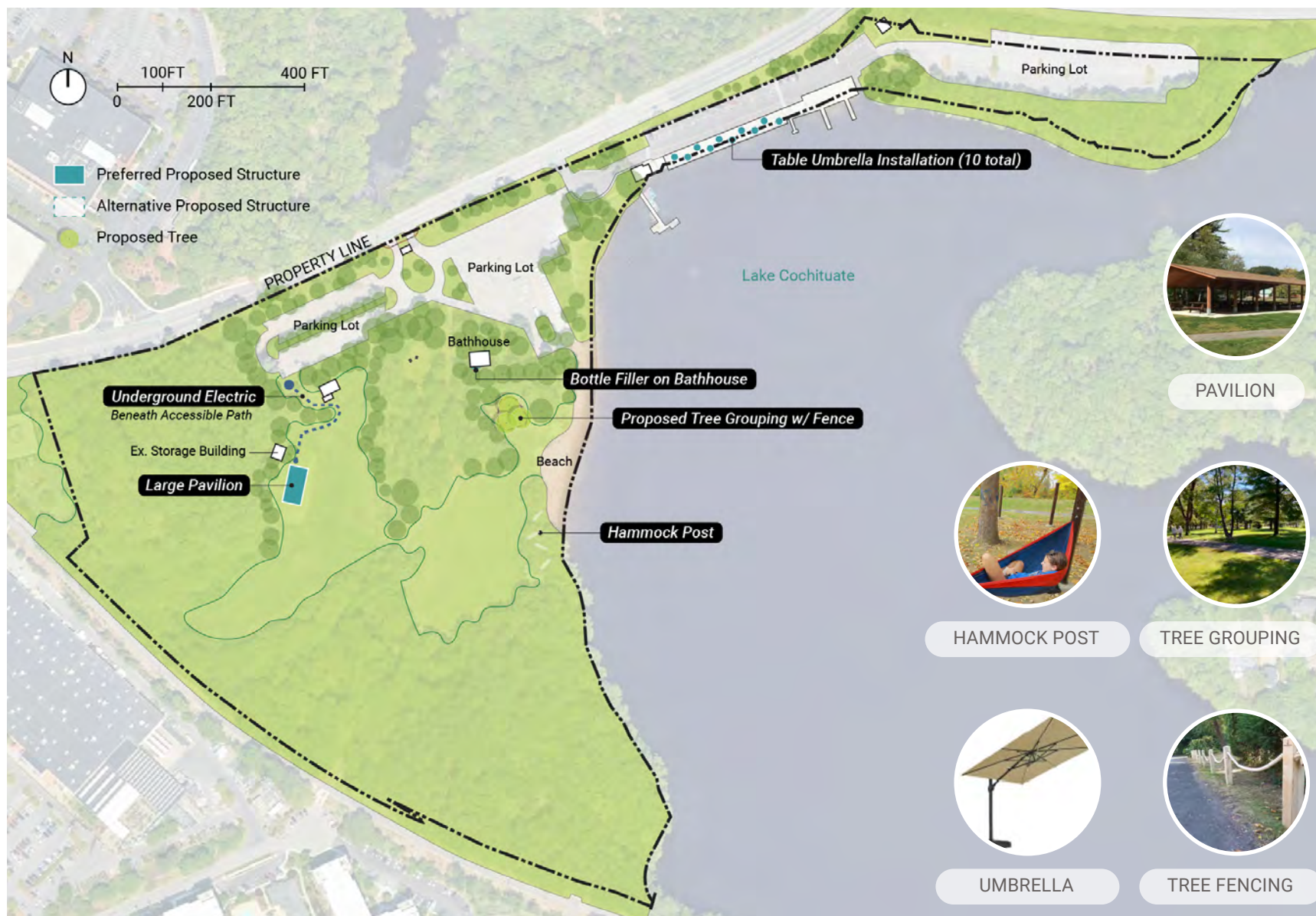

Figure 4.5-2. Site plan with proposed elements

4.6 LAWRENCE RIVERFRONT STATE PARK | LAWRENCE



Figure 4.6-1. Existing conditions plan

Proposed:

- (1) Gazebo
- (1) Playground canopy
- (3) Shelters

To provide additional shade at the playground, a gazebo (to match existing) is proposed placed on axis at the north end (in turn creating another entry point). Inside the playground fence, two options are proposed, a fabric canopy or playground post and metal roof. Shelters are proposed around the perimeter of the lawn.

Lessons Learned:

Ops staff did not want shade structures to encourage illicit use in areas that could not be monitored from Everett Street. Property line/ management of riverfront area—Fish and Game or DCR—is not apparent.



Figure 4.6-2. Site plan with proposed elements



OCTAGONAL PAVILION
(To match existing)



SHELTER



CANOPY



SHADE TREE

4.7 CONSTITUTION BEACH PARK | BOSTON



Figure 4.7-1. Existing conditions plan

Proposed:

- (2) Large octagonal pavilions
- (1) Canopy
- Tree planting

Two locations for octagonal pavilions to match existing are proposed. Playground renovation now underway, canopy proposed for eastern end of new play area. Next generation tree planting proposed along northeast fence line.

Lessons Learned:

The pavilions will need to match the existing octagonal pavilion on site. Existing pavilion in need of pavement and roof repairs. Be certain to match roof colors and materials.



Figure 4.7-2. Site plan with proposed elements



OCTAGONAL PAVILION
(To match existing)



CANOPY



OAK TREE



WILLOW TREE

4.8 MELNEA A. CASS RECREATIONAL COMPLEX | BOSTON



Figure 4.8-1. Existing conditions plan

Proposed:

- (2) Solar tables
- (2) Entry awnings
- Tree planting

Two solar picnic tables are proposed in the entry plaza. Awnings are proposed at the entry where visitors may queue for admittance.

Lessons Learned:

No additional impervious surfaces added. Benches reset by PSO. Tree pruning completed by Tree Maintenance Contract. Tree planting to be installed by Landscape Improvements Contract. Solar picnic tables, which can power laptops and cell phones, will be used for after school programs and summer camps.



SOLAR SHELTER



AWNING



TREE

A. *Cercis canadensis*
(No cultivars)
B. *Ostrya virginiana*

Figure 4.8-2. Site plan with proposed elements

4.9 POPE JOHN PAUL II PARK | BOSTON



Figure 4.9-1. Existing conditions plan

Proposed:

- (1) Medium pavilion
- (2) Bench shelters
- Tree planting

Proposed pavilion to match popular pavilion at playground. Shelters proposed for spectator seating at soccer fields.

Lessons Learned:

Similar to Holyoke Heritage, these structures will need to match custom designs on site, which may add to cost. Similar to Lawrence, Ops did not want structures located along Neponset River Greenway where police could not observe potential illicit activity. Ops requested tree planting continue the pattern of planting in clumps with mixed native species like oak, Eastern red cedar and bayberry, rather than single stem trees.

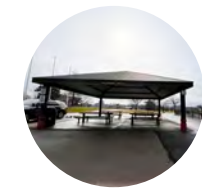
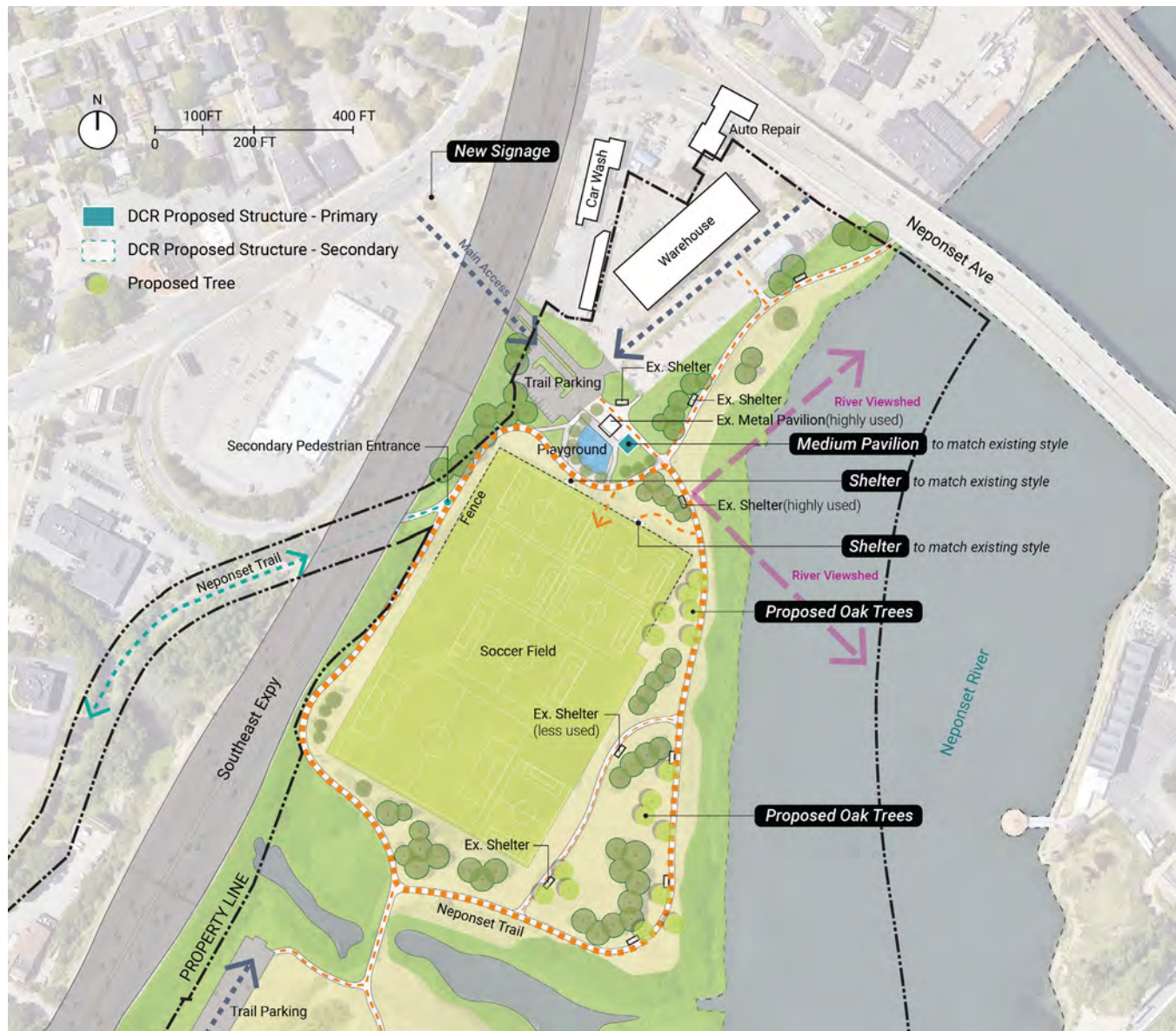

MEDIUM PAVILION
(To match existing)



SHELTER
(To match existing)



OAK TREE

4.10 FORT PHOENIX STATE RESERVATION | FAIRHAVEN



Figure 4.10-1. Existing conditions plan

Proposed:

- (1) Large octagonal pavilion
- (1) Solar awning
- (1) Large pavilion
- (1) Medium pavilion, tree planting

Octagonal pavilion is proposed next to existing octagonal pavilion. Building awning is proposed to shade staff break area.

Locations for additional pavilions proposed at north end of lawn area (adjacent to future location for playground) and at east end of site to activate the east end of the beach.

Lessons Learned:

Wind is too strong at this coastal location for canopies. Abutters do not want views of Buzzards Bay blocked by trees or structures. Localized flooding eliminates some locations. People picnic/ lounge in and adjacent to parking lots.



Figure 4.10-2. Site plan with proposed elements



PAVILION



OCTAGON PAVILION



SOLAR AWNING

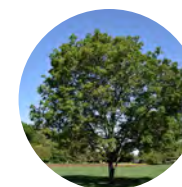

SHADE TREE