

ELEVATION OF ABUTMENT

SCALE: $\frac{1}{4}" = 1'-0"$

BACK FACE OF ABUTMENT

* Denotes dimension that varies for gravity abutment

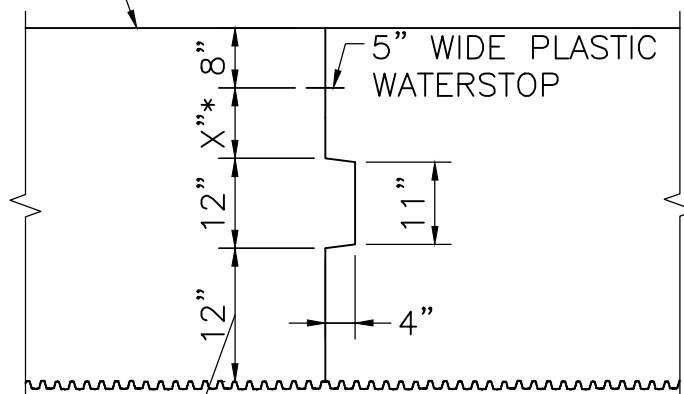

See Note 3 on Dwg. No. 3.1.8

SECTION 1

SCALE: $\frac{1}{2}" = 1'-0"$



LRFD BRIDGE
MANUAL, PART II

CONSTRUCTION JOINT DETAILS

ABUTMENT DETAILS

DATE OF ISSUE
JUNE 2013

DRAWING NUMBER

3.1.7