

February 9, 2021

Southborough-Westborough I-90 Superstructure Replacements (EB & WB) over Woodland, Cordaville, Parkerville and Flanders Roads

Public Information Meeting



How To Use Zoom Captioning

- You can view closed captions by clicking the **Closed Captions** feature and selecting from the options shown.
- **Show Subtitle** will display a caption at the bottom of the screen.
- **View Full Transcript** will display the meeting's audio transcription in a window to the right.

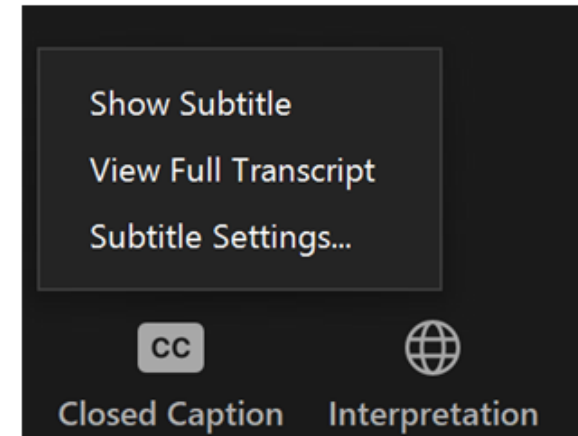
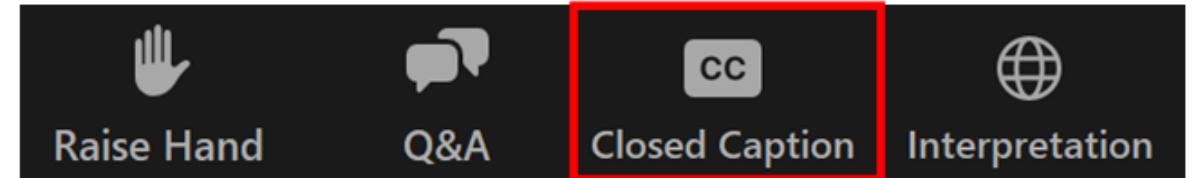

Agenda

Welcome and Introductions

Project Goals

Construction Schedule and Staging

ABC Construction

Traffic Impacts & Local Detour Routes

Public Outreach Plan

Questions & Answers

MassDOT I-90 Projects

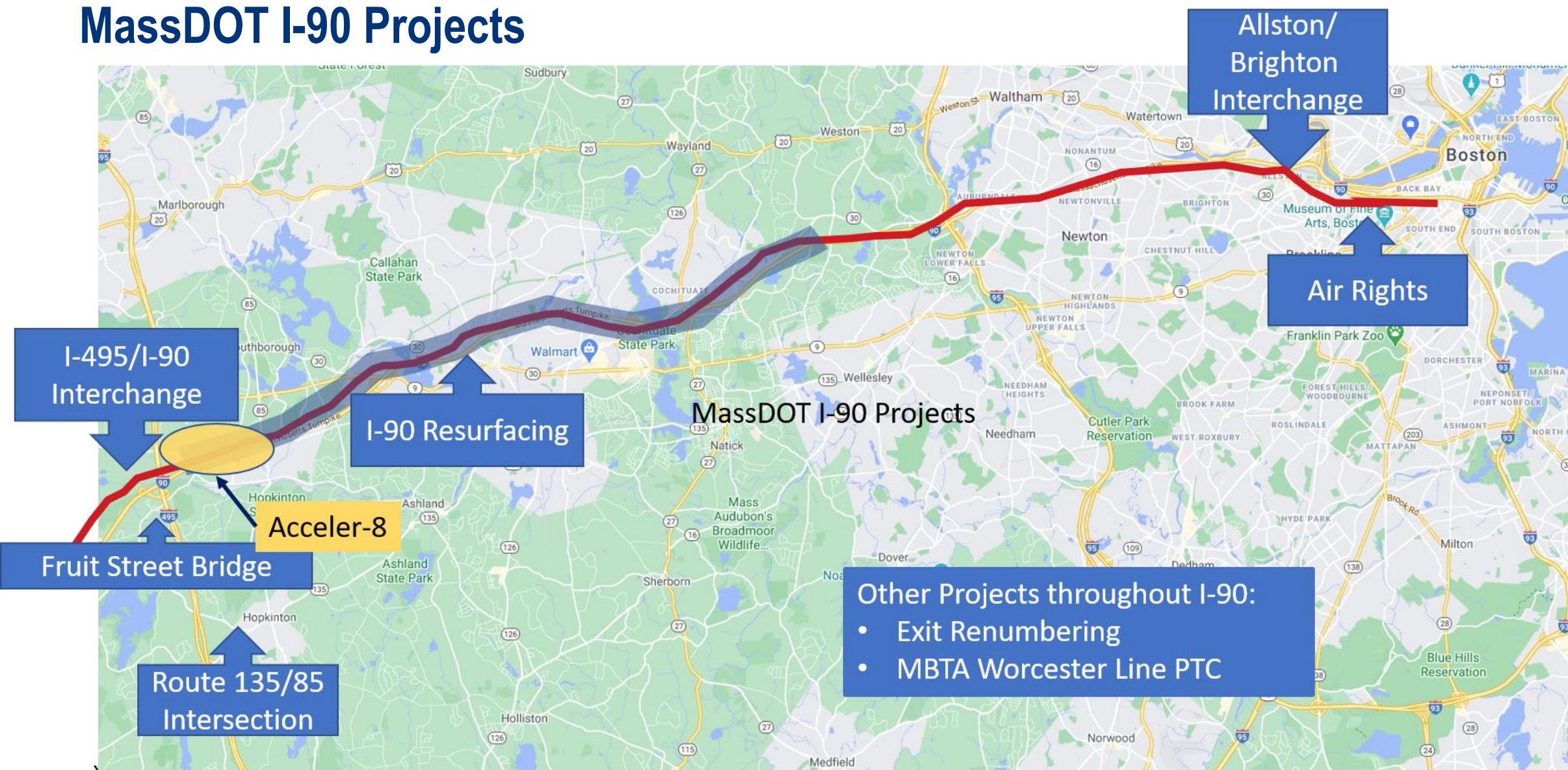

Project Goals

- **Replace Failing Bridge Decks and Superstructures**
 - **Increase life of each bridge (75 Years)**
- **Improve Clearance to Local Roadways below**
- **Increase available width between Abutments of Cordaville Road**
- **Upgrade Median Barrier**
- **Upgrade I-90 Driving Surface and Pavement Markings**
- **Upgrade Shoulder Protection**
 - **New Shoulder Barrier & New Guardrail**

Work Activities and Locations

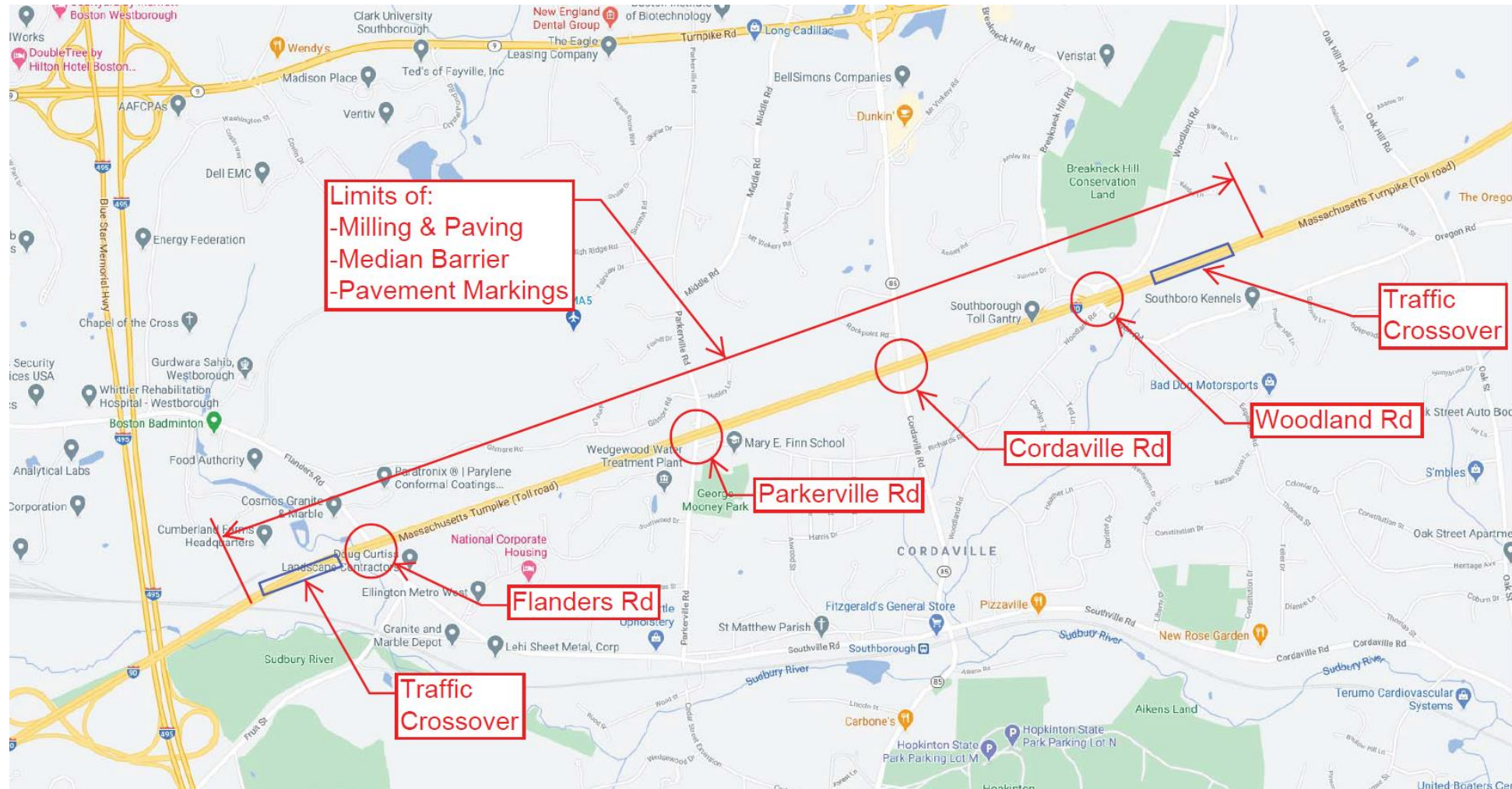

Significant Construction Work

Estimated Start Dates and Durations:

- February 2021 – March 2021 Flanders Rd. Utility Relocation
- February 2021 – May 2021 – I-90 Median Barrier Replacement
- February 2021 – July 2021 Bridge Abutments
- March 2021 – May 2021 – Median Crossover Construction
- May 2021 – Movable Barrier Trial Run
- **June 2021 – August 2021 – Rapid Bridge Replacements**
- August 2021 – October 2021 – I-90 Median Barrier Replacement
- September 2021 – November 2021 – Final Paving

Construction Staging by Weekend

| | | | | 56 Hour Work Window | | | |
|----------|---|-------------------------|----------------|---------------------|-----------------------------|-----------|-----------|
| | MassDOT I-90 Southborough - Westborough Acceler-8 Construction Sequence | | | | | | |
| Wknd No. | Primary Work Location | Primary Operation | Hwy. Direction | Start | 24 hrs per day over Weekend | | End |
| | | | | FRI @ 9pm | SAT | SUN | MON @ 5am |
| 1 | Woodland Road | Bridge Replacement | WB | 6/18/2021 | 6/19/2021 | 6/20/2021 | 6/21/2021 |
| 2 | Cordaville Road | Full Bridge Replacement | WB | 6/25/2021 | 6/26/2021 | 6/27/2021 | 6/28/2021 |
| 3 | Parkerville Rd & Flanders Rd | Bridge Replacement | WB | 7/9/2021 | 7/10/2021 | 7/11/2021 | 7/12/2021 |
| 4 | Woodland Parkerville & Flanders | Waterproof & Pave | WB | 7/16/2021 | 7/17/2021 | 7/18/2021 | 7/19/2021 |
| 5 | Woodland Road | Bridge Replacement | EB | 7/23/2021 | 7/24/2021 | 7/25/2021 | 7/26/2021 |
| 6 | Cordaville Road | Full Bridge Replacement | EB | 7/30/2021 | 7/31/2021 | 8/1/2021 | 8/2/2021 |
| 7 | Parkerville Rd & Flanders Rd | Bridge Replacement | EB | 8/6/2021 | 8/7/2021 | 8/8/2021 | 8/9/2021 |
| 8 | Woodland Parkerville & Flanders | Waterproof & Pave | EB | 8/13/2021 | 8/14/2021 | 8/15/2021 | 8/16/2021 |

56 Hour Weekend Construction



Accelerated Bridge Construction (ABC) Pre-Cast Elements

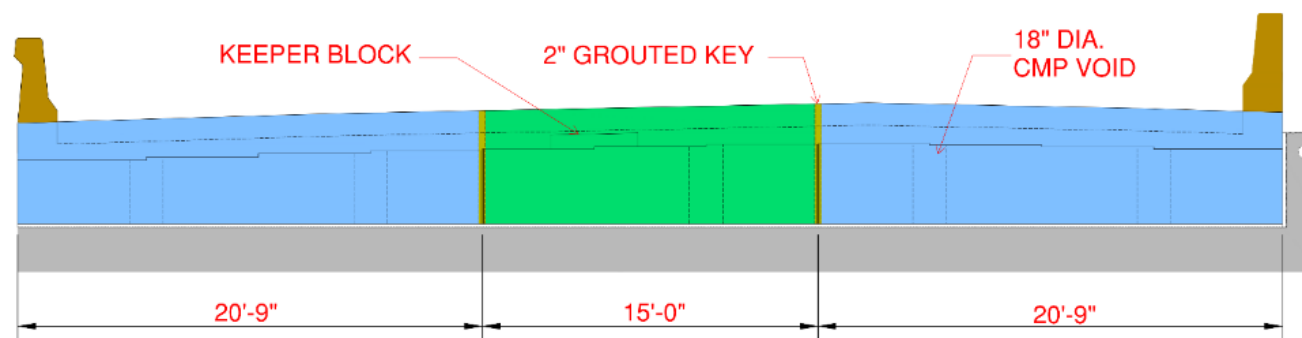

Caps – three to four pieces at each abutment depending upon skew

Accelerated Bridge Construction (ABC)

- NEXT D Beams

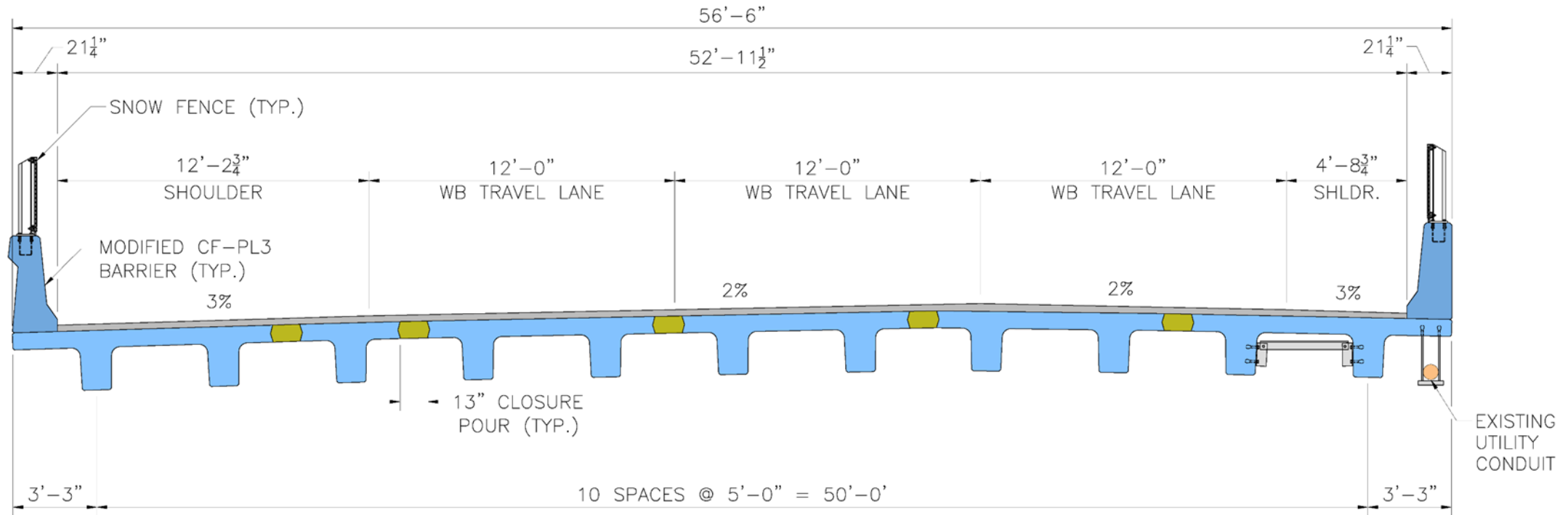

Cordaville Road – New Abutments

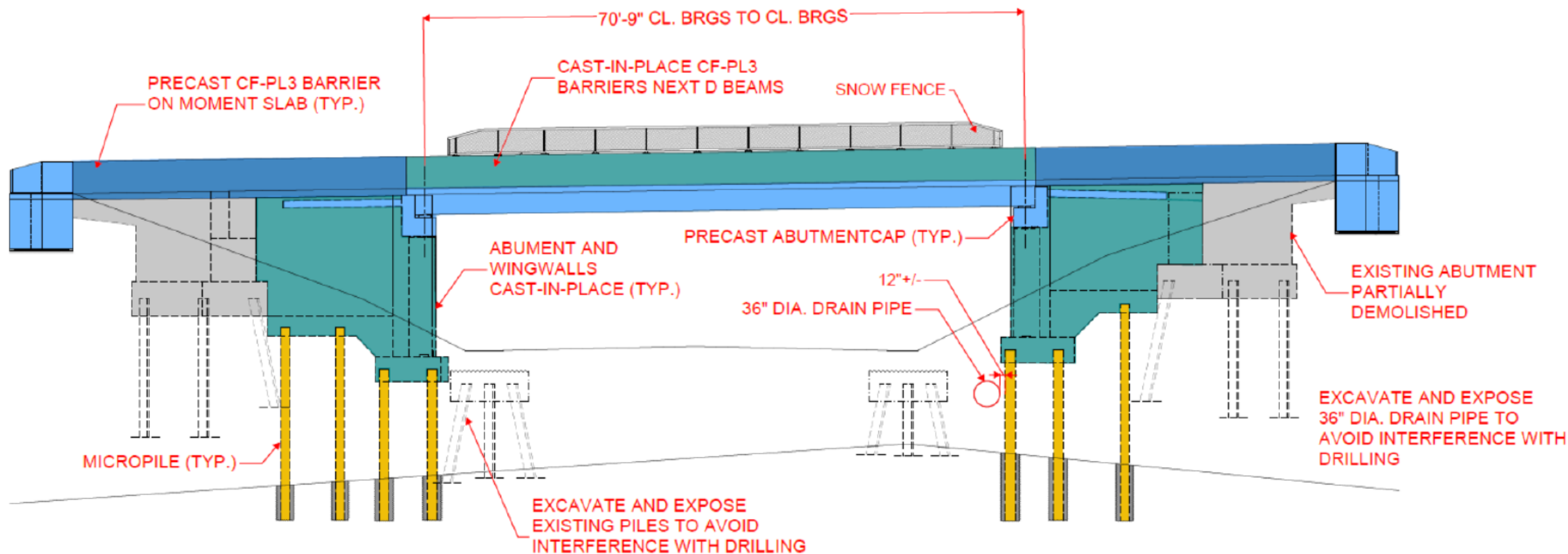

Acceler-8: TMPs & Crossovers



Multiple Work Areas during Weekend Traffic Set-ups

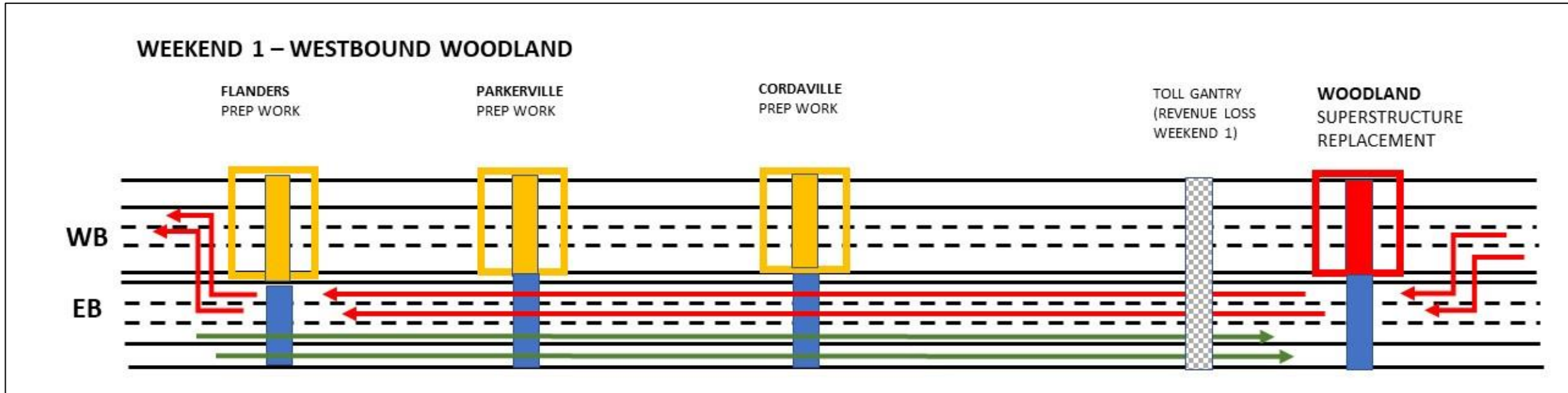

Weekend #1 includes the bridge deck replacement along I-90 westbound (WB) at Woodland Road Bridge (red) while performing excavation and demolition of the approach slabs, followed by backfill, compaction and temporary pavement along I-90 WB at Cordaville, Parkerville and Flanders Road Bridges (yellow).

Real Time Traffic

15

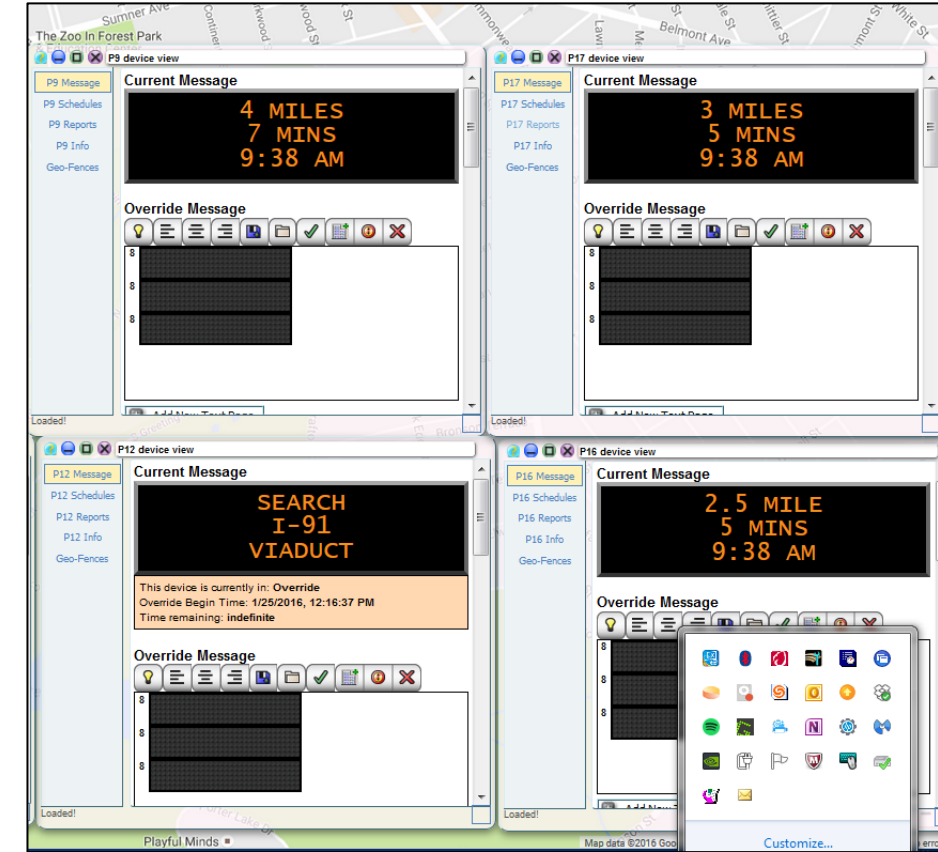
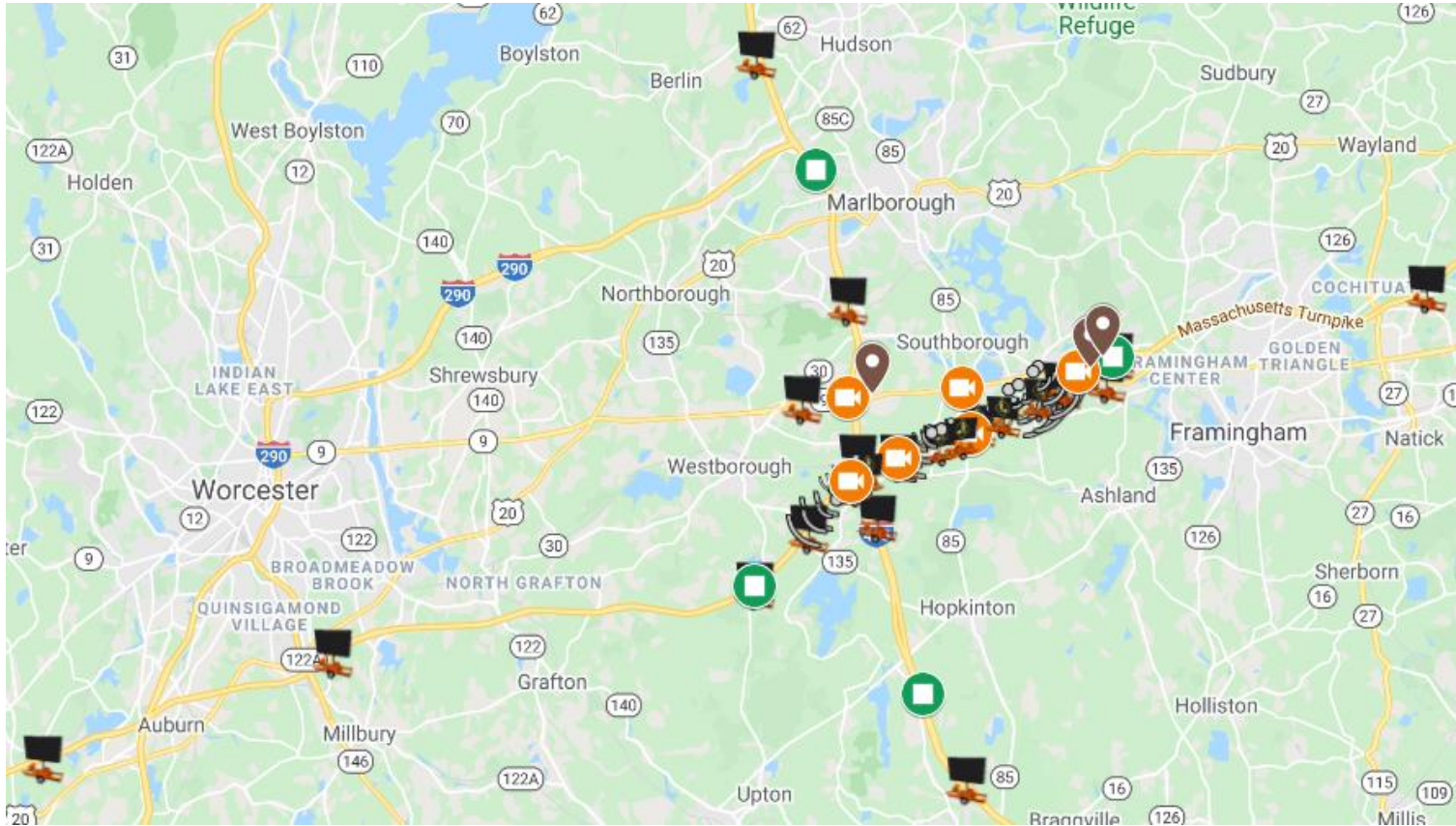

- Real Time Traffic Management (RTTM) systems, Regional PCMS and “Go Time” info
 - Distance/Time info provided at multiple locations along the Mass Pike, I-495 and Route 9

Local Detour Plan for Woodland Road Closure

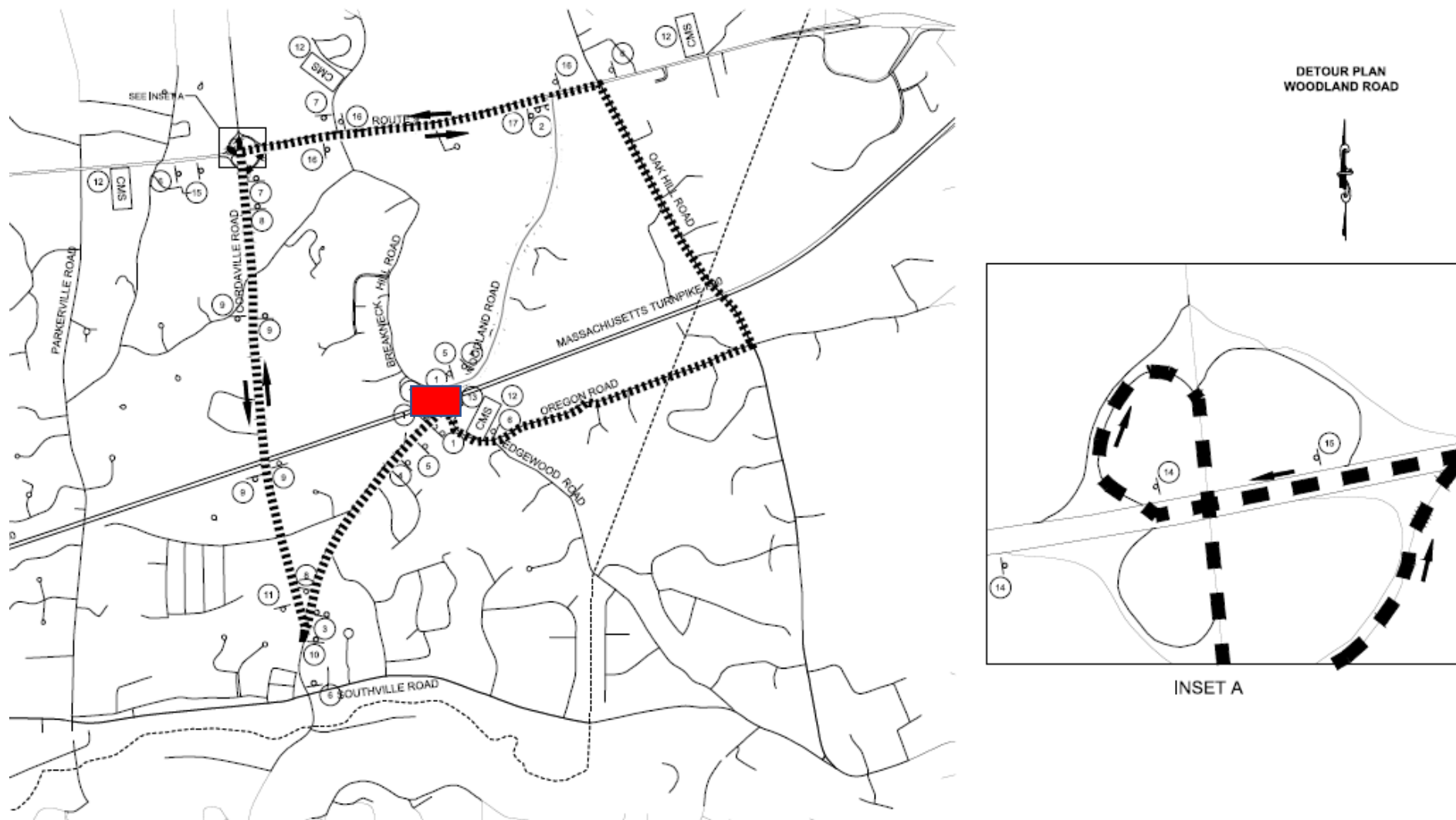

Local Detour Plan for Cordaville Road Closure

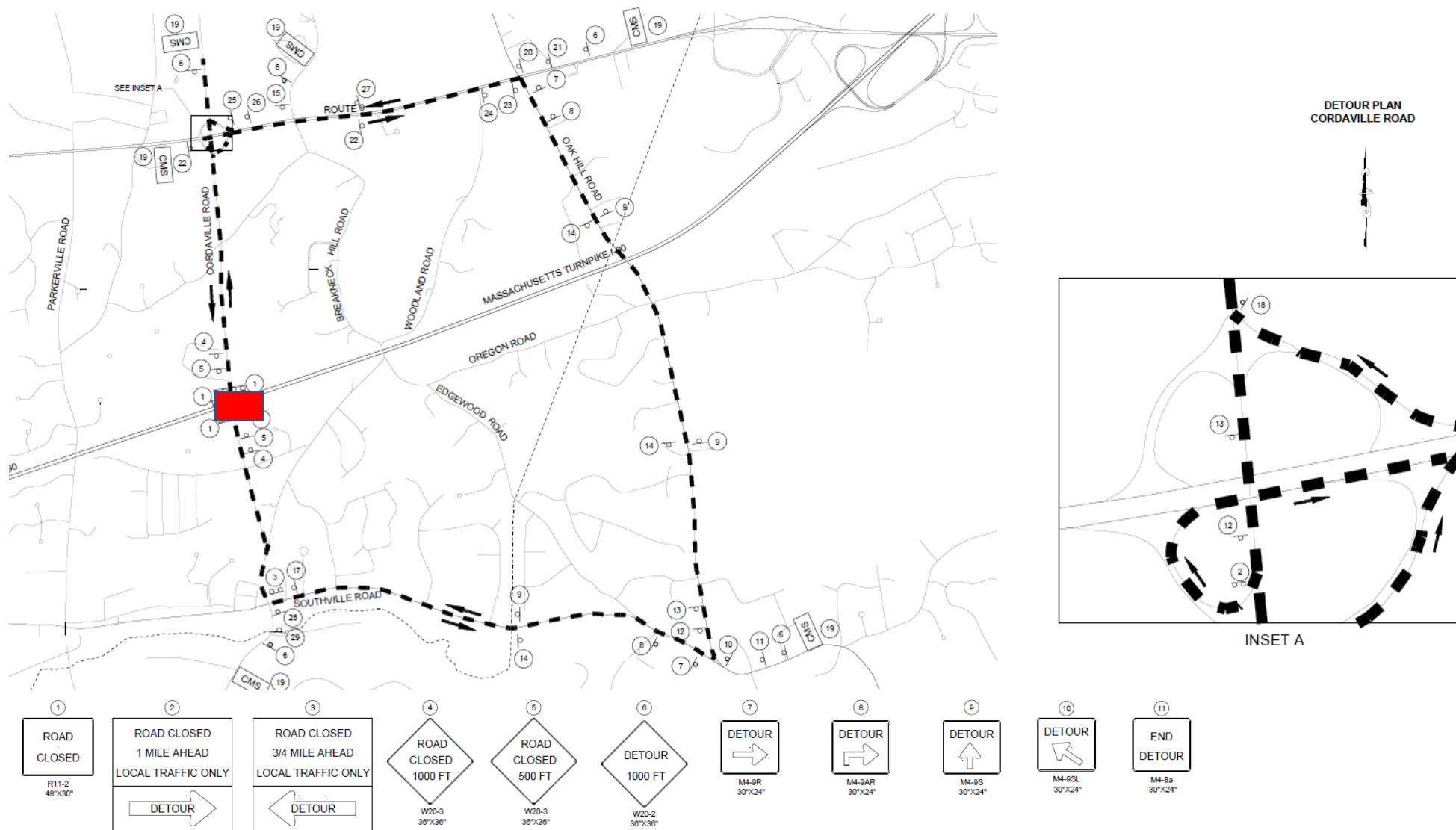

Flanders and Parkerville Closed on Same Weekend

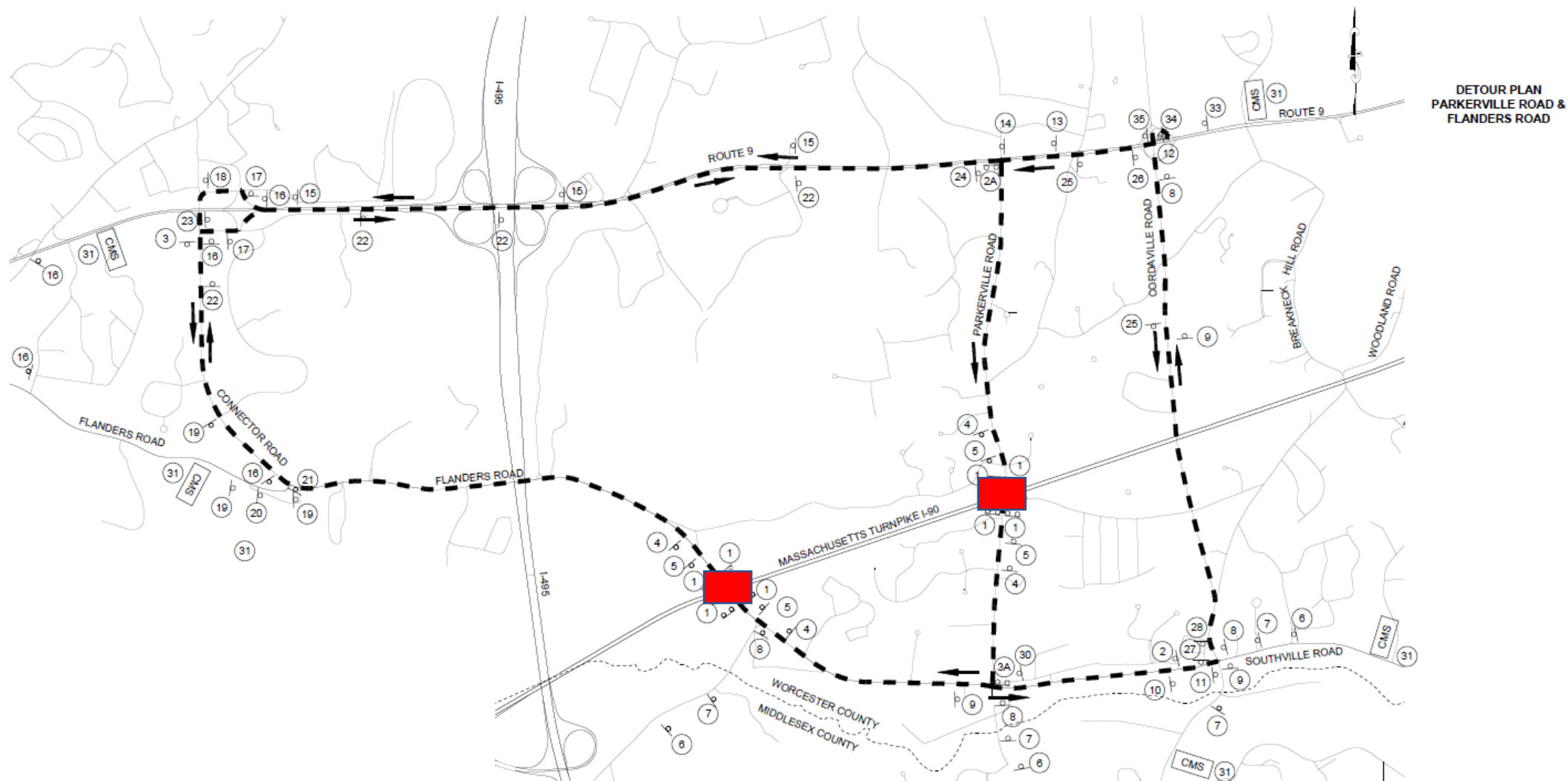

Woodland, Flanders and Parkerville Roads Existing Abutments will be Re-Faced



Cordaville Road – New Abutments

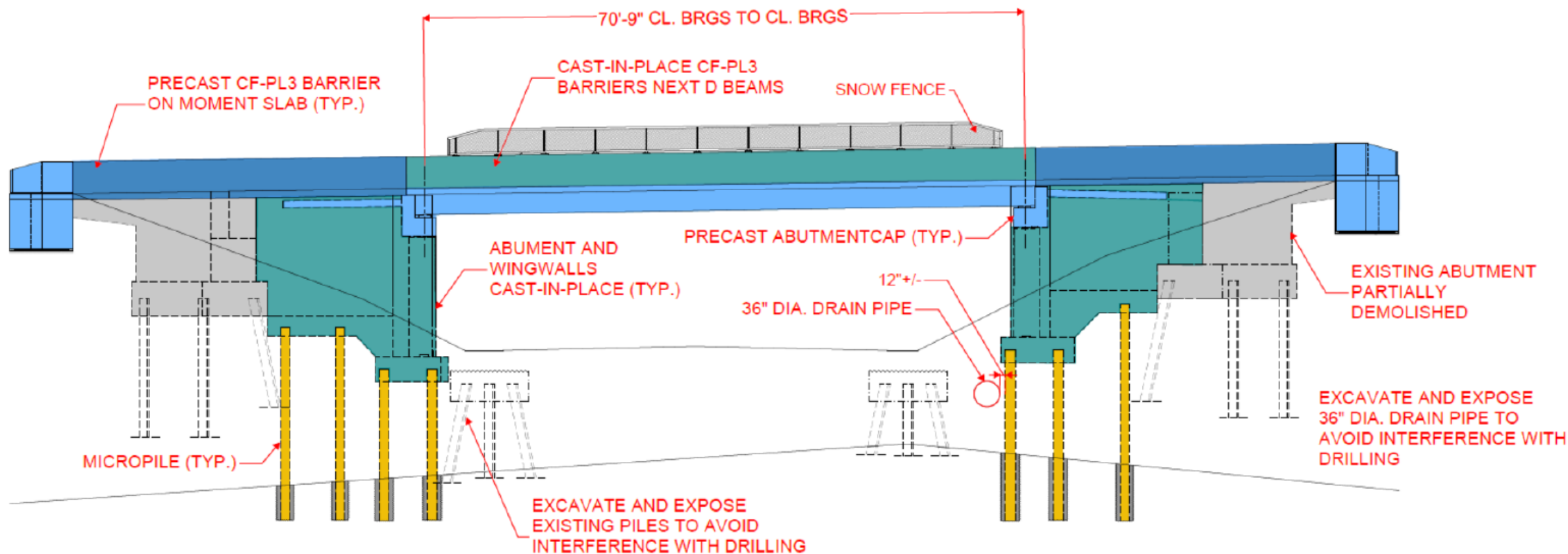

Typical Abutment Work Zone

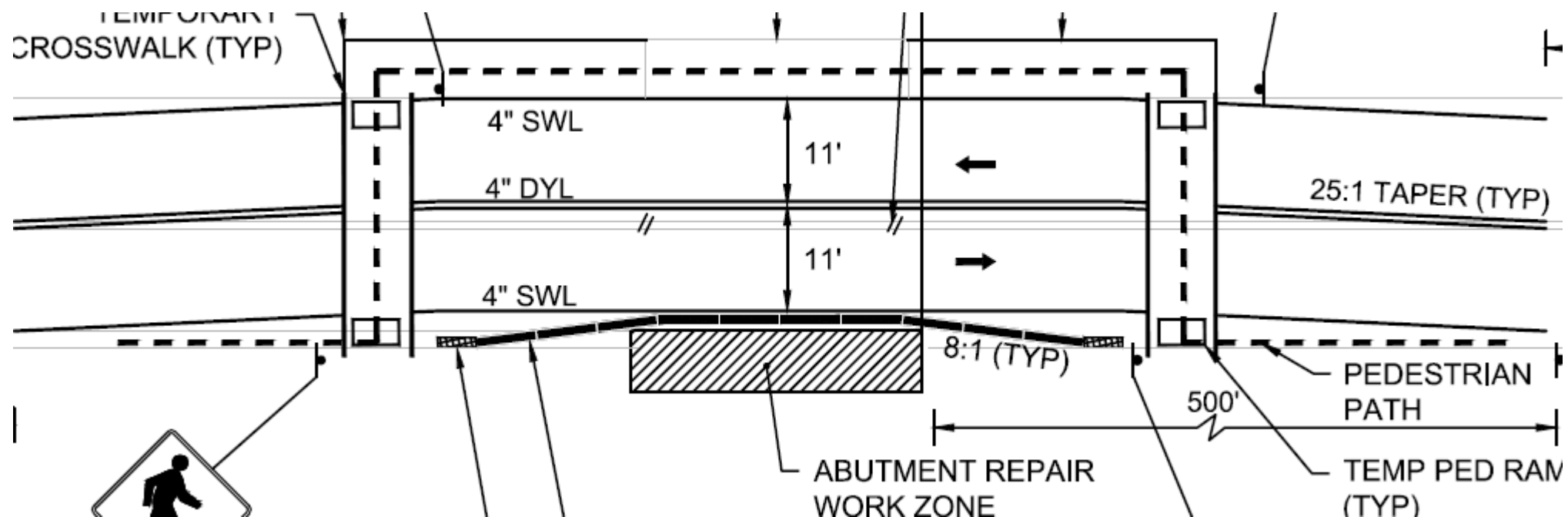

TEMPORARY TWO-WAY TRAFFIC CONTROL AT ABUTMENT REPAIR LOCATIONS

N.T.S.

Typical Abutment Work Zone

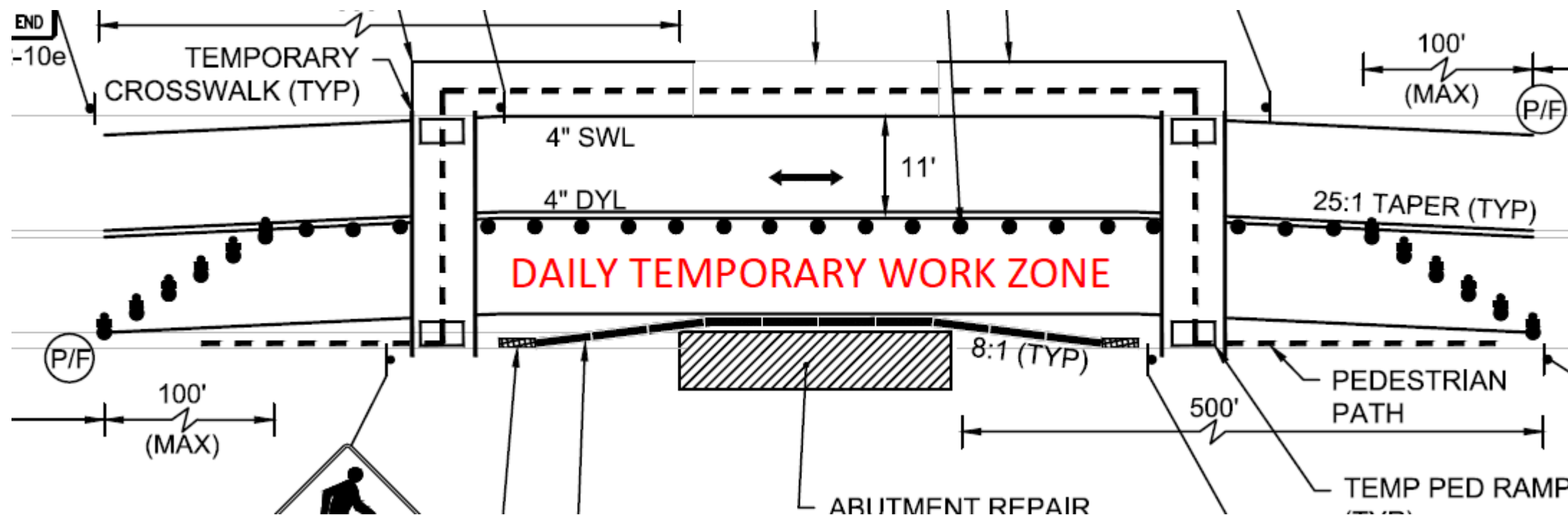

TEMPORARY ONE-WAY ALTERNATING TRAFFIC CONTROL AT ABUTMENT REPAIR LOCATIONS

N.T.S.

Public Participation and Outreach

- Early Action Advisories
 - Utility Relocation (Flanders Rd)
 - Median Barrier Replacement (I-90 ROW)
- Dedicated Project Website
 - www.mass.gov/Acceler8Bridges
- Email Advisories for Traffic Impacts with Advance Notice
- Comprehensive Email Contact List
 - Email Contact List includes other area projects, Chambers, TMAs, trucking and travel industries, local and regional elected officials, town departments, etc.
- Public Information Meeting
 - February 9, 2021
- Construction Kickoff Public Meetings in April and May
 - Prior to start of major construction activities
- Briefings

Public Outreach Tools



Twitter



E-Mail



Community Calendar



Website



Advertisements



Television



Fact Sheets



Public Meetings



Newspaper

How to Reach Us

For questions, comments, and concerns:

Email us at A8@dot.state.ma.us

For project updates and more information:

Visit the website at <http://www.mass.gov/Acceler8Bridges>, where you can also sign up for the project email list to receive meeting notices and advisories.

Closing Remarks

- MassDOT **D-B Experienced Management Personnel**
 - I-93 Fast-14, Cedar St Bridge, Longfellow Bridge
 - Empowering Key People
 - Effective and Quick Issue Resolution
- Including Safety in the Planning
- ABC Sequence insuring **more Reliable Weekend Schedules**
- Experienced implementation of **Incident Action and Contingency Plans**
- Evaluated, understood and **Addressed all Risks**

Our team's experience on I-93 Fast 14 has informed our plan for the Acceler-8 project.



Questions & Answers

Q+A After Presentation

*If you are joining via phone only, you may press *9 to raise your hand.*

- Please share only one question or comment at a time.
- Use the **Q&A** button to submit a typed question or comment.
- Press the **RAISE HAND** button to share your question or comment verbally. Wait for the moderator to recognize you and unmute you before speaking.

You can always send questions and comments to A8@dot.state.ma.us

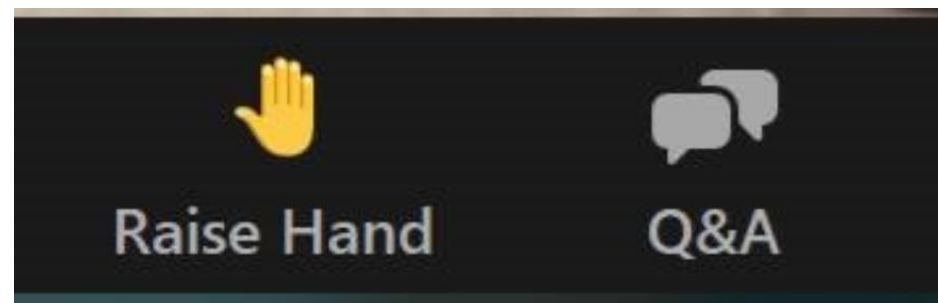



Thank you!

Email us at A8@dot.state.ma.us

Visit the project website: www.mass.gov/Acceler8Bridges