



ALLSTON MULTIMODAL TRANSPORTATION PROJECT

Task Force Meeting

November 13, 2025

Zoom Controls



- Drop down menu to check microphone and speakers



- Ask a question and share comments; Alt+H



- Raise your hand – *9 for users dialing in; Alt+Y



Live Transcript

- Closed captioning is automatically generated by ZOOM



- If you are unable to access the internet or are having technical problems, please call into the meeting at 305-224-1968, Meeting ID: 814 3273 9106 Passcode: 100287



- Ask for support from the Virtual Public Involvement team



If you have trouble with the meeting technology during the presentation, please call:

1-888-799-9666



Unmute



Start Video



Q&A



Participants



Chat



Live Transcript



Reactions

Public meeting notes and procedures:

Notification

- While this virtual public meeting is not being recorded, the Massachusetts Department of Transportation may choose to retain and distribute images, reports, and/or the Q/A transcript.
- All parts of this meeting are considered public record.
- If you are not comfortable being part of the official record, please refrain from utilizing the Q/A feature, turn off your camera, and keep your microphone muted, or you may choose to excuse yourself from the meeting.

Important notes

- Your microphone is automatically disabled upon entering the meeting.
- The meeting will be open to questions and answers at the end of the formal presentation, with opportunities to ask questions after each of the updates as well.
- Task Force members will be prioritized for questions and comments

All questions and comments are welcome and appreciated, however we do request that you refrain from any disrespectful comments.

Notice of MassDOT's policy on diversity and civil rights:

- All MassDOT activities, including public meetings, are free of discrimination.
- MassDOT complies with all federal and state civil rights requirements preventing discrimination based on sex, race, color, ancestry, national origin (limited English proficiency), religion, creed, gender, sexual orientation, gender identity or expression, or veteran's status.
- We welcome the diversity from across our entire service area. If you have any questions or concerns, please visit <https://www.mass.gov/nondiscrimination-in-transportation-program> to reach the Office of Diversity and Civil Rights.

Thank you for joining our meeting. We appreciate your participation!

Share Your Questions and Comments



- Submit your questions and comments
- “Raise your hand” to be unmuted for verbal questions
- Please state your name before your question
- Please share only **1** question or comment at a time, limited to **2** minutes, to allow others to participate.
- To ask a question via phone, dial *9 and the moderator will call out the last 4-digits of your phone number and unmute your audio when it is your turn.

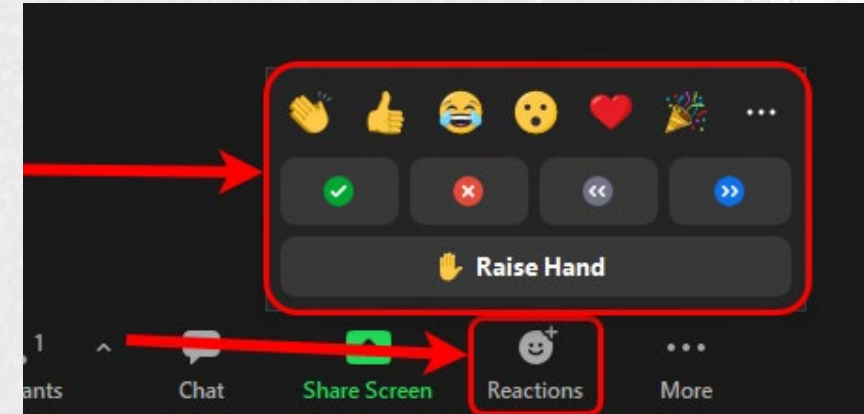

Please be advised that all comments are subject to disclosure for public records, therefore use these functions for project-related business only.

Today's Agenda



- **Welcome/Introductions**
- Project Update
- Early Action Project Considerations/Ideas
- Worcester Regional Research Bureau: "Express for Whom?: Ridership, Recovery, and the Importance of the Worcester/Framingham Line"
- Next Steps

Today's Agenda

- Welcome/Introductions
- **Project Update**
- Early Action Project Considerations/Ideas
- Worcester Regional Research Bureau: "Express for Whom?: Ridership, Recovery, and the Importance of the Worcester/Framingham Line"
- Next Steps

Today's Agenda

- Welcome/Introductions
- Project Update
- **Early Action Project Considerations/Ideas**
- Worcester Regional Research Bureau: "Express for Whom?: Ridership, Recovery, and the Importance of the Worcester/Framingham Line"
- Next Steps

Early Action Project Considerations (1 of 4)



- Early Action Projects:
 - MassDOT and the current Allston design team is investigating focused early action projects
 - Intent is to demonstrate ongoing commitment to improving transportation infrastructure in Allston
 - Projects evaluated will be selected for independent utility, readiness, and compatibility with future Allston Multimodal Transportation Project

Early Action Project Considerations (2 of 4)

- Project Selection Considerations
 - Is there community support for this activity?
 - Are there any permitting actions required?
 - Does the project have independent utility?
 - How is the project potentially funded, Federal, State?
 - Are there ROW actions triggered?
 - How does the item work within the context of the larger AMTP?

Early Action Project Considerations (3 of 4)



- Lincoln Street Noise Barrier
 - MassDOT continues to advance design and utility coordination for a new Noise Barrier along Lincoln Street adjacent to I-90 to reduce traffic noise for nearby homes
 - Design enables a future City of Boston shared-use path through the Allston-Brighton corridor
 - MassDOT is evaluating potential funding through state resources
 - Ongoing regulatory process including outreach to impacted residents 'benefitted receptors' for input on aesthetics and support

Early Action Project Considerations (4 of 4)



- Cambridge Street Bridge Preservation
 - MassDOT is initiating preservation work on the Cambridge Street Bridge which will bring the bridge to improved condition, restore westbound sidewalk and bridge lighting
 - Substructure repair work is ongoing with railroad coordination and night work commencing to repair bearings and replace timber shielding
 - MassDOT is coordinating with City of Boston to obtain necessary BTD permits for construction phasing

Early Action Project Ideas

- Potential Early Action Projects:
 - Task Force ideas/suggestions for early action projects

Today's Agenda



- Welcome/Introductions
- Project Update
- Early Action Project Considerations/Ideas
- **Worcester Regional Research Bureau: “Express for Whom?: Ridership, Recovery, and the Importance of the Worcester/Framingham Line”**
- Next Steps



Express for Whom? Ridership, Recovery, and the Importance of the Worcester/Framingham Line

Report 25-07, June 2025

November 13, 2025



The Research Bureau serves the public interest of Greater Worcester by conducting independent, non-partisan research and analysis of public-policy issues to promote informed public debate and decision-making

- **Collecting Objective & Credible Data**
- **Identifying & Analyzing Greater Worcester's Challenges & Opportunities**
- **Issuing Briefs, Reports, & Visualizations**
- **Conducting Briefings for Interested Stakeholders**
- **Convening Issue Based Forums & Programs**
- **Sharing Research Results via Professional & Social Media**
- **Collaborating With Appropriate Partners**

INTRODUCTION



wrrb.org The Research Bureau

Thank you all for having us today. Special thank you to the Barr Foundation, funding from which has enabled us to do this research

We relied heavily on MBTA, National Transit Database, and Census Sources. Thanks especially to the [MBTA's Open Data Portal](#), the data from which allowed so much of this report to happen

Overall, **ridership is strong on the Worcester/Framingham Line**. Moreover, **onboardings between Worcester and Framingham were strong in Fall 2024**.

With growth in housing around Worcester's Union Station, and an interest in frequent and fast service, we believe there is a lot of **latent demand for increased service** in Worcester and among its neighbors

WORCESTER LINE RIDERSHIP



wrrb.org The Research Bureau

Worcester/Framingham is the second-most ridden line in the system, after Providence (about 14.3% of all riders)

Throughout 2024, **the line averaged about 14,000 riders on weekdays**

Nearly all ridership recovery is due to weekday riders, but weekend ridership is large portion of total: **10-15%/month in 2024**

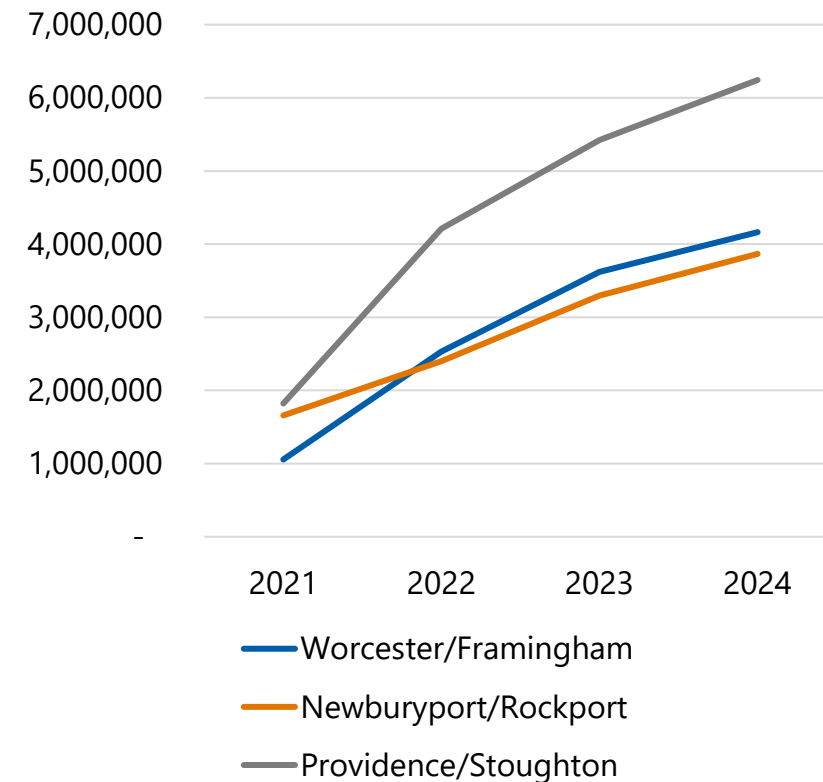

Estimated Yearly Boardings, 2021-2024

MBTA Estimated Boardings, June 2020 through December 2024. Note: 2021 does not include weekend ridership until July.

STATION BOARDING DATA



wrrb.org The Research Bureau

Stop	500	502	504	582	506	584	508	552	586	510	512	514	516	518	520	522	524	526	592	528	594	530	598	532	534	536	538
Worcester	9	64	105	-	123	-	176	100	-	63	51	39	35	78	38	50	26	38	-	27	-	31	-	31	30	12	13
Grafton	4	45	44	-	49	-	71	-	-	46	11	11	9	4	4	5	3	3	-	17	-	6	-	5	0	0	0
Westborough	5	41	25	-	46	-	91	-	-	44	14	9	11	20	8	3	11	8	-	18	-	9	-	2	4	1	0
Southborough	6	48	36	-	46	-	126	-	-	49	11	15	5	8	9	4	3	9	-	18	-	6	-	3	1	1	0
Ashland	3	51	32	-	67	-	129	-	-	57	7	9	0	0	4	2	9	0	-	5	-	3	-	0	0	1	1
Framingham	9	72	59	16	64	46	69	151	34	53	11	20	17	30	14	13	18	11	8	21	7	8	8	5	8	7	1
West Natick	7	48	44	3	77	37	100	-	49	33	10	2	9	20	9	7	14	-	13	-	15	0	3	0	2	1	0
Natick Center	7	11	-	27	-	113	-	-	56	41	9	7	4	4	6	8	11	-	26	-	22	12	2	0	0	2	0
Wellesley Square	2	14	-	46	-	102	-	-	65	7	12	1	1	18	6	47	18	-	24	-	29	12	5	7	10	4	1
Wellesley Hills	2	2	-	28	-	78	-	-	43	8	0	4	6	26	7	7	14	-	12	-	3	9	9	9	5	0	0
Wellesley Farms	4	7	-	36	-	96	-	-	44	16	4	13	1	2	3	0	2	-	3	-	3	2	2	0	1	0	0
Auburndale	0	2	-	26	-	44	-	-	31	16	0	3	-	12	-	-	5	-	-	-	10	-	3	-	1	0	-
West Newton	3	9	-	30	-	78	-	-	43	12	4	2	-	12	-	-	5	-	-	-	12	-	2	-	0	1	-
Newtonville	4	28	-	55	-	122	-	-	78	8	10	7	-	18	-	-	17	-	-	-	6	-	3	-	1	0	-
Boston Landing	5	25	39	106	45	114	56	-	118	33	8	15	5	40	7	16	67	39	39	14	40	4	13	16	5	1	0
Lansdowne	0	13	7	20	16	72	16	22	0	11	10	0	4	12	8	21	27	23	21	9	10	6	0	5	2	2	0
Back Bay	0	4	0	7	7	11	6	1	1	1	14	0	8	8	2	3	14	18	20	4	27	15	0	0	1	0	0
South Station	0	0	0	0	0	0	0	0	0	0	0	0	0	0	0	0	0	0	0	0	0	0	0	0	0	0	0
Train Departing	4:15	5:00	5:45	6:35	6:30	7:25	7:07	7:40	8:15	8:13	9:05	10:00	11:00	12:00	13:05	14:00	15:00	15:47	16:40	16:30	17:20	17:45	18:55	18:35	19:55	20:55	22:50
Train Arriving	5:50	6:36	7:10	7:33	7:56	8:23	8:33	8:45	9:11	9:49	10:43	11:38	12:33	13:38	14:38	15:33	16:39	17:07	17:29	17:50	18:13	19:13	19:48	20:03	21:30	22:30	0:18

Inbound Onboardings, Fall 2024

STATION BOARDING DATA



wrrb.org The Research Bureau

Worcester's Union Station had a remarkable number of onboardings in the Fall 2024 station boarding data

Counting all trains, all day, **15.55% of inbound onboardings occurred in Worcester, more than any other stop**

Nearly 50% of onboardings occurred between Worcester and Framingham

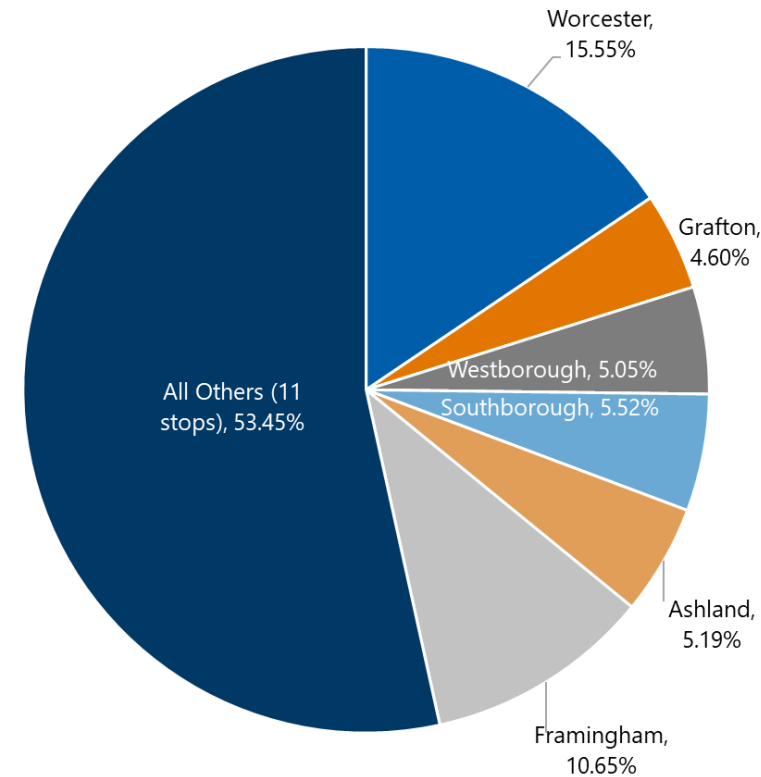

Percent of Inbound Riders, Selected Stops (All Trains)

WHO IS RIDING?



wrrb.org The Research Bureau

According to the 2023 release of the MBTA Passenger Survey,

52.59% of riders are taking it from home to work (compared to 49.95% systemwide)

More than **50% report taking it three to five days per week**, with more riders taking it five days than three to four

44.8% of riders report making 30 to 80% of Area Median Income (AMI), and **11.73% make less than 30% of AMI**

MAPS



www.researchbureau.org The Research Bureau

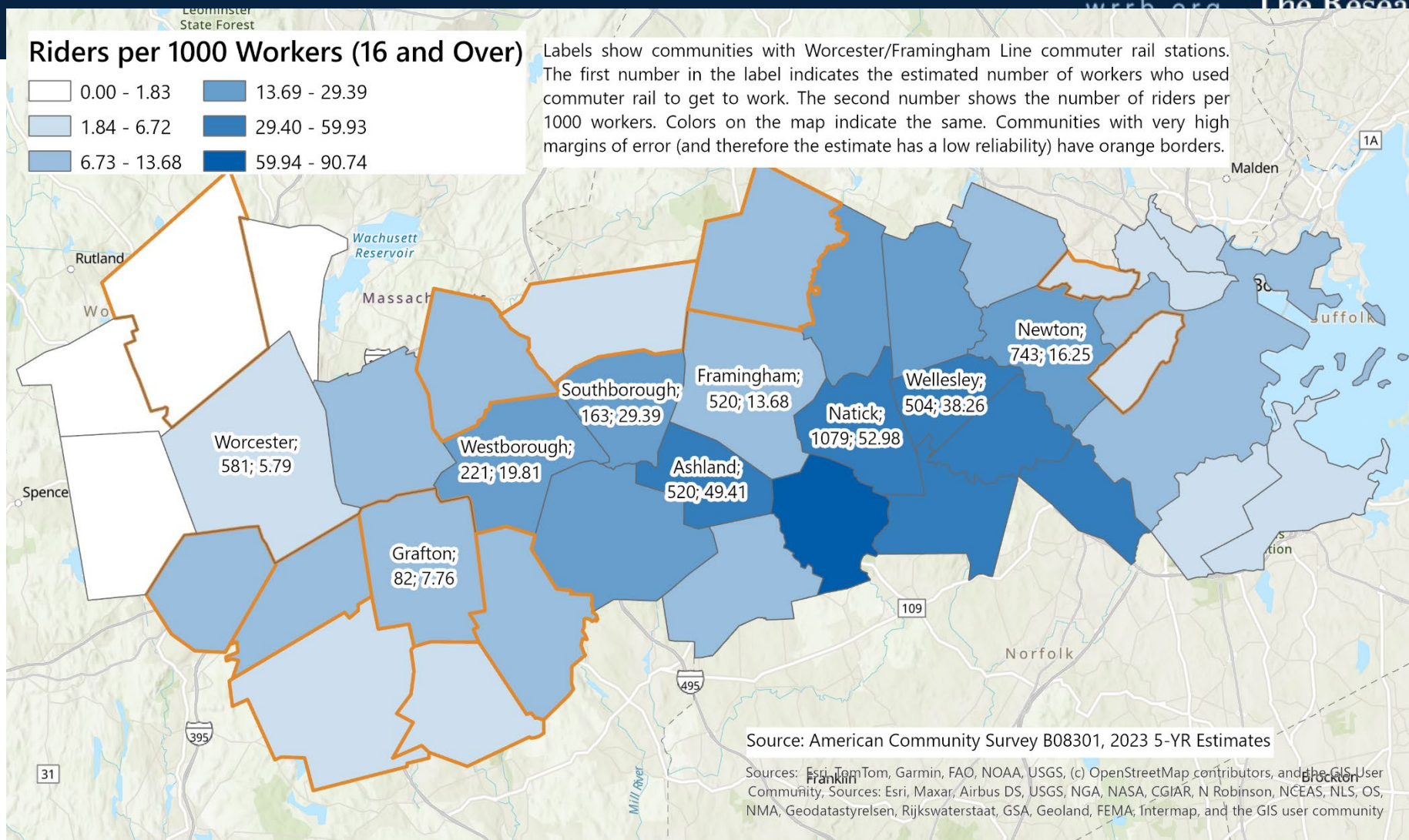

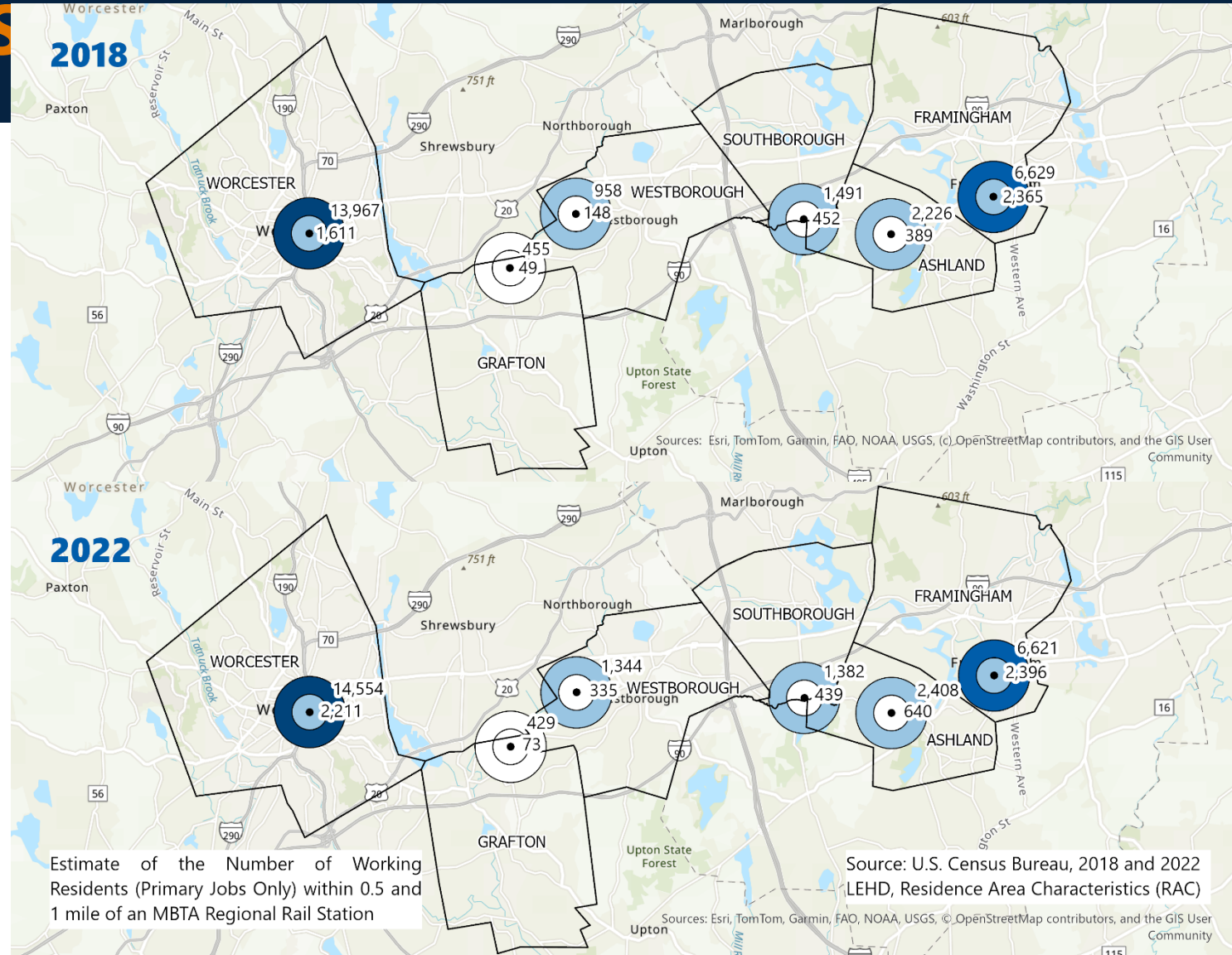

Working Residents (Primary Jobs Only)

CONCLUSIONS



wrrb.org The Research Bureau

There are a significant number of riders getting on at Worcester: with recent housing growth, there is a great potential for more riders.

There is strong ridership at the six westernmost stops on the line: nearly 50% of inbound weekday onboardings occur on just 6 of 17 stops on the line.

Ensuring that these six stops have frequent, speedy, and adequate service is key: with no other easy transit access to Greater Boston, riders (and potential riders) are forced to drive on I-90 when service falls.

The Research Bureau supports dedicated and robust Worcester main line track infrastructure to ensure and maintain adequate and speedy service, and to encourage even more riders.

Be on the lookout for part 2: *The Promises of the Worcester/Framingham Line*

WRRB CONTACT & SOCIAL MEDIA



wrrb.org The Research Bureau

Executive Director & CEO Paul Matthews

pmatthews@wrrb.org

www.wrrb.org / (508) 799-7169

Facebook: **The Research Bureau**

Linked In: **Worcester Regional Research Bureau**

Instagram: **wrrbureau**

YouTube: **TheResearchBureau**

BlueSky: **wrrbureau.bsky.social**

Twitter/X: **@WRRBureau**

Tableau: **TheResearchBureau**

ArcGIS: **wrrb mapping**

Research Ideas: www.wrrb.org/submit-your-idea/

Director of Programs & Operations Eric Kneeland

*Senior Research Associate Josh Boucher
Research Associate Anthony Clough*

***Thanks to leadership and support
from our 13 member Executive
Committee and 110 member Board
of Directors***

Today's Agenda



- Welcome/Introductions
- Project Update
- Early Action Project Considerations/Ideas
- Worcester Regional Research Bureau: "Express for Whom?: Ridership, Recovery, and the Importance of the Worcester/Framingham Line"
- **Next Steps**

Next Steps

- Proposed Upcoming Task Force Meeting Dates:
December 11, January 15, February 26
- Potential Topics at Upcoming Task Force Meetings
 - Project Update (incl. Strategic Review and Layover)
 - Early Action Projects
 - Rail Operations Analysis
 - City of Boston BPY Regional Framework Plan
- Other Suggested Topics for Upcoming Task Force Meetings?

Thank You!

