

dc r



MASSACHUSETTS DEPARTMENT OF  
CONSERVATION AND RECREATION

# Welcome!

## Artesani Parking Lot

Herter Park, Boston, MA

Virtual Public Meeting

October 30th, 2024

6:00 PM to 7:30 PM

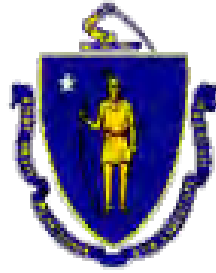

# Commonwealth of Massachusetts

Governor

**Maura T. Healey**

Lieutenant Governor

**Kimberly Driscoll**

Energy and Environmental Secretary

**Rebecca L. Tepper**

Department of Conservation and Recreation Commissioner

**Brian Arrigo**

## Meeting Logistics

- Two ways to ask questions during the Q&A portion of the meeting:
  - Raise your hand
  - Use chat feature
- You will have the opportunity to submit comments over the course of the next two weeks at:
  - DCR Public Comments  
<https://www.mass.gov/forms/dcr-public-comments>
- *Please note that this meeting will be recorded; the recording will be a public record*



MASSACHUSETTS DEPARTMENT OF  
CONSERVATION AND RECREATION

## DCR Mission

*To protect, promote, and enhance our  
common wealth of natural, cultural, and  
recreational resources for the well-being of all.*

# Agenda

1. Welcome
2. Purpose
3. Project Background and Process
4. Walkthrough of Design Layout
5. Public Comment
6. Next Steps

# Contents

Existing Site  
Conditions

Site Design

Stormwater  
and Landscape  
Design &  
Utilities Design



# Site Design

# Relevant Master Plan Project Goals



**1** Enhance public access to recreation along the riverbank



**2** Improved stormwater management, water quality, and climate resiliency



**3** Improve visitor experience, wayfinding, and visitor comfort amenities



# Master Plan Design Directive

- A main entry that aligns with Everett Street
  - Location based on Everett Street Signal plans developed for Soldier's Field Road diet
- Enhance pedestrian and bicycle access and circulation
- More green space
- Improve stormwater management
- Improve electrical infrastructure
- Electrical vehicle accommodations
- Provide boat trailer access and storage during the Head of the Charles regatta

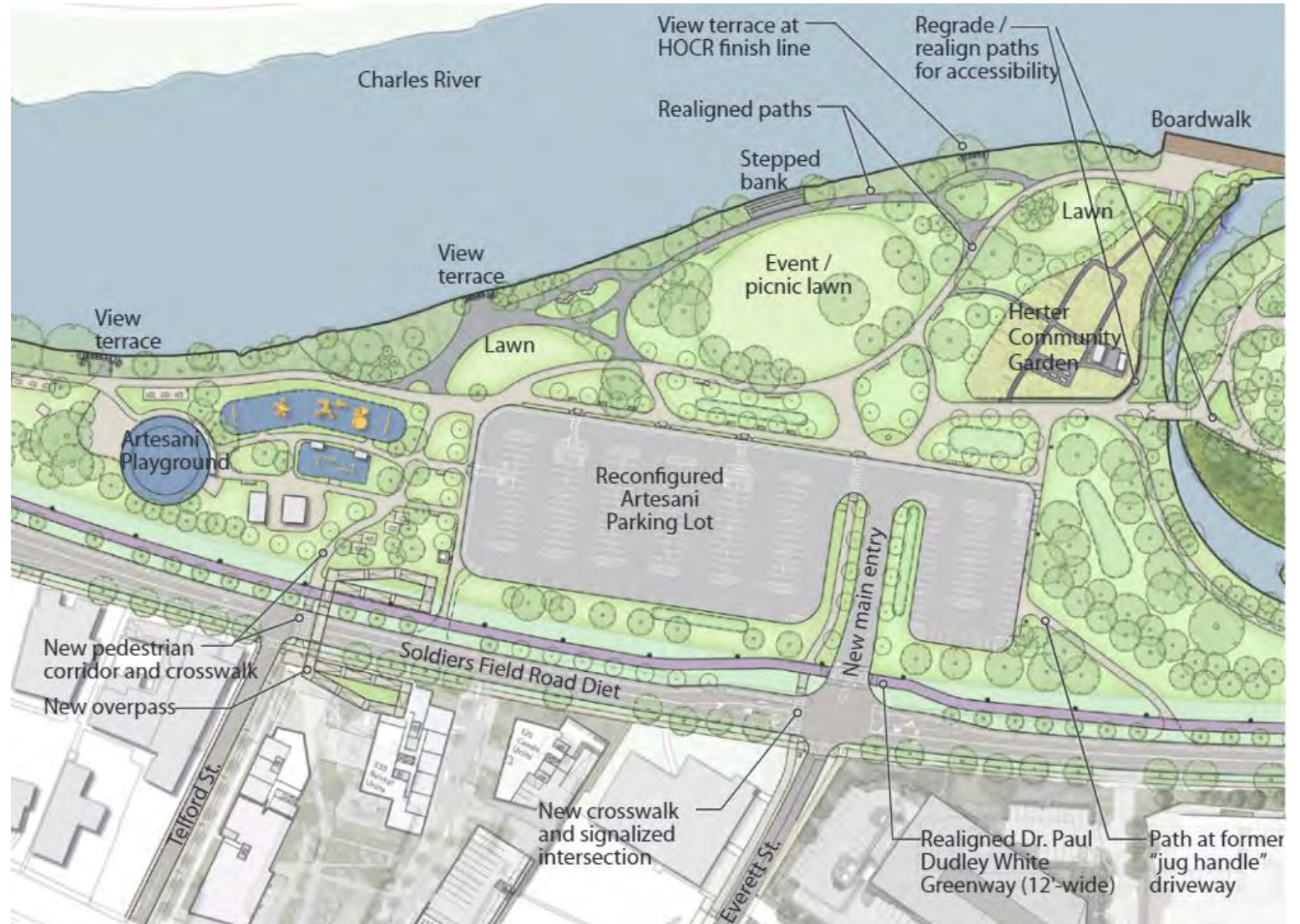



# Original Concept Design

- Compact design
- 232 total spaces
- Split lot design
- Large center landscape island for stormwater management

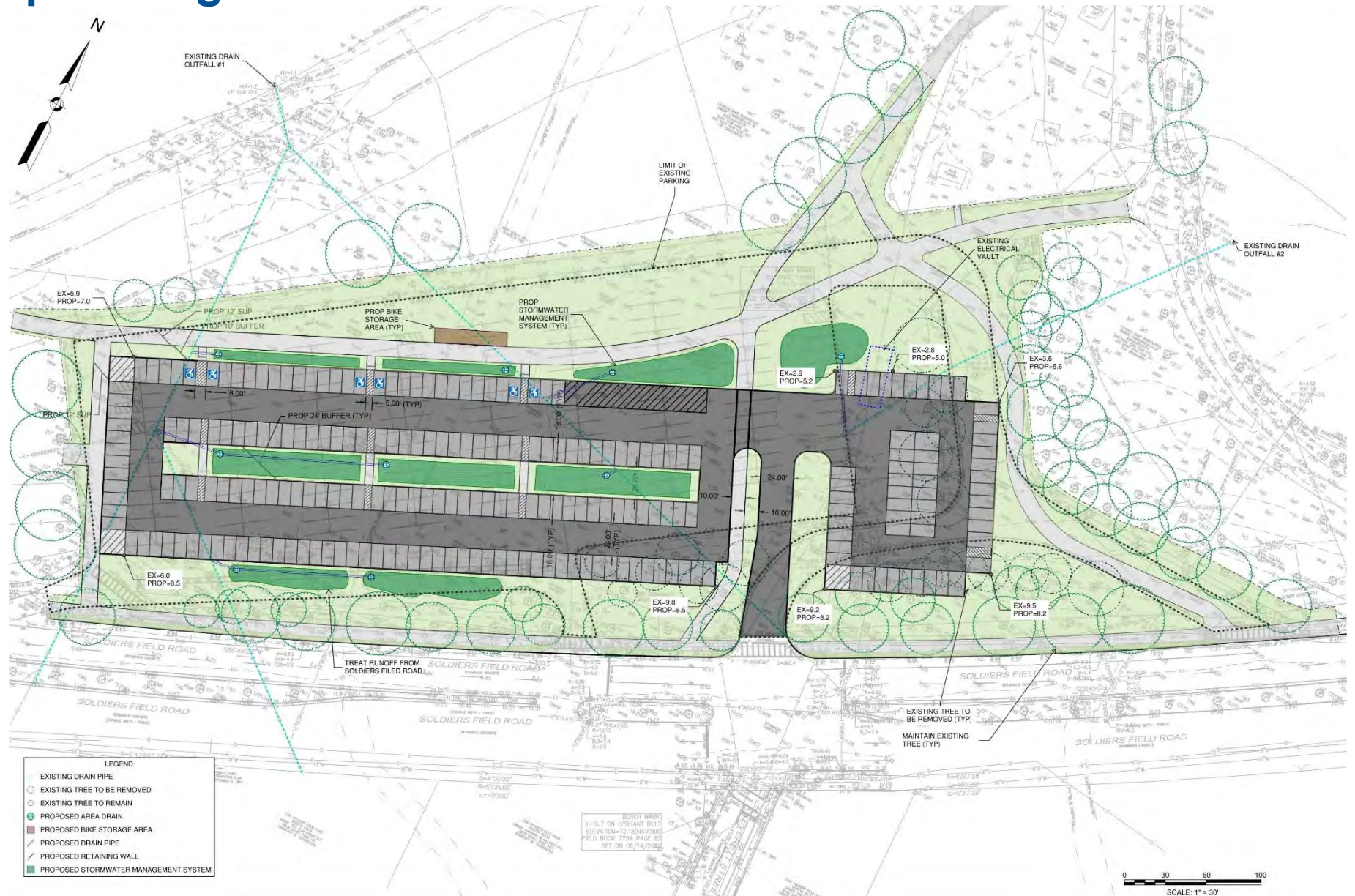



# Public Comments

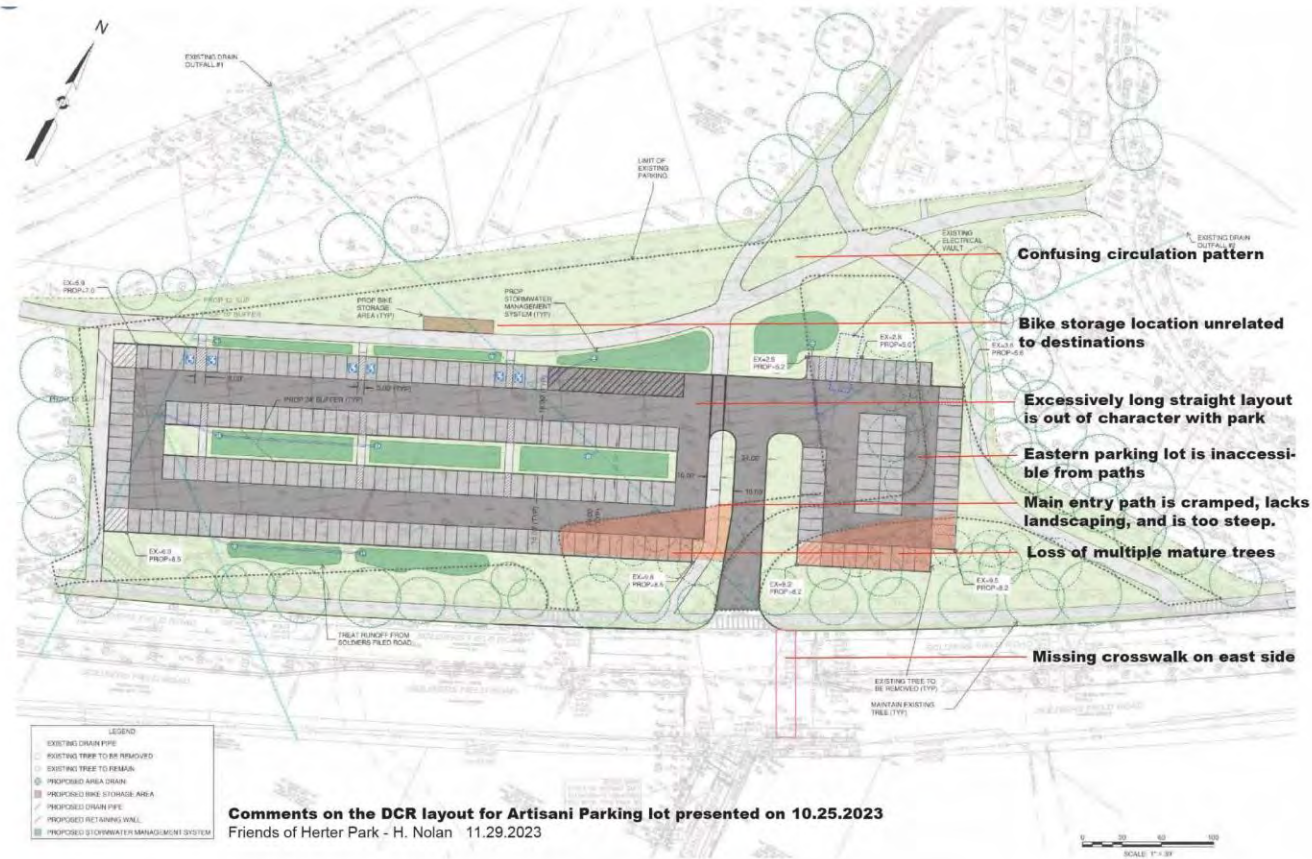

## Summary of Comments:

1. Confusing circulation patterns that lack connection to parking.
2. Overall layout is too “rectilinear”, and should be more influenced by Landscape Architect.
3. Excessive loss of trees near SFR.
4. Consider 4<sup>th</sup> Crosswalk on east side.
5. Maintain access for HOVR.
6. Restrict Parking Lot Use.

# Public Suggestions

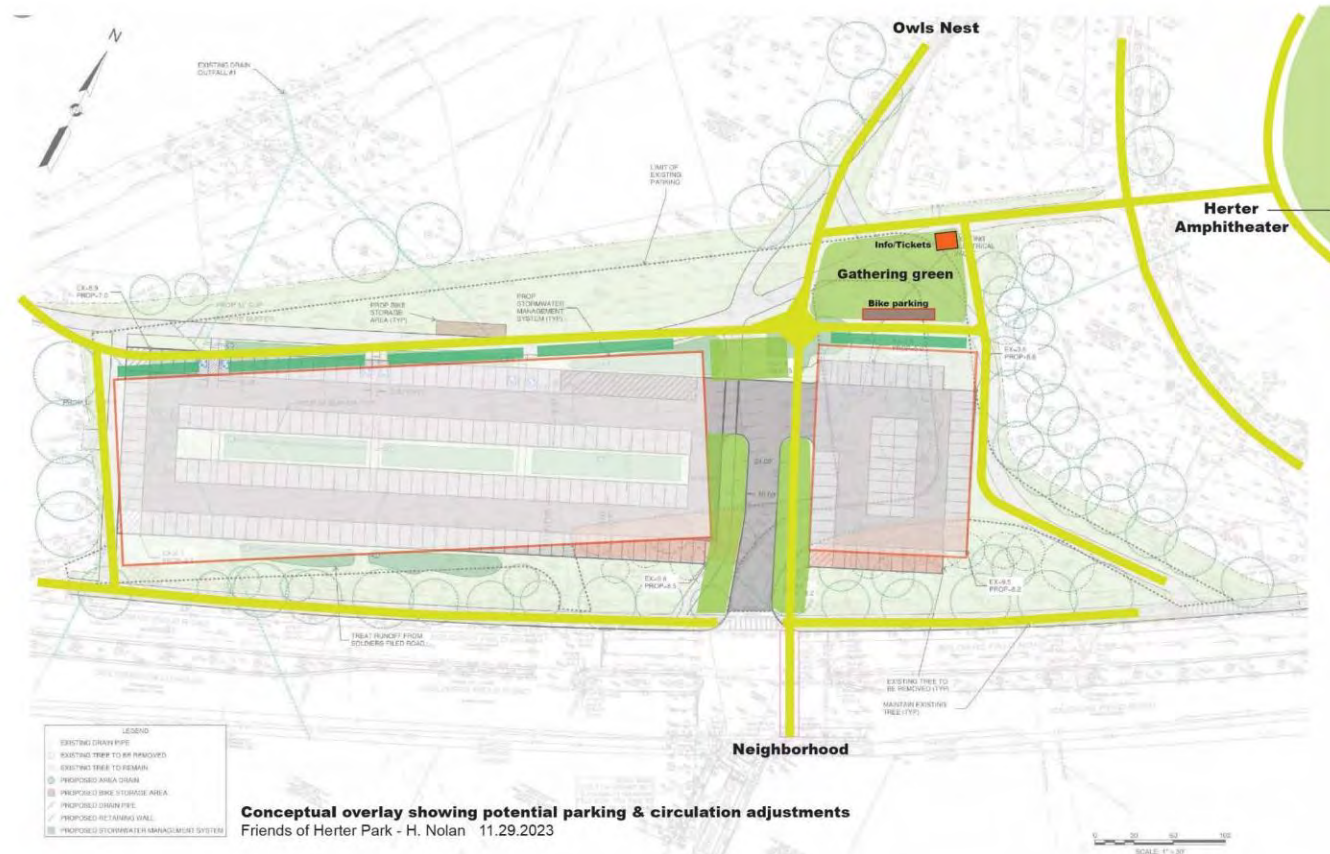

Some Suggestions:

1. Dignify Entrance with more green space.
2. Simplify & Separate Pedestrian Paths.
3. Keep Pedestrian Paths close to parking.
4. Rotate Parking Lot to save trees along SFR.
5. Keep parking close to Community Garden.
6. Maintain maintenance access to AMP and Community Garden.



# Revised Concept Design

216 total spaces  
10 accessible spaces

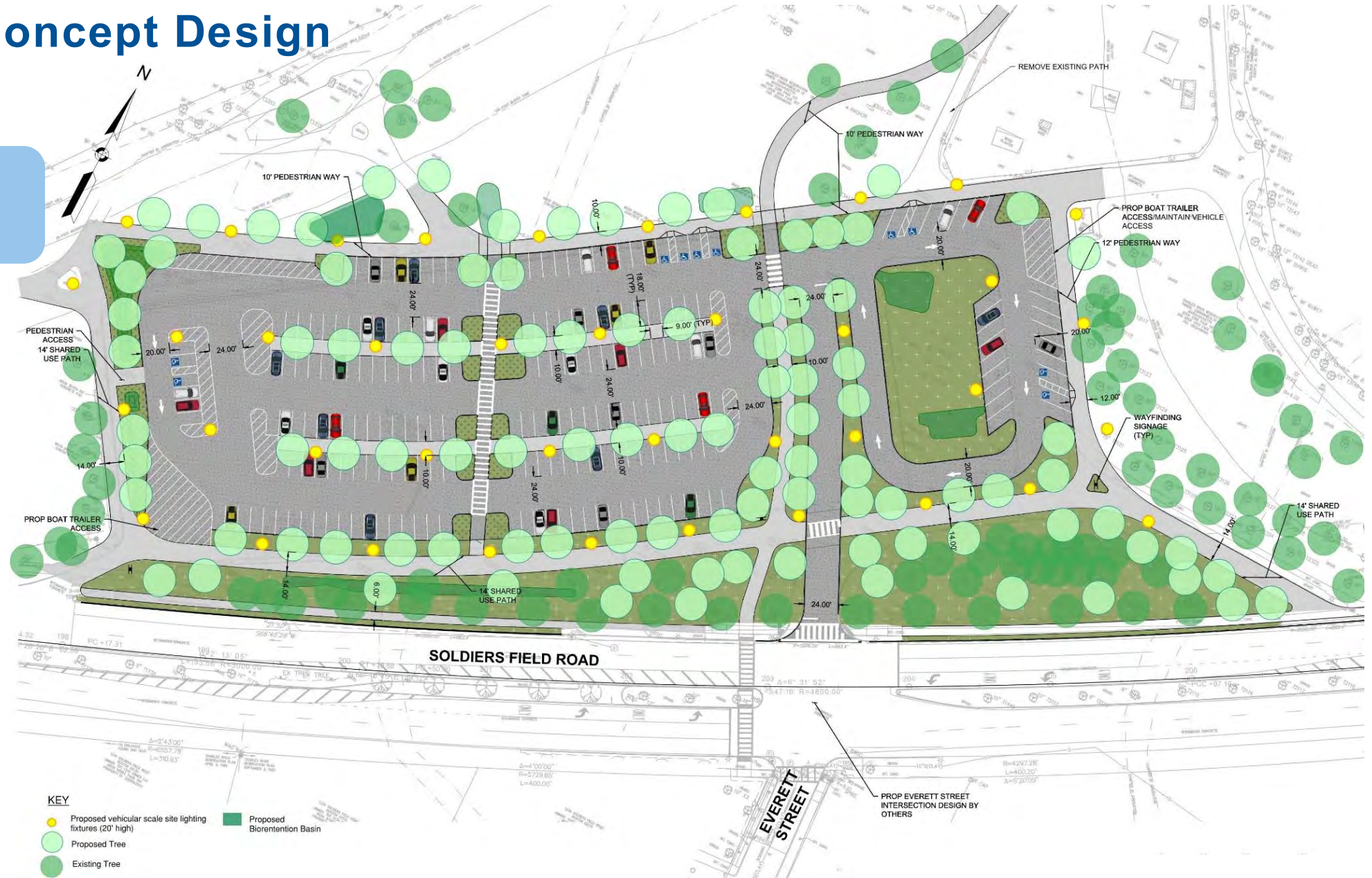



# Revised Concept Design

## Bicycle and Pedestrian Accommodations

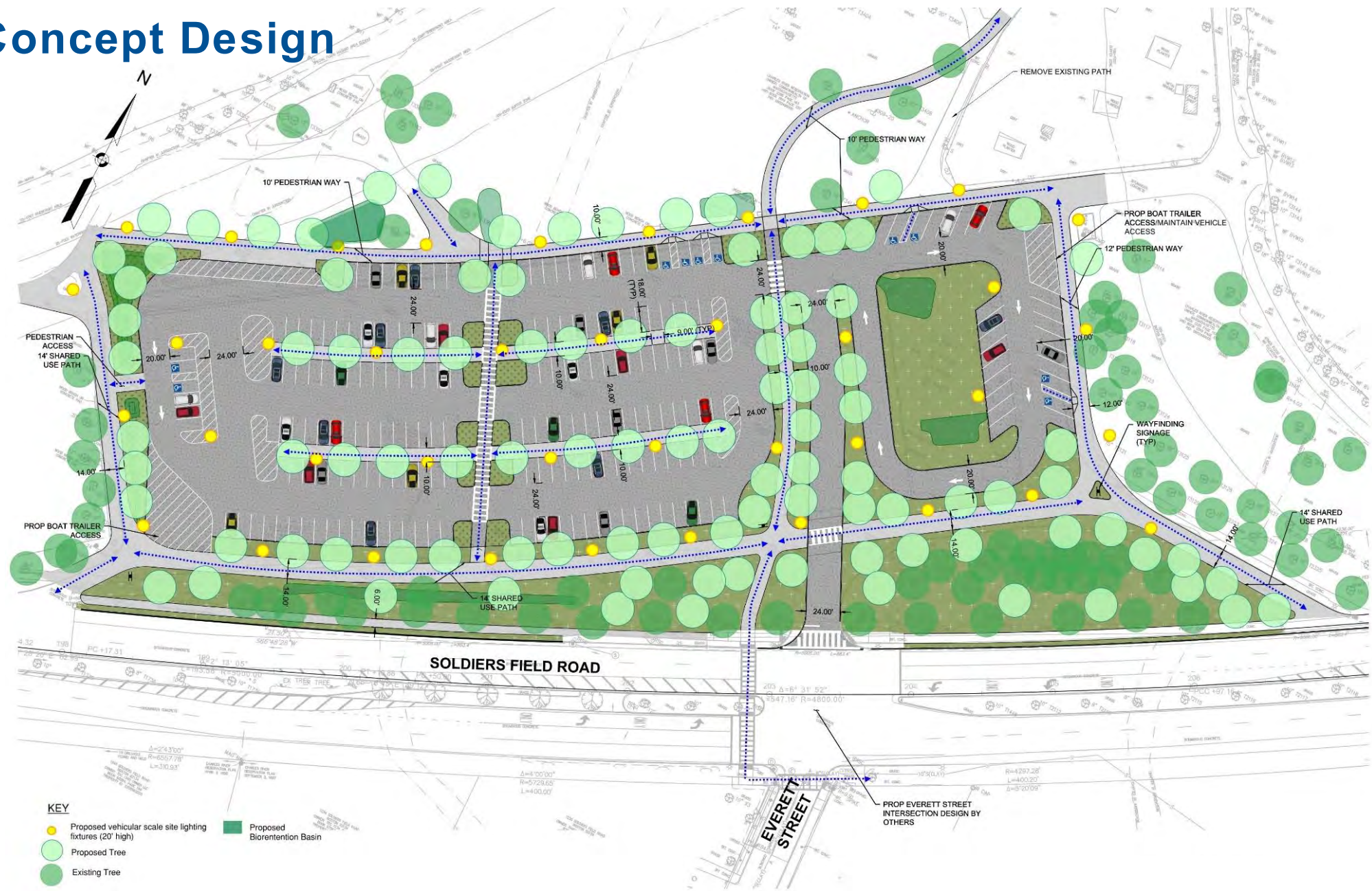







# Electrical Accommodations

## Electric Vehicle accommodations

- Meet needs of current vehicles
- Design infrastructure for future EV regulations

## Burying overhead electrical lines

- Improved views and sightlines
- Improved resilience







# Stormwater and Landscape Design & Utilities Design



# Current Day Flood & Drainage Issues

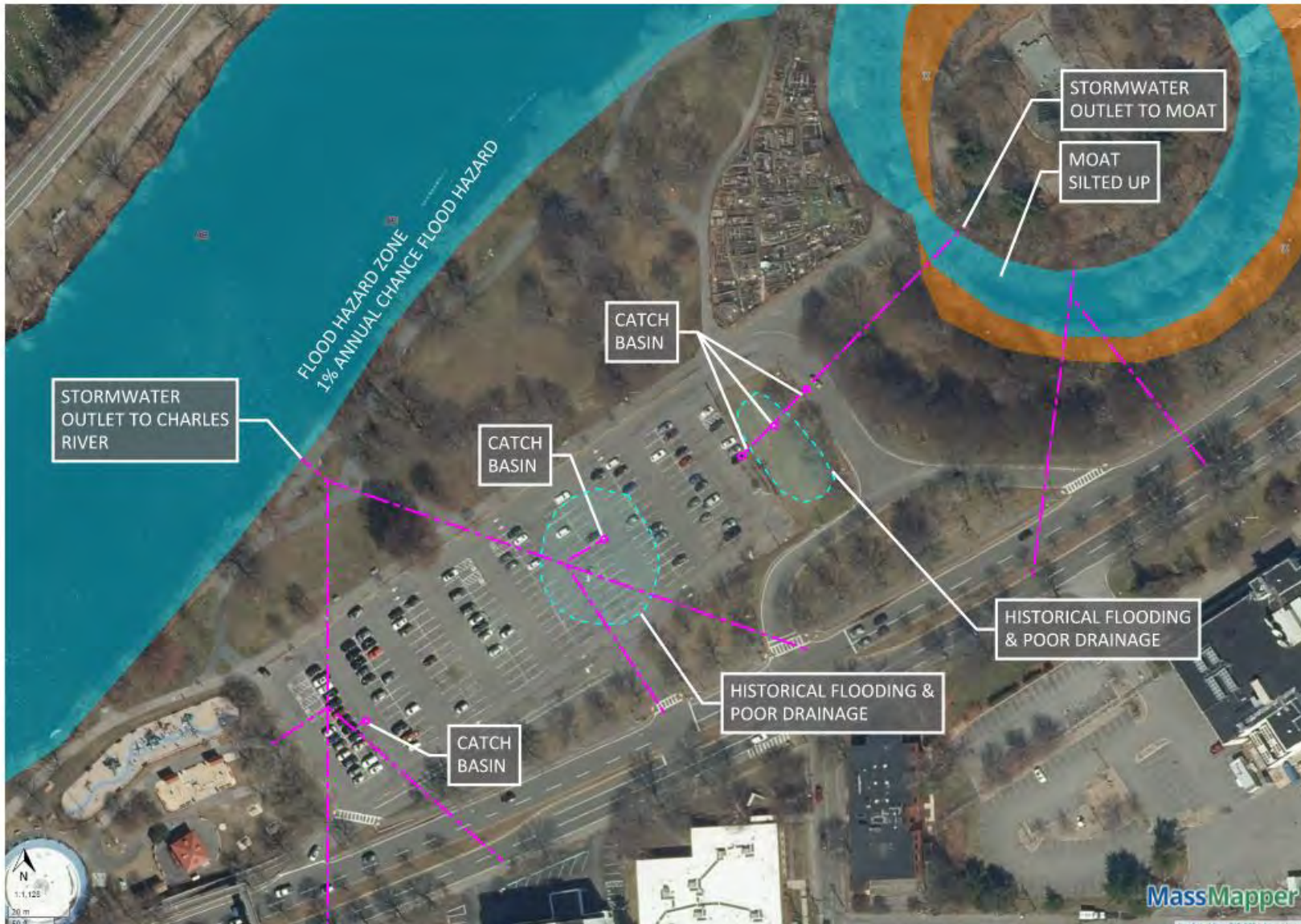

## Parking Lot Flooding

Ponding at parking lot low points, drainage system is surcharged

## Moat Sedimentation

Discharge of Untreated Stormwater to Charles River



# Analyze Adding Drainage to Moat



# Performed Stormwater Assessment

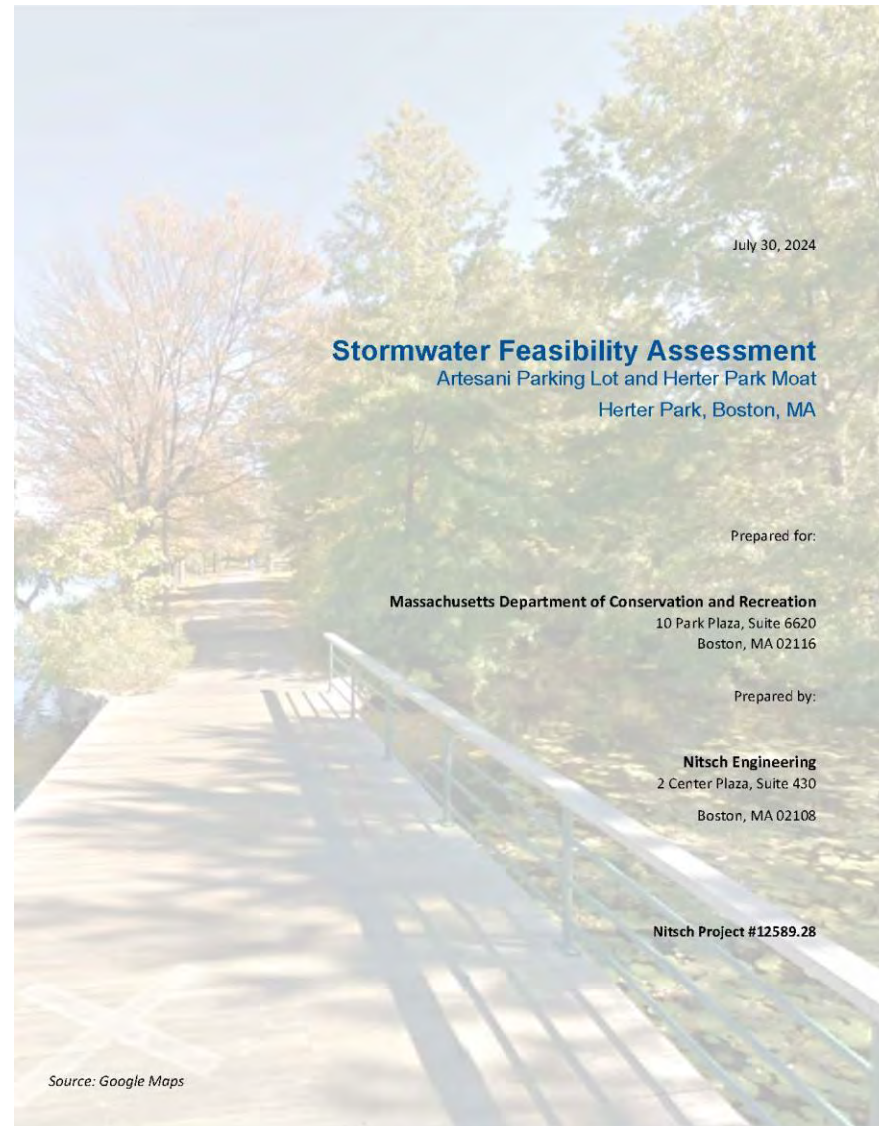



# Stormwater Management Design

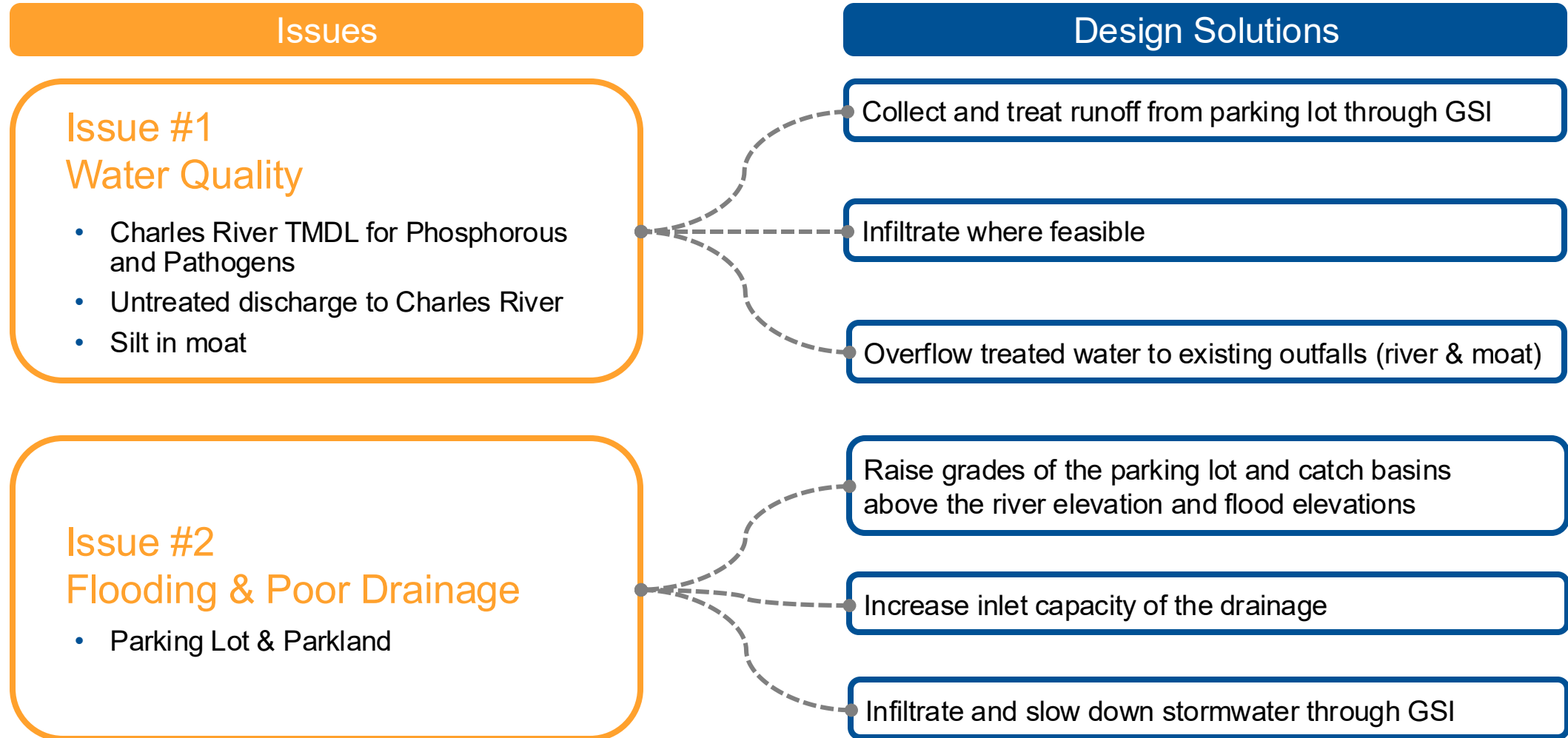

# Stormwater Design

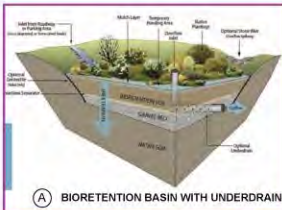

A BIORETENTION BASIN WITH UNDERDRAIN



B OVERFLOW TRENCH DRAIN



C SEDIMENT FOREBAY WITH CURB CUT INLET (EXAMPLE)

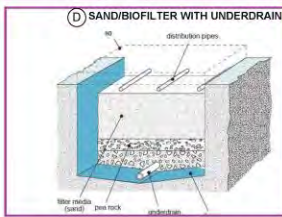

D SAND/BIOFILTER WITH UNDERDRAIN



E MANUFACTURED MODULAR WETLAND SYSTEM (EXAMPLE)

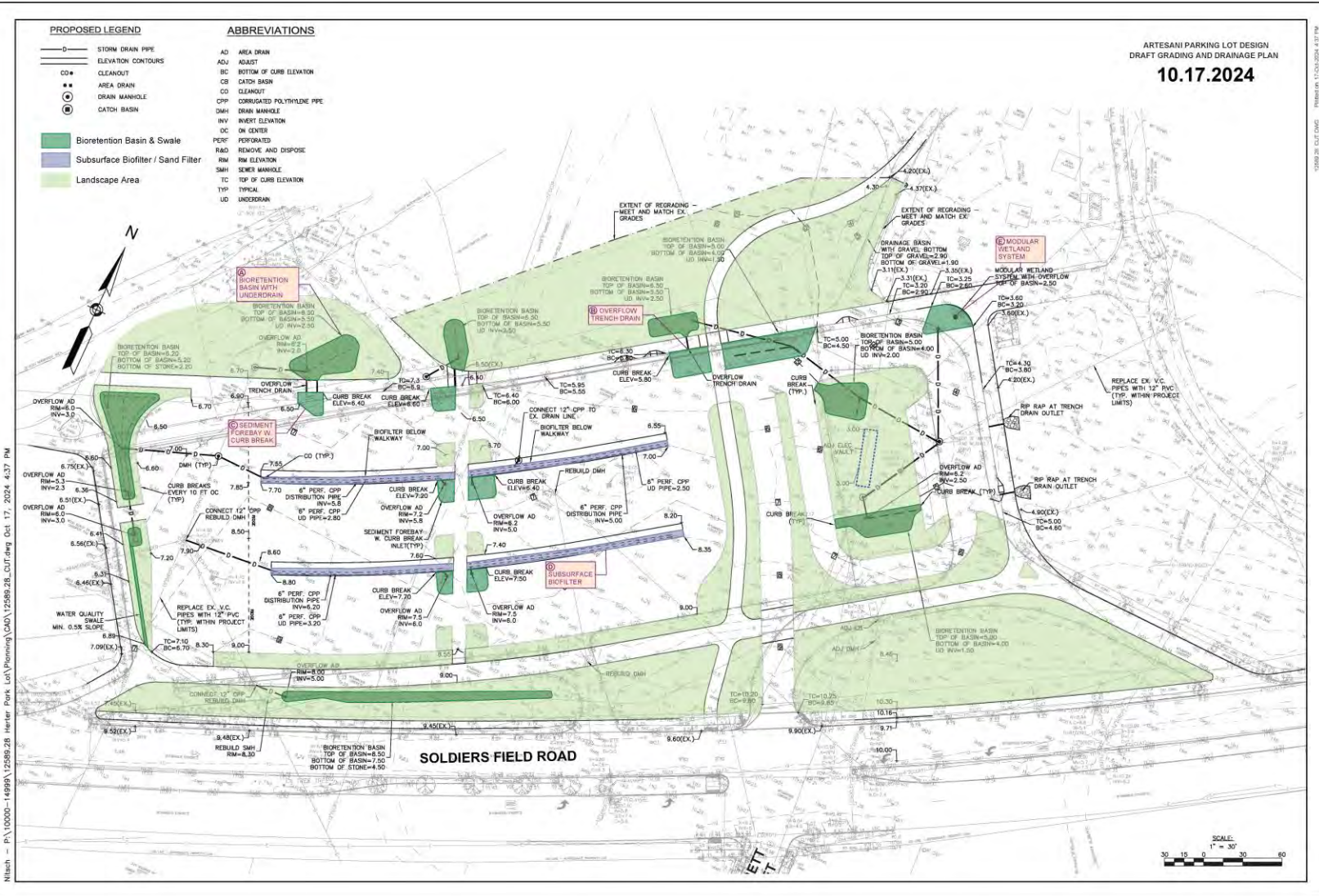



# Potential Plant Palette – Roadside Trees & Shrubs

<u>Botanical name</u>	<u>Common name</u>
<u>Trees</u>	
<i>Acer rubrum</i>	Red maple
<i>Amelanchier canadensis</i>	Shadblow serviceberry
<i>Platanus occidentalis</i>	Sycamore
<i>Quercus bicolor</i>	Swamp white oak
<i>Quercus rubra</i>	Northern red oak
<i>Ulmus americana</i> (variety)	American elm

<u>Shrubs</u>	
<i>Alnus incana</i>	Speckled alder
<i>Aronia arbutifolia</i>	Red chokeberry
<i>Cephalanthus americanus</i>	Buttonbush
<i>Clethra alnifolia</i>	Sweet pepperbush
<i>Cornus amomum</i>	Silky dogwood
<i>Ilex glabra</i>	Inkberry
<i>Ilex verticillata</i>	Winterberry
<i>Lindera benzoin</i>	Common spicebush
<i>Sambucus canadensis</i>	Common elderberry
<i>Viburnum dentatum</i>	Arrowwood
<i>Viburnum trilobum</i>	American cranberrybush





# Potential Plant Palette – Bioretention Basins

<u>Botanical name</u>	<u>Common name</u>
<b>Herbaceous plants</b>	
<i>Andropogon gerardii</i>	Big bluestem
<i>Asclepias incarnata</i>	Swamp milkweed
<i>Asclepias tuberosa</i>	Butterflyweed
<i>Aster novae-angliae</i>	New England aster
<i>Calamagrostis canadensis</i>	Blue joint grass
<i>Carex lupulina</i>	Hop sedge
<i>Elymus riparius</i>	Riverbank wild rye
<i>Elymus virginicus</i>	Virginia wild rye
<i>Eupatorium maculatum</i>	Joe-pye weed
<i>Eupatorium perfoliatum</i>	Boneset
<i>Euthamia graminifolia</i>	Grass-leaved goldenrod
<i>Iris versicolor</i>	Blue flag iris
<i>Juncus tenuis</i>	Path rush
<i>Panicum virgatum</i>	Switchgrass
<i>Schizachyrium scoparium</i>	Little bluestem
<i>Solidago spp.</i>	Goldenrod
<i>Verbena hastata</i>	Blue vervain
<i>Veronia noveboracensis</i>	New York ironweed





# Proposed Site Lighting



DCR Standard lighting fixture for non-historic parking lots & parkways:

- LEOTEK ARIETA® 18 Architectural LED Area Luminaire
- Potential for solar pole using cylindrical solar collectors



*Solar-powered Light Assembly Sketch*

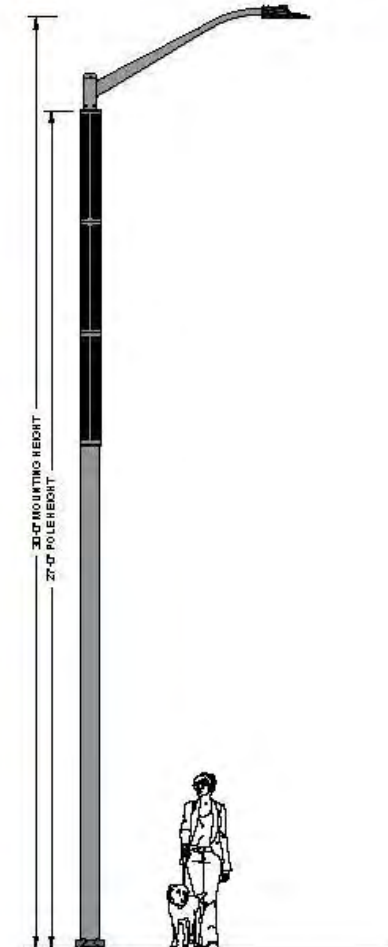

# Proposed Cross Section

SECTION FROM SOLDIERS FIELD ROAD

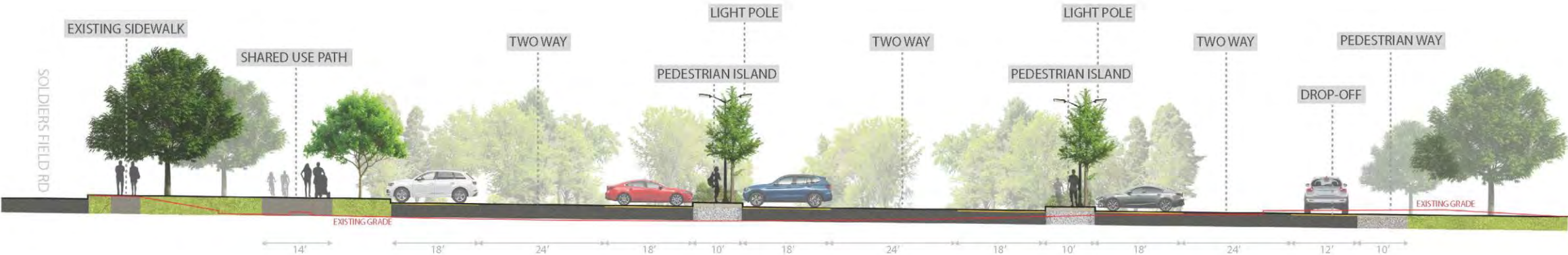

DEPT. OF CONSERVATION & RECREATION  
ARTESANI PARKING LOT, HERTER PARK

PARKING CONCEPTS    SEPTEMBER 2024





## Main Parking Lot Driveway





A serene landscape of a calm river or lake reflecting the surrounding trees and sky, with a green overlay. The text "Thank you! Questions?" is centered in white.

# Thank you! Questions?