

N O T N O T
AMENDMENT TO CONSERVATION RESTRICTION

O F F I C I A L O F F I C I A L

Barnstable County, a political subdivision of the commonwealth of Massachusetts having its principal place of business as Superior Court House, Route 6A, Barnstable, Massachusetts, acting through the Barnstable County Commissioners and the Assembly of Delegates, to the extent that the County holds any and all interest, and their successors and assigns holding any interest in the premises as hereinafter defined (Grantor), and the Town of Bourne, acting by and through its Conservation Commission, a public instrumentality with a principal place of business at Bourne Town Hall, 24 Perry Avenue, Buzzards Bay, Massachusetts, by authority of M.G.L. c. 40 section 8C, its successors and permitted assigns, (Grantee), IN PERPETUITY and exclusively for conservation purposes, hereby AMEND the ORIGINAL CONSERVATION RESTRICTION on a portion of a parcel of land known as the Barnstable County Hospital property, of approximately 50 acres, located in the Town of Bourne, County of Barnstable, Commonwealth of Massachusetts, recorded at Barnstable County Registry of Deeds, Registered Land Department, Certificate No. 18176 on September 1, 2004, said parcel and Amendment being further described in Exhibit A attached (Premises).

The ORIGINAL CONSERVATION RESTRICTION is hereby AMENDED so that item number 11 in A. Prohibited Uses will now read:

11) Animal husbandry is prohibited; gardening or other agricultural uses are also prohibited except in the area designated on Exhibit A, "Sketch Plan", subject to an Eastern Box Turtle protection plan approved by the Division of Fisheries and Wildlife.

In all other respects, the CONSERVATION RESTRICTION remains and is hereby affirmed.

BARNSTABLE COUNTY COMMISSIONERS

At a public meeting duly held on 6/2/2010, the County of Barnstable acting through the Barnstable County Commissioners and the Assembly of Delegates, voted to authorize and approve this Amendment. IN WITNESS WHEREOF, the duly elected Commissioners of Barnstable County have hereunto set their corporate names and seals this 2nd day of JUNE, 2010.

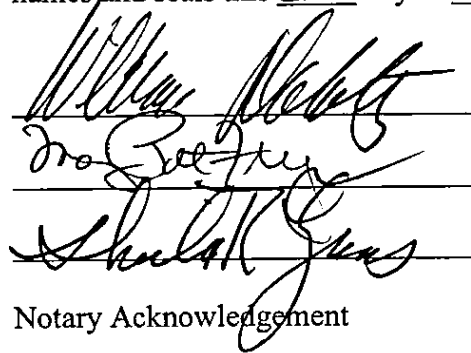
Notary Acknowledgement

Commonwealth of Massachusetts, County of Barnstable:

On this 2nd day of June, 2010 before me personally appeared William Doherty, Mary Pat Flynn, Sheila Lyons proving to me through satisfactory evidence of identification, which was/were personal knowledge to be the person whose name is signed on the preceding or attached document, and acknowledged to me that he signed it voluntarily for its stated purpose as a member of the Barnstable County Commissioners.

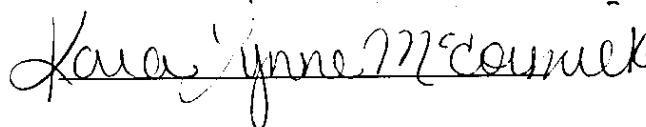

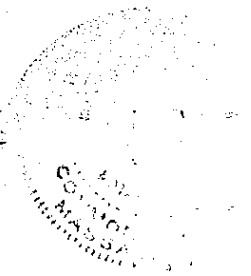

Doc. No. 978790
392 County Rd

At a public meeting duly held on July 1, 2010, the Bourne Conservation Commission voted to authorize and approve this Amendment and by our signatures hereby approve said Amendment, this 1st day of July, 2010.

RM Gray
Paul R. Lyle
Robert J. [Signature]

AN OFFICIAL COPY

[Signature]
Elizabeth R. Kibuka
Susan J. Miller

AN OFFICIAL COPY

Notary Acknowledgement

Commonwealth of Massachusetts, County of Barnstable:

On this 1st day of July, 2010 before me personally appeared Robert Gray proving to me through satisfactory evidence of identification, which was/were personally known to me to be the person whose name is signed on the preceding or attached document, and acknowledged to me that he signed it voluntarily for its stated purpose as a member of the Bourne Conservation Commission.

~~namu / Lindman~~
Notary Public
my Comm. Exp. - 1.11.12



APPROVAL BY SELECTMEN

We, the undersigned, being a majority of the Selectmen of the Town of Bourne, Massachusetts, hereby certify that at a meeting duly held on July 27, 2010 the Selectmen voted to approve the foregoing Amendment pursuant to MG L. Chapter 184, Section 32.

John a Ford
Dear friend
May 2003
USA
James Stoner

Notary Acknowledgement

Commonwealth of Massachusetts, ^{N O T} ~~County~~ of Barnstable: ^{A N}

On this 27th day of July, 2010 before me personally appeared John Ford proving to me through satisfactory evidence of identification, which was/were personally known to me to be the person whose name is signed on the preceding or attached document, and acknowledged to me that he signed it voluntarily for its stated purpose as a member of the Town of Bourne Board of Selectmen.

^{O F F I C I A L}
^{C O P Y}

^{O F F I C I A L}
^{C O P Y}

Notary Public
Mu Com Sup 1.11.13

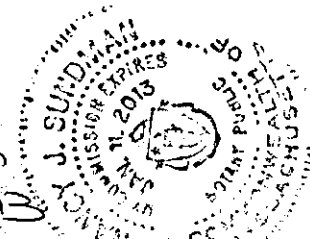

**APPROVAL BY SECRETARY OF ENERGY AND ENVIRONMENTAL AFFAIRS
COMMONWEALTH OF MASSACHUSETTS**

The undersigned, Secretary of the Executive Office of Energy and Environmental Affairs of the Commonwealth of Massachusetts, hereby certifies that the foregoing Conservation Restriction has been approved in the public interest pursuant to M.G.L., Chapter 184, Section 32.

Date: Aug 4, 2010

Ian Bowles, Secretary of Energy and Environmental Affairs

COMMONWEALTH OF MASSACHUSETTS

County of Suffolk, ss:

On this 4th day of August, 2010, before me, the undersigned notary public, personally appeared Ian A. Bowles proved to me through satisfactory evidence of identification which was personal knowledge to be the person whose name is signed on the preceding or attached document, and acknowledged to me that he signed it voluntarily for its stated purpose as Secretary of Energy and Environmental Affairs for the Commonwealth of Massachusetts.

Nicole Sicard
Com Expires 12/15/2011

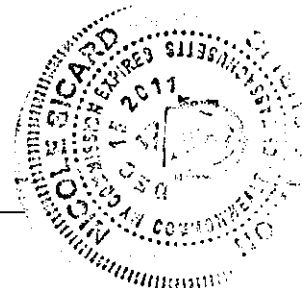
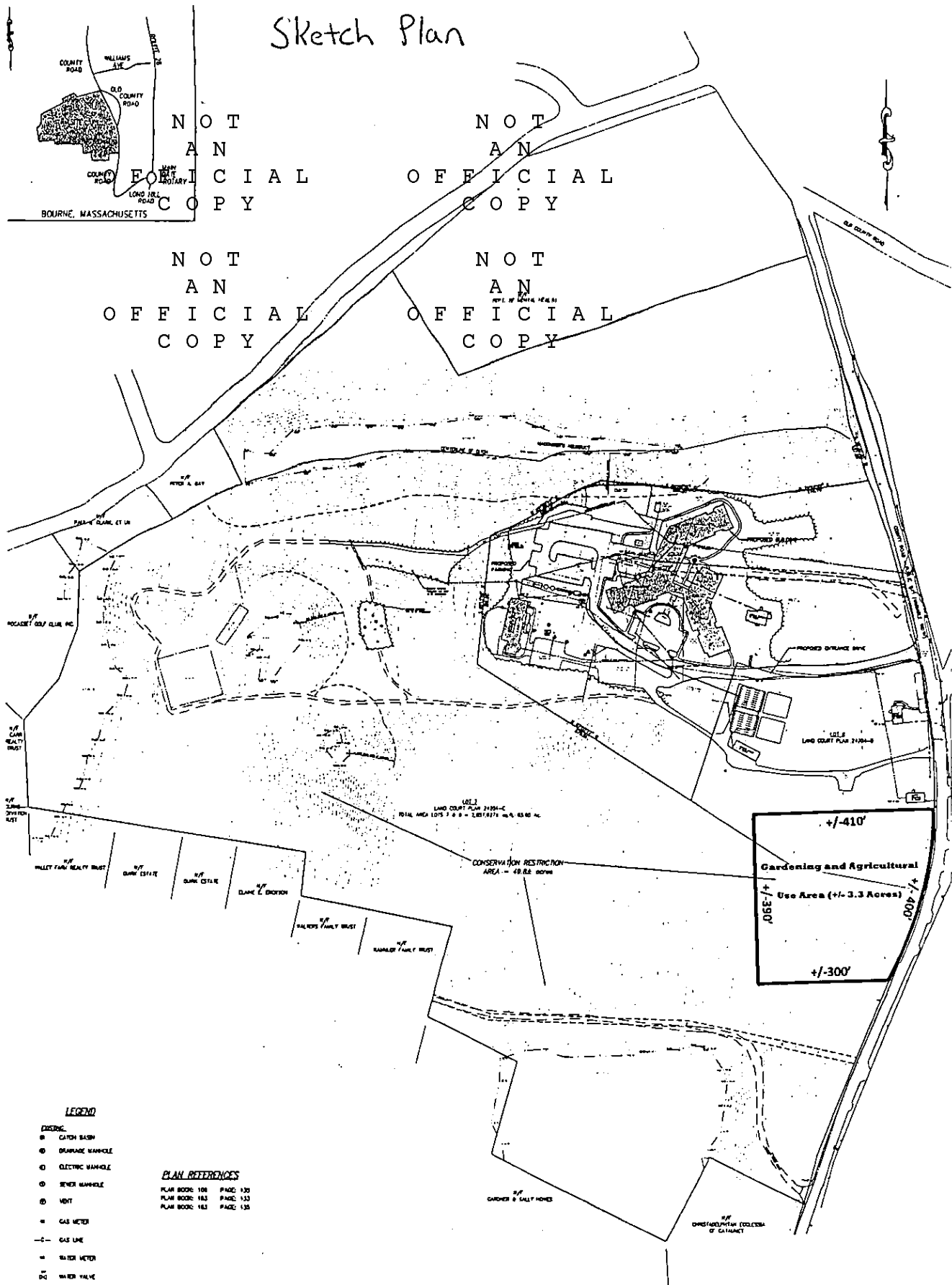

EXHIBIT A

A description of the area that may be used for gardening or other agricultural uses is shown on the attached copy of a plan entitled "Conservation Restriction Plan Pocasset Assisted Living Scale 1" = 100' Bourne, Massachusetts April 16, 2003" prepared by Coastal Engineering Co., recorded with the Barnstable County Registry of Deeds at Plan Book Plan , ("Sketch Plan") on which the area on which such use is allowed has been drawn and labeled as "Gardening and Agricultural Use Area".

Sketch Plan



LEGEND

- EXISTING
- ① CATCH BASIN
- ② DRAINAGE MANHOLE
- ③ ELECTRIC MANHOLE
- ④ SEWER MANHOLE
- ⑤ VENT
- ⑥ GAS METER
- ⑦ GAS LINE
- ⑧ WATER METER
- ⑨ WATER VALVE
- ⑩ MISC. SIGN
- ⑪ UTILITY POLE
- ⑫ LIGHT POLE
- ⑬ CONCRETE POST
- ⑭ CONTROLLER
- ⑮ STOCKADE FENCE
- ⑯ POST & RAIL FENCE
- ⑰ CONCRETE BOARD
- ⑱ MONITORING WELL
- ⑲ BROWN MARK
- ⑳ EDGE OF PAYMENT

PLAN REFERENCES

PLAN BOOK 108 PAGE 130
PLAN BOOK 183 PAGE 133
PLAN BOOK 183 PAGE 135

BARNSTABLE REGISTRY OF DEEDS

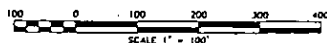

COASTAL ENGINEERING CO.
ENGINEERS & LAND SURVEYORS
200 GRAMMERY HIGHWAY
ORLEANS, MASS. 02653
(508) 255-6511

CONSERVATION RESTRICTION PLAN
POCASSET ASSISTED LIVING
SCALE 1" = 100'
BOURNE, MASSACHUSETTS
APRIL 16, 2003