

PROPOSED PROJECT | CONTEXT

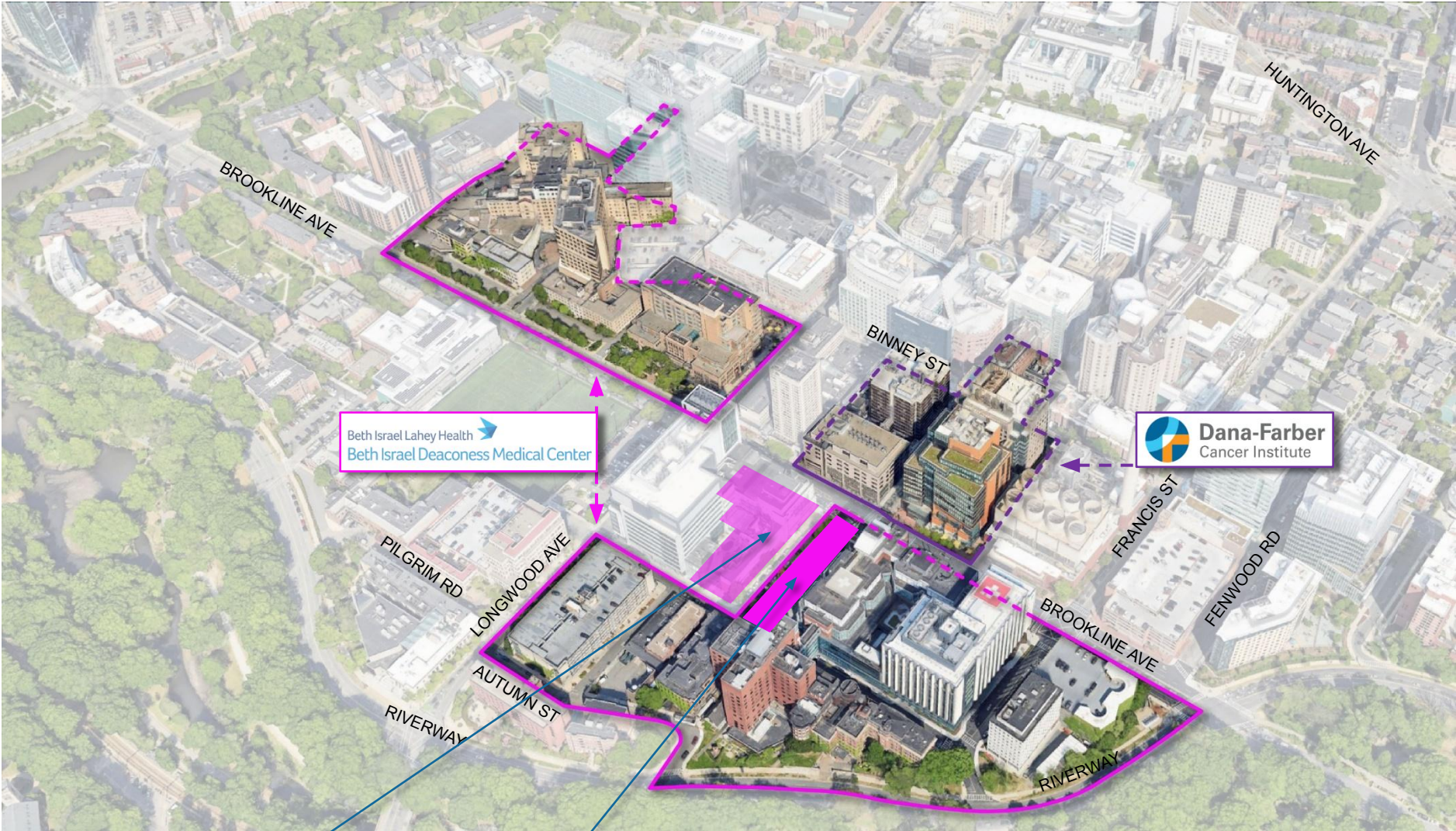

**1 Joslin Place**  
Future Cancer Hospital

**Joslin Park**



# EXISTING CONDITIONS | ONE JOSLIN PLACE and JOSLIN PARK



Joslin Diabetes Center (BIDMC/BILH)  
and Joslin Park (City of Boston, maintained by BIDMC)

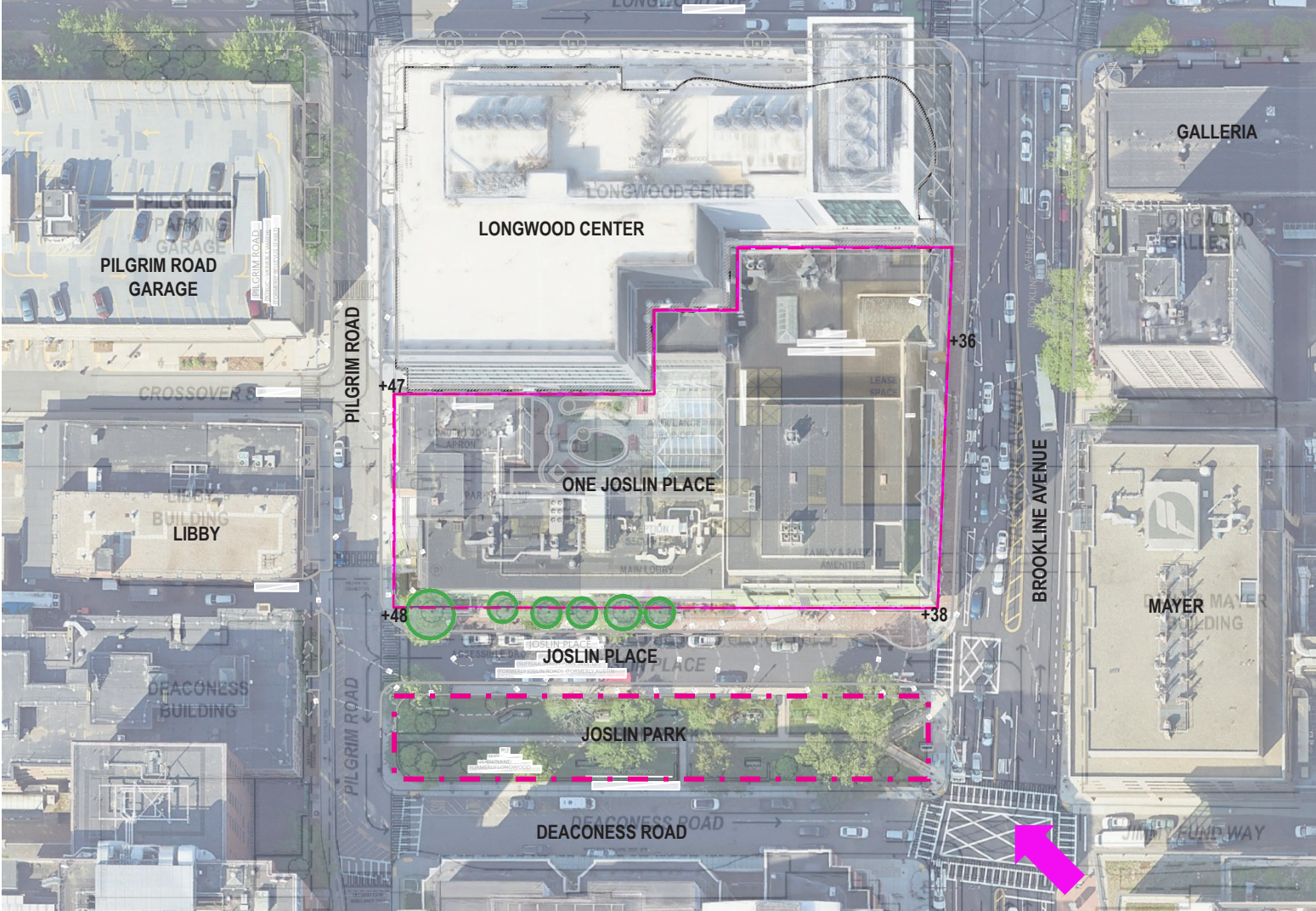

LEGEND

Property Line





# JOSLIN PARK | Existing and Proposed Park Configuration

Strategic Redistribution and Increase of Park Area

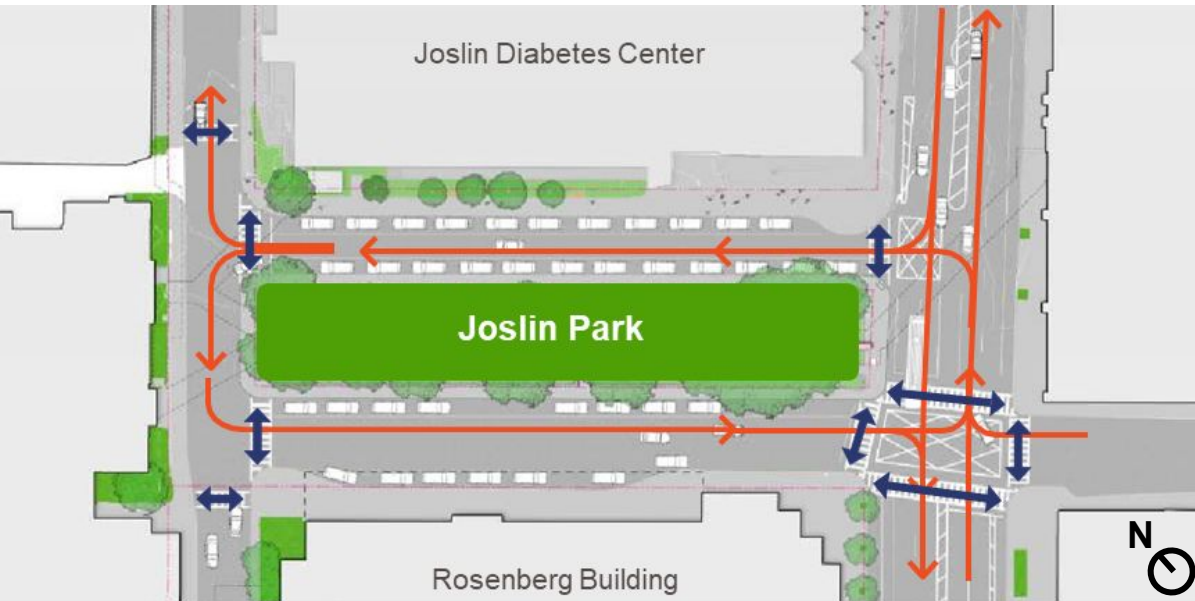

## Existing Alignment

Existing Park: approx. 13,300 sf

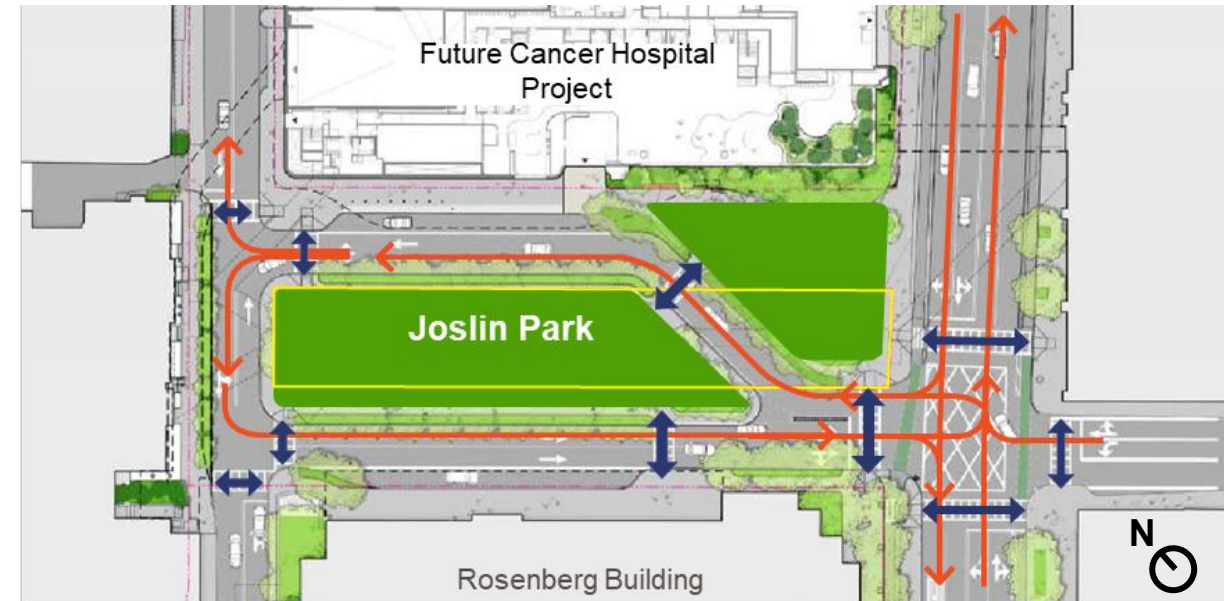

## Proposed Realignment

New Park: approx. 14,600 sf  
Net New Park: approx. 1,300 sf



# JOSLIN PARK | Aerial Rendering



Existing Alignment



Proposed Realignment



# JOSLIN PARK | Proposed Illustrative Plan (result of BPRD-led community process)

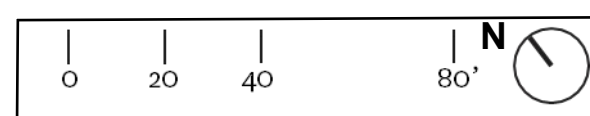
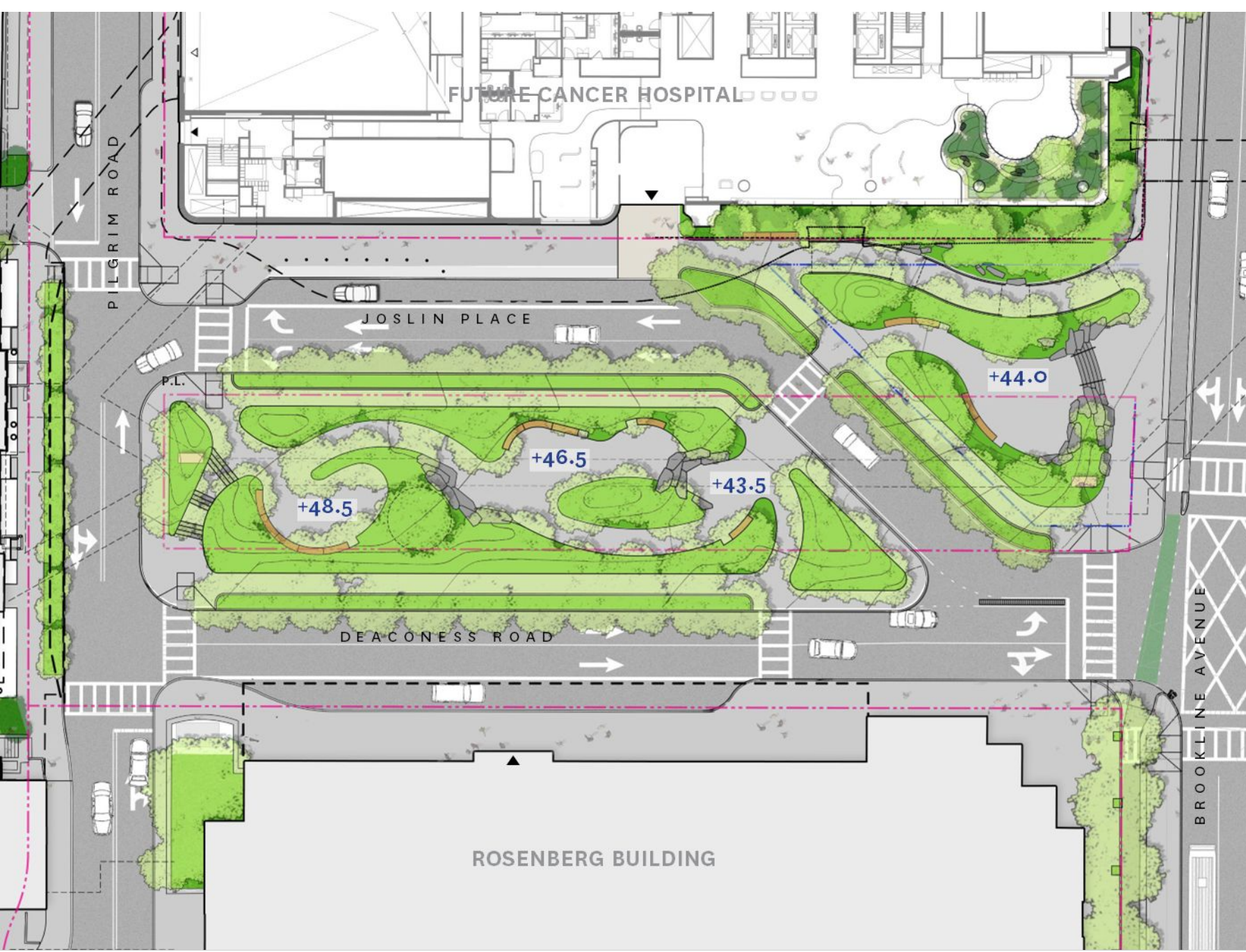



## Change of Land Use Exhibit

**Green = Future Park**  
**Purple = Current Park to Future ROW**  
**Yellow = Current ROW to BIDMC**

