



# Boston-Bridge Superstructure Replacement and Widening Bowker Overpass over I-90/ MBTA/ Ipswich Street

*Virtual Public Information Meeting*

Zoom | September 10, 2025 | 6:00 p.m.

Project File No. 606496 Contract No. 127762



# Zoom meeting controls



- Ask a question and share comments



- Drop-down menu to check the microphone and speakers



- Raise your hand - \*9 for users dialing in and Alt + Y to raise your hand



- If you are unable to access the internet or are having technical problems, please call into the meeting at 646-931-3860, Webinar ID: 878 6463 1124



- Use the View button in the upper right-hand corner to adjust the meeting view settings to your preference



Live Transcript

- Closed captioning automatically generated by Zoom

If you have trouble with the meeting technology during the presentation, please call:

+1 888 799 9666

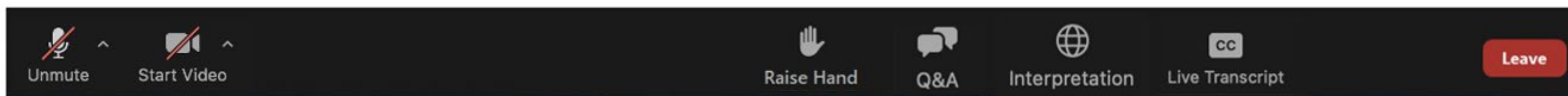

# Public Meeting Notes and Procedures

## Notification of video recording

- This public meeting will be recorded. The Massachusetts Department of Transportation may choose to retain and distribute the video, images, or audio.
- All parts of this meeting are considered public record.
- By continuing attendance with this public meeting, you are consenting to participate in a recorded event.
- If you are not comfortable being recorded, you may choose to excuse yourself from the meeting.

## Important notes

- The meeting will be open to questions and answers at the end of the formal presentation.

**All questions and comments are welcome and appreciated, however we do request that you refrain from any disrespectful comments.**

## Notice of MassDOT's Policy on Diversity and Civil Rights

- All MassDOT activities, including public meetings, are free of discrimination.
- MassDOT complies with all federal and state civil rights requirements preventing discrimination based on sex, race, color, ancestry, national origin (limited English proficiency), religion, creed, gender, sexual orientation, gender identity or expression, or veteran's status.
- We welcome the diversity from across our entire service area. If you have any questions or concerns, please visit <https://www.mass.gov/nondiscrimination-in-transportation-program> to reach the Office of Diversity and Civil Rights.

**Thank you for joining our meeting. We appreciate your participation!**

# Agenda

- 01 Project Team
- 02 Project Background
- 03 Project Purpose, Scope, & Benefits
- 04 Construction Timeline & Staging
- 05 Community Engagement
- 06 Questions & Answers



## Project Team

- MassDOT District 6 Assistant Construction Engineer: James O'Leary
- MassDOT Legislative Affairs: Daniel Fielding
- MassDOT Design Project Manager: Alwin Ramirez
- Barletta Heavy Division General Contractor: Bryan Delaney
- VHB Public Outreach: Jim Kersten
- Gill Engineering Associates Designer Manager: Scott Carpenter
- Howard Stein Hudson Public Outreach: Taylor O'Neill

# How did we get here?

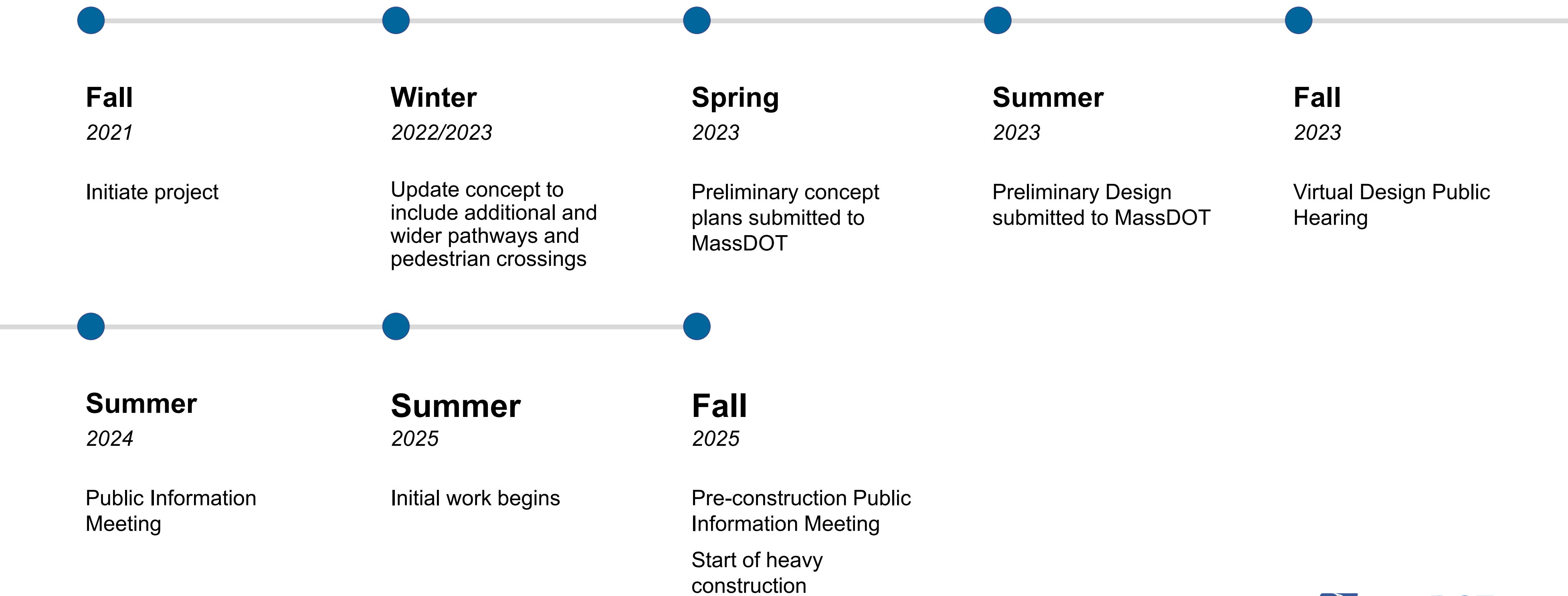

## Existing Conditions

- Built in 1964, rehabilitated in 1984
- Structurally deficient bridge requires replacement
- Lack of good infrastructure to support multimodal movement
- Inaccessible (non-ADA compliant) and uninviting pedestrian accommodation
- Impacts on environmental and cultural resources
  - (Muddy River, Charlesgate Park, Back Bay Fens)

## Project Purpose and Scope

- The purpose of this project is to restore and improve the existing Bowker Overpass over I-90/ MBTA railroad lines/ Ipswich Street
- Scope of Work
  - Replace the deficient Bowker Overpass over I-90/ MBTA railroad lines/ Ipswich Street
  - Widen the structure to include a bi-directional bike path and shared use path adjacent to the roadway, along with dedicated pedestrian only sidewalk to the west
  - The shared use path that is to be constructed will provide pedestrians and cyclists the ability to cross over I-90/ MBTA/ Ipswich Street. The proposed width is approximately 22' and will include variable vegetation on the sides of the structure
  - Provide accessibility, multimodal transportation, and a reconnection to the Emerald Necklace parklands over I-90. We will be restoring the historic Olmstead Alignment
  - Emphasis on Tree protection and preservation
  - Reconstruct and improve traffic patterns at Boylston Street and Bowker Overpass intersection
  - Remove the existing deficient Bowker Overpass off-ramp structure over Muddy River and relocate it to Charlesgate West

## Project Benefits

In addition to the necessary replacement of the aging overpass, this project aims to bring benefits to the community, including:

- Improvements to pedestrian and cyclist connectivity and access to surrounding parklands
- Enhanced ADA compliance for pedestrian accommodations
- Preparations for future park and green space improvements, including restoration of the historic Olmsted alignment
- The construction project will be adding approximately 100 new trees, 160 new shrubs and 3500 perennials and ferns all to be planted in the project area

# Completed Initial Construction Activities

- Installation of advance warning signage for traffic
- Installation of erosion control measures and environmental protections
- Test pitting and dig safe for existing utilities
- Work zone establishment
- Trees
  - Coordination site walk with arborists and DCR
  - Installation of tree protection
  - Initial tree pruning and tree care
  - Follow up site walk to review tree protection fencing
  - Removal of DCR trees previously identified by arborists

# 2026 Summer Events Coordination

Parade of Sail

FIFA World Cup Game at Gillette Stadium

250th

FIFA Timeline

Sail Boston Timeline

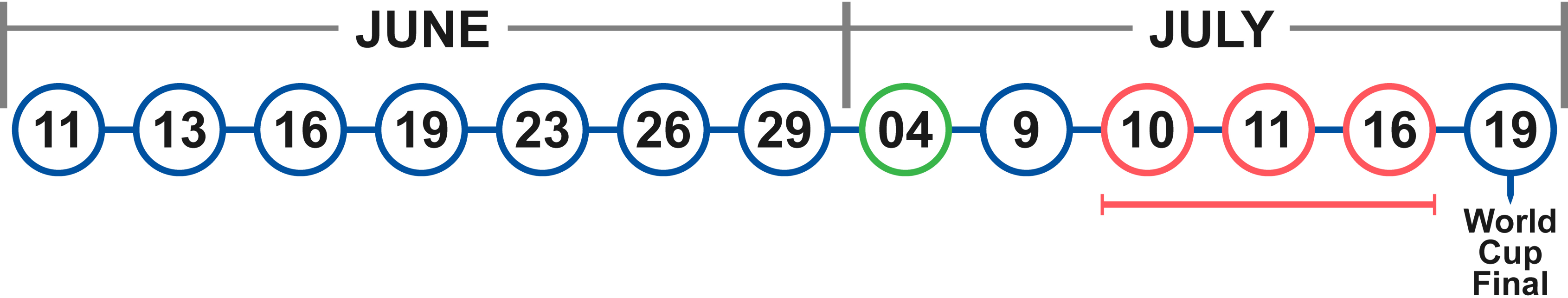

# Project Timeline and Staging – Project Overview

| STAGE    | DURATION                | I-90 EB & WB   | BOWKER OVERPASS & NEW CHARLESGATE BRIDGE   |                                     |  | IPSWICH STREET                       |   |
|----------|-------------------------|--|--|-------------------------------------|--|--------------------------------------|---|
|          |                         | VEHICLE LANES  | VEHICLE SB LANES   | VEHICLES NB LANES                   | PEDESTRIAN LOCATION                              | VEHICLE LANES                        | PEDESTRIAN LOCATION                     |
| EXISTING |                         | 4EB / 4WB  | 3 (2 VIADUCT + 1 EXISTING ON-RAMP)   | 3 (2 VIADUCT + 1 EXISTING OFF-RAMP) | EXISTING BOWKER OVERPASS & RAMPS                 | 1EB / 1WB                            | EXISTING SIDEWALK (SOUTH SIDE)          |
| 1A       | SEPT. 2025 - MARCH 2026 | 3EB / 3WB<br>(Low-Speed Work Zones)                        | EXISTING   |                                     | EXISTING<br>(Temporary Pedestrian Path)          | EXISTING<br>(Shifted North or South) | EXISTING<br>(Temporary Pedestrian Path) |
| 1B       | MARCH 2026 - AUG. 2026  | 3EB / 3WB<br>(High-Speed Work Zones)                       |  |                                     |  |                                      |   |
| 2A       | AUG. 2026 - DEC. 2026   | EXISTING   | EXISTING   | LEFT LANE NB WORK ZONE              | EXISTING<br>(Temporary Pedestrian Path)          | EXISTING                             | EXISTING                                |
| 2B       | DEC. 2026 - AUG. 2027   | 4EB / 3WB<br>(Low-Speed Work Zones Dec. 2026 to May. 2027) | New Charlesgate Bridge as New On-Ramp<br>EXISTING  |                                     | Existing Bowker Off-Ramp, New Charlesgate Bridge |                                      |   |
| 3A       | AUG. 2027 - APRIL. 2028 | EXISTING   | Existing SB Overpass 1 Lane Traffic Each Direction, New Charlesgate Bridge as On-Ramp & Off-Ramp |                                     | NEW CHARLESGATE BRIDGE                           |                                      |   |
| 3B       | APRIL. 2028 - DEC. 2028 | EXISTING   | New NB Overpass 1 Lane Traffic Each Direction, New Charlesgate Bridge as On-Ramp & Off-Ramp      |                                     | NEW CHARLESGATE BRIDGE                           |                                      |   |
| 4        | DEC. 2028 - DEC. 2029   | EXISTING   | New Overpass All Lanes, New Charlegate Bridge All Lanes  |                                     | NEW CHARLESGATE BRIDGE                           |                                      |   |

# Stage 1A – September 2025 to March 2026

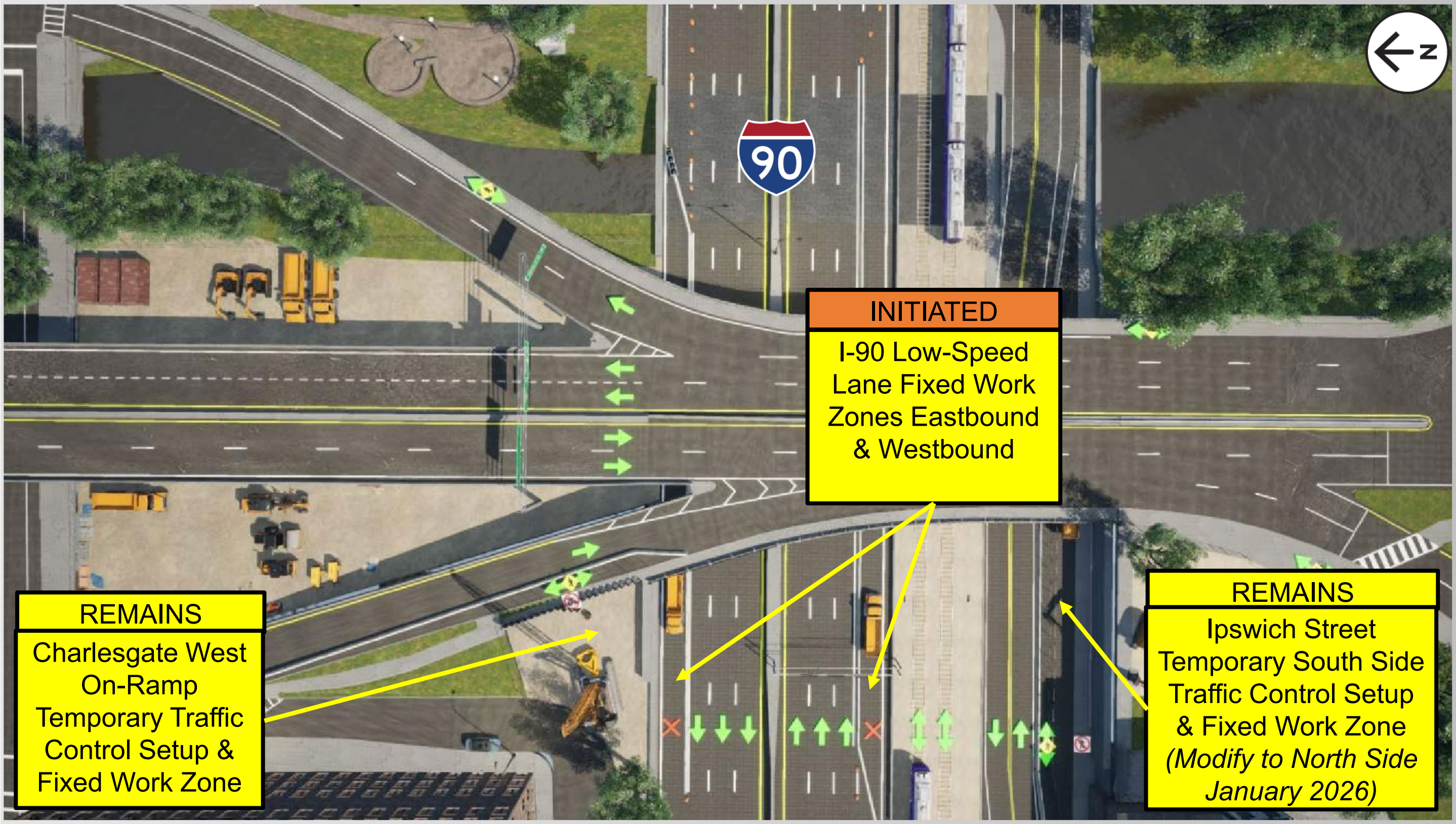

**X** = Lane closure  
**→** = Open for travel

# Stage 1B – March 2026 to August 2026

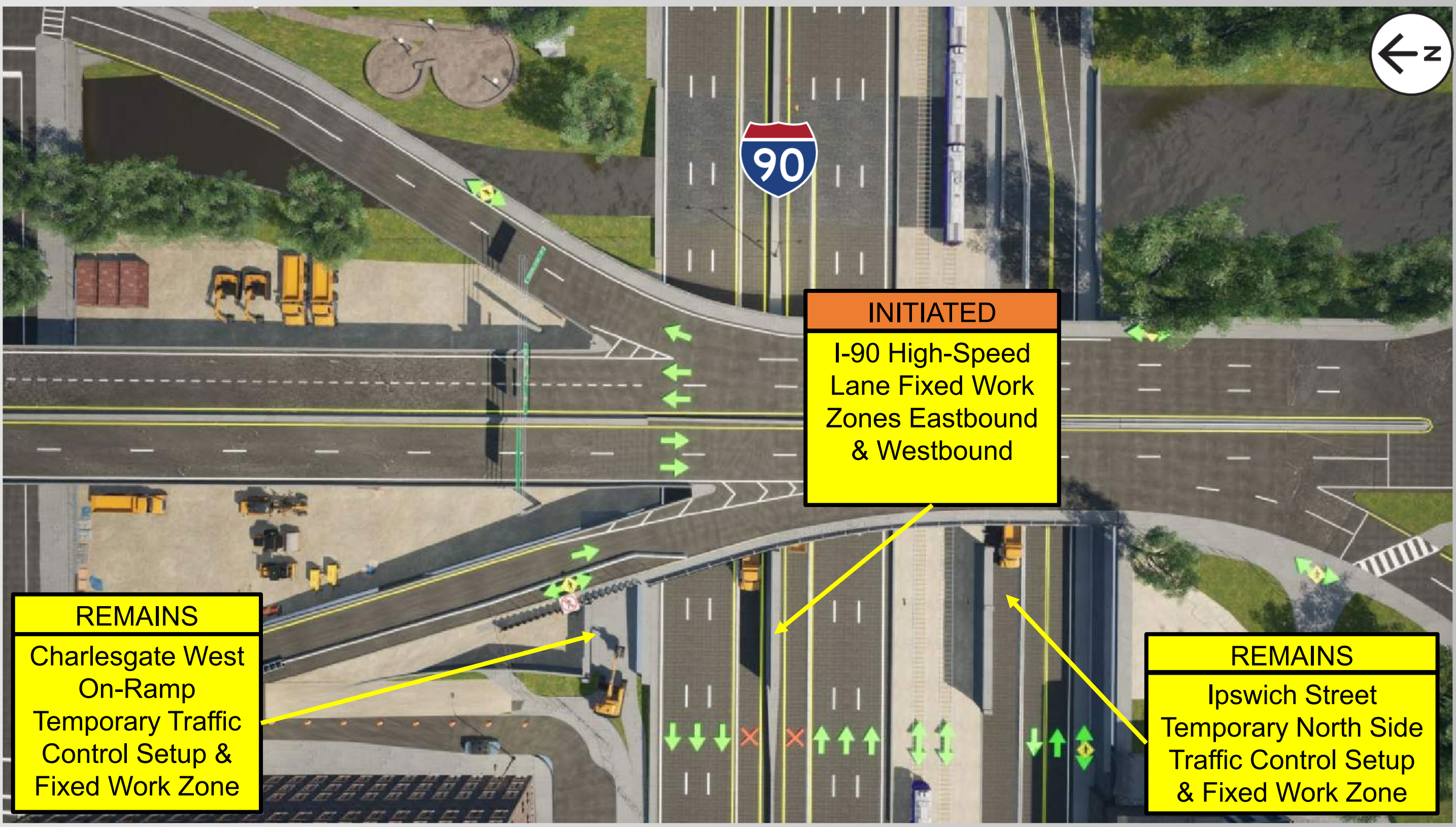

**X** = Lane closure  
**→** = Open for travel

# Stage 2A – August 2026 to December 2026 (night work)

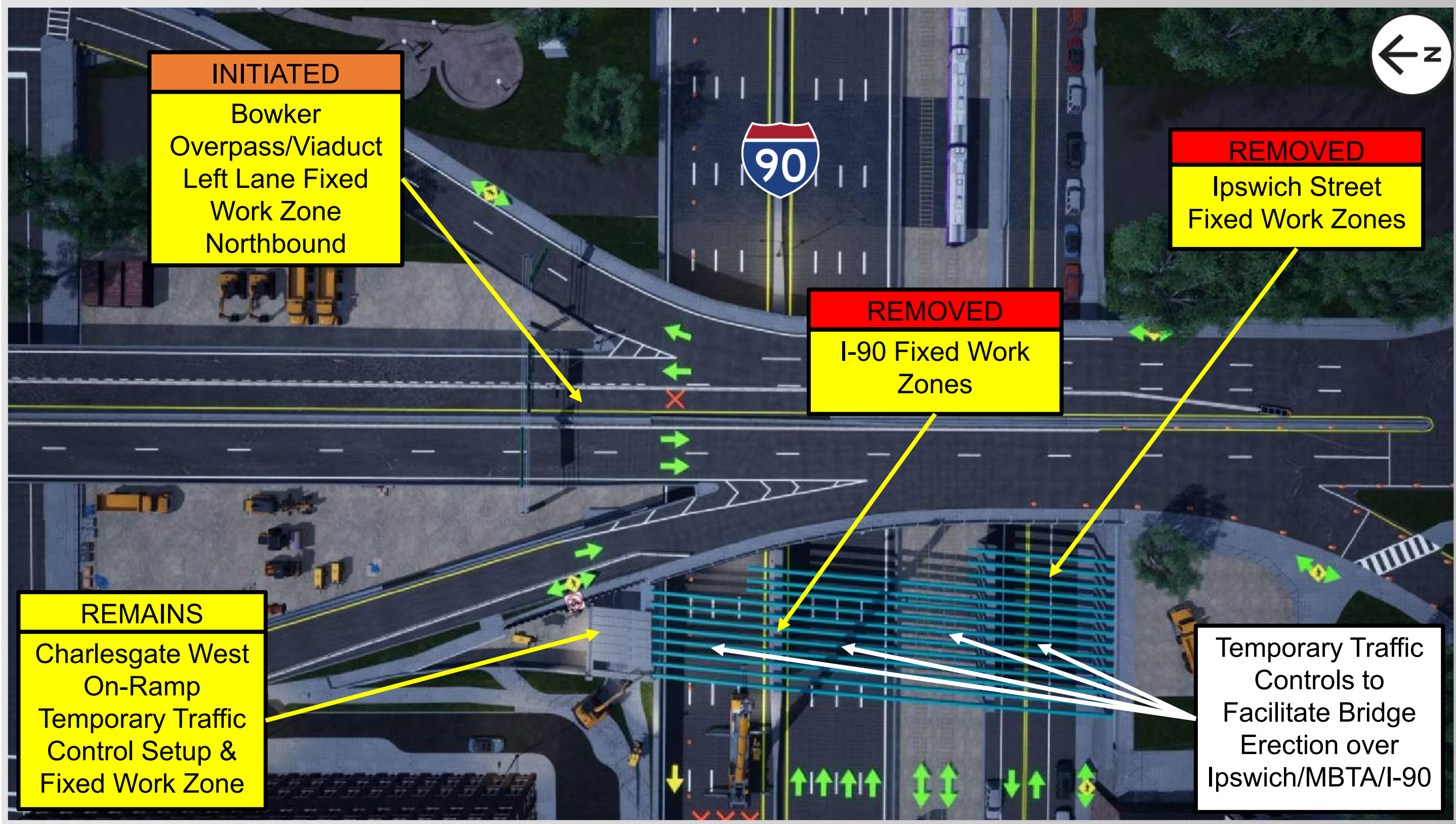

**X** = Lane closure  
**→** = Open for travel

# Stage 2B – December 2026 to August 2027

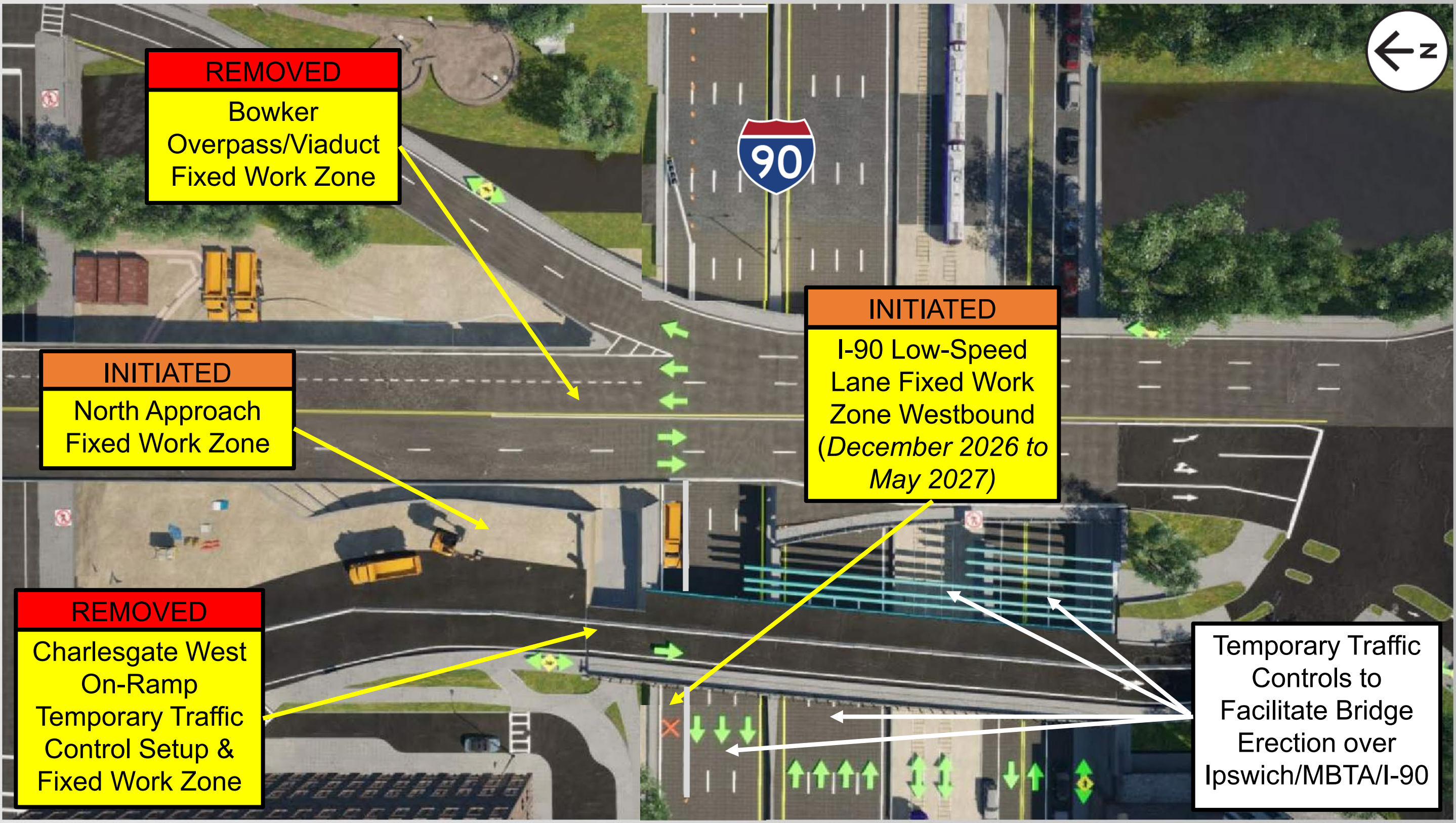

**X** = Lane closure  
**→** = Open for travel

# Stage 3A – August 2027 to April 2028 (night work)

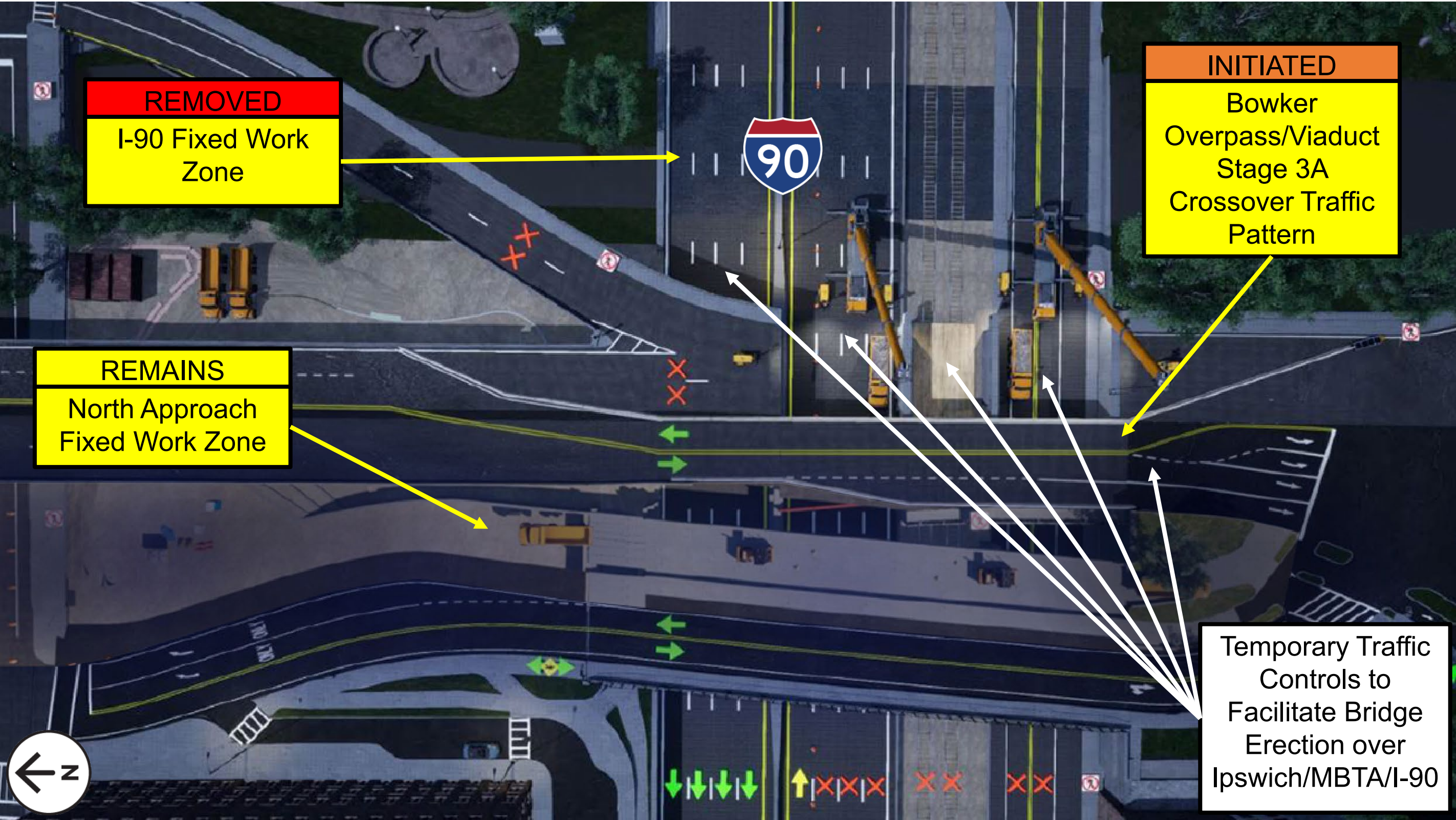

X = Lane closure  
→ = Open for travel

# Stage 3B – April 2028 to December 2028 (night work)

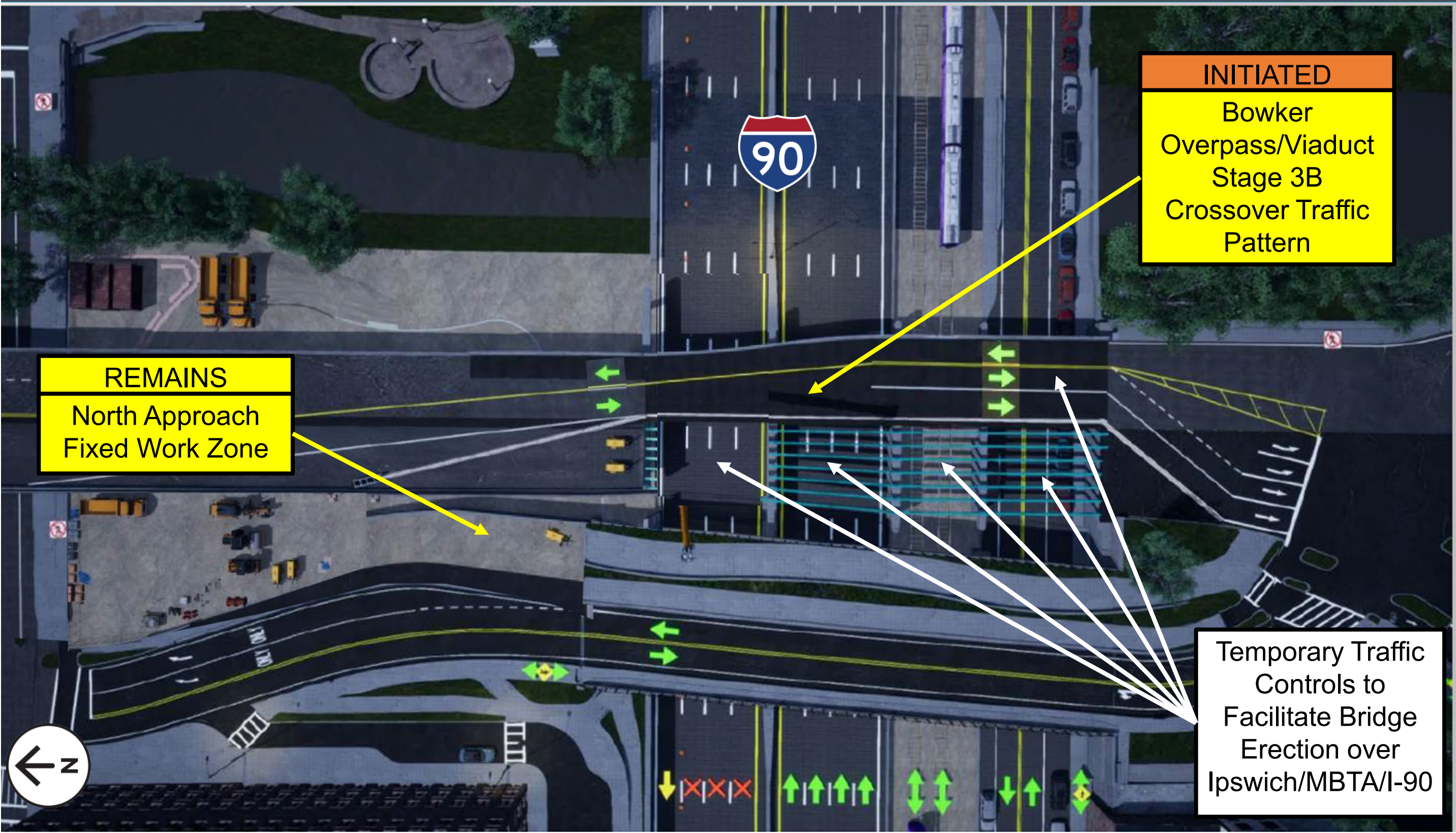

X = Lane closure  
→ = Open for travel

# Stage 4 – January 2029 – December 2029 Final Completion

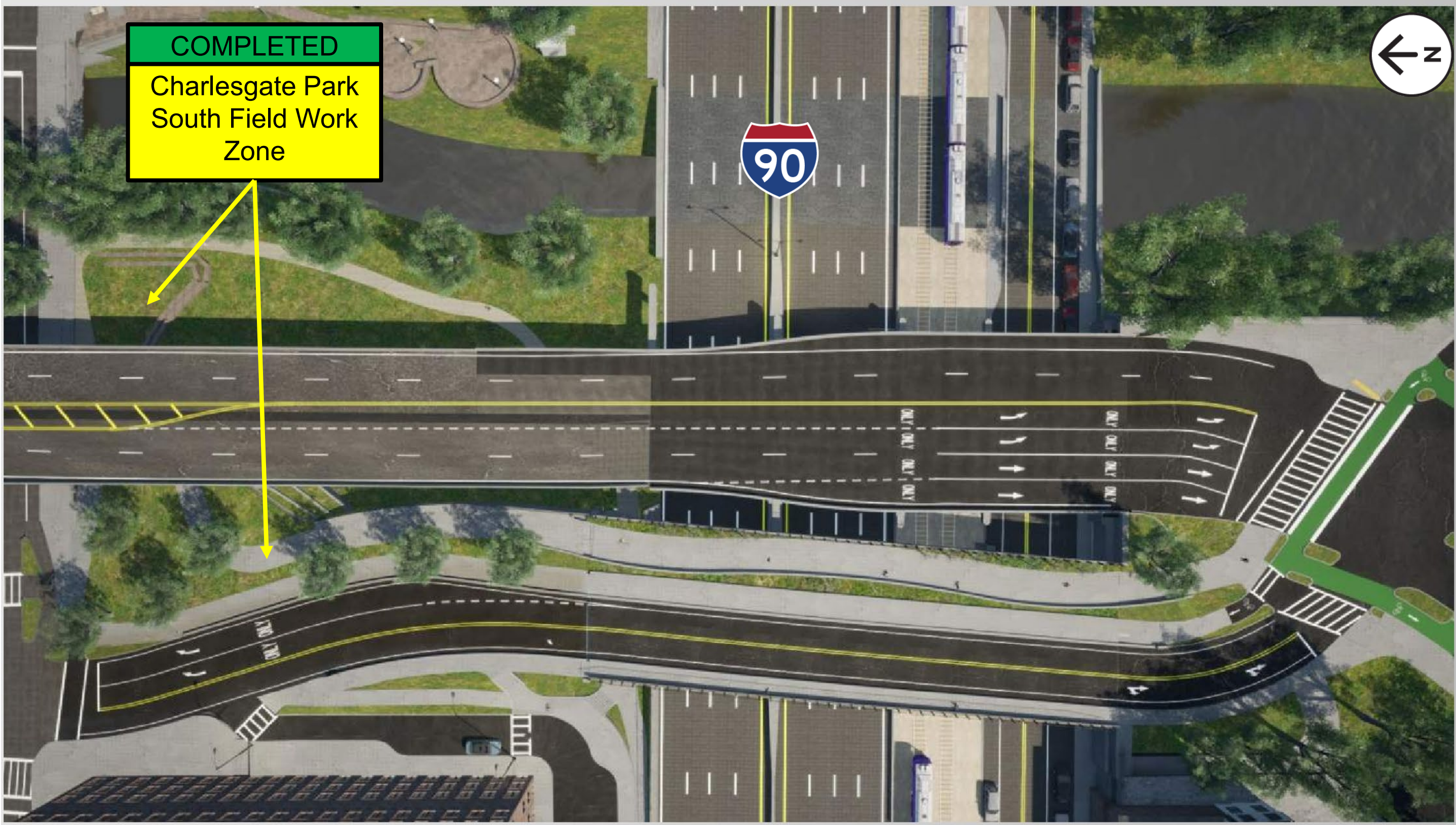

# Construction Logistics

- Most construction work is intended to occur during daytime shifts
- Some night work is needed for specific operations (i.e. bridge demolition, bridge steel erection, etc.)
- Some night and/or weekend work is needed for operations in proximity to MBTA railroad lines based on train schedules
- Some night and/or weekend work is needed for operations in proximity to active I-90 travel lanes and other roadways
- Night and weekend work will be coordinated with area events
- Project will be constructed in phases predominantly in fixed work zones
- Pedestrian and vehicular traffic will be managed via traffic control devices and temporary signal equipment in various stages of construction
- Work restrictions during events, holidays, etc.
- No long-term full roadway closures
- Access for emergency services will be coordinated and maintained

# Construction Monitoring

- Monitoring systems and preventative measures throughout construction for:
  - Noise
  - Construction vibration
  - Dust
  - Rodents
  - Tree/ park protections
  - Erosion (river/ waterway protection)

## Project Benefits.

In addition to the necessary replacement of the aging overpass, this project aims to bring benefits to the community, including:

- . Improvements to pedestrian and cyclist connectivity and access to surrounding parklands
- . Enhanced ADA compliance for all pedestrian accommodations
- . Preparations for future park and green space improvements, including restoration of the historic Olmsted alignment
- . The construction project will be adding approximately 100 new trees, 160 new shrubs and 3500 perennials and ferns all to be planted in the project area

## How Will We Keep You Informed?

- Regular construction updates will be distributed via email to project subscribers bi-weekly, or as needed
- Additional construction advisories will be distributed as needed
- Provide advanced notification for overnight and weekend work
- Project email for two-way communication between the public and the project team: [MassDOTBowkeroverpass@dot.state.ma.us](mailto:MassDOTBowkeroverpass@dot.state.ma.us)
- Visit the project website for more information:  
<https://www.mass.gov/bowker-overpass-project>



## Questions and Answers

 • Raise your hand to be called on for verbal questions

 • Please state your name and connection to the project before your question

 • Please share only 1 question or comment at a time, limited to 2 minutes, to allow others to participate

 • Comments may also be submitted to the project team electronically at [MassDOTBowkeroverpass@dot.state.ma.us](mailto:MassDOTBowkeroverpass@dot.state.ma.us)

**All questions and comments will be included in the meeting record, which will become public record. We do ask that you refrain from any disrespectful comments.**



# ***Thank You***

*Boston-Bridge Superstructure Replacement  
and Widening Bowker Overpass over I-90/  
MBTA/ Ipswich Street*

September 10, 2025 | 6:00 p.m.

Project File No. 606496 Contract No. 127762

Project email: [MassDOTBowkeroverpass@dot.state.ma.us](mailto:MassDOTBowkeroverpass@dot.state.ma.us)

