

**Massachusetts Department of Conservation and Recreation**  
**Division of Water Supply Protection, Office of Watershed Management**  
***Forest Management Project Summary***

**Project Title:**

<b>DWSP Harvest Permit Number:</b> 3146
<b>DCR Forest Cutting Plan File Number:</b> 204-8430-17

**Site Information**

<b>Watershed:</b> Quabbin	<b>Town(s):</b> New Salem
<b>Acres:</b> 10	<b>Nearest Road:</b> Route 202, Gate 17
<b>Natural Heritage Atlas overlap?:</b> Yes	<b>Public Drinking Water Supply Watershed?:</b> Yes
<b>Forest Types:</b> White Pine, Mixed Oak	<b>ACEC?:</b> No
<b>Soils:</b> Gneiss and Schist derived well drained till	
<b>Wetland Resources:</b> No	
<b>Vernal Pools present or within 200 feet of harvest?:</b> Yes	

**Harvest Information**

<b>Harvest Start Date:</b> September, 20, 2016	<b>Harvest End Date:</b> December 7, 2018
<b>Number of Wetland Crossings:</b> None	<b>Number of Stream Crossings:</b> None

**Best Management Practices Applied**

<b>Stream Crossings</b>	None
<b>Filter Strips</b>	1 filter strip; 100 ft. wide
<b>Wetland Crossings</b>	None
<b>Harvesting in Wetlands</b>	None

**DWSP Forester supervising this harvest**

<b>Name:</b> Derek Beard
<b>Forester License #</b> 14
<b>Phone #:</b> 617-780-0631
<b>Email:</b> derek.beard@state.ma.us

## **NARRATIVE**

### **General Description/Forest Composition/History:**

This watershed forest management project covers 10 acres located about mid way down the Prescott peninsula. Specifically it's situated on the east side of Herman Powers Road between the gate 17 and 20 roads (intersections 17-8 and 20-6). The south boundary is Aiken Road, east along a wetland complex, north/northeast along a stone wall and Herman Powers Road to the west.

Fairly large low quality white pine sawtimber is the main forest cover. The southern quarter is a mixture of average quality oak (red, black, white and scarlet) sawtimber. A 1982 thinning triggered a regeneration layer of sapling/pole size black birch, white pine and red maple.

A myriad of adjacent and nearby stone walls coupled with old wire fence along Herman Powers Road suggest the area was pasture before being taken for watershed conservation in the 1920s.

### **Site Selection:**

The primary goal of the watershed forest management program is to create and maintain a forest that provides high quality drinking water to current users and future generations. In order to achieve this, DWSP has determined that the forest should contain a diversity of species in various stages of development (seedlings through large legacy trees). In addition, the forest should be vigorous; actively growing and regenerating. Forest in this condition is ideally suited to be resilient to and quickly recover from small and large scale disturbances such as disease, insect infestation, ice storms and hurricanes. Sufficient advanced regeneration coupled with an underrepresented young for layer merits some regeneration harvesting.

### **Silvicultural Objectives:**

Diversification of forest structure and reducing stock of low quality timber are the primary project objectives. This will be accomplished by a two pronged forest management approach. First, a selection harvest consisting of two 2 acre openings situated on the west side of the project furthest from the wetland complex. And second, a shelterwood harvest situated between the openings and east bounding wetland complex. There are two shelterwood sections being 1.5 and 0.5 acres each. The distinct difference between approaches is a shelterwood retains a significant number of overstory trees for seed, shade and/or protection; in this case shade for the adjacent wetland complex while a selection opening retains few if any overstory trees creating a highly stimulus forest regeneration scenario. In this case, the mid sections of both openings have randomly spaced overstory which include vigorous, declining live and dead standing trees. Partially dead and dead standing trees, known as snags, providing forage and cavity nesting/denning opportunity for an array of wildlife.

### **Cultural Resources:**

The project area is home to several small quarries/barrow pits adjacent to the wetland complex.

**Wildlife/Rare or Endangered Species:**

The east side of the project area is bound by water resources that include a beaver pond, wetland, a vernal pool and an intermittent brook. Vernal pools are important habitat for a variety of salamanders as well as invertebrates like the fairy shrimp. In addition, the area overlaps with a natural heritage endangered species bubble.

**FIGURES**

Figure 1. Forest Cutting Plan

Figure 2. Pre-Harvest & Post Harvest Photographs, A-B

Figure 1: Forest Cutting Plan

10-19-16A09:25 RCVD

# Forest Cutting Plan

and Notice of Intent under M.G.L.  
Chapter 132 – The Forest Cutting  
Practices Act, 304 CMR 11.00  
(Effective Date: 1/1/04)

**For DCR Use Only:**  
File Number 204-8430-17 Case No. \_\_\_\_\_  
Date Rec'd 10/14/16 Nat. Hert. Yes 1  
Earliest Start 11/2/16 Nat. Hert. Imp. NO  
River Basin Chicopee Pub. Dr. Wat. Quabbin  
Gen. Obj. LT ACEC NO

**FINAL 9/17**

Site Information

**Location** Timber Lot 3146

Town New Salem  
Road Herman Powers Rd. (Inside Gate 17)  
Acres 10 Proposed Start Date \_\_\_\_\_  
Vol. MBF 65.7 Vol. Cds. 24 Vol. Tons 294

**Plan Preparer**

Name Derek Beard  
Address DCR – Div. of Water Supply Protection  
21 Elm St.  
Town, State, Zip New Salem, MA 01355  
Phone 978-544-6343  
Type of Preparer LF  
\*Mass. Forester License # 14  
\*Required for land under Ch61, Ch61A or Forest Stewardship

**Landowner**

Name DCR – Division of Water Supply Protection  
Mailing Address 485 Ware Rd.  
Town, State, Zip Belchertown, MA 01007  
Phone 412-323-6921  
Ch61 ☐ 61A ☐ 61B ☐ Stew ☐ \*Case # \_\_\_\_\_  
CR ☐ CR Holder \_\_\_\_\_

**Licensed Timber Harvester\*\***

Name Chris Pinner Logging  
Address 152 Williamsville Rd  
Town, State, Zip Hubbardston, MA 01452  
Phone 978-270-9916  
Mass. Lic. Harvester # 587  
\*\*This information may be supplied after the plan is approved, but before work begins.

Best Management Practices

**Stream Crossings**

Indicate location on map	SC-1	SC-2	SC-3	SC-4
Type of Crossing				
Existing Structure				
Type of Bottom				
Bank Height (ft)				
Stabilization				

**Wetland Crossings**

Indicate location on map	WC-1	WC-2	WC-3	WC-4
Length of Crossing				
Mitigation				
Stabilization				

**Filter Strips**

Indicate location on map	FS-1	FS-2	FS-3	FS-4
Width (50', 100', or VA)	100			

**Harvesting in Wetlands**

Indicate location on map	HW-1	HW-2	HW-3	HW-4
Forest Type (see pg 2)				
Acres to be Harvested				
Resid. Basal Area (>50%)				

**Service Forester Comments**

---

---

---

---

---

---

---

---

Codes

Type of Preparer	Type of Crossing	Stabilization	Mitigation	Type of Bottom
LF Mass. Lic. For	CU Culvert	SE Seed	FR Frozen	LE Ledge
TH Lic. Tim. Har	BR Bridge	MU Mulch	DR Dry	ST Stony
TB Timber Buyer	FO Ford	CO Corduroy	OT Other	MU Mud
LO Landowner	PO Poled	ST Stone		GR Gravel
OT Other	OT Other	HB Hay Bales		OT Other
		OT Other		

Note: Applicant must provide DCR with all relevant information before plan may be approved and cutting may begin. Some forestry activities, such as prescribed burning and pesticide or fertilizer application may require additional permits. Consult MA Forestry BMP Manual for further information.

If Other (OT) is used in any category an explanation must be given on an attached narrative page

pg 3 of 5



## Products to be Harvested\*Timber Lot 3146

Species	Mbf/Cds		Mbf/Cds
White Pine	61	Red Maple	1.9
Red Pine		Sugar Maple	
Pitch Pine		Red Oak	
Hemlock		Black Oak	1.3
Spruce		White Oak	
Other Sftwd.		Other Hdwd.	.6
White Ash		Total Mbf	65.7
Beech		Cordwood (Cds)	24
White Birch		SW Pulp (Tons)	294
B & Y Birch	.9	HW Pulp (Tons)	
Black Cherry		Chips (Tons)	

\*Note: Volumes and values indicated in the Plan are as reported by the plan preparer and have not been independently verified by the service forester upon approval. Mbf = thousand board feet.

## Cutting Standards

Indicate location on map	ST-1	ST-2	ST-3	ST-4
Forest Type	WP	WP	WP	WP
Acres	2	2	.5	1.5
Landowner Objective	LT	LT	LT	LT
Designation of Trees	CT	CT	CT	CT
Type of Cut	SE	SE	SH	SH
Source of Regeneration	SE/AD	SE/AD	SE/AD	SE/AD

## Landowner Signature

The most important information on a cutting plan is the Landowner's objective, as this will determine which trees will be harvested and which will remain; this decision will also determine the future condition of the forest for decades to come. After having read the Massachusetts Forest Cutting Plan Information Sheet on page one, indicate your objective by checking the appropriate box below.



LT - Long-term Forest Management

Planned management of the forest to achieve one or more of the following objectives: produce immediate and maximize long-term income, enhance wildlife habitat, improve recreational opportunities, protect soil and water quality, or produce forest specialty products.



ST - Short-term Harvest

Harvest of trees with the main intention of producing short-term income with minimal consideration given to improving the future forest condition, which often results in a forest dominated by poor quality and low value species

I (we) have read the Massachusetts Cutting Plan Information Sheet, and am aware of my (our) management options.

I (we) hereby certify that I (we) have the legal authority to carry out the operation described above.

I (we) certify that I (we) have notified the Conservation Commission in the town in which the operation is to take place and the abutters of record within two hundred feet of the area to be harvested.

I (we) understand that the volumes and values (Ch61 only) in this plan have not been independently verified by the service forester upon approval and will report final values and volumes to the Director or his/her agent if the final figures differ from those reported.



Signature of landowner(s)

10-13-16

Date

## Determination and Status

204-8430-17

## Final Report and Comments

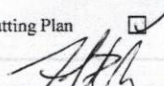
Approved ☒ Disapproved ☐ Expires 10/26/2018  
 Cutting Plan   
 Signature of Service Forester/Director's Agent 11/1/16  
 Date

I hereby certify that the afore described Forest Cutting Plan and all relevant statutes have been substantially complied with.

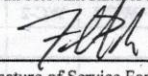
 6/13/17  
 Signature of Service Forester/Director's Agent Date

Extension 1 ☐ 2 ☐ Expires /  
 Ser. For. Ints. /  
 Amendment App 1 ☐ Dis 1 ☐ App 2 ☐ Dis 2 ☐ /

Forest Types				Designation of Trees		Type of Cut	Source of Regeneration						
WP	White Pine	HK	Hemlock	OM	Mixed Oak	CT	Cut Tree	SH	Shelterwood	Intermediate Harvests:	AD	Advanced	
WK	WP/Hem	HH	Hem/Hdwd	RM	Red Maple	LT	Leave Tree	ST	Seed Tree	CT	Commercial Thin	SE	Natural Seed
WH	WP/Hdwd	BC	Black Cherry	BE	Beech	SB	Stand Boundary	CC	Clear Cut	NT	Non Com Thin	PL	Plant
WO	WP/Oak	BB	Bee/Bir/Map	SF	Spruce/Fir	OT	Other	SE	Selection	Non-Standard Systems:	CO	Coppice	
RP	Red Pine	OH	Oak/Hdwd	SM	Sugar Maple	Landowner Objective	SA	Salvage	HG	Highgrade*	DS	Direct Seed	
SR	Red Spruce	OR	N Red Oak	PP	Pitch Pine	LT	Long-term Mgt	SN	Sanitation	DL	Diameter Limit*	OT	Other
						ST	Short-term Har.			OT	Other*		

\*If Other (OT) or a non-standard system is used an explanation must be given on attached narrative page

pg 4 of 5

# Forest Cutting Plan

Narrative Page (Effective Date: 1/1/04)

Use this page to provide further explanation or if  
Other (OT) was used in any category on pages 3 or 4.  
Timber Lot 3146

Landowner DCR-DWSP-Quab

Town New Salem

File Number 204-8430-17

BMPs

Use this Section to provide further explanation or if Other (OT) was used in any category in the Best Management Practices Section on Page 3.

The 10 acre harvest area is composed of 2 two acre openings separated by 200 feet of un-harvested forest. These openings have retention trees equivalent to at least 5 square feet of basal area per acre. Openings are marked blue. There are two shelterwood stands separated by un-harvested forest. These stands have 60 square feet of residual basal area and are marked orange. Landing and skid roads are marked both blue and orange. There are 4 acres of un-harvested or original condition forest.

Designation of Trees

Use this Section to describe the types of trees to be harvested and/or retained if Other (OT) was used for "Designation of Trees" in the Stand Treatment Section on page 4.

Stand No.	Species to be Cut	Size of Trees to be Cut	Quality of Trees to be Cut	% BA/Acre Removed

Regeneration & Future Condition

Use this Section to describe how Chapter 132 requirements will be met if a non standard system (HG, DL, or OT) was used for the "Type of Cut" in the Cutting Standards Section on page 4.

Stand No.	Source of Regeneration (ex. AD, SE)	How will Regeneration be obtained/protected? If using AD - Describe the species present and how the regeneration will be protected If using SE - Describe the source of the seed and the number of seed trees/acre
-----------	--	--

Stand No.	Desired Future Condition Describe what the stand is expected to look like five years from the harvest, including the condition of the overstory & understory
-----------	---





**DIVISION OF  
FISHERIES & WILDLIFE**

1 Rabbit Hill Road, Westborough, MA 01581  
p: (508) 389-6300 | f: (508) 389-7890  
**MASS.GOV/MASSWILDLIFE**

Jack Buckley, Director

Fletcher Clark - Department of Conservation and Recreation  
40 Cold Storage Drive  
P.O. Box 484  
Amherst, MA 01004

Cutting Plan No.	204-8430-17
NHESP Tracking No.	16-36186
Town	New Salem
Road	Herman Powers Road
Landowner	DCR - DWSP
Preparer	Derek Beard
Date	November 28, 2016

Dear Fletcher,

The Natural Heritage and Endangered Species Program ("the NHESP") of the Massachusetts Division of Fisheries and Wildlife ("the Division") has reviewed the above-referenced Forest Cutting Plan (hereinafter "the Plan") pursuant to the special approval procedures of the Forest Cutting Practices Regulations (304 CMR 11.04(6)). Based on details of the Plan and information in the NHESP database, the Division does not expect activities proposed in the Plan to negatively impact Estimated Habitat or result in "Take" (as defined in 321 CMR 10.02) of plant or animal species protected under the Massachusetts Endangered Species Act (MESA) (M.G.L. c. 131A) and its implementing regulations (321 CMR 10.00). Therefore, the Division does not require that the Plan be modified at this time.

Please copy the Division on any proposed amendment, extension and on the approved Plan for the site. If you have any questions about this letter, please contact Brent Powers at (508) 389-6354 or [brent.powers@state.ma.us](mailto:brent.powers@state.ma.us).

Sincerely,

A handwritten signature in cursive script that reads "Thomas W. French".

Thomas W. French, Ph.D.  
Assistant Director

Cc: New Salem Conservation Commission (via e-mail)

**MASSWILDLIFE**

Department of Conservation & Recreation  
Division of Water Supply Protection  
Timber Lot 3146 Located in New Salem - 10 acres  
Quabbin Reservoir Watershed

200  
Feet

**Legend**

-- Access Road

□ No Cut

▨ Opening

▨ Shelterwood

⊕ Landing

--- Skid Road

▨ Wetland

--- Intermittent Stream

☆ Vernal Pool

▨ Filter Strip

--- Stone Wall

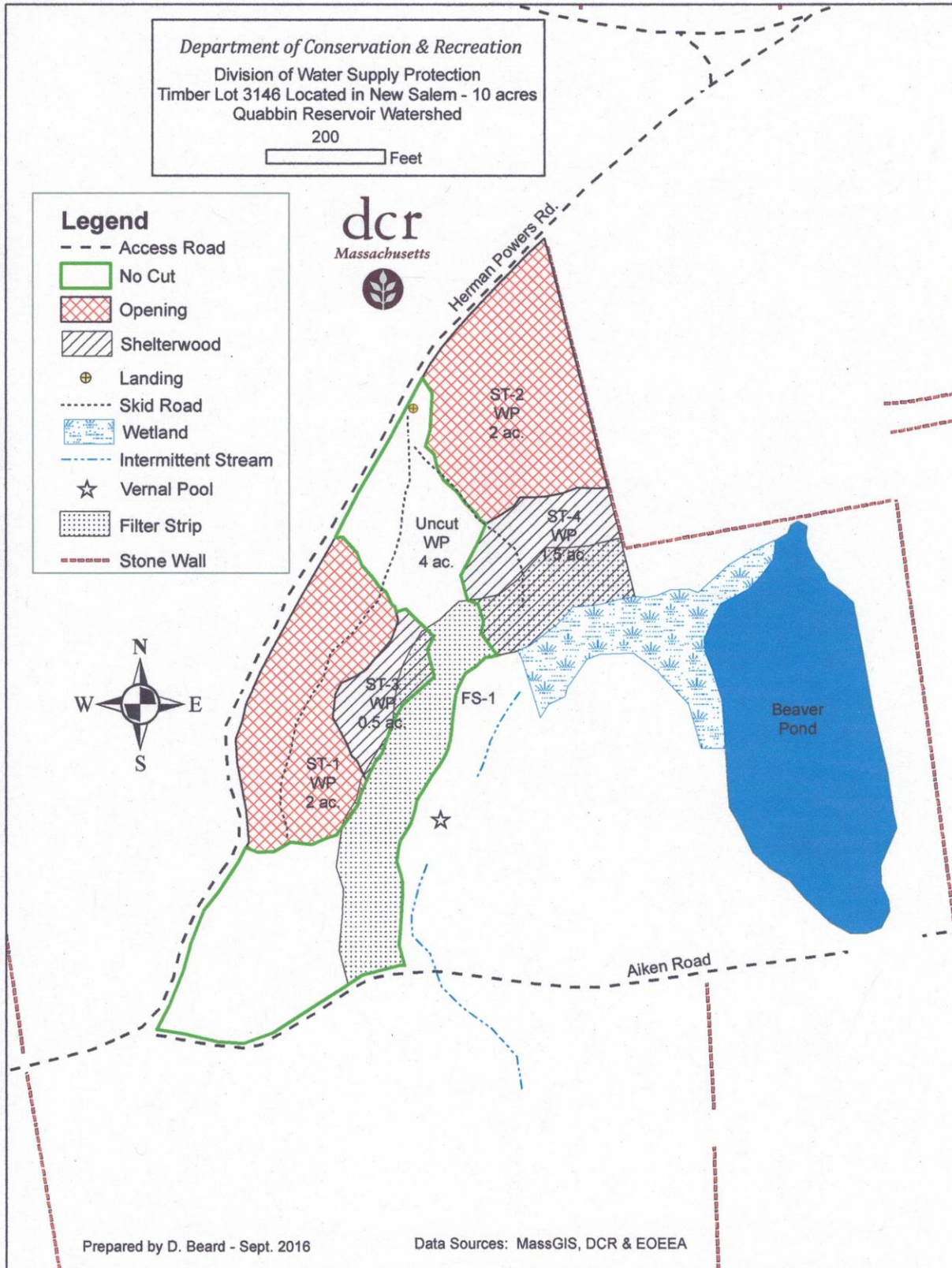

Prepared by D. Beard - Sept. 2016

Data Sources: MassGIS, DCR & EOEEA



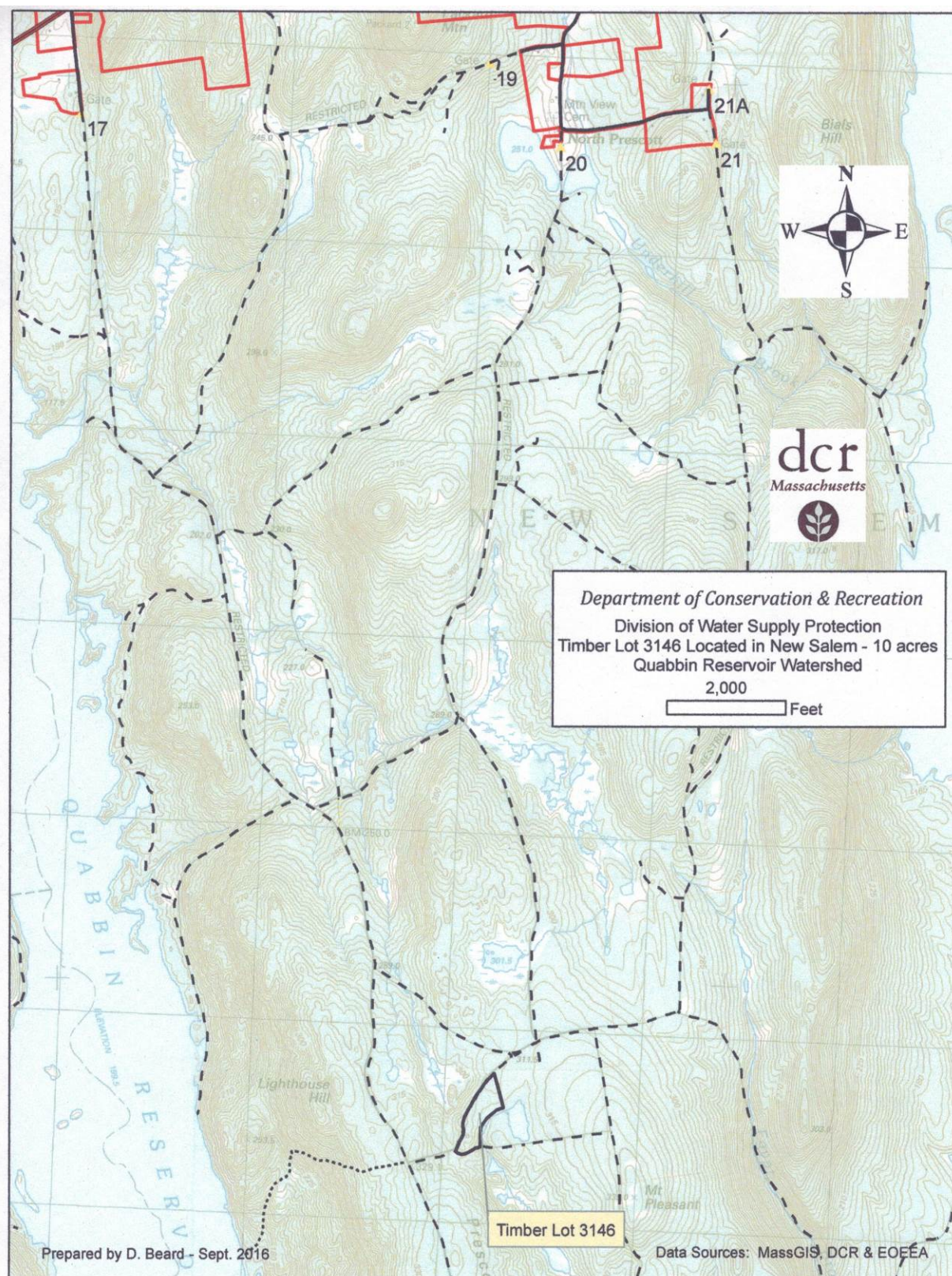



dcr



COMMONWEALTH OF MASSACHUSETTS  
Department of Conservation and Recreation  
Division of State Parks and Recreation

FILE #

204-8430-17

## FOREST CUTTING PLAN CERTIFICATE

Post this in a conspicuous place within the area in which the harvesting operation is to take place.

This certifies that

D.R. Quabbin

(Name of Owner)

Belchertown

(Address)

in accordance with the

provision of M.G.L. Chapter 132, Section 40-46, filed in

Amherst

with the Dept. of Conservation

and Recreation, Division of State Parks and Recreation, a Notice of Intent to cut forest products upon the

3146

lot.

Approval Date

11-1-2016

Director's Agent

FLETCHER CLARK

DCR Phone No.

413-262-2367

ISSUED BY:

Priscilla E. Geigis

Priscilla E. Geigis, Director  
Division of State Parks and Recreation



**Figure 2: Pre-Harvest Photograph, A (October 2016)**

A.



**Post-Harvest Photograph, A (June 2017)**





After one year of growth, A (July 2018)





**Pre-Harvest Photograph, B (October 2016)**

B.



**Post-Harvest Photograph, B (October 2017)**





After one year of growth Photograph, B (July 2018)

