

Massachusetts Department of Conservation and Recreation
Division of Water Supply Protection, Office of Watershed Management
Forest Management Project Summary

Project Title:

DWSP Harvest Permit Number: S15NQ
DWSP Proposal ID: PR-20-08-S
DCR Forest Cutting Plan File Number: 204-31025-21

Site Information

Watershed: Quabbin	Town(s): New Salem
Acres: 14	Nearest Road: Cooleyville
Natural Heritage Atlas overlap?: Yes	Public Drinking Water Supply Watershed?: Yes
Forest Types: Red Oak	ACEC?: No
Soils: Stony till with varying levels of sandy loam	
Wetland Resources: None	
Vernal Pools: 0	

Harvest Information

Harvest Start Date: 12/14/2020	Harvest End Date: 12/15/2022
Number of Wetland Crossings: 0	Number of Stream Crossings: 1

Best Management Practices Applied

Stream Crossings	1
Filter Strips	1
Wetland Crossings	0
Harvesting in Wetlands	0

DWSP Forester supervising this harvest
Name: Derek Beard
Forester License #: 14
Phone #:
Email: derek.beard@mass.gov

NARRATIVE

General Description/Forest Composition/History:

The project is in the Griswold Farm area of the Prescott Peninsula, approximately 6.5 miles south from gate 17 (Cooleyville Rd). Specifically, the area is southeast of intersection 17-10 approximately 4,000 feet along Griswold Rd. It's bounded by a brook to the south, a field to the west and extent of dead oak to the north and east.

The project is home to high canopy sawtimber red oak that died (2018). The main associates are black birch, white ash, hickory and sugar maple. Regeneration is limited to sapling/pole size black birch resulting from a 1974 thinning.

The project area was dedicated to small scale farming, mainly livestock grazing (rocky soils), prior to state ownership.

Site Selection:

The primary goal of the watershed forest management program is to create and maintain a forest that provides high quality drinking water to current and future users. In order to achieve this, DWSP has determined that the forest should contain a diversity of species in various stages of development (seedlings through large legacy trees). In addition, the forest should be vigorous; actively growing and regenerating. Forest in this condition is ideally suited to be resilient to and quickly recover from small to large scale disturbances such as disease, insect infestation, ice storms and hurricanes.

Silvicultural Objectives:

The main goal of the project is to salvage the dead oak having succumbed to consecutive years of intense gypsy moth caterpillar defoliation. Specifically, the project follows the pattern of mortality; such that there are uncut pockets due to the oak being alive and healthy or a change in species composition such as white pine or black birch (unaffected by gypsy moth). Furthermore, in areas of heavy mortality, oaks have been retained because they are healthy or have high wildlife value (cavity nesting/denning). In salvaging this resource, the stage will be set for a new forest to develop; with the hope it will be diverse/resilient enough to ward off the myriad issues affecting it today and in the future.

Cultural Resources:

With past agrarian history the area is home to a few stone walls. There are also several cellar holes along the project periphery.

Rare or Endangered Species:

Overlapping a habitat bubble, the project was reviewed by the MA Natural Heritage and Endanger Species program who determined the harvest would not negatively impact the specie(s) within the bubble.

FIGURES

Figure 1. Forest Cutting Plan

Figure 1a: Forest Cutting Plan pg. 1.

Forest Cutting Plan

and Notice of Intent under M.G.L.
Chapter 132 – The Forest Cutting
Practices Act, 304 CMR 11.00
(Effective Date: 3/15/16)

For DCR Use Only:

File Number	<u>204.31025.21</u>	Case No.	<u>NA</u>
Date Rec'd	<u>10/26/2020</u>	Nat. Hert.	<u>True</u>
Earliest Start	<u>11/10/2020</u>	Pub. Dr. Wat.	<u>yes</u>
River Basin	<u>Chicapee</u>	ACEC	<u>yes</u>
Gen. Obj.	<u>15</u>		

Site Information

Location

Town	New Salem		
Road	Cooleyville Rd. (Gate 17)		
Acres	14.00	Proposed Start Date	12/14/2020
Vol. MBF	79.300	Vol. Cds.	144
		Vol. Tons	0

Plan Preparer

Name Derek Beard
Address 485 Ware Rd

Town, State, Zip Belchertown MA 01007

Phone 617-780-0631

Type of Preparer LF

*Mass. Forester License # 14

*Required for land under Ch61, Ch61A or Forest Stewardship

Landowner

Name DCR Div. of Water Supply Protection

Mailing Address 485 Ware Rd

Town, State, Zip Belchertown Massachusetts 01007

Phone 413-323-6921

Ch61 ☐ 61A ☐ 61B ☐ Stew ☐ *Case # _____

FSC ☐ CR ☐ CR Holder _____

Licensed Timber Harvester**

Name _____

Address _____

Town, State, Zip _____ MA

Phone _____

Mass. Lic. Harvester # _____

**This information may be supplied after the plan is approved, but before work begins.

Best Management Practices

Stream Crossings

Indicate location on map	SC-1	SC-2	SC-3	SC-4
Type of Crossing	BR			
Existing Structure	No			
Type of Bottom	ST, MU			
Bank Height (ft)	1.00			
Stabilization	CO			

Wetland Crossings

Indicate location on map	WC-1	WC-2	WC-3	WC-4
Length of Crossing				
Mitigation				
Stabilization				

Filter Strips

Indicate location on map	FS-1	FS-2	FS-3	FS-4
Width (50', 100', or VA)	Va			

Harvesting in Wetlands

Indicate location on map	HW-1	HW-2	HW-3	HW-4
Forest Type (see pg 2)				
Acres to be Harvested				
Resid. Basal Area (>50%?)				

Service Forester Comments

* Heritage No Impact * MR
* See Attached * MR

Codes

Type of Preparer	Type of Crossing	Stabilization	Mitigation	Type of Bottom
LF Mass. Lic. For.	CU Culvert	SE Seed	FR Frozen	LE Ledge
TH Lic. Tim. Har	BR Bridge	MO Mulch	DR Dry	ST Stony
TB Timber Buyer	FO Ford	CO Corduroy	OT Other	MU Mud
LO Landowner	PO Poled	ST Stone		GR Gravel
OT Other	OT Other	HB Hay Bales		OT Other
		OT Other		

Note:
Applicant must provide DCR with all relevant information before plan may be approved and cutting may begin. Some forestry activities, such as prescribed burning and pesticide or fertilizer application may require additional permits. Consult MA Forestry BMP Manual for further information.

If Other (OT) is used in any category an explanation must be given on an attached narrative page

Figure 1b: Forest Cutting Plan pg. 2.

Forest Products			
Products to be Harvested*			
Species	Mbf/Cds		Mbf/Cds
White Pine	1.400	Red Maple	2.300
Red Pine	3.400	Sugar Maple	0.700
Pitch Pine		Red Oak	53.500
Hemlock		Black Oak	5.800
Spruce		White Oak	3.600
Other Sftwd.		Other Hdwd.	1.000
White Ash	3.700	Total Mbf	79.300
Beech		Cordwood (Cds)	144.000
White Birch		SW Pulp (Tons)	
B & Y Birch	3.900	HW Pulp (Tons)	
Black Cherry		Chips (Tons)	

***Note:** Volumes and values indicated in the Plan are as reported by the plan preparer and have not been independently verified by the service forester upon approval. Mbf = thousand board feet.

Stand Treatment				
Indicate location on map	ST-1	ST-2	ST-3	ST-4
Forest Type	OR			
Acres	14.000			
Landowner Objective	LT			
Designation of Trees	CT			
Type of Cut	SA			
Source of Regeneration	SE,CO			

Landowner Signature

The most important information on a cutting plan is the Landowner's objective, as this will determine which trees will be harvested and which will remain; **this decision will also determine the future condition of the forest for decades to come.** After having read the Massachusetts Forest Cutting Plan Information Sheet on page one, indicate your objective by checking the appropriate box below.

☒ **LT - Long-term Forest Management**

Planned management of the forest to achieve one or more of the following objectives: produce immediate and maximize long-term income, enhance wildlife habitat, improve recreational opportunities, protect soil and water quality, or produce forest specialty products.

☐ **ST - Short-term Harvest**

Harvest of trees with the main intention of producing short-term income with minimal consideration given to improving the future forest condition, which often results in a forest dominated by poor quality and low value species.

I (we) have read the Massachusetts Cutting Plan Information Sheet, and am aware of my (our) management options.
 I (we) hereby certify that I (we) have the legal authority to carry out the operation described above.
 I (we) certify that I (we) have notified the Conservation Commission in the town in which the operation is to take place and the abutters of record within two hundred feet of the area to be harvested.
 I (we) understand that the volumes and values (Ch61 only) in this plan have not been independently verified by the service forester upon approval and will report final values and volumes to the Director or his/her agent if the final figures differ from those reported.

[Signature]

Signature of landowner(s)

See next pg

Date

Service Forester			
Determination and Status			
Cutting Plan	Approved <input checked="" type="checkbox"/> Disapproved <input type="checkbox"/>	Expires	10/26/2022
<p><i>[Signature]</i></p> <p>Signature of Service Forester/Director's Agent</p>		<p style="text-align: center;"><i>11-9-20</i></p> <p>Date</p>	
Extension	1 <input type="checkbox"/> 2 <input type="checkbox"/>	Expires	Ser. For. Ints. <u>1</u>
Amendment	App 1 <input type="checkbox"/> Dis 1 <input type="checkbox"/> App 2 <input type="checkbox"/> Dis 2 <input type="checkbox"/>	<u>1</u>	

Final Report and Comments

I hereby certify that the afore described Forest Cutting Plan and all relevant statutes have been substantially complied with.

[Signature]

Signature of Service Forester/Director's Agent

2-7-22

Date

Codes											
Forest Types		Designation of Trees		Type of Cut		Source of Regeneration					
WP	White Pine	HK	Hemlock	OM	Mixed Oak	CT	Cut Tree	SH	Shelterwood	Intermediate Harvests:	
WK	WP/Hem	HH	Hem/Hdwd	RM	Red Maple	LT	Leave Tree	ST	Seed Tree	CT	Commercial Thin
WH	WP/Hdwd	BC	Black Cherry	BE	Beech	SB	Stand Boundary	CC	Clear Cut	NT	Non Com Thin
WO	WP/Oak	BB	Bee/Bir/Map	SF	Spruce/Fir	OT	Other	SE	Selection	Non-Standard Systems:	
RP	Red Pine	OH	Oak/Hdwd	SM	Sugar Maple		<u>Landowner Objective</u>	SA	Salvage	HG	Highgrade*
SR	Red Spruce	OR	N Red Oak	PP	Pitch Pine	LT	Long-term Mgt.	SN	Sanitation	DL	Diameter Limit*
						ST	Short-term Har.			OT	Other*

*If Other (OT) or a non-standard system is used an explanation must be given on attached narrative page

Figure 1c: Forest Cutting Plan pg 3.

10/14/2020

DCR Massachusetts - Forestry Permitting and Tracking System

The most important information on a cutting plan is the Landowner's objective, as this will determine which trees will be harvested and which will remain; **This will also determine the future condition of the forest for decades to come.** After having read the Massachusetts Forest Cutting Plan Information Sheet on page one, indicate your objective by checking the appropriate box below.

☒ **LT - Long-term Forest Management**

Planned management of the forest to achieve one or more of the following objectives: produce immediate and maximize long-term income, enhance wildlife habitat, improve recreational opportunities, protect soil and water quality, or produce forest speciality products.

☐ **ST - Short-term Harvest**

Harvest of trees with the main intention of producing short-term income with minimal consideration given to improving the future forest condition, which often results in a forest dominated by poor quality and low value species.

I (we) have read the Massachusetts Cutting Plan Information Sheet, and aware of my (out) management options. I (we) hereby certify that I (we) have the legal authority to carry out the operation described above. I (we) certify that I (we) have notified the Conservation Commission in the town in which the operation is to take place and the abutters of record within two hundred feet of the are to be harvested. I (we) understand that the volumes and values (Ch61 only) in this plan have not been independently verified by the service forester upon approval and will report final values and volumes to the Director or his/her agent if the final figures differ from those reported.

Signature of landowner(s)

Figure 1d: Forest Cutting Plan pg. 4.

10/14/2020

DCR Massachusetts - Forestry Permitting and Tracking System

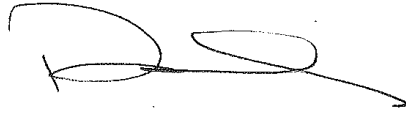
A handwritten signature in black ink, appearing to be 'Derek Beard', is written over a faint, illegible background.

CLEAR

Last Modified By: derek.beard@mass.gov

Last Modified Date: 10/14/2020 8:14 AM

✕ CANCEL

DISCARD

📄 SAVE AS DRAFT

SUBMIT →

Figure 1e: Forest Cutting Plan pg. 5.

Forest Cutting Plan

Narrative Page (Effective Date: 3/15/16)

Use this page to provide further explanation or if Other (OT) was used in any category on pages 3 or 4.

Landowner of Water Supply Prote

Town New Salem

File Number 204.31025.21

BMPs

Use this Section to provide further explanation or if Other (OT) was used in any category in the Best Management Practices Section on Page 3.

Most of the oak (80%) on this project is dead at the hands of a 2017-18 gypsy moth infestation. Cut trees are marked blue. Main skid roads are marked in orange paint.

Designation of Trees

Use this Section to describe the types of trees to be harvested and/or retained if Other (OT) was used for "Designation of Trees" in the Stand Treatment Section on page 4. Additional narrative description may be added on a separate page.

Stand No.	Describe Trees to be Cut			Describe Trees to be Left			% BA/AC	
	Species	Size	Quality	Species	Size	Quality	Cut	Left

Regeneration & Future Condition

Use this Section to describe how Chapter 132 requirements will be met if a non standard system (HG, DL, or OT) was used for the "Type of Cut" in the Cutting Standards Section on page 4.

Stand No. Source of Regeneration (ex. AD, SE)

How will Regeneration be obtained/protected?

If using AD - Describe the species present and how the regeneration will be protected
If using SE - Describe the source of the seed and the number of seed trees/acre

Stand No.

Desired Future Condition

Describe what the stand is expected to look like five years from the harvest, including the condition of the overstory & understory

Figure 1f: Forest Cutting Plan pg. 6

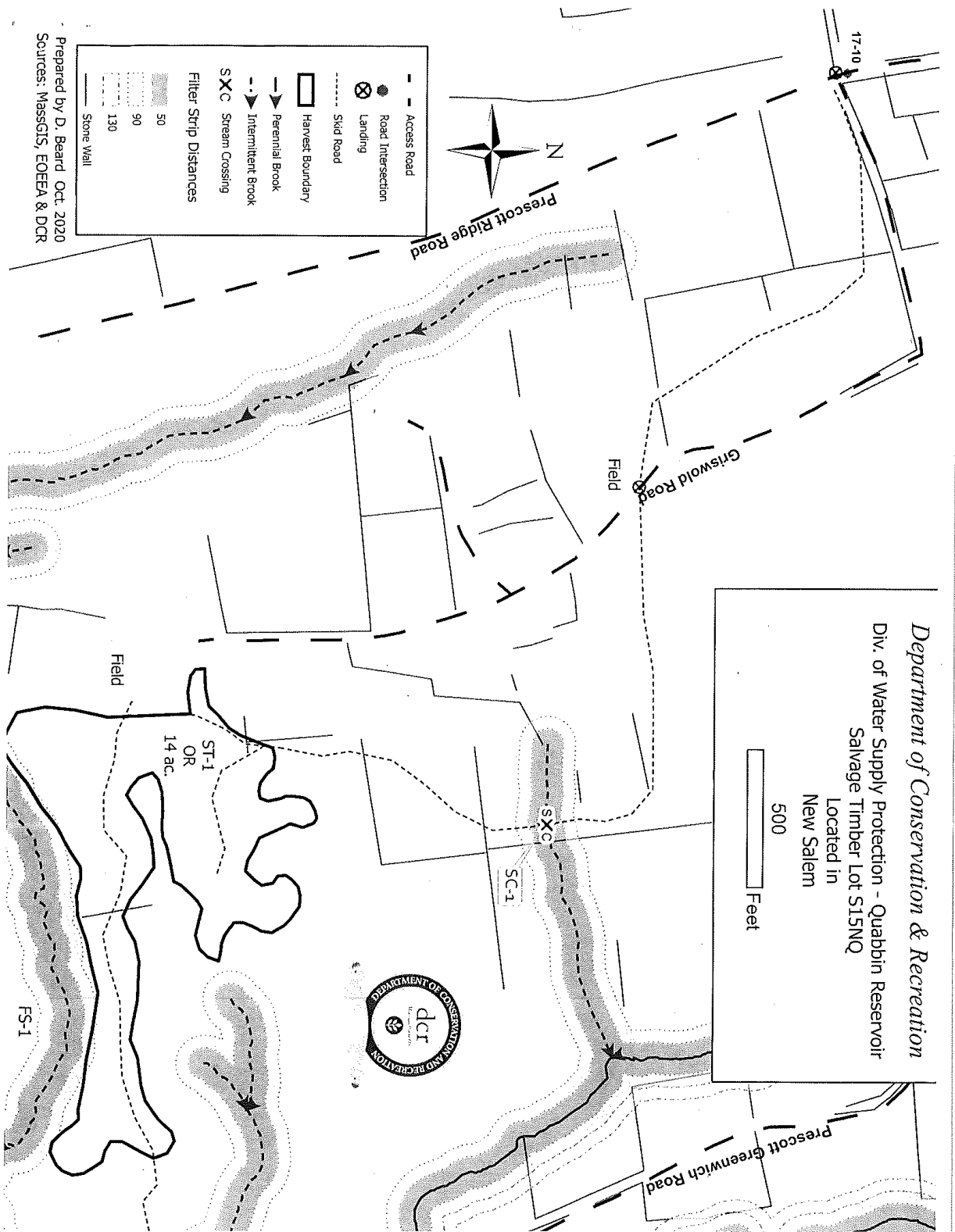

Figure 1g: Forest Cutting Plan pg. 7

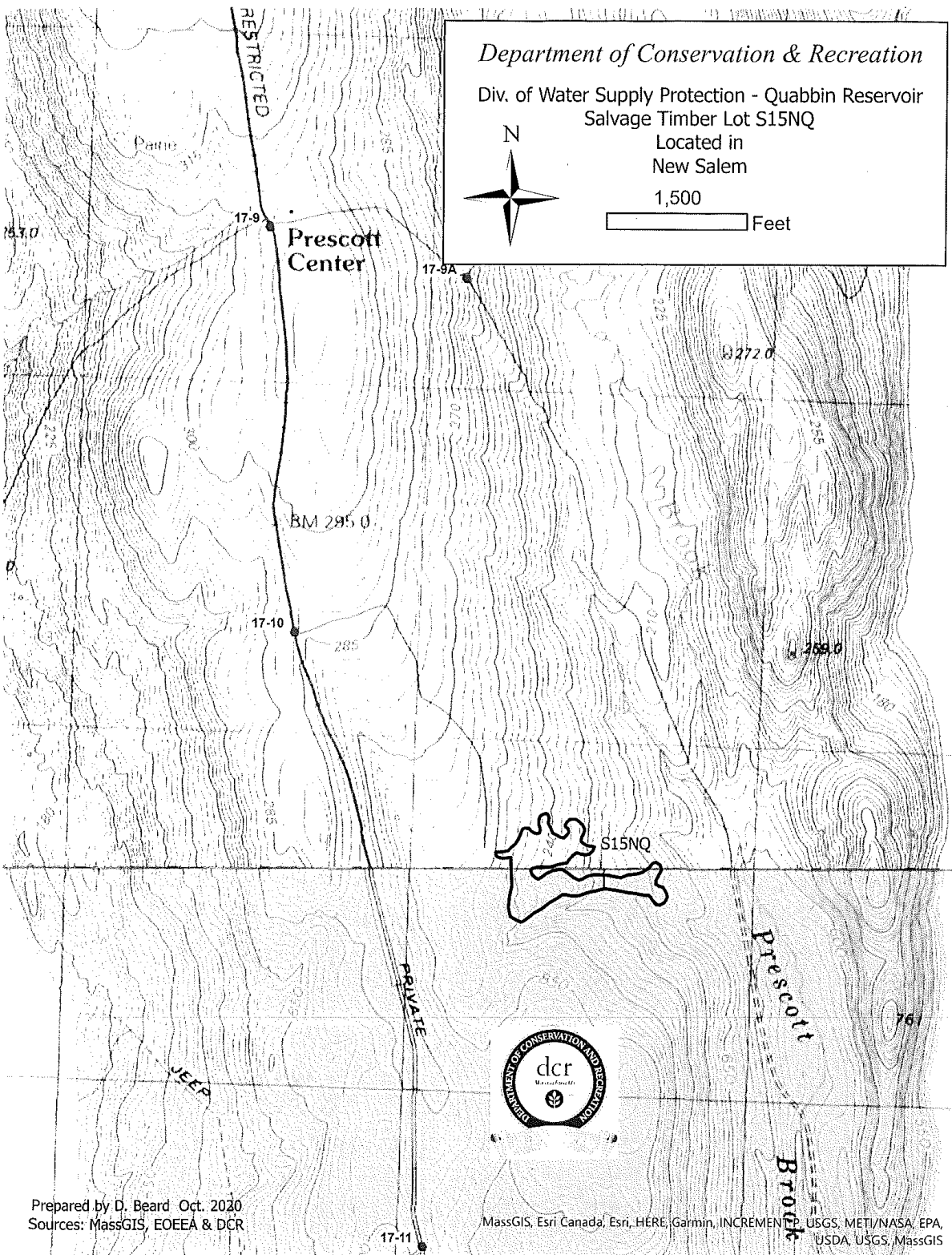

Figure 1h: Forest Cutting Plan pg. 8



MASSWILDLIFE

DIVISION OF
FISHERIES & WILDLIFE

1 Rabbit Hill Road, Westborough, MA 01581
p: (508) 389-6300 | f: (508) 389-7890
MASS.GOV/MASSWILDLIFE

Andrew Rawcliffe
Department of Conservation and Recreation
40 Cold Storage Drive
Amherst, MA 01004

Cutting Plan No.	204.31025.21
NHESP Tracking No.	20-39705
Town	New Salem
Road	Cooleyville Rd. (Gate 17)
Landowner	DCR DWSP
Preparer	Derek Beard
Date	November 4, 2020

Dear Andrew,

The Natural Heritage and Endangered Species Program (NHESP) of the Massachusetts Division of Fisheries and Wildlife ("the Division") has reviewed the above-referenced Forest Cutting Plan ("the Plan") pursuant to the special approval procedures of the Forest Cutting Practices Regulations (304 CMR 11.04(6)). Based on details of the Plan and information in the NHESP database, the Division does not expect activities proposed in the Plan to negatively impact Estimated Habitat or result in **Take** (as defined in 321 CMR 10.02) of plant or animal species protected under the Massachusetts Endangered Species Act (MESA) (M.G.L. c. 131A) and its implementing regulations (321 CMR 10.00). Therefore, the Division does not require that the Plan be modified at this time.

Please copy the Division on any proposed amendment, extension and on the approved Plan for the site. If you have any questions about this letter, please contact Rebekah Zimmerer at (508) 389-6354 or rebekah.zimmerer@mass.gov.

Sincerely,



A handwritten signature in cursive script, reading "Everose Schlüter".

Everose Schlüter, Ph.D.
Assistant Director

Cc: New Salem Conservation Commission

MASSWILDLIFE

Figure 1i: Forest Cutting Plan pg. 9

<u>dc</u> 	COMMONWEALTH OF MASSACHUSETTS Department of Conservation and Recreation Division of State Parks and Recreation	FILE # <u>204-31025-21</u>
<h1>FOREST CUTTING PLAN CERTIFICATE</h1>		
<p>Post this in a conspicuous place within the area in which the harvesting operation is to take place.</p>		
This certifies that <u>DCR-DWSP</u> <u>485 Ware Rd, Belchertown, MA 01007</u> in accordance with the (Name of Owner) (Address)		
provision of M.G.L. Chapter 132, Section 40-46, filed in <u>Amherst F.O.</u> with the Dept. of Conservation and Recreation, Division of State Parks and Recreation, a Notice of Intent to cut forest products upon the <u>Gate 17 / Cooleyville Rd</u> lot, <u>New Salem</u>		
Approval Date <u>11/9/2020</u>		
Director's Agent <u>Andrew Rawcliffe</u>		
DCR Phone No. <u>617-549-1677</u>		
ISSUED BY:  Priscilla E. Geigis, Director Division of State Parks and Recreation		