

**Massachusetts Department of Conservation and Recreation
Division of Water Supply Protection, Office of Watershed Management
*Forest Management Project Summary***

Project Title: Giles Brook and Moosehorn Brook
DWSP Harvest Permit Number: 3138
DWSP Proposal ID: PR-15-15 and PR-15-17
DCR Forest Cutting Plan File Number: 204-7705-16 & 204-7749-16

Site Information

Watershed: Quabbin
Town(s): New Salem
Acres: 116
Nearest Road: Route 202 and East Main St.
Natural Heritage Atlas overlap?: No
Public Drinking Water Supply Watershed?: Yes
Forest Types: Hemlock/White Pine/Oak/Mixed Hardwoods
Area of Critical Environmental Concern (ACEC)?: No
Soils: Chatfield-Hollis Complex, Canton-Chatfield-Hollis Complex, Montauk fine sandy loam
Wetland Resources: No
Vernal Pools: Yes

Harvest Information

Harvest Start Date: December 1,2016
Harvest End Date: May 4,2017
Number of Wetland Crossings: 0
Number of Stream Crossings: 5

Best Management Practices Applied

Stream Crossings: Temporary Bridging when flowing
Filter Strips: 8 filter strips ranging from 50 to 100 feet
Wetland Crossings: Not Applicable
Harvesting in Wetlands: Not Applicable

DWSP Forester supervising this harvest

Name: Derek Beard
Forester License number: 14
Phone number: 617-780-0631
Email: derek.beard@mass.gov

Narrative

General Description/Forest Composition/History

This project encompasses two harvest areas that are a mile apart and linked by a watershed access road. The south area is in the Giles Brook watershed and the north area is in the Moosehorn Brook watershed. These forest areas have relatively dense concentrations of hemlock along with white pine, mixed oak and other hardwoods. There are also two small red pine plantations. Stone walls, a staple of the New England landscape, are indicative of a much more open and agrarian landscape created by past inhabitants' generations ago.

The hemlock is aggregated while the white pine/hardwoods component is dispersed across harvest areas. The hemlock component has been in steady decline for the past two decades due to infestations of hemlock woolly adelgid and other pathogens. Early 1980s and 1990s improvement thinning spurred a scattered of regeneration currently composed of sapling/pole size black birch, hemlock and red maple.

Site Selection

The primary goal of the watershed forest management program is to create and maintain a forest that provides high quality drinking water to current users and future generations. In order to achieve this, DWSP has determined that the forest should contain a diversity of species in various stages of development (seedlings through large legacy trees). In addition, the forest should be vigorous; actively growing and regenerating. Forest in this condition is ideally suited to be resilient to and quickly recover from small- and large-scale disturbances such as disease, insect infestation, ice storms and hurricanes.

Diseased and dying hemlock coupled with an insufficient young forest layer indicates some regeneration cutting begin to trigger development of a healthier, more balanced and diverse forest structure.

Silvicultural Objectives

Reducing stocking of diseased hemlock and diversifying the area's forest structure are the primary objectives of the project. This will be accomplished by making a series of small forest openings randomly spaced through the area. Specifically, there are 35 openings covering 13 of the 116 acres with an average opening size of 0.4 acres. The well drained till soils are suited for hardwood regeneration. However, white pine is a possibility if the harvest is completed during a seed year.

Cultural Resources

In addition to stone walls mentioned above, there is a cellar hole located on the east side of the north harvest area.

Rare or Endangered Species

The harvest area does not overlap or abut any priority floral or faunal habitat; as compiled by MA Fish & Wildlife's Natural Heritage and Endangered Species program. No unusual wildlife, or evidence of, has been seen in, or adjacent to, the area. Maintenance of habitat mainly in the form of large diameter, partially alive and dead standing trees, known as *snags*, will be a priority. Additionally, the south harvest area is home to several vernal pools. Maintaining unique habitats, like vernal pools, is a primary goal when performing forestry operations. To that end no harvesting occurs within 15 feet of the pool; a shaded or thinned condition is maintained within 100 feet of the pool; and no significant rutting is permitted within 200 feet of the pool.

Figures

- Figure 1. Forest Cutting Plan
- Figure 2. Photo Point Pictures

Figure 1. Forest Cutting Plan

Forest Cutting Plan

and Notice of Intent under M.G.L. Chapter 132 – The Forest Cutting Practices Act, 304 CMR 11.00 (Effective Date: 1/1/04)

For DCR Use Only:

File Number 204-9805-16 Case No. _____
 Date Rec'd 7-6-15 Nat. Hert. NO
 Earliest Start 7-17-15 Nat. Hert. Imp. N/A
 River Basin Chicopee/Quabbin Pub. Dr. Wat. YES
 Gen. Obj. LT ACEC NO

FINAL 5/17

Location TIMBER LOT 3138 SECTION A **Landowner** _____

Site Information

Town New Salem Name DCR – Division of Water Supply Protection
 Road Millington Rd. aka Belden Hill Rd. (Gate 27) Mailing Address 485 Ware Rd.
 Acres 54 Proposed Start Date _____
 Vol. MBF 77 Vol. Cds. 110 Vol. Tons 437
 Town, State, Zip Belchertown, MA 01007
 Phone 412-323-6921
 Ch61 61A 61B Stew *Case # _____
 CR CR Holder _____

Plan Preparer

Name Derek Beard
 Address DCR – Div. of Water Supply Protection
21 Elm St.
 Town, State, Zip New Salem, MA 01355
 Phone 978-544-6343
 Type of Preparer LF
 *Mass. Forester License # 14
 *Required for land under Ch61, Ch61A or Forest Stewardship

Licensed Timber Harvester**

Name Alford Bros Logging
 Address Breckenridge Rd
 Town, State, Zip Hartley, MA 01035
 Phone 413-586-8938
 Mass. Lic. Harvester # 1513
 **This information may be supplied after the plan is approved, but before work begins.

Best Management Practices

Stream Crossings

Indicate location on map	SC-1	SC-2	SC-3	SC-4
Type of Crossing	BR	BR		
Existing Structure	N	N		
Type of Bottom	ST	ST		
Bank Height (ft)	<1'	<1'		
Stabilization	CO	CO		

Harvesting in Wetlands

Indicate location on map	HW-1	HW-2	HW-3	HW-4
Forest Type (see pg 2)				
Acres to be Harvested				
Resid. Basal Area (>50%?)				

Wetland Crossings

Indicate location on map	WC-1	WC-2	WC-3	WC-4
Length of Crossing				
Mitigation				
Stabilization				

Filter Strips

Indicate location on map	FS-1	FS-2	FS-3	FS-4
Width (50', 100', or VA)	100'	50'	50'	

Service Forester Comments

Codes

Type of Preparer	Type of Crossing	Stabilization	Mitigation	Type of Bottom	Note:
LF Mass. Lic. For.	CU Culvert	SE Seed	FR Frozen	LE Ledge	Applicant must provide DCR with all relevant information before plan may be approved and cutting may begin. Some forestry activities, such as prescribed burning and pesticide or fertilizer application may require additional permits. Consult MA Forestry BMP Manual for further information.
TH Lic. Tim. Har	BR Bridge	MU Mulch	DR Dry	ST Stony	
TB Timber Buyer	FO Ford	CO Corduroy	OT Other	MU Mud	
LO Landowner	PO Poled	ST Stone		GR Gravel	
OT Other	OT Other	HB Hay Bales		OT Other	
		OT Other			

Products to be Harvested*

TIMBER LOT 3138 SECTION A

*Note: Volumes and values indicated in the Plan are as reported by the plan preparer and have not been independently verified by the service forester upon approval. Mbf = thousand board feet

Forest Products

Species	Mbf/Cds		Mbf/Cds
White Pine	13.1	Red Maple	
Red Pine		Sugar Maple	
Pitch Pine		Red Oak	10.5
Hemlock	40.9	Black Oak	3.3
Spruce		White Oak	0.7
Other Sftwd.		Other Hdwd.	4.7
White Ash	0.8	Total Mbf	77.0
Beech		Cordwood (Cds)	110
White Birch		SW Pulp (Tons)	437
B & Y Birch	3.0	HW Pulp (Tons)	
Black Cherry		Chips (Tons)	

Stand Treatment

Cutting Standards

Indicate location on map	ST-1	ST-2	ST-3	ST-
Forest Type	HH	WK	OW	
Acres	16	8	30	
Landowner Objective	LT	LT	LT	
Designation of Trees	CT	CT	CT	
Type of Cut	SE	SE	SE	
Source of Regeneration	SE/AD	SE/AD	SE/AD	

Landowner Signature

The most important information on a cutting plan is the Landowner's objective, as this will determine which trees will be harvested and which will remain; this decision will also determine the future condition of the forest for decades to come. After having read the Massachusetts Forest Cutting Plan Information Sheet on page one, indicate your objective by checking the appropriate box below.

LT - Long-term Forest Management

Planned management of the forest to achieve one or more of the following objectives: produce immediate and maximize long-term income, enhance wildlife habitat, improve recreational opportunities, protect soil and water quality, or produce forest specialty products.

ST - Short-term Harvest

Harvest of trees with the main intention of producing short-term income with minimal consideration given to improving the future forest condition, which often result in a forest dominated by poor quality and low value spe

I (we) have read the Massachusetts Cutting Plan Information Sheet, and am aware of my (our) management options.
 I (we) hereby certify that I (we) have the legal authority to carry out the operation described above.
 I (we) certify that I (we) have notified the Conservation Commission in the town in which the operation is to take place and the abutters of record within two hundred feet of the area to be harvested.
 I (we) understand that the volumes and values (Ch61 only) in this plan have not been independently verified by the service forester upon approval and will report final values and volumes to the Director or his/her agent if the final figures differ from those reported.

William E. P...
 Signature of landowner(s)

June 26, 2015
 Date

Landowner

Determination and Status

Approved Disapproved Expires 7-17-17

[Signature]
 Signature of Service Forester/Director's Agent Date 7-15-15

Extension 1 2 Expires Ser. For. Ints. _____

Amendment App 1 Dis 1 App 2 Dis 2 _____

Final Report and Comments

I hereby certify that the afore described Forest Cutting Plan and all relevant statutes have been substantially complied with.

[Signature]
 Signature of Service Forester/Director's Agent Date 5/10/17

Service Forester

Codes

Forest Types	WP White Pine	HK Hemlock	OM Mixed Oak	Designation of Trees	SH Shelterwood	Intermediate Harvests:	Source of Regeneration
	WK WP/Hem	HH Hem/Hdwd	RM Red Maple	CT Cut Tree	ST Seed Tree	CT Commercial Thin	AD Advanced
	WH WP/Hdwd	BC Black Cherry	BE Beech	LT Leave Tree	CC Clear Cut	NT Non Com Thin	SE Natural Seed
	WO WP/Oak	BB Bee/Bir/Map	SF Spruce/Fir	SB Stand Boundary	SE Selection	Non-Standard Systems:*	PL Plant
	RP Red Pine	OH Oak/Hdwd	SM Sugar Maple	OT Other	SA Salvage	HG Highgrade*	CO Coppice
	SR Red Spruce	OR N Red Oak	PP Pitch Pine	Landowner Objective	SN Sanitation	DL Diameter Limit*	DS Direct Seed
				LT Long-term Mgt.		OT Other*	OT Other
				ST Short-term Har.			

*If Other (OT) or a non-standard system is used an explanation must be given on attached narrative page

Forest Cutting Plan

Narrative Page (Effective Date: 1/1/04)

Use this page to provide further explanation or if Other (OT) was used in any category on pages 3 or 4.

TIMBER LOT 3138 SECTION A

Landowner DCR-DWSP-Quab

Town New Salem

File Number _____

BMPs

Use this Section to provide further explanation or if Other (OT) was used in any category in the Best Management Practices Section on Page 3.

This harvest is an aggregation of 19 canopy openings (patches) spread across 54 acres. Opening size ranges from 0.1 to 0.7 acres with an average of 0.4 of an acre. The 19 openings cover a total of 7.5 acres.

Designation of Trees

Use this Section to describe the types of trees to be harvested and/or retained if Other (OT) was used for "Designation of Trees" in the Stand Treatment Section on page 4.

Stand No.	Species to be Cut	Size of Trees to be Cut	Quality of Trees to be Cut	% BA/Acre Removed

Regeneration & Future Condition

Use this Section to describe how Chapter 132 requirements will be met if a non standard system (HG, DL, or OT) was used for the "Type of Cut" in the Cutting Standards Section on page 4.

Stand No.	Source of Regeneration (ex. AD, SE)	How will Regeneration be obtained/protected? If using AD - Describe the species present and how the regeneration will be protected If using SE - Describe the source of the seed and the number of seed trees/acre

Stand No. **Desired Future Condition**
Describe what the stand is expected to look like five years from the harvest, including the condition of the overstory & understorey

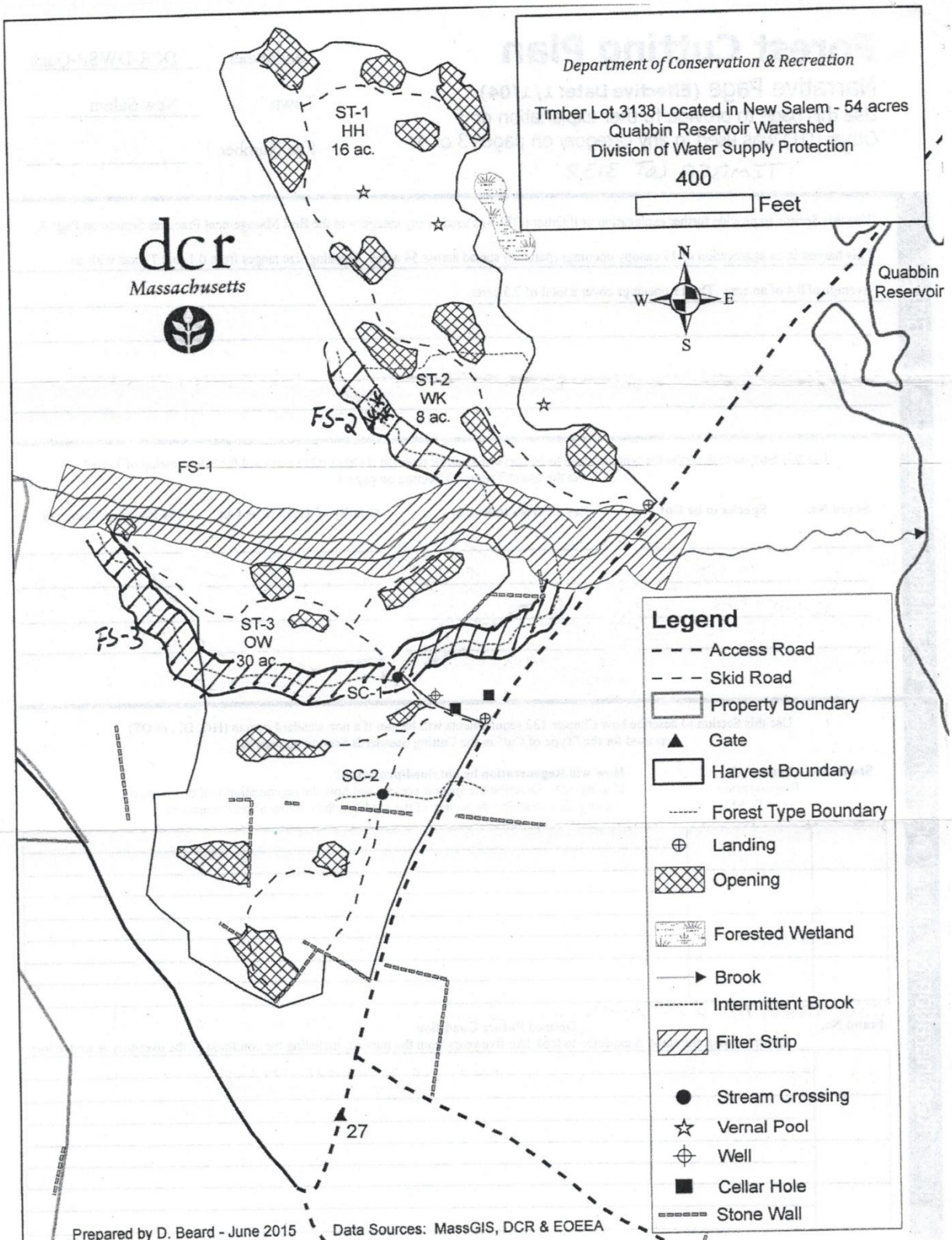

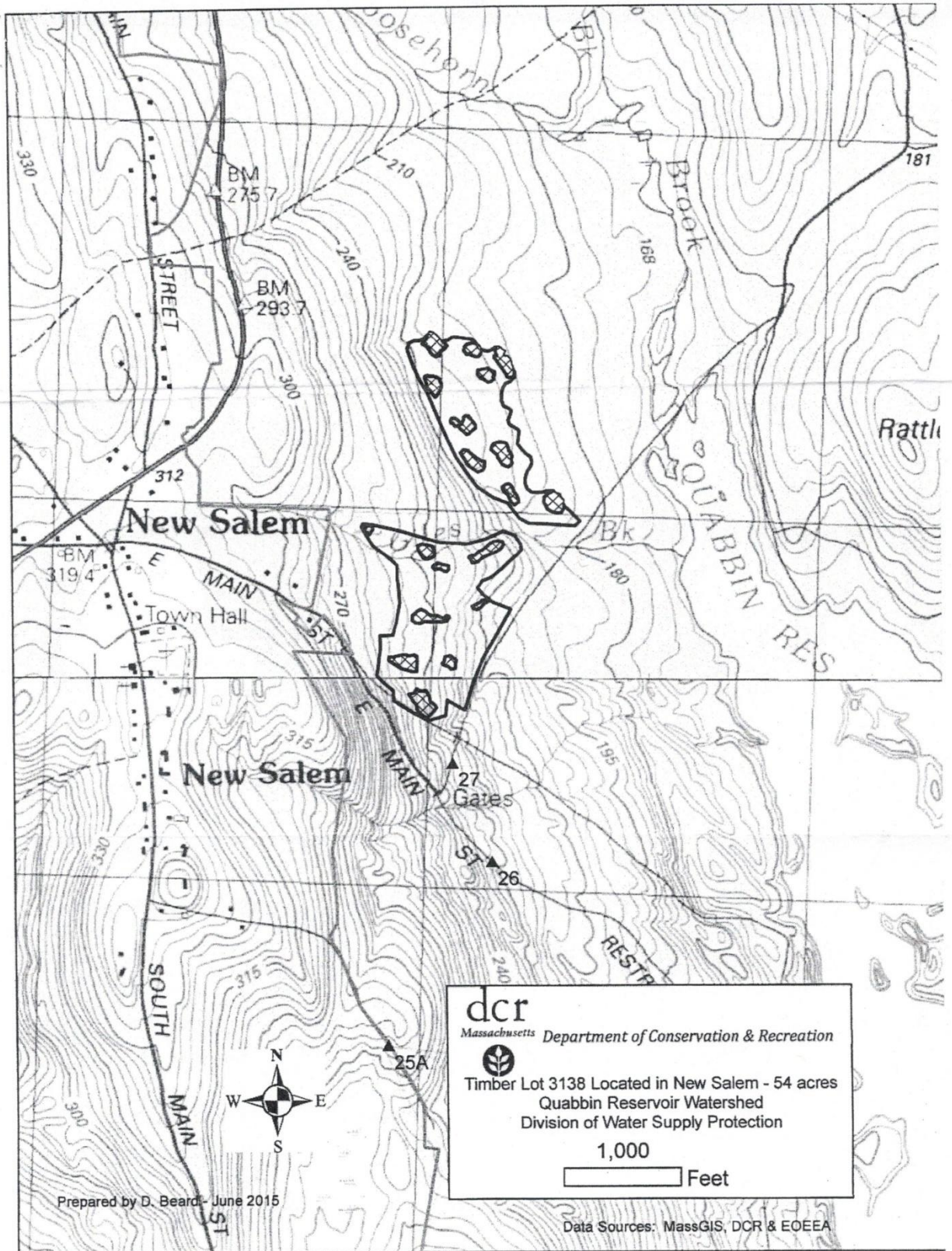

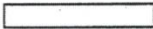
Massachusetts Department of Conservation & Recreation
 Timber Lot 3138 Located in New Salem - 54 acres
 Quabbin Reservoir Watershed
 Division of Water Supply Protection
 1,000
 Feet

Prepared by D. Beard - June 2015

Data Sources: MassGIS, DCR & EOEEA

dcr



COMMONWEALTH OF MASSACHUSETTS
Department of Conservation and Recreation
Division of State Parks and Recreation

FILE # 204-7705-16

W

FOREST CUTTING PLAN CERTIFICATE

Post this in a conspicuous place within the area in which the harvesting operation is to take place.

This certifies that DCR (DWSR) (Name of Owner) Ware Road, Belcherbun, MA (Address) in accordance with the

provision of M.G.L. Chapter 132, Section 40-46, filed in the Amherst office with the Dept. of Conservation and Recreation, Division of State Parks and Recreation, a Notice of Intent to cut forest products upon the

Millington Road lot.

Approval Date 7/15/2015

Director's Agent Fletcher Clark

DCR Phone No. (413) 262-2307 (forester)
(413) 545-5752 (clerk)

ISSUED BY:

Priscilla E. Geigis, Director
Division of State Parks and Recreation

Forest Cutting Plan

and Notice of Intent under M.G.L.
Chapter 132 – The Forest Cutting
Practices Act, 304 CMR 11.00
(Effective Date: 1/1/04)

For DCR Use Only:

File Number	201-7719-16	Case No.	NO 1
Date Rec'd	8/13/2015	Nat. Hert.	N/A
Earliest Start	8/28/2015	Nat. Hert. Imp.	Quibin
River Basin	Chicopee	Pub. Dr. Wat.	NO
Gen. Obj.	LT	ACEC	

FINAL 5/17

Site Information

Location

Town New Salem
Road Moosehorn Brook Road (Gate 28)
Acres 63 Proposed Start Date _____
Vol. MBF 83.8 Vol. Cds. 65 Vol. Tons 358

Landowner

Name DCR – Division of Water Supply Protection
Mailing Address 485 Ware Rd.
Town, State, Zip Belchertown, MA 01007
Phone 412-323-6921
Ch61 61A 61B Stew *Case # _____
CR CR Holder _____

Plan Preparer

Name Derek Beard
Address DCR – Div. of Water Supply Protection
21 Elm St.
Town, State, Zip New Salem, MA 01355
Phone 978-544-6343
Type of Preparer LF
*Mass. Forester License # 14
*Required for land under Ch61, Ch61A or Forest Stewardship

Licensed Timber Harvester**

Name Allard Bros. Logging
Address Breckenridge Rd
Town, State, Zip Hadley, MA 01035
Phone 413-586-8938
Mass. Lic. Harvester # 1513
**This information may be supplied after the plan is approved, but before work begins.

Best Management Practices

Stream Crossings

Indicate location on map	SC-1	SC-2	SC-3	SC-4
Type of Crossing	CU	BR	CU	BR/PO
Existing Structure	Y	N	Y	N
Type of Bottom	ST	ST/Mu	ST	ST/Mu
Bank Height (ft)	<1'	<1'	<1'	1'
Stabilization	CO	CO	CO	CO

Wetland Crossings

Indicate location on map	WC-1	WC-2	WC-3	WC-4
Length of Crossing				
Mitigation				
Stabilization				

Filter Strips

Indicate location on map	FS-1	FS-2	FS-3	FS-4
Width (50', 100', or VA)	100'	50'	50'	50'

Harvesting in Wetlands

Indicate location on map	HW-1	HW-2	HW-3	HW-4
Forest Type (see pg 2)				
Acres to be Harvested				
Resid. Basal Area (>50%?)				

Service Forester Comments

*Trees to be retained in ST-3 along
buffer strip are flagged in Pink.
FE 8/27/15

Codes

Type of Preparer	Type of Crossing	Stabilization	Mitigation	Type of Bottom
LF Mass. Lic. For.	CU Culvert	SE Seed	FR Frozen	LE Ledge
TH Lic. Tim. Har	BR Bridge	MU Mulch	DR Dry	ST Stony
TB Timber Buyer	FO Ford	CO Corduroy	OT Other	MU Mud
LO Landowner	PO Poled	ST Stone		GR Gravel
OT Other	OT Other	HB Hay Bales		OT Other

Note:
Applicant must provide DCR with all relevant information before plan may be approved and cutting may begin.
Some forestry activities, such as prescribed burning and pesticide or fertilizer application may require additional permits. Consult MA Forestry BMP Manual for further information.

If Other (OT) is used in any category an explanation must be given on an attached narrative page

Forest Products

Products to be Harvested*

Species	Mbf/Cds		Mbf/Cds
White Pine	11.8	Red Maple	
Red Pine	13.1	Sugar Maple	
Pitch Pine		Red Oak	8.1
Hemlock	45.2	Black Oak	1.3
Spruce		White Oak	0.2
Other Sftwd.		Other Hdwd.	1.6
White Ash		Total Mbf	83.8
Beech		Cordwood (Cds)	65
White Birch		SW Pulp (Tons)	358
B & Y Birch	2.5	HW Pulp (Tons)	
Black Cherry		Chips (Tons)	

TIMBER LOT #40 3138 SECTION B

*Note: Volumes and values indicated in the Plan are as reported by the plan preparer and have not been independently verified by the service forester upon approval. Mbf = thousand board feet.

Stand Treatment

Cutting Standards

Indicate location on map	ST-1	ST-2	ST-3	ST-4
Forest Type	HK/WP	OH	RP	WP/RP
Acres	39.5	19	.5	4
Landowner Objective	LT	LT	LT	LT
Designation of Trees	CT	CT	CT	CT
Type of Cut	SE	SE	CT	SE
Source of Regeneration	SE/AD	SE/AD	SE	SE/AD

Landowner

Landowner Signature

The most important information on a cutting plan is the Landowner's objective, as this will determine which trees will be harvested and which will remain; this decision will also determine the future condition of the forest for decades to come. After having read the Massachusetts Forest Cutting Plan Information Sheet on page one, indicate your objective by checking the appropriate box below.

LT - Long-term Forest Management

Planned management of the forest to achieve one or more of the following objectives: produce immediate and maximize long-term income, enhance wildlife habitat, improve recreational opportunities, protect soil and water quality, or produce forest specialty products.

ST - Short-term Harvest

Harvest of trees with the main intention of producing short-term income with minimal consideration given to improving the future forest condition, which often results in a forest dominated by poor quality and low value spec

I (we) have read the Massachusetts Cutting Plan Information Sheet, and am aware of my (our) management options.

I (we) hereby certify that I (we) have the legal authority to carry out the operation described above.

I (we) certify that I (we) have notified the Conservation Commission in the town in which the operation is to take place and the abutters of record within two hundred feet of the area to be harvested.

I (we) understand that the volumes and values (Ch61 only) in this plan have not been independently verified by the service forester upon approval and will report final values and volumes to the Director or his/her agent if the final figures differ from those reported.

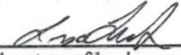
Signature of landowner(s)

8-10-15
Date

Service Forester

Determination and Status

Approved Disapproved Expires 8/3/2017

Cutting Plan 8/27/15

Signature of Service Forester/Director's Agent _____ Date _____

Final Report and Comments

I hereby certify that the afore described Forest Cutting Plan and all relevant statutes have been substantially complied with.

Signature of Service Forester/Director's Agent _____ Date 5/6/17

Codes

Forest Types	Designation of Trees	Type of Cut	Source of Regeneration
WP White Pine	CT Cut Tree	SH Shelterwood	AD Advanced
WK WP/Hem	LT Leave Tree	ST Seed Tree	SE Natural Seed
WH WP/Hdwd	SB Stand Boundary	CC Clear Cut	PL Plant
WO WP/Oak	OT Other	SE Selection	CO Coppice
RP Red Pine	Landowner Objective	SA Salvage	DS Direct Seed
SR Red Spruce	LT Long-term Mgt.	SN Sanitation	OT Other
	ST Short-term Har.	OT Other*	
		Intermediate Harvests:	
		CT Commercial Thin	
		NT Non Com Thin	
		Non-Standard Systems:*	
		HG Highgrade*	
		DL Diameter Limit*	

*If Other (OT) or a non-standard system is used an explanation must be given on attached narrative page

Forest Cutting Plan

Narrative Page (Effective Date: 1/1/04)
 Use this page to provide further explanation or if
 Other (OT) was used in any category on pages 3 or 4.

Landowner DCR-DWSP-Quab

Town New Salem

File Number _____

TIMBER LOT 3140 3138 SECTION B

BMPs

Use this Section to provide further explanation or if Other (OT) was used in any category in the Best Management Practices Section on Page 3. This project consists of 16 canopy openings (patches) and one half acre (0.5) thinning spaced across a 63 acre available harvest area. Stocking

reduction of diseased/dying hemlock is the primary goal of the project and the main criterion used in sighting openings. A secondary component is to reduce plantation red pine which also has pathogen vulnerability. The openings cover 6 acres, range between 0.1 and 0.5 acres and have an average of 0.3 acres. Live and dead snags are present in most openings and have been reserved (not marked) for habitat and structure.

Designation of Trees

Use this Section to describe the types of trees to be harvested and/or retained if Other (OT) was used for "Designation of Trees" in the Stand Treatment Section on page 4.

Stand No.	Species to be Cut	Size of Trees to be Cut	Quality of Trees to be Cut	% BA/Acre Removed
_____	_____	_____	_____	_____
_____	_____	_____	_____	_____
_____	_____	_____	_____	_____
_____	_____	_____	_____	_____

Regeneration & Future Condition

Use this Section to describe how Chapter 132 requirements will be met if a non standard system (HG, DL, or OT) was used for the "Type of Cut" in the Cutting Standards Section on page 4.

Stand No.	Source of Regeneration (ex. AD, SE)	How will Regeneration be obtained/protected? If using AD - Describe the species present and how the regeneration will be protected If using SE - Describe the source of the seed and the number of seed trees/acre
_____	_____	_____
_____	_____	_____
_____	_____	_____
_____	_____	_____

Stand No. **Desired Future Condition**
 Describe what the stand is expected to look like five years from the harvest, including the condition of the overstory & understory

_____	_____
_____	_____
_____	_____
_____	_____
_____	_____

Forest Cutting Plan

DCR-DWSP-Quab.

Narrative Page Continued

New Salem

Timber Lot ~~3140~~ 3138 SEC. B

Stream Crossings - Cont.

	SC-5	SC-6
Type of Crossing	FO/BR	CU
Existing Structure	N	Y
Type of Bottom	ST	ST
Bank Height (ft.)	<1'	<1'
Stabilization	CO	CO

BMPs cont.

Supplemental map is being filed displaying stream crossings on an existing watershed access road the DWSP may use to operationally link timber lots ~~3140~~^{3138A} and ~~3138~~^B. Travel of the road by logging equipment would be a onetime event when moving to one of the projects after completion of the other.

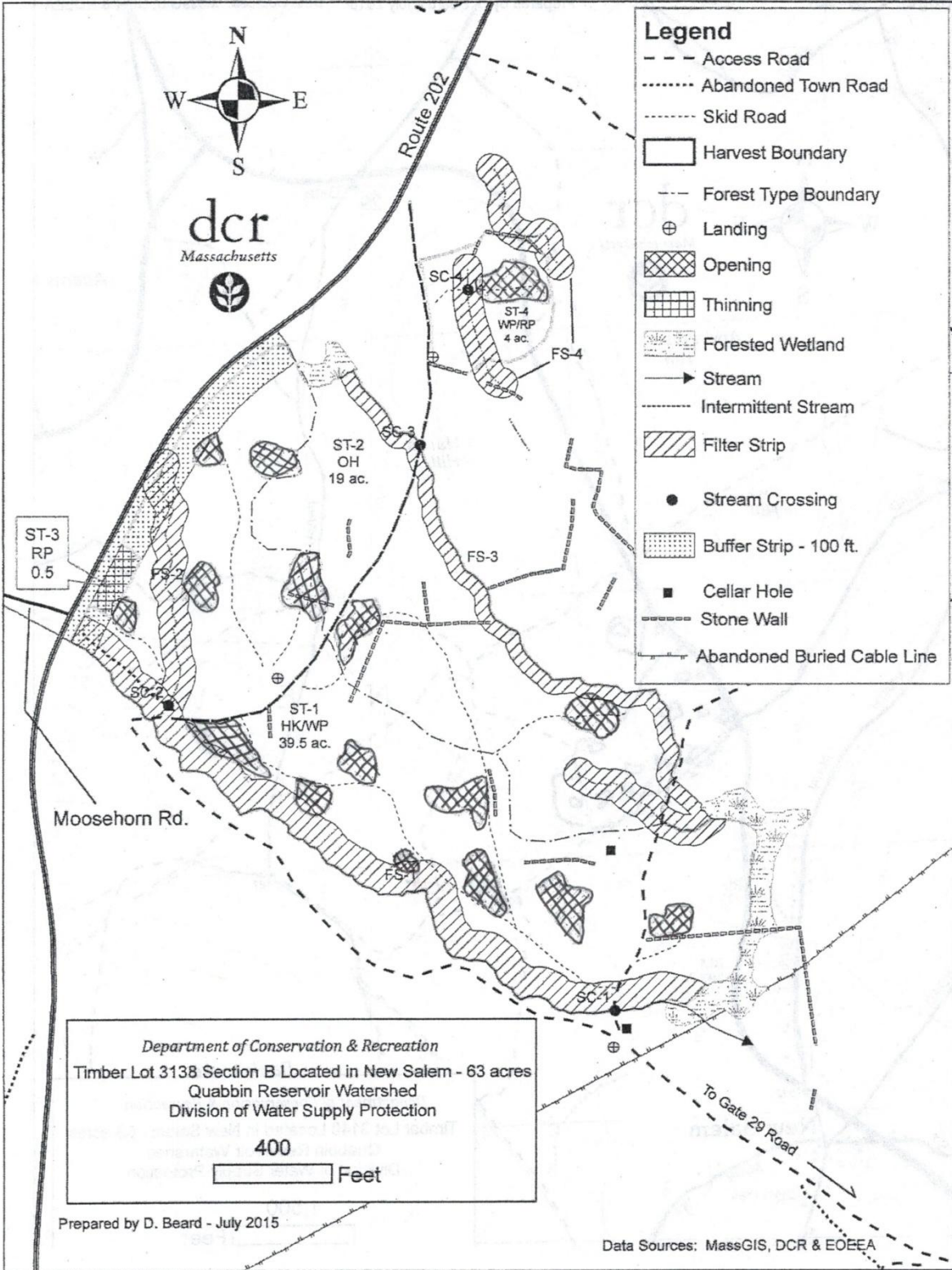

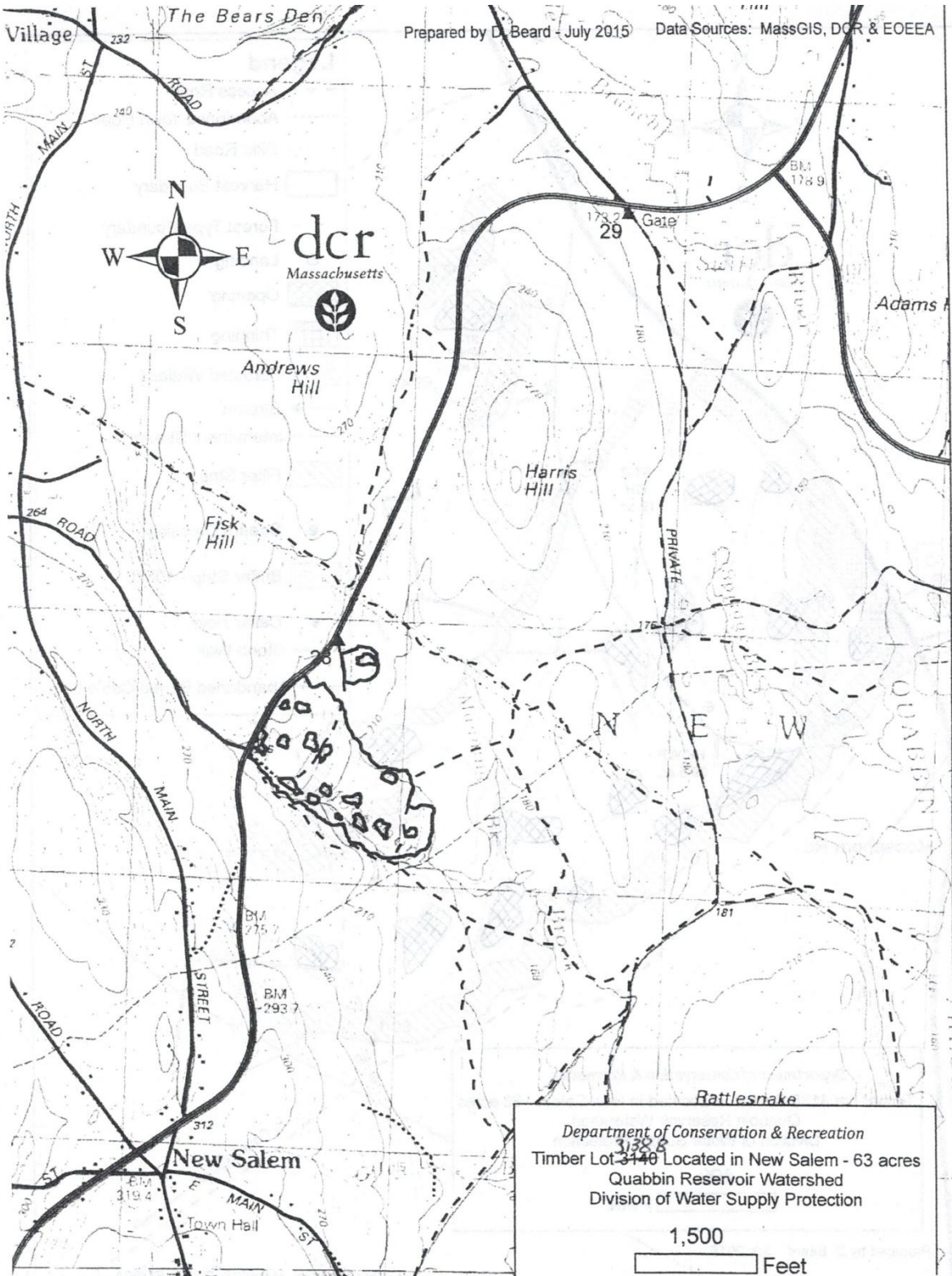

Department of Conservation & Recreation
 Timber Lot 3140 Located in New Salem - 63 acres
 Quabbin Reservoir Watershed
 Division of Water Supply Protection

1,500
 Feet

Department of Conservation & Recreation
Division of Water Supply Protection
Quabbin Reservoir
Supplemental Map Displaying Watershed Access Road
and Associated Stream Crossings between Timber lots 3140 and 3138
500 Feet

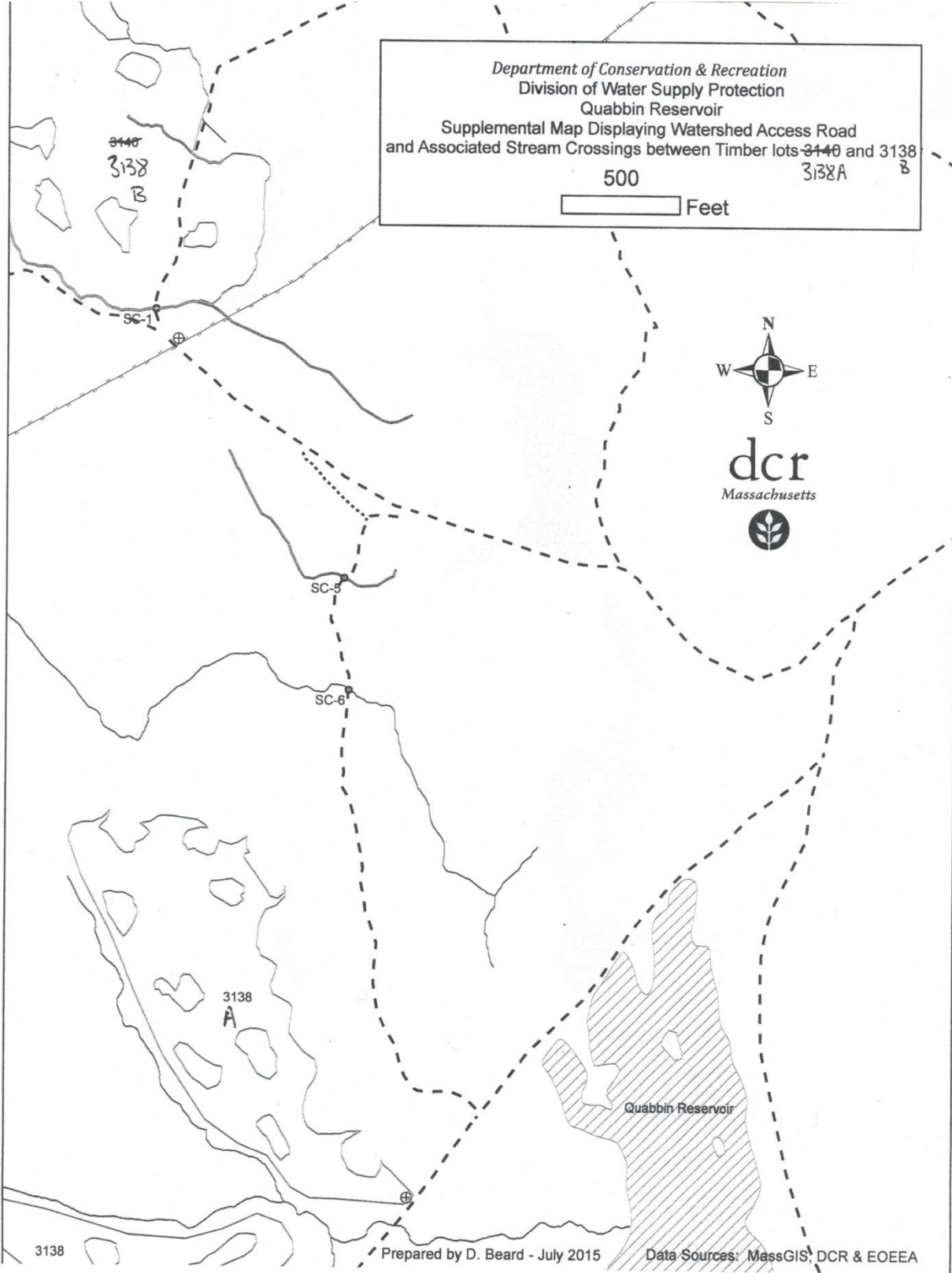

3138

Prepared by D. Beard - July 2015

Data Sources: MassGIS, DCR & EOEEA

dcr



COMMONWEALTH OF MASSACHUSETTS
Department of Conservation and Recreation
Division of State Parks and Recreation

FILE # 204-7749-16

W

FOREST CUTTING PLAN CERTIFICATE

Post this in a conspicuous place within the area in which the harvesting operation is to take place.

This certifies that DCR - Division of Water Supply Protection Ware Rd., Belchertown, MA in accordance with the
(Name of Owner) (Address)

provision of M.G.L. Chapter 132, Section 40-46, filed in the Amherst office with the Dept. of Conservation
and Recreation, Division of State Parks and Recreation, a Notice of Intent to cut forest products upon the
Moosehorn Brook Rd. lot.

Approval Date 8/27/2015

Director's Agent Fletcher Clark

DCR Phone No. (413) 262-2307 (forester)
(913) 545-5752 (clerk)

ISSUED BY:

Priscilla E. Geigis, Director
Division of State Parks and Recreation

Figure 2. Photo Point Pictures

Pre-Harvest, July 2015



Post Harvest, April 2017



July 2024 (8 years of growth)

