

**Massachusetts Department of Conservation and Recreation
Division of Water Supply Protection, Office of Watershed Management
*Forest Management Project Summary***

Project Title: Herman Powers Rd. South
DWSP Harvest Permit Number: 3146
DWSP Proposal ID: PR-16-11
DCR Forest Cutting Plan File Number: 204-8430-17

Site Information

Watershed: Quabbin
Town(s): New Salem
Acres: 10
Nearest Road: Route 202, Cooleyville Rd. (Gate 17)
Natural Heritage Atlas overlap?: Yes
Public Drinking Water Supply Watershed?: Yes
Forest Types: White Pine, Mixed Oak
Area of Critical Environmental Concern (ACEC)?: No
Soils: Chichester fine sandy loam
Wetland Resources: No
Vernal Pools: Yes (with 200 ft.)

Harvest Information

Harvest Start Date: May 23,2017
Harvest End Date: June 1,2017
Number of Wetland Crossings: 0
Number of Stream Crossings: 0

Best Management Practices Applied

Stream Crossings: Not Applicable
Filter Strips: One Filter Strip, 100 feet in width
Wetland Crossings: Not Applicable
Harvesting in Wetlands: Not Applicable

DWSP Forester supervising this harvest

Name: Derek Beard
Forester License number: 14
Phone number: 617-780-0631
Email: derek.beard@mass.gov

Narrative

General Description/Forest Composition/History

This watershed forest management project covers 10 acres located about mid-way down the Prescott peninsula. Specifically, it's situated on the east side of Herman Powers Road between gate 17 and 20 roads (intersections 17-8 and 20-6). The south boundary is Aiken Road, east along a wetland complex, north/northeast along a stone wall and Herman Powers Road to the west.

Fairly large low quality white pine sawtimber is the main forest cover. The southern quarter is a mixture of average quality oak (red, black, white and scarlet) sawtimber. A 1982 thinning triggered a regeneration layer of sapling/pole size black birch, white pine and red maple.

A myriad of adjacent and nearby stone walls coupled with old wire fence along Herman Powers Road suggest the area was pasture before being taken for watershed conservation in the 1920s.

This timber lot is located on the Prescott Peninsula, south of the reclaimed University of Massachusetts Astronomy site; along the east side of the Gate 17 road; the primary access through the peninsula. The forest is composed of White and Red Pine likely planted in the late 1930s. A thinning was completed in 1991. Proceeding the thinning, Red Oak seedlings were planted. As part of the 1927 original taking, this area was classified as arable and likely open (not forested) before public ownership. Believing that forest was the preferred watershed cover, early managers were quick to colonize these open areas with softwood plantations; like this one.

Site Selection

The primary goal of the watershed forest management program is to create and maintain a forest that provides high quality drinking water to current users and future generations. To achieve this, DWSP has determined that the forest should contain a diversity of species in various stages of development (seedlings through large legacy trees). In addition, the forest should be vigorous; actively growing and regenerating. Forest in this condition is suited to be resilient to and quickly recover from small- and large-scale disturbances such as disease, insect infestation, ice storms and hurricanes. Sufficient advanced regeneration coupled with an underrepresented young forest layer merits some regeneration harvesting.

Silvicultural Objectives

Diversification of forest structure and reducing stock of low-quality timber are the primary project objectives. This will be accomplished by a two-pronged forest management approach. First, a selection harvest consisting of two 2-acre openings situated on the west side of the project furthest from the wetland complex. And second, a shelterwood harvest situated between the openings and east bounding wetland complex. There are two shelterwood sections, being 1.5 and 0.5 acres each. The distinct difference between approaches is a shelterwood retains a significant number of overstory trees for seed, shade and/or protection; in this case shade for the adjacent wetland complex while a selection opening retains few if any overstory trees creating a highly stimulus forest regeneration scenario. In this case, the mid sections of both openings have randomly spaced overstory which include vigorous, declining live and dead standing trees. Partially dead and dead standing trees, known as snags, providing forage and cavity nesting/denning opportunity for an array of wildlife.

Cultural Resources

The project area is home to several small quarries/barrow pits adjacent to the wetland complex.

Rare or Endangered Species

The east side of the project area is bound by water resources including a beaver pond, wetland, vernal pool and intermittent brook. Vernal pools are important habitat for a variety of salamanders as well as invertebrates like fairy shrimp.

Figures

- Figure 1. Forest Cutting Plan
- Figure 2. Photo Point Pictures

Figure 1. Forest Cutting Plan

10-19-16A09:25 RCVD

Forest Cutting Plan

and Notice of Intent under M.G.L.
Chapter 132 – The Forest Cutting
Practices Act, 304 CMR 11.00
(Effective Date: 1/1/04)

For DCR Use Only:

File Number	204-8430-17	Case No.	
Date Rec'd	10/19/16	Nat. Hert.	Yes 1
Earliest Start	11/2/16	Nat. Hert. Imp.	NO
River Basin	Chicopee	Pub. Dr. Wat.	Quabbin
Gen. Obj.	LT	ACEC	NO

FINAL 9/17

Location Timber Lot 3146

Town New Salem

Road Herman Powers Rd. (Inside Gate 17)

Acres 10 Proposed Start Date _____

Vol. MBF 65.7 Vol. Cds. 24 Vol. Tons 294

Plan Preparer

Name Derek Beard

Address DCR – Div. of Water Supply Protection
21 Elm St.

Town, State, Zip New Salem, MA 01355

Phone 978-544-6343

Type of Preparer LF

*Mass. Forester License # 14

*Required for land under Ch61, Ch61A or Forest Stewardship

Landowner

Name DCR – Division of Water Supply Protection

Mailing Address 485 Ware Rd.

Town, State, Zip Belchertown, MA 01007

Phone 412-323-6921

Ch61 61A 61B Stew *Case # _____

CR CR Holder _____

Licensed Timber Harvester**

Name Chris Pinner Logging

Address 152 Williamsville Rd

Town, State, Zip Hubbardston, MA 01432

Phone 978-270-9916

Mass. Lic. Harvester # 587

**This information may be supplied after the plan is approved, but before work begins.

Stream Crossings

Indicate location on map	SC-1	SC-2	SC-3	SC-4
Type of Crossing				
Existing Structure				
Type of Bottom				
Bank Height (ft)				
Stabilization				

Wetland Crossings

Indicate location on map	WC-1	WC-2	WC-3	WC-4
Length of Crossing				
Mitigation				
Stabilization				

Filter Strips

Indicate location on map	FS-1	FS-2	FS-3	FS-4
Width (50', 100', or VA)	100			

Harvesting in Wetlands

Indicate location on map	HW-1	HW-2	HW-3	HW-4
Forest Type (see pg 2)				
Acres to be Harvested				
Resid. Basal Area (>50%)				

Service Forester Comments

Codes

Type of Preparer	Type of Crossing	Stabilization	Mitigation	Type of Bottom	Note:
LF Mass. Lic. For.	CU Culvert	SE Seed	FR Frozen	LE Ledge	Applicant must provide DCR with all relevant information before plan may be approved and cutting may begin. Some forestry activities, such as prescribed burning and pesticide or fertilizer application may require additional permits. Consult MA Forestry BMP Manual for further information
TH Lic. Tim. Har	BR Bridge	MU Mulch	DR Dry	ST Stony	
TB Timber Buyer	FO Ford	CO Corduroy	OT Other	MU Mud	
LO Landowner	PO Poled	ST Stone		GR Gravel	
OT Other	OT Other	HB Hay Bales		OT Other	
		OT Other			

If Other (OT) is used in any category an explanation must be given on an attached narrative page

Forest Products

Products to be Harvested* Timber Lot 3146

Species	Mbf/Cds		Mbf/Cds
White Pine	61	Red Maple	1.9
Red Pine		Sugar Maple	
Pitch Pine		Red Oak	
Hemlock		Black Oak	1.3
Spruce		White Oak	
Other Sftwd.		Other Hdwd.	.6
White Ash		Total Mbf	65.7
Beech		Cordwood (Cds)	24
White Birch		SW Pulp (Tons)	294
B & Y Birch	.9	HW Pulp (Tons)	
Black Cherry		Chips (Tons)	

*Note: Volumes and values indicated in the Plan are as reported by the plan preparer and have not been independently verified by the service forester upon approval. Mbf = thousand board feet.

Stand Treatment

Cutting Standards

Indicate location on map	ST-1	ST-2	ST-3	ST-4
Forest Type	WP	WP	WP	WP
Acres	2	2	.5	1.5
Landowner Objective	LT	LT	LT	LT
Designation of Trees	CT	CT	CT	CT
Type of Cut	SE	SE	SH	SH
Source of Regeneration	SE/AD	SE/AD	SE/AD	SE/AD

Landowner

Landowner Signature

The most important information on a cutting plan is the Landowner's objective, as this will determine which trees will be harvested and which will remain; this decision will also determine the future condition of the forest for decades to come. After having read the Massachusetts Forest Cutting Plan Information Sheet on page one, indicate your objective by checking the appropriate box below.

LT - Long-term Forest Management

Planned management of the forest to achieve one or more of the following objectives: produce immediate and maximize long-term income, enhance wildlife habitat, improve recreational opportunities, protect soil and water quality, or produce forest specialty products.

ST - Short-term Harvest

Harvest of trees with the main intention of producing short-term income with minimal consideration given to improving the future forest condition, which often results in a forest dominated by poor quality and low value species.

I (we) have read the Massachusetts Cutting Plan Information Sheet, and am aware of my (our) management options.
 I (we) hereby certify that I (we) have the legal authority to carry out the operation described above.
 I (we) certify that I (we) have notified the Conservation Commission in the town in which the operation is to take place and the abutters of record within two hundred feet of the area to be harvested.
 I (we) understand that the volumes and values (Ch61 only) in this plan have not been independently verified by the service forester upon approval and will report final values and volumes to the Director or his/her agent if the final figures differ from those reported.

[Signature] 10-13-16
 Signature of landowner(s) Date

Service Forester

Determination and Status 204-8430-17

Approved Disapproved Expires 10/26/2018
[Signature] 11/1/16
 Signature of Service Forester/Director's Agent Date

Final Report and Comments

I hereby certify that the afore described Forest Cutting Plan and all relevant statutes have been substantially complied with.
[Signature] 6/13/17
 Signature of Service Forester/Director's Agent Date

Codes

Extension 1 2 Expires 1 Ser. For. Ints. 1
 Amendment App 1 Dis 1 App 2 Dis 2

Forest Types	Designation of Trees	Type of Cut	Source of Regeneration
WP White Pine	CT Cut Tree	SH Shelterwood	AD Advanced
WK WP/Hem	LT Leave Tree	ST Seed Tree	SE Natural Seed
WH WP/Hdwd	SB Stand Boundary	CC Clear Cut	NT Non Com Thin
WO WP/Oak	OT Other	SE Selection	PL Plant
RP Red Pine	Landowner Objective	SA Salvage	CO Coppice
SR Red Spruce	LT Long-term Mgt	SN Sanitation	DS Direct Seed
	ST Short-term Har.	OT Other*	OT Other

*If Other (OT) or a non-standard system is used an explanation must be given on attached narrative page pg 4 of 5

Forest Cutting Plan

Narrative Page (Effective Date: 1/1/04)
 Use this page to provide further explanation or if
 Other (OT) was used in any category on pages 3 or 4.
 Timber Lot 3146

Landowner DCR-DWSP-Quab

Town New Salem

File Number 204-8430-17

BMPs

Use this Section to provide further explanation or if Other (OT) was used in any category in the Best Management Practices Section on Page 3.
 The 10 acre harvest area is composed of 2 two acre openings separated by 200 feet of un-harvested forest. These openings have retention trees
 equivalent to at least 5 square feet of basal area per acre. Openings are marked blue. There are two shelterwood stands separated by
 un-harvested forest. These stands have 60 square feet of residual basal area and are marked orange. Landing and skid roads are marked both
 blue and orange. There are 4 acres of un-harvested or original condition forest.

Designation of Trees

Use this Section to describe the types of trees to be harvested and/or retained if Other (OT) was used for "Designation of Trees"
 in the Stand Treatment Section on page 4.

Stand No.	Species to be Cut	Size of Trees to be Cut	Quality of Trees to be Cut	% BA/Acre Removed

Regeneration & Future Condition

Use this Section to describe how Chapter 132 requirements will be met if a non standard system (HG, DL, or OT)
 was used for the "Type of Cut" in the Cutting Standards Section on page 4.

Stand No.	Source of Regeneration (ex. AD, SE)	How will Regeneration be obtained/protected? If using AD - Describe the species present and how the regeneration will be protected If using SE - Describe the source of the seed and the number of seed trees/acre

Stand No. **Desired Future Condition**
 Describe what the stand is expected to look like five years from the harvest, including the condition of the overstory & understory

Department of Conservation & Recreation
 Division of Water Supply Protection
 Timber Lot 3146 Located in New Salem - 10 acres
 Quabbin Reservoir Watershed
 200
 Feet

- Legend**
- - - Access Road
 - No Cut
 - ▨ Opening
 - ▧ Shelterwood
 - ⊕ Landing
 - · - · - Skid Road
 - ▨ Wetland
 - · - · - Intermittent Stream
 - ☆ Vernal Pool
 - ▨ Filter Strip
 - · - · - Stone Wall

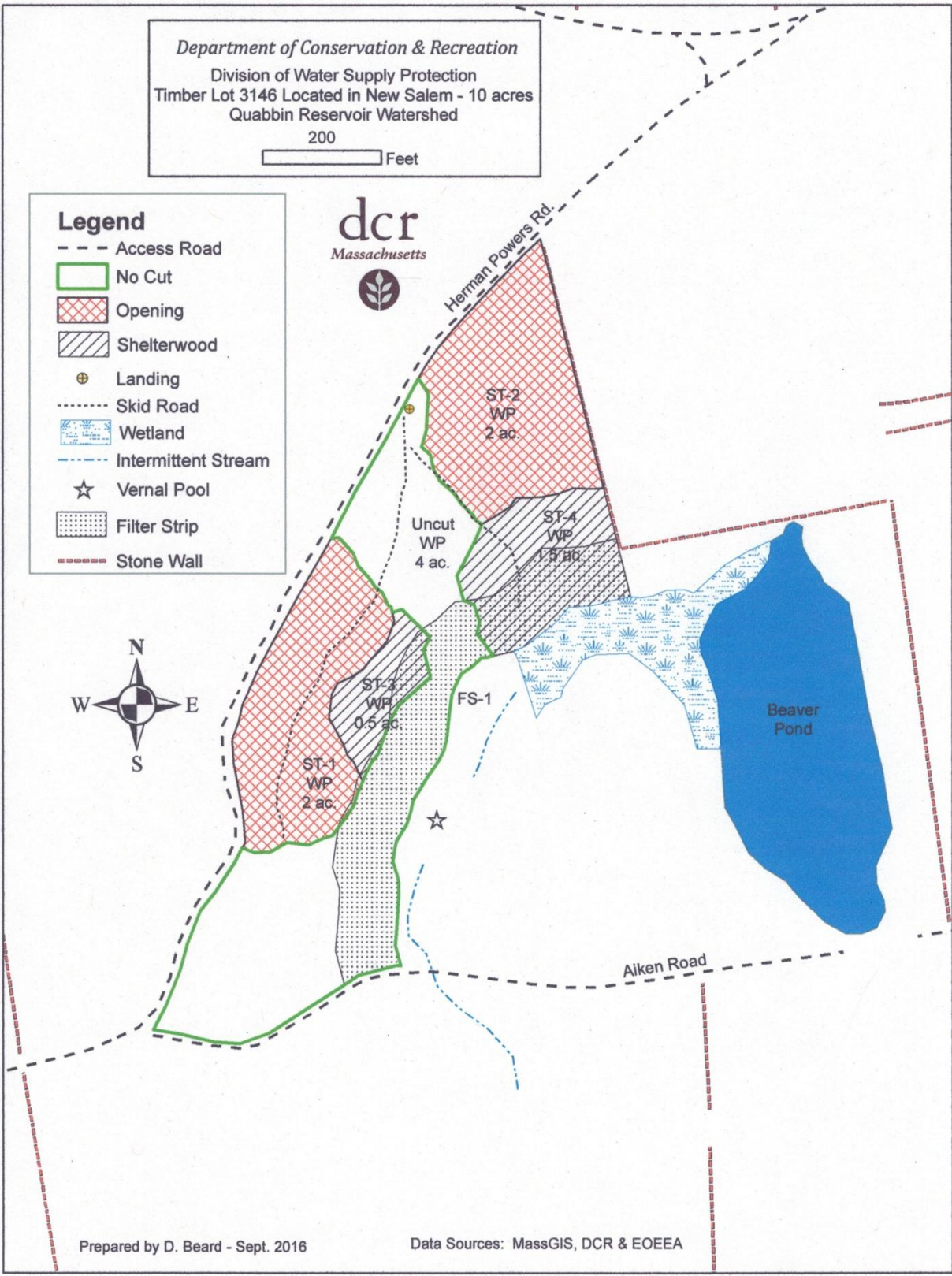

Prepared by D. Beard - Sept. 2016

Data Sources: MassGIS, DCR & EOEEA

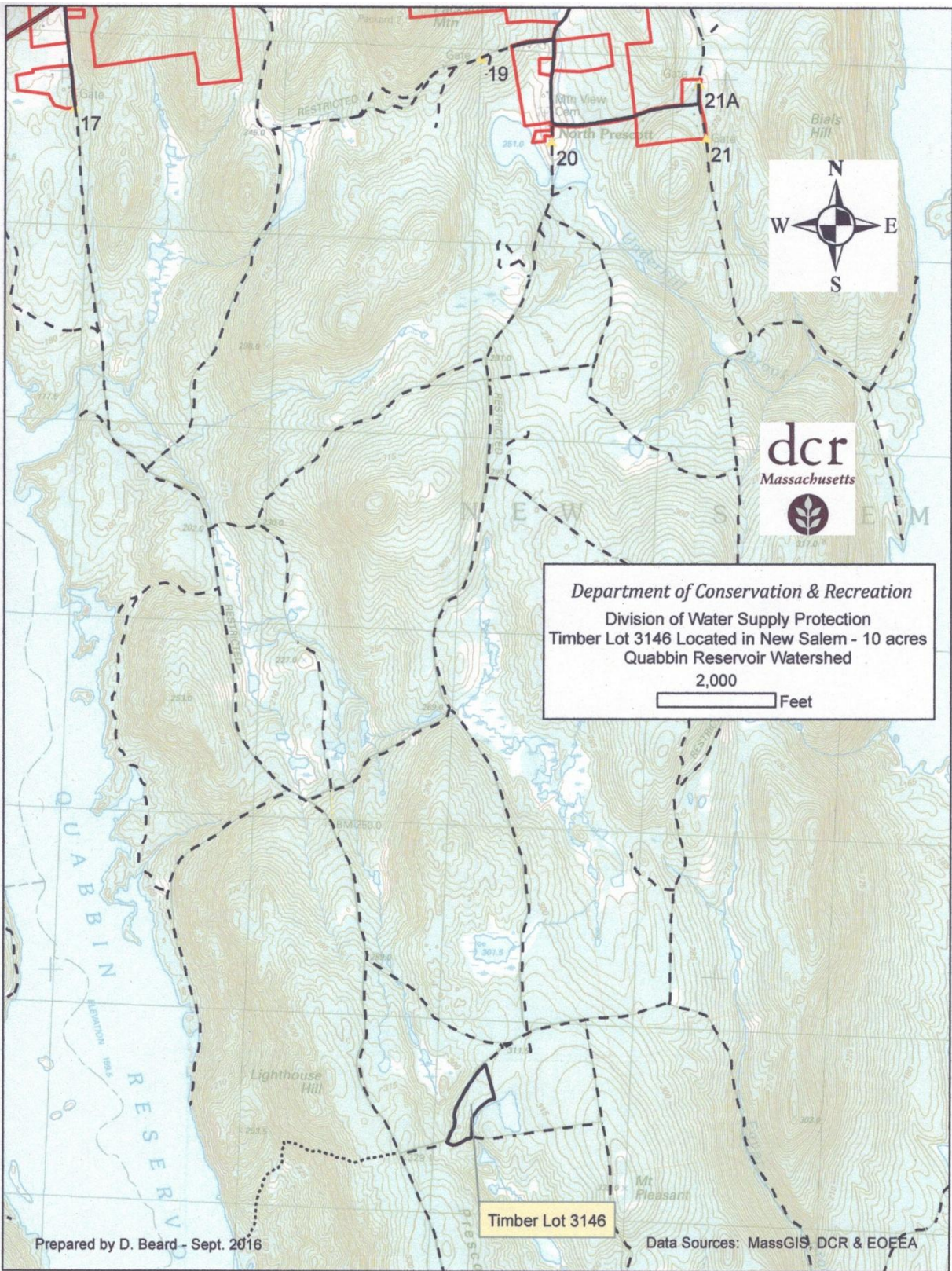

Department of Conservation & Recreation
Division of Water Supply Protection
Timber Lot 3146 Located in New Salem - 10 acres
Quabbin Reservoir Watershed
2,000
Feet

Timber Lot 3146

Prepared by D. Beard - Sept. 2016

Data Sources: MassGIS, DCR & EOE&A



MASSWILDLIFE

DIVISION OF FISHERIES & WILDLIFE

1 Rabbit Hill Road, Westborough, MA 01581

p: (508) 389-6300 | f: (508) 389-7890

MASS.GOV/MASSWILDLIFE

Jack Buckley, Director

Fletcher Clark - Department of Conservation and Recreation
40 Cold Storage Drive
P.O. Box 484
Amherst, MA 01004

Cutting Plan No.	204-8430-17
NHESP Tracking No.	16-36186
Town	New Salem
Road	Herman Powers Road
Landowner	DCR - DWSP
Preparer	Derek Beard
Date	November 28, 2016

Dear Fletcher,

The Natural Heritage and Endangered Species Program ("the NHESP") of the Massachusetts Division of Fisheries and Wildlife ("the Division") has reviewed the above-referenced Forest Cutting Plan (hereinafter "the Plan") pursuant to the special approval procedures of the Forest Cutting Practices Regulations (304 CMR 11.04(6)). Based on details of the Plan and information in the NHESP database, the Division does not expect activities proposed in the Plan to negatively impact Estimated Habitat or result in "Take" (as defined in 321 CMR 10.02) of plant or animal species protected under the Massachusetts Endangered Species Act (MESA) (M.G.L. c. 131A) and its implementing regulations (321 CMR 10.00). Therefore, the Division does not require that the Plan be modified at this time.

Please copy the Division on any proposed amendment, extension and on the approved Plan for the site. If you have any questions about this letter, please contact Brent Powers at (508) 389-6354 or brent.powers@state.ma.us.

Sincerely,

Thomas W. French, Ph.D.
Assistant Director

Cc: New Salem Conservation Commission (via e-mail)

MASSWILDLIFE

dcr



COMMONWEALTH OF MASSACHUSETTS
Department of Conservation and Recreation
Division of State Parks and Recreation

FILE # 204-8430-17

FOREST CUTTING PLAN CERTIFICATE

Post this in a conspicuous place within the area in which the harvesting operation is to take place.

This certifies that DCR Quabbin (Name of Owner) Belchertown (Address) in accordance with the

provision of M.G.L. Chapter 132, Section 40-46, filed in Amherst with the Dept. of Conservation and Recreation, Division of State Parks and Recreation, a Notice of Intent to cut forest products upon the 3146 lot.

Approval Date 11-1-2016

Director's Agent FLETCHER CLARK

DCR Phone No. 413-262-2367

ISSUED BY:

Priscilla E. Geigis, Director
Division of State Parks and Recreation

Figure 2. Photo Point Pictures

Pre-Harvest, October 2016



Post Harvest, June 2017



July 2024 (7 years of growth)

