

**Massachusetts Department of Conservation and Recreation
Division of Water Supply Protection, Office of Watershed Management
*Forest Management Project Summary***

Project Title: Old Town Line Lot
DWSP Harvest Permit Number: 3151
DWSP Proposal ID: PR-17-06-A
DCR Forest Cutting Plan File Number: 204-9094-18

Site Information

Watershed: Quabbin
Town(s): New Salem
Acres: 65
Nearest Road: Cooleyville Rd. (Gate 17)
Natural Heritage Atlas overlap?: Yes
Public Drinking Water Supply Watershed?: Yes
Forest Types: White Pine, Mixed Oak
Area of Critical Environmental Concern (ACEC)?: No
Soils: Montauk fine sandy loam, Canton-Chatfield-Hollis complex
Wetland Resources: No
Vernal Pools: Yes

Harvest Information

Harvest Start Date: January 8, 2018
Harvest End Date: February 2, 2018
Number of Wetland Crossings: 0
Number of Stream Crossings: 0

Best Management Practices Applied

Stream Crossings: Not Applicable
Filter Strips: One 100 feet wide
Wetland Crossings: Not Applicable
Harvesting in Wetlands: Not Applicable

DWSP Forester supervising this harvest

Name: Derek Beard
Forester License number: 14
Phone number: 617-780-0631
Email: derek.beard@mass.gov

Narrative

General Description/Forest Composition/History

This watershed forest management project covers 65 acres of upland amid and 2/3s the way down the Prescott Peninsula. Specifically, it's about 1 ½ miles south of the old UMASS observatory on the east side of gate 17 Road (Cooleyville Rd.). It's bounded to the north by forest type change, wetland and brook, to the east by forest type change and old property line, to the south by forest type change, intermittent brook, wetland and stone wall and to the west by gate 17 road.

The project is concentrated on a 30-acre section of average to low quality white pine. The worst of the pine has cabbage type form indicative of trees growing in an open environment typically associated with agricultural abandonment. Much of the area has a robust understory of mostly white pine and a scattering of black birch saplings that developed following a light thinning in the late 1980s.

Site Selection

The primary goal of the watershed forest management program is to create and maintain a forest that provides high quality drinking water to current users and future generations. To achieve this, DWSP has determined that the forest should contain a diversity of species in various stages of development (seedlings through large legacy trees). In addition, the forest should be vigorous; actively growing and regenerating. Forest in this condition is suited to be resilient to and quickly recover from small and large scale disturbances such as disease, insect infestation, ice storms and hurricanes. Sufficient advanced regeneration coupled with an underrepresented young forest layer merits some regeneration harvesting.

Silvicultural Objectives

The project has a dual objective of removing low quality timber and diversifying forest structure. This will be accomplished by creating openings (a.k.a. patches) in the forest canopy. Specifically, this project has 6 openings ranging between 0.75 and 2 acres with an average of 1.3 acres. Openings greater than 0.5 acres have retention trees which will add to future forest complexity.

Cultural Resources

Myriad stone walls typical of new England's forest landscape.

Rare or Endangered Species

Maintaining and/or enhancing habitat is a high priority when planning and executing watershed forest management projects. As such, retaining live and dead snags, trees that show sign of use by wildlife for nesting/denning, scenting and foraging is a priority.

Adjacent to the north harvest boundary is a vernal pool; a seasonal wetland that provides breeding habitat for amphibious and invertebrate fauna.

The project does intersect with a MA Natural Heritage Endanger Species Program (NHESP) bubble. Upon NHESP review, the project was deemed to have no impact on the protected flora and/or fauna.

Figures

- Figure 1. Forest Cutting Plan
- Figure 2. Photo Point Pictures

Figure 1. Forest Cutting Plan

Forest Cutting Plan

and Notice of Intent under M.G.L. Chapter 132 – The Forest Cutting Practices Act, 304 CMR 11.00 (Effective Date: 1/1/04)

For DCR Use Only:

File Number 204-9094-18 Case No. _____
 Date Rec'd 11/11/17 Nat. Hert. 11/6/17
 Earliest Start 11/17/17 Nat. Hert. Imp. _____
 River Basin Chicopee Pub. Dr. Wat. _____
 Gen. Obj. LT ACEC _____

Final (2/18)

Site Information	Location <u>Timber Lot 3151</u>	Landowner
	Town <u>New Salem</u>	Name <u>DCR – Division of Water Supply Protection</u>
	Road <u>Cooleyville Rd. (Gate 17)</u>	Mailing Address <u>485 Ware Rd.</u>
	Acres <u>65</u> Proposed Start Date _____	Town, State, Zip <u>Belchertown, MA 01007</u>
	Vol. MBF <u>109.4</u> Vol. Cds. <u>85</u> Vol. Tons <u>496</u>	Phone <u>412-323-6921</u>
	Plan Preparer	Ch61 <input type="checkbox"/> 61A <input type="checkbox"/> 61B <input type="checkbox"/> Stew <input type="checkbox"/> *Case # _____
	Name <u>Derek Beard</u>	CR <input type="checkbox"/> CR Holder _____
	Address <u>DCR – Div. of Water Supply Protection</u> <u>21 Elm St.</u>	Licensed Timber Harvester**
	Town, State, Zip <u>New Salem, MA 01355</u>	Name <u>Wagner Wood</u>
	Phone <u>978-544-6343</u>	Address <u>305 Northeast St.</u>
Type of Preparer <u>LF</u>	Town, State, Zip <u>Amherst, MA 01002</u>	
*Mass. Forester License # <u>14</u>	Phone <u>413-253-5194</u>	
*Required for land under Ch61, Ch61A or Forest Stewardship	Mass. Lic. Harvester # <u>2018-775 + 393</u>	
	**This information may be supplied after the plan is approved, but before work begins.	

Best Management Practices	Stream Crossings	Harvesting in Wetlands																														
	Indicate location on map	<table border="1"> <thead> <tr> <th></th> <th>HW-1</th> <th>HW-2</th> <th>HW-3</th> <th>HW-4</th> </tr> </thead> <tbody> <tr> <td>Forest Type (see pg 2)</td> <td></td> <td></td> <td></td> <td></td> </tr> <tr> <td>Acres to be Harvested</td> <td></td> <td></td> <td></td> <td></td> </tr> <tr> <td>Resid. Basal Area (>50%?)</td> <td></td> <td></td> <td></td> <td></td> </tr> </tbody> </table>		HW-1	HW-2	HW-3	HW-4	Forest Type (see pg 2)					Acres to be Harvested					Resid. Basal Area (>50%?)														
		HW-1	HW-2	HW-3	HW-4																											
	Forest Type (see pg 2)																															
	Acres to be Harvested																															
	Resid. Basal Area (>50%?)																															
	<table border="1"> <thead> <tr> <th></th> <th>SC-1</th> <th>SC-2</th> <th>SC-3</th> <th>SC-4</th> </tr> </thead> <tbody> <tr> <td>Type of Crossing</td> <td></td> <td></td> <td></td> <td></td> </tr> <tr> <td>Existing Structure</td> <td></td> <td></td> <td></td> <td></td> </tr> <tr> <td>Type of Bottom</td> <td></td> <td></td> <td></td> <td></td> </tr> <tr> <td>Bank Height (ft)</td> <td></td> <td></td> <td></td> <td></td> </tr> <tr> <td>Stabilization</td> <td></td> <td></td> <td></td> <td></td> </tr> </tbody> </table>		SC-1	SC-2	SC-3	SC-4	Type of Crossing					Existing Structure					Type of Bottom					Bank Height (ft)					Stabilization					
		SC-1	SC-2	SC-3	SC-4																											
	Type of Crossing																															
	Existing Structure																															
Type of Bottom																																
Bank Height (ft)																																
Stabilization																																
Wetland Crossings	Service Forester Comments																															
Indicate location on map	_____																															
<table border="1"> <thead> <tr> <th></th> <th>WC-1</th> <th>WC-2</th> <th>WC-3</th> <th>WC-4</th> </tr> </thead> <tbody> <tr> <td>Length of Crossing</td> <td></td> <td></td> <td></td> <td></td> </tr> <tr> <td>Mitigation</td> <td></td> <td></td> <td></td> <td></td> </tr> <tr> <td>Stabilization</td> <td></td> <td></td> <td></td> <td></td> </tr> </tbody> </table>		WC-1	WC-2	WC-3	WC-4	Length of Crossing					Mitigation					Stabilization					_____											
	WC-1	WC-2	WC-3	WC-4																												
Length of Crossing																																
Mitigation																																
Stabilization																																
Filter Strips	_____																															
Indicate location on map	_____																															
<table border="1"> <thead> <tr> <th></th> <th>FS-1</th> <th>FS-2</th> <th>FS-3</th> <th>FS-4</th> </tr> </thead> <tbody> <tr> <td>Width (50', 100', or VA)</td> <td><u>NAR</u></td> <td></td> <td></td> <td></td> </tr> </tbody> </table>		FS-1	FS-2	FS-3	FS-4	Width (50', 100', or VA)	<u>NAR</u>				_____																					
	FS-1	FS-2	FS-3	FS-4																												
Width (50', 100', or VA)	<u>NAR</u>																															

Codes	Type of Preparer	Type of Crossing	Stabilization	Mitigation	Type of Bottom	Note:
	LF Mass. Lic. For	CU Culvert	SE Seed	FR Frozen	LE Ledge	Applicant must provide DCR with all relevant information before plan may be approved and cutting may begin.
	TH Lic. Tim. Har	BR Bridge	MU Mulch	DR Dry	ST Stony	Some forestry activities, such as prescribed burning and pesticide or fertilizer application may require additional permits.
	TB Timber Buyer	FO Ford	CO Corduroy	OT Other	MU Mud	Consult MA Forestry BMP Manual for further information
	LO Landowner	PO Poled	ST Stone		GR Gravel	
	OT Other	OT Other	HB Hay Bales		OT Other	
			OT Other			

If Other (OT) is used in any category an explanation must be given on an attached narrative page

Forest Products

Products to be Harvested* Timber Lot 3151

Species	Mbf/Cds		Mbf/Cds
White Pine	91.4	Red Maple	6.7
Red Pine		Sugar Maple	
Pitch Pine		Red Oak	5.0
Hemlock		Black Oak	4.8
Spruce		White Oak	0.4
Other Sftwd.		Other Hdw.	
White Ash	0.9	Total Mbf	109.4
Beech		Cordwood (Cds)	85
White Birch		SW Pulp (Tons)	496
B & Y Birch		HW Pulp (Tons)	
Black Cherry	0.2	Chips (Tons)	

*Note: Volumes and values indicated in the Plan are as reported by the plan preparer and have not been independently verified by the service forester upon approval. Mbf = thousand board feet.

Stand Treatment

Cutting Standards

Indicate location on map	ST-1	ST-2	ST-3	ST-4
Forest Type	WP	WP	OH	WH
Acres	26	3	3	14
Landowner Objective	LT	LT	N/A	N/A
Designation of Trees	CT	CT	N/A	N/A
Type of Cut	SE	SE	N/A	N/A
Source of Regeneration	SE/AD	SE	N/A	N/A

Landowner

Landowner Signature

The most important information on a cutting plan is the Landowner's objective, as this will determine which trees will be harvested and which will remain; this decision will also determine the future condition of the forest for decades to come. After having read the Massachusetts Forest Cutting Plan Information Sheet on page one, indicate your objective by checking the appropriate box below.

LT - Long-term Forest Management

Planned management of the forest to achieve one or more of the following objectives: produce immediate and maximize long-term income, enhance wildlife habitat, improve recreational opportunities, protect soil and water quality, or produce forest specialty products.

ST - Short-term Harvest

Harvest of trees with the main intention of producing short-term income with minimal consideration given to improving the future forest condition, which often results in a forest dominated by poor quality and low value species.

I (we) have read the Massachusetts Cutting Plan Information Sheet, and am aware of my (our) management options.
 I (we) hereby certify that I (we) have the legal authority to carry out the operation described above.
 I (we) certify that I (we) have notified the Conservation Commission in the town in which the operation is to take place and the abutters of record within two hundred feet of the area to be harvested.
 I (we) understand that the volumes and values (Ch61 only) in this plan have not been independently verified by the service forester upon approval and will report final values and volumes to the Director or his/her agent if the final figures differ from those reported.

Signature of landowner(s)

10-24-17
 Date

Service Forester

Determination and Status 204-9094-18

Approved Disapproved Expires 11/1/19

Cutting Plan

Signature of Service Forester/Director's Agent

11/26/2017
 Date

Extension 1 2 Expires _____ Ser. For. Ints. _____

Amendment App 1 Dis 1 App 2 Dis 2

Final Report and Comments

I hereby certify that the afore described Forest Cutting Plan and all relevant statutes have been substantially complied with.

Signature of Service Forester/Director's Agent

2-28-2018
 Date

Codes

Forest Types	HK Hemlock	OM Mixed Oak	Designation of Trees	SH Shelterwood	Intermediate Harvests:	Source of Regeneration
WP White Pine	HH Hem/Hdw	RM Red Maple	CT Cut Tree	ST Seed Tree	CT Commercial Thin	AD Advanced
WK WP/Hem	BC Blk Cherry	BE Beech	LT Leave Tree	CC Clear Cut	NT Non Com Thin	SE Natural Seed
WH WP/Hdw	BB Bee/Bir/Map	SF Spruce/Fir	SB Stand Boundary	SE Selection	Non-Standard Systems:	PL Plant
WO WP/Oak	OH Oak/Hdw	SM Sugar Maple	OT Other	SA Salvage	HG Highgrade*	CO Coppice
RP Red Pine	OR N Red Oak	PP Pitch Pine	Landowner Objective	SN Sanitation	DL Diameter Lima*	DS Direct Seed
SR Red Spruce			LT Long-term Mgt.	OT Other*	OT Other	OT Other

*If Other (OT) or a non-standard system is used an explanation must be given on attached narrative page

Cutting Standards (cont.)

Stand Treatment

Indicate location on map	ST-5	ST-6	ST-7	
Forest Type	OH	RP	RP	
Acres	9	9	1	
Landowner Objective	N/A	N/A	N/A	
Designation of Trees	N/A	N/A	N/A	
Type of Cut	N/A	N/A	N/A	
Source of Regeneration	N/A	N/A	N/A	

Forest Cutting Plan

Narrative Page (Effective Date: 1/1/04)

Use this page to provide further explanation or if Other (OT) was used in any category on pages 3 or 4.
Timber Lot 3151

Landowner DCR-DWSP-Quab

Town New Salem

File Number 204-9094-18

BMPs

Use this Section to provide further explanation or if Other (OT) was used in any category in the Best Management Practices Section on Page 3.

This project covers the white pines stands (29 acres) of the management area (65 acres). There are six openings encompassing a total area of

8 acres. Openings range between 0.7 to 2 acres in size with an average of 1.3. All openings have some retention (min. 5 sq. ft. of basal area per

acre) which include dead standing trees. The landing and main skid roads are marked in yellow paint. All openings, except one (southern most),

are marked in orange paint. The southern most opening is marked in yellow paint. Harvest boundary is a mix of flagging and triple striped paint

marking.

Designation of Trees

Use this Section to describe the types of trees to be harvested and/or retained if Other (OT) was used for "Designation of Trees" in the Stand Treatment Section on page 4.

Stand No.	Species to be Cut	Size of Trees to be Cut	Quality of Trees to be Cut	% BA/Acre Removed

Regeneration & Future Condition

Use this Section to describe how Chapter 132 requirements will be met if a non standard system (HG, DL, or OT) was used for the "Type of Cut" in the Cutting Standards Section on page 4.

Stand No.	Source of Regeneration (ex. AD, SE)	How will Regeneration be obtained/protected? If using AD - Describe the species present and how the regeneration will be protected If using SE - Describe the source of the seed and the number of seed trees/acre

Stand No. **Desired Future Condition**
Describe what the stand is expected to look like five years from the harvest, including the condition of the overstory & understory

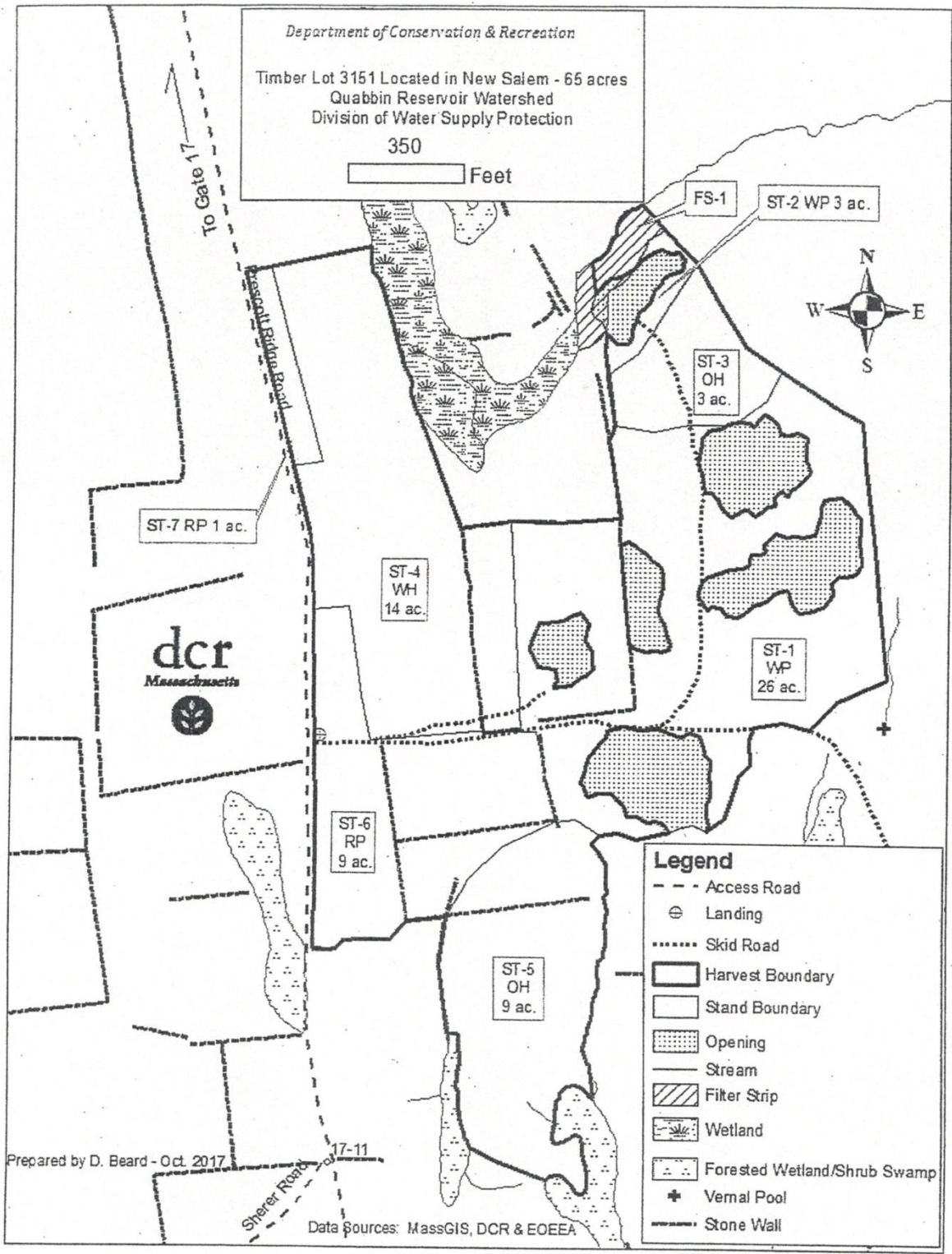

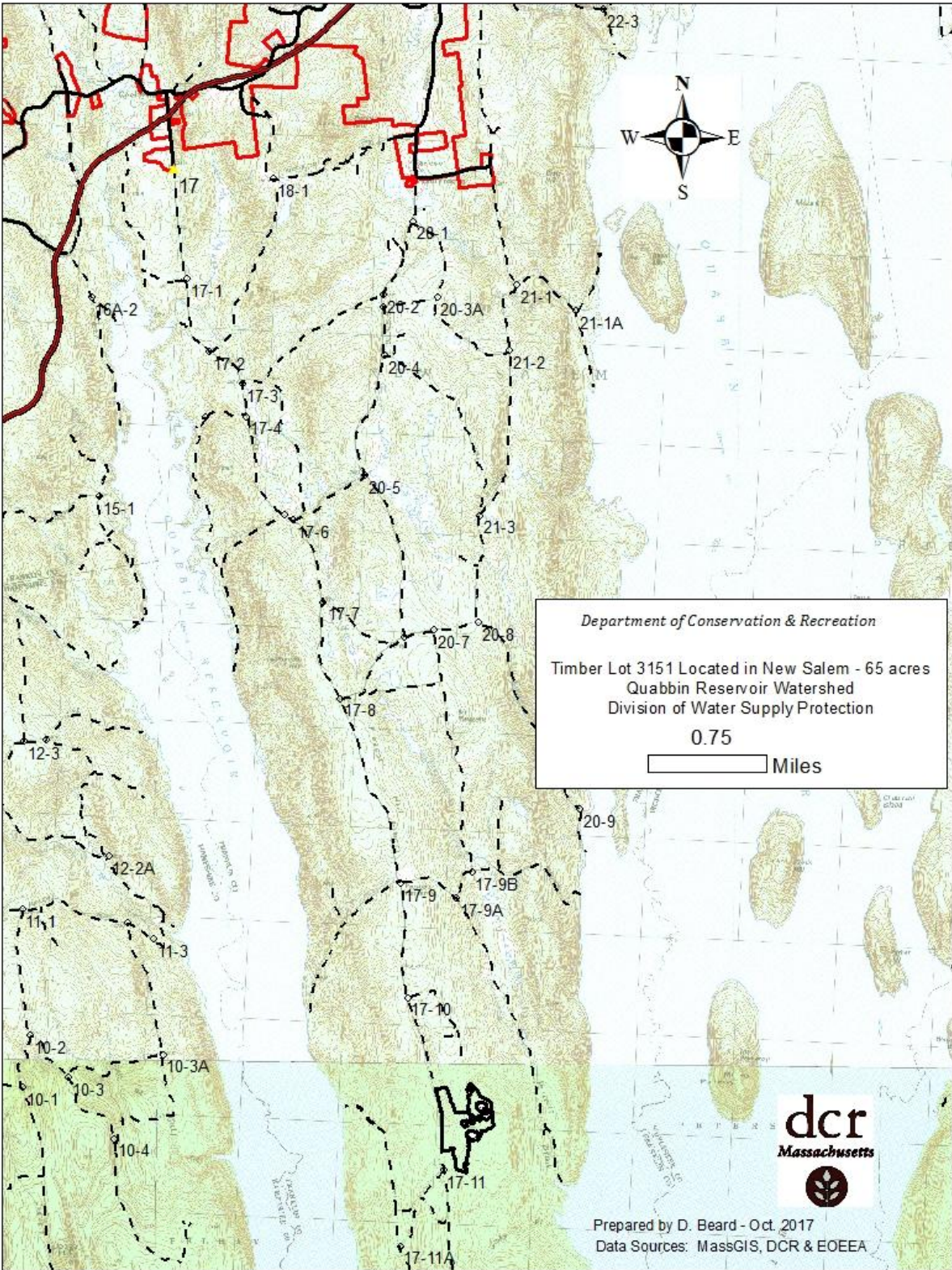



MASSWILDLIFE

DIVISION OF
FISHERIES & WILDLIFE

1 Rabbit Hill Road, Westborough, MA 01581
p: (508) 389-6300 | f: (508) 389-7890
MASS.GOV/MASSWILDLIFE

Jack Buckley, *Director*

Sean Libbey
Department of Conservation and Recreation
40 Cold Storage Drive
Amherst, MA 01004

Cutting Plan No. 204-9094-18
NHESP Tracking No. 17-37280
Town New Salem
Road Cooleyville Road
Landowner DCR- Watershed Protection
Preparer Derek Beard
Date November 13, 2017

Dear Sean,

The Natural Heritage and Endangered Species Program ("the NHESP") of the Massachusetts Division of Fisheries and Wildlife ("the Division") has reviewed the above-referenced Forest Cutting Plan ("the Plan") pursuant to the special approval procedures of the Forest Cutting Practices Regulations (304 CMR 11.04(6)). Based on details of the Plan and information in the NHESP database, the Division does not expect activities proposed in the Plan to negatively impact Estimated Habitat or result in "Take" (as defined in 321 CMR 10.02) of plant or animal species protected under the Massachusetts Endangered Species Act (MESA) (M.G.L. c. 131A) and its implementing regulations (321 CMR 10.00). Therefore, the Division does not require that the Plan be modified at this time.

Please copy the Division on any proposed amendment, extension and on the approved Plan for the site. If you have any questions about this letter, please contact David Paulson at (508) 389-6366 or david.paulson@state.ma.us.

Sincerely,

Thomas W. French, Ph.D.
Assistant Director

Cc: New Salem Conservation Commission

MASSWILDLIFE

DCI

COMMONWEALTH OF MASSACHUSETTS
Department of Conservation and Recreation
Division of State Parks and Recreation



FILE # 204.9094.18

W

FOREST CUTTING PLAN CERTIFICATE

Post this in a conspicuous place within the area in which the harvesting operation is to take place.

This certifies that DCR-DWSP 485 Ware Rd, Belchertown, MA 01007 in accordance with the
(Name of Owner) (Address)

provision of M.G.L. Chapter 132, Section 40-46, filed in Amherst F.O. with the Dept. of Conservation
and Recreation, Division of State Parks and Recreation, a Notice of Intent to cut forest products upon the

Gate 17 / "3151" lot, New Salem

Approval Date 11/20/17

Director's Agent Sean Libbey

DCR Phone No (413) 545-4539

ISSUED BY:

Priscilla E. Geigis, Director
Division of State Parks and Recreation

Figure 2. Photo Point Pictures

Pre-Harvest, October 2017



Post Harvest, February 2018



June 2022 (5 years of growth)

