

Massachusetts Department of Conservation and Recreation
Division of Water Supply Protection, Office of Watershed Management
Forest Management Project Summary

Project Title: Boyd-Gross

DWSP Harvest Permit Number: 3176

DWSP Proposal ID: PR-22-11

DCR Forest Cutting Plan File Number: 204-42944-25

Site Information

Watershed: Quabbin

Town(s): New Salem

Acres: 72

Nearest Road: Cooleyville

Natural Heritage Atlas overlap?: Yes

Public Drinking Water Supply Watershed?: Yes

Forest Types: White Pine Red Oak, Red Oak and Mixed Oak Dry Site

ACEC?: No

Soils: Stony till with varying levels of sandy loam

Wetland Resources:

Vernal Pools: 0

Harvest Information

Harvest Start Date: 10/1/2024

Harvest End Date: 12/14/2026

Number of Wetland Crossings: 0

Number of Stream Crossings: 0

Best Management Practices Applied

Stream Crossings:

Filter Strips:

Wetland Crossings: 0

Harvesting in Wetlands: 0

DWSP Forester supervising this harvest

Name: Derek Beard

Forester License #: 14

Phone #:

Email: derek.beard@mass.gov

NARRATIVE

General Description/Forest Composition/History:

The project is located on the east side of Prescott Rd south of intersection 17-8 (Prescott Rd & Herman Powers Rd; approximately 4 miles south of gate 17. The harvest area covers 72 acres bounded to the east by upper Prescott Brook, past harvest boundary (3008) to the north, Prescott Rd to the west and past harvest boundary (3129) to the south.

Forest structure is bifurcated between two aged throughout the western half transitioning to single storied (saw timber) multi-species in the east. The western half is composed of sawtimber size white pine and red oak followed by pole size black birch trigger by 2001 red pine overstory removal. The eastern portion is composed of red oak, mixed oak and black birch. This part of the harvest was lightly thinned in 1980.

Site Selection:

One goal of public water supply management is maintaining forest that protects high quality drinking water for current and future users. To achieve this, DWSP has determined the forest contain a diversity of species in various stages of development (seedlings through large legacy trees). This requires some active forest management designed to foster health, regeneration and greater complexity. Forest in this condition is well positioned to bolster inherent resiliency and ameliorate impacts from a range of disturbances (disease, insect infestation, ice storms and hurricanes) that climate change has exacerbated.

Silvicultural Objectives:

The main goal of the harvest is developing and/or establishing a diverse young forest age class. To accomplish this, four patch openings were sited across 72 acres. The openings total 9.7 acres, average 2.5 acres and range from 1.1 to 4.3 acres in size. In addition to being well-spaced and suited to the landscape, they all have live tree retention contributing to future forest complexity.

Cultural Resources:

The project area is home to myriad stone walls and a cellar hole; both a beacon to past agrarian land use.

Rare or Endangered Species:

According to the latest edition of the MA Natural Heritage & Endanger Species Atlas, the project overlaps with estimated or critical habitat area. The NHESP Program review determined that the proposed plan will not negatively impact Priority Habitat or result in Take (as defined in 321 CMR 10.02) of plant or animal species protected under the Massachusetts Endangered Species Act.

FIGURES

Figure 1. Forest Cutting Plan

Figure 1a: Forest Cutting Plan pg. 1.

Forest Cutting Plan

and Notice of Intent under M.G.L.
Chapter 132 – The Forest Cutting
Practices Act, 304 CMR 11.00
(Effective Date: 3/15/16)

For DCR Use Only:

File Number 204-42944-25 Case No.

Date Rec'd 8/29/24 Nat. Hrt. Yes

Earliest Start 9/16/24 Pub. Dr. Wat. Yes

River Basin Chicopee ACEC NO

Gen. Obj. LT

Site Information

Location Timber Lot 3176

Town New Salem

Road Prescott Road (Gate 17)

Acres 72 Proposed Start Date

Vol. MBF 81.2 Vol. Cds. 94 Vol. Tons 109

Plan Preparer

Name Derek Beard

Address 485 Ware Rd.

Town, State, Zip Belchertown, MA 01007

Phone (617) 780-0631

Type of Preparer Licensed Forester

*Mass. Forester License # 14

*Required for land under Ch61, Ch61A or Forest Stewardship

Landowner

Name DCR - Div. of Water Supply Protection

Mailing Address 485 Ware Rd.

Town, State, Zip Belchertown, MA 01007

Phone 413-323-6921

Ch61 ☐ 61A ☐ 61B ☐ Stew ☐ *Case #

FSC ☐ CR ☐ CR Holder

Best Management Practices

Stream Crossings

Indicate location on map	SC-1	SC-2	SC-3	SC-4
Type of Crossing				
Existing Structure				
Type of Bottom				
Bank Height (ft)	<input checked="" type="checkbox"/>			
Stabilization				

Wetland Crossings

Indicate location on map	WC-1	WC-2	WC-3	WC-4
Length of Crossing				
Mitigation				
Stabilization				

Filter Strips

Indicate location on map	FS-1	FS-2	FS-3	FS-4
Width (50', 100', or VA)				

Harvesting in Wetlands

Indicate location on map	HW-1	HW-2	HW-3	HW-4
Forest Type (see pg 2)				
Acres to be Harvested				
Resid. Basal Area (>50%)				

Service Forester Comments

* Heritage = No Impact - See Attached AR

Codes

Type of Preparer	Type of Crossing	Stabilization	Mitigation	Type of Bottom	Note:
LF Mass. Lic. For.	CU Culvert	SE Seed	FR Frozen	LE Ledge	Applicant must provide DCR with all relevant information before plan may be approved and cutting may begin. Some forestry activities, such as prescribed burning and pesticide or fertilizer application may require additional permits. Consult MA Forestry BMP Manual for further information.
TH Lic. Tim. Har	BR Bridge	MU Mulch	DR Dry	ST Stony	
TB Timber Buyer	FO Ford	CO Corduroy	OT Other	MU Mud	
LO Landowner	PO Poled	ST Stone		GR Gravel	
OT Other	OT Other	HB Hay Bales		OT Other	
		OT Other			

If Other (OT) is used in any category an explanation must be given on an attached narrative page

Figure 1b: Forest Cutting Plan pg. 2.

Forest Products			
Products to be Harvested*			
Species	Mb/Cds		Mb/Cds
White Pine	42	Red Maple	2.4
Red Pine		Sugar Maple	
Pitch Pine		Red Oak	31.0
Hemlock		Black Oak	3.6
Spruce	0.4	White Oak	0.2
Other Sftwd.		Other Hdwd.	0.2
White Ash	0.4	Total Mb	66.5
Beech		Cordwood (Cds)	94
White Birch	0.4	SW Pulp (Tons)	109
B & Y Birch	0.6	HW Pulp (Tons)	
Black Cherry		Chips (Tons)	

***Note:** Volumes indicated in the Plan are as reported by the plan preparer and have not been independently verified by the service forester upon approval. Mb = thousand board feet.

Stand Treatment				
Cutting Standards				
Indicate location on map	ST-1	ST-2	ST-3	ST-4
Forest Type	WO <input type="checkbox"/>	OR <input type="checkbox"/>	WO <input type="checkbox"/>	OM <input type="checkbox"/>
Acres	1.1	1.4	4.3	2.8
Landowner Objective	LT	LT	LT	LT
Designation of Trees	CT <input type="checkbox"/>	CT <input type="checkbox"/>	CT <input type="checkbox"/>	CT <input type="checkbox"/>
Type of Cut	CC <input type="checkbox"/>	CC <input type="checkbox"/>	CC <input type="checkbox"/>	CC <input type="checkbox"/>
Source of Regeneration	AD <input type="checkbox"/>	AD <input type="checkbox"/>	AD <input type="checkbox"/>	AD <input type="checkbox"/>

Landowner Signature

The most important information on a cutting plan is the Landowner's objective, as this will determine which trees will be harvested and which will remain; this decision will also determine the future condition of the forest for decades to come. After having read the Massachusetts Forest Cutting Plan Information Sheet on page one, indicate your objective by checking the appropriate box below.

☒ **LT - Long-term Forest Management**

Planned management of the forest to achieve one or more of the following objectives: produce immediate and maximize long-term income, enhance wildlife habitat, improve recreational opportunities, protect soil and water quality, or produce forest specialty products.

☐ **ST - Short-term Harvest**

Harvest of trees with the main intention of producing short-term income with minimal consideration given to improving the future forest condition, which often results in a forest dominated by poor quality and low value species.

I (we) have read the Massachusetts Cutting Plan Information Sheet, and am aware of my (our) management options.

I (we) hereby certify that I (we) have the legal authority to carry out the operation described above.

I (we) certify that I (we) have notified the Conservation Commission in the town in which the operation is to take place and the abutters of record within two hundred feet of the area to be harvested.

I (we) understand that the volumes in this plan have not been independently verified by the service forester upon approval and will report final values and volumes to the Director or his/her agent if the final figures differ from those reported.

Signature of landowner(s)

8/29/2024

Date

Service Forester			
Determination and Status			
Approved	Disapproved	Expires	
<input checked="" type="checkbox"/>	<input type="checkbox"/>	8/29/24	
Cutting Plan		9.20.24	
Signature of Service Forester/Director's Agent		Date	
Extension		Expires	
1 <input type="checkbox"/> 2 <input type="checkbox"/>		/	
Amendment		Ser. For. Ints.	
App 1 <input type="checkbox"/> Dis 1 <input type="checkbox"/> App 2 <input type="checkbox"/> Dis 2 <input type="checkbox"/>		/	

Final Report and Comments

I hereby certify that the afore described Forest Cutting Plan and all relevant statutes have been substantially complied with.

Signature of Service Forester/Director's Agent

Date

Codes											
Forest Types					Designation of Trees		Type of Cut		Source of Regeneration		
WP	White Pine	HK	Hemlock	OM	Mixed Oak	CT	Cut Tree	SH	Shelterwood	AD	Advanced
WK	WP/Hem	HH	Hem/Hdwd	RM	Red Maple	LT	Leaves Tree	ST	Seed Tree	CT	Commercial Thin
WH	WP/Hdwd	HC	Black Cherry	BE	Beech	SB	Stand Boundary	CC	Clear Cut	NT	Non Com Thin
WO	WP/Oak	HB	Bee/Bir/Map	SF	Spruce/Fir	OT	Other	SE	Selection	Non-Standard Systems*	
RP	Red Pine	OH	Oak/Hdwd	SM	Sugar Maple	Landowner Objective		SA	Salvage	HG	Highgrade*
SR	Red Spruce	OR	N Red Oak	PP	Pitch Pine	LT	Long-term Mgt.	SN	Sanitation	DL	Diameter Limit*
						ST	Short-term Har.			OT	Other*

*If Other (OT) or a non-standard system is used an explanation must be given on attached narrative page

Figure 1c: Forest Cutting Plan pg. 3.

<h2 style="margin: 0;">Forest Cutting Plan</h2> <p style="margin: 0;">Narrative Page (Effective Date: 3/15/16)</p> <p style="margin: 0;">Use this page to provide further explanation or if Other (OT) was used in any category on pages 3 or 4</p>		<p>Landowner <u>DCR-DWSP</u></p> <p>Town <u>New Salem</u></p> <p>File Number _____</p>																																																														
BMPs	<p>Use this Section to provide further explanation or if Other (OT) was used in any category in the Best Management Practices Section on Page 3.</p> <p>This project encompasses four patch clear cuts covering 9.7 acres. All openings have live and dead tree retention. Patch cut boundaries (three stripes) and live retention trees are marked with yellow paint. Trees to be harvested are marked with blue paint. Main skid roads are marked with vertically striped blue paint. Patch 4 is home to scattered pitch pine being retained to bolster long term forest diversity.</p>																																																															
Designation of Trees	<p>Use this Section to describe the types of trees to be harvested and/or retained if Other (OT) was used for "Designation of Trees" in the Stand Treatment Section on page 4. Additional narrative description may be added on a separate page.</p> <table border="1" style="width: 100%; border-collapse: collapse; text-align: center;"> <thead> <tr> <th rowspan="2">Stand No.</th> <th colspan="3">Describe Trees to be Cut</th> <th colspan="3">Describe Trees to be Left</th> <th colspan="2">% BA/AC</th> </tr> <tr> <th>Species</th> <th>Size</th> <th>Quality</th> <th>Species</th> <th>Size</th> <th>Quality</th> <th>Cut</th> <th>Left</th> </tr> </thead> <tbody> <tr><td> </td><td> </td><td> </td><td> </td><td> </td><td> </td><td> </td><td> </td><td> </td></tr> <tr><td> </td><td> </td><td> </td><td> </td><td> </td><td> </td><td> </td><td> </td><td> </td></tr> <tr><td> </td><td> </td><td> </td><td> </td><td> </td><td> </td><td> </td><td> </td><td> </td></tr> <tr><td> </td><td> </td><td> </td><td> </td><td> </td><td> </td><td> </td><td> </td><td> </td></tr> <tr><td> </td><td> </td><td> </td><td> </td><td> </td><td> </td><td> </td><td> </td><td> </td></tr> </tbody> </table>	Stand No.	Describe Trees to be Cut			Describe Trees to be Left			% BA/AC		Species	Size	Quality	Species	Size	Quality	Cut	Left																																														
	Stand No.		Describe Trees to be Cut			Describe Trees to be Left			% BA/AC																																																							
Species		Size	Quality	Species	Size	Quality	Cut	Left																																																								
Regeneration & Future Condition	<p>Use this Section to describe how Chapter 82 requirements will be met if a non standard system (HG, DL, or OT) was used for the "Type of Cut" in the Cutting Standards Section on page 4.</p> <table border="1" style="width: 100%; border-collapse: collapse; text-align: center;"> <thead> <tr> <th rowspan="2">Stand No.</th> <th rowspan="2">Source of Regeneration (ex. AD, SE)</th> <th colspan="2">How will Regeneration be obtained/protected?</th> </tr> <tr> <th>If using AD - Describe the species present and how the regeneration will be protected</th> <th>If using SB - Describe the source of the seed and the number of seed trees/acre</th> </tr> </thead> <tbody> <tr><td> </td><td> </td><td> </td><td> </td></tr> <tr><td> </td><td> </td><td> </td><td> </td></tr> <tr><td> </td><td> </td><td> </td><td> </td></tr> <tr><td> </td><td> </td><td> </td><td> </td></tr> <tr><td> </td><td> </td><td> </td><td> </td></tr> </tbody> </table>	Stand No.	Source of Regeneration (ex. AD, SE)	How will Regeneration be obtained/protected?		If using AD - Describe the species present and how the regeneration will be protected	If using SB - Describe the source of the seed and the number of seed trees/acre																																																									
	Stand No.			Source of Regeneration (ex. AD, SE)	How will Regeneration be obtained/protected?																																																											
If using AD - Describe the species present and how the regeneration will be protected		If using SB - Describe the source of the seed and the number of seed trees/acre																																																														
Regeneration & Future Condition	<table border="1" style="width: 100%; border-collapse: collapse; text-align: center;"> <thead> <tr> <th rowspan="2">Stand No.</th> <th colspan="2">Desired Future Condition</th> </tr> <tr> <th colspan="2">Describe what the stand is expected to look like five years from the harvest, including the condition of the overstory & understory</th> </tr> </thead> <tbody> <tr><td> </td><td> </td><td> </td></tr> <tr><td> </td><td> </td><td> </td></tr> <tr><td> </td><td> </td><td> </td></tr> <tr><td> </td><td> </td><td> </td></tr> <tr><td> </td><td> </td><td> </td></tr> </tbody> </table>	Stand No.	Desired Future Condition		Describe what the stand is expected to look like five years from the harvest, including the condition of the overstory & understory																																																											
	Stand No.		Desired Future Condition																																																													
Describe what the stand is expected to look like five years from the harvest, including the condition of the overstory & understory																																																																

Figure 1d forest cutting plan pg 4.

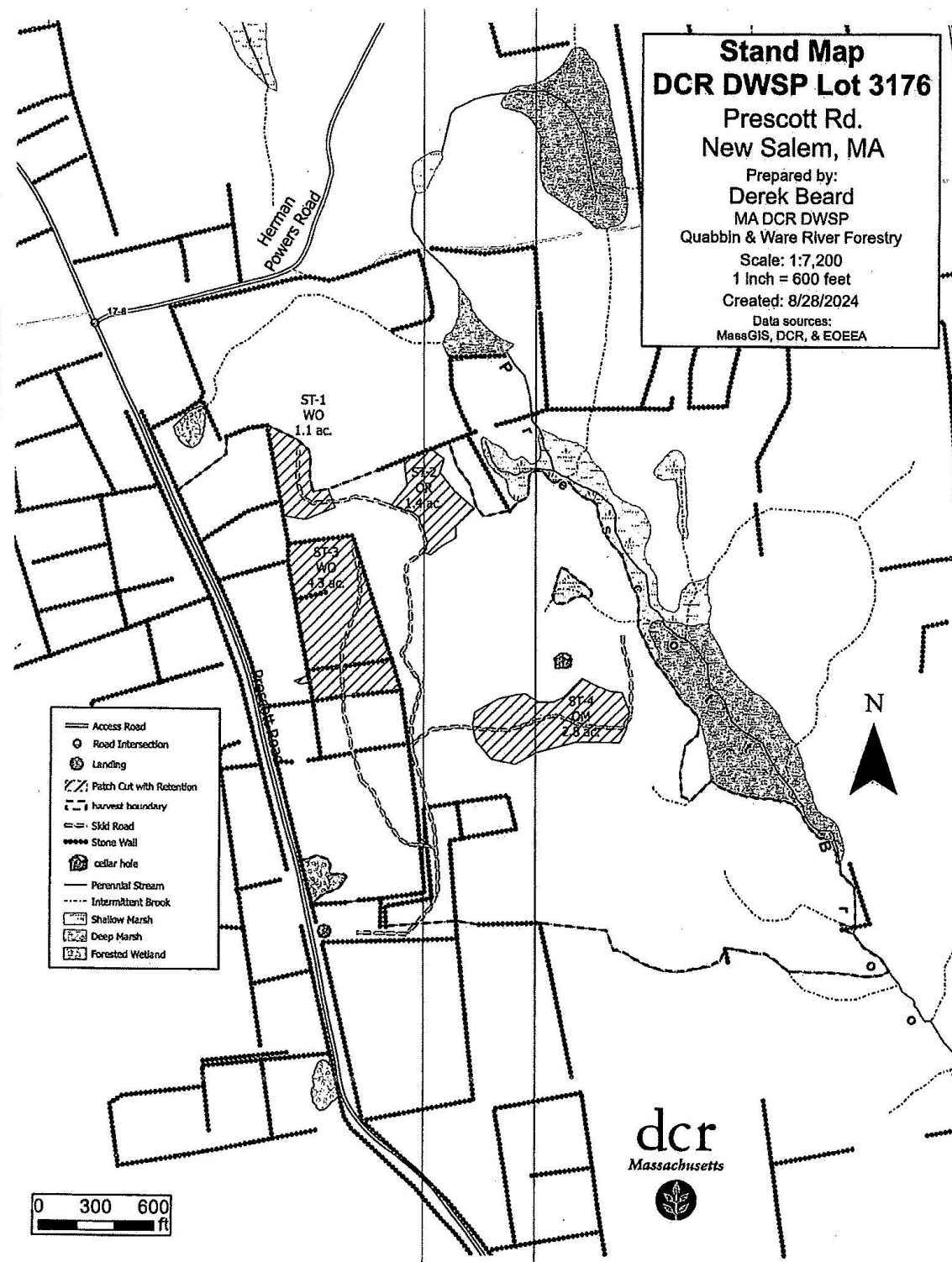

Figure 1d: Forest Cutting Plan pg. 5.

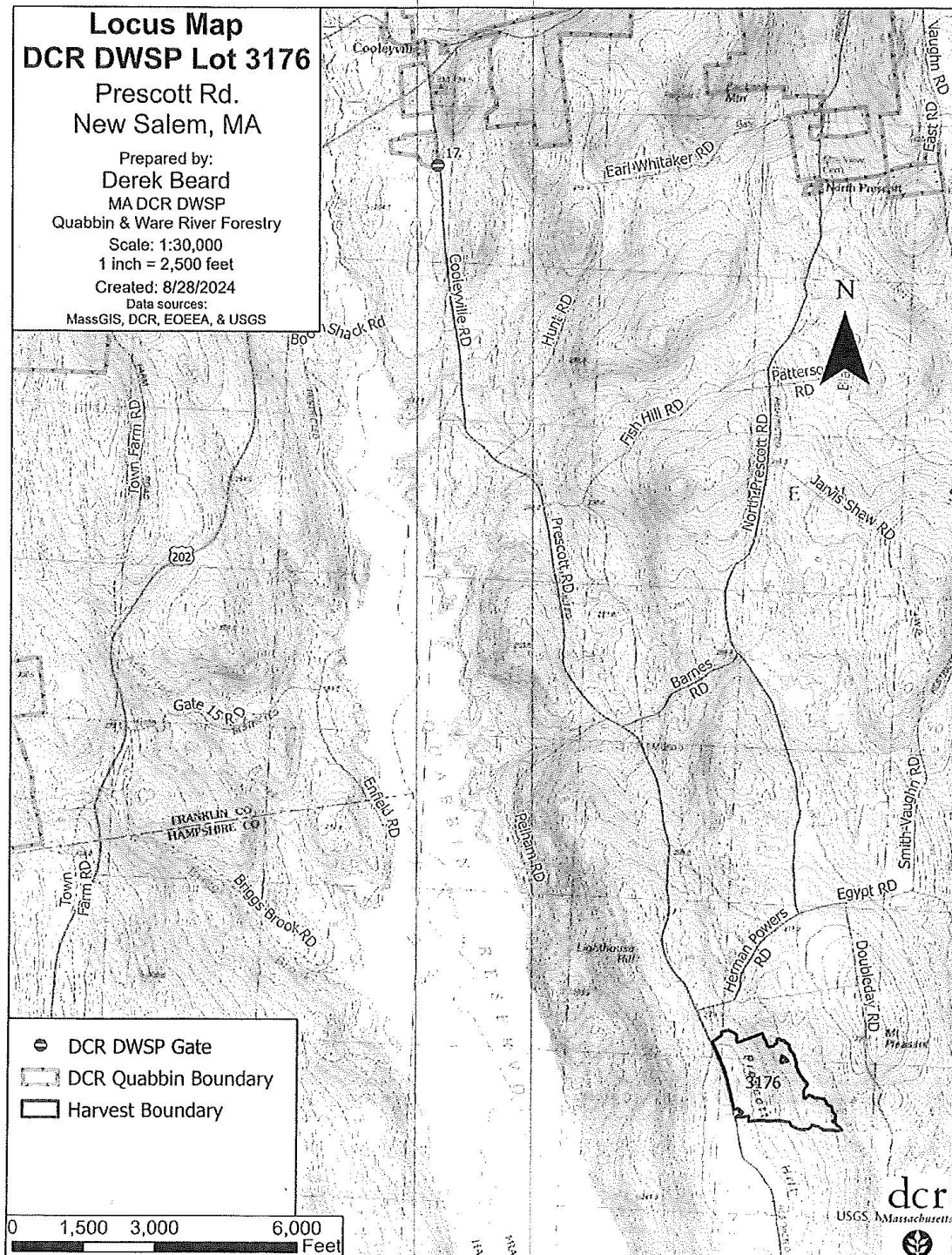

Figure 1e: Forest Cutting Plan page 6.

	COMMONWEALTH OF MASSACHUSETTS Department of Conservation and Recreation Division of State Parks and Recreation	FILE # <u>204-42944-25</u>
<h2>FOREST CUTTING PLAN CERTIFICATE</h2>		
Post this in a conspicuous place within the area in which the harvesting operation is to take place.		
This certifies that <u>DCR-DWSP</u> <u>485 Ware Rd, Belchertown, MA</u> in accordance with the		
(Name of Owner) (Address) <u>01007</u>		
provision of M.G.L. Chapter 132, Section 40-46, filed in <u>Amherst F.O.</u> with the Dept. of Conservation		
and Recreation, Division of State Parks and Recreation, a Notice of Intent to cut forest products upon the		
<u>Gate 17 /</u> lot. <u>(3176)</u>		
<u>Prescott Rd</u>		
Approval Date	<u>9/20/24</u>	ISSUED BY: 
Director's Agent	<u>Andrew Rawcliffe</u>	Priscilla E. Geigis, Director
DCR Phone No.	<u>(617) 549-1677</u>	Division of State Parks and Recreation