

**Massachusetts Department of Conservation and Recreation  
Division of Water Supply Protection, Office of Watershed Management  
*Forest Management Project Summary***

**Project Title: Lyman Johnson**

DWSP Harvest Permit Number: 3178

DWSP Proposal ID: PR-23-7

DCR Forest Cutting Plan File Number: 204-43039-25

***Site Information***

Watershed: Quabbin

Town(s): New Salem

Acres: 8.6

Nearest Road: Cooleyville

Natural Heritage Atlas overlap?: Yes

Public Drinking Water Supply Watershed?: Yes

Forest Types: White Pine Red Oak, Red Oak and Mixed Oak Dry Site

ACEC?: No

Soils: Stony till with varying levels of sandy loam

Wetland Resources:

Vernal Pools: 0

***Harvest Information***

Harvest Start Date: TBD

Harvest End Date: Before 12/14/2026

Number of Wetland Crossings: 0

Number of Stream Crossings: 0

***Best Management Practices Applied***

Stream Crossings: 0

Filter Strips: 0

Wetland Crossings: 0

Harvesting in Wetlands: 0

***DWSP Forester supervising this harvest***

Name: Derek Beard

Forester License #: 14

Phone #: 617 780 0631

Email: derek.beard@mass.gov

## **Narrative**

### ***General Description/Forest Composition/History***

The project is located on the west side of Prescott Rd about a quarter mile (0.25) south of intersection 17-9 (locale of razed UMASS astronomy site). The harvest area covers 8.6 acres bounded to the east by stone wall, south by boundary of past harvest 3067, west by absence of old field white pine and north by seep.

Large tall low quality white pine best characterizes the project's forest composition. A complexion commonly found throughout New England and indicative of forest that colonized abandoned agricultural land. In addition to white pine, the area is home to dry site oak (scarlet, black, white and red) and small aggregation of pitch pine. Mostly confined to the coast, pitch pine inhabits isolated post-glacial sand/gravel outwashes scattered across interior MA. Ground and shrub layer flora amongst pitch pine can provide habitat for a variety of lepidoptera (butterflies and moths) that are species of concern in MA.

### ***Site Selection***

One goal of public water supply management is maintaining forest that protects high quality drinking water for current and future users. To achieve this, DWSP has determined the forest contain a diversity of species in various stages of development (seedlings through large legacy trees). This requires some active forest management designed to foster health, regeneration and greater complexity. Forest in this condition is well positioned to bolster inherent resiliency and ameliorate impacts from a range of disturbances (disease, insect infestation, ice storms and hurricanes) that climate change has exacerbated.

### ***Silvicultural Objectives***

The main goal of the harvest is to remove the low-quality old field white pine along with mature and/or low-quality oak. Post-harvest complexion will encompass randomly spaced overstory white pine, oaks, pitch pine and live/dead wildlife trees (snags). All pitch pine is being retained as a seed source for future regeneration. Overstory spacing will be broad enough to encourage vigorous regeneration development of sun loving species (oaks, white pine and hopefully pitch pine).

### ***Cultural Resources***

The project does not encompass any extraordinary cultural resources.

### ***Rare or Endangered Species***

According to the latest edition of the MA Natural Heritage & Endanger Species Atlas, the project overlaps with estimated or critical habitat area. The NHESP Program review determined that the proposed plan will not negatively impact Priority Habitat or result in Take (as defined in 321 CMR 10.02) of plant or animal species protected under the Massachusetts Endangered Species Act.

## Figures

- Figure 1. Forest Cutting Plan
- Figure 2. Camera Post Photos

Figure 1a: Forest Cutting Plan pg. 1.

RECEIVED OCT 31 2024

# Forest Cutting Plan

and Notice of Intent under M.G.L. Chapter 132 – The Forest Cutting Practices Act, 304 CMR 11.00 (Effective Date: 3/15/16)

**For DCR Use Only:**

File Number 204-43039-25 Case No. \_\_\_\_\_  
 Date Rec'd 10/31/24 Nat. Hert. Y  
 Earliest Start 11/18/24 Pub. Dr. Wat. Y  
 River Basin Chicopee ACEC N  
 Gen. Obj. LT

Site Information	<b>Location</b> <u>Timber Lot 3178</u>	<b>Landowner</b>
	Town <u>New Salem</u>	Name <u>DCR - Div. of Water Supply Protection</u>
	Road <u>Prescott Road (Gate 17)</u>	Mailing Address <u>485 Ware Rd.</u>
	Acres <u>8.6</u> Proposed Start Date _____	Town, State, Zip <u>Belchertown, MA 01007</u>
	Vol. MBF <u>96.6</u> Vol. Cds. <u>81</u> Vol. Tons <u>213</u>	Phone <u>413-323-6921</u>
	<b>Plan Preparer</b>	Ch61 <input type="checkbox"/> 61A <input type="checkbox"/> 61B <input type="checkbox"/> Stew <input type="checkbox"/> *Case # _____
	Name <u>Derek Beard</u>	FSC <input type="checkbox"/> CR <input type="checkbox"/> CR Holder _____
	Address <u>485 Ware Rd.</u>	<b>Licensed Timber Harvester**</b>
	Town, State, Zip <u>Belchertown, MA 01007</u>	Name _____
	Phone <u>(617) 780-0631</u>	Address _____
Type of Preparer <u>Licensed Forester</u>	Town, State, Zip _____	
*Mass. Forester License # <u>14</u>	Phone _____	
*Required for land under Ch61, Ch61A or Forest Stewardship	Mass. Lic. Harvester # _____	
	**This information may be supplied after the plan is approved, but before work begins.	

Best Management Practices	<b>Stream Crossings</b>	<b>Harvesting in Wetlands</b>		
	Indicate location on map	SC-1 SC-2 SC-3 SC-4	Indicate location on map	HW-1 HW-2 HW-3 HW-4
	Type of Crossing		Forest Type (see pg 2)	
	Existing Structure		Acres to be Harvested	
	Type of Bottom		Resid. Basal Area (>50%)	
	Bank Height (ft)	<input checked="" type="checkbox"/>		
	Stabilization			
	<b>Wetland Crossings</b>		<b>Service Forester Comments</b>	
	Indicate location on map	WC-1 WC-2 WC-3 WC-4	_____	
	Length of Crossing		_____	
Mitigation		_____		
Stabilization		_____		
<b>Filter Strips</b>		_____		
Indicate location on map	FS-1 FS-2 FS-3 FS-4	_____		
Width (50', 100', or VA)		_____		

<b>Type of Preparer</b>	<b>Type of Crossing</b>	<b>Stabilization</b>	<b>Mitigation</b>	<b>Type of Bottom</b>	<b>Note:</b>
LF Mass. Lic. For.	CU Culvert	SE Seed	FR Frozen	LE Ledge	Applicant must provide DCR with all relevant information before plan may be approved and cutting may begin.
TH Lic. Tim. Har	BR Bridge	MU Mulch	DR Dry	ST Stony	Some forestry activities, such as prescribed burning and pesticide or fertilizer application may require additional permits.
TB Timber Buyer	FO Ford	CO Corduroy	OT Other	MU Mud	Consult MA Forestry BMP Manual for further information.
LO Landowner	PO Poled	ST Stone		GR Gravel	
OT Other	OT Other	HB Hay Bales		OT Other	
		OT Other			

If Other (OT) is used in any category an explanation must be given on an attached narrative page

Figure 1b: Forest Cutting Plan pg. 2.

Forest Products	<b>Products to be Harvested*</b>				Stand Treatment	<p><b>*Note:</b> Volumes indicated in the Plan are as reported by the plan preparer and have not been independently verified by the service forester upon approval. MbF = thousand board feet.</p>
	<b>Species</b>	<b>MbF/Cds</b>		<b>MbF/Cds</b>		
	White Pine	62.6	Red Maple	5.7		
	Red Pine		Sugar Maple			
	Pitch Pine		Red Oak	15.2		
	Hemlock		Black Oak	2.7		
	Spruce		White Oak	0.2		
	Other Sftwd.		Other Hdwd.	4.4		
	White Ash	3.9	<b>Total MbF</b>	<b>96.6</b>		
	Beech		<b>Cordwood (Cds)</b>	<b>81</b>		
White Birch	0.2	<b>SW Pulp (Tons)</b>	<b>213</b>			
B & Y Birch	1.4	<b>HW Pulp (Tons)</b>				
Black Cherry	0.3	<b>Chips (Tons)</b>				

Landowner	<b>Landowner Signature</b>				
	<p>The most important information on a cutting plan is the Landowner's objective, as this will determine which trees will be harvested and which will remain; <b>this decision will also determine the future condition of the forest for decades to come.</b> After having read the Massachusetts Forest Cutting Plan Information Sheet on page one, indicate your objective by checking the appropriate box below.</p>				
	<input checked="" type="checkbox"/>	<b>LT – Long-term Forest Management</b>			
	<p>Planned management of the forest to achieve one or more of the following objectives: produce immediate and maximize long-term income, enhance wildlife habitat, improve recreational opportunities, protect soil and water quality, or produce forest specialty products.</p>				
	<input type="checkbox"/>	<b>ST - Short-term Harvest</b>			
	<p>Harvest of trees with the main intention of producing short-term income with minimal consideration given to improving the future forest condition, which often results in a forest dominated by poor quality and low value species.</p>				
	<p>I (we) have read the Massachusetts Cutting Plan Information Sheet, and am aware of my (our) management options.                  I (we) hereby certify that I (we) have the legal authority to carry out the operation described above.                  I (we) certify that I (we) have notified the Conservation Commission in the town in which the operation is to take place and the abutters of record within two hundred feet of the area to be harvested.                  I (we) understand that the volumes in this plan have not been independently verified by the service forester upon approval and will report final values and volumes to the Director or his/her agent if the final figures differ from those reported.</p>				
		10/25/2024			
	Signature of landowner(s) <span style="float: right;">Date</span>				

Service Forester	<b>Determination and Status</b>				<b>Final Report and Comments</b>				
	Approved		Disapproved		I hereby certify that the afore described Forest Cutting Plan and all relevant statutes have been substantially complied with.				
	Expires		Expires						
	Cutting Plan	<input checked="" type="checkbox"/>	<input type="checkbox"/>	10.31.26		Signature of Service Forester/Director's Agent <span style="float: right;">Date</span>			
	Signature of Service Forester/Director's Agent <span style="float: right;">Date</span>								
	Extension	1 <input type="checkbox"/>	2 <input type="checkbox"/>	Expires /		_____ _____ _____			
	Amendment	App 1 <input type="checkbox"/>	Dis 1 <input type="checkbox"/>	App 2 <input type="checkbox"/>	Dis 2 <input type="checkbox"/>				
	Ser. For. Ints. /				Date				

Codes	<b>Forest Types</b>				<b>Designation of Trees</b>				<b>Type of Cut</b>				<b>Source of Regeneration</b>			
	WP	White Pine	HK	Hemlock	OM	Mixed Oak	CT	Cut Tree	SH	Shelterwood	<b>Intermediate Harvests:</b>			AD Advanced		
	WK	WP/Hem	HH	Hem/Hdwd	RM	Red Maple	LT	Leave Tree	ST	Seed Tree	CT	Commercial Thin	SE Natural Seed			
	WH	WP/Hdwd	BC	Blck Cherry	BE	Beech	SB	Stand Boundary	CC	Clear Cut	NT	Non Com Thin	PL Plant			
	WO	WP/Oak	BB	Bee/Bir/Map	SF	Spruce/Fir	OT	Other	SE	Selection	<b>Non-Standard Systems:*</b>			CO Coppice		
	RP	Red Pine	OH	Oak/Hdwd	SM	Sugar Maple	<b>Landowner Objective</b>		SA	Salvage	HG	Highgrade*	DS Direct Seed			
	SR	Red Spruce	OR	N Red Oak	PP	Pitch Pine	LT	Long-term Mgt.	SN	Sanitation	DL	Diameter Limit*	OT Other			
							ST	Short-term Har.			OT	Other*				
	*If Other (OT) or a non-standard system is used an explanation must be given on attached narrative page pg 4 of 5															

Figure 1c: Forest Cutting Plan pg 3.

# Forest Cutting Plan

Narrative Page (Effective Date: 3/15/16)

Use this page to provide further explanation or if Other (OT) was used in any category on pages 3 or 4.

Landowner DCR -DWSP

Town New Salem

File Number \_\_\_\_\_

BMPs

Use this Section to provide further explanation or if Other (OT) was used in any category in the Best Management Practices Section on Page 3. Removing low quality white pine that colonized this former open agricultural area is the primary harvest intent. Specifically it's a 8.6 acre clear cut with live tree retention. Retained trees include well formed high canopy white pine, oak and pitch pine as well as live and dead snags. Harvest trees are marked blue. Main skid roads are marked with blue vertical stripe. Retention trees are marked yellow. Harvest boundary is marked with 3 yellow stripes.

Designation of Trees

Use this Section to describe the types of trees to be harvested and/or retained if Other (OT) was used for "Designation of Trees" in the Stand Treatment Section on page 4. Additional narrative description may be added on a separate page.

Stand No.	Describe Trees to be Cut			Describe Trees to be Left			% BA/AC	
	Species	Size	Quality	Species	Size	Quality	Cut	Left

Regeneration & Future Condition

Use this Section to describe how Chapter 132 requirements will be met if a non standard system (HG, DL, or OT) was used for the "Type of Cut" in the Cutting Standards Section on page 4.

Stand No.	Source of Regeneration (ex. AD, SE)	How will Regeneration be obtained/protected? If using AD - Describe the species present and how the regeneration will be protected If using SE - Describe the source of the seed and the number of seed trees/acre

Stand No.	Desired Future Condition
	Describe what the stand is expected to look like five years from the harvest, including the condition of the overstory & understory

Figure 1d forest cutting plan pg. 4.

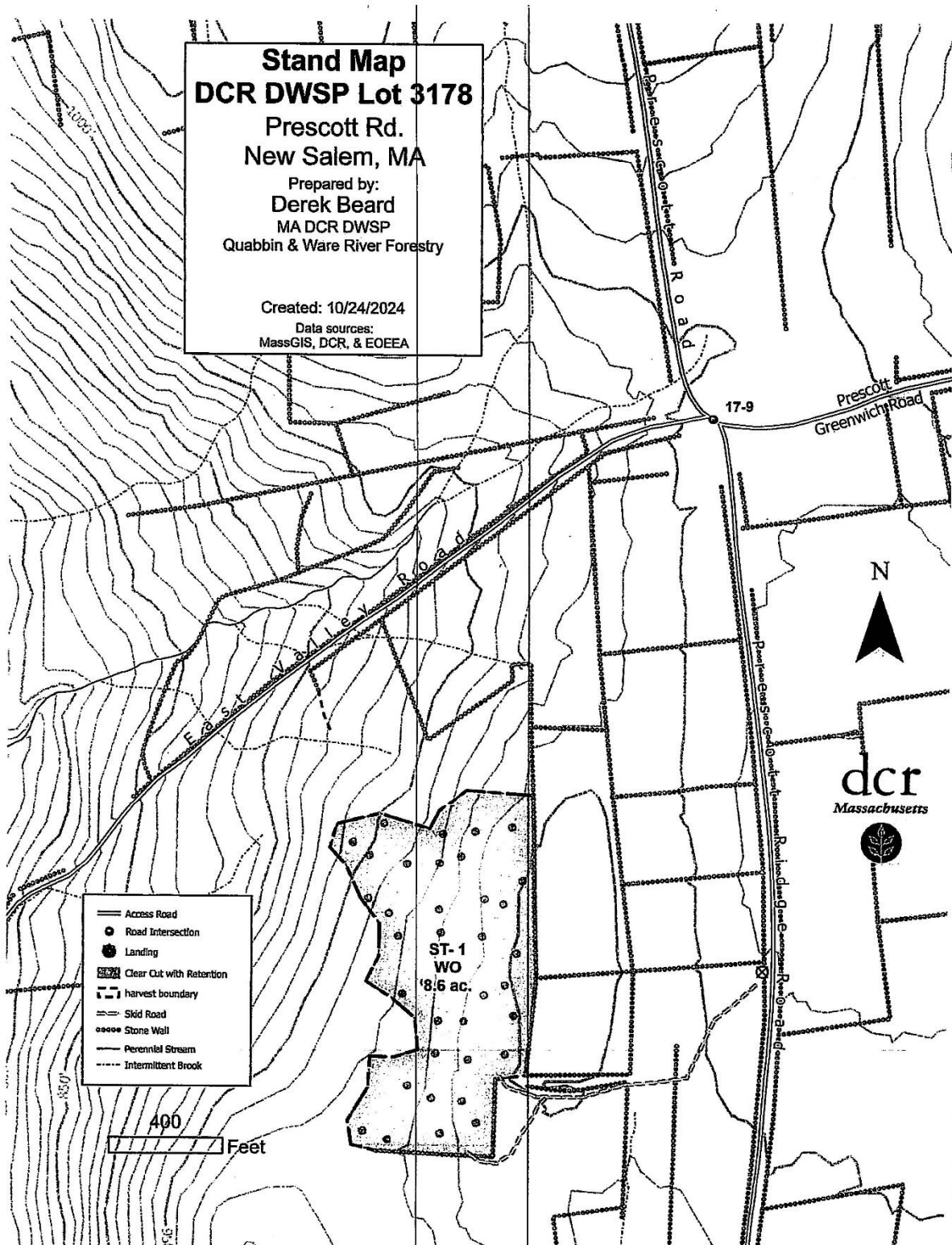

Figure 1d: Forest Cutting Plan pg. 5.

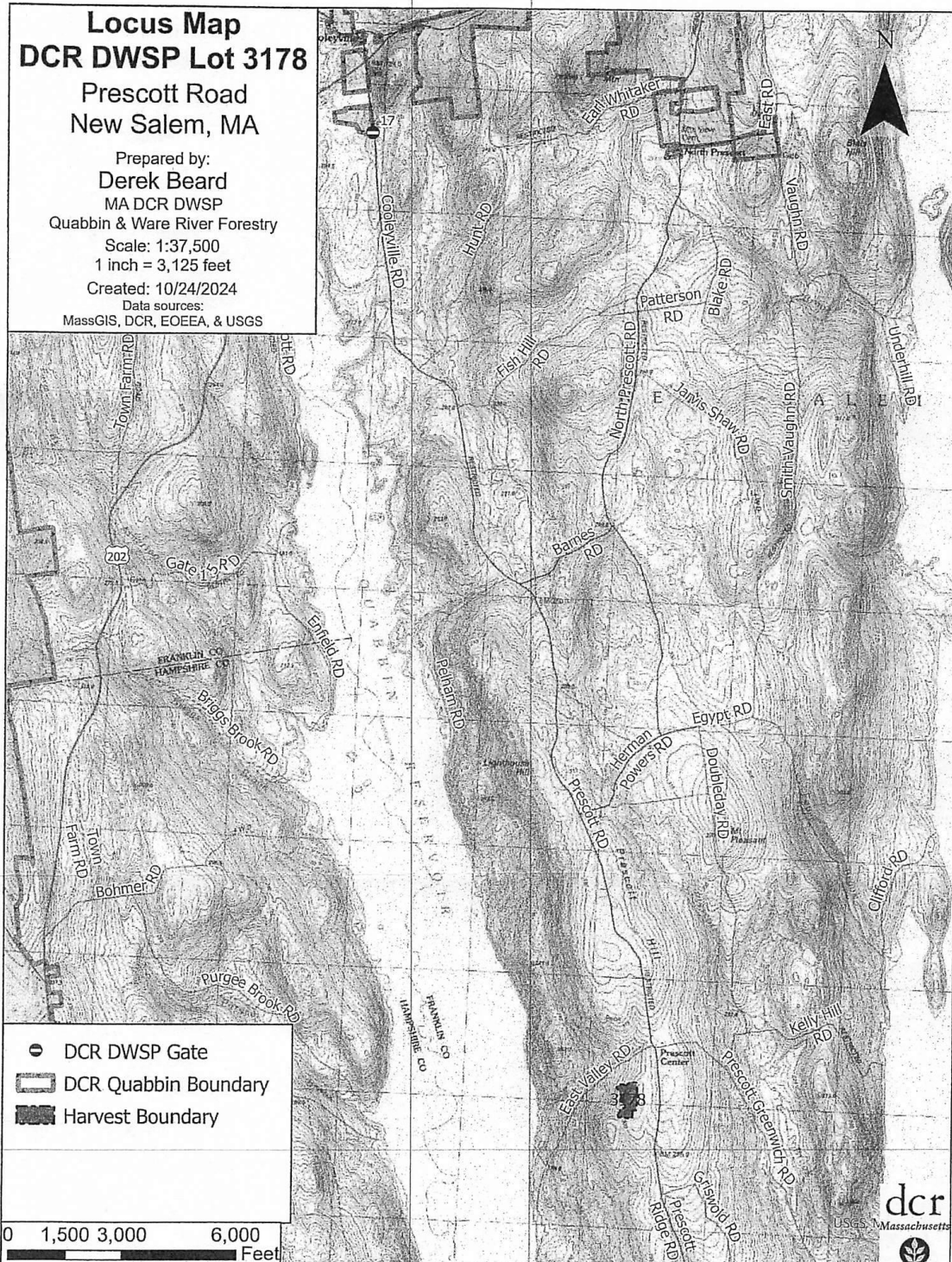



Figure 1e: Forest Cutting Plan page 6.

 COMMONWEALTH OF MASSACHUSETTS  
Department of Conservation and Recreation  
Division of State Parks and Recreation

FILE # 204-43039-25

## FOREST CUTTING PLAN CERTIFICATE

Post this in a conspicuous place within the area in which the harvesting operation is to take place.

This certifies that DCR-DWSP 485 Ware Rd, Belchertown, MA in accordance with the  
(Name of Owner) (Address) 01007

provision of M.G.L. Chapter 132, Section 40-46, filed in Amherst F.O. with the Dept. of Conservation  
and Recreation, Division of State Parks and Recreation, a Notice of Intent to cut forest products upon the  
Gate 17 "3178" lot, New Salem  
(Prescott Rd)

Approval Date 11/22/24 ISSUED BY: 

Director's Agent Andrew Rawcliffe  
DCR Phone No. (617) 549-1677  
Priscilla E. Geigis, Director  
Division of State Parks and Recreation

**Figure 2a: Pre-Harvest Photo, Jan. 16, 2025**

