

Massachusetts Department of Conservation and Recreation
Division of Water Supply Protection, Office of Watershed Management
Forest Management Project Summary

Project Title: Pine Plains Rd

DWSP Harvest Permit Number: 4392

DWSP Proposal ID: WR-16-10-03

DCR Forest Cutting Plan File Number: 257-8447-17

Site Information

Watershed: Ware River Watershed

Town(s): Rutland

Acres: 8.1

Nearest Road: Pine Plains Rd

Natural Heritage Atlas overlap?: No

Public Drinking Water Supply Watershed?: Yes

Forest Types: White Pine/Hardwood

Area of Critical Environmental Concern (ACEC)?: No

Soils: 253 C Hinckley loamy sand 8-15% slopes excessively drained, and 254 B Merrimac fine sandy loam 3- 8% slopes somewhat excessively drained

Wetland Resources: Wetlands and a stream are present, adjacent to but outside of harvest area.

Vernal Pools: none known

Harvest Information

Harvest Start Date: 5/8/17

Harvest End Date: 5/25/17

Number of Wetland Crossings: None

Number of Stream Crossings: None

Best Management Practices Applied

Stream Crossings: None

Filter Strips: There is harvesting in filter strips.

Wetland Crossings: There are no wetland crossings.

Harvesting in Wetlands: There is no harvesting in wetlands.

DWSP Forester supervising this harvest

Name: Ken Canfield

Forester License number: 431

Phone number: 857 274 7090

Email: Kenneth.canfield@mass.gov

Narrative

General Description/Forest Composition/History

This area was used as pastureland until the 1930's. The 1938 aerial photos show that white pine was already established on areas with a little bit of slope, while the flat areas are completely open. The white pine started under these conditions is very low quality.

Overstory tree species diversity is relatively low. The harvest area is dominated by low quality "old pasture" white pine trees that are 80+ years old. Although there are scattered red and white oak, red maple, hemlock, and pitch pine trees, they make up a very low percentage of overstory trees. Advanced regeneration of all species except pitch pine is present and is much more balanced in terms of diversity.

Site Selection

The primary goal of the watershed forest management program is to create and maintain a forest that provides high quality drinking water to current users and future generations. DWSP recognizes that wildlife habitat management and restoration of rare habitats are important secondary goals, where they are compatible with maintaining high quality drinking water.

This area was specifically targeted because there is a 25 + acre stand dominated by poorly formed pasture white pine. That type of stand is relatively low in diversity of overstory tree species. The white pine trees that are present are also more prone to windthrow in a wind event because they are tall and multi-stemmed. The abundant advanced regeneration present consists of a more balanced species mix and makes it more likely that the resulting stand will be established quickly and will be more diverse.

Silvicultural Objectives

The silvicultural objective for this lot is to regenerate 8.1 acres of old pasture white pine stand to a more diverse stand with a higher percentage of dominant or co – dominant hardwood species, especially oak. This will be done in four groups that are 0.6 acres, 1.2 acres, 1.4 acres, and 4.9 acres in size.

Cultural Resources

This land has been determined to not be culturally or archeologically sensitive based on a review by the DCR Archaeologist. Standard practice dictates that every effort is made to avoid disturbing stone walls and other cultural resources.

Rare or Endangered Species

No known vernal pools are present within the lot or within 200 feet of the boundary of the lot.

Figures

- | | |
|----------------|--|
| Figure 1 | Final Forest Cutting Plan |
| Figure 2 (A-C) | Pre-Harvest photographs taken 1/19/17 |
| Figure 3 (A-C) | Post-Harvest photographs taken 5/24/17 |
| Figure 4 (A-C) | Post-Harvest photographs taken 8/24/22 (after 5 growing seasons) |

Figure 1 Final Forest Cutting Plan

Forest Cutting Plan

and Notice of Intent under M.G.L. Chapter 132 – The Forest Cutting Practices Act, 304 CMR 11.00 NOV 03 2016 (Effective Date: 1/1/04)

For DCR Use Only:

File Number 257-8447-17 Case No. _____
 Date Rec'd 11/3/16 Nat. Hert. No
 Earliest Start 11/15/16 Nat. Hert. Imp. N/A
 River Basin Chicopee Pub. Dr. Wat. Ware River
 Gen. Obj. LT ACEC No

Site Information

Location mailed 11/18/16
 Town Rutland
 Road Pine Plains Rd
 Acres 8.1 Proposed Start Date 11/16
 Vol. MBF 17.1 Vol. Cds. 28 Vol. Tons 559

Plan Preparer

Name Kenneth W. Canfield
 Address 578 Old Turnpike Rd
 Town, State, Zip Oakham, MA 01068
 Phone (508) 882-3789 X 1603
 Type of Preparer LF
 *Mass. Forester License # 431
 *Required for land under Ch61, Ch61A or Forest Stewardship

Landowner

Name DCR, Division of Water Supply Protection
 Mailing Address 485 Ware Rd
 Town, State, Zip Belchertown, MA 01007
 Phone (413) 323-6921
 Ch61 61A 61B Stew *Case # _____
 CR CR Holder _____

Licensed Timber Harvester**

Name _____
 Address _____
 Town, State, Zip _____
 Phone _____
 Mass. Lic. Harvester # _____
 **This information may be supplied after the plan is approved, but before work begins.

Best Management Practices

Stream Crossings

Indicate location on map	SC-1	SC-2	SC-3	SC-4
Type of Crossing				
Existing Structure				
Type of Bottom				
Bank Height (ft)				
Stabilization				

Wetland Crossings

Indicate location on map	WC-1	WC-2	WC-3	WC-4
Length of Crossing				
Mitigation				
Stabilization				

Filter Strips

Indicate location on map	FS-1	FS-2	FS-3	FS-4
Width (50', 100', or VA)				

Harvesting in Wetlands

Indicate location on map	HW-1	HW-2	HW-3	HW-4
Forest Type (see pg 2)				
Acres to be Harvested				
Resid. Basal Area (>50%)				

Service Forester Comments

Please notify DCR Service Forester when harvest begins

Codes

Type of Preparer	Type of Crossing	Stabilization	Mitigation	Type of Bottom
LF Mass. Lic. For.	CU Culvert	SE Seed	FR Frozen	LE Ledge
TH Lic. Tim. Har	BR Bridge	MU Mulch	DR Dry	ST Stony
TB Timber Buyer	FO Ford	CO Corduroy	OT Other	MU Mud
LO Landowner	PO Poled	ST Stone		GR Gravel
OT Other	OT Other	HB Hay Bales		OT Other
		OT Other		

Note:
 Applicant must provide DCR with all relevant information before plan may be approved and cutting may begin. Some forestry activities, such as prescribed burning and pesticide or fertilizer application may require additional permits. Consult MA Forestry BMP Manual for further information.

If Other (OT) is used in any category an explanation must be given on an attached narrative page

Forest Products

Products to be Harvested*

Species	Mbf/Cds		Mbf/Cds
White Pine	16.9 M	Red Maple	
Red Pine		Sugar Maple	
Pitch Pine		Red Oak	0.2 M
Hemlock		Black Oak	
Spruce		White Oak	
Other Sftwd.		Other Hdwd.	
White Ash	Total Mbf		17.1
Beech	Cordwood (Cds)		28
White Birch	SW Pulp (Tons)		
B & Y Birch	HW Pulp (Tons)		
Black Cherry	Chips (Tons)		559

*Note: Volumes and values indicated in the Plan are as reported, by the plan preparer and have not been independently verified by the service forester upon approval. Mbf = thousand board feet.

Stand Treatment

Cutting Standards

Indicate location on map	ST-1	ST-2	ST-3	ST-4
Forest Type	WH	WH		
Acres	3.2	4.9		
Landowner Objective	LT	LT		
Designation of Trees	CT	CT		
Type of Cut	SE	CC		
Source of Regeneration	SE	SE		

Landowner

Landowner Signature

The most important information on a cutting plan is the Landowner's objective, as this will determine which trees will be harvested and which will remain; this decision will also determine the future condition of the forest for decades to come. After having read the Massachusetts Forest Cutting Plan Information Sheet on page one, indicate your objective by checking the appropriate box below.

LT - Long-term Forest Management

Planned management of the forest to achieve one or more of the following objectives: produce immediate and maximize long-term income, enhance wildlife habitat, improve recreational opportunities, protect soil and water quality, or produce forest specialty products.

ST - Short-term Harvest

Harvest of trees with the main intention of producing short-term income with minimal consideration given to improving the future forest condition, which often results in a forest dominated by poor quality and low value species

I (we) have read the Massachusetts Cutting Plan Information Sheet, and am aware of my (our) management options.

I (we) hereby certify that I (we) have the legal authority to carry out the operation described above.

I (we) certify that I (we) have notified the Conservation Commission in the town in which the operation is to take place and the abutters of record within two hundred feet of the area to be harvested.

I (we) understand that the volumes and values (Ch61 only) in this plan have not been independently verified by the service forester upon approval and will report final values and volumes to the Director or his/her agent if the final figures differ from those reported.

Signature of landowner(s)

10/31/16

Date

Service Forester

Determination and Status

	Approved	Disapproved	Expires	
Cutting Plan	<input checked="" type="checkbox"/>	<input type="checkbox"/>	<u>11/3/2018</u>	
			<u>11/17/2016</u>	
	Signature of Service Forester/Director's Agent		Date	
Extension	1 <input type="checkbox"/>	2 <input type="checkbox"/>	Expires	Ser. For. Ints.
Amendment	App 1 <input type="checkbox"/>	Dis 1 <input type="checkbox"/>	App 2 <input type="checkbox"/>	Dis 2 <input type="checkbox"/>

Final Report and Comments

I hereby certify that the afore described Forest Cutting Plan and all relevant statutes have been substantially complied with.

Signature of Service Forester/Director's Agent

6/15/17

Date

Site harvest completed and landing area + skid trails were stabilized

Codes

Forest Types	HK Hemlock	OM Mixed Oak	Designation of Trees	SH Shelterwood	Intermediate Harvests:	Source of Regeneration
WP White Pine	HH Hem/Hdwd	RM Red Maple	CT Cut Tree	ST Seed Tree	CT Commercial Thin	AD Advanced
WH WP/Hem	BC Black Cherry	BE Beech	LT Leave Tree	CC Clear Cut	NT Non Com Thin	SE Natural Seed
WH WP/Hdwd	BB Bee/Bir/Map	SF Spruce/Fir	SB Stand Boundary	SE Selection	Non-Standard Systems:*	PL Plant
WO WP/Oak	OH Oak/Hdwd	SM Sugar Maple	OT Other	SA Salvage	HG Highgrade*	CO Coppice
RP Red Pine	OR N Red Oak	PP Pitch Pine	Landowner Objective	SN Sanitation	DL Diameter Limit*	DS Direct Seed
SR Red Spruce			LT Long-term Mgt.		OT Other*	OT Other
			ST Short-term Har.			

*If Other (OT) or a non-standard system is used an explanation must be given on attached narrative page pg 4 of 5

Forest Cutting Plan

Narrative Page (Effective Date: 1/1/04)
 Use this page to provide further explanation or if Other (OT) was used in any category on pages 3 or 4.

Landowner MA DCR, DWSP

Town Rutland

File Number 257-8447-17

BMPs

Use this Section to provide further explanation or if Other (OT) was used in any category in the Best Management Practices Section on Page 3.

Stand 1 is a white pine/hardwood stand dominated by low quality overstory white pine. Three group selection cuts of 0.6, 1.2, and 1.4 acres will be harvested, retaining 5 to 10 square feet of basal area per acre of co-dominant trees, mostly red and white oak where present, also pitch pine, white pine and black cherry. Stand 2 is a white pine hardwood stand that is dominated by low quality overstory white pine. A 4.9 acre clearcut will be harvested retaining 5 to 10 square feet of basal area per acre of co-dominant trees, mostly red, white, and black oaks, also pitch pine, white pine, black cherry, and eastern hemlock.

Designation of Trees

Use this Section to describe the types of trees to be harvested and/or retained if Other (OT) was used for "Designation of Trees" in the Stand Treatment Section on page 4.

Stand No.	Species to be Cut	Size of Trees to be Cut	Quality of Trees to be Cut	% BA/Acre Removed

Regeneration & Future Condition

Use this Section to describe how Chapter 132 requirements will be met if a non standard system (HG, DL, or OT) was used for the "Type of Cut" in the Cutting Standards Section on page 4.

Stand No.	Source of Regeneration (ex. AD, SE)	How will Regeneration be obtained/protected? <small>If using AD - Describe the species present and how the regeneration will be protected If using SE - Describe the source of the seed and the number of seed trees/acre</small>

Stand No. **Desired Future Condition**
 Describe what the stand is expected to look like five years from the harvest, including the condition of the overstory & understory

Lot # 4392
Pine Plains Rd, Rutland, MA
8.1 Acres
MA DCR
Division of Water Supply Protection
Prepared by Kenneth W Canfield 10/28/16
Data Sources: MassGIS, DCR & EOEAA
Not a legal survey

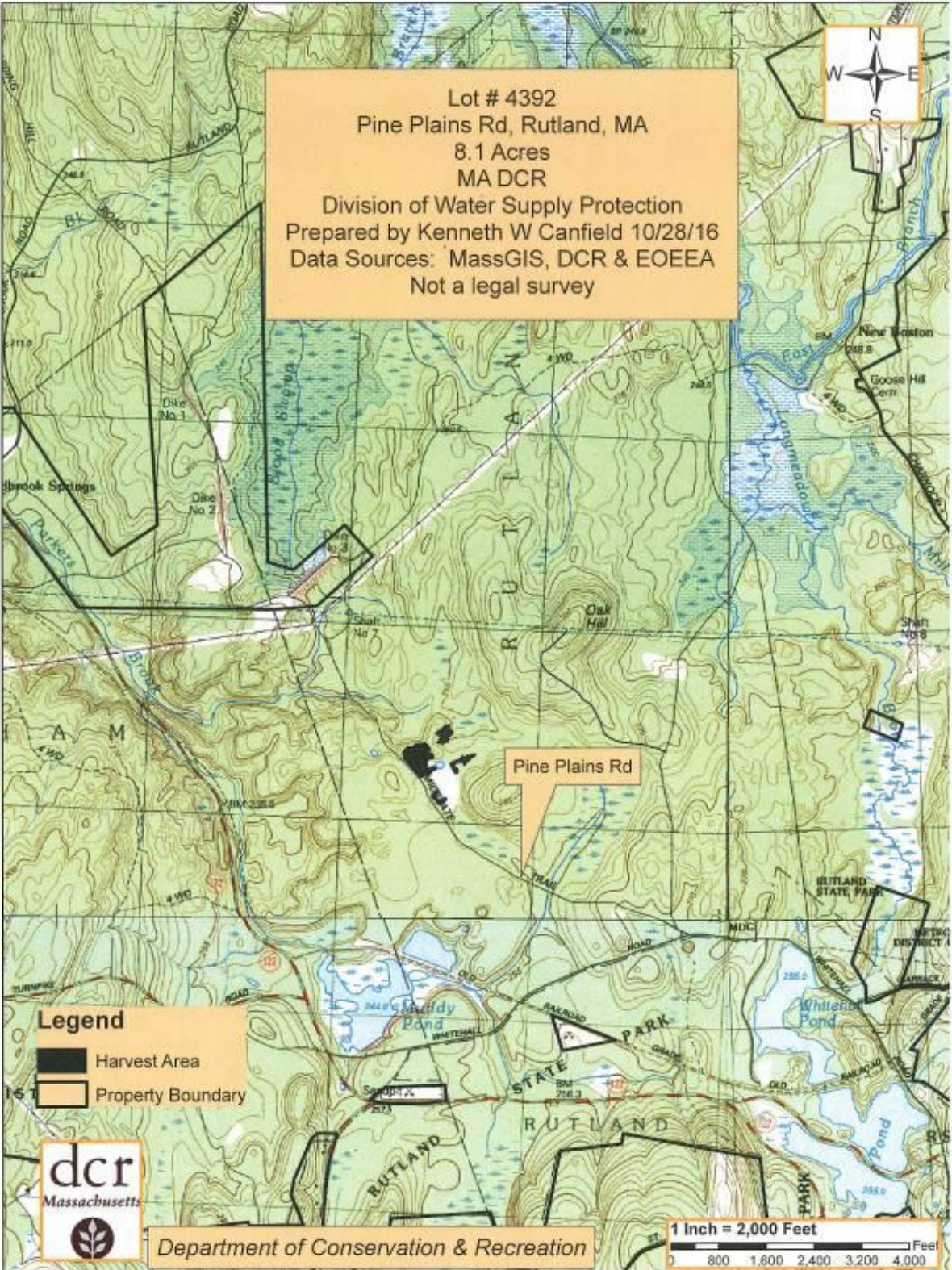

- Legend**
- Harvest Area
 - Property Boundary



Department of Conservation & Recreation



Lot # 4392
Pine Plains Rd, Rutland
8.1 acres
MA DCR DWSP
Map by Kenneth W. Canfield
10/27/16
Not a legal survey

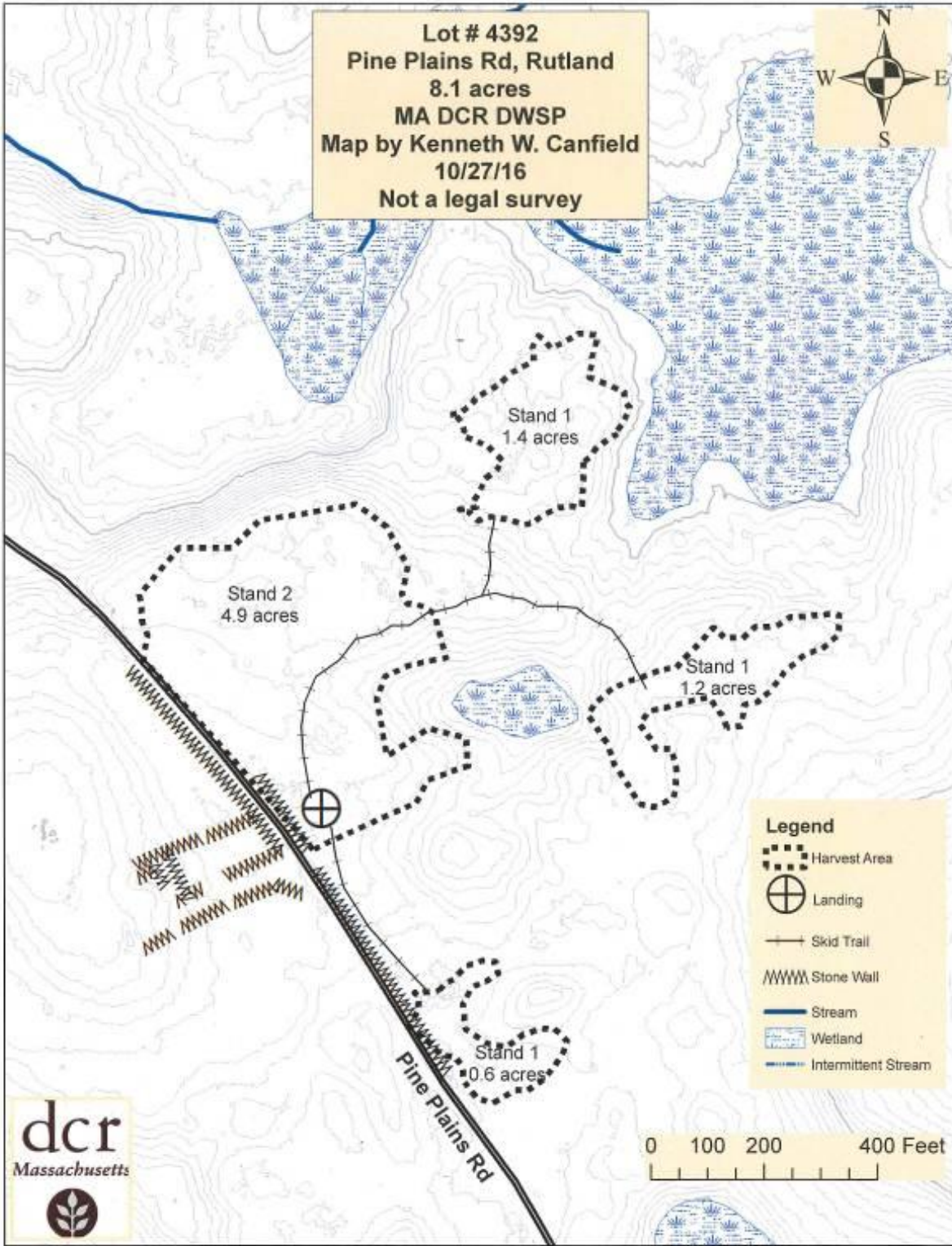

dcr



COMMONWEALTH OF MASSACHUSETTS
Department of Conservation and Recreation
Division of State Parks and Recreation

FILE # 257-8447-17

FOREST CUTTING PLAN CERTIFICATE

Post this in a conspicuous place within the area in which the harvesting operation is to take place.

This certifies that DWSP 485 Ware Rd Belcher town in accordance with the
(Name of Owner) (Address) MA 01007

provision of M.G.L. Chapter 132, Section 40-46, filed in Clinton with the Dept. of Conservation
and Recreation, Division of State Parks and Recreation, a Notice of Intent to cut forest products upon the

Pine Plum Rd lot.

Approval Date 11/17/16
Director's Agent Kate Margurs
DCR Phone No. (413) 992-8734

ISSUED BY: 
Priscilla E. Geigh, Director
Division of State Parks and Recreation

Figure 2 (A-C) Pre-Harvest photographs from marked photo point taken 1/19/17

2A From the edge of Pine Plains Rd looking north



2B From the edge of Pine Plains Rd looking northeast



2C From the edge of Pine Plains Rd looking east



Figure 3 (A-C) Post-Harvest Photographs taken from marked photo point taken 5/24/17

3A From the edge of Pine Plains Rd looking north



3B From the edge of Pine Plains Rd looking northeast



3C From the edge of Pine Plains Rd looking east



Figure 4 (A-C) Post-Harvest photographs taken 8/24/22 (after 5 growing seasons)

4A From the edge of Pine Plains Rd Looking north



4B From the edge of Pine Plains Rd looking northeast



3C From the edge of Pine Plains Rd looking east

