

Massachusetts Department of Conservation and Recreation
Division of Water Supply Protection, Office of Watershed Management
Forest Management Project Summary

Project Title: Soapstone Hill Spongy Moth Salvage

DWSP Harvest Permit Number: S11NQ
DWSP Proposal ID: PT-19-12&13-S
DCR Forest Cutting Plan File Number: 234- 9586-19

Site Information

Watershed: Quabbin	Town(s): Petersham
Acres: 25.4	Nearest Road: Soapstone Road
Natural Heritage Atlas overlap?: Yes	Public Drinking Water Supply Watershed?: Yes
Forest Types: oak-hardwood	ACEC?: No
Soils: Montauk-Scituate-Canton association, extremely stony, 3-15% slopes, and Montauk -Canton association, extremely stony, 15-45% slopes	
Wetland Resources: There are wooded wetlands outside the harvest boundary to the west, southeast, and southwest, with intermittent streams leading away from the harvest from the latter two wetlands.	
Vernal Pools: none	

Harvest Information

Harvest Start Date: 10/14/2020	Harvest End Date: 5/24/2021
Number of Wetland Crossings: none	Number of Stream Crossings: none

Best Management Practices Applied

Stream Crossings	none
Filter Strips	variable width filter strips on both streams
Wetland Crossings	none
Harvesting in Wetlands	none

DWSP Foresters supervising this harvest

Name	Helen Johnson
Forester License #	383
Phone #	617-733-2937
Email	Helen.Johnson@mass.gov

NARRATIVE

General Description/Forest Composition/History

Lot S11NQ is located on the west slopes of Soapstone Hill in Petersham. The primary forest type in the harvest area is oak-hardwood. Forest health is poor, with a large proportion of the oak dead or badly weakened by the recent spongy moth infestation.

Site Selection

This site was chosen because of its high concentration of mature oaks that died in the wake of the 2017-2019 spongy moth outbreak, and because the area is easily accessible from an existing cart road between Soapstone Road and the Gate 36B access road.

Oak, especially red oak, is one of the most economically valuable timber resources on DWSP lands. After trees die decay sets in quickly, wood boring insects begin to tunnel in, and wood value falls steeply. As part of its fiduciary responsibility to the Commonwealth of Massachusetts, DWSP conducts salvage harvests of a portion of the most valuable dead and dying trees before their value is lost forever. Locations are prioritized based on ease of access, with preference given to areas that need few or no stream or wetland crossings and are on gentle to moderate terrain, thus presenting minimal risk to the water supply. This harvest is consistent with those criteria.

Silvicultural Objectives

The primary silvicultural objective of this harvest is to salvage dead and dying oaks.

Cultural Resources

A cellar hole is located outside the harvest boundary to the south.

Rare or Endangered Species

The Natural Heritage and Endangered Species Program (NHESP) of the Division of Fisheries and Wildlife has determined that state-listed sensitive species or habitats may exist within the harvest area. To protect them from unnecessary disturbance, detailed information regarding affected species and their locations is not included here. DWSP has coordinated with NHESP to gather recommendations to protect these species during the harvest. NHESP has reviewed the Forest Cutting Plan for this lot and determined that

“Based on details in the Plan and information in our database, the Division [DFW] does not expect activities proposed in the Plan to negatively impact Estimated Habitat or result in Take (as defined in 321 CMR 10.02) of plant or animal species protected under the Massachusetts Endangered Species Act and its implementing regulations (321 CMR 10.00).”

Figure 1: Forest Cutting Plan

Forest Cutting Plan

and Notice of Intent under M.G.L.
Chapter 132 – The Forest Cutting
Practices Act, 304 CMR 11.00
(Effective Date: 1/1/04)

Extension 1 (4/20)

For DCR Use Only:

File Number <u>234-9586-19</u>	Case No. <u> </u>
Date Rec'd <u>11/2/18</u>	Nat. Hert. <u>Yes /</u>
Earliest Start <u>11/20/18</u>	Nat. Hert. Imp. <u>NO</u>
River Basin <u>Chicopee</u>	Pub. Dr. Wat. <u>N/A</u>
Gen. Obj. <u>LT</u>	ACEC <u>N/A</u>

Location

Town Petersham Lot S11NQ

Road Access: South Athol Rd. New Salem (Quabbin Gate 35)
OR Munson Turnpike, Petersham (Quabbin Gate 37)

Acres 25.4 Proposed Start Date 11/28/2018

Vol. MBF 74 Vol. Cds. 73 Vol. Tons 5

Plan Preparer

Name Helen Johnson

Address DCR-DWSP Quabbin Forestry
485 Ware Road

Town, State, Zip Belchertown, MA 01007

Phone 617-733-2937

Type of Preparer LF

*Mass. Forester License # 383

*Required for land under Ch61, Ch61A or Forest Stewardship

Landowner

Name DCR-DWSP Quabbin Forestry

Mailing Address 485 Ware Road
Helen.Johnson@mass.gov

Town, State, Zip Belchertown, MA 01007

Phone 617-733-2937

Ch61 ☐ 61A ☐ 61B ☐ Stew ☐ *Case #

CR ☐ CR Holder

Licensed Timber Harvester**

Name James Harrington

Address 4 East St

Town, State, Zip Petersham MA 01366

Phone 978-724-3452

Mass. Lic. Harvester # 2021-402

**This information may be supplied after the plan is approved, but before work begins.

Stream Crossings No Crossings

Indicate location on map	SC-1	SC-2	SC-3	SC-4
Type of Crossing				
Existing Structure				
Type of Bottom				
Bank Height (ft)				
Stabilization				

Wetland Crossings No Crossings

Indicate location on map	WC-1	WC-2	WC-3	WC-4
Length of Crossing				
Mitigation				
Stabilization				

Filter Strips

Indicate location on map	FS-1	FS-2	FS-3	FS-4
Width (50', 100', or VA)	VA	VA		

Harvesting in Wetlands None

Indicate location on map	HW-1	HW-2	HW-3	HW-4
Forest Type (see pg 2)				
Acres to be Harvested				
Resid. Basal Area (>50%)				

Service Forester Comments

Heritage - No Take - See Attached AR

Codes

Type of Preparer	Type of Crossing	Stabilization	Mitigation	Type of Bottom	Note:
LF Mass. Lic. For.	CU Culvert	SE Seed	FR Frozen	LE Ledge	<small>Applicant must provide DCR with all relevant information before plan may be approved and cutting may begin. Some forestry activities, such as prescribed burning and pesticide or fertilizer application may require additional permits. Consult MA Forestry BMP Manual for further information.</small>
TH Lic. Tim. Har	BR Bridge	MU Mulch	DR Dry	ST Stony	
TB Timber Buyer	FO Ford	CO Corduroy	OT Other	MU Mud	
LO Landowner	PO Poled	ST Stone		GR Gravel	
OT Other	OT Other	HB Hay Bales		OT Other	
		OT Other			

If Other (OT) is used in any category an explanation must be given on an attached narrative page

pg 3 of 5

Products to be Harvested*

Species	Mbf/Cds		Mbf/Cds
White Pine	0.6	Red Maple	
Red Pine		Sugar Maple	
Pitch Pine		Red Oak	47.2
Hemlock	0.2	Black Oak	20.0
Spruce		White Oak	5.1
Other Sftwd.		Other Hdwd.	0.7
White Ash		Total Mbf	73.9
Beech		Cordwood (Cds)	73
White Birch		SW Pulp (Tons)	
B & Y Birch		HW Pulp (Tons)	
Black Cherry		Chips (Tons)	

*Note: Volumes and values indicated in the Plan are as reported by the plan preparer and have not been independently verified by the service forester upon approval. Mbf = thousand board feet.

Cutting Standards

Indicate location on map	ST-1	ST-2	ST-3	ST-4
Forest Type	OH			
Acres	25.4			
Landowner Objective	LT			
Designation of Trees	CT			
Type of Cut	SA			
Source of Regeneration	AD/SE			

Landowner Signature

The most important information on a cutting plan is the Landowner's objective, as this will determine which trees will be harvested and which will remain; **this decision will also determine the future condition of the forest for decades to come.** After having read the Massachusetts Forest Cutting Plan Information Sheet on page one, indicate your objective by checking the appropriate box below.



LT - Long-term Forest Management

Planned management of the forest to achieve one or more of the following objectives: produce immediate and maximize long-term income, enhance wildlife habitat, improve recreational opportunities, protect soil and water quality, or produce forest specialty products.



ST - Short-term Harvest

Harvest of trees with the main intention of producing short-term income with minimal consideration given to improving the future forest condition, which often results in a forest dominated by poor quality and low value species.

I (we) have read the Massachusetts Cutting Plan Information Sheet, and am aware of my (our) management options.

I (we) hereby certify that I (we) have the legal authority to carry out the operation described above.

I (we) certify that I (we) have notified the Conservation Commission in the town in which the operation is to take place and the abutters of record within two hundred feet of the area to be harvested.

I (we) understand that the volumes and values (Ch61 only) in this plan have not been independently verified by the service forester upon approval and will report final values and volumes to the Director or his/her agent if the final figures differ from those reported.

Signature of landowner(s)

10-30-18
Date

Determination and Status

234.9580.19

Approved Disapproved Expires

Cutting Plan



11/2/20

Signature of Service Forester/Director's Agent

11-13-18
Date

Extension



Expires

4-22-17

Ser. For. Ints.

Amendment



Forest Types

WP White Pine
WK WP/Hem
WH WP/Hdwd
WO WP/Oak
RP Red Pine
SR Red Spruce

HK Hemlock
HH Hem/Hdwd
BC Black Cherry
BB Bee/Bir/Map
OH Oak/Hdwd
OR N Red Oak

OM Mixed Oak
RM Red Maple
BE Beech
SF Spruce/Fir
SM Sugar Maple
PP Pitch Pine

CT Cut Tree
LT Leave Tree
SB Stand Boundary
OT Other
Landowner Objective
LT Long-term Mgt.
ST Short-term Har.

SH Shelterwood
ST Seed Tree
CC Clear Cut
SE Selection
SA Salvage
SN Sanitation

Intermediate Harvester:
CT Commercial Thin
NT Non Com Thin
Non-Standard Systems:
HG Highgrade*
DL Diameter Limit*
OT Other*

Source of Regeneration
AD Advanced
SE Natural Seed
PL Plant
CO Coppice
DS Direct Seed
OT Other

*If Other (OT) or a non-standard system is used an explanation must be given on attached narrative page

Forest Cutting Plan

Narrative Page (Effective Date: 1/1/04)

Use this page to provide further explanation or if Other (OT) was used in any category on pages 3 or 4.

Landowner DCR-DWSP Quabbin

Town Petersham

File Number 234.9586-19

BMPs

Use this Section to provide further explanation or if Other (OT) was used in any category in the Best Management Practices Section on Page 3.

The primary purpose of this lot is to salvage oak that dead or dying due to gypsy moth.

BLUE PAINT: dot = cordwood / pulp; horizontal line = sawlog; vertical/diagonal line = TSI; "X" = cull; three vertical dots = edge of harvest.

Designation of Trees

Use this Section to describe the types of trees to be harvested and/or retained if Other (OT) was used for "Designation of Trees" in the Stand Treatment Section on page 4. Additional narrative description may be added on a separate page.

Stand No.	Describe Trees to be Cut			Describe Trees to be Left			% BA/AC	
	Species	Size	Quality	Species	Size	Quality	Cut	Left

Regeneration & Future Condition

Use this Section to describe how Chapter 132 requirements will be met if a non standard system (HG, DL, or OT) was used for the "Type of Cut" in the Cutting Standards Section on page 4.

Stand No. Source of Regeneration (ex. AD, SE)

How will Regeneration be obtained/protected?

If using AD - Describe the species present and how the regeneration will be protected
If using SE - Describe the source of the seed and the number of seed trees/acre

Stand No.

Desired Future Condition

Describe what the stand is expected to look like five years from the harvest, including the condition of the overstory & understory

Quabbin Lot S11NQ

Gypsy Moth Salvage
Petersham, MA

Prepared by Helen Johnson
Quabbin Watershed Forester
October 2018

1 inch = 400 feet

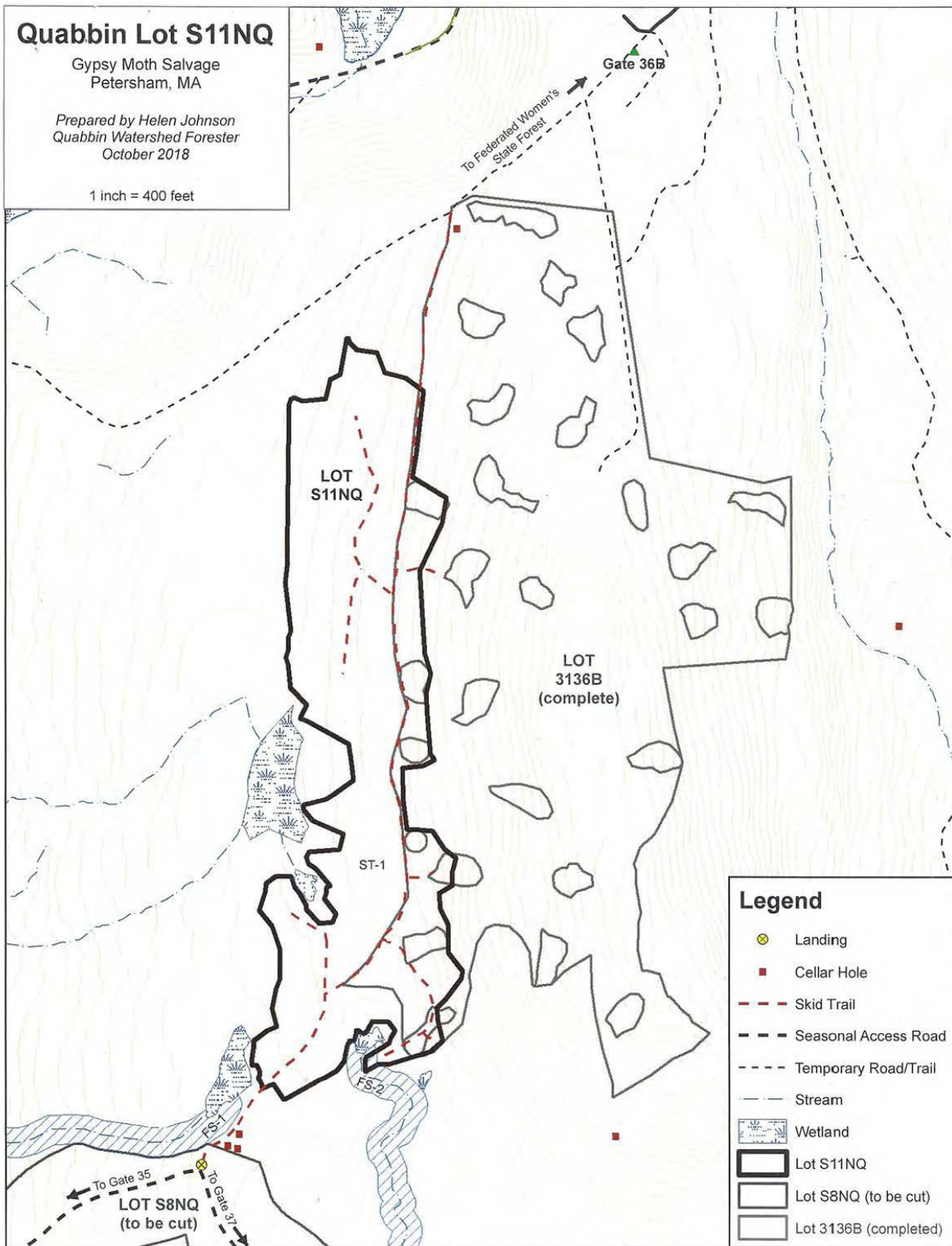

Legend

- ⊗ Landing
- Cellar Hole
- - - Skid Trail
- - - Seasonal Access Road
- - - Temporary Road/Trail
- Stream
- Wetland
- Lot S11NQ
- Lot S8NQ (to be cut)
- Lot 3136B (completed)

Quabbin Lot S11NQ

Gypsy Moth Salvage
Petersham, MA

Prepared by Helen Johnson
Quabbin Watershed Forester
October 2018

1 inch = 400 feet

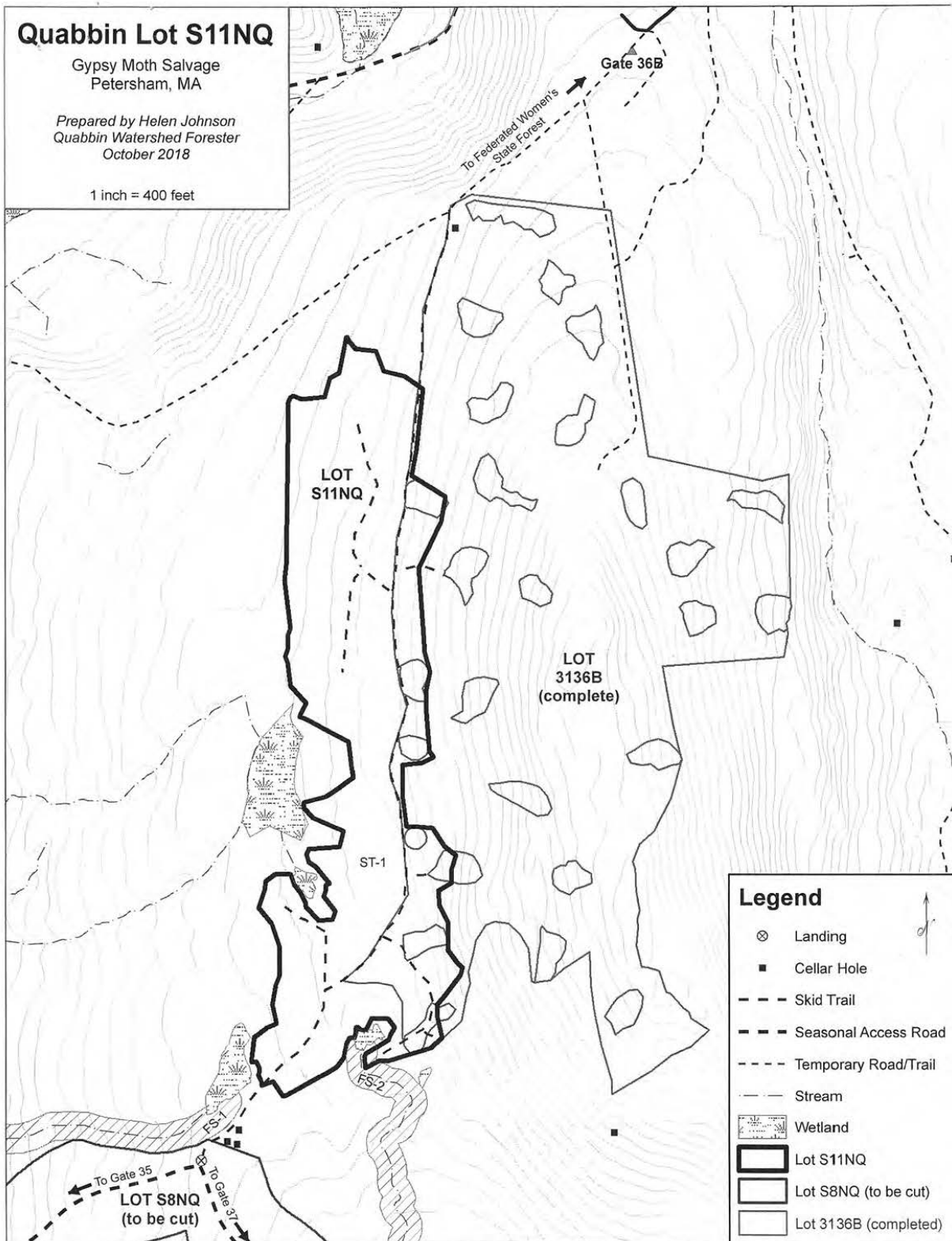

Quabbin Lot S11NQ

Gypsy Moth Salvage
Petersham, MA

Prepared by Helen Johnson
Quabbin Watershed Forester
October 2018

1 inch = 0.5 miles

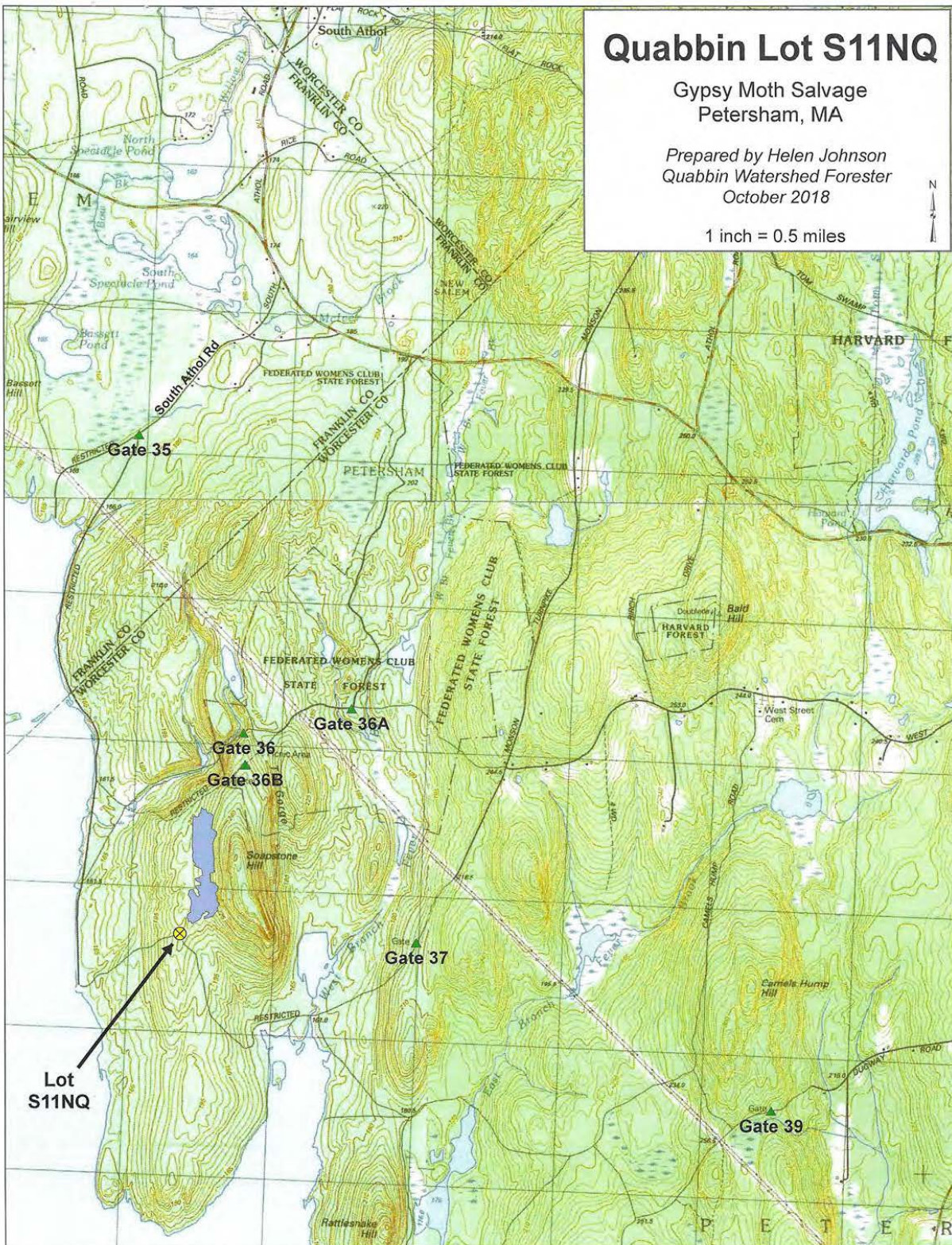



**DIVISION OF
FISHERIES & WILDLIFE**

1 Rabbit Hill Road, Westborough, MA 01581
p: (508) 389-6300 | f: (508) 389-7890
MASS.GOV/MASSWILDLIFE

Andrew Rawcliffe
Department of Conservation and Recreation
40 Cold Storage Drive
Amherst, MA 01004

Cutting Plan No. 234.9586.19
NHESP Tracking No. 18-38167
Town Petersham
Road South Athol Rd (Quabbin Gate 35)
Landowner DCR-DWSP Quabbin Forestry
Preparer Helen Johnson
Date November 13, 2018

Dear Andrew,

The Natural Heritage and Endangered Species Program (NHESP) of the Massachusetts Division of Fisheries and Wildlife ("the Division") has reviewed the above-referenced Forest Cutting Plan ("the Plan") pursuant to the special approval procedures of the Forest Cutting Practices Regulations (304 CMR 11.04(6)). Based on details of the Plan, information in the NHESP database, the Division does not expect activities proposed in the Plan to negatively impact Estimated Habitat or result in a **Take** (as defined in 321 CMR 10.02) of plant or animal species protected under the Massachusetts Endangered Species Act (MESA) (M.G.L. c. 131A) and its implementing regulations (321 CMR 10.00). Therefore, the Division does not require that the Plan be modified at this time.

Please copy the Division on any proposed amendment, extension and on the approved Plan for the site. If you have any questions about this letter, please contact Rebekah Zimmerer, NRCS Review Biologist, at (508) 389-6354 or Rebekah.zimmerer@state.ma.us.

Sincerely,

Thomas W. French, Ph.D.
Assistant Director

Cc: Petersham Conservation Commission

MASSWILDLIFE

dc



COMMONWEALTH OF MASSACHUSETTS
Department of Conservation and Recreation
Division of State Parks and Recreation

FILE #

234.9586.19

W

FOREST CUTTING PLAN CERTIFICATE

Post this in a conspicuous place within the area in which the harvesting operation is to take place.

This certifies that DCR-DWSP Quabbin 485 Ware Rd, Belchertown, MA 01007 in accordance with the
(Name of Owner) (Address)

provision of M.G.L. Chapter 132, Section 40-46, filed in Amherst F.O. with the Dept. of Conservation
and Recreation, Division of State Parks and Recreation, a Notice of Intent to cut forest products upon the

S11NQ lot, Petersham

Approval Date 11/13/18

Director's Agent Andrew Rawcliffe

DCR Phone No. 617. 549. 1677

ISSUED BY:

Priscilla E. Geigis, Director
Division of State Parks and Recreation