

**Massachusetts Department of Conservation and Recreation**  
**Division of Water Supply Protection, Office of Watershed Management**  
***Forest Management Project Summary***

**Project Title:**

<b>DWSP Harvest Permit Number:</b> 3158
<b>DCR Forest Cutting Plan File Number:</b> 204-9779-19

**Site Information**

<b>Watershed:</b> Quabbin	<b>Town(s):</b> New Salem
<b>Acres:</b> 11.5	<b>Nearest Road:</b> North Prescott; Gate 20
<b>Natural Heritage Atlas overlap?:</b> Yes	<b>Public Drinking Water Supply Watershed?:</b> Yes
<b>Forest Types:</b> Red Pine	<b>ACEC?:</b> No
<b>Soils:</b> Canton-Chatfield-Hollis, Montauk fine sandy loam	
<b>Wetland Resources:</b> No	
<b>Vernal Pools present or within 200 feet of harvest?:</b> Yes	

**Harvest Information**

<b>Harvest Start Date:</b> March 26, 2019	<b>Harvest End Date:</b> June 30, 2021
<b>Number of Wetland Crossings:</b> None	<b>Number of Stream Crossings:</b> None

**Best Management Practices Applied**

<b>Stream Crossings</b>	None
<b>Filter Strips</b>	None
<b>Wetland Crossings</b>	None
<b>Harvesting in Wetlands</b>	None

<b>DWSP Forester supervising this harvest</b>
<b>Name:</b> Derek Beard
<b>Forester License #</b> 14
<b>Phone #:</b> 617-780-0631
<b>Email:</b> derek.beard@mass.gov

ACEC: Area of Critical Environmental Concern

## **NARRATIVE**

### **General Description/Forest Composition/History:**

This watershed forestry project covers 11.5 acres located about 2 miles inside gate 20 (North Prescott Rd.). Specifically it is two separate areas (both east of the road) being 3.5 and 8 acres respectively. The areas encompass red pine planted in the late 1930/early 1940s (Civilian Conservation Corp Era "CCC"). They were thinned in the mid 1970s, late '80s and early 2000s.

### **Site Selection:**

Around 2005 red pine plantations all around the watershed came under attack by a microscopic bug, the Red Pine Scale, which developed into a full fledged infestation and eventual mortality; particularly within plantations located near the reservoir. Although the voracity of the initial infestation has ebbed the insect is still present and continues to attack more interior plantations (such as these) throughout the watershed.

The primary goal of the watershed forest management program is to create and maintain a forest that provides high quality drinking water to current users and future generations. In order to achieve this, DWSP has determined that the forest should contain a diversity of species in various stages of development (seedlings through large legacy trees). In addition, the forest should be vigorous; actively growing and regenerating. Forest in this condition is ideally suited to be resilient to and quickly recover from small and large scale disturbances such as disease, insect infestation, ice storms and hurricanes. Red Pine Scale presence coupled with strong advanced regeneration merits some regeneration harvesting.

### **Silvicultural Objectives:**

Project intent is to remove remaining red pine before succumbing to insect/disease and release regeneration spurred by prior thinning. This is being accomplished by removing three separate patches of red pine (all under 5 acres in size) which will enable the existing understory to robustly develop. Dead and Live standing trees with sign of wildlife use (these trees are known as snags) have been retained along with some healthy well- formed white pine. At landscape scale, the project will contribute to continual forest diversification.

### **Cultural Resources:**

Stone walls are the most prominent cultural resource in the project area.

### **Wildlife/Rare or Endangered Species:**

Although not present within, several vernal pools are adjacent to the project's east boundary. To ameliorate disruption chance, a 50 foot no cut buffer has been established around the pools.

Because the project falls within a MA Natural Heritage & Endanger Species (NHESP) bubble, its corresponding plan was submitted for review by NHESP, and found to have no impact on the specie(s) of concern.

Maintaining and/or enhancing habitat is a high priority when planning and executing watershed forest management projects. As such, retaining live and dead snags, trees that show sign of use by wildlife for nesting/denning, scenting and foraging is a priority.

## **FIGURES**

Figure 1. Forest Cutting Plan

Figure 1: Cutting Plan

# Forest Cutting Plan

and Notice of Intent under M.G.L.  
Chapter 132 – The Forest Cutting  
Practices Act, 304 CMR 11.00  
(Effective Date: 3/15/16)

## For DCR Use Only:

File Number 204-9779-19 Case No. -  
Date Rec'd 2-15-19 Nat. Hert. Yes  
Earliest Start 3-5-19 Pub. Dr. Wat. No  
River Basin Chicopee ACBC No  
Gen. Obj. LT

Site Information

## Location

Town New Salem  
Road North Prescott Rd. (Gate 20)  
Acres 11.5 Proposed Start Date \_\_\_\_\_  
Vol. MBF 159.1 Vol. Cds. 41 Vol. Tons 91

## Plan Preparer

Name Derek Beard  
Address 485 Ware Rd.  
Town, State, Zip Belchertown, MA 01007  
Phone (617) 780-0631  
Type of Preparer Forester  
\*Mass. Forester License # 14  
\*Required for land under Ch61, Ch61A or Forest Stewardship

## Landowner

Name DCR - Div. of Water Supply Protection  
Mailing Address 485 Ware Rd.  
Town, State, Zip Belchertown, MA 01007  
Phone 413-323-6921  
Ch61 ☐ 61A ☐ 61B ☐ Stew ☐ \*Case #  
FSC ☐ CR ☐ CR Holder

## Licensed Timber Harvester\*\*

Name \_\_\_\_\_  
Address \_\_\_\_\_  
Town, State, Zip \_\_\_\_\_  
Phone \_\_\_\_\_  
Mass. Lic. Harvester # \_\_\_\_\_

\*\*This information may be supplied after the plan is approved, but before work begins.

Best Management Practices

## Stream Crossings

Indicate location on map	SC-1	SC-2	SC-3	SC-4
Type of Crossing				
Existing Structure				
Type of Bottom				
Bank Height (ft)				
Stabilization				

## Wetland Crossings

Indicate location on map	WC-1	WC-2	WC-3	WC-4
Length of Crossing				
Mitigation				
Stabilization				

## Filter Strips

Indicate location on map	FS-1	FS-2	FS-3	FS-4
Width (50', 100', or VA)	50	50		

## Harvesting in Wetlands

Indicate location on map	HW-1	HW-2	HW-3	HW-4
Forest Type (see pg 2)				
Acres to be Harvested				
Resid. Basal Area (>50%)				

## Service Forester Comments

If Heritage = no Impact - See attached - AR

Codes

Type of Preparer	Type of Crossing	Stabilization	Mitigation	Type of Bottom	Note:
LF Mass. Lic. For.	CU Culvert	SE Seed	FR Frozen	LE Ledge	Applicant must provide DCR with all relevant information before plan may be approved and cutting may begin.
TH Lic. Tim. Har	BR Bridge	MU Mulch	DR Dry	ST Stony	Some forestry activities, such as prescribed burning and
TB Timber Buyer	FO Ford	CO Corduroy	OT Other	MU Mud	pesticide or fertilizer application may require additional permits.
LO Landowner	PO Poled	ST Stone		GR Gravel	Consult MA Forestry BMP Manual for further information.
OT Other	OT Other	HB Hay Bales		OT Other	
		OT Other			

If Other (OT) is used in any category an explanation must be given on an attached narrative page

Forest Products

## Products to be Harvested\*

Species	MBF/Cds		MBF/Cds
White Pine	3.9	Red Maple	
Red Pine	149	Sugar Maple	
Pitch Pine		Red Oak	
Hemlock		Black Oak	
Spruce		White Oak	
Other Silv.		Other Silv.	6.2
White Ash		Total MBF	159.1
Peech		Cordwood (Cds)	41
White Birch		SW Pulp (Tons)	91
B & Y Birch		HW Pulp (Tons)	
Black Cherry		Chips (Tons)	

\*Note: Volumes indicated in the Plan are as reported by the plan preparer and have not been independently verified by the service forester upon approval. MBF = thousand board feet.

Stand Treatment

## Cutting Standards

Indicate location on map	ST-1	ST-2	ST-3	ST-4
Forest Type	RP	RP	RP	
Acres	4.2	3.8	3.5	
Landowner Objective	LT	LT	LT	
Designation of Trees	CT	CT	CT	
Type of Cut	SE	SE	SE	
Source of Regeneration	AD	AD	AD	

Landowner

## Landowner Signature

The most important information on a cutting plan is the Landowner's objective, as this will determine which trees will be harvested and which will remain; this decision will also determine the future condition of the forest for decades to come. After having read the Massachusetts Forest Cutting Plan Information Sheet on page one, indicate your objective by checking the appropriate box below.



## LT - Long-term Forest Management

Planned management of the forest to achieve one or more of the following objectives: produce immediate and maximize long-term income, enhance wildlife habitat, improve recreational opportunities, protect soil and water quality, or produce forest specialty products.



## ST - Short-term Harvest

Harvest of trees with the main intention of producing short-term income with minimal consideration given to improving the future forest condition, which often results in a forest dominated by poor quality and low value species.

I (we) have read the Massachusetts Cutting Plan Information Sheet, and am aware of my (our) management options.

I (we) hereby certify that I (we) have the legal authority to carry out the operation described above.

I (we) certify that I (we) have notified the Conservation Commission in the town in which the operation is to take place and the owners of record within two hundred feet of the area to be harvested.

I (we) understand that the volumes in this plan have not been independently verified by the service forester upon approval and will report final values and volumes to the Director or his/her agent if the final figures differ from those reported.

Signature of landowner(s)

Date

Service Forester

## Determination and Status

Approval	Disapproved	Expires
Cutting Plan	<input checked="" type="checkbox"/>	2/15/21
Signature of Service Forester/Director's Agent		Date
Extension	<input type="checkbox"/>	Expires
Amendment	App 1 <input type="checkbox"/> Dis 1 <input type="checkbox"/> App 2 <input type="checkbox"/> Dis 2 <input type="checkbox"/>	Sec. For. Ints.

## Final Report and Comments

I hereby certify that the above described Forest Cutting Plan and all relevant statutes have been substantially complied with.

Signature of Service Forester/Director's Agent Date

Codes

Forest Type	Designation of Trees	Type of Cut	Source of Regeneration
WP White Pine	CT Opt Tree	SH Shelterwood	AD Advanced
WR White Birch	CT Live Tree	ST Seed Tree	SE Natural Seed
WH White Hemlock	SP Seed Boundary	CC Clear Cut	PL Plan
WB White Birch	CT Other	SE Selection	CO Coppice
RP Red Pine	Landowner Objective	SA Salvage	DS Direct Seed
SR Red Spruce	LT Long-term Mgt	SN Sanction	OT Other
	ST Short-term Har.	OT Other	

\* If Other (OT) or a non-standard system is used an explanation must be given on attached narrative page pg 4 of 5

# Forest Cutting Plan

Narrative Page (Effective Date: 3/15/16)

Use this page to provide further explanation or if Other (OT) was used in any category on pages 3 or 4.

Landowner DCR - Div. of Water Supply Protection

Town New Salem

File Number

Use this Section to provide further explanation or if Other (OT) was used in any category in the Best Management Practices Section on Page 3.

The intent of this timber harvest is to fully release advanced regeneration from an overstory of plantation red pine. This is being accomplished by creating three openings, all under five acres, where most of the overstory (red pine) is being removed. Some healthy overstory, mainly native white pine and sawtimber size cavity/denning trees (alive and dead) have been retained for structural complexity and wildlife habitat.

BMPs

Use this Section to describe the types of trees to be harvested and/or retained if Other (OT) was used for "Designation of Trees" in the Stand Treatment Section on page 4. Additional narrative description may be added on a separate page.

Stand No.	Describe Trees to be Cut			Describe Trees to be Left			% BA/AC	
	Species	Size	Quality	Species	Size	Quality	Cut	Left

Designation of Trees

Use this Section to describe how Chapter 132 requirements will be met if a non standard system (HG, DL, or OT) was used for the "Type of Cut" in the Cutting Standards Section on page 4.

Stand No.	Source of Regeneration (ex. AD, SE)	How will Regeneration be obtained/protected? If using AD - Describe the species present and how the regeneration will be protected If using SE - Describe the source of the seed and the number of seed trees/acre
-----------	--	--

Regeneration & Future Condition

Stand No.	Desired Future Condition Describe what the stand is expected to look like five years from the harvest, including the condition of the overstory & understory
-----------	---

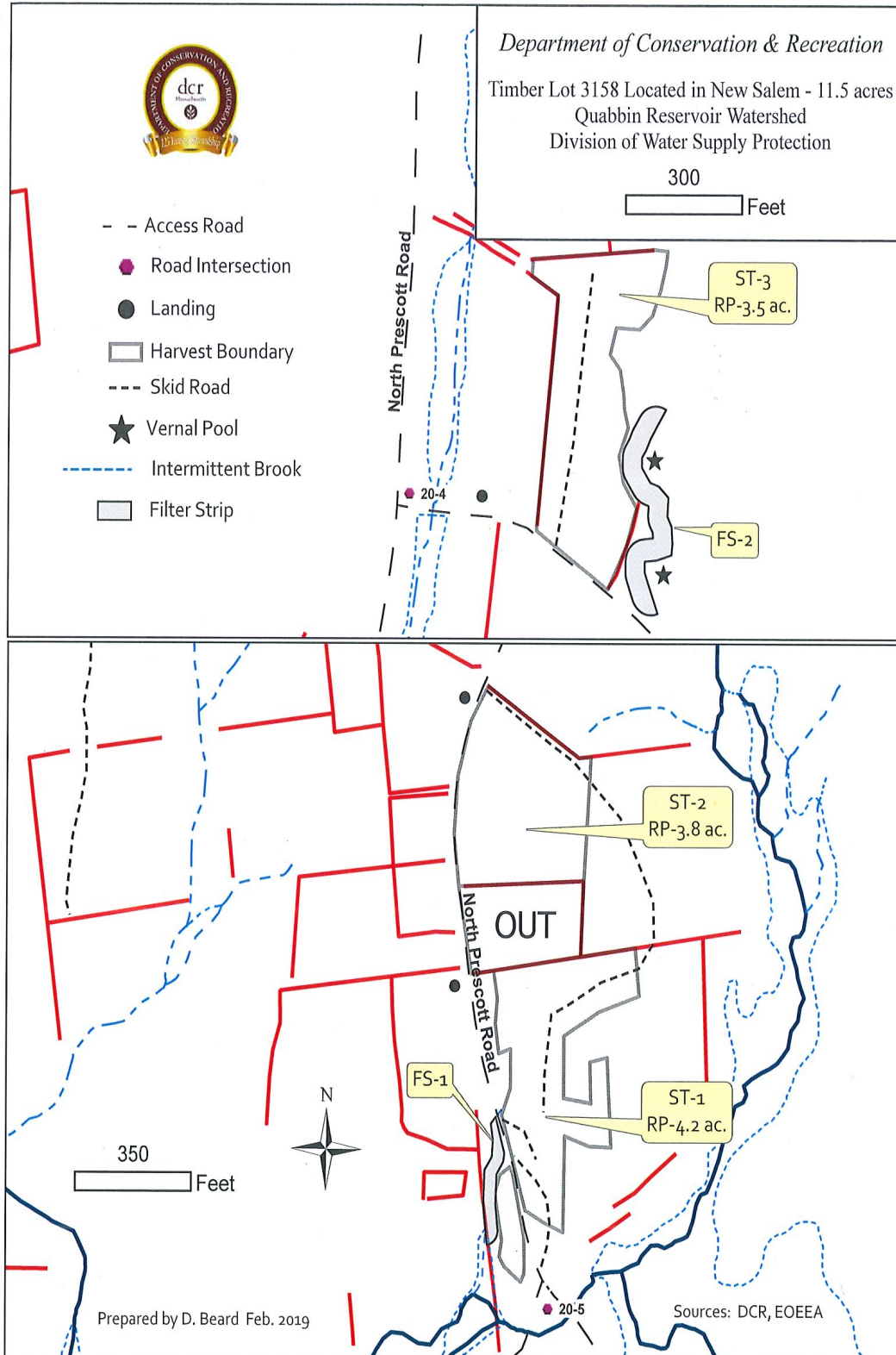



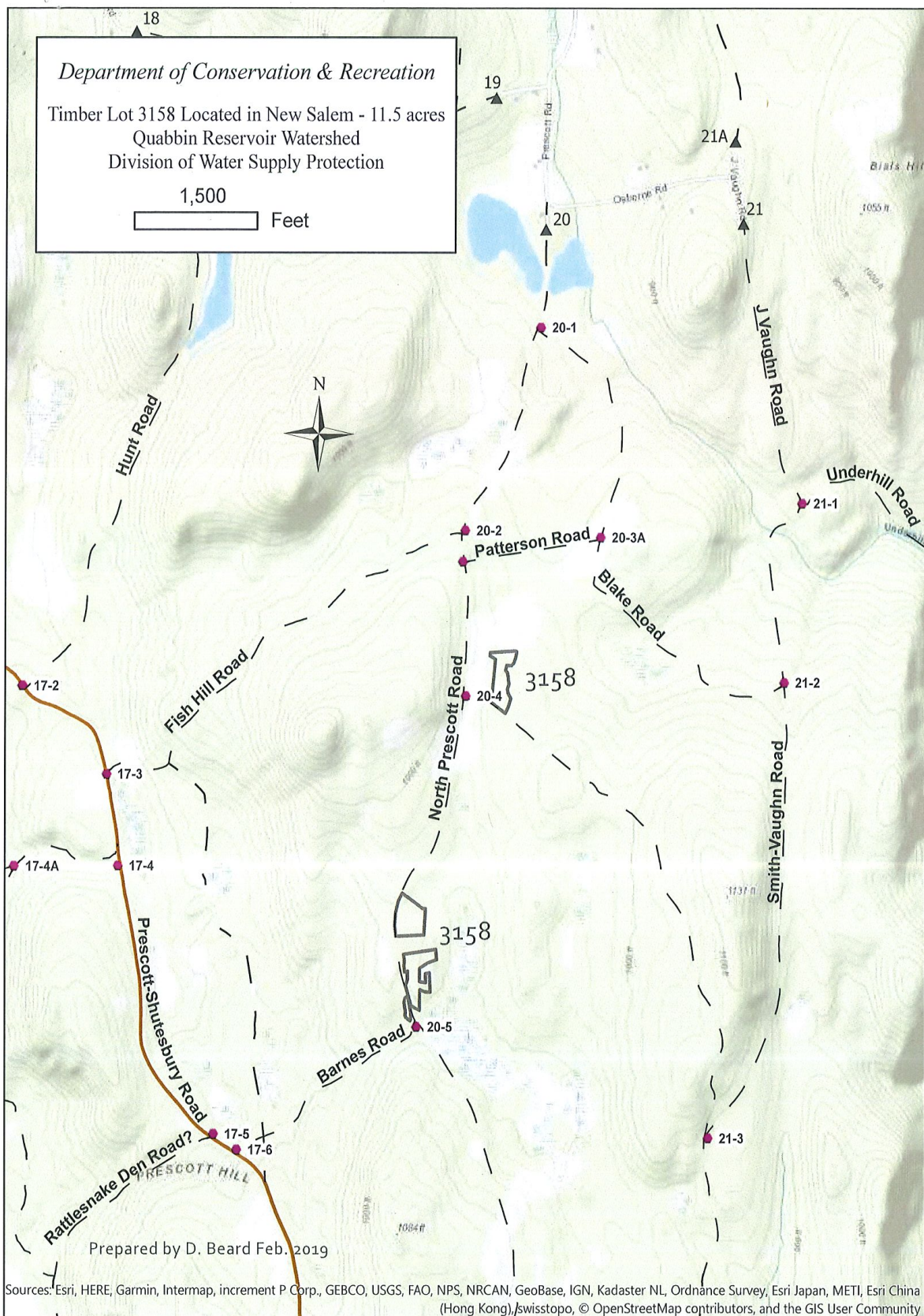



**DIVISION OF  
FISHERIES & WILDLIFE**

1 Rabbit Hill Road, Westborough, MA 01581  
p: (508) 389-6300 | f: (508) 389-7890  
**MASS.GOV/MASSWILDLIFE**

Andrew Rawcliffe  
Department of Conservation and Recreation  
40 Cold Storage Drive  
Amherst, MA 01004

Cutting Plan No. 204-9779-19  
NHESP Tracking No. 19-38384  
Town New Salem  
Road North Prescott Rd. (Gate 20)  
Landowner DCR - Div. of Water Supply Protection  
Preparer Derek Beard  
Date February 20, 2019

Dear Andrew,

The Natural Heritage and Endangered Species Program (NHESP) of the Massachusetts Division of Fisheries and Wildlife ("the Division") has reviewed the above-referenced Forest Cutting Plan ("the Plan") pursuant to the special approval procedures of the Forest Cutting Practices Regulations (304 CMR 11.04(6)). Based on details of the Plan and information in the NHESP database, the Division does not expect activities proposed in the Plan to negatively impact Estimated Habitat or result in Take (as defined in 321 CMR 10.02) of plant or animal species protected under the Massachusetts Endangered Species Act (MESA) (M.G.L. c. 131A) and its implementing regulations (321 CMR 10.00). Therefore, the Division does not require that the Plan be modified at this time.

Please copy the Division on any proposed amendment, extension and on the approved Plan for the site. If you have any questions about this letter, please contact Rebekah Zimmerer at (508) 389-6354 or [Rebekah.zimmerer@state.ma.us](mailto:Rebekah.zimmerer@state.ma.us).

Sincerely,

A handwritten signature in black ink that reads "Thomas W. French".

Thomas W. French, Ph.D.  
Assistant Director

Cc: New Salem Conservation Commission

**MASSWILDLIFE**

dc



COMMONWEALTH OF MASSACHUSETTS  
Department of Conservation and Recreation  
Division of State Parks and Recreation

FILE #

204.9779.19

W

## FOREST CUTTING PLAN CERTIFICATE

Post this in a conspicuous place within the area in which the harvesting operation is to take place.

This certifies that DCR-DWSP 485 Ware Rd, Belchertown, MA in accordance with the  
(Name of Owner) (Address) 01007

provision of M.G.L. Chapter 132, Section 40-46, filed in Amherst F.O. with the Dept. of Conservation  
and Recreation, Division of State Parks and Recreation, a Notice of Intent to cut forest products upon the  
N. Prescott Rd lot. (Gak 20), New Salem

Approval Date 2/20/19

Director's Agent Andrew Rawcliffe

DCR Phone No. 617.549.1677

ISSUED BY:

*Priscilla E. Geigis*

Priscilla E. Geigis, Director  
Division of State Parks and Recreation