

Massachusetts Department of Conservation and Recreation
Division of Water Supply Protection, Office of Watershed Management
Forest Management Project Summary

Project Title:

DWSP Harvest Permit Number: 3160
DCR Forest Cutting Plan File Number: 204-11152-19

Site Information

Watershed: Quabbin	Town(s): New Salem
Acres: 50	Nearest Road: Cooleyville, Gate 17
Natural Heritage Atlas overlap?: Yes	Public Drinking Water Supply Watershed?: Yes
Forest Types: White Pine/Red Pine	ACEC?: No
Soils: Gneiss derived rock sandy loam	
Wetland Resources: No	
Vernal Pools present or within 200 feet of harvest?: No	

Harvest Information

Harvest Start Date: June, 6, 2019	Harvest End Date: June 30, 2021
Number of Wetland Crossings: None	Number of Stream Crossings: None

Best Management Practices Applied

Stream Crossings	None
Filter Strips	None
Wetland Crossings	None
Harvesting in Wetlands	None

DWSP Forester supervising this harvest
Name: Derek Beard
Forester License # 14
Phone #: 617-780-0631
Email: derek.beard@mas.gov

ACEC: Area of Critical Environmental Concern

NARRATIVE

General Description/Forest Composition/History:

This watershed forestry project covers 50 acres of White/Red Pine forest (all the red pine is plantation) located near the old UMASS observatory site on the east side of the gate 17 Road (Prescott Rd).

All areas have been thinning once and in some cases twice. First thinnings were completed in the 1980s. Beginning in the early to middle 2000s red pine, throughout the watershed, began to rapidly die from infestation of the red pine scale; a microscopic insect that pierces the needle disrupting photosynthesis leading to death. The primary goal of the harvest is to remove the plantations, improve timber quality of native species and release/spur growth of a young forest age class.

Site Selection:

The primary goal of the watershed forest management program is to create and maintain a forest that provides high quality drinking water to current users and future generations. In order to achieve this, DWSP has determined that the forest should contain a diversity of species in various stages of development (seedlings through large legacy trees). In addition, the forest should be vigorous; actively growing and regenerating. Forest in this condition is ideally suited to be resilient to and quickly recover from small and large scale disturbances such as disease, insect infestation, ice storms and hurricanes. Sufficient advanced regeneration coupled with an underrepresented young forest layer merits some regeneration harvesting.

Silvicultural Objectives:

Harvest purpose is to ameliorate further red pine mortality by removing the plantations, improve timber quality of native species (primarily white pine) and release/spur growth of a young forest age class. Achievement of these objectives should lead to a more diverse resilient forest over the long term.

Cultural Resources:

Stone walls are the most prominent cultural resource in the project area. There are also two old field stone wells that have been identified.

Wildlife/Rare or Endangered Species:

Maintaining and/or enhancing habitat is a high priority when planning and executing watershed forest management projects. As such, retaining live and dead snags, trees that show sign of use by wildlife for nesting/denning, scenting and foraging is a priority. Falling in a natural heritage bubble, the project area was reviewed by MA Natural Heritage and Endanger Species program and deemed to have no impact on the specie(s) within the bubble.

FIGURES

Figure 1. Forest Cutting Plan

Figure 1: Cutting Plan

Forest Cutting Plan

and Notice of Intent under M.G.L.
Chapter 132 – The Forest Cutting
Practices Act, 304 CMR 11.00
(Effective Date: 3/15/16) Final 1/20

For DCR Use Only:

File Number <u>204-1152-19</u>	Case No. <u>---</u>
Date Rec'd <u>6-11-19</u>	Nat. Herd. <u>Yes</u>
Earliest Start <u>6-26-19</u>	Pub. Dr. Wat. <u>No</u>
River Basin <u>Chicopee</u>	ACEC <u>No</u>
Gen. Obj. <u>LT</u>	

Site Information

Location

Town New Salem

Road Cooleyville Rd. (Gate 17)

Acres 50 Proposed Start Date _____

Vol. MBF 561 Vol. Cds. 146 Vol. Tons 835

Plan Preparer

Name Derek Beard

Address 485 Ware Rd.

Town, State, Zip Bekerkown MA 01007

Phone (617) 780-0631

Type of Preparer Forester

*Mass. Forester License # 14

*Required for land under Ch61, Ch61A or Forest Stewardship

Best Management Practices

Stream Crossings

Indicate location on map	SC-1	SC-2	SC-3	SC-4
Type of Crossing				
Existing Structure				
Type of Disturb				
Bank Elevation (ft)				
Stabilization				

Wetland Crossings

Indicate location on map	WC-1	WC-2	WC-3	WC-4
Length of Crossing				
Mitigation				
Stabilization				

Filter Strips

Indicate location on map	FS-1	FS-2	FS-3	FS-4
Width (50', 100', or VA)				

Codes

Type of Stream	Type of Crossing	Stabilization	Mitigation	Type of Disturb	Note
LF Mass. Tr. C. R.	CU Culvert	ST Seed	PR Pison	LE Edge	<p><i>Note:</i></p> <p>Applicant must submit DCR with all relevant information before plan may be approved and cutting may begin.</p> <p>Some forestry activities, such as, pre-cutting, seedling and post-harvest or further application may require additional permits. Consult MA Forestry BMP Manual for further information.</p>
TH Dec. Tim. Har	DB Bridge	ML Mulch	DR Dry	ST Spray	
TD Timber Degr	FD Fard	CO Covering	OT Other	ML Mulch	
LO Landowner	PO Poles	ST Stone		GR Ground	
OT Other	OK Other	EH Haystack		OT Other	
		OT Other			

Landowner

Name DCR - Div. of Water Supply Protection

Mailing Address 485 Ware Rd.

Town, State, Zip Bekerkown MA 01007

Phone 413-323-6921

Ch61 ☐ Ch61A ☐ Ch61B ☐ Stew ☐ *Case # _____

FSC ☐ CR ☐ CR Holder

Licensed Timber Harvester**

Name King Timber Harvesting

Address 25 Raymond Hill Rd

Town, State, Zip Holliston, MA 01452

Phone 978-920-4422

Mass. Lic. Harvester # 2020-262/128

**This information may be supplied after the plan is approved, but before work begins.

Harvesting in Wetlands

Indicate location on map	HW-1	HW-2	HW-3	HW-4
Forest Type (see pg. 2)				
Acres to be Harvested				
Resid. Basal Area (>5000?)				

Service Forester Comments

Seed Tree requires retention of 4 Seed Trees >20" DBH/acre and has been marked as such - AR

Harvest = No Impact - See Attached - AR

If Other (OT) is used in any category an explanation must be given on an attached narrative page

pg 3 of 5

Products to be Harvested*

Species	MBF Cds		MBF Cds
White Pine	108	Red Maple	1
Red Pine	407	Sugar Maple	9
Pitch Pine		Red Oak	3
Hemlock		Black Oak	
Spruce		White Oak	
Other Silv.		Other Hard	
White Ash	31	Total MBF	581
Beech		Conduct (Cbs)	148
White Birch		SW Pulp (Tons)	835
B & Y Birch	1	HW Pulp (Tons)	
Black Cherry	2	Chips (Tons)	

*Note: Volumes indicated in the Plan are as reported by the plan preparer and have not been independently verified by the service forester upon approval. MBF = thousand board feet.

Cutting Standards

Indicate location on map	ST-1	ST-2	ST-3	ST-4
Forest Type	WP/RS	WP/RS	WP/RS	WP/RS
Acres	6	29	6	7
Landowner Objective	LT	LT	LT	LT
Designation of Trees	CT	CT	CT	CT
Type of Cut	ST	SE	ST	SA
Source of Regeneration	AD	AD	AD	AD

Landowner Signature

The most important information on a cutting plan is the Landowner's objective, as this will determine which trees will be harvested and which will remain; this decision will also determine the future condition of the forest for decades to come. After having read the Massachusetts Forest Cutting Plan Information Sheet on page one, indicate your objective by checking the appropriate box below.



LT - Long-term Forest Management

Planned management of the forest to achieve one or more of the following objectives: produce immediate and maximize long-term income, enhance wildlife habitat, improve recreational opportunities, protect soil and water quality, or produce forest specialty products.



ST - Short-term Harvest

Harvest of trees with the main intention of producing short-term income with minimal consideration given to improving the future forest condition, which often results in a forest dominated by poor quality and low value species.

I (we) have read the Massachusetts Cutting Plan information Sheet, and am (are) aware of my (our) management options.

I (we) hereby certify that I (we) have the legal authority to carry out the operation described above.

I (we) certify that I (we) have notified the Conservation Commission in the town in which the operation is to take place and the shunters of record within two hundred feet of the area to be harvested.

I (we) understand that the volumes in this plan have not been independently verified by the service forester

upon approval and will report final values and volumes to the Director or higher agent if the final figures differ from those reported.

Signature of Landowner(s)

6-5-19

Date

Determination and Status 204.11152-19

Approved ☒ Disapproved ☐ Expires

Cutting Plan ☒ 6-4-21

Signature of Service Forester/Director's Agent

6-19-19
Date

Extension ☐ ☐ Expires

App 1 ☐ Dis 1 ☐ App 2 ☐ Dis 2 ☐

Final Report and Comments

I hereby certify that the above described Forest Cutting Plan and all relevant statutes have been substantially complied with.

Signature of Service Forester/Director's Agent

1-6-2020
Date

Forest Type	Species	Designation of Trees	Type of Cut	Source of Regeneration
WP White Pine	HK Hemlock	CT Cut Tree	ST Short-term Harvest	AD Advanced
WK White Birch	HM Hem Hard	LT Leave Tree	CT Commercial Thin	SE Natural Seed
WR White Red	BC Black Cherry	SR Short Rotation	CT Clear Cut	HL Plant
WO White Oak	BB Beech	OT Other	SE Selection	NS Non-Standard System*
RP Red Pine	UN White Birch	LT Long-term Mgt	SA Salvage	HT Highgrade
SR Red Spruce	CR Red Oak	ST Short-term Har	SN Sanitation	DL Darker Luma*
			OT Other*	OT Other

*If Other (OT) or a non-standard system is used an explanation must be given on attached narrative page pg. 4 of 5

Forest Cutting Plan

Narrative Page (Effective Date: 3/15/16)

Use this page to provide further explanation or if Other (OT) was used in any category on pages 3 or 4.

Landowner DCR - Div. of Water Supply Protection

Town New Salem

File Number 204-11152-19

BMPs

Use this Section to provide further explanation or if Other (OT) was used in any category in the Best Management Practices Section on Page 3.

The intent of this timber harvest is to substantially reduce the red pine component of these mixed softwood (white pine/red pine) plantations. In past decades, red pine, a species native to the upper mid-west, has died throughout the watershed; falling prey to a scale insect and diplotia fungus. Although mostly alive, significant mortality has struck the southern portion of the project (stands designated as salvage "SA"). Stand two is a DCR approved large opening with green tree retention of mainly white pine and black birch. Live and dead trees with cavity den, bird peck (excavation) sign (know as snags) will be retained throughout the project area. Ultimately, the project should lead to future forest that is healthier and more diverse in composition and structure.

Designation of Trees

Use this Section to describe the types of trees to be harvested and/or retained if Other (OT) was used for "Designation of Trees" in the Stand Treatment Section on page 4. Additional narrative description may be added on a separate page.

Stand No.	Describe Trees to be Cut			Describe Trees to be Left			% BA/AC	
	Species	Size	Quality	Species	Size	Quality	Cut	Left

Regeneration & Future Condition

Use this Section to describe how Chapter 132 requirements will be met if a non standard system (HG, DL, or OT) was used for the "Type of Cut" in the Cutting Standards Section on page 4.

Stand No.	Source of Regeneration (ex. AD, SE)	How will Regeneration be obtained/protected? If using AD - Describe the species present and how the regeneration will be protected If using SB - Describe the source of the seed and the number of seed trees/acre
-----------	-------------------------------------	--

Stand No.	Desired Future Condition Describe what the stand is expected to look like five years from the harvest, including the condition of the overstory & understory
-----------	---

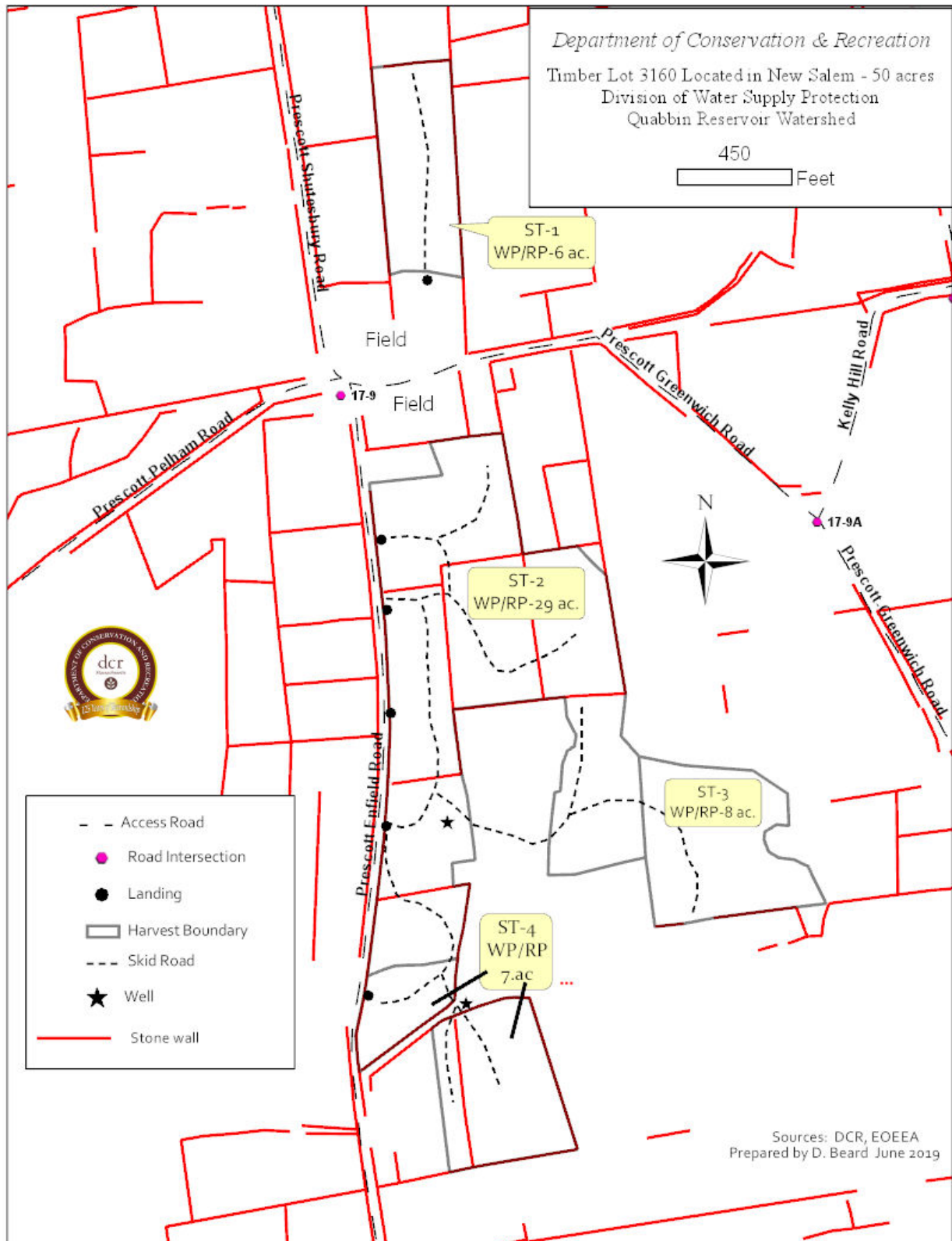

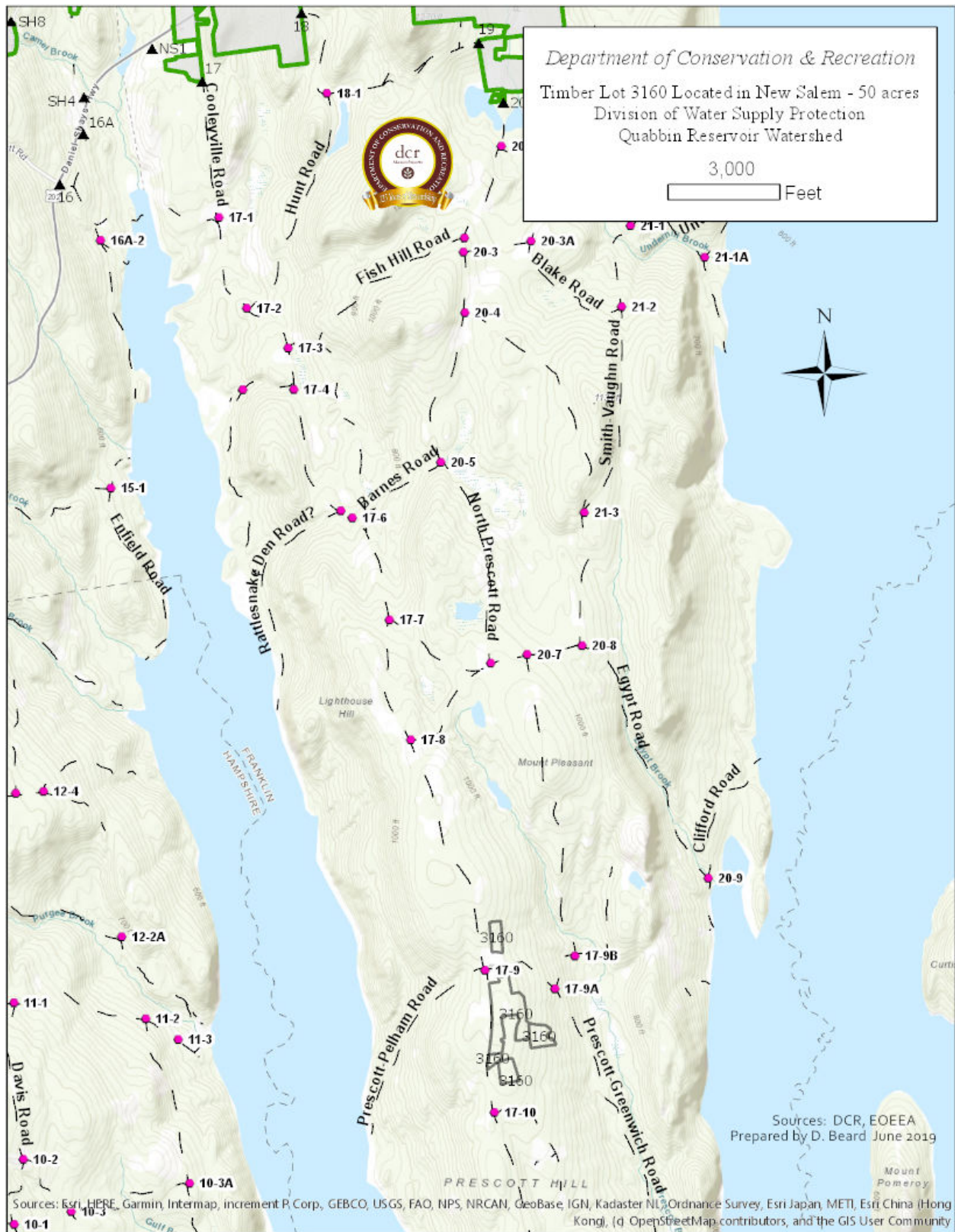



MASSWILDLIFE

**DIVISION OF
FISHERIES & WILDLIFE**

1 Rabbit Hill Road, Westborough, MA 01581
p: (508) 389-6300 | f: (508) 389-7890
MASS.GOV/MASSWILDLIFE

Andrew Rawcliffe
Department of Conservation and Recreation
40 Cold Storage Drive
Amherst, MA 01004

Cutting Plan No. 204-1152-19
NHESP Tracking No. 19-38707
Town New Salem
Road Cooleyville Road
Landowner DCR-DWSP
Preparer Derek Beard
Date June 14, 2019

Dear Andrew,

The Natural Heritage and Endangered Species Program (NHESP) of the Massachusetts Division of Fisheries and Wildlife ("the Division") has reviewed the above-referenced Forest Cutting Plan ("the Plan") pursuant to the special approval procedures of the Forest Cutting Practices Regulations (304 CMR 11.04(5)). Based on details of the Plan and information in the NHESP database, the Division does not expect activities proposed in the Plan to negatively impact Estimated Habitat or result in Take (as defined in 321 CMR 10.02) of plant or animal species protected under the Massachusetts Endangered Species Act (MESA) (M.G.L. c. 131A) and its implementing regulations (321 CMR 10.00). Therefore, the Division does not require that the Plan be modified at this time.

Please copy the Division on any proposed amendment, extension and on the approved Plan for the site. If you have any questions about this letter, please contact Rebekah Zimmerer at (508) 389-6354 or Rebekah.zimmerer@state.ma.us.

Sincerely,

Jonathan V. Regosin, Ph.D.
Deputy Director

Cc: New Salem Conservation Commission

MASSWILDLIFE



COMMONWEALTH OF MASSACHUSETTS
Department of Conservation and Recreation
Division of State Parks and Recreation



FILE # 204-11152-19

FOREST CUTTING PLAN CERTIFICATE

Post this in a conspicuous place within the area in which the harvesting operation is to take place.

This certifies that DDR-DWSP 485 Ware Rd, Belchertown, MA 01007 in accordance with the
(Name of Owner) (Address)

provision of M.G.L. Chapter 132, Section 40-46, filed in Amherst F.O. with the Dept. of Conservation
and Recreation, Division of State Parks and Recreation, a Notice of Intent to cut forest products upon the

Gate 17 lot, New Salem
(Cooleyville Rd)

Approval Date 6/19/19

Director's Agent Andrew Rawcliffe

DCR Phone No. 617-549-1677

ISSUED BY:

Priscilla E. Geigis, Director
Division of State Parks and Recreation