

DIRECTIONS TO THE BOSTON CONVENTION AND EXHIBITION CENTER (BCEC)



FROM Logan International Airport and Route 1A South: Follow the signs towards "I-90 West"- Ted Williams Tunnel. Take I-90 West/Ted Williams Tunnel to Exit 25, "South Boston". At the top of the ramp take a right onto Congress Street. Take the next right onto D Street. After the highway ramp, turn right onto Summer Street. Turn left at the first light (World Trade Center Avenue). You will immediately see the valet area on your right hand side. To access the self-parking lot, drive past the valet area, and continue straight along the side of the building. At the end of the building, make a right and go down the ramp. At the bottom of the ramp, turn left and you will see the entrance to the South Parking Lot in front of you. Additional parking is available in the Boston Marine Industrial Park (BMIP) Garage (7 Drydock Avenue).

FROM Western Massachusetts via Massachusetts Turnpike: Follow the Massachusetts Turnpike /I-90 East to Exit 25, "South Boston". At the top of the ramp, bear left towards "Seaport Boulevard". At the first set of lights, take a right onto Congress Street. Take the second right onto D Street. After the highway ramp, turn right onto Summer Street. Turn left at the first light (World Trade Center Avenue). You will immediately see the valet area on your right hand side. To access the self-parking lot, drive past the valet area, and continue straight along the side of the building. At the end of the building, make a right and go down the ramp. At the bottom of the ramp, turn left and you will see the entrance to the South Parking Lot in front of you. Additional parking is available in the Boston Marine Industrial Park (BMIP) Garage (7 Drydock Avenue).

FROM Points South via I-93 (passenger vehicles ONLY): Take I-93 North to Exit 20 (immediately after Exit 18). Follow the signs to "I-90 East". Take the first tunnel exit to "South Boston". At the first set of lights, take a right onto Congress Street. Take the second right onto D Street. After the highway ramp, turn right onto Summer Street. Turn left at the first light (World Trade Center Avenue). You will immediately see the valet area on your right hand side. To access the self-parking lot, drive past the valet area, and continue straight along the side of the building. At the end of the building, make a right and go down the ramp. At the bottom of the ramp, turn left and you will see the entrance to the South Parking Lot in front of you. Additional parking is available in the Boston Marine Industrial Park (BMIP) Garage (7 Drydock Avenue).

FROM Points North via I-93: Take I-93 South to Exit 23, "Purchase Street/South Station". At the end of the ramp, continue onto Purchase Street. Take a left onto Summer Street at South Station. Follow Summer Street for approximately 1 mile, and the BCEC will be on your right hand side. Turn right at the second entrance to the BCEC (World Trade Center Avenue). You will immediately see the valet area on your right hand side. To access the self-parking lot, drive past the valet area, and continue straight along the side of the building. At the end of the building, make a right and go down the ramp. At the bottom of the ramp, turn left and you will see the entrance to the South Parking Lot in front of you. Additional parking is available in the Boston Marine Industrial Park (BMIP) Garage (7 Drydock Avenue).

Directions to the BOSTON MARINE INDUSTRIAL PARK (BMIP) GARAGE (7 Drydock Avenue)

From Logan International Airport and 1A South: I90W to Ted Williams Tunnel Exit 25 "South Boston", take a right on Congress Street, Right on D Street, Left on Summer Street and Left onto Drydock Avenue. End at the Boston Marine Industrial Park.

From Western Massachusetts: I90E to Exit 25 "South Boston", take a right on Congress Street, Right on D Street, Left on Summer Street and Left onto Drydock Avenue. End at the Boston Marine Industrial Park.

From I93 Southbound: I93 to Exit 23- "Purchase Street", take a left at the top of the Ramp, Go straight onto Seaport Blvd. which becomes Northern Ave., take a right on D Street, Left on Summer Street and Left onto Drydock Avenue. End at the Boston Marine Industrial Park.

From I93 Northbound: I93 North to Exit 20 "I90E Logan Airport", follow Massachusetts Turnpike/I90E to Exit 25 "South Boston". Take a right on Congress Street, Right on D Street, Left on Summer Street and Left onto Drydock Avenue. End at the Boston Marine Industrial Park.

**There will be a shuttle to bring you to the Boston Convention & Exhibition Center (BCEC).*



Driving to BMIP

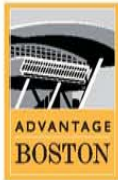

Boston Convention & Exhibition Center

415 Summer Street
Boston, Massachusetts 02210
ph: 617.954.2800 fx: 617.954.3326
www.AdvantageBOSTON.com

Exhibit Level

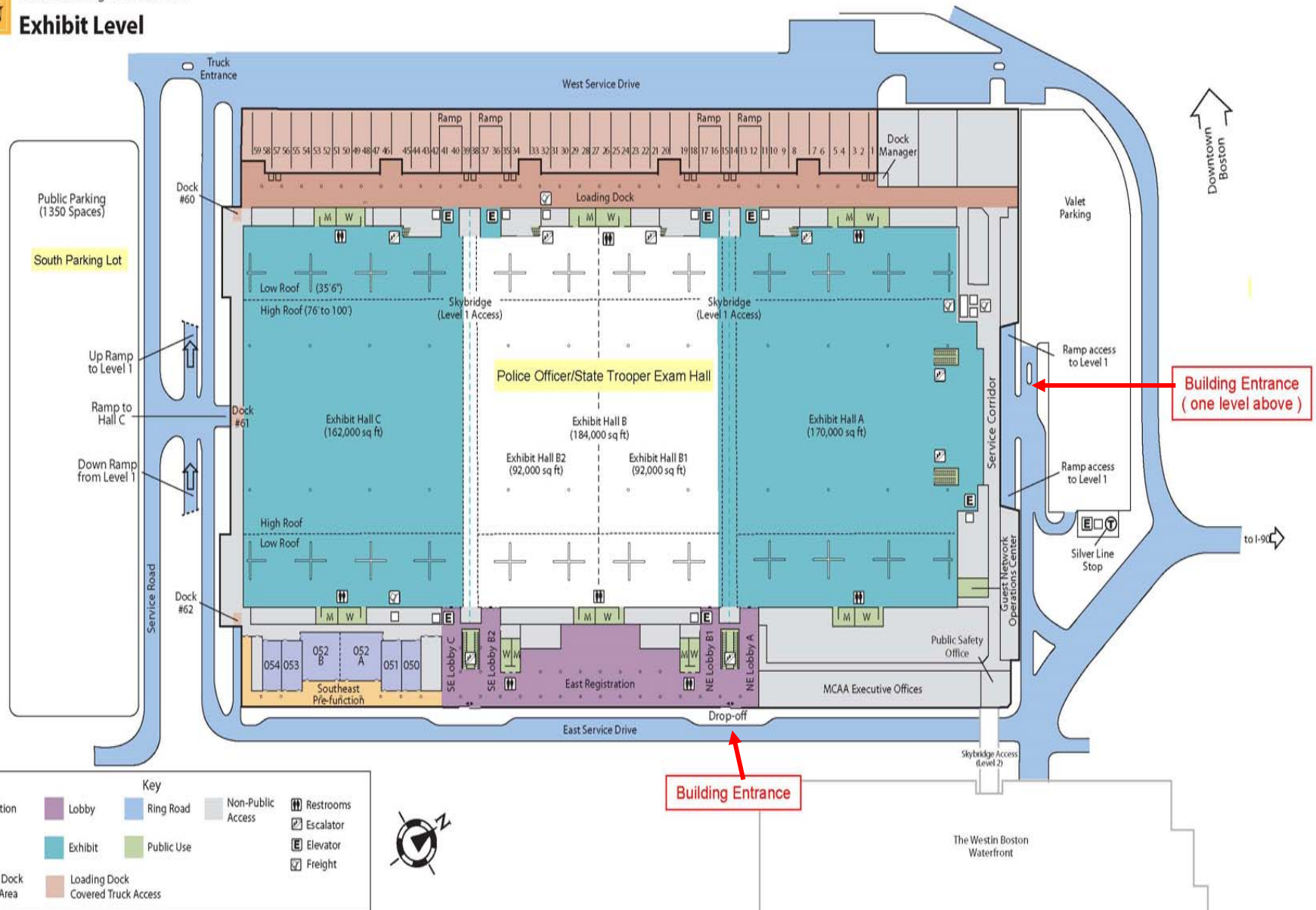

The Massachusetts Convention Center Authority owns and operates the Boston Convention & Exhibition Center and the Hynes Convention Center.