

**Massachusetts Department of Conservation and Recreation
Division of Water Supply Protection, Office of Watershed Management
*Forest Management Project Summary***

Project Title

DWSP Harvest Permit Number: 5307

DWSP Proposal ID: WA-23-295

DCR Forest Cutting Plan File Number: 282-41548-24

Site Information

Watershed: Wachusett

Town(s): Sterling

Acres: 55.8

Nearest Road: Beaman Road

Natural Heritage Atlas overlap?: No

Public Drinking Water Supply Watershed?: Yes

Forest Types: White pine/Oak, Mixed Oak, Oak/Hardwoods

Area of Critical Environmental Concern (ACEC)?: No

Soils: Canton and Paxton fine sandy loams, Chatfield-Hollis-Rock Outcrop complex

Wetland Resources: There's a large wetland on the northeast side of this area and a narrow wooded-wetland on the east side.

Vernal Pools: None

Harvest Information

Harvest Start Date: 9/25/24

Harvest End Date: 12/14/26

Number of Wetland Crossings: Two

Number of Stream Crossings: None

Best Management Practices Applied

Stream Crossings: There are no stream crossings.

Filter Strips: There is no harvesting in the filter strips.

Wetland Crossings: Both wetland crossings will be corduroyed with an appropriate volume of wood depending on conditions.

Harvesting in Wetlands: There is no harvesting in wetlands.

DWSP Forester supervising this harvest

Name: Greg Buzzell

Forester License number: 025

Phone number: 774-261-1841

Email: greg.buzzell@mass.gov

Narrative

General Description/Forest Composition/History

This forest can be characterized by its mix of rocky hill tops, unique wetland areas and evidence of past land usage. This property was acquired in 2000 and has had no forestry work done since it was purchased. However, there have been recent harvests all around this working unit (both DWSP and private) and the results suggest a harvest will result in a strong diverse young forest. The main tree species of this working unit are white pine, red oak white oak, red maple and black oak with lesser amounts of yellow birch, sassafras, hemlock, black birch, and hickory in the overstory. The best regeneration in the working unit is located on several rocky hilltops where regeneration is currently good enough to release. There is a smattering of mountain laurel and witch-hazel in these areas and some taller black birch just beyond regeneration size that was released in a prior harvest evidenced by hardwood stumps in the northwest region. There are also some pine stumps in the lower elevation eastern region which is covered with mountain laurel and hemlock. The large red maple wetland in the northern section is surrounded by thick sweet pepperbush and mountain laurel. Overall, the wetter soils have more mountain laurel and witch-hazel. The far eastern portion of the working unit is covered with old cabins, housewares, vehicles and an outdoor pool from a previous summer camp.

Site Selection

This working unit was selected due both to the lack of age diversity in the forests of this subwatershed and in this working unit itself. This area is within subwatershed #18 (Middle Stillwater/Rocky). Only 12% of the forest stands within this subwatershed are 20 years old or less. 65% of the stands are more than 80 years old. Within the 55.8 manageable acres of this working unit, only 5% of the stands are 20 years old or less. The full age structure is as follows: 5%, 0-20 years old; 4% 21-40 years; 0%, 41-60 years; 14%, 61-80 years; 27%, 81-100 years and 50% > 100 years old. Given the lack of young stands in this area and given the presence of good advance regeneration comprised of species well suited to this site, the primary goal will be to increase the proportion of young forest stands in this area.

Silvicultural Objectives

With adequate regeneration found throughout the working unit, openings will be made on 17.3 acres. This will be accomplished by removal of the overstory in fourteen (14) patches. These patches average 1.1 acres in size and range from 0.4 to 2.4 acres in size. These have been placed according to where the regeneration is best and the lay of the land has helped shape each individual opening.

Cultural Resources

There are none known other than stone walls and the foundations and well associated with previous landowner's summer camp in the east end of the sale area where no trees are being cut. Any other cultural features that are located before or during the harvest will be mapped, photographed, flagged, avoided and protected, consistent with the guidelines set forth in the 2017 DWSP Land Management Plan.

Rare or Endangered Species

None known.

Figures

Figure 1. Forest Cutting Plan

Figure 2. Maps of harvest area showing approximate boundary, proposed openings and other features

Figure 3. General locus map showing the location of the proposed timber harvest

Figure 4. Pre-Harvest Photographs, A-C

Figure 5. Post-Harvest Photographs, A-B

Figure 1. Forest Cutting Plan

Forest Cutting Plan

and Notice of Intent under M.G.L.
Chapter 132 – The Forest Cutting
Practices Act, 304 CMR 11.00
(Effective Date: 1/1/04)

For DCR Use Only:

File Number 282-415824 Case No.
Date Rec'd 10-31-23 Nat. Hert. 1 N
Earliest Start 11-15-23 Nat. Hert. Imp. N
River Basin NASHUA Pub. Dr. Wat. WACHUSETT
Gen. Obj. LT ACEC N

Site Information

Location

Town Sterling Lot 5307
Road Beaman Road
Acres: 17.3 of 68.6 Proposed Start Date 1/2/24
Vol. MBF 131.8 Vol. Cds. 137 Vol. Tons 142

Plan Preparer

Name Gregory S. Buzzell
Address 180 Beaman Rd.

Town, State, Zip West Boylston, MA, 01583
Phone 774-261-1841
Type of Preparer Mass. Licensed Forester
*Mass. Forester License # 25
*Required for land under Ch61, Ch61A or Forest Stewardship

Landowner

Name DCR/DWSP/OWM Wachusett/Sudbury
Mailing Address 180 Beaman St.

Town, State, Zip West Boylston, MA 01583
Phone 608-792-7806
Ch61 ☐ Ch61A ☐ Stew ☐ *Case #
Est. Stumpage Value

Licensed Timber Harvester**

Name To be supplied when known.
Address
Town, State, Zip
Phone
Mass. Lic. Harvester #
**This information may be supplied after the plan is approved, but before work begins.

Best Management Practices

Stream Crossings

Indicate location on map	SC-1	SC-2	SC-3	SC-4
Type of Crossing				
Existing Structure				
Type of Bottom				
Bank Height (ft)				
Stabilization				

Wetland Crossings

Indicate location on map	WC-1	WC-2	WC-3	WC-4
Length of Crossing	25'	100		
Mitigation	OT	OT		
Stabilization	CO	CO		

Filter Strips

Indicate location on map	FS-1	FS-2	FS-3	FS-4
Width (50', 100', or VA)	VA	VA		

Harvesting in Wetlands

Indicate location on map	HW-1	HW-2	HW-3	HW-4
Forest Type (see pg 2)				
Acres to be Harvested				
Resid. Basal Area (>50%)				

Service Forester Comments

*PLEASE NOTIFY DCR SERVICE
FORESTER AT START OF HARVEST
OPERATION

Codes

Type of Preparer	Type of Crossing	Stabilization	Mitigation	Type of Bottom
LF Mass. Lic. For.	CU Culvert	SE Seed	FR Frozen	LE Ledge
TH Lic. Tim. Har	BR Bridge	MU Mulch	DR Dry	ST Stony
TB Timber Buyer	FO Ford	CO Corduroy	OT Other	MU Mud
LO Landowner	PO Poled	ST Stone		GR Gravel
OT Other	OT Other	HB Hay Bales		OT Other
		OT Other		

Note:
Applicant must provide DCR with all relevant information before plan may be approved and cutting may begin.
Some forestry activities, such as prescribed burning and pesticide or fertilizer application may require additional permits. Consult MA Forestry BMP Manual for further information.

If Other (OT) is used in any category an explanation must be given on an attached narrative page

pg 3 of 5

Products to be Harvested*

Species	Mbf/Cds		Mbf/Cds
White Pine	88.2	Red Maple	
Red Pine		Sugar Maple	
Pitch Pine		Red Oak	33.2
Hemlock		Black Oak	9.1
Spruce		White Oak	1.3
Other Sftwd.		Other Hdwd.	
White Ash		Total Mbf	131.8
Beech		Cordwood (Cds)	137
White Birch		SW Pulp (Tons)	142
B & Y Birch		HW Pulp (Tons)	
Black Cherry		Chips (Tons)	

*Note: Volumes and values indicated in the Plan are as reported by the plan preparer and have not been independently verified by the service forester upon approval. Mbf = thousand board feet.

Cutting Standards

Indicate location on map	ST-1	ST-2	ST-3	ST-4
Forest Type	WO	WH		
Acres	41.2	27.4		
Landowner Objective	LT	LT		
Designation of Trees	CT	CT		
Type of Cut	SE	SE		
Source of Regeneration	AD	AD		

Landowner Signature

The most important information on a cutting plan is the Landowner's objective, as this will determine which trees will be harvested and which will remain; this decision will also determine the future condition of the forest for decades to come. After having read the Massachusetts Forest Cutting Plan Information Sheet on page one, indicate your objective by checking the appropriate box below.

☒ **LT - Long-term Forest Management**

Planned management of the forest to achieve one or more of the following objectives: produce immediate and maximize long-term income, enhance wildlife habitat, improve recreational opportunities, protect soil and water quality, or produce forest specialty products.

☐ **ST - Short-term Harvest**

Harvest of trees with the main intention of producing short-term income with minimal consideration given to improving the future forest condition, which often results in a forest dominated by poor quality and low value species.

I (we) have read the Massachusetts Cutting Plan Information Sheet, and am aware of my (our) management options.

I (we) hereby certify that I (we) have the legal authority to carry out the operation described above.

I (we) certify that I (we) have notified the Conservation Commission in the town in which the operation is to take place and the abutters of record within two hundred feet of the area to be harvested.

I (we) understand that the volumes and values (Ch61 only) in this plan have not been independently verified by the service forester upon approval and will report final values and volumes to the Director or his/her agent if the final figures differ from those reported.

Kelley Frede

Signature of landowner(s)

10/31/2023

Date

Determination and Status 282-41548-24 **Final Report and Comments**

Approved Disapproved Expires

Cutting Plan ☒ ☐ 10/31/25

[Signature] 11/14/23
Signature of Service Forester/Director's Agent Date

I hereby certify that the afore described Forest Cutting Plan and all relevant statutes have been substantially complied with.

Signature of Service Forester/Director's Agent Date

Extension 1 ☐ 2 ☐ Expires / Ser. For. Ints. /

Amendment App 1 ☐ Dis 1 ☐ App 2 ☐ Dis 2 ☐ /

Forest Types				Designation of Trees	Type of Cut	Intermediate Harvester:	Source of Regeneration
WP White Pine	HK Hemlock	OM Mixed Oak	CT Cut Tree	SH Shelterwood	CT Commercial Thin	AD Advanced	
WK WP/Hem	HH Hem/Hdwd	RM Red Maple	LT Leave Tree	ST Seed Tree	NT Non Com Thin	SE Natural Seed	
WI WP/Hdwd	BC Black Cherry	BE Beech	SB Stand Boundary	CC Clear Cut	SE Selection	PL Plant	
WO WP/Oak	BB Bee/Bir/Map	SF Spruce/Fir	OT Other	SA Salvage	DL Diameter Limit*	CO Coppice	
RP Red Pine	OH Oak/Hdwd	SM Sugar Maple	LT Long-term Mgt	SN Sanitation	OT Other*	DS Direct Seed	
SR Red Spruce	OR N Red Oak	PP Pitch Pine	ST Short-term Har			OT Other	

*If Other (OT) or a non-standard system is used an explanation must be given on attached narrative page pg 4 of 5

Forest Cutting Plan

Narrative Page

Use only if further explanation is required of information on pages one or two or if "other" was used in any category.

Landowner:

OCR/DWSP

Town:

Sterling

File Number:

282-47548-24

BMPs	<p><u>Ideally WC-1 and WC-2 will be crossed during dry or frozen conditions. Regardless of the conditions, adequate material, whether corduroy, mulch or swamp mats, will be used if needed to protect the soil from rutting. WC-2 is on an existing cart path.</u></p> <p><u>There are no Stream Crossings or Harvesting in Wetland areas.</u></p> <p><u>No trees are being cut in FS-1 or FS-2.</u></p> <p><u>There are short stretches along the haul road that are seasonally wet. This will be protected as necessary from rutting.</u></p>
Silviculture	<p><u>In order to release advance regeneration, 14 openings in the overstory are being created, covering 17.3 acres. These openings range from 0.4 acre to 2.5 acres in size with an average of 1.2 acres. They are well distributed throughout the area taking advantage of the advance regeneration comprised of white pine, oaks, and other hardwoods.</u></p>
Object	<p><u>The objective of this operation is to diversify the age structure of the forest by removing the overstory in patches thereby releasing the advance regeneration. The current age structure is limited with an insufficient component of young forest.</u></p>
Other	<p><u>Most of the haul roads are existing cart paths and so have not been flagged. Only on the approach to WC-1 has the haul road been flagged.</u></p> <p><u>Trees are only being cut within the 14 overstory removal patches and of course, as needed at the landing and along haul roads.</u></p>

dc



COMMONWEALTH OF MASSACHUSETTS
Department of Conservation and Recreation
Division of State Parks and Recreation

FILE # 282-41548-24

W

FOREST CUTTING PLAN CERTIFICATE

Post this in a conspicuous place within the area in which the harvesting operation is to take place.

This certifies that DCR/DWSP/OWM WEST BOYLSTON in accordance with the
(Name of Owner) (Address)

provision of M.G.L. Chapter 132, Section 40-46, filed in CLINTON with the Dept. of Conservation
and Recreation, Division of State Parks and Recreation, a Notice of Intent to cut forest products upon the
BEAMAN RD lot. (LOT 5307)

Approval Date 11/14/23

Director's Agent CHRIS CAPONE

DCR Phone No. (857) 406-0175

ISSUED BY:

Priscilla E. Gelgis, Director
Division of State Parks and Recreation

DCR -- Wachusett Reservoir Timber Sale 5307

Scale: 1:5,000

0 105 210 420 630 840 Feet

Legend:

- Sale Area (68.6 acres)
- Overstory Removal (17.3 acres)
- Forest Road
- Stream\Wetland Crossing/s
- Filter Strip
- Streams
- Wetlands
- Stone Walls
- Property lines w/wo walls
- Landing/s
- Haul Roads
- Stand boundaries
- Vernal pool/s

North arrow pointing North (N).

Map features include: Beaman Rd, Rocky Brook, and various labeled areas (FS-1, FS-2, ST-1, ST-2, WC-1, WC-2).

Figure 3. General locus map showing the location of the proposed timber harvest

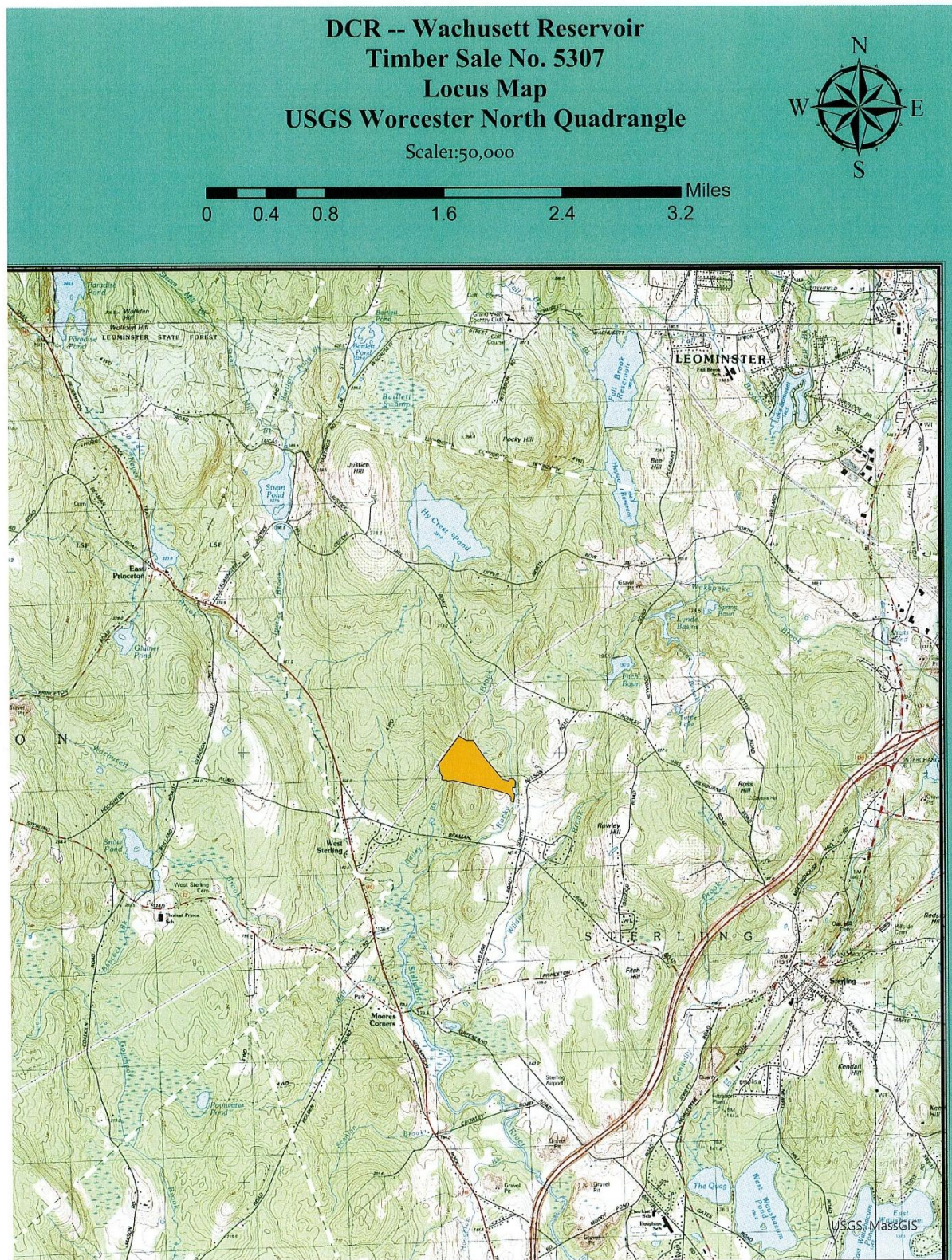

Figure 4. Pre-Harvest Photographs, A-C



A. The landing location on the north side of Beaman Road.



B. An area of overstory removal with good regeneration of mixed species. The white oak in the foreground is being retained to provide valuable structural diversity.



C. One of the wetland crossings. This is a very narrow rocky wetland that is seasonally wet.

Figure 5. Post-Harvest Photographs, A-B



A. An area where the overstory was removed to give the seedlings and sapling the space and light they need to continue to thrive and become a new, young age-class within this older forest.



B. The excellent acorn crop from last year has led to numerous oak seedling throughout these cut areas.