

Massachusetts Department of Conservation and Recreation
Division of Water Supply Protection, Office of Watershed Management
Forest Management Project Summary

Project Title: Marsh Lane

DWSP Harvest Permit Number: 4385

DWSP Proposal ID: WR-15-02-02

DCR Forest Cutting Plan File Number: 134-1647-15

Site Information

Watershed: Ware River Watershed

Town(s): Oakham

Acres: 35

Nearest Road: Marsh Lane and Rt 122

Natural Heritage Atlas overlap?: Yes

Public Drinking Water Supply Watershed?: Yes

Forest Types: Mixed oak

Area of Critical Environmental Concern (ACEC)?: No

Soils: Most of the lot is on 253C Hinckley loamy sand, excessively drained. There is also 927C Montauk-Scituate-Canton association, extremely stony, well drained.

Wetland Resources: Wetlands present adjacent to but outside of harvest area.

Vernal Pools: none known

Harvest Information

Harvest Start Date: 5/2/16

Harvest End Date: 6/13/16

Number of Wetland Crossings: None

Number of Stream Crossings: None

Best Management Practices Applied

Stream Crossings: There are no stream crossings.

Filter Strips: There is harvesting in filter strips.

Wetland Crossings: There are no wetland crossings.

Harvesting in Wetlands: There is no harvesting in wetlands.

DWSP Forester supervising this harvest

Name: Ken Canfield

Forester License number: 431

Phone number: 857 274 7090

Email: Kenneth.canfield@mass.gov

Narrative

General Description/Forest Composition/History

This area is mainly pine-oak and pine-hemlock, with a small section of mixed oak. Species present are white pine, red, black, white, and scarlet oak, red maple, hemlock, shagbark hickory, and pitch pine. The overstory health is generally good, though low quality. The understory is made up of white pine and red maple with some oaks, chestnut sprouts, and hemlock. The harvest area is adjacent to a 17 acre overstory removal harvest that was completed in 2001. There has been little recent harvesting within the harvest area.

Invasive shrubs, glossy buckthorn and Japanese barberry, are lightly present on the lot. Hemlock woolly adelgid was also observed on the lot.

The soil is an excessively drained sandy loam.

Site Selection

The primary goal of the watershed forest management program is to create and maintain a forest that provides high quality drinking water to current users and future generations. In order to achieve this, DWSP has determined that the forest should contain a diversity of species in various stages of development (seedlings through large mature trees). In addition, the forest should be vigorous; actively growing and regenerating. Forests in this condition are resilient to and quickly recover from small- and large-scale disturbances such as disease, insect infestation, ice storms and hurricanes.

Silvicultural Objectives

The main purpose of this harvest is to diversify and regenerate the forest. Small (up to 1/3rd of an acre) groups of trees will be removed, generally in areas where the trees have the lowest vigor and poorest form. In between groups, some thinning will be done to remove low vigor trees. Most snags and trees with stick nests, dens or unusual wildlife habitat characteristics will be retained.

This treatment should increase the diversity of species and will increase the age and structural diversity of the forest as a whole.

Cultural Resources

This land has been determined to not be culturally or archeologically sensitive based on a review by the DCR Archaeologist. Standard practice dictates that every effort is made to avoid disturbing stone walls. There are multiple walls on this lot but it is anticipated that none will need to be crossed.

Rare or Endangered Species

There are no known vernal pools adjacent to the harvest area. There are NHESP critical habitats adjacent to the lot, but NHESP has determined that the harvest will not result in any significant impacts on that habitat. A variety of wildlife such as deer, turkey, coyote and moose are known to frequent the lot and beaver and otter are in adjacent wetlands.

Figures

- Figure 1 Final Forest Cutting Plan
- Figure 2 (A-B) Pre-Harvest photographs taken 7/2/15
- Figure 3 (A-B) Post-Harvest photographs taken 6/6/16
- Figure 4 (A-B) Post-Harvest photographs taken 8/25/21 (after 5 growing seasons)

Figure 1

Final Forest Cutting Plan

Forest Cutting Plan

and Notice of Intent under M.G.L. Chapter 132 – The Forest Cutting Practices Act, 304 CMR 11.00 (Effective Date: 1/1/04)

For DCR Use Only:
 File Number 202-7630-15 Case No. _____
 Date Rec'd 3-23-15 Nat. Hert. Yes 1
 Earliest Start 4-9-15 Nat. Hert. Imp. No
 River Basin Chicopee Pub. Dr. Wat. Ware River
 Gen. Obj. LT ACEC No

MAR 23 2015
 APR 14 2015
 - Final -

Site Information

Location
 Town Oakham, lot WR 4385
 Road Worcester Rd (Rt122)
 Acres 35 Proposed Start Date 5/15
 Vol. MBF 59,700 Vol. Cds. 150 Vol. Tons 369

Plan Preparer
 Name Kenneth W. Canfield
 Address DCR, Division of Water Supply Protection
578 Old Turnpike Rd.
 Town, State, Zip Oakham, MA 01068
 Phone (508)882-3789 ext.1603
 Type of Preparer Mass. Licensed Forester
 *Mass. Forester License # 431
 *Required for land under Ch61, Ch61A or Forest Stewardship

Landowner
 Name DCR, Division of Water Supply Protection
 Mailing Address 485 Ware Rd.
 Town, State, Zip Belchertown, MA 01007
 Phone (413)323-447 6921
 Ch61 Ch61A Stew *Case # _____
 Est. Stumpage Value \$6000.00

Licensed Timber Harvester**
 Name _____
 Address _____
 Town, State, Zip _____
 Phone _____
 Mass. Lic. Harvester # _____
 **This information may be supplied after the plan is approved, but before work begins.

Best Management Practices

Stream Crossings

Indicate location on map	SC-1	SC-2	SC-3	SC-4
Type of Crossing				
Existing Structure				
Type of Bottom				
Bank Height (ft)				
Stabilization				

Wetland Crossings

Indicate location on map	WC-1	WC-2	WC-3	WC-4
Length of Crossing				
Mitigation				
Stabilization				

Filter Strips

Indicate location on map	FS-1	FS-2	FS-3	FS-4
Width (50', 100', or VA)	VA			

Harvesting in Wetlands

Indicate location on map	HW-1	HW-2	HW-3	HW-4
Forest Type (see pg 2)				
Acres to be Harvested				
Resid. Basal Area (>50%?)				

Service Forester Comments

See attached NRES review

Type of Preparer	Type of Crossing	Stabilization	Mitigation	Type of Bottom	Note:
LF Mass. Lic. For.	CU Culvert	SE Seed	FR Frozen	LE Ledge	Applicant must provide DCR with all relevant information before plan may be approved and cutting may begin.
TH Lic. Tim. Har	BR Bridge	MU Mulch	DR Dry	ST Stony	Some forestry activities, such as prescribed burning and
TB Timber Buyer	FO Ford	CO Corduroy	OI Other	MU Mud	
LO Landowner	BO Baled	ST Stone		CR Capped	

Products to be Harvested*

Species	Mbf/Cds		Mbf/Cds
White Pine	47.5M	Red Maple	0.5M
Red Pine		Sugar Maple	
Pitch Pine		Red Oak	9.9M
Hemlock	0.2M	Black Oak	
Spruce		White Oak	1.1M
Other Sfld.		Other Hdwd.	0.2M
White Ash		Total Mbf	59.7
Beech		Cordwood (Cds)	150
White Birch		SW Pulp (Tons)	369
B & Y Birch	0.3M	HW Pulp (Tons)	
Black Cherry		Chips (Tons)	

*Note: Volumes and values indicated in the Plan are as reported by the plan preparer and have not been independently verified by the service forester upon approval. Mbf = thousand board feet.

Cutting Standards

Indicate location on map	ST-1	ST-2	ST-3	ST-4
Forest Type	WO	WK		
Acres	27.9	6.3		
Landowner Objective	LT	LT		
Designation of Trees	CT	CT		
Type of Cut	SE	SE		
Source of Regeneration	SE	AD/SE		

Landowner Signature

The most important information on a cutting plan is the Landowner's objective, as this will determine which trees will be harvested and which will remain; this decision will also determine the future condition of the forest for decades to come. After having read the Massachusetts Forest Cutting Plan Information Sheet on page one, indicate your objective by checking the appropriate box below.

LT - Long-term Forest Management

Planned management of the forest to achieve one or more of the following objectives: produce immediate and maximize long-term income, enhance wildlife habitat, improve recreational opportunities, protect soil and water quality, or produce forest specialty products.

ST - Short-term Harvest

Harvest of trees with the main intention of producing short-term income with minimal consideration given to improving the future forest condition, which often results in a forest dominated by poor quality and low value species.

I (we) have read the Massachusetts Cutting Plan Information Sheet, and am aware of my (our) management options.

I (we) hereby certify that I (we) have the legal authority to carry out the operation described above.

I (we) certify that I (we) have notified the Conservation Commission in the town in which the operation is to take place and the abutters of record within two hundred feet of the area to be harvested.

I (we) understand that the volumes and values (Ch61 only) in this plan have not been independently verified by the service forester upon approval and will report final values and volumes to the Director or his/her agent if the final figures differ from those reported.

[Signature] _____ Date 3-18-15

Signature of landowner(s)

Date

Determination and Status

Approved Disapproved Expires 3-23-17

Signature of Service Forester/Director's Agent *[Signature]* Date 4/14/15

Extension 1 2 Expires 1 Ser. For. Ints. 1

Amendment App 1 Dis 1 App 2 Dis 2 1

Final Report and Comments

I hereby certify that the afore described Forest Cutting Plan and all relevant statutes have been substantially complied with.

[Signature] _____ Date 4/15/2015

Signature of Service Forester/Director's Agent

Date

Forest Types	HK Hemlock	OM Mixed Oak	Designation of Trees	SH Shelterwood	Intermediate Harvests:	Source of Regeneration
WP White Pine	HH Hem/Hdwd	RM Red Maple	CT Cut Tree	ST Seed Tree	CT Commercial Thin	AD Advanced
WK WP/Hem	BC Black Cherry	BE Beech	LT Leave Tree	CC Clear Cut	NT Non Com Thin	SE Natural Seed
WH WP/Hdwd	BB Bee/Bir/Map	SE Spruce/Fir	SR Stand Boundary	SE Selection	Non-Standard Systems:*	PL Plant
WO WP/Oak	OH Oak/Hdwd	SM Sugar Maple	OT Other	SA Salvage	HG Highgrade*	CO Coppice
RP Red Pine			Landowner Objective			DS Direct Seed

Forest Products

Stand Treatment

Landowner

Service Forester

Codes

Harvest Lot 4385
 Oakham, MA
 35 Acres
 MA DCR
 Division of Water Supply Protection
 Prepared by Kenneth W Canfield 3/16/15
 Data Sources: MassGIS, DCR & EOEEA
 Not a legal survey



- Legend**
- Property Boundary
 - Harvest Boundary
 - Gate #122-7

WR 4385

METROPOLITAN DISTRICT COMMISSION



Department of Conservation & Recreation

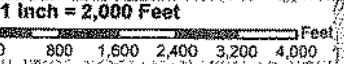

RUTLAND STATE PARK

STATE

RUTLAND

MARRIOTT PARK

OAKHAM

OAKHAM

OAKHAM

OAKHAM

OAKHAM

Harvest Lot 4385
 Oakham, MA
 35 Acres
 MA DCR
 Division of Water Supply Protection
 Prepared by Kenneth W Canfield 3/16/15
 Data Sources: MassGIS, DCR & EOEEA
 Not a legal survey

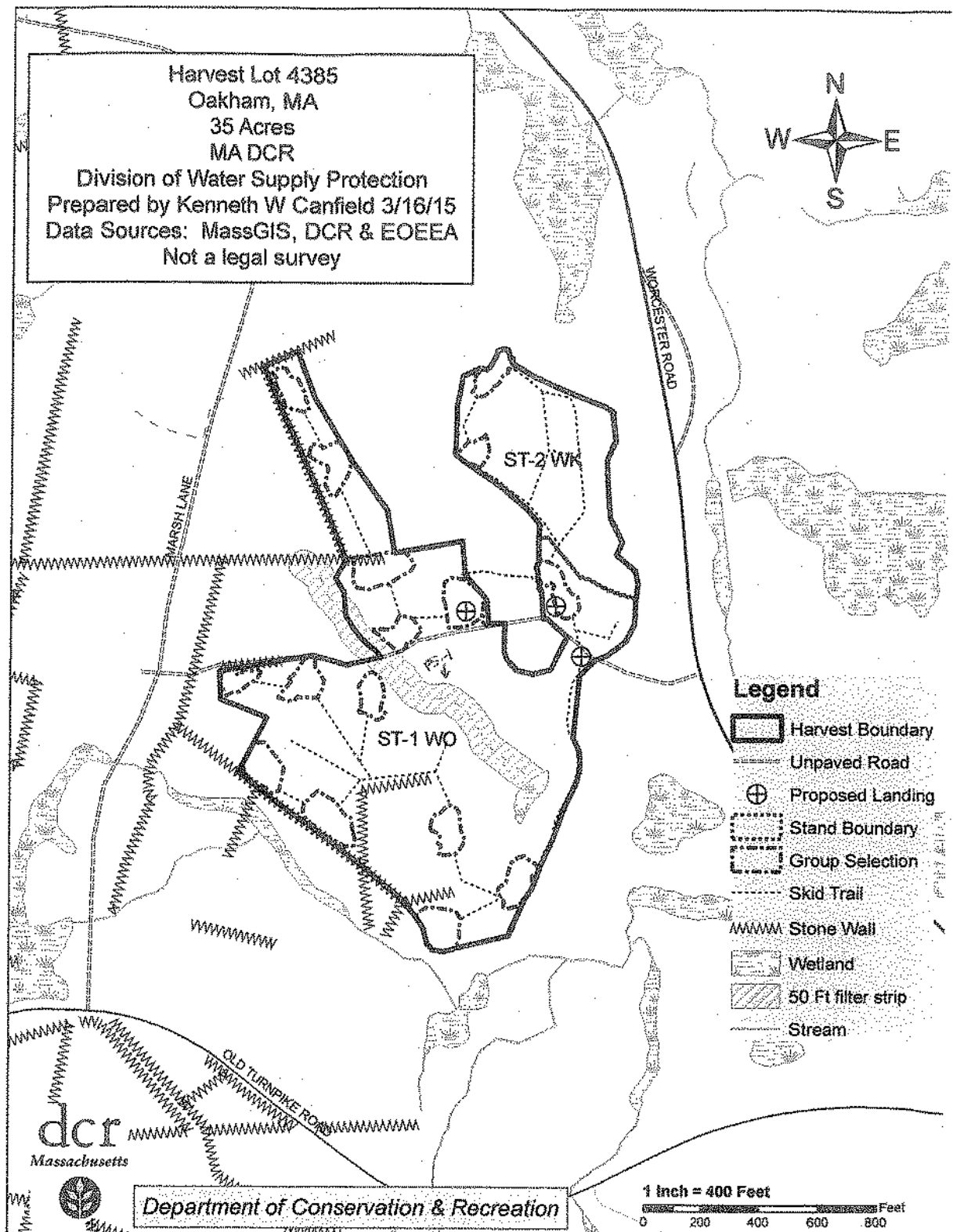

- Legend**
- Harvest Boundary
 - Unpaved Road
 - Proposed Landing
 - Stand Boundary
 - Group Selection
 - Skid Trail
 - Stone Wall
 - Wetland
 - 50 Ft filter strip
 - Stream

dcr
 Massachusetts



Department of Conservation & Recreation

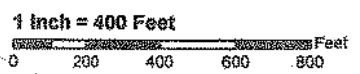



Division of Fisheries & Wildlife

Jack Buckley, *Acting Director*

Kate Marquis
Department of Conservation and Recreation
355 West Boylston St.
Clinton, MA 01510

Cutting Plan No. 134-1647-15
NHESP Tracking No. 15-34302
Town Oakham
Road Worcester Road
Landowner DCR Watershed
Preparer Kenneth W. Canfield
Date April 10, 2015

Dear Kate,

The Natural Heritage and Endangered Species Program (NHESP) of the Massachusetts Division of Fisheries and Wildlife (the Division) has reviewed the above-referenced Forest Cutting Plan (hereinafter "the Plan") pursuant to the special approval procedures of the Forest Cutting Practices Regulations (304 CMR 11.04(6)). Based on details of the Plan and information in the NHESP database, the Division does not expect activities proposed in the Plan to negatively impact Estimated Habitat or result in "Take" (as defined in 321 CMR 10.02) of plant or animal species protected under the Massachusetts Endangered Species Act (MESA) (M.G.L. c. 131A) and its implementing regulations (321 CMR 10.00). Therefore, the Division does not require that the Plan be modified at this time.

Please copy the Division on any proposed amendment, extension and on the approved Plan for the site. If you have any questions about this letter, please contact Brent Powers at (508) 389-6354.

Sincerely,

Thomas W. French, Ph.D.
Assistant Director

Cc: Conservation Commission (via e-mail)



dcr



COMMONWEALTH OF MASSACHUSETTS
Department of Conservation and Recreation
Division of State Parks and Recreation

FILE # **134-1647-15**

W

FOREST CUTTING PLAN CERTIFICATE

Post this in a conspicuous place within the area in which the harvesting operation is to take place.

This certifies that **DCR DWSP** (Name of Owner) **485 Ware Rd Belchertown** (Address) in accordance with the

provision of M.G.L. Chapter 132, Section 40-46, filed in **Clinton** with the Dept. of Conservation and Recreation, Division of State Parks and Recreation, a Notice of Intent to cut forest products upon the

Rt 122 lot, **Oakham**

Approval Date **4/14/2015**

Director's Agent **Kate Margolis**

DCR Phone No. **(413) 992-8734**

ISSUED BY: 

Priscilla E. Geigis, Director
Division of State Parks and Recreation

Figure 2 (A-B) Pre-Harvest photographs taken 7/2/15

2A Taken looking north from the edge of woods road into opening



2B Taken looking northeast from the south edge of westernmost opening



Figure 3 (A-B) Post-Harvest photographs taken 6/6/16

3A Taken looking north from the edge of woods road into opening



3B Taken looking northeast from the south edge of westernmost opening



Figure 4 (A-B) Post-Harvest photographs taken 8/25/21 (after 5 growing seasons)

4A Taken looking north from the edge of woods road into opening



4B Taken looking northeast from the south edge of westernmost opening

