

Massachusetts Department of Conservation and Recreation
Division of Water Supply Protection, Office of Watershed Management
Forest Management Project Summary

Project Title: Lackey Lane

DWSP Harvest Permit Number: 4386

DWSP Proposal ID: WR-15-21-5

DCR Forest Cutting Plan File Number: 021-7625-15

Site Information

Watershed: Ware River Watershed

Town(s): Barre

Acres: 21

Nearest Road: Lackey Lane

Natural Heritage Atlas overlap?: Yes

Public Drinking Water Supply Watershed?: Yes

Forest Types: White Pine/oak, mixed oak

Area of Critical Environmental Concern (ACEC)?: No

Soils: Most of the lot is on 910C Woodbridge-Paxton, fine sandy loam, extremely stony, moderately well-drained. There is also 902E Charlton-Paxton association, extremely stony, well drained.

Wetland Resources: Wetlands present adjacent to but outside of harvest area.

Vernal Pools: none known

Harvest Information

Harvest Start Date: 4/20/16

Harvest End Date: 6/10/16

Number of Wetland Crossings: None

Number of Stream Crossings: None

Best Management Practices Applied

Stream Crossings: There are no stream crossings.

Filter Strips: There is no harvesting in filter strips.

Wetland Crossings: There are no wetland crossings.

Harvesting in Wetlands: There is no harvesting in wetlands.

DWSP Forester supervising this harvest

Name: Ken Canfield

Forester License number: 431

Phone number: 857 274 7090

Email: Kenneth.canfield@mass.gov

Narrative

General Description/Forest Composition/History

The overstory is mostly white pine – oak, with an oak stand in the middle. Species present are white pine, red, black, white, and scarlet oak, with some hemlock and red maple. The overstory is generally even aged with good quality stems of varying vigor. The area was lightly thinned 20 to 25 years ago. The understory is made up of mostly white pine and red maple with sections of oaks and hemlock, and is adequate but somewhat sparse.

No invasive shrubs were observed.

The soil is moderately well drained.

Site Selection

The primary goal of the watershed forest management program is to create and maintain a forest that provides high quality drinking water to current users and future generations. In order to achieve this, DWSP has determined that the forest should contain a diversity of species in various stages of development (seedlings through large mature trees). In addition, the forest should be vigorous; actively growing and regenerating. A forest in this condition is resilient to and quickly recovers from small and large scale disturbances such as disease, insect infestation, ice storms and hurricanes.

Silvicultural Objectives

The main purpose of this harvest is to diversify and regenerate the forest. Small (up to 1/3rd of an acre) groups of trees will be removed, generally in areas where the trees have the lowest vigor and poorest form. The groups have been targeted in areas where softwood species dominate the overstory and/or understory. Most snags and trees with stick nests, dens or unusual wildlife habitat characteristics will be retained.

This treatment should increase the diversity of species and will increase the age and structural diversity of the forest as a whole.

Cultural Resources

This land has been determined to not be culturally or archeologically sensitive based on a review by the DCR Archaeologist. Standard practice dictates that every effort is made to avoid disturbing stone walls. There are multiple walls on this lot that will need to be crossed. Existing barways will be used to cross walls, but will need to be widened due to the size of modern harvesting equipment.

Rare or Endangered Species

There are no known vernal pools adjacent to the harvest area. There are NHESP critical habitats on the lot. NHESP has visited the site and made recommendations to mitigate any potential adverse effects on habitat, and to improve habitat where possible. NHESP has determined that because of the mitigations incorporated into the cutting plan, the harvest will not result in any significant impacts on that habitat. A variety of wildlife such as deer, turkey, coyote and moose are known to frequent the lot and beaver and otter are in adjacent wetlands.

Figures

- Figure 1 Final Forest Cutting Plan
- Figure 2 Pre-Harvest photograph taken 7/2/15
- Figure 3 Post-Harvest photograph taken 5/9/16
- Figure 4 Post-Harvest photograph taken 8/18/20 (after 5 growing seasons)

Figure 1

Final Forest Cutting Plan

Forest Cutting Plan

and Notice of Intent under M.G.L. Chapter 132 – The Forest Cutting Practices Act, 304 CMR 11.00 (Effective Date: 1/1/04)

For DCR Use Only:

File Number 021-2625-15 Case No. _____
 Date Rec'd 5-21-15 Nat. Hert. Yes 1
 Earliest Start 6-8-15 Nat. Hert. Imp. No
 River Basin Chicopee Pub. Dr. Wat. Yes
 Gen. Obj. LT ACEC No

MAY 21 2015

Final

Site Information

Location

Town Barre, lot WR 4386
 Road Coldbrook Road
 Acres 21 Proposed Start Date 6/15
 Vol. MBF 28.9 Vol. Cds. 69 Vol. Tons 158

Plan Preparer

Name Kenneth W. Canfield
 Address DCR, Division of Water Supply Protection
578 Old Turnpike Rd.
 Town, State, Zip Oakham, MA 01068
 Phone (508)882-3789 ext.1603
 Type of Preparer Mass. Licensed Forester
 *Mass. Forester License # 431
 *Required for land under Ch61, Ch61A or Forest Stewardship

Landowner

Name DCR, Division of Water Supply Protection
 Mailing Address 485 Ware Rd.
 Town, State, Zip Belchertown, MA 01007
 Phone (413) 323-6921
 Ch61 Ch61A Stew *Case # _____
 Est. Stumpage Value _____

Licensed Timber Harvester**

Name _____
 Address _____
 Town, State, Zip _____
 Phone _____
 Mass. Lic. Harvester # _____

**This information may be supplied after the plan is approved, but before work begins.

Best Management Practices

Stream Crossings

| Indicate location on map | SC-1 | SC-2 | SC-3 | SC-4 |
|--------------------------|------|------|------|------|
| Type of Crossing | | | | |
| Existing Structure | | | | |
| Type of Bottom | | | | |
| Bank Height (ft) | | | | |
| Stabilization | | | | |

Wetland Crossings

| Indicate location on map | WC-1 | WC-2 | WC-3 | WC-4 |
|--------------------------|------|------|------|------|
| Length of Crossing | | | | |
| Mitigation | | | | |
| Stabilization | | | | |

Filter Strips

| Indicate location on map | FS-1 | FS-2 | FS-3 | FS-4 |
|--------------------------|------|------|------|------|
| Width (50', 100', or VA) | | | | |

Harvesting in Wetlands

| Indicate location on map | HW-1 | HW-2 | HW-3 | HW-4 |
|---------------------------|------|------|------|------|
| Forest Type (see pg 2) | | | | |
| Acres to be Harvested | | | | |
| Resid. Basal Area (>50%?) | | | | |

Service Forester Comments

* See attached NHESP
review

| | | | | |
|--------------------|------------------|---------------|------------|----------------|
| Type of Preparer | Type of Crossing | Stabilization | Mitigation | Type of Bottom |
| LF Mass. Lic. For. | CU Culvert | SE Seed | FR Frozen | LE Ledge |
| TH Lic. Tim. Har | BR Bridge | MU Mulch | DR Dry | ST Stony |
| TB Timber Buyer | FO Ford | CO Corduroy | OT Other | MU Mud |
| LO Landowner | BO Baled | ST Stone | | CB Gravel |

Note:
 Applicant must provide DCR with all relevant information before plan may be approved and cutting may begin.
 Some forestry activities, such as prescribed burning and pesticide or fertilizer application may require additional permits.

ies

Forest Products

Products to be Harvested*

| Species | Mbf/Cds | | Mbf/Cds |
|--------------|---------|-----------------------|---------|
| White Pine | 18.6M | Red Maple | 0.2M |
| Red Pine | | Sugar Maple | |
| Pitch Pine | | Red Oak | 5.9M |
| Hemlock | | Black Oak | 2.9M |
| Spruce | | White Oak | 1.3M |
| Other Sftwd. | | Other Hdwd. | |
| White Ash | | Total Mbf | |
| Beech | | Cordwood (Cds) | 69 |
| White Birch | | SW Pulp (Tons) | 158 |
| B & Y Birch | | HW Pulp (Tons) | |
| Black Cherry | | Chips (Tons) | |

*Note: Volumes and values indicated in the Plan are as reported by the plan preparer and have not been independently verified by the service forester upon approval. Mbf = thousand board feet.

Stand Treatment

Cutting Standards

| Indicate location on map | ST-1 | ST-2 | ST-3 | ST-4 |
|--------------------------|------|------|------|------|
| Forest Type | WP | OH | WH | |
| Acres | 4.6 | 8.2 | 8.0 | |
| Landowner Objective | LT | LT | LT | |
| Designation of Trees | CT | CT | CT | |
| Type of Cut | SE | SE | SE | |
| Source of Regeneration | SE | SE | SE | |

Landowner

Landowner Signature

The most important information on a cutting plan is the Landowner's objective, as this will determine which trees will be harvested and which will remain; this decision will also determine the future condition of the forest for decades to come. After having read the Massachusetts Forest Cutting Plan Information Sheet on page one, indicate your objective by checking the appropriate box below.

LT - Long-term Forest Management

Planned management of the forest to achieve one or more of the following objectives: produce immediate and maximize long-term income, enhance wildlife habitat, improve recreational opportunities, protect soil and water quality, or produce forest specialty products.

ST - Short-term Harvest

Harvest of trees with the main intention of producing short-term income with minimal consideration given to improving the future forest condition, which often results in a forest dominated by poor quality and low value specie

I (we) have read the Massachusetts Cutting Plan Information Sheet, and am aware of my (our) management options.

I (we) hereby certify that I (we) have the legal authority to carry out the operation described above.

I (we) certify that I (we) have notified the Conservation Commission in the town in which the operation is to take place and the abutters of record within two hundred feet of the area to be harvested.

I (we) understand that the volumes and values (Ch61 only) in this plan have not been independently verified by the service forester upon approval and will report final values and volumes to the Director or his/her agent if the final figures differ from those reported.

Signature of landowner(s)

Date

Service Forester

Determination and Status

Approved Disapproved Expires 5-21-17

Signature of Service Forester/Director's Agent [Signature] Date 6-15-15

Extension 1 2 Expires / Ser. For. Ints. /

Amendment App 1 Dis 1 App 2 Dis 2 /

Final Report and Comments

I hereby certify that the afore described Forest Cutting Plan and all relevant statutes have been substantially complied with.

Signature of Service Forester/Director's Agent

Date

Codes

| | | | | | | |
|---------------------|----------------|----------------|-----------------------------|----------------|-------------------------------|-------------------------------|
| Forest Types | HK Hemlock | OM Mixed Oak | Designation of Trees | SH Shelterwood | Intermediate Harvets: | Source of Regeneration |
| WP White Pine | HH Hem/Hdwd | RM Red Maple | CT Cut Tree | ST Seed Tree | CT Commercial Thin | AD Advanced |
| WK WP/Hem | BC Bck Cherry | BE Beech | LT Leave Tree | CC Clear Cut | NT Non Com Thin | SE Natural Seed |
| WH WP/Hdwd | BB Bee/Bir/Map | SF Spruce/Fir | SB Stand Boundary | SE Selection | Non-Standard Systems:* | PL Plant |
| WO WP/Oak | OH Oak/Hdwd | SM Sugar Maple | OT Other | SA Salvage | HG Highgrade* | CO Coppice |
| RP Red Pine | | | Landowner Objective | | | DS Direct Seed |

Forest Cutting Plan

Narrative Page (Effective Date: 1/1/04)
 Use this page to provide further explanation or if Other (OT) was used in any category on pages 3 or 4.

Landowner DCR, DWSP
 Town Barre
 File Number 021-7625-15

BMPs

Use this Section to provide further explanation or if Other (OT) was used in any category in the Best Management Practices Section on Page 3.
 To benefit [redacted] ** Sensitive species information* and their habitat, the following recommended management actions from NHESP will be incorporated.
 Harvesting operations will be conducted first in the northern and eastern (higher elevation) sections of the harvest area, working towards the south and west. Groups have been concentrated in areas with dense softwood stands and regeneration as much as possible. Trees to be harvested have been limited to within groups and skid trails, with no thinning in between groups. Four trees have been identified within the harvest area to be "tip" trees. These trees will be pushed over by harvesting equipment, with operator safety as a priority, and left onsite as habitat.

Designation of Trees

Use this Section to describe the types of trees to be harvested and/or retained if Other (OT) was used for "Designation of Trees" in the Stand Treatment Section on page 4.

| Stand No. | Species to be Cut | Size of Trees to be Cut | Quality of Trees to be Cut | % BA/Acre Removed |
|-----------|-------------------|-------------------------|----------------------------|-------------------|
| | | | | |
| | | | | |
| | | | | |
| | | | | |

Regeneration & Future Condition

Use this Section to describe how Chapter 132 requirements will be met if a non standard system (HG, DL, or OT) was used for the "Type of Cut" in the Cutting Standards Section on page 4.

| Stand No. | Source of Regeneration (ex. AD, SE) | How will Regeneration be obtained/protected? If using AD - Describe the species present and how the regeneration will be protected If using SE - Describe the source of the seed and the number of seed trees/acre |
|-----------|-------------------------------------|--|
| | | |
| | | |
| | | |
| | | |
| | | |

Stand No. **Desired Future Condition**
 Describe what the stand is expected to look like five years from the harvest, including the condition of the overstory & understory

Harvest Lot 4386
Barre, MA
21 Acres
MA DCR
Division of Water Supply Protection
Prepared by Kenneth W Canfield 5/7/15
Data Sources: MassGIS, DCR & EOEEA
Not a legal survey



WR 4386

Legend



- Property Boundary
- Harvest Boundary
- Landing
- ACE Gate

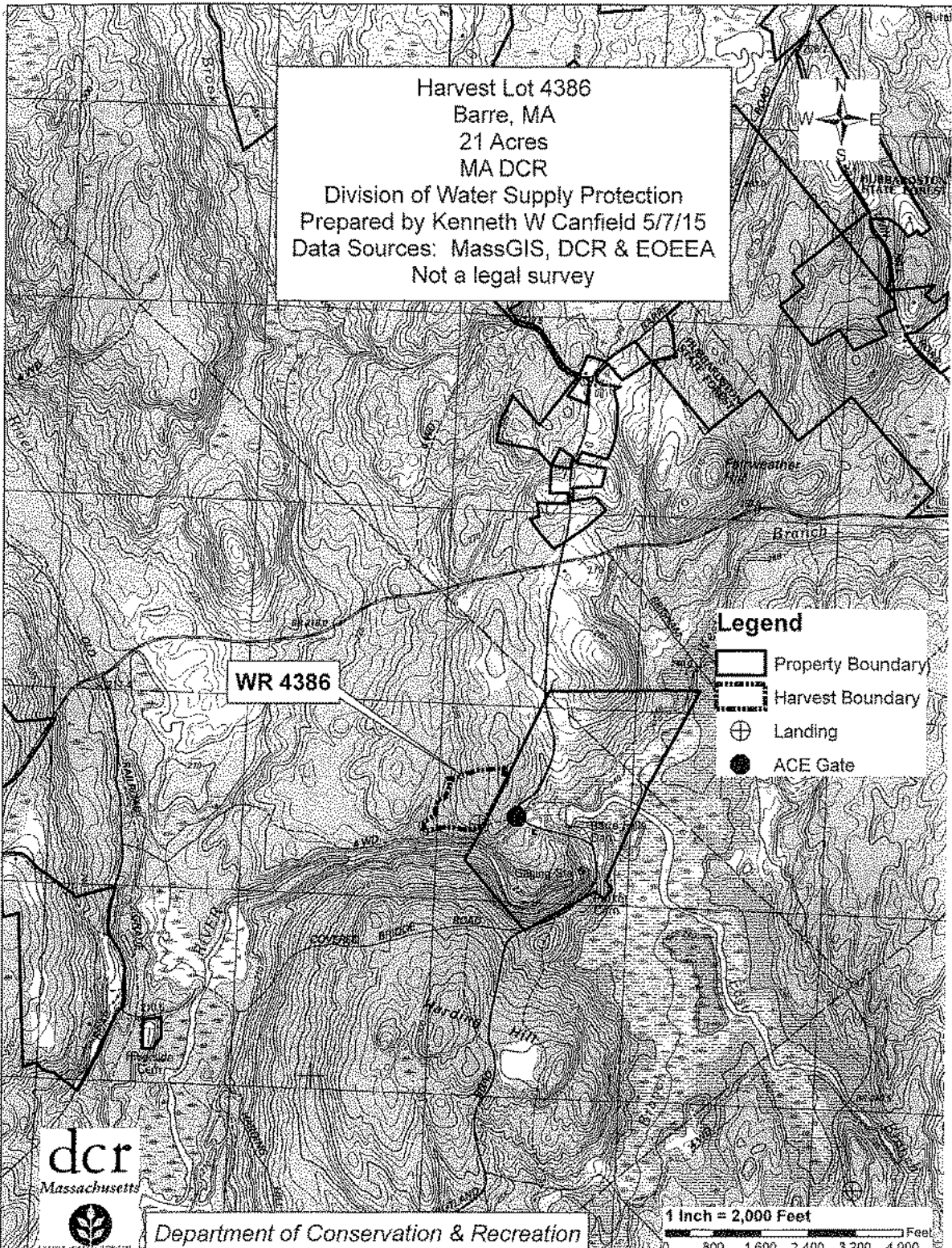

Department of Conservation & Recreation



Legend

-  Landing
-  Gate
-  Existing Unpaved Road
-  Harvest Boundary
-  Property Boundary
-  Skid Trail
-  Stand Boundary
-  Group Selection
-  Stonewall
-  Stream
-  Wetland

Harvest Lot 4386
Barre, MA
21 Acres
MA DCR
Division of Water Supply Protection
Prepared By Kenneth W Canfield 5/7/15
Data Sources: MassGIS, DCR & EOEEA
Not a legal survey

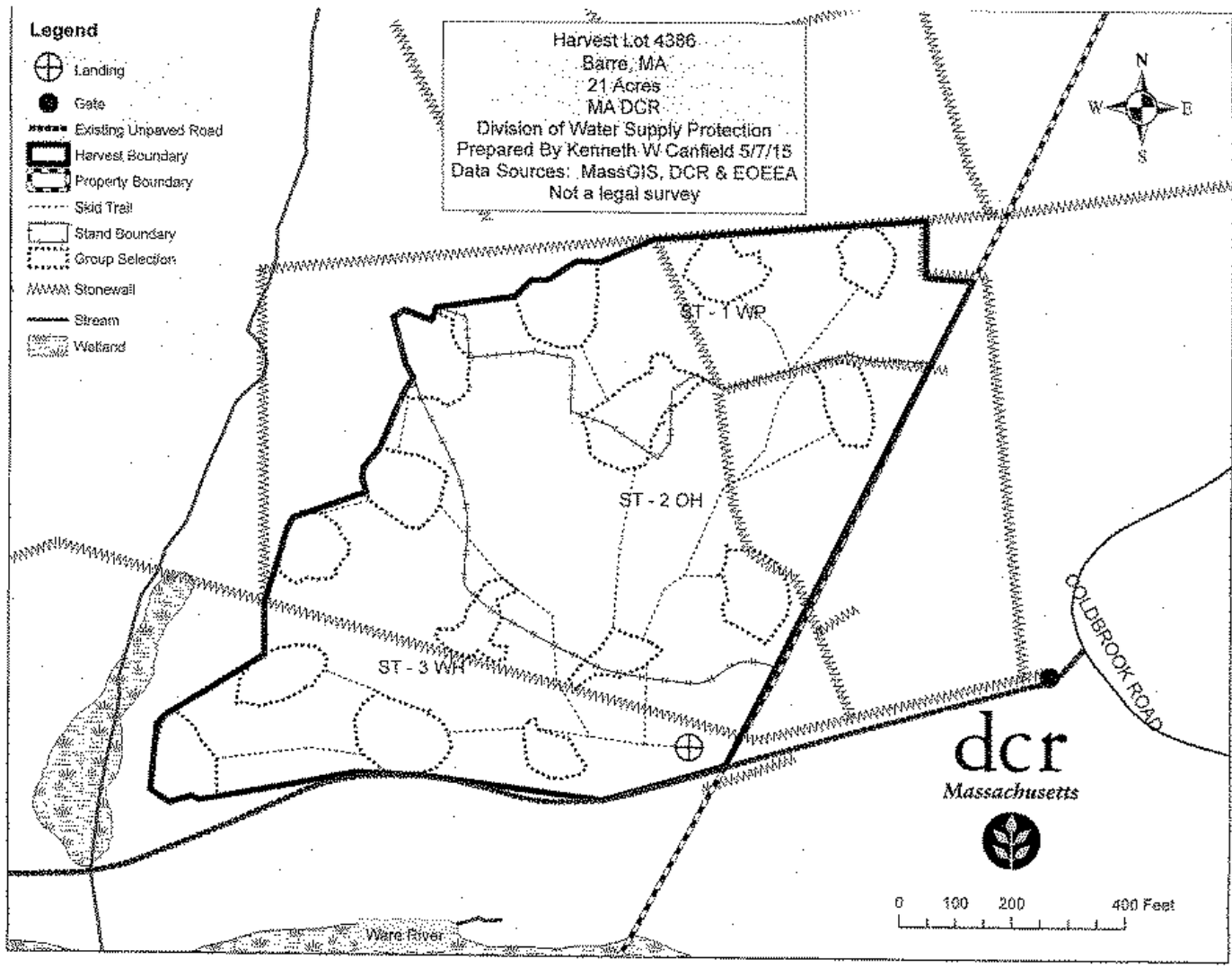

0 100 200 400 Feet



Division of Fisheries & Wildlife

Jack Buckley, *Director*

Kate Marquis
Department of Conservation and Recreation
355 West Boylston St.
Clinton, MA 01510

Cutting Plan No. 021-7625-15
NHESP Tracking No. 15-34531
Town Barre
Road Off Coldbrook Road
Landowner DCR - DWSP
Preparer Kenneth Canfield
Date June 12, 2015

Dear Kate,

The Natural Heritage and Endangered Species Program (NHESP) of the Massachusetts Division of Fisheries and Wildlife (the Division) has reviewed the above-referenced Forest Cutting Plan (hereinafter "the Plan") pursuant to the special approval procedures of the Forest Cutting Practices Regulations (304 CMR 11.04(6)). Based on details of the Plan and information in the NHESP database, the Division does not expect activities proposed in the Plan to negatively impact Estimated Habitat or result in "Take" (as defined in 321 CMR 10.02) of plant or animal species protected under the Massachusetts Endangered Species Act (MESA) (M.G.L. c. 151A) and its implementing regulations (321 CMR 10.00). Therefore, the Division does not require that the Plan be modified at this time.

Please copy the Division on any proposed amendment, extension and on the approved Plan for the site. If you have any questions about this letter, please contact Brent Powers at (508) 389-6354.

Sincerely,

Thomas W. French, Ph.D.
Assistant Director

Cc: Barre Conservation Commission (via e-mail)



dcr



COMMONWEALTH OF MASSACHUSETTS
Department of Conservation and Recreation
Division of State Parks and Recreation

FILE # 021-7625-15

FOREST CUTTING PLAN CERTIFICATE

Post this in a conspicuous place within the area in which the harvesting operation is to take place.

This certifies that DWSP 485 Ware Rd Belchertown in accordance with the
(Name of Owner) (Address) 01007

provision of M.G.L. Chapter 132, Section 40-46, filed in Clinton with the Dept. of Conservation
and Recreation, Division of State Parks and Recreation, a Notice of Intent to cut forest products upon the
Coldbrook Rd lot, Barre

Approval Date 6/12/2015
Director's Agent Kate Marquis
DCR Phone No. (413) 992-8734

ISSUED BY: 
Priscilla E. Geigis, Director
Division of State Parks and Recreation

Figure 2

Pre-Harvest photograph taken 7/2/15

Taken from Lackey Lane looking northeast into group



Figure 3 Post-Harvest photograph taken 5/9/16

Taken from Lackey Lane looking northeast into group



Figure 4 Post-Harvest photograph taken 8/18/20 (after 5 growing seasons)

Taken from Lackey Lane looking northeast into group

