



GREEN LINE EXTENSION PROJECT



massDOT
Massachusetts Department of Transportation



Agenda

Welcome & Introduction

- John Dalton, MBTA / GLX Program Manager

Construction Plans for 2020

- Jeff Wagner, Public Outreach Manager, GLX-C

Public Outreach

- Terry McCarthy, MBTA / GLX Stakeholder Engagement

Comments / Questions



Genesis of GLX Project

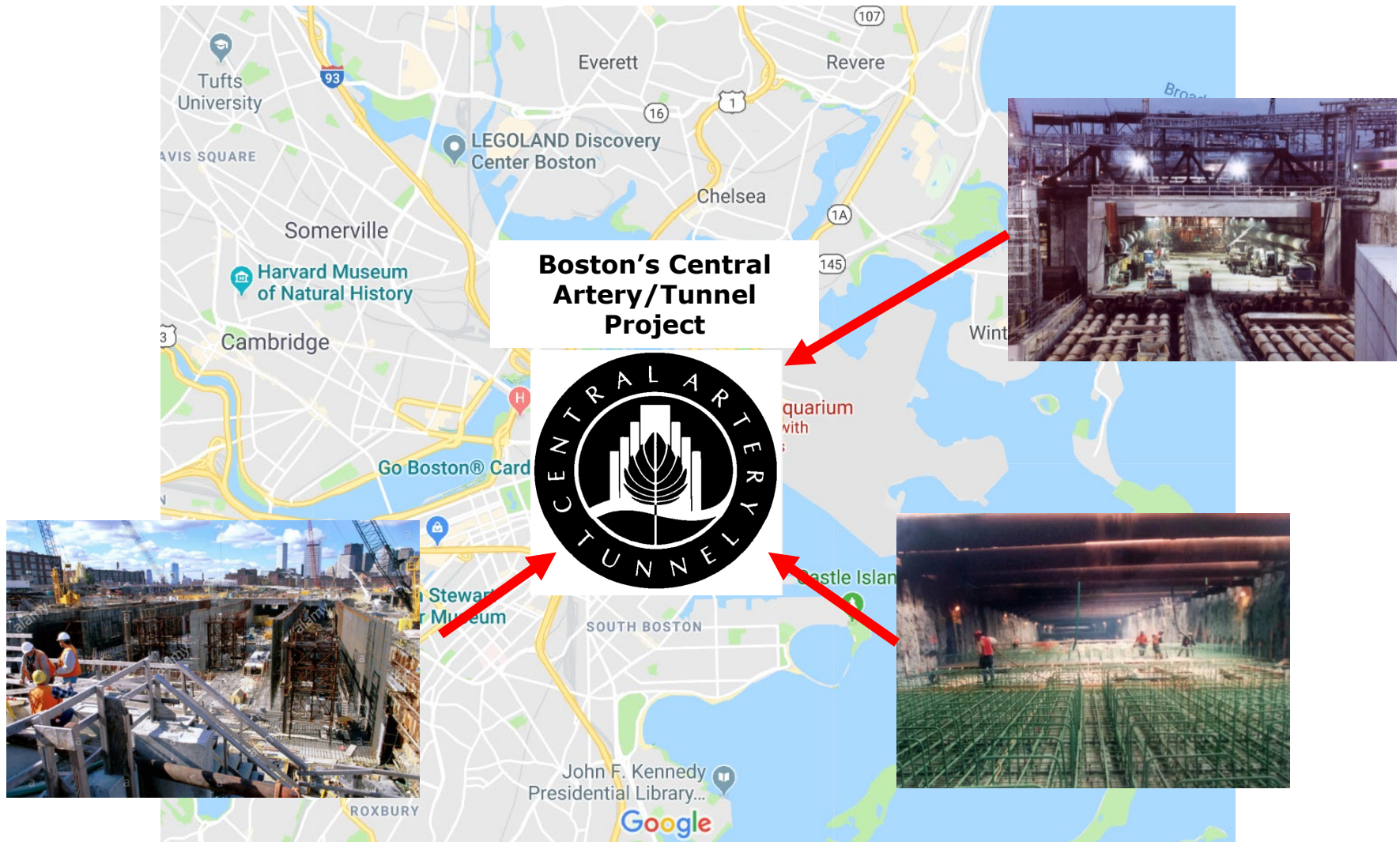

massDOT
Massachusetts Department of Transportation



Genesis of GLX Project

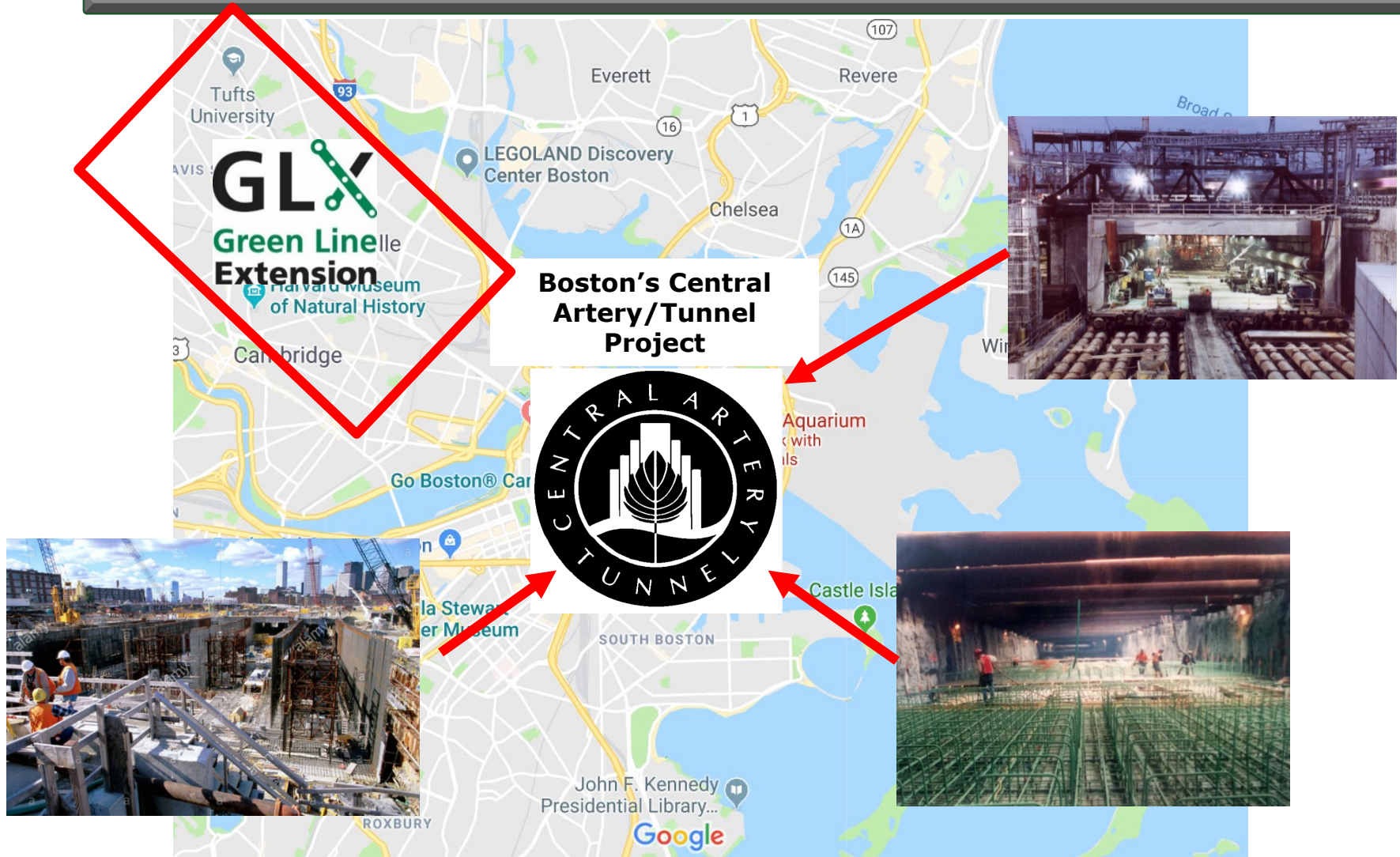

massDOT
Massachusetts Department of Transportation



Project Scope Summary



- 1) Seven light-rail GLX stations
 - Relocated Lechmere Station
 - 5 on Medford Branch
 - 1 on Union Square Branch
- 2) Includes a multiuse community path (Lowell Street to Cambridge Crossing/Lechmere)
- 3) Procurement of 24 Green Line light rail vehicles
- 4) Vehicle Maintenance Facility (VMF)
- 5) Any future Green Line service to Route 16 and/or Porter Square is not precluded

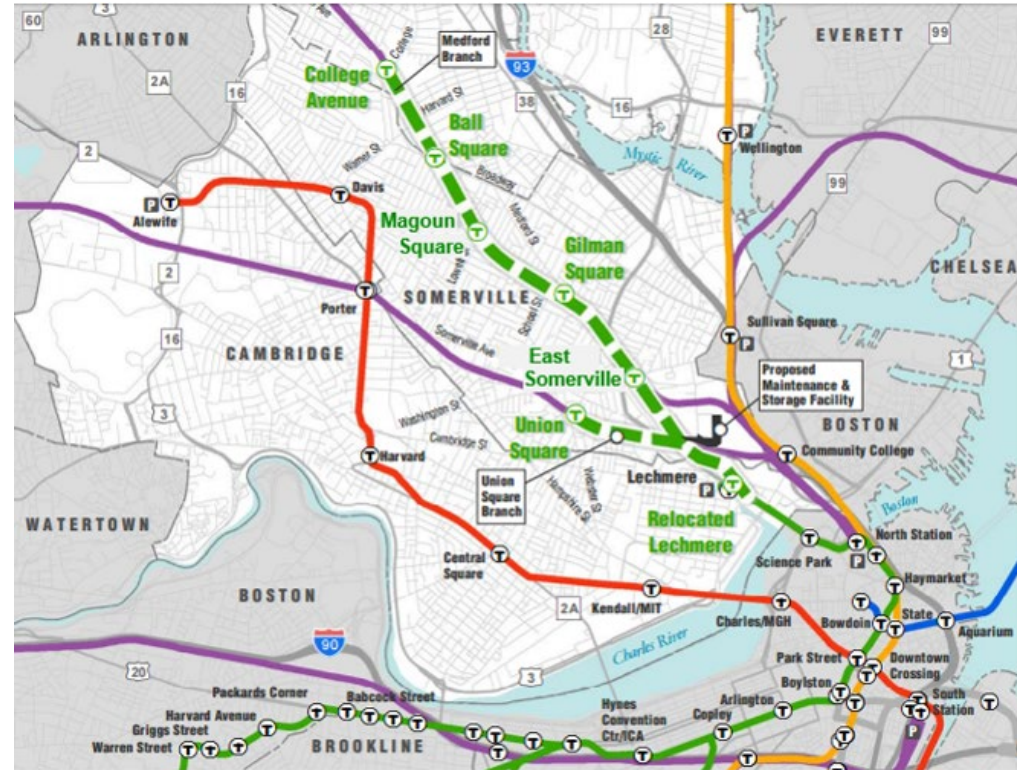

Project Goals & Benefits

- Improves local and regional air quality
- A projected reduction in regional daily Vehicle Miles Traveled by 25,728 miles reducing automobile congestion.
- Daily ridership (boardings and alightings) of approximately 45,000 by 2030.
- 20% of Somerville population is within walking distance of rail transit today, and 80% is anticipated to be so with GLX
- Economic benefits, including the improvement of the commercial tax base



Construction Sequencing

*Original
Configuration*

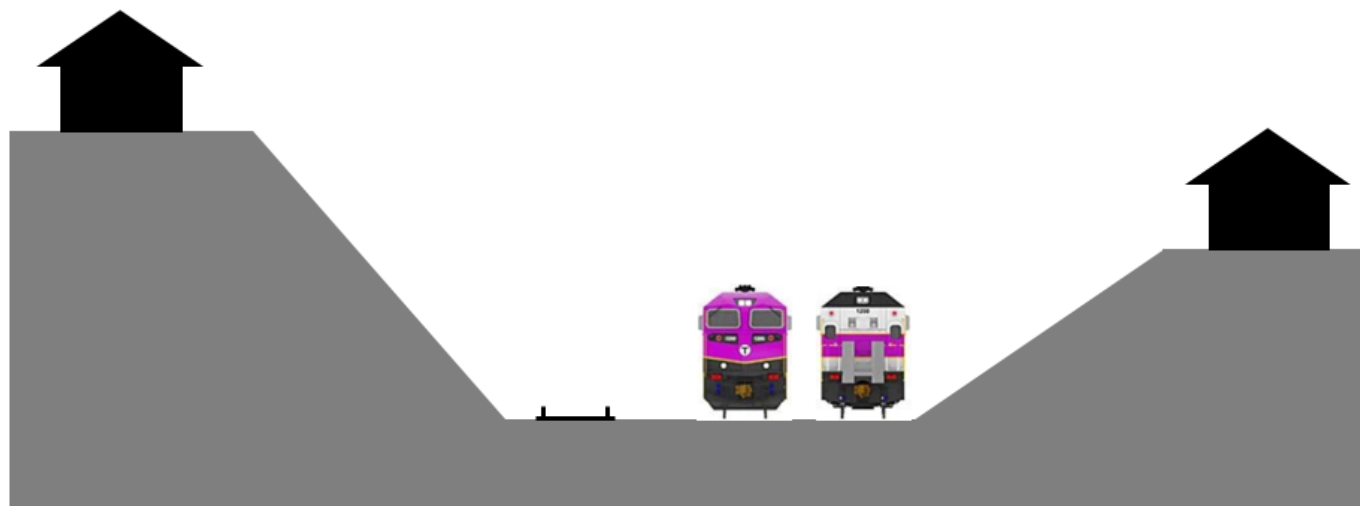

Fall 2018



Construction Sequencing

*Current
Configuration*



*2019 Performance
Goal =
November 2019*



massDOT
Massachusetts Department of Transportation

Construction Sequencing

Original Configuration

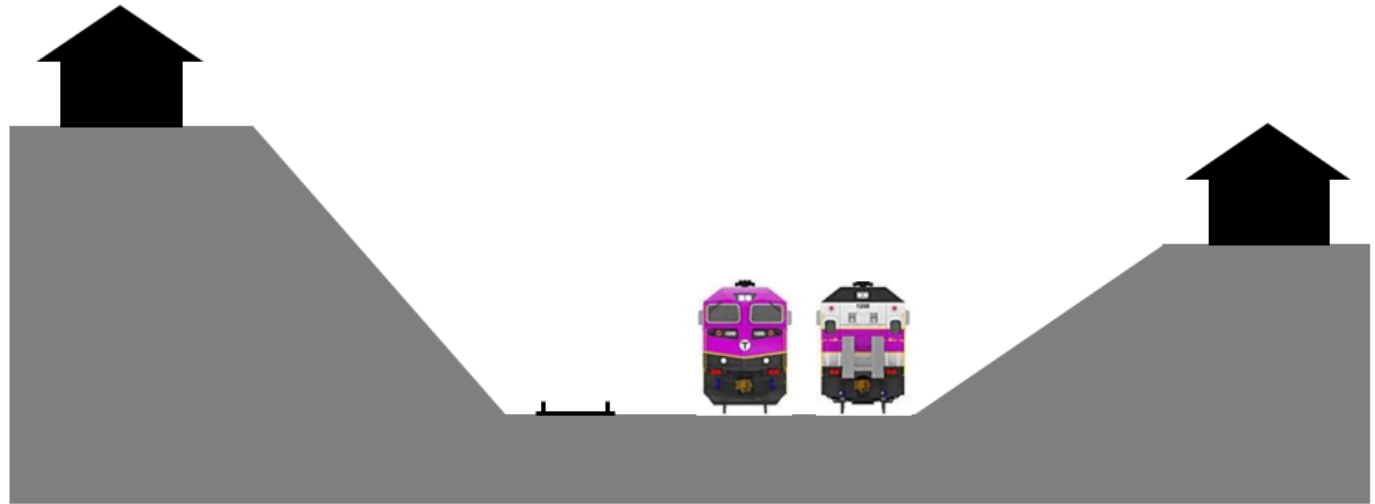

Fall 2018

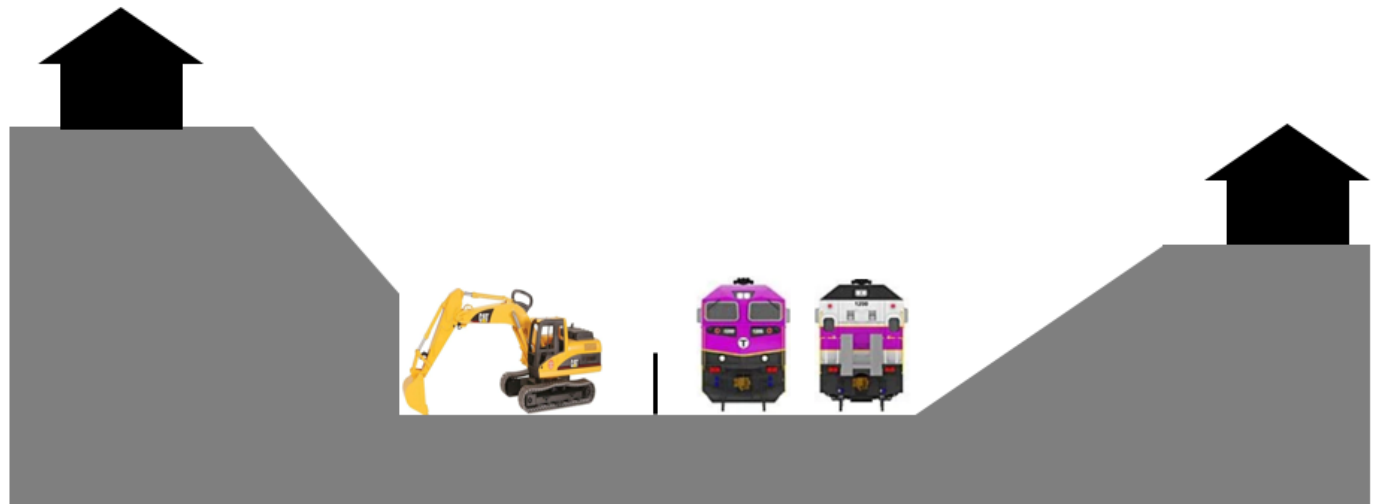

Construction Sequencing

2020 / 2021

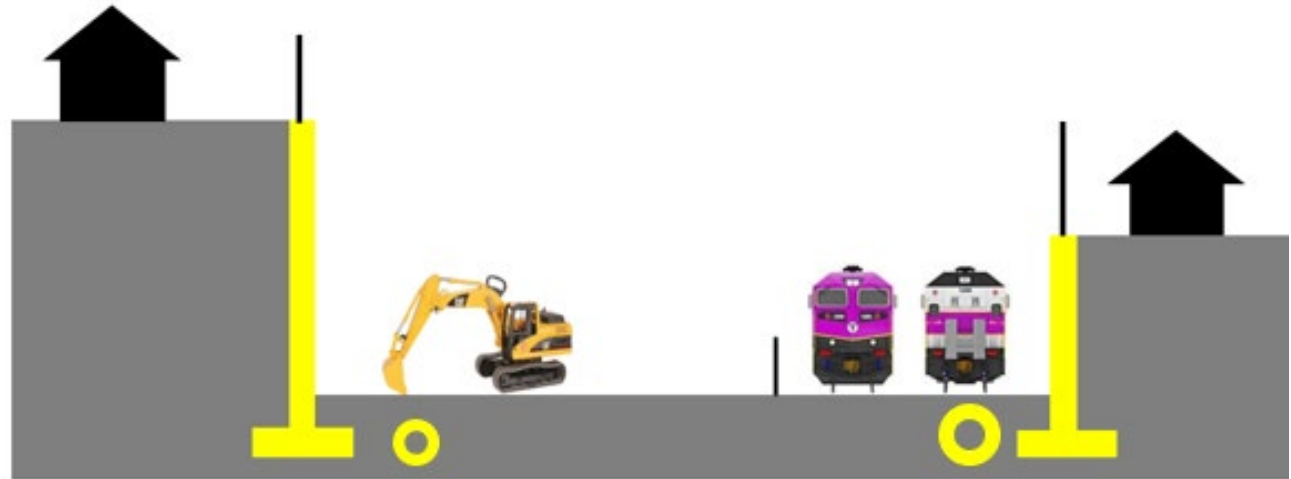

*New
Green Line
In Service*



massDOT
Massachusetts Department of Transportation



Significant Active Work Areas

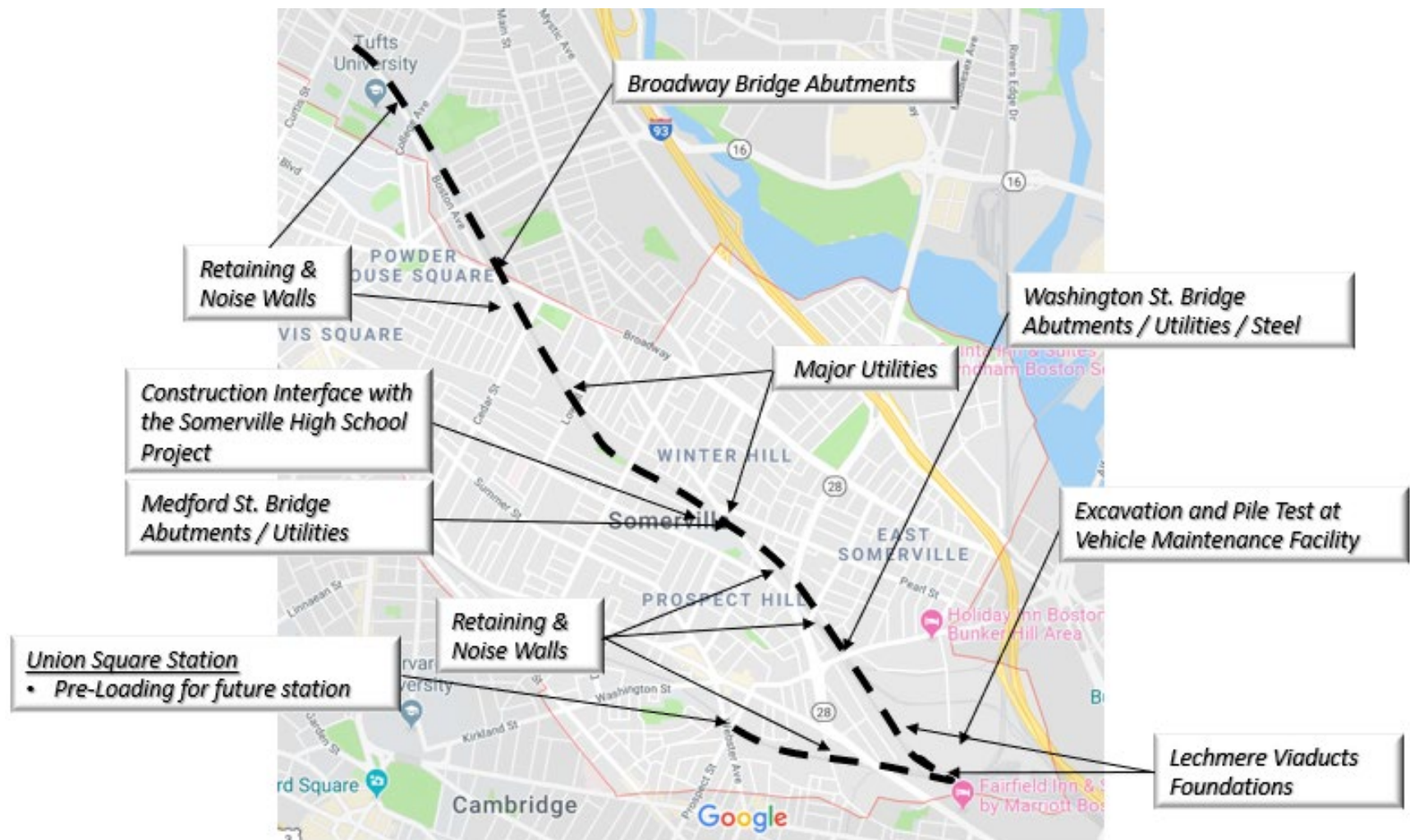

Lechmere / Fitchburg Viaduct



55 Viaduct Drilled Shafts Complete

Lechmere / Fitchburg Viaduct



55 Viaduct Drilled Shafts Complete



massDOT
Massachusetts Department of Transportation



Progress Photos



55 Viaduct Drilled Shafts Complete



Progress Photos

Vehicle Maintenance Facility
Approximately 300 Foundation Pilings Complete



Progress Photos

Washington St. Bridge Phase - 1 Substantially Complete

- New bridge deck is ready to support commuter and freight rail traffic



Progress Photos

Washington Street Bridge



Progress Photos

Earth / Material Moving – Active Rail



Progress Photos

Gilman Square / Utility Work



Progress Photos

Gilman Square / Utility Work

- Prime example of the challenges associated with the construction of major infrastructure inside an active rail corridor
- Segment of 60-inch drainage pipe from School St. to Sycamore St. nearing completion



Progress Photos

Broadway Bridge Advancement

- West bridge abutment
- East bridge abutment
- Center bridge pier

Ball Square

- Major utility work progressing
- Station work to begin spring 2020



Progress Photos

Ball Square / Utility Work



Progress Photos

Noise & Retaining Walls

- *Panel installation underway*





GLX-C Construction Update



Safety Update

GLX Safety Performance

- Project Hours to Date – 1.5 Million
- OSHA Total Recordable Incident Rate – 0.80
- Bureau of Labor Statistics Rate – 3.20
- Performance is 400% better than national average



Construction Update

Track Shift



Construction Update



Track Shift

- South of College Ave to northern terminus underway



massDOT
Massachusetts Department of Transportation



Construction Update



Track Shift

- Washington St. to Cedar

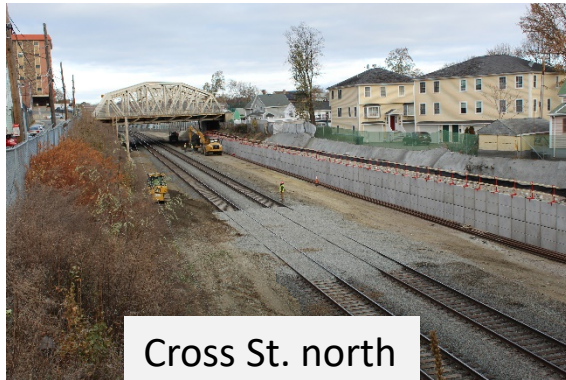

massDOT
Massachusetts Department of Transportation



Construction Update

Track Shift

- Cedar to North of Ball Square



Cedar north



Broadway north

Construction Update

What Drives When and Where we Work?

- Challenges of Working Along Commuter Rail Alignment
- Levels of rail service & implications on construction
 - Normal service
 - 1 track out of service
 - Full service outage



GLX-C Construction Plans for 2020



Bridge Closure Schedule



Bridge Closures	2019												2020												2021											
	WINTER			SPRING			SUMMER			FALL			WINTER			SPRING			SUMMER			FALL			WINTER			SPRING			SUMMER			FALL		
	J	F	M	A	M	J	J	A	S	O	N	D	J	F	M	A	M	J	J	A	S	O	N	D	J	F	M	A	M	J	J	A	S	O	N	D
Broadway																																				
Washington Street																																				
Medford Street																																				
School Street																																				
College Avenue*																																				
Cedar Street*																																				
Lowell Street																																				
Green Line Bus Diversion Lechmere to North Station																																				
Lechmere Viaduct																																				

* On College Avenue and Cedar Street bridges, traffic may be restricted at times, but will remain open throughout construction.

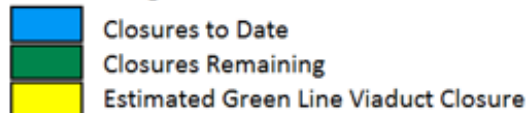

massDOT
Massachusetts Department of Transportation



Construction Update

Broadway Bridge

- Drainage, wall construction and bridge construction continues
- Frequent weekend and night work based on track shutdowns
- Next Steps for Bridge Construction:
 - Complete drainage
 - Bridge abutment construction
 - Steel placement & build deck
 - Concrete
 - Complete tie ins and finishing work



Construction Update

Washington St. Rail Overpass

- First phase of Washington St. Rail Overpass construction nearly complete
- Demolition of 2nd half of old overpass to begin after track shift
- Build new section of overpass throughout winter





Construction Update



Medford St. Bridge

- Modification to West Abutment underway.

	Commuter / Freight Rail
	Green Line Rail

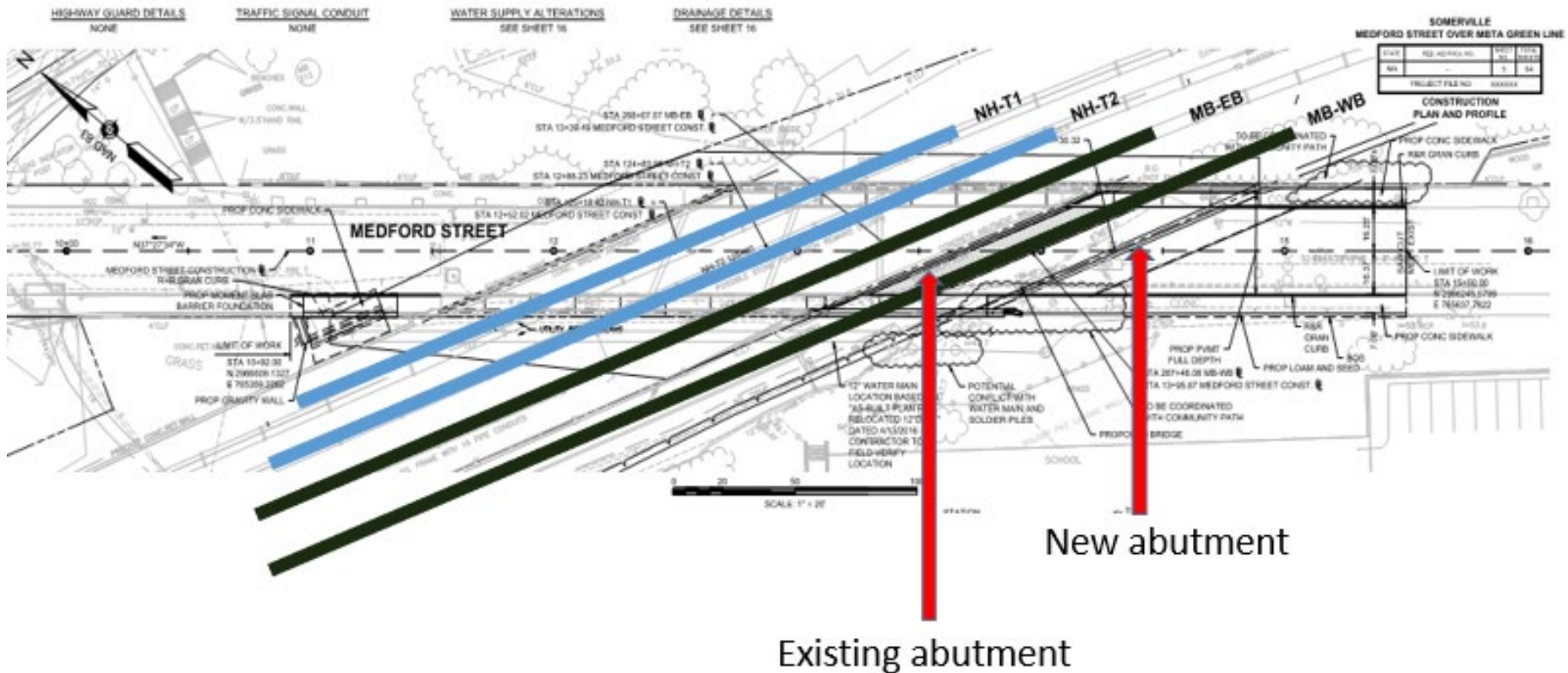

massDOT
Massachusetts Department of Transportation



Construction Update

Medford St. Bridge

- Modification to West Abutment underway
- New abutment and bridge extension to be complete in late spring



Construction Update

Medford St. Bridge

- Modification to West Abutment underway
- New abutment and bridge extension to be complete in late spring



Construction Update



School St. Bridge

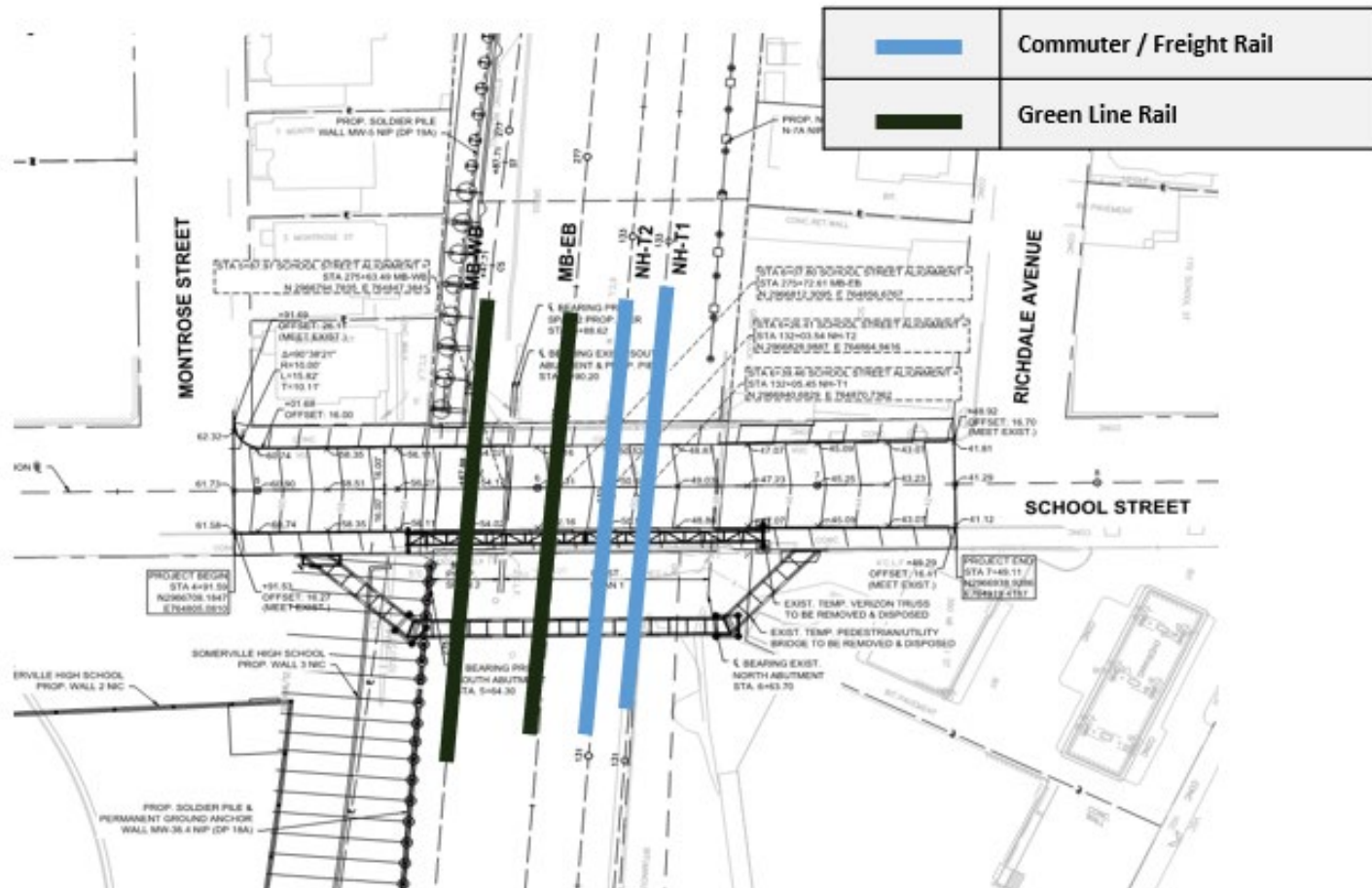

Construction Update

School St. Bridge



Construction Update

School St. Bridge

New
Underpass



Local Outreach

- Community Working Group (24 consecutive monthly meetings)
- GLX website updates
www.Mass.gov/GLX
- Email Blasts (>7,250 registered)
- Automated phone calls (Reverse 911)
- Door-to-door leafletting (12,000+ delivered)
- Public Meetings
- City Traffic Engineers & First-Responders
- Tabling Events (20 events, 3,000+ engagements)



Outreach

GLX Team – Food Drives, School Supplies, Clothing, Causes

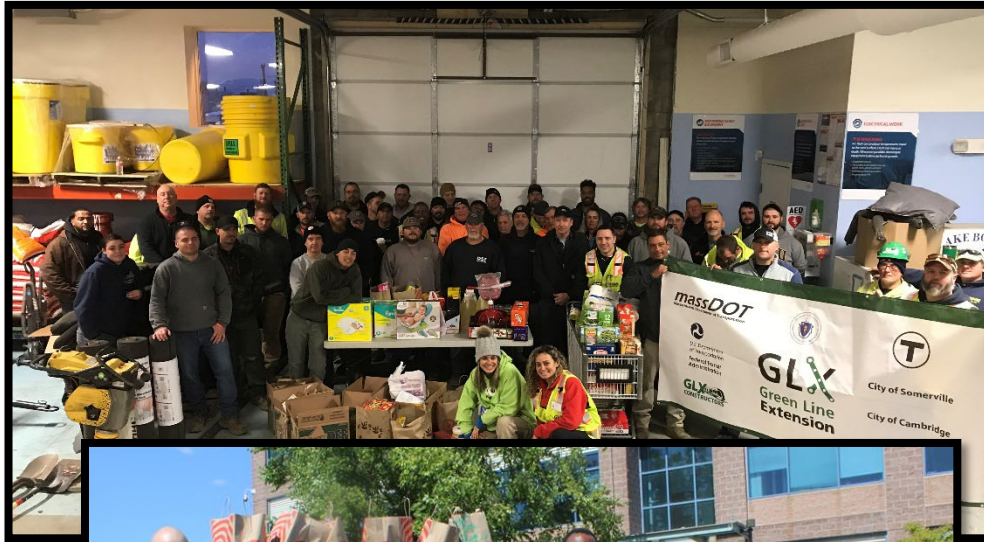

massDOT
Massachusetts Department of Transportation



Discussion

Q & A

Info@GLXinfo.com

(855)-GLX-INFO

www.Mass.gov/GLX

