

Lowell Memorial Park Landscape Rehabilitation Project

PRESENTATION OF DESIGN

JUNE 22, 2023



Commonwealth of Massachusetts

Governor

Maura T. Healey

Lieutenant Governor

Kimberley Driscoll

Energy and Environmental Secretary

Rebecca L. Tepper

Department of Conservation and Recreation Commissioner

Brian Arrigo



DCR Mission

*To protect, promote and enhance
our common wealth of natural,
cultural and recreational resources
for the well-being of all.*

Meeting Logistics

- You will have the opportunity to submit comments over the course of the next two weeks at:
 - DCR Public Comments
<https://www.mass.gov/forms/dcr-public-comments>
- Two ways to ask questions during the meeting
 - Use chat feature
 - Raise your hand using the Zoom function, and you will be given permission to unmute and speak.
- *Please note that this public information meeting will be recorded; the recording will be a public record.*

Project Team

Wendy Pearl, Director, DCR Office of Cultural Resources

Danielle Desilets, Kyle Zick Landscape Architecture, Inc.

With special thanks to:

- Cambridge Historical Commission
- Cambridge Community Preservation Act Committee
- Cambridge Plant & Garden Club

Purpose of the Meeting

Refresher on Lowell Memorial Park

Work to Date

Final Design Highlights

Presentation of 90% design for
landscape rehabilitation

Construction Schedule and Impacts



1910 View of Lowell Memorial Park and Fresh Pond Parkway
from Brattle Street

Massachusetts Department of Conservation and Recreation

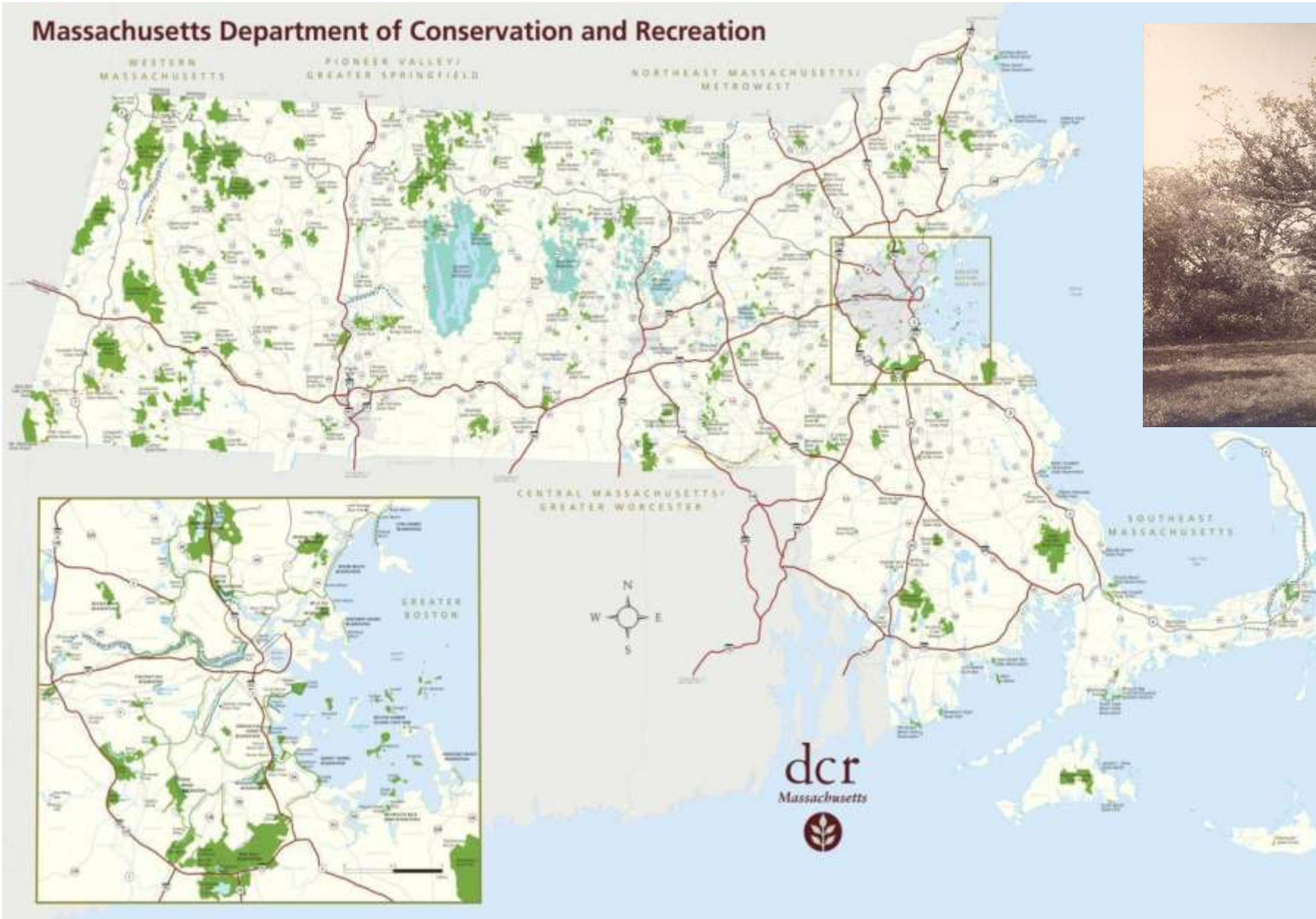

DCR is steward to nearly 500,000 acres of public land, and it all began with the preservation of a landscape, the Waverley Oaks in Belmont in 1893.

America's First Regional Park System

June 3, 1893 Metropolitan Park Commission established

First parks:

Beaver Brook Reservation (Waverley Oaks), Belmont

Stony Brook Reservation, Boston

Blue Hills Reservation, Milton

Middlesex Fells Reservation, Stoneham

1894 authorization to build parkways

1898 Lowell Memorial Park acquired as first segment of Fresh Pond Parkway

By 1903 MPC had acquired 9,246 acres



1901 Map of the Metropolitan Parks System

Lowell Memorial Park

James Russell Lowell (1819-1891)

Fireside Poet (contemporary of Longfellow)

Abolitionist

Ambassador



Lowell's family home Elmwood
is a National Historic Landmark

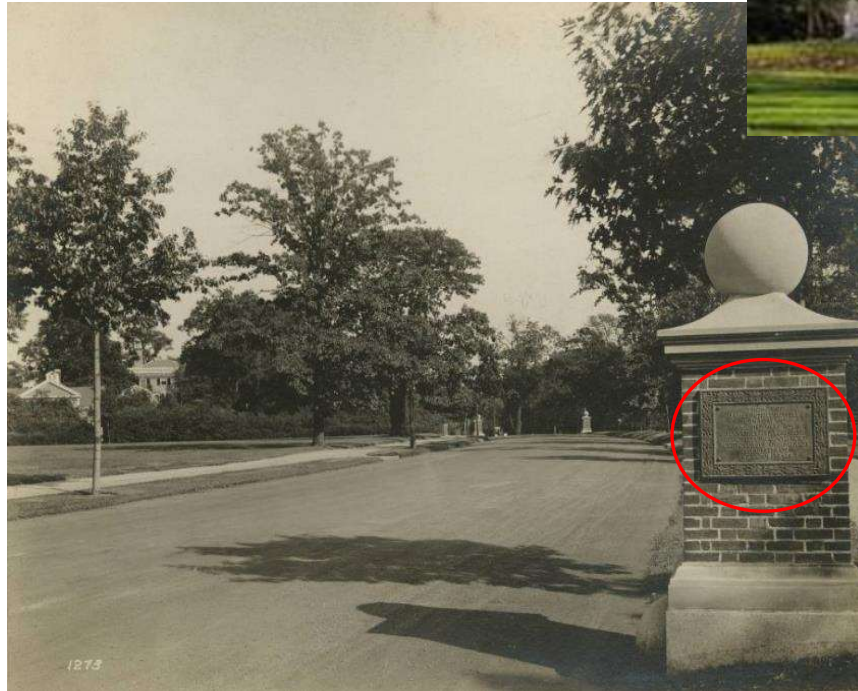

Dedication plaques to Lowell are now
missing (view from Brattle St, c 1910)

Laying Out the Parkway



1900 Atlas of Middlesex County showing proposed layout for Fresh Pond Parkway
(courtesy Cambridge Historical Commission)

1900 Fresh Pond Parkway Construction Plans,
Metropolitan Park Commission
(DCR Plans Archives)

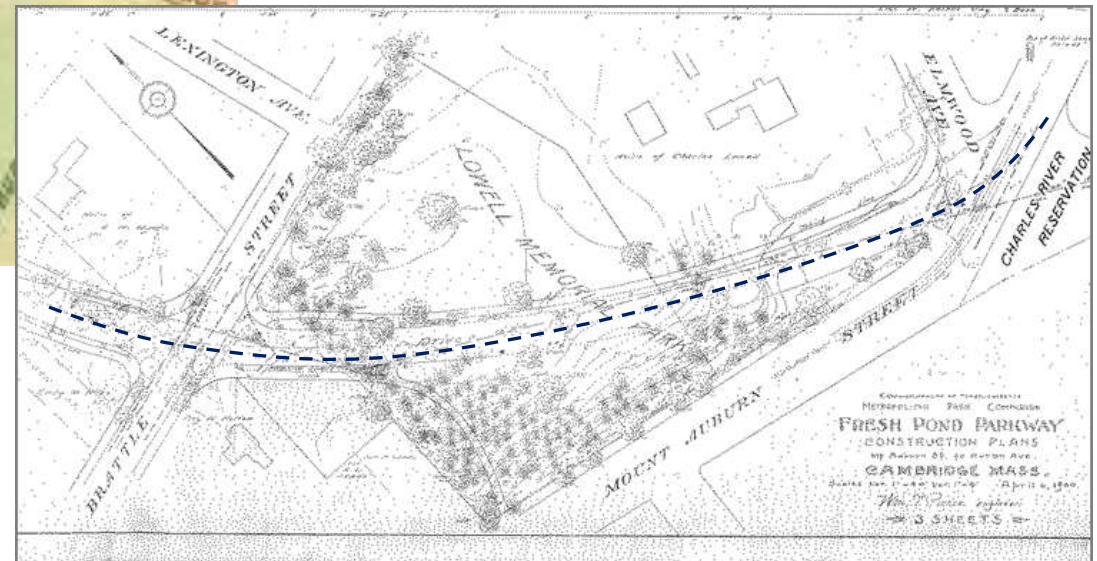

LEXINGTON AVE.

STREET

REAR OF CHURCH LINDER

MOUNT AUBURN STREET

PLANTING PLAN FOR LOWELL MEMORIAL PARK

SCALE 1" = 100'

1914-15

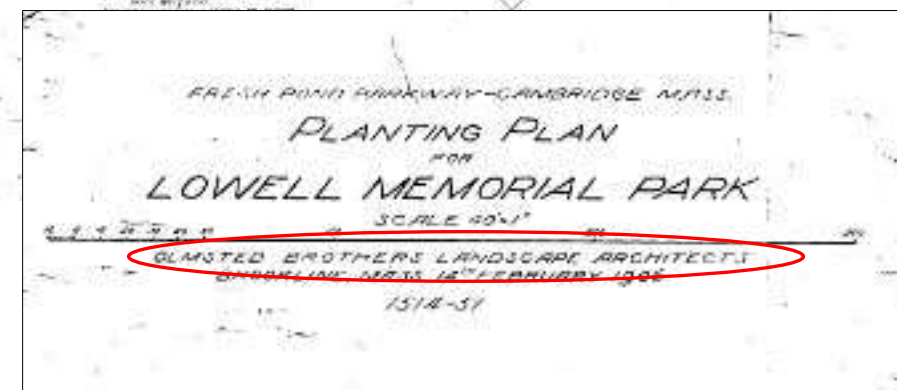
[illegible][illegible][illegible]

Designing the Park



“Big Lowell” looking east toward Elmwood c.1910-1920



Fresh Pond Parkway looking west c.1910-1920 (Courtesy Library of Congress)

Work to Date

2014 Cultural Landscape Report

2014 Assessment of Historic Walls

2015 CPA Grant from City of Cambridge and donation from Cambridge Plant & Garden Club, matched through DCR Partnership Matching funds

2016 Repair of Walls in Northern Section (“Big Lowell”)

2016 CPA Grant from City of Cambridge, through Cambridge Plant & Garden Club for design work, again matched from DCR Partnerships Matching Funds

2018 KZLA hired as Landscape Architects to develop rehabilitation plans

2018-2019 Design development, public meetings

-----2020- 2022 Pandemic-----

2022-2023 Archaeological Investigations per MA Historical Commission

March 2023 Presentation to Cambridge Historical Commission

June 2023 Final design prepared for public presentation

Final Design - Highlights

Little Lowell

Wall Repairs with larger opening at Mt. Auburn Street

Reconfiguration of pathways for ADA access and to increase separation between cars and people

Big Lowell

Preservation of lawn areas and pruning of mature trees

Expanded pathway with ADA benches

Seating area and interpretive panel near Brattle Street entrance

Planting bed along Brattle Street to imitate shrub border of original design

Pedestrian lighting

ESTIMATED COST: \$1.25M

- Walkway improvement
- Wall repair
- New wall
- - - Chain link fence repair

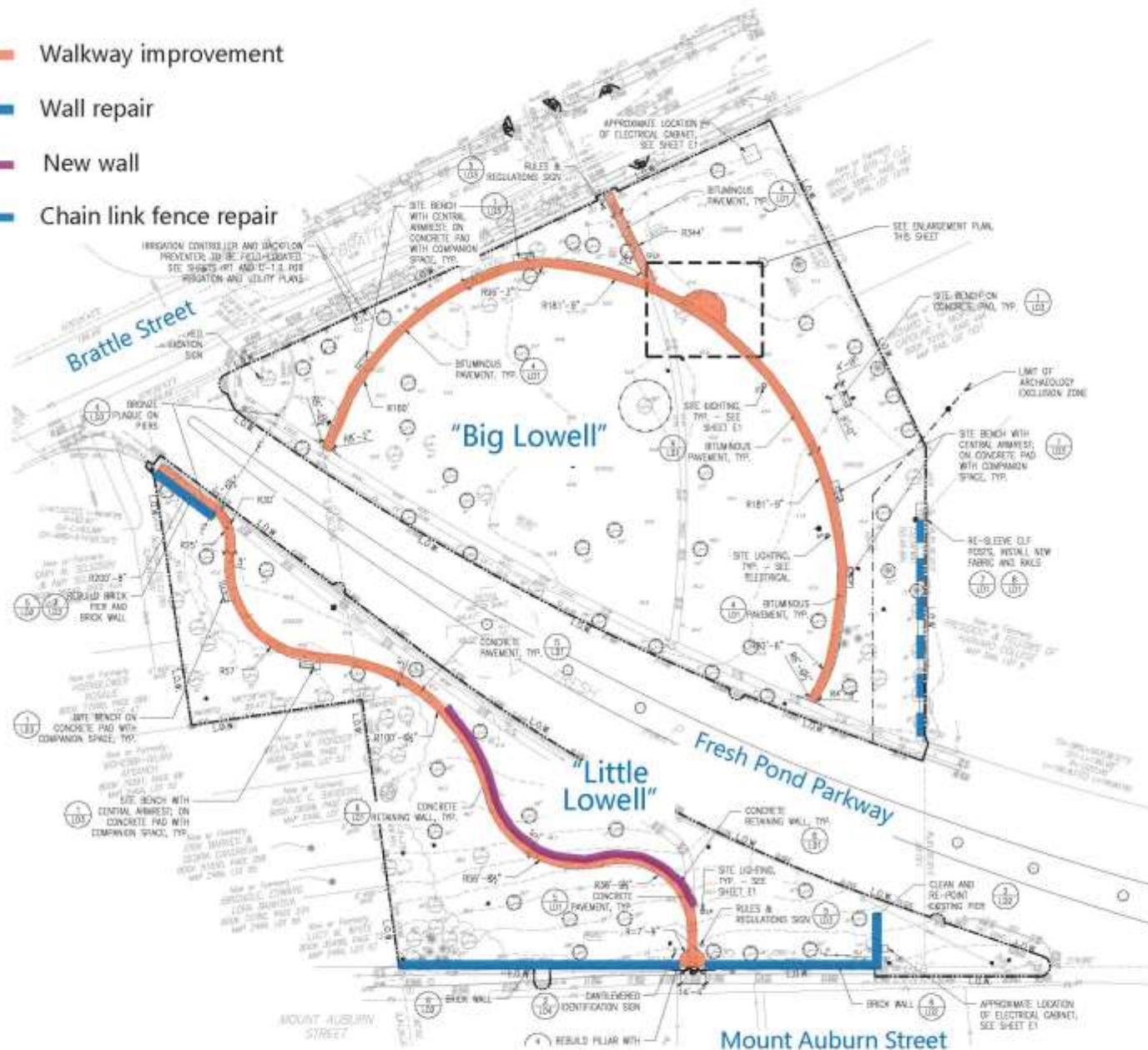

LAYOUT & MATERIALS NOTES:

1. SURVEY WAS PERFORMED IN 2018 BY FELDMAN LAND SURVEYORS, BOSTON, MA.
2. ALL LINE AND GRADE WORK FOR DRAWINGS AND SPECIFICATIONS SHALL BE Laid OUT BY A REGISTERED CIVIL ENGINEER OR SURVEYOR ENGAGED BY THE CONTRACTOR.
3. ALL LINES AND DIMENSIONS ARE PARALLEL OR PERPENDICULAR TO THE LINES FROM WHICH THEY ARE MEASURED UNLESS OTHERWISE INDICATED.
4. STORAGE AREAS FOR CONTRACTOR'S EQUIPMENT AND MATERIALS SHALL BE IN AND WITHIN LIMITS OF WORK AS SHOWN ON PLANS AND AS APPROVED BY THE LANDSCAPE ARCHITECT.
5. CONTRACTOR SHALL VERIFY ALL EXISTING CONDITIONS IN THE FIELD AND REPORT ANY DISCREPANCIES IN THE SITE SURVEY TO THE LANDSCAPE ARCHITECT PRIOR TO STARTING WORK.
6. ALL LAYOUTS FOR WALKS AND PATHS SHALL BE ADEQUATELY STAKED BY THE CONTRACTOR AND APPROVED BY THE LANDSCAPE ARCHITECT PRIOR TO CONSTRUCTION.
7. THE CONTRACTOR SHALL ESTABLISH PERMANENT CONSTRUCTION BENCH MARKS MAINTAIN ALL ESTABLISHED BOUNDS AND BENCH MARKS AND REPLACE AS DIRECTED ANY WHICH ARE DESTROYED OR DISTURBED.
8. CONTRACTOR SHALL COORDINATE LOCATION OF ALL UTILITIES (LINES, DUCTS, CONDUITS, SLOVES, FOOTINGS, ETC.) WITH LOCATIONS OF PROPOSED LANDSCAPE ELEMENTS (WALKS, FENCE, FOOTINGS, TREE ROOTBALLS, PROPOSED LIGHTING FOOTINGS, ETC.). CONTRACTOR SHALL REPORT ANY DISCREPANCIES TO LANDSCAPE ARCHITECT PRIOR TO CONTINUING WORK.
9. LIMIT OF WORK LINE IS NOTED ON DRAWINGS. CONTRACTOR IS RESPONSIBLE FOR ALL DAMAGE DUE TO OPERATIONS INSIDE AND OUTSIDE OF THE CONTRACT LIMIT LINE. ANY AREAS OUTSIDE THE LIMIT OF WORK THAT ARE DISTURBED SHALL BE RESTORED TO ITS ORIGINAL CONDITION AT NO ADDITIONAL COST TO THE OWNER. PROMISE EXAMINATIONS ADJACENT TO ALL CURBS, WALLS, SLOPS, LIGHT POLE BASES, PULL BOXES, MANHOLES, ETC. AND AS SHOWN ON PLAN.
10. AUTOCAD FILE WILL BE PROVIDED TO THE CONTRACTOR TO LAYOUT SITE IMPROVEMENTS.

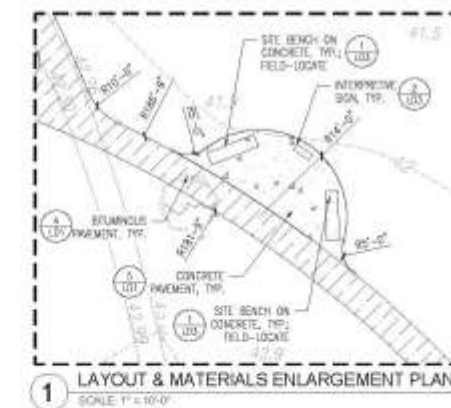

LEGEND

-  DEAD, DYING, OR DAMAGED TREE (9)
-  TREES INCONSISTENT WITH OLMSTED BROTHERS PLAN (8)
-  TREES IN POOR LOCATION FOR PATHWAY RESTORATION (1)
-  TREES WITHIN 5 FEET OF WALLS/FENCES (12)
-  TREE STUMPS TO BE REMOVED (7)

TOTAL TREES TO BE REMOVED: 30

- TREES TO BE PRUNED

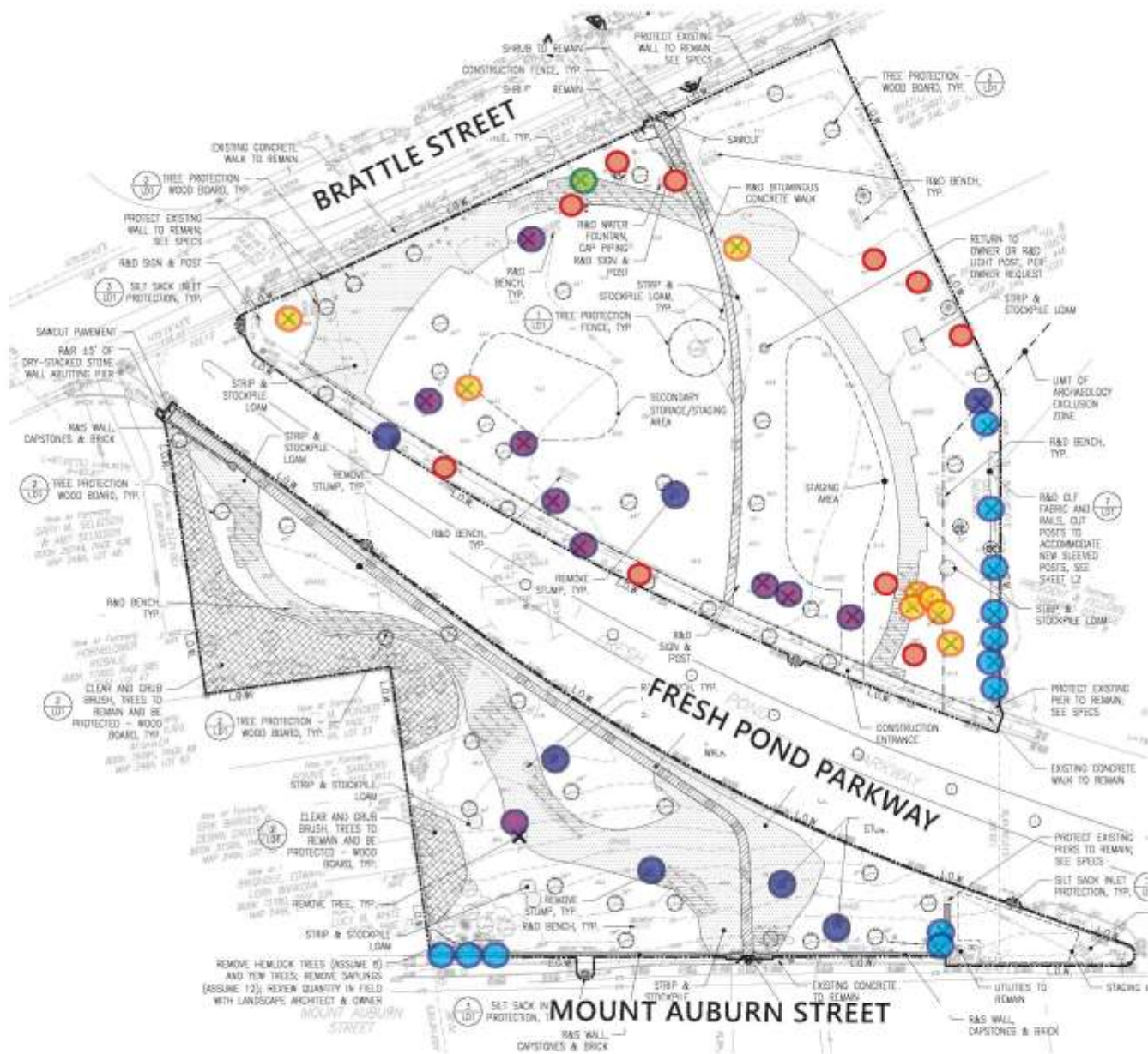





DEPT. OF CONSERVATION & RECREATION
LOWELL MEMORIAL PARK

PLANTINGS

JUNE 2023

kzla

LEGEND

-  EXISTING TREE
-  PROPOSED TREE
-  SCIONS OF MAPLE
-  SHRUB PLANTING (IRRIGATED)

TOTAL TREES TO BE PLANTED: 27

BIG LOWELL: 13

LITTLE LOWELL: 14



DEPT. OF CONSERVATION & RECREATION
LOWELL MEMORIAL PARK

PLANTINGS

JUNE 2023

kzla



Swamp White Oak



Red oak



Pin oak



Norway maple



White ash



DEPT. OF CONSERVATION & RECREATION
LOWELL MEMORIAL PARK

EXISTING TREES
PLANTINGS

JUNE 2023

kzla



Washington hawthorn



- Leaves turn attractive shades of orange and red in fall.
- Fragrant, white flowers in clusters bloom in late spring; June
- Followed in fall by bright red fruits; persist throughout the winter



Yellowwood

- Leaves open as yellowish green, turn bright green in summer and then turn yellow in fall
- Intensely fragrant, wisteria-like, pink flowers in large, drooping, terminal panicles cover a mature tree in late spring; May



Flowering dogwood 'Celestial'



- Bracts emerge white with a green tinge, but mature to pink; April to May
- Purple-red fall foliage



Silver linden



- Fall color is an undistinguished pale green to pale yellow



Beautyberry

- Clusters of small, pink to lavender flowers bloom along the stems in summer: June to August
- Flowers are followed by clusters of lilac-violet fruits; ripen in September through October.



Deutzia

- Tiny, fragrant, bell-shaped, white flowers appear in spring; April to May



St. John's wort

- Large, slightly fragrant and bloom throughout the summer; June to September
- Golden yellow bloom
- Reddish-brown fruit that ripen in September and can persist well into winter.
- Dark green, lance-shaped leaves
- Reddish, twiggly stems



Coralberry

- Bell-shaped, white flowers with a pink tinge appear in summer (June to July) along the stems
- Flowers give way to clusters of round, coral-red berries which mature in autumn.
- Berries persist through most of the winter providing excellent color and interest to the winter landscape.



Foamflower

- Herbaceous perennial
- Foliage is evergreen in mild winters, often turning reddish bronze in autumn and winter.
- Tiny, white or pink flowers with very long stamens in May



Common selfheal

- Herbaceous perennial
- Dense spikes of purple to pink blooms from late spring to early fall
- Beneficial to pollinators



Sweet woodruff

- Herbaceous perennial
- Small, fragrant, white flowers appear in spring; April to May

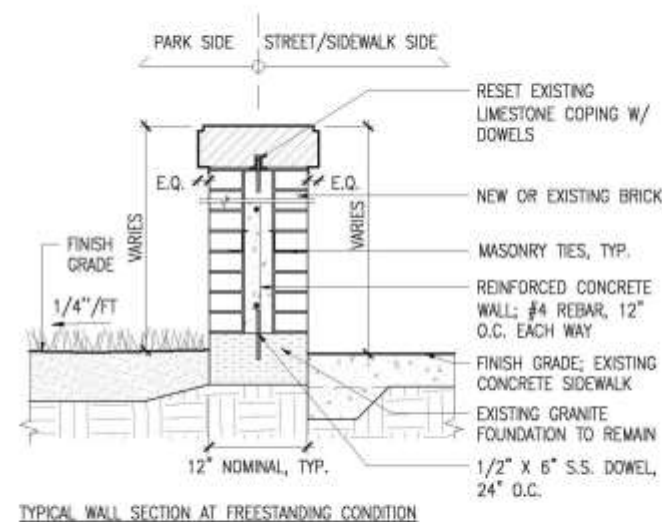
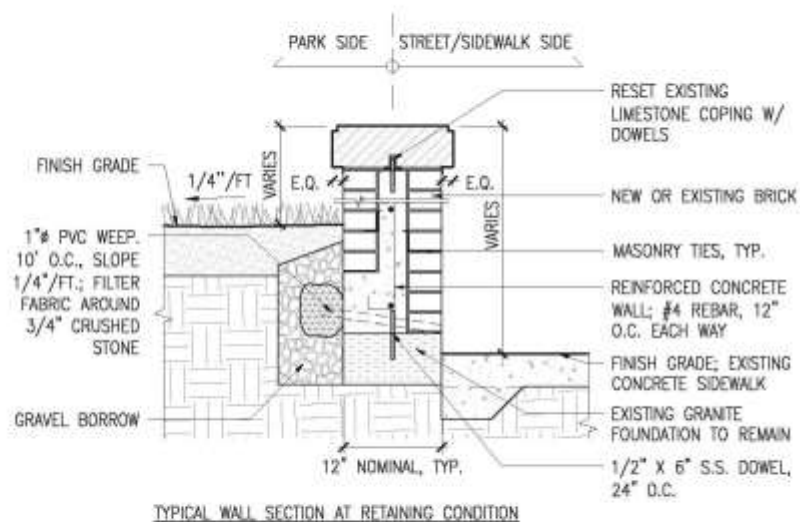
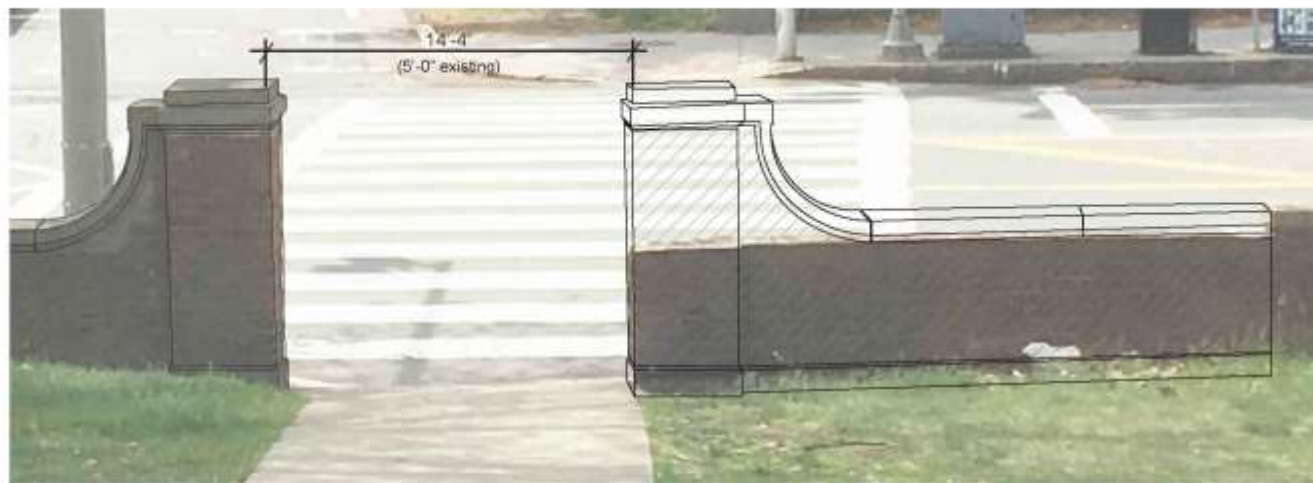

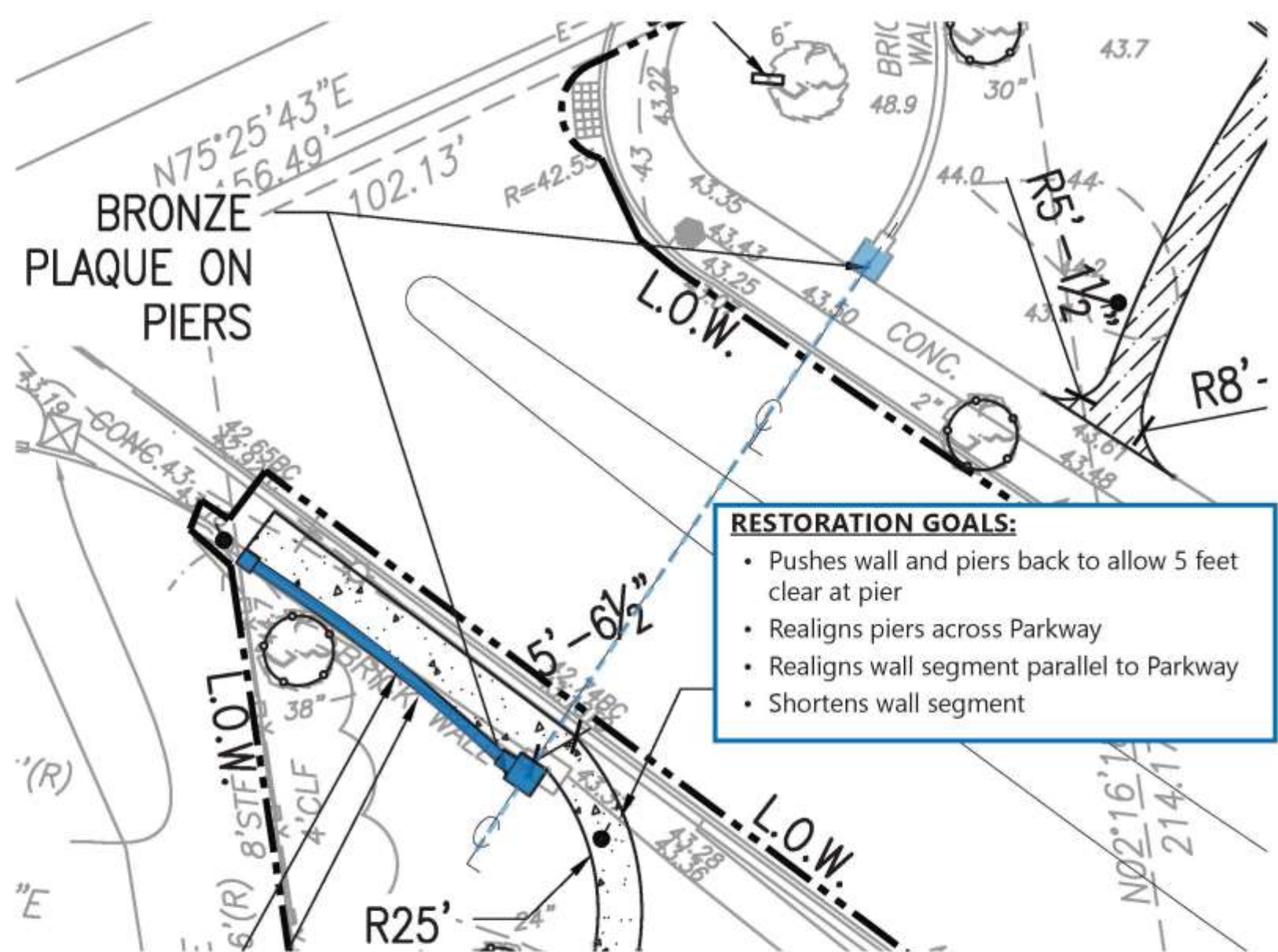

LEGEND

-  PROPOSED LIGHT FIXTURES
-  PROPOSED BENCH
-  PROPOSED PARK ID SIGN
-  PROPOSED RULES & REGULATIONS SIGN
-  INTERPRETIVE SIGNAGE
-  HISTORIC WALL PLAQUES

TOTAL BENCHES: 9

BIG LOWELL: 7 (5 EXISTING)

LITTLE LOWELL: 2 (3 EXISTING)

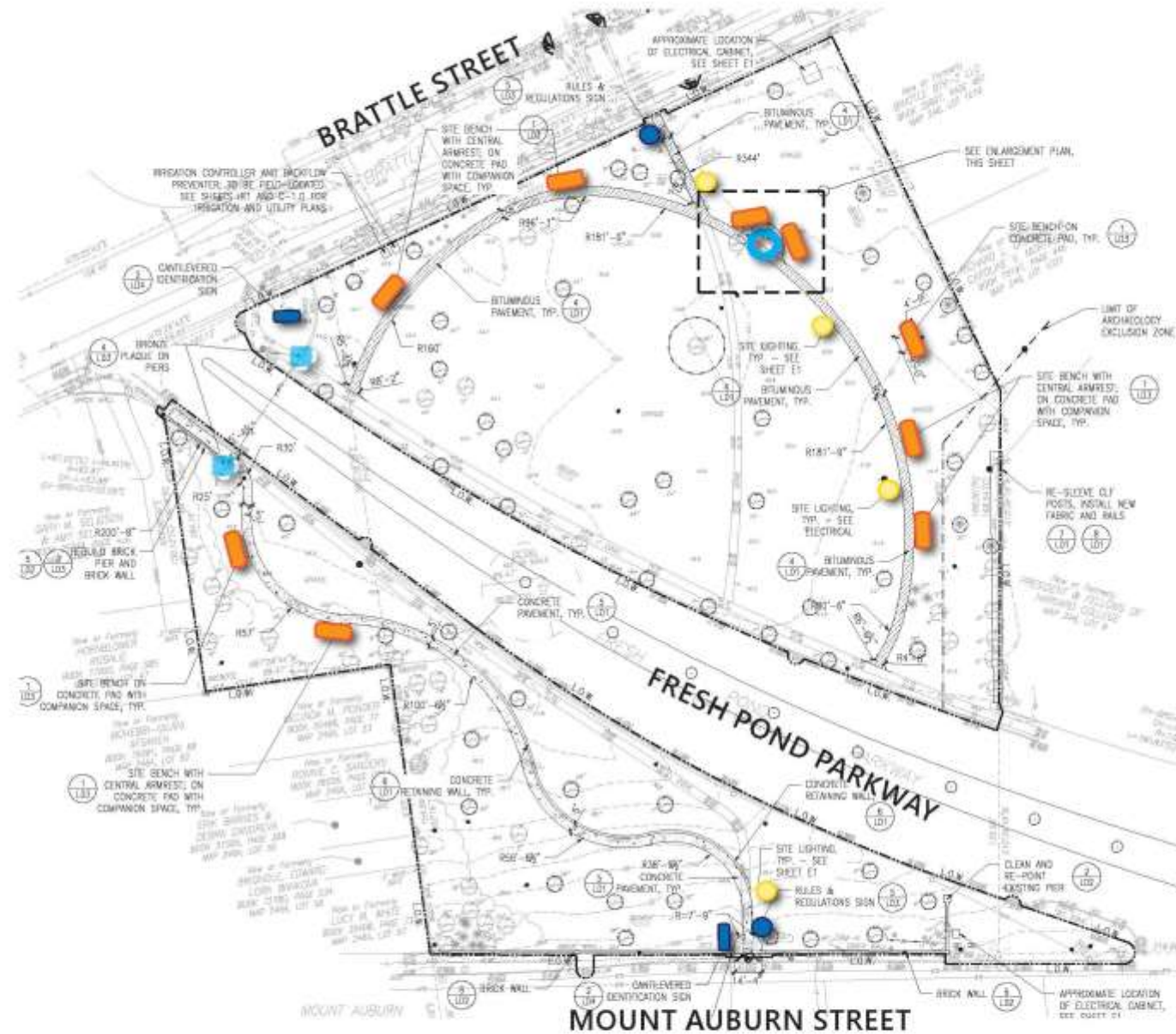



KING LUMINAIRE FIXTURE: YARMOUTH
CMT LEGACY METAL POLE: 20" COLONNADE



DCR SHURCLIFF BENCH



SAMPLE DCR PARK SIGNAGE

Construction Schedule and Impacts

Bidding	July
Award	September
Construction Start	September 2023
Construction End	June 2024

Potential Impacts

Park closures

Potential pedestrian detours during work in Little Lowell

Construction best practices including dust control, standard work hours, etc.

Questions and Answers

In the meeting:

The public is invited to ask questions and provide feedback on the presentation, using the Q&A functionality that will be available through the virtual participation platform.

After the meeting:

DCR encourages the public to share additional feedback, with a deadline for receipt of comments by DCR of July 6th, 2023.

Comments may be submitted online at <http://www.mass.gov/dcr/public-comment>

Please note that the content of comments you submit to DCR, along with your name, town, and zip code, will be posted on DCR's website. Additional contact information required when commenting, notably email address, will only be used for outreach on future updates on the subject project or property.