



DESIGN PUBLIC HEARING

Tuesday, January 14, 2020

AT

**OTIS TOWN HALL
CONFERENCE ROOM**

OTIS, MASSACHUSETTS

6:30 PM

FOR THE PROPOSED

TANNERY ROAD OVER WEST BRANCH FARMINGTON RIVER

Bridge Replacement Project

Project No.608856

Bridge Nos O-05-007

Bridge Project Management

IN THE TOWN OF OTIS, MASSACHUSETTS

**COMMONWEALTH OF MASSACHUSETTS
MASSACHUSETTS DEPARTMENT OF TRANSPORTATION
HIGHWAY DIVISION**

**JONATHAN GULLIVER
HIGHWAY ADMINISTRATOR**

**PATRICIA A. LEAVENWORTH, P.E.
CHIEF ENGINEER**

THE COMMONWEALTH OF MASSACHUSETTS
MASSACHUSETTS DEPARTMENT OF TRANSPORTATION – HIGHWAY DIVISION
NOTICE OF A PUBLIC HEARING
Project File No. 608856

A Design Public Hearing will be held by MassDOT to discuss the proposed Bridge Replacement of Bridge No. O-05-007 carrying Tannery Road over West Branch Farmington River in Otis, MA.

WHERE: Otis Town Hall, Conference Room
One North Main Road
Otis, MA 01253

WHEN: Tuesday, January 14, 2020 @ 6:30 PM

PURPOSE: The purpose of this hearing is to provide the public with the opportunity to become fully acquainted with the proposed Bridge Replacement of Bridge No. O-05-007 carrying Tannery Road over West Branch Farmington River. All views and comments made at the hearing will be reviewed and considered to the maximum extent possible.

PROPOSAL: The proposed project consists of replacing the existing bridge with a single span precast concrete deck beam. The bridge will be approximately a 42-foot single span. The bridge will have a 15' – 0" minimum curb to curb width, and about 18' - 0" out to out width. The span of the bridge will be increased from the existing 25' – 0" to 42' – 0" to provide sufficient horizontal clearance to meet the bank full width requirements under the bridge. There will be a one lane two-way road, and approach roadway guardrails will be added. Classified as a rural Local road with no current sidewalks, it is exempt from need to comply with Pedestrian and Bicycle accommodations.

A secure right-of-way is necessary for this project. Acquisitions in fee and permanent or temporary easements may be required. The town of Otis is responsible for acquiring all needed rights in private or public lands. MassDOT's policy concerning land acquisitions will be discussed at this hearing.

Written views received by MassDOT subsequent to the date of this notice and up to five (5) days prior to the date of the hearing shall be displayed for public inspection and copying at the time and date listed above. Plans will be on display one-half hour before the hearing begins, with an engineer in attendance to answer questions regarding this project. A project handout will be made available on the MassDOT website listed below.

Written statements and other exhibits in place of, or in addition to, oral statements made at the Public Hearing regarding the proposed undertaking are to be submitted to Patricia A. Leavenworth, P.E., Chief Engineer, MassDOT, 10 Park Plaza, Boston, MA 02116, Attention: Bridge Project Management Section, Project File No. 608856. Such submissions will also be accepted at the hearing. Mailed statements and exhibits intended for inclusion in the public hearing transcript must be postmarked no later than ten (10) business days after this Public Hearing. Project inquiries may be emailed to dot.feedback.highway@state.ma.us

This location is accessible to people with disabilities. MassDOT provides reasonable accommodations and/or language assistance free of charge upon request (including but not limited to interpreters in American Sign Language and languages other than English, open or closed captioning for videos, assistive listening devices and alternate material formats, such as audio tapes, Braille and large print), as available. For accommodation or language assistance, please contact MassDOT's Chief Diversity and Civil Rights Officer by phone (857-368-8580), fax (857-368-0602), TTD/TTY (857-368-0603) or by email (MassDOT.CivilRights@dot.state.ma.us). Requests should be made as soon as possible prior to the meeting, and for more difficult to arrange services including sign-language, CART or language translation or interpretation, requests should be made at least ten (10) business days before the meeting.

In case of inclement weather, hearing cancellation announcements will be posted on the internet at <http://www.massdot.state.ma.us/Highway/>

JONATHAN GULLIVER
HIGHWAY ADMINISTRATOR

PATRICIA A. LEAVENWORTH, P.E.
CHIEF ENGINEER



Dear Concerned Citizen:

The Massachusetts Department of Transportation (MassDOT) is committed to building and maintaining a transportation infrastructure that is both safe and efficient for all who use our roadways, bridges, bicycle facilities and pedestrian paths, while maintaining the integrity of the environment.

As part of the design process for this project, we are conducting this public hearing to explain the proposed improvements, listen to your comments and answer any questions you may have. At the conclusion of the hearing, MassDOT will review all of your comments and, where feasible, incorporate them into the design of the project.

We recognize that road and bridge construction can create inconveniences for the public. MassDOT places a great deal of emphasis on minimizing the temporary disruptive effects of construction.

MassDOT encourages input from local communities and values your opinions. Please be assured that we will undertake no project without addressing the concerns of the community.

Sincerely,

Patricia A Leavenworth, P. E.
Chief Engineer

WHAT IS A PUBLIC HEARING?

WHY A PUBLIC HEARING?

To provide an assured method whereby the Commonwealth of Massachusetts can furnish to the public information concerning the State's highway construction proposals, and to afford every interested resident of the area an opportunity to be heard on any proposed project. At the same time, the hearings afford the Commonwealth an additional opportunity to receive information from local sources which would be of value to the State in making its final decisions to what design should be advanced for development.

WHY NOT A VOTE ON HIGHWAY PLANS?

The hearings are not intended to be a popular referendum for the purpose of determining the nature of a proposed improvement by a majority of those present. They do not relieve the duly constituted officials of a State highway department of the necessity for making decisions in State highway matters for which they are charged with full responsibility.

WHAT DOES A PUBLIC HEARING ACCOMPLISH?

It is designed to ensure the opportunity for, or the availability of, a forum to provide factual information which is pertinent to the determination of the final alternative considered by the state to best serve the public interest, and on which improvement projects are proposed to be undertaken.

It is important that the people of the area express their views in regard to the proposal being presented, so that views can be properly recorded in the minutes of the meeting. These minutes will be carefully studied and taken into consideration in the determination of the final design.

RIGHT OF WAY ISSUES

A secure right of way is necessary for this project. Temporary construction easements may be required. Your municipality is responsible for acquiring all necessary rights in private or public lands. If your property is affected, your rights are fully protected under law.

1. REASON FOR PROJECT

The completion of this project will serve local needs. The proposed enhancement will also be in the interest of others in the greater community, and provide for the public good.

2. WHO CONTACTS ME?

Representatives of the municipality have already contacted or will contact you. They will explain the procedures used in acquiring any necessary rights in land.

3. WHAT ABOUT DONATIONS? WHAT IS A RIGHT OF ENTRY?

Town officials will often seek donations, of parcels, where permanent rights are required. This procedure will minimize the acquisition cost for your community.

A Right of Entry is a document that is signed by the owner. It allows the Contractor to perform certain types of work on the owner's land. The work is usually minor in nature and frequently consists of loaming/seeding behind sidewalks, new driveway apron work, grading/sloping, and wetland protection, etc. The rights granted are temporary in nature.

4. WHAT IS A FAIR PRICE FOR THE ACQUIRED PARCELS?

In the event that donations are not considered, or completed, every effort will be made to ensure that an equitable value is awarded. Municipal and/or outside appraisers will complete an appraisal. Consideration is given to the type of rights needed, whether in fee, permanent or temporary easements. The appraisal will be the basis for arriving at a fair price (for damages that result).

5. MUST I ACCEPT THE MUNICIPALITY OFFER?

No, if the owner feels that the offer is not fair the owner may petition the courts. This action does not stop or delay the acquisition. The action must occur within 3 years. The owner(s) may be paid pro tanto (for the time being). The pro tanto payment will not prejudice the court's final decision.

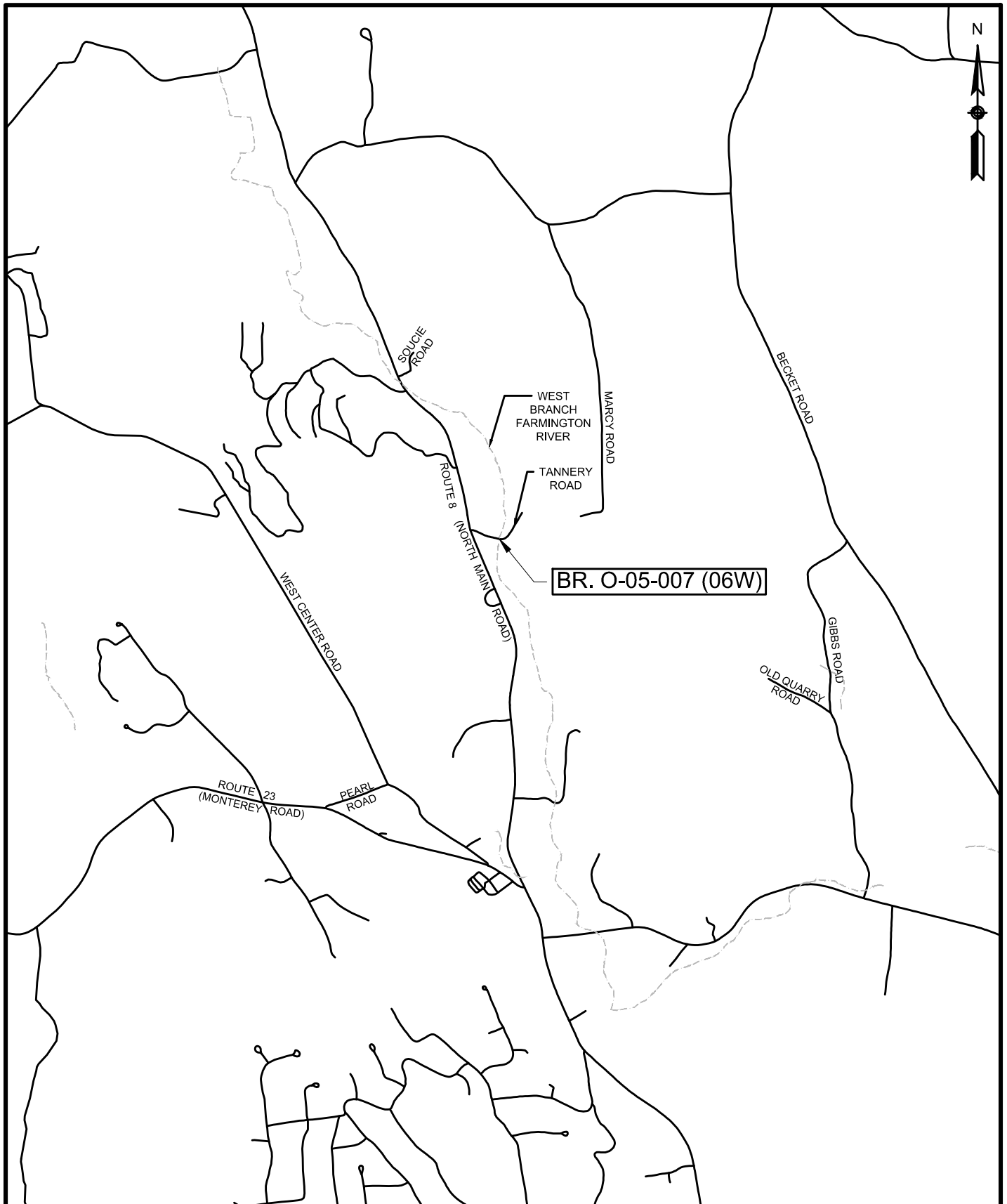

TANNERY ROAD

OVER THE WEST BRANCH OF THE FARMINGTON RIVER

BRIDGE NO. O-05-007 (06W)

MASSDOT PROJECT FILE NO. 608856



Mcfarland Johnson

239 LITTLETON ROAD, SUITE 1A
WESTFORD, MA 01886
PH: 978-692-0522 www.mjinc.com

PROJECT LOCATION MAP

DRAWN BY:
MDA

CHECKED BY:
JLR

FIGURE NO.

SCALE:
1" = 2000'

DATE:
OCTOBER, 2019

1

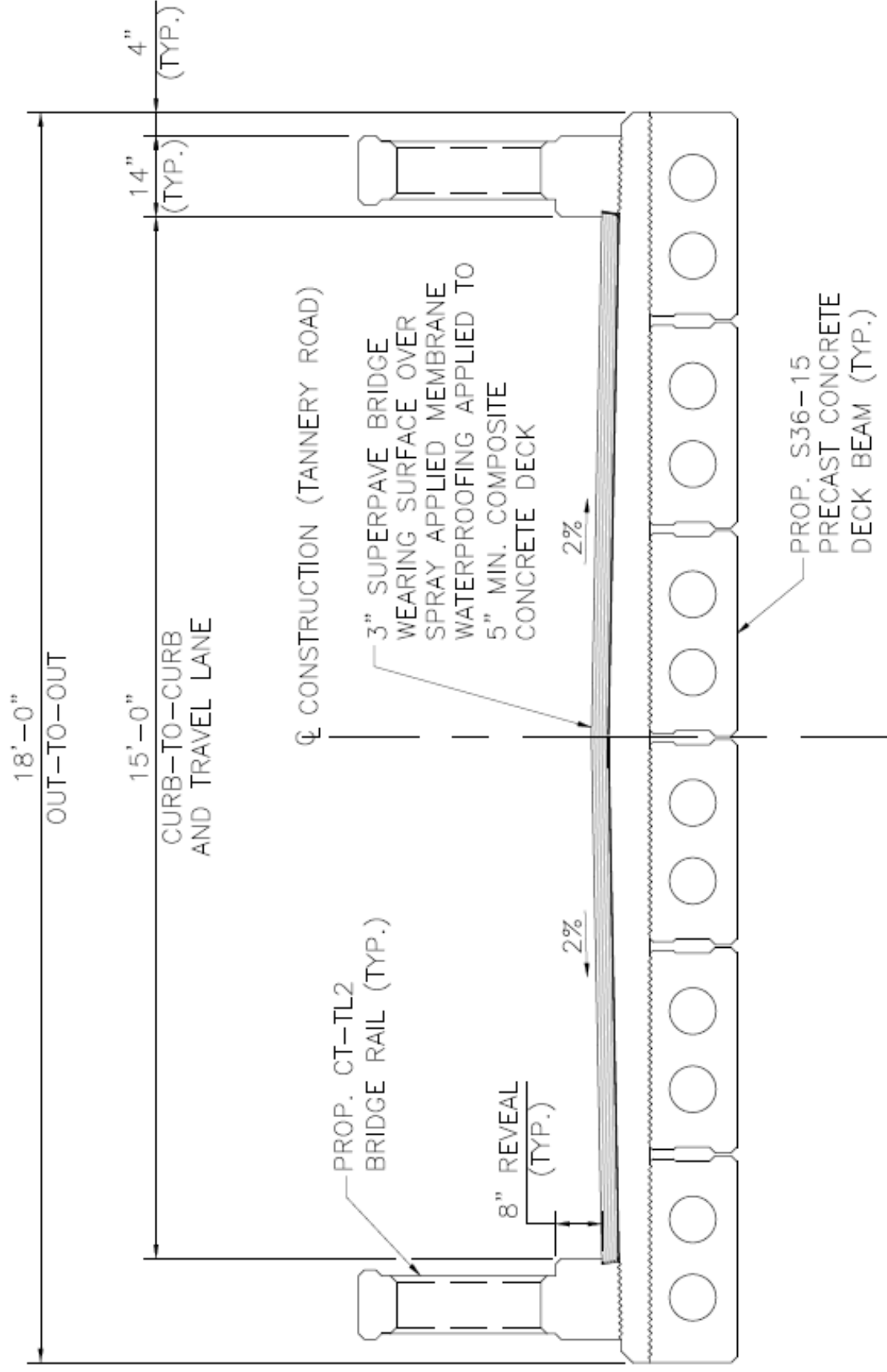

TRANSVERSE SECTION

SCALE: $\frac{1}{2}" = 1'-0"$

Project Purpose

The limited scope of this project is to replace the existing structurally deficient bridge that carries Tannery Road over the West Branch Farmington River. The project is focused on the bridge replacement and not on roadway improvements while minimizing wetland impacts and maintaining vehicle access during construction. The project will maintain access to the driveway east of the existing bridge throughout construction. The project will remove the existing bridge and its approaches and replace them with a 42-foot span bridge constructed on a new alignment south of the existing bridge.

Existing Conditions

The existing bridge structure that carries the 15-foot wide gravel Tannery Road over the West Branch Farmington River was constructed in 1930 and reconstructed in 1969. The existing bridge is approximately 14-feet wide, has no striped lanes or shoulders, has substandard bridge rail, and carries one direction of vehicular traffic at a time. The superstructure consists of six steel beams that support a corrugated steel deck with asphalt wearing surface. The substructure consists of two reinforced concrete gravity abutments and stone masonry splayed wingwalls. According to the latest MassDOT Inspection Report, the existing bridge is structurally deficient. The bridge was recently closed due to the severe deterioration of the steel beams.

Proposed Improvements

The proposed bridge will be constructed on a new alignment south of the existing bridge. The proposed bridge structure will span 42'-0" over the West Branch Farmington River and will consist of adjacent prestressed concrete deck beams supported on cast-in-place reinforced concrete abutments with spread footings. The proposed bridge will accommodate one 15-foot vehicular travel lane. Concrete CT-TL2 crash-tested bridge railing will be mounted on each side of the proposed bridge. Roadway work includes removal of existing approaches, construction of the realigned roadway with new guardrail that meets current standards, and wetland restoration.

Traffic Management

The existing bridge and roadway will be open during construction and will be utilized while the proposed bridge and realigned roadway are under construction.

Utilities

The project will require the relocation of existing overhead wires and poles.

Environmental

Due to wetland and surface water impacts needed to complete the proposed work, an Army Corps of Engineers Section 404 permit and a MassDEP Section 401 Water Quality Certification will be required.

Right of Way

Takings are required for the proposed realigned Tannery Road layout. Permanent easements are required to install the proposed channel stabilization, utility relocation, and additional guardrail. Temporary easements are required to re-grade the driveway located east of the proposed bridge structure and to install the proposed control of water system needed to complete the construction.

Project Cost

The estimated preliminary construction cost of the proposed roadway and bridge structure is \$1,000,000.

Project Status

The plans on display tonight were prepared during the 25% (preliminary) design stage. Comments received this evening will be considered during final design. The design is anticipated to be complete in the fall of 2020 and will be advertised for Construction in December of 2020. Construction is anticipated to start in Spring 2021 and be complete by fall 2022.

Address: _____

Please Fold and Tape



Please Place
Appropriate
Postage Here

Patricia A. Leavenworth, P.E.
Chief Engineer
MassDOT – Highway Division
10 Park Plaza
Boston, MA 02116-3973

RE: Public Hearing
BRIDGE REPLACEMENT – TANNERY ROAD OVER WEST BRANCH
FARMINGTON RIVER
OTIS
Project File No. 608856
Insert section: Bridge Project Management

