



**VIRTUAL DESIGN PUBLIC HEARING**

**June 23, 2022**

**FOR THE PROPOSED**

**BRIDGE REPLACEMENT  
MAIN STREET OVER HEMLOCK BROOK**

**Project No. 609072**

**Bridge No. W-37-010**

**IN THE TOWN OF WILLIAMSTOWN, MASSACHUSETTS**

**COMMONWEALTH OF MASSACHUSETTS  
MASSACHUSETTS DEPARTMENT OF TRANSPORTATION  
HIGHWAY DIVISION**

**JONATHAN GULLIVER  
HIGHWAY ADMINISTRATOR**

**CARRIE E. LAVALLEE, P.E.  
CHIEF ENGINEER**

**THE COMMONWEALTH OF MASSACHUSETTS**  
**MASSACHUSETTS DEPARTMENT OF TRANSPORTATION – HIGHWAY DIVISION**  
**NOTICE OF A PUBLIC HEARING**  
**Project File No. 609072**

A Live Virtual Design Public Hearing will be hosted on the MassDOT website below to present the design for the proposed Bridge Replacement W-37-010 Main Street over Hemlock Brook project in Williamstown, MA.

WHEN: 6:30 PM Thursday June 23, 2022

PURPOSE: The purpose of this hearing is to provide the public with the opportunity to become fully acquainted with the proposed Bridge Replacement of Main Street over the Hemlock Brook project. All views and comments submitted in response to the hearing will be reviewed and considered to the maximum extent possible.

PROPOSAL: The proposed project consists of a uniform bridge deck and approach road with two 12'-0" wide travel lanes, and 2'-0" wide shoulders on both sides for a total roadway width of 28'-0" curb to curb. The bridge and immediate approaches will have granite curb and guardrail transitions to the bridge parapet. A 5'-6" wide sidewalk will be provided on the north side of the bridge. Shared use of the travel lane for bicyclists will continue the same as it does today.

A secure right-of-way is necessary for this project. Acquisitions in fee and permanent or temporary easements may be required. The town is responsible for acquiring all needed rights in private or public lands. The Town's policy concerning land acquisitions will be presented in the hearing.

Project inquiries, written statements and other exhibits regarding the proposed undertaking may be submitted to Carrie E. Lavallee, P.E., Chief Engineer, via e-mail to [MassDOTProjectManagement@dot.state.ma.us](mailto:MassDOTProjectManagement@dot.state.ma.us) or via US Mail to Suite 7210, 10 Park Plaza, Boston, MA 02116, Attention: Project Management, Project File No. 609072. Statements and exhibits intended for inclusion in the public hearing transcript must be emailed or postmarked no later than ten (10) business days (14 calendar days) after the hearing is hosted on the MassDOT website listed below.

This hearing is accessible to people with disabilities. MassDOT provides reasonable accommodations and/or language assistance free of charge upon request (e.g interpreters in American Sign Language and languages other than English, live captioning, videos, assistive listening devices and alternate material formats), as available. For accommodation or language assistance, please contact MassDOT's Chief Diversity and Civil Rights Officer by phone (857-368-8580), TTD/TTY at (857) 266-0603, fax (857) 368-0602 or by email ([MassDOT.CivilRights@dot.state.ma.us](mailto:MassDOT.CivilRights@dot.state.ma.us)). Requests should be made as soon as possible and prior to the hearing, and for more difficult to arrange services including sign-language, CART or language translation or interpretation, requests should be made at least ten business days before the hearing.

This Live Virtual Design Public Hearing or a cancellation announcement will be hosted on the internet at [www.mass.gov/massdot-highway-design-public-hearings](http://www.mass.gov/massdot-highway-design-public-hearings).

JONATHAN GULLIVER  
HIGHWAY ADMINISTRATOR

CARRIE E. LAVALLEE, P.E.  
CHIEF ENGINEER



Dear Concerned Citizen:

The Massachusetts Department of Transportation (MassDOT) is committed to building and maintaining a transportation infrastructure that is both safe and efficient for all who use our roadways, bridges, bicycle facilities and pedestrian paths, while maintaining the integrity of the environment.

As part of the design process for this project, we are conducting this public hearing to explain the proposed improvements, listen to your comments and answer any questions you may have. At the conclusion of the hearing, MassDOT will review all of your comments and, where feasible, incorporate them into the design of the project.

We recognize that road and bridge construction can create inconveniences for the public. MassDOT places a great deal of emphasis on minimizing the temporary disruptive effects of construction.

MassDOT encourages input from local communities and values your opinions. Please be assured that we will undertake no project without addressing the concerns of the community.

Sincerely,

Patricia A Leavenworth, P. E.  
Chief Engineer

## **WHAT IS A PUBLIC HEARING?**

### **WHY A PUBLIC HEARING?**

To provide an assured method whereby the Commonwealth of Massachusetts can furnish to the public information concerning the State's highway construction proposals, and to afford every interested resident of the area an opportunity to be heard on any proposed project. At the same time, the hearings afford the Commonwealth an additional opportunity to receive information from local sources which would be of value to the State in making its final decisions to what design should be advanced for development.

### **WHY NOT A VOTE ON HIGHWAY PLANS?**

The hearings are not intended to be a popular referendum for the purpose of determining the nature of a proposed improvement by a majority of those present. They do not relieve the duly constituted officials of a State highway department of the necessity for making decisions in State highway matters for which they are charged with full responsibility.

### **WHAT DOES A PUBLIC HEARING ACCOMPLISH?**

It is designed to ensure the opportunity for, or the availability of, a forum to provide factual information which is pertinent to the determination of the final alternative considered by the state to best serve the public interest, and on which improvement projects are proposed to be undertaken.

It is important that the people of the area express their views in regard to the proposal being presented, so that views can be properly recorded in the minutes of the meeting. These minutes will be carefully studied and taken into consideration in the determination of the final design.

## **RIGHT OF WAY CONCERNS**

Your Municipality is responsible for securing the right of way for this project. If your property, or a portion of it, must be acquired by the Municipality for highway purposes in the interest of all people of the Commonwealth, your rights are fully protected under the law. Briefly, here are some of the answers to questions you might ask.

### **1. REASON FOR PROJECT**

The completion of this project will serve local needs. The proposed enhancement will also be in the interest of others in the greater community, and provide for the public good.

### **2. WHO CONTACTS ME?**

Representatives of the municipality have already contacted or will contact you. They will explain the procedures used in acquiring any necessary rights in land.

### **3. WHAT ABOUT DONATIONS? WHAT IS A RIGHT OF ENTRY?**

Town officials will often seek donations, of parcels, where permanent rights are required. This procedure will minimize the acquisition cost for your community.

A Right of Entry is a document that is signed by the owner. It allows the Contractor to perform certain types of work on the owner's land. The work is usually minor in nature and frequently consists of loaming/seeding behind sidewalks, new driveway apron work, grading/sloping, and wetland protection, etc. The rights granted are temporary in nature.

### **4. WHAT IS A FAIR PRICE FOR THE ACQUIRED PARCELS?**

In the event that donations are not considered, or completed, every effort will be made to ensure that an equitable value is awarded. Municipal and/or outside appraisers will complete an appraisal. Consideration is given to the type of rights needed, whether in fee, permanent or temporary easements. The appraisal will be the basis for arriving at a fair price (for damages that result).

### **5. MUST I ACCEPT THE MUNICIPALITY OFFER?**

No, if the owner feels that the offer is not fair the owner may petition the courts. This action does not stop or delay the acquisition. The action must occur within 3 years. The owner(s) may be paid pro tanto (for the time being). The pro tanto payment will not prejudice the court's final decision.

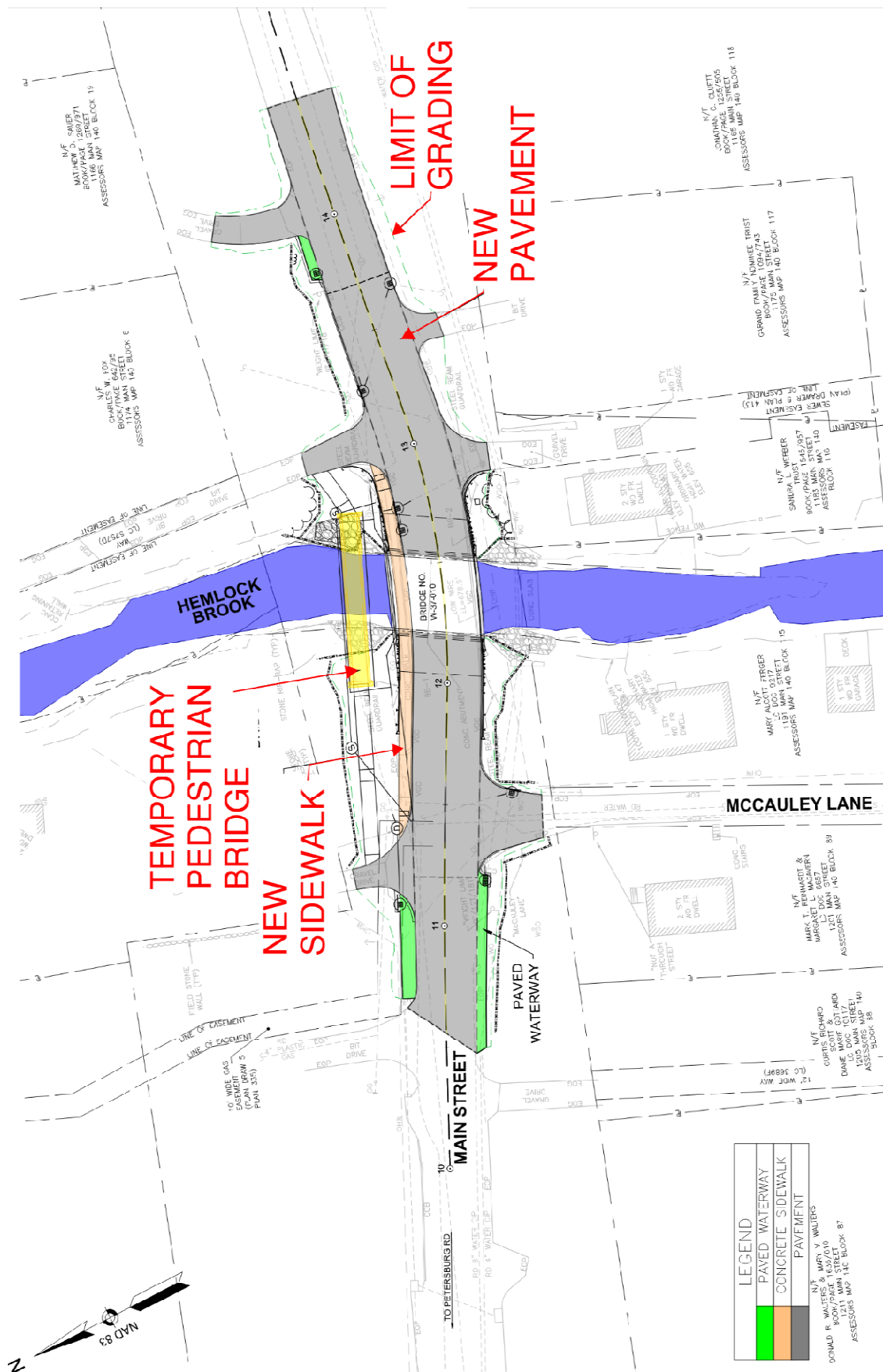

#### Project Location:

Bridge No. W-37-010 carries Main Street over Hemlock Brook in the Town of Williamstown. The bridge is located between Belden Street and McCauley Lane on Main Street.

#### Project Purpose:

The purpose of this project is to replace the structurally deficient bridge with a new structure. The bridge is currently open to traffic however it has weight limits. The bridge has a curb-to-curb width of 28 feet with a 3 foot wide sidewalk on the north side.

#### Existing Conditions:

Main Street is a two-lane road with a Functional Classification of "Local Road." Main Street serves residential neighborhoods west of Route 2 and Field Park. The corridor is a low-speed local road.

The roadway approaches to the bridge are approximately 20 feet wide and grows to 28 feet at the bridge. There are no defined shoulders and no sidewalks. The horizontal alignment at the bridge is curved. The vertical profile through the bridge site is at the bottom of a sag curve with significant downgrades that are over 10% from each direction. The bridge has a cross slope of 6%. There are driveways on both sides of Main Street approximately 35 feet from the east end of the bridge.

There is a gas main and a sewer main on the bridge.

#### Proposed Improvements:

The proposed improvements include complete superstructure replacement to replace the deteriorated elements. The existing abutments and foundations will remain. The footprint of the bridge will be the same as the existing bridge. Re-construction of about 200 feet of the roadway approaches, wingwall and retaining walls, guardrails and drainage improvements are also proposed.

The proposed roadway section consists of 2-12 ft. lanes and 2-2 ft. shoulders tapering to the existing width at the project limits. A wider 5 ft. 6 inch sidewalk will be provided on the north side of the bridge. The horizontal alignment will remain basically the same as the existing. The vertical profile of the bridge will be raised about one foot to accommodate deeper structural elements. No construction is proposed in the stream bed.

#### Maintenance of Traffic during Construction:

The proposed bridge will be constructed in two stages. The first stage will include building a temporary utility and pedestrian bridge north of the existing bridge while the road remains open. The second stage will replace the existing bridge while Main Street is closed.

During the second stage, the bridge will be closed for both vehicular and pedestrian traffic. Traffic from Main Street will be detoured via Thornliebank Road or Bulkley Street to Routes 2 and 7 respectively. Pedestrians and bicyclists will be able to use the temporary bridge.

THE COMMONWEALTH OF MASSACHUSETTS  
MASSACHUSETTS DEPARTMENT OF TRANSPORTATION  
HIGHWAY DIVISION

FEDERAL AID PROJECT

Williamstown, MA  
Bridge Replacement W-37-010, Main Street over Hemlock Brook  
Project File No. 609072

This sheet is provided for your comments. Your input is solicited and appreciated. You may e-mail comments directly to [DOTHighwayDesign@dot.state.ma.us](mailto:DOTHighwayDesign@dot.state.ma.us) or you may mail this sheet with any additional comments to:

Carrie E. Lavallee, P.E., Chief Engineer  
MassDOT – Highway Division  
10 Park Plaza, Boston, MA 02116-3973  
Attn: Highway Design

Statements and exhibits intended for inclusion in the public hearing transcript must be emailed or postmarked no later than ten (10) business days after the hearing.

**PLEASE TYPE OR PRINT LEGIBLY.**

---

---

---

---

---

---

---

---

---

---

Name: \_\_\_\_\_ Title: \_\_\_\_\_

Organization: \_\_\_\_\_

Address: \_\_\_\_\_

---



Please Fold and Tape

-----

\_\_\_\_\_  
\_\_\_\_\_  
\_\_\_\_\_

Please Place  
Appropriate  
Postage Here

Carrie E. Lavallee, P.E.  
Chief Engineer  
MassDOT – Highway Division  
10 Park Plaza  
Boston, MA 02116-3973

RE: Virtual Public Hearing  
Bridge Replacement W-37-010, Main Street over Hemlock Brook  
WILLIAMSTOWN, MA  
Project File No. 609072  
Attn: Highway Design

-----