



Perry Hill Rd Ext over North Branch Manhan River

Bridge Replacement

Town of Westhampton / January 31st, 2023 6:30 pm

Project File No. 610768



Zoom Hearing Controls



- Ask a question and share comments



- Raise your hand - *9 for users dialing in and Alt + Y to raise your hand



- If you are unable to access the internet or are having technical problems, please call into the meeting at [1-646-876-9923], Webinar ID: 899 5207 2358



Live Transcript

- Closed captioning automatically generated by Zoom



If you have trouble with the meeting technology during the presentation, please call:

[1-888-799-9666]

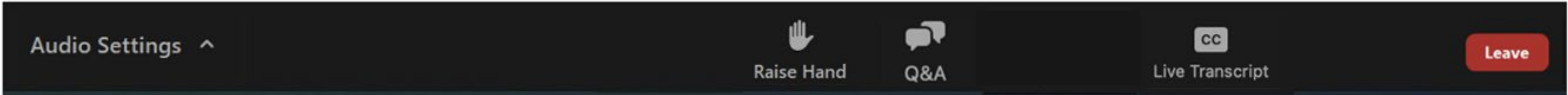

Public Hearing Notes and Procedures

Public record

- While this virtual public hearing is not being recorded, MassDOT may choose to retain and distribute the images, audio and the Q&A transcript from this hearing.
- All parts of this hearing are considered public record.
- If you are not comfortable being recorded, please refrain from using the Q&A feature or you may choose to excuse yourself from the hearing. Information from this hearing will be posted on the Mass.gov website.

Important notes

- Your microphone and webcam are automatically disabled upon entering the hearing.
- This hearing will be open to questions and answers at the end of the presentation.
- Please take time to respond to our survey at the end of the presentation. Your feedback is important.

Notice of MassDOT's policy on diversity and civil rights:

- All MassDOT activities, including public meetings, are free of discrimination.
- MassDOT complies with all federal and state civil rights requirements preventing discrimination based on sex, race, color, ancestry, national origin (limited English proficiency), religion, creed, gender, sexual orientation, gender identity or expression, or veteran's status.
- We welcome the diversity from across our entire service area. If you have any questions or concerns, please visit <https://www.mass.gov/nondiscrimination-in-transportation-program> to reach the Office of Diversity and Civil Rights.

Thank you for joining our meeting. We appreciate your participation!

Introduction

- **MassDOT Project Manager:** Harry Adolphe
- **MassDOT District Staff:** Paula K. Simmons
- **MassDOT Right of Way:** Zachary Feury
- **VPI Producer/Facilitator:** Olaoye Adetoyin & Raissah Kouame
- **Stenographer:** Greg Tarbox
- **Design Consultant Project Manager:** Jeff Lewis, P.E.
- **Town of Westhampton:** Bill Jablonski & Douglas Finn

Agenda

- 1 Project Location
- 2 How did we get here?
- 3 Why was this project Initiated?
- 4 What do we want to accomplish?
- 5 What alternatives were considered?
- 6 What is the preferred alternative?
- 7 How will your property be impacted?
- 8 How will bicyclists and pedestrians be impacted?
- 9 What are the environmental, cultural resource and community impacts?
- 10 What is the construction approach?
- 11 How will the road user be affected?
- 12 Our next steps
- 13 How will we keep you informed?
- 14 Questions and Discussion

Public Outreach

Newspaper
Daily Hampshire Gazette

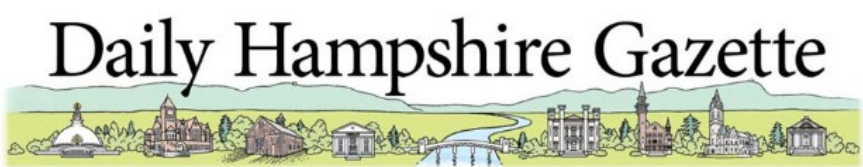

MassDOT Social Media
Facebook
Twitter



Thanks to the following for sending notice of this meeting:
Pioneer Valley Planning Commission
Stavros
Westhampton Disability Commission
Town of Westhampton

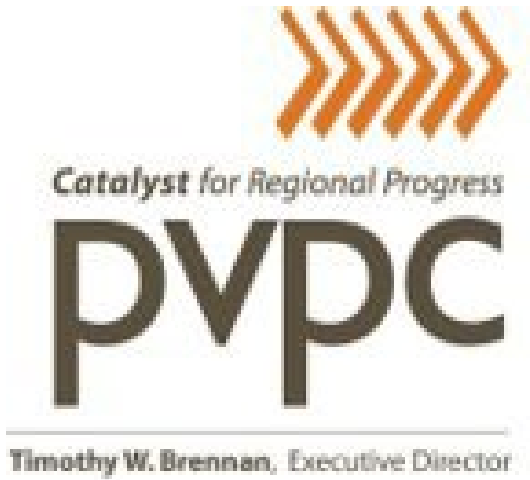

Project Location: Perry Hill Rd. Ext. over North Branch Manhan River



How did we get here?





**Why was this
project
initiated?**

Existing Issues

- **Structurally Deficient Bridge**
- **Substandard Bridge Rail and Approach Guard Railing**
- **Bridge Abutment Geometry not Aligned with Edge of River**

Looking North Across the Bridge -
Missing and Outdated Guardrail



Scour Void Along the Base of the
North Abutment



**Westerly Elevation:
Erosion & Collapse of NW Wingwall &
Embankment – Upstream Side**



**Southeast Corner:
Full Height Crack along Southerly
Abutment – Downstream Side**



Substandard Bridge Rail across Bridge



Deteriorating Bridge Beams at South Abutment





**What do we
want to
accomplish?**

Project Scope

- **Replace Structurally Deficient Bridge Deck and Beams**
- **Replace Bridge Abutments and Realign Geometry with Riverbanks**
- **Widen New Roadway Width to Improve Safety**
- **Add Railing to Bridge and Guardrail Roadway**

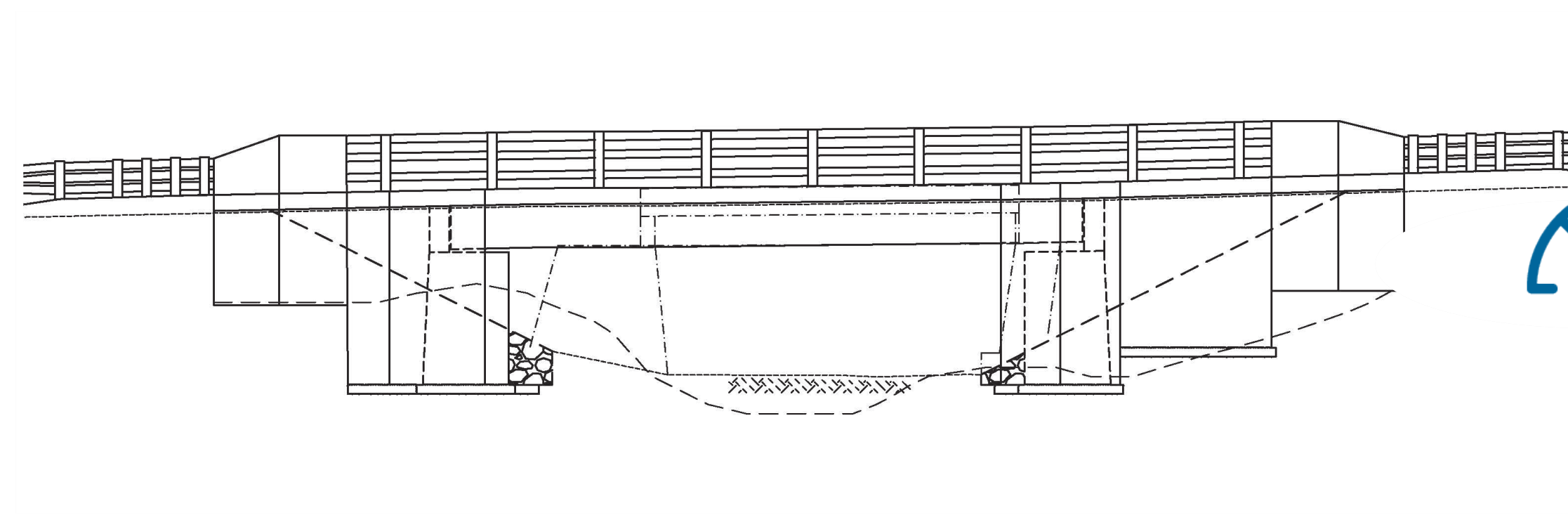

**What
alternatives
were
considered?**

Alternatives

- **No-Build alternative will further compromise the structural integrity of the bridge**
- **Option 1:** Adjacent Precast Prestressed Concrete Deck Beams or Precast Prestressed NEXT D Beams
- **Option 2:** Steel Rolled Stringers
- **Option 3:** Three-Sided Precast Concrete Culvert on cast-in-place concrete footing

Option 1: Adjacent Precast Prestressed Concrete Next Beams

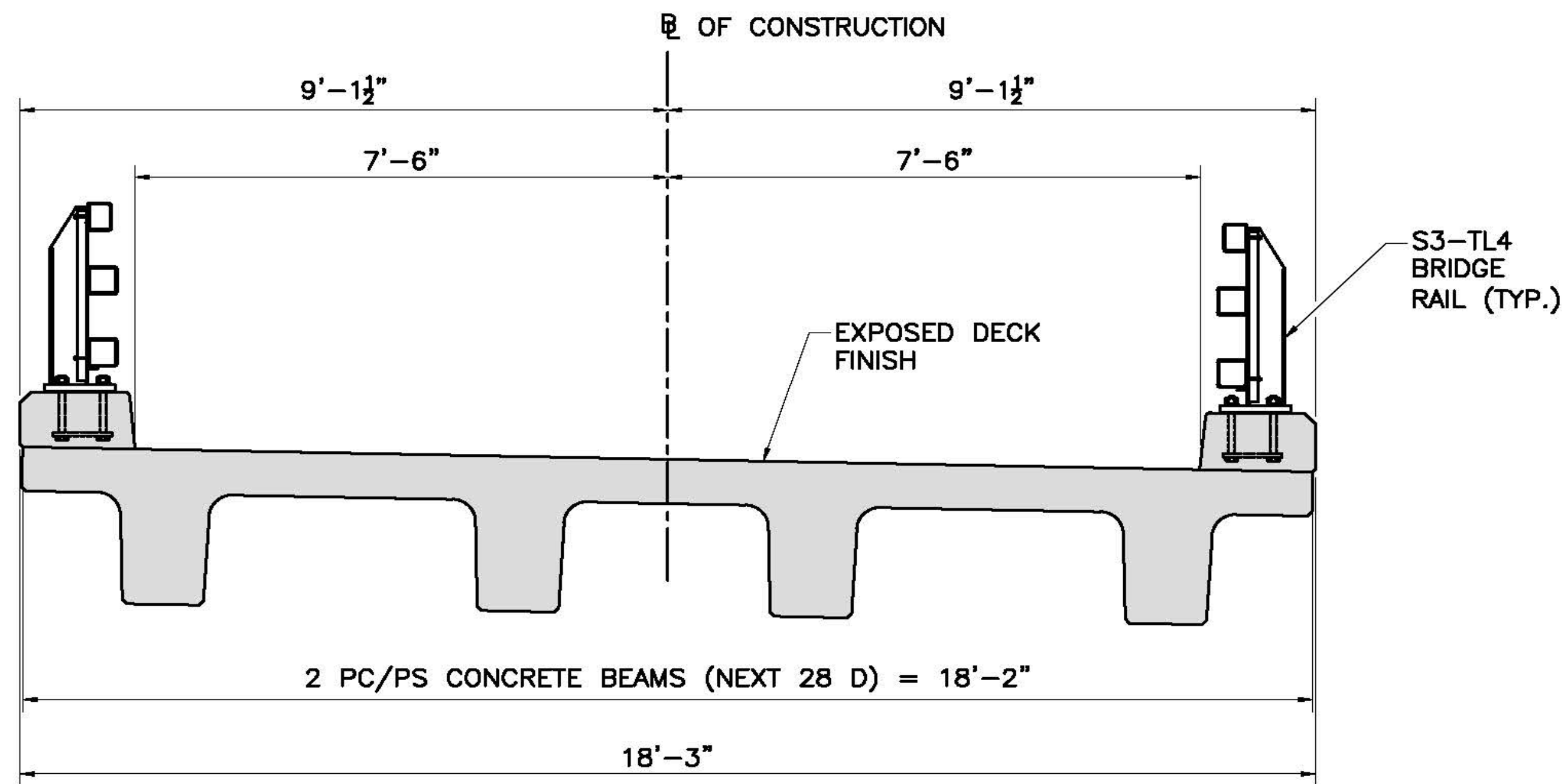

Option 2: Steel Rolled Stringers

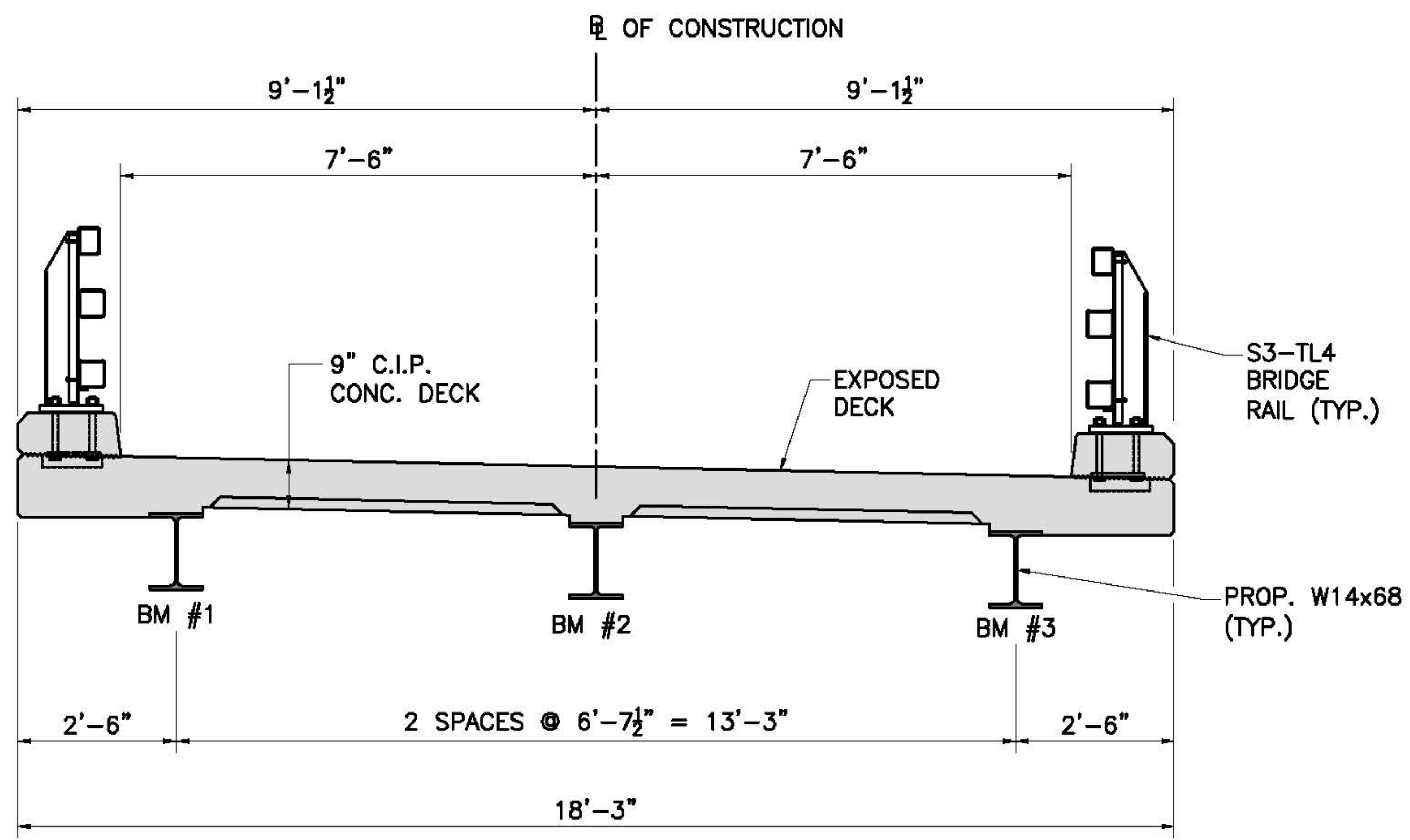

Option 3: Three-Sided Precast Concrete Culvert

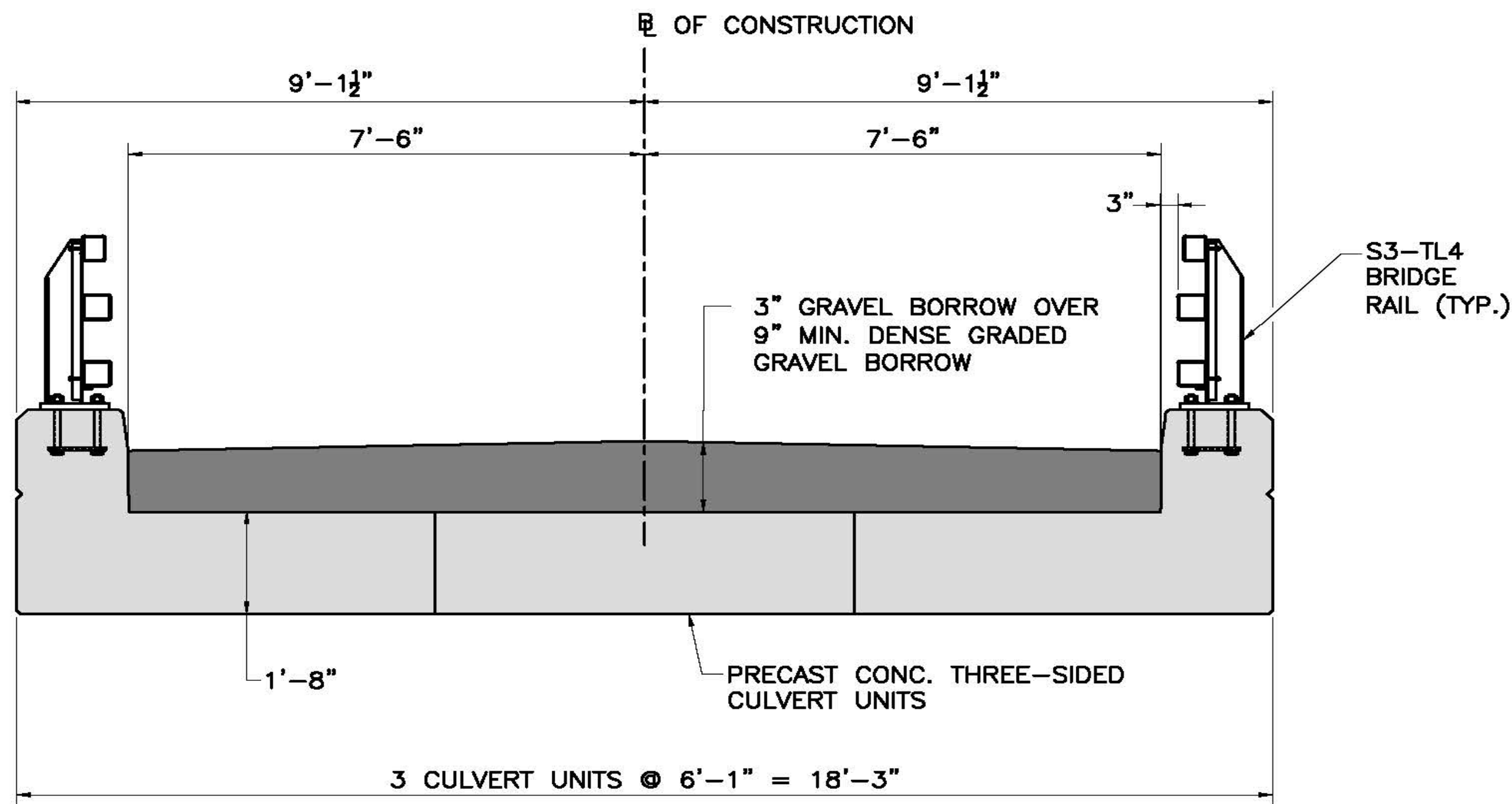



**What is the
preferred
alternative?**

Preferred Alternative: Option 3 - Three-Sided Precast Concrete Culvert

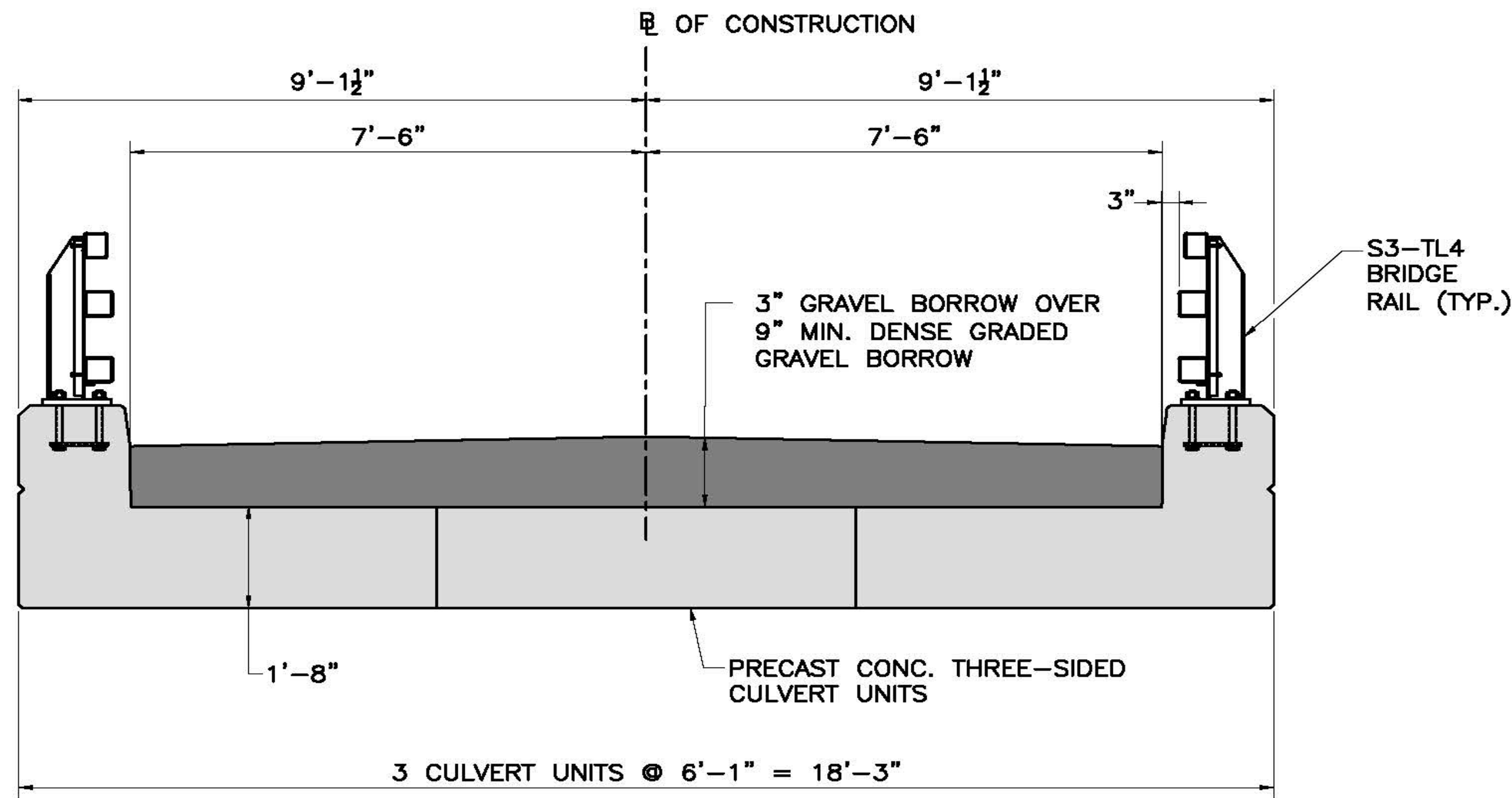

Proposed 25% Highway Plan

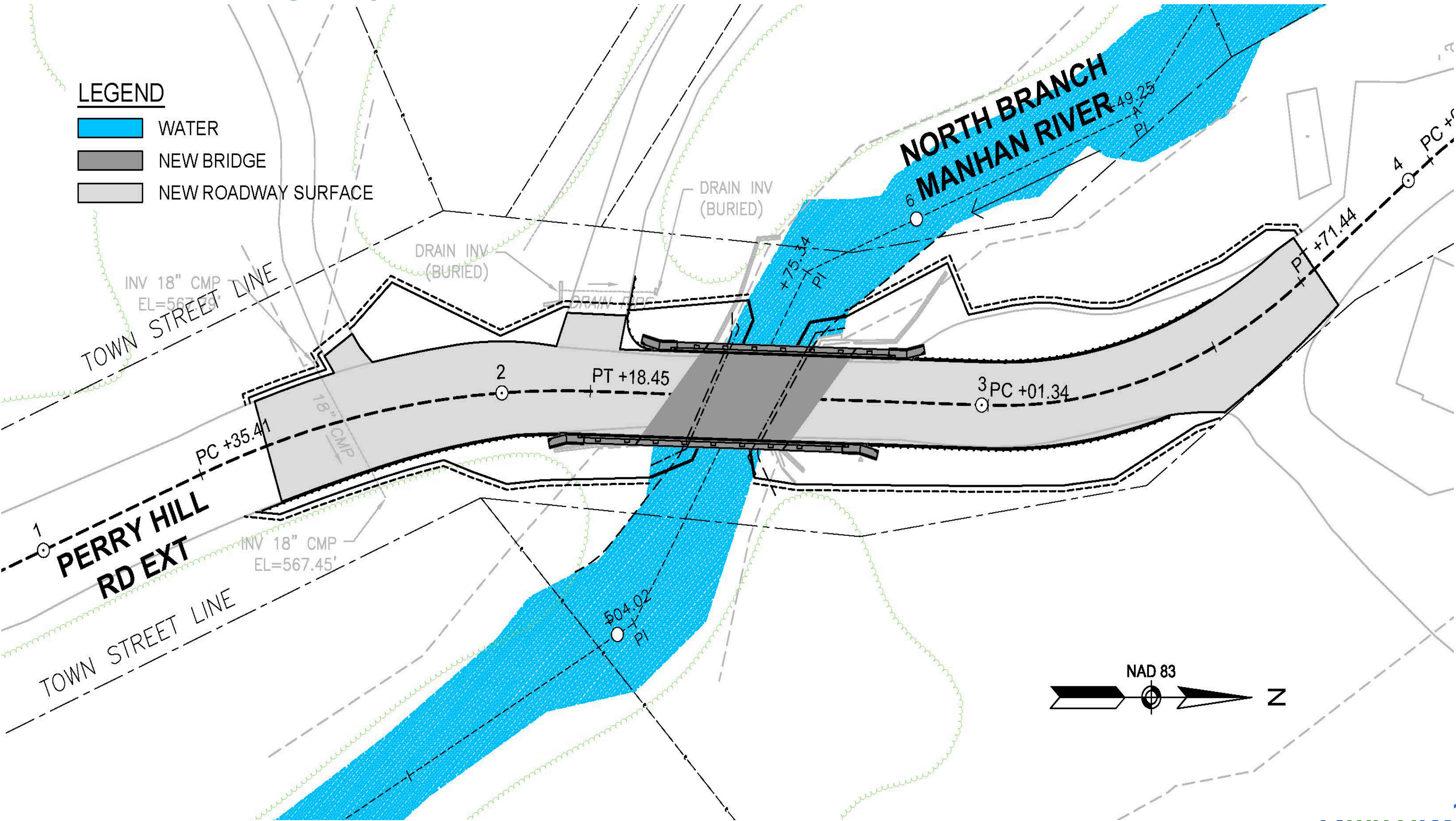

Typical Approach Roadway Section

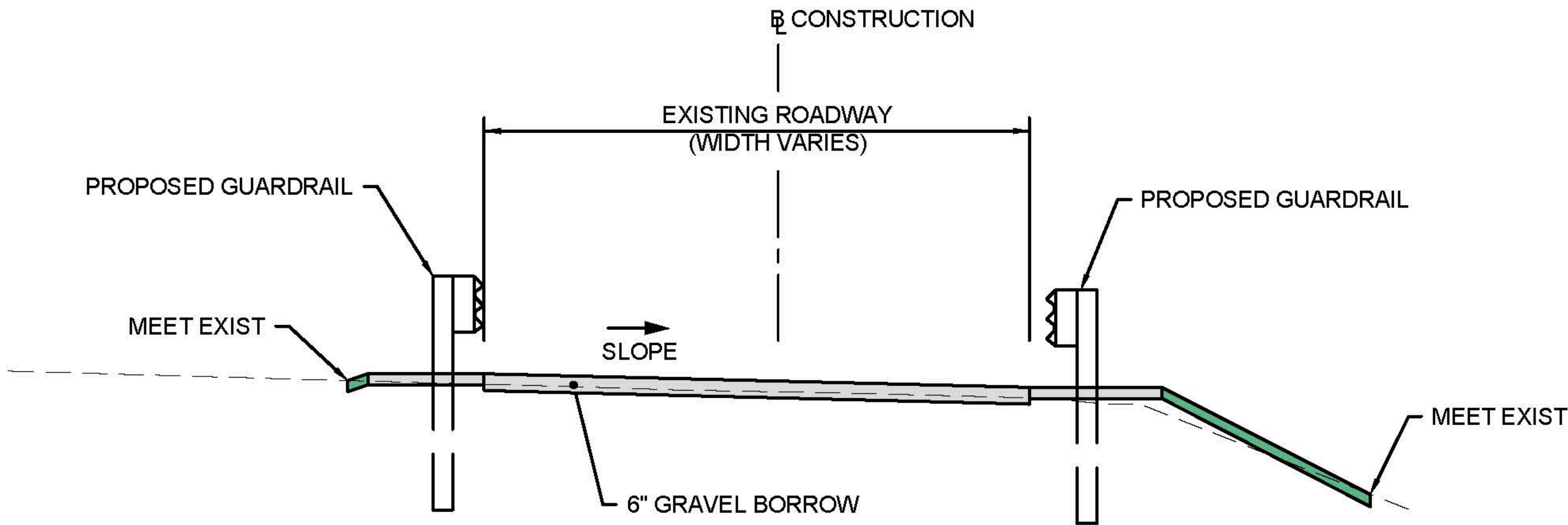

TYPICAL GRAVEL ROADWAY SECTION
PERRY HILL ROAD EXTENSION (WITH GUARDRAIL)



Bridge Location

Kings Highway

Perry Hill Rd. Ext.



**How will your
property be
impacted?**

25% Right-of-Way Plan

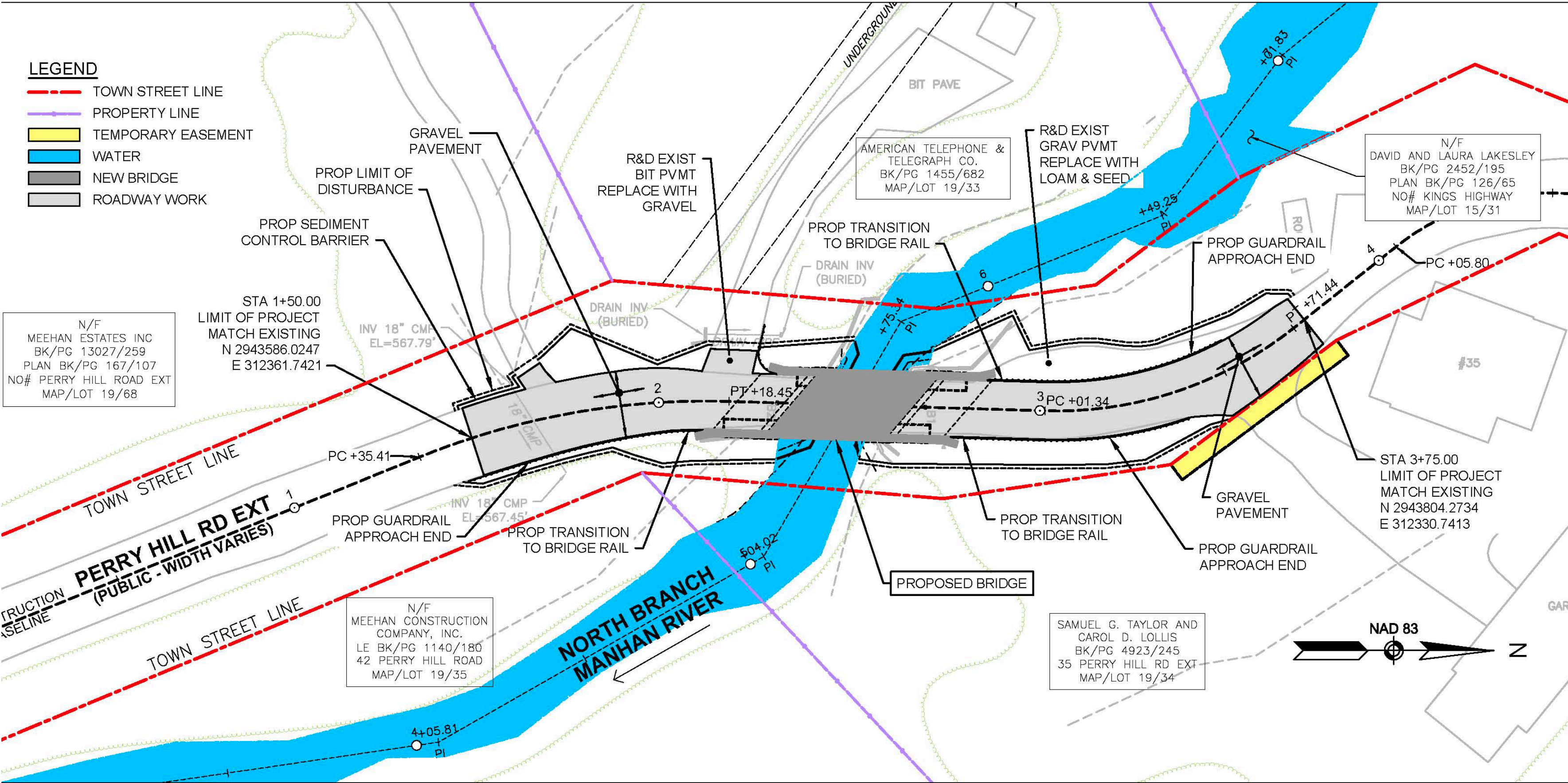

Right of Way (ROW) – General

- **Responsible for acquiring all necessary rights in public land for design, construction, and implementation of a project.**
- **Affected property owners will be contacted by personnel from the Town of Westhampton.**
- **Procedures must comply with state and federal regulations governing the acquisition process.**
 - **Property owners are protected under Massachusetts General Laws, primarily Chapter 79.**
 - **If project receives federal funds, property owners are further protected under Title III of the Real Property Act of 1970, as amended.**
- **Only temporary easements will be required. Fee takings will not be required.**
- **The temporary construction easement will be required to blend the new work into the existing driveway.**



**How will
bicyclists and
pedestrians
be impacted?**

Bicyclists and Pedestrian Impacts

- **During Bridge and Roadway Construction – Complete Bridge Closure. No Bicyclists or Pedestrians will cross the bridge during construction.**
- **The roadway will be widened slightly within Project Area which will allow more room for bikes and vehicles.**



**What are the
environmental,
cultural
resource, and
community
impacts?**

Environmental Impact and Permitting

- **National Historic Preservation Act 1966 (Section 106) - No known Cultural or Historic Resources**
- **The project will require the following permitting within the Clean Water Act:**
 - **Section 401 – Water Quality Certification**
 - **Section 404 – Army Corps of Engineers**
- **National Environmental Policy Act (NEPA)**
 - **Categorical Exclusion (CE) Class of Action**
- **Use of Best Management Practice (BMP)**
 - **Sediment Control Barrier**
 - **Shielding under the bridge during demolition**



**What is the
construction
approach?**

Proposed construction approach: Design-Bid-Build

- Estimated 8 month Construction Time
- Set up Traffic Control for Detour Route and Complete Bridge Closure
- Demolish Existing Bridge
- Construct two new Footings, Earth support or sheeting will be used to support the excavation during the construction of the abutments and wingwalls
- Erect and Place Precast Culvert sections. Construct Approach Wingwalls and Guardrail Transitions.
- Install Bridge Railing and Approach Guardrail
- Prepare Approach Roadway Work
- Install Gravel Roadway Surface over Culvert Roof Slab and Approaches.
- Open Bridge to Traffic



**How will the
road user be
affected?**

Traffic Impacts

- **During Bridge and Roadway Construction – Complete Bridge Closure. Detour to King's Highway**
- **Detour has limited impact on Perry Hill Road Ext. users.**

Traffic Detour

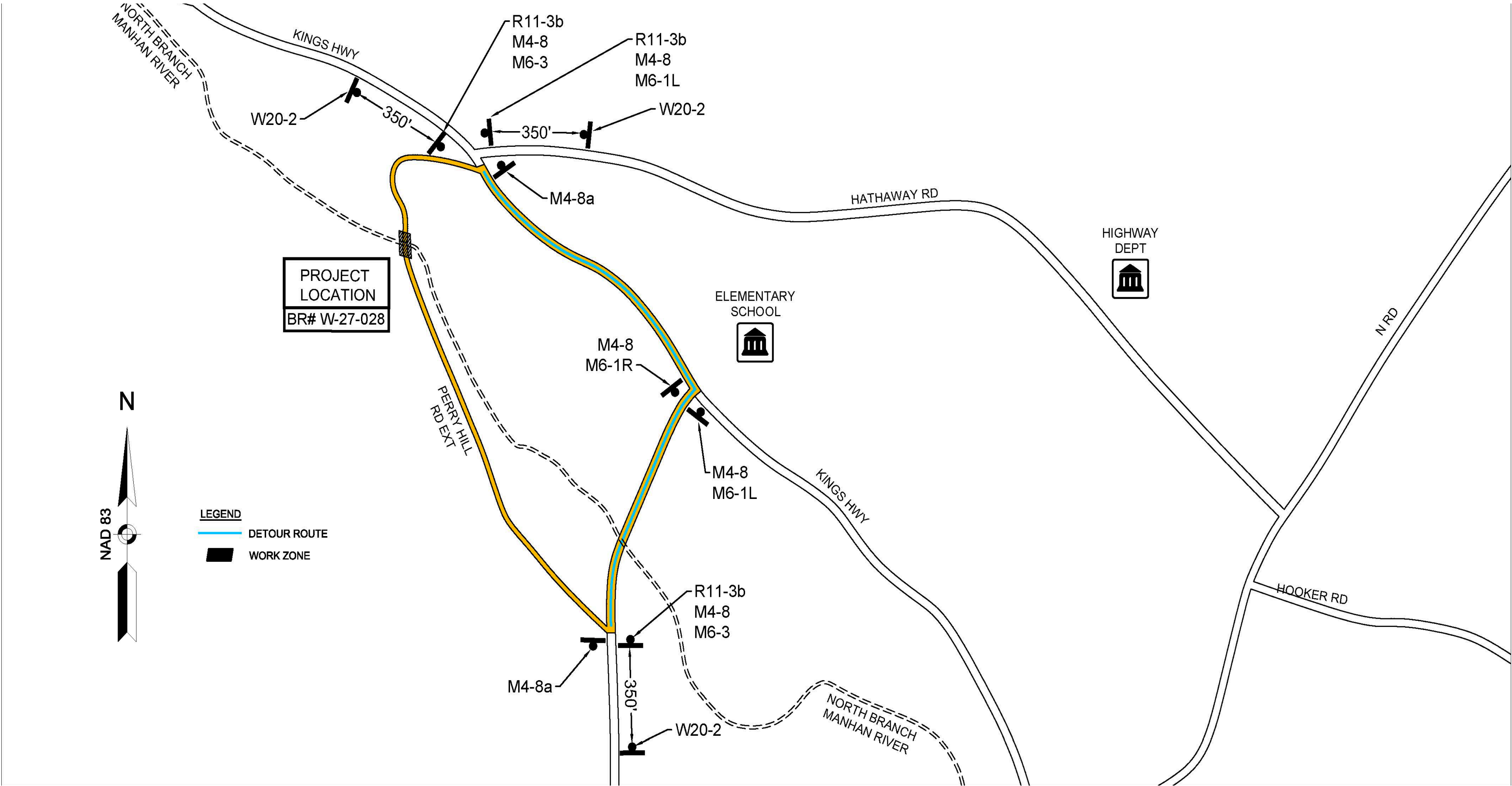



**Receive, Review,
Evaluate &
Incorporate
Public Input**



**Advance to the
75% and
Acquiring
Environmental
Permitting**



**100% and
PS&E Design
Stages**



**Advertise the
Project for
Construction.
Tentative
Advertising Date
in December 2024**



**Construct the
Project. Tentative
Start of Construction
in Summer 2025**



**How will we
keep you
informed**

Contact Information

- Email comments directly to MassDOT (preferred)
 - MassDOTprojectmanagement@state.ma.us
 - Subject Line: Public Hearing Comments: Project File No. 610768
- Website address (Project Handout Form)
 - www.mass.gov/MassDOT-highway-design-public-hearings
- Mail comments to MassDOT
 - Include last page of handout (can also be found at website above)
 - Comments must be postmarked within 10 days of when webinar was published for inclusion in public hearing transcript
 - Mail to: Carrie Lavallee, P.E.
Chief Engineer MassDOT
Attn: Project Management
Project File 610768
10 Park Plaza
Boston, MA 02116

SCAN ME





Questions and discussion

Questions and Answers



- “Raise your hand” to be unmuted for verbal questions (Alt + Y if using a phone)



- Submit your questions and comments using the Q&A button



- Please state your name before your question



- Please share only 1 question or comment at a time, limited to 2 minutes, to allow others to participate



- To ask a question via phone, dial *9 and the moderator will call out the last 4-digits of your phone number and unmute your audio when it is your turn



- Please take a few minutes to complete the survey after the meeting to let us know how your experience was with this virtual meeting

All questions and comments are subject to disclosure for public records. Please use these functions for project related business only.



Thank You

Perry Hill Rd. Ext. over North Branch Manhan River

Town of Westhampton - January 31st, 2023 - 6:30 pm

Project File No. 610768

Project Manager Contact- See Handouts

