



VIRTUAL DESIGN PUBLIC HEARING

JANUARY 21, 2026

FOR THE PROPOSED

**Bridge Replacement Route 3 (NB & SB) over North River
Project No.607349
Bridge Nos N-24-004/P-05-008
Major Projects**

IN NORWELL, PEMBROKE AND MARSHFIELD, MASSACHUSETTS

**COMMONWEALTH OF MASSACHUSETTS
MASSACHUSETTS DEPARTMENT OF TRANSPORTATION
HIGHWAY DIVISION**

**JONATHAN GULLIVER
HIGHWAY ADMINISTRATOR**

**CARRIE E. LAVALLEE, P.E.
CHIEF ENGINEER**

**THE COMMONWEALTH OF MASSACHUSETTS
MASSACHUSETTS DEPARTMENT OF TRANSPORTATION – HIGHWAY DIVISION
NOTICE OF A VIRTUAL DESIGN PUBLIC HEARING**

**Project Description: Norwell – Pembroke – Marshfield: Bridge Replacement N-24-004=P-05-008 Route 3
(NB & SB) over North River**

Project File No. 607349

A Virtual Design Public Hearing will be hosted on the MassDOT website below to present the design for the proposed project in Norwell, Pembroke and Marshfield, MA.

WHEN: 7:00 PM, Wednesday, January 21st, 2026

PURPOSE: The purpose of this hearing is to provide the public with the opportunity to become fully acquainted with the proposed project. All views and comments submitted in response to the hearing will be reviewed and considered to the maximum extent possible.

PROPOSAL: The proposed project consists of replacing the northbound and southbound bridges along Route 3 NB/SB over the North River and to provide associated roadway improvements through the towns of Norwell, Pembroke, and Marshfield. To maintain traffic during construction the proposed SB bridge will be located in the existing median and the proposed NB bridge will be in the same location as the existing NB bridge. Once complete the bridges will accommodate 2–12-foot lanes in each direction and 18’ inside and 14’ outside shoulders. Due to the roadway classification of Route 3 bicycle and pedestrian accommodations are not applicable

A secure right-of-way is necessary for this project. Acquisitions in fee and permanent or temporary easements may be required. The Commonwealth of Massachusetts is responsible for acquiring all needed rights in private or public lands. MassDOT’s policy concerning land acquisitions will be presented in the hearing.

Project inquiries, written statements and other exhibits regarding the proposed undertaking may be submitted to Carrie E. Lavallee, P.E., Chief Engineer, via e-mail to massdotmajorprojects@dot.state.ma.us or via US Mail to Suite 7210, 10 Park Plaza, Boston, MA 02116, Attention: Major Projects, Project File No. 607349. Statements and exhibits intended for inclusion in the hearing transcript must be emailed or postmarked no later than ten (10) business days after the hearing is hosted.

This hearing is accessible to people with disabilities. MassDOT provides reasonable accommodations and/or language assistance free of charge upon request (e.g interpreters in American Sign Language and languages other than English, live captioning, videos, assistive listening devices and alternate material formats), as available. For accommodation or language assistance, please contact MassDOT’s Chief Diversity and Civil Rights Officer by phone (857-368-8580), TTD/TTY at (857) 266-0603, fax (857) 368-0602 or by email (MassDOT.CivilRights@dot.state.ma.us). Requests should be made as soon as possible and prior to the hearing, and for more difficult to arrange services including sign-language, CART or language translation or interpretation, requests should be made at least ten business days before the hearing.

This hearing will be hosted, or a cancellation announcement posted, on the internet at <https://www.mass.gov/orgs/highway-division/events>.

JONATHAN GULLIVER
HIGHWAY ADMINISTRATOR

CARRIE E. LAVALLEE, P.E.
CHIEF ENGINEER



Dear Concerned Citizen:

The Massachusetts Department of Transportation (MassDOT) is committed to building and maintaining a transportation infrastructure that is both safe and efficient for all who use our roadways, bridges, bicycle facilities and pedestrian paths, while maintaining the integrity of the environment.

As part of the design process for this project, we are conducting this public hearing to explain the proposed improvements, listen to your comments and answer any questions you may have. At the conclusion of the hearing, MassDOT will review all of your comments and, where feasible, incorporate them into the design of the project.

We recognize that road and bridge construction can create inconveniences for the public. MassDOT places a great deal of emphasis on minimizing the temporary disruptive effects of construction.

MassDOT encourages input from local communities and values your opinions. Please be assured that we will undertake no project without addressing the concerns of the community.

Sincerely,

Carrie E. Lavallee, P.E.
Chief Engineer

WHAT IS A PUBLIC HEARING?

WHY A PUBLIC HEARING?

To provide an assured method whereby the Commonwealth of Massachusetts can furnish to the public information concerning the State's highway construction proposals, and to afford every interested resident of the area an opportunity to be heard on any proposed project. At the same time, the hearings afford the Commonwealth an additional opportunity to receive information from local sources which would be of value to the State in making its final decisions to what design should be advanced for development.

WHY NOT A VOTE ON HIGHWAY PLANS?

The hearings are not intended to be a popular referendum for the purpose of determining the nature of a proposed improvement by a majority of those present. They do not relieve the duly constituted officials of a State highway department of the necessity for making decisions in State highway matters for which they are charged with full responsibility.

WHAT DOES A PUBLIC HEARING ACCOMPLISH?

It is designed to ensure the opportunity for, or the availability of, a forum to provide factual information which is pertinent to the determination of the final alternative considered by the state to best serve the public interest, and on which improvement projects are proposed to be undertaken.

It is important that the people of the area express their views in regard to the proposal being presented, so that views can be properly recorded in the minutes of the meeting. These minutes will be carefully studied and taken into consideration in the determination of the final design.

RIGHT OF WAY CONCERNS

The State is responsible for securing the Right of Way for this project. If your property, or a portion of it, must be acquired by the State for highway purposes in the interest of all people of the Commonwealth, your rights are fully protected under the law. Briefly, here are some of the answers to questions you might ask.

1. WHO CONTACTS ME?

Representatives of the Right of Way Bureau of the Massachusetts Department of Transportation's Highway Division. They will explain the impacts and your rights as protected under Massachusetts General Laws Chapter 79.

2. WHAT IS A FAIR PRICE FOR MY PROPERTY?

Every offer is made to ensure that an equitable value is awarded to you for the property, or to appraise the "damage" to the property as a result of the acquisition. MassDOT appraisers, independent appraisers, MassDOT "Review Appraisers" and a Real Estate Appraisal Review Board may all contribute in arriving at an award of damages. The State also pays a proportionate part of the real estate tax for the current year for fee takings, and interest from the date the property is acquired to the payment date, on all impacts.

3. MUST I ACCEPT THE DEPARTMENT'S OFFER?

No. If, after the figure established as market value has been offered to the owner, the owner feels he or she is not being offered a fair price, he or she has the right, within three years, to appeal to the courts. Pending a court decision, he or she can be paid on a "pro-tanto" basis (or "for the time being") that in no way prejudices the court appeal.

4. WHAT WILL HAPPEN TO MY HOUSE?

The owner will have the opportunity to buy back his or her house, provided he or she has a location to which it can be moved, and the proper permits for its removal. If the owner does not wish to repurchase, the house will be advertised for bids. The highest bidder, who must also have a location and permits for removal, will be awarded the house. Otherwise, the structure will be slated for demolition.

5. WHAT HAPPENS IF I MUST RELOCATE?

In addition to the market value of the property, the Department pays certain relocation benefits for both owners and tenants of acquired residences and businesses who meet eligibility requirements. Assistance in relocation is also provided. Department brochures are available for details on these benefits.

MASSACHUSETTS DEPARTMENT OF TRANSPORTATION HIGHWAY DIVISION

PLAN AND PROFILE OF

ROUTE 3 OVER THE NORTH RIVER

(BRIDGE NO. N-24-004=P-05-008 (XXX, XXX))

IN THE TOWN OF

NORWELL/PEMBROKE/MARSHFIELD

PLYMOUTH COUNTY

FEDERAL AID PROJECT NO. -

25% SUBMITTAL

INDEX

SHEET NO.	DESCRIPTION
1	TITLE SHEET & INDEX
2	LEGEND & ABBREVIATIONS
3	GENERAL NOTES
4	KEY PLAN
5-7	TYPICAL SECTIONS
8	BASELINE AND ALIGNMENT PLAN
9-19	CONSTRUCTION PLANS
20-30	PROFILES
31-41	DRAINAGE AND UTILITY PLANS
42-44	CONSTRUCTION DETAILS
45	WETLAND REPLICATION AND LANDSCAPE PLANS - GENERAL NOTES & LEGEND
46-51	WETLAND IMPACT AND LANDSCAPE PLANS
52-55	WETLAND REPLICATION PLANS
56	WETLAND REPLICATION AND LANDSCAPE DETAILS
57-66	PAVEMENT MARKING AND SIGNING PLANS
67	RT 3 NB TEMPORARY Crossover TYPICAL SECTIONS
68-78	RT 3 NB TEMPORARY Crossover CONSTRUCTION PLANS
79-84	RT 3 NB TEMPORARY Crossover PROFILES
85	TEMPORARY TRAFFIC CONTROL PLANS - GENERAL NOTES AND DETAILS
86-87	TEMPORARY TRAFFIC CONTROL PLANS - OVERALL PHASING
88-98	TEMPORARY TRAFFIC CONTROL PLANS - PHASE 1
99-108	TEMPORARY TRAFFIC CONTROL PLANS - PHASE 2
109-119	TEMPORARY TRAFFIC CONTROL PLANS - PHASE 3
120-128	TEMPORARY TRAFFIC CONTROL PLANS - PHASE 4
129	TEMPORARY TRAFFIC SIGN SUMMARY
130-169	CROSS SECTIONS

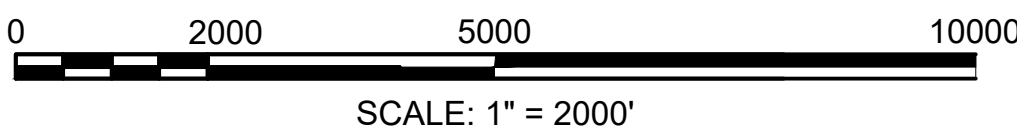
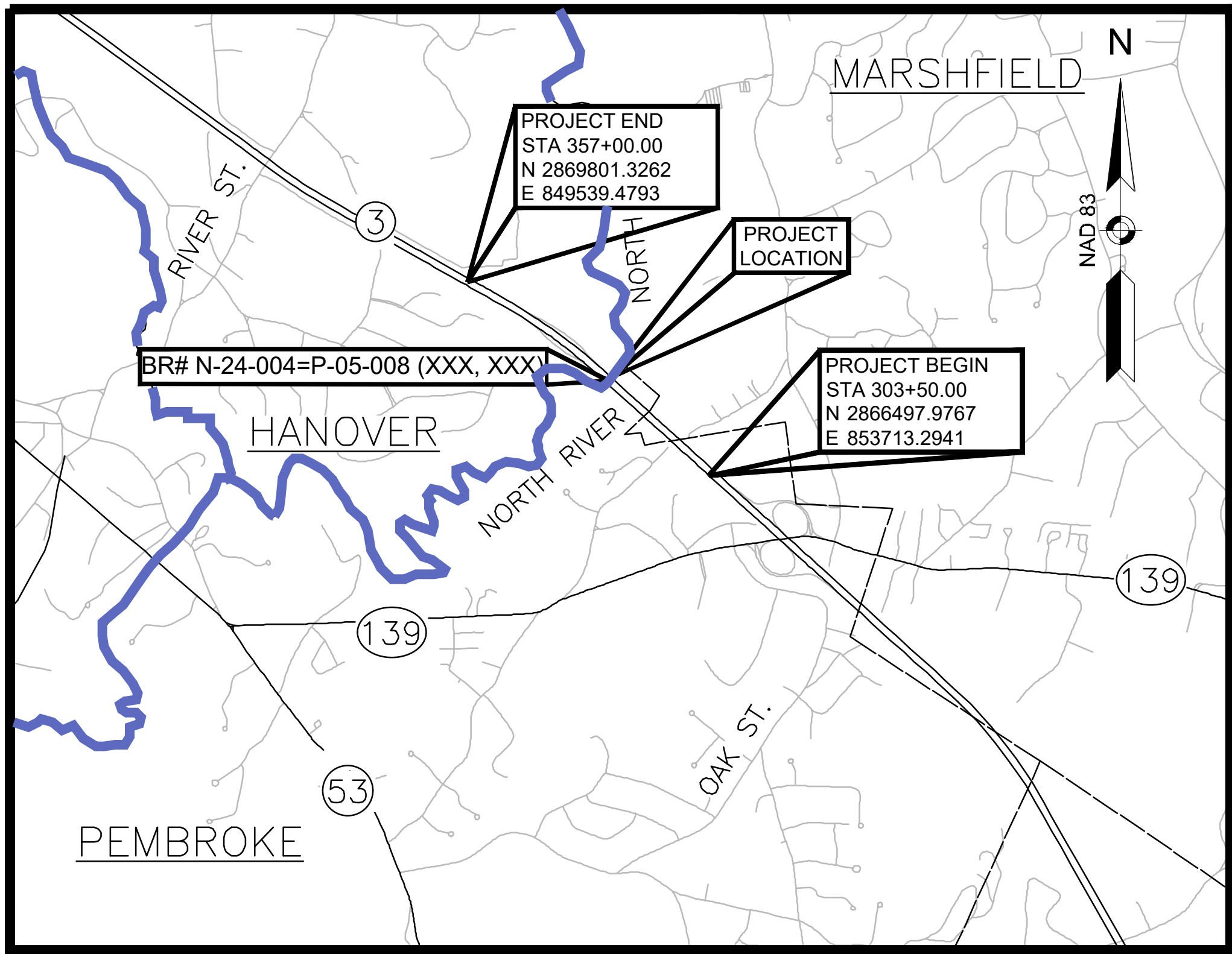

LENGTH OF PROJECT = 5,400 FEET = 1.02 MILES

NORWELL/PEMBROKE/MARSHFIELD

ROUTE 3 OVER THE NORTH RIVER

STATE	FED. AID PROJ. NO.	SHEET NO.	TOTAL SHEETS
MA	-	1	169
PROJECT FILE NO.		607349	

TITLE SHEET & INDEX

THESE PLANS ARE SUPPLEMENTED BY THE LATEST EDITIONS OF THE FOLLOWING PUBLICATIONS, AS IDENTIFIED IN THE CONTRACT SPECIAL PROVISIONS: THE MASSDOT CONSTRUCTION STANDARD DETAILS, THE MASSDOT STANDARD DRAWINGS FOR SIGNS AND SUPPORTS, THE MASSDOT STANDARD DRAWINGS FOR TRAFFIC SIGNALS AND HIGHWAY LIGHTING, THE MASSDOT OVERHEAD SIGNAL STRUCTURE AND FOUNDATION STANDARD DRAWINGS, THE MASSDOT TRAFFIC MANAGEMENT PLANS AND DETAIL DRAWINGS, AND THE ANSI AMERICAN STANDARD FOR NURSERY STOCK.

DESIGN DESIGNATION (ROUTE 3 OVER THE NORTH RIVER)

DESIGN SPEED	70 MPH			
	WEEKDAY		WEEKEND	
ADT (2024)	80,309		80,207	
ADT (2031)	83,162		83,057	
ADT (2044)	88,733		88,620	
K	8.6% (AM, NB DIRECTION)	9.2% (PM, SB DIRECTION)	7.0% (AM, NB DIRECTION)	7.3% (PM, SB DIRECTION)
D	64.5% (AM, NB DIRECTION)	60.6% (PM, SB DIRECTION)	51.7% (AM, NB DIRECTION)	50.4% (PM, SB DIRECTION)
T (PEAK HOUR)	1.8% (NB)	1.4% (SB)	1.0% (NB)	1.4% (SB)
T (AVERAGE DAY)	2.6% (NB)	3.1% (SB)	0.9% (NB)	1.4% (SB)
DHV	5,385 (AM)	6,067 (PM)	5,674 (AM)	5,528 (PM)
DDHV	3,473 (AM)	3,678 (PM)	2,932 (AM)	2,787 (PM)
FUNCTIONAL CLASSIFICATION	2, FREEWAY	2, FREEWAY	2, FREEWAY	2, FREEWAY

CS/ADA: There are no facilities for people walking or biking within the project limits. No further submissions to ADA or CS are required unless there is a major change to the Scope of Work or project limits prior to advertising.

AECOM

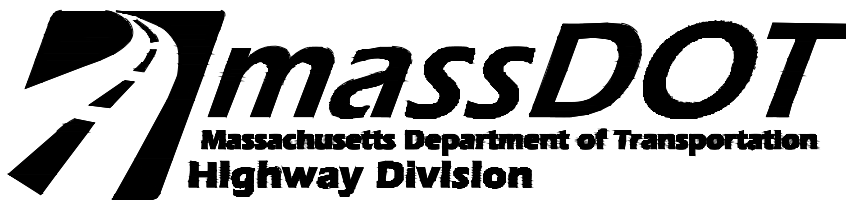

APPROVED

CHIEF ENGINEER

DATE

1.0 PROJECT OVERVIEW

The Massachusetts Department of Transportation, Highway Division (MassDOT) is undertaking a project to replace the structurally deficient bridges carrying Route 3 (NB & SB) over the North River in the towns of Norwell, Pembroke, and Marshfield, Massachusetts, with two new bridges designed for a 75-year design life. The Project will be known as Norwell, Pembroke, Marshfield Bridge Replacement, N-24-004=P-05-008, Route 3 (NB & SB) over North River, Design-Build Project No. 607349.

1.1 PROJECT AREA

The Project is in the towns of Norwell, Pembroke, and Marshfield, MA. The limits of the Project extend along Route 3 from just north of the route 139 interchange and extend to the north to approximately mile mark 28.2.

1.2 PROJECT SUMMARY

The Project is being advanced by MassDOT to replace the structurally deficient bridges on Route 3 (NB & SB) over the North River. The Proposed Project consists of constructing two new bridges within the same general footprint of the existing structures. The proposed replacement bridges will provide a 75-year design life and meet criteria established for the proposed bridges while minimizing impacts to the environment, right-of-way, and the traveling public. The proposed bridges are each single span structures that will provide the required hydraulic clearances. The proposed work includes removing the existing bridges while constructing new foundations, abutments, and superstructure elements.

The proposed bridges are to be constructed in the same general footprint as the existing bridges, the southbound bridge will be in the current median of route 3 to support construction stages while minimizing impacts to traffic. The northbound bridge will remain in its current location and alignment. Both bridges will be widened to provide adequate shoulder widths.

The proposed work includes limited roadway reconstruction at each approach, drainage improvements, and landscaping.

THE COMMONWEALTH OF MASSACHUSETTS
MASSACHUSETTS DEPARTMENT OF TRANSPORTATION
HIGHWAY DIVISION

FEDERAL AID PROJECT

Norwell, Pembroke and Marshfield, MA
Bridge Replacement, Route 3 over North River
Project File No. 607349

This sheet is provided for your comments. Your input is solicited and appreciated. You may e-mail comments directly to massdotmajorprojects@dot.state.ma.us or you may mail this sheet with any additional comments to:

Carrie E. Lavallee, P.E., Chief Engineer
MassDOT – Highway Division
10 Park Plaza, Boston, MA 02116-3973
Attn: Major Projects

Statements and exhibits intended for inclusion in the public hearing transcript must be emailed or postmarked no later than ten (10) business days after the hearing presentation.

PLEASE TYPE OR PRINT LEGIBLY.

Name: _____ Title: _____

Organization: _____

Address: _____

Please Fold and Tape



Please Place
Appropriate
Postage Here

Carrie E. Lavallee, P.E.
Chief Engineer
MassDOT – Highway Division
10 Park Plaza
Boston, MA 02116-3973

RE: Virtual Public Hearing
Bridge Replacement, Route 3 over North River
NORWELL, PEMBROKE, MARSHFIELD
Project File No. 607349
Attn: Major Projects

