

# Winthrop Shore Drive Improvements Project



## DCR Public Meeting

**Tuesday, October 25, 2016 - 6:30 p.m. – 8:00 p.m.**  
**Robert A. DeLeo Winthrop Senior Center – Winthrop, MA**



# Commonwealth of Massachusetts

Governor

**Charles D. Baker**

Lieutenant Governor

**Karyn E. Polito**

Energy and Environmental Affairs Secretary

**Matthew A. Beaton**

Department of Conservation and Recreation Commissioner

**Leo P. Roy**



## **DCR Mission Statement**

*To protect, promote and enhance our common wealth of natural, cultural and recreational resources for the well-being of all.*

## Purpose of Public Meeting

- Recap of June Meeting and presentation of final Winthrop Shore Drive design elements taking into consideration public comment received
- DCR presentation and public input on, proposed concept plans for work in the Winthrop Highlands
- General Q&A

## Project Goals – Winthrop Shore Drive

- Improve sidewalks and install sidewalk amenities at major entrances
- Reconstruct roadway
- Improve drainage/storm water management
- Improve accessibility
- Enhance ocean side lighting
- Create new Beach Road Gateway.



# Project Requirements – Winthrop Shore Drive

- Two-way traffic
- On-street parking
- Adequate width for Fire Department vehicles and truck traffic
- Emergency response route.



## Project Consultant Team

- **Parsons Brinckerhoff, Inc.** – *Lead Engineering Consultant*
- **Applied Coastal Research  
& Engineering Inc.** – *Coastal Engineers*
- **Pressley Associates, Inc.** - *Landscape Architects*



## What you told us

- Extend the sidewalk replacement to the corner of Grovers Ave.
- Use thermoplastic markings instead of paint for durability
- Don't have bump outs eliminating too much parking or making turns difficult
- Replace sidewalk, benches, seawall cap railing and fence in Highlands
- Use pedestrian lighting for increased visibility
- More green space
- Modify parking regulations



# Sidewalk Improvements and Amenities at Major Entrances

- Create an additional 24,000 SF of concrete sidewalks, increasing widths on the ocean side from the current 8' to either 11' or 15' (at bump-outs), and on residential side from 5' to 6'
- Install amenities at 5 major entrances – Coral St./Bathhouse, Pearl Ave\*, Cutler St., Sturgis St., Charles St.
  - 10 additional benches
  - 4 bicycle racks
  - 4 drinking fountains
  - 4 shower towers.

\* Pearl Ave. amenities were installed previously during Winthrop Beach Shore Protection project.



## Winthrop Shore Drive – Detail of Bump-Out



# Proposed Rendering of Winthrop Shore Drive



# Cross-Section: Winthrop Shore Drive Existing Section

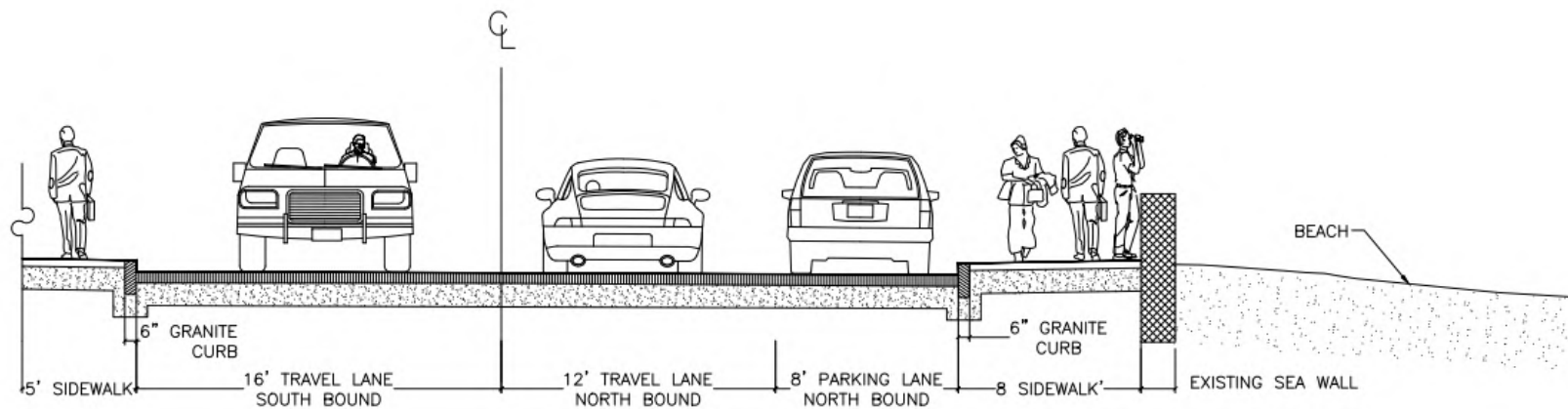

# Cross-Section: Winthrop Shore Drive Proposed Section

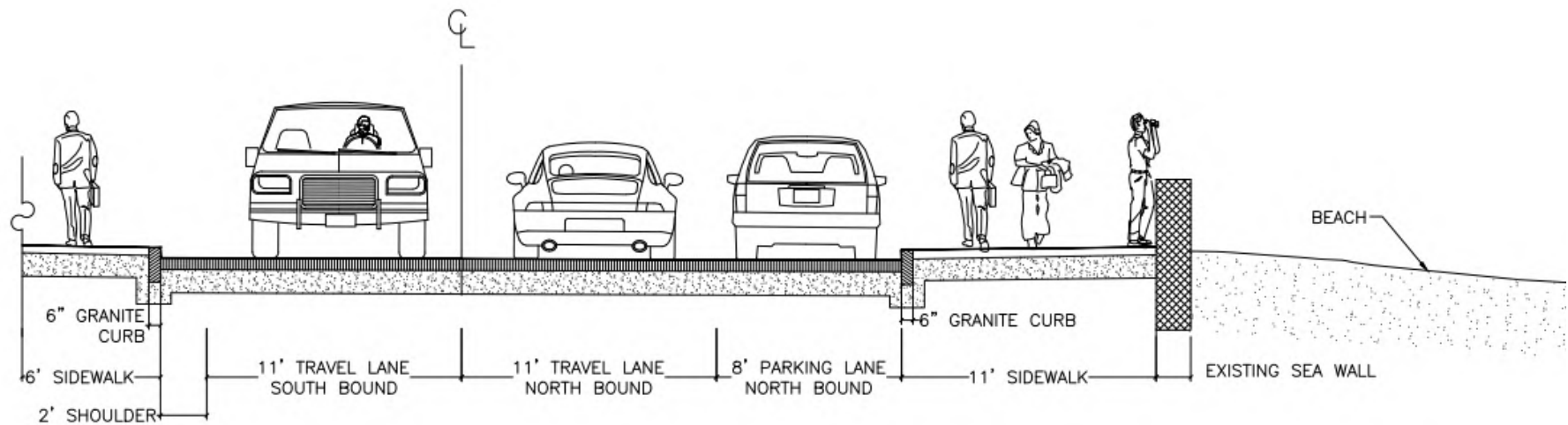

# Cross-Section: Winthrop Shore Drive – Proposed Section at Bump-Out

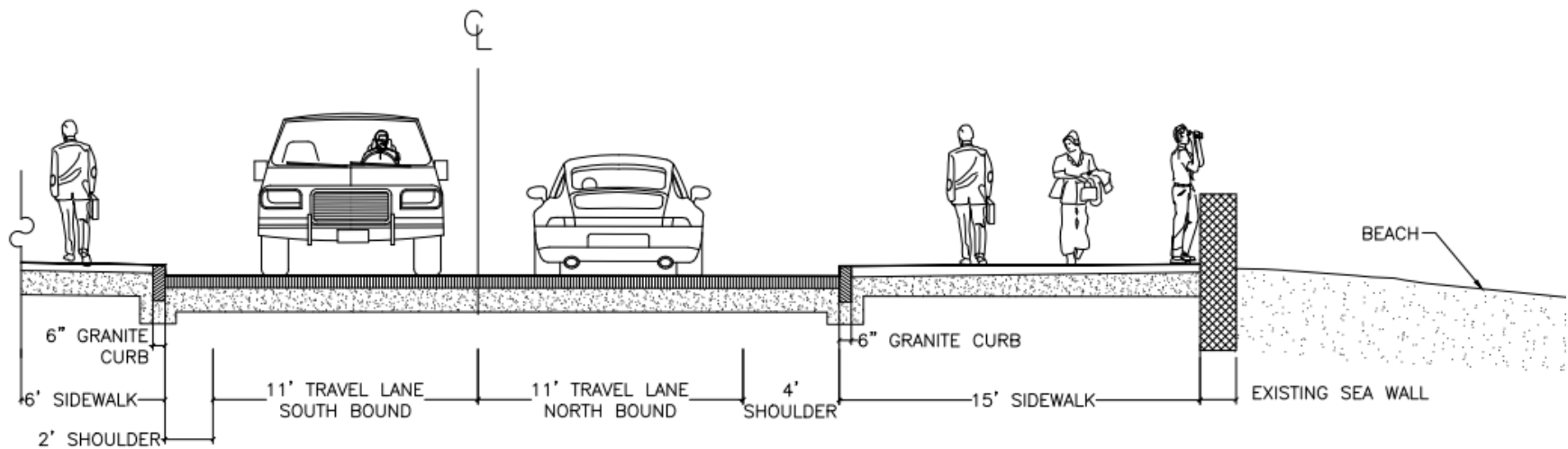



# Improved Drainage/Stormwater Management

- New Stormwater Management System
  - New catch basins
  - New water quality manholes
  - New stormwater infiltration system

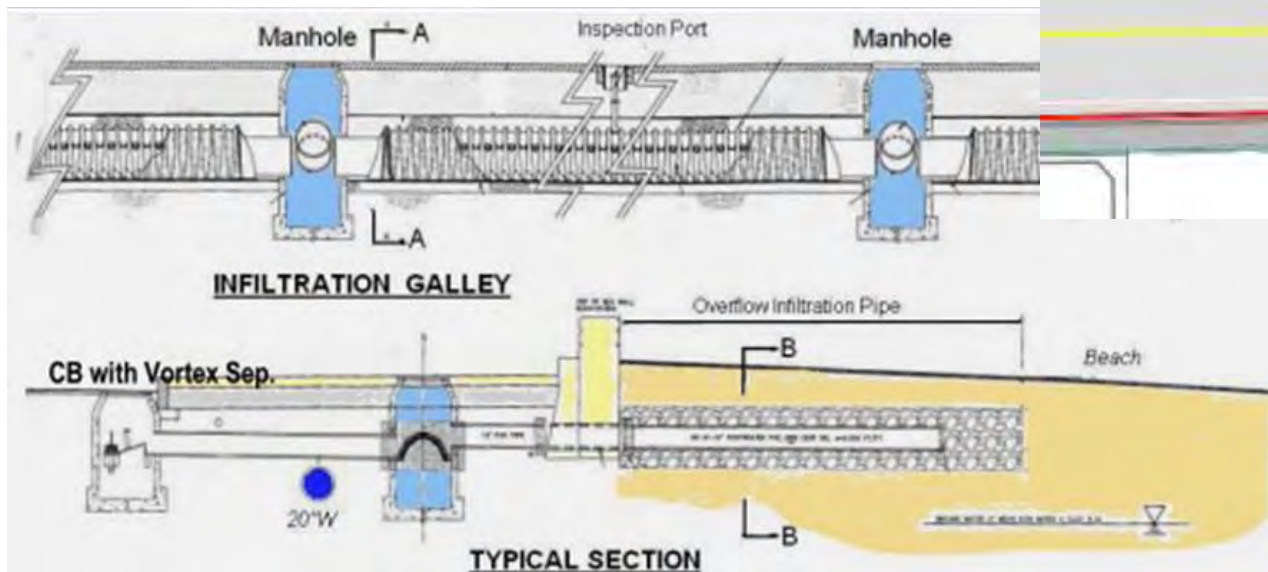
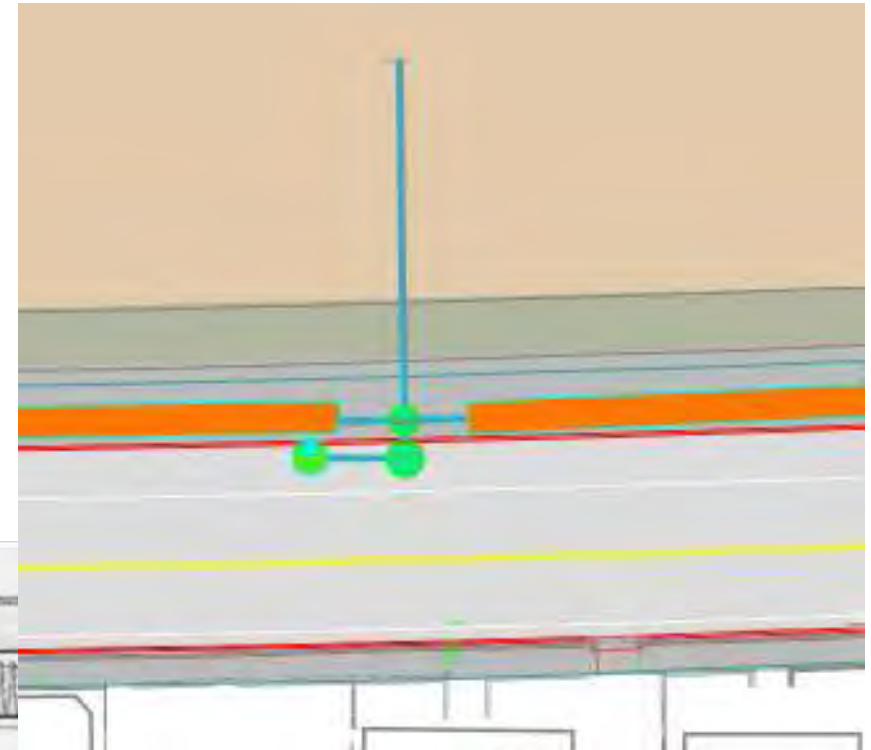

# New Beach Road Gateway

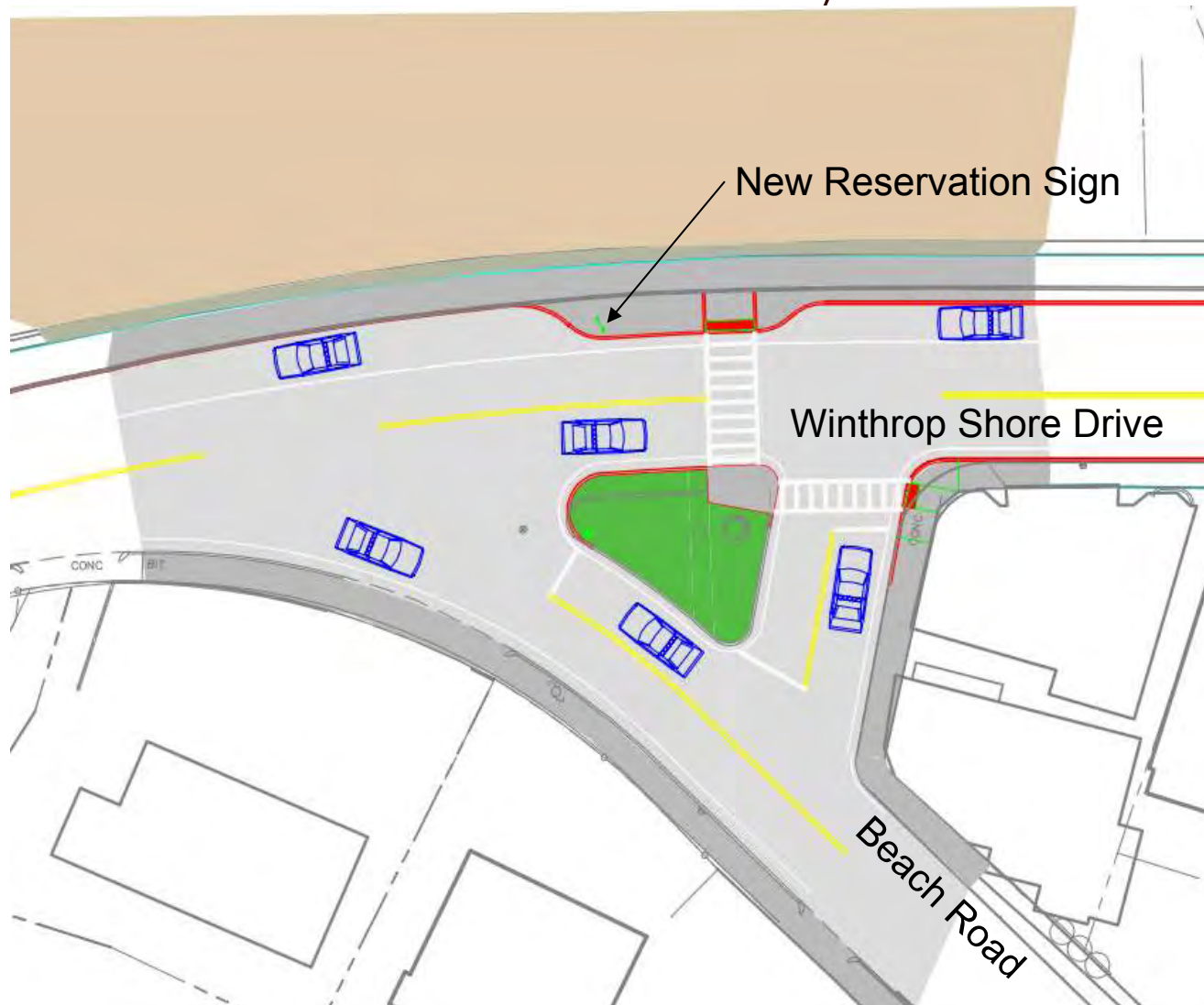



# Enhanced Ocean Side Lighting

## Enhance Ocean Side Lighting Options

Pendant  
Fixture –  
Nahant Beach



- Most recommendations from public
- Mimics historical fixture

Replace Aluminum Poles at North  
End with Historic Fixtures



## Railing on Winthrop Shore Drive

- Improves safety for children while not obstructing ocean views

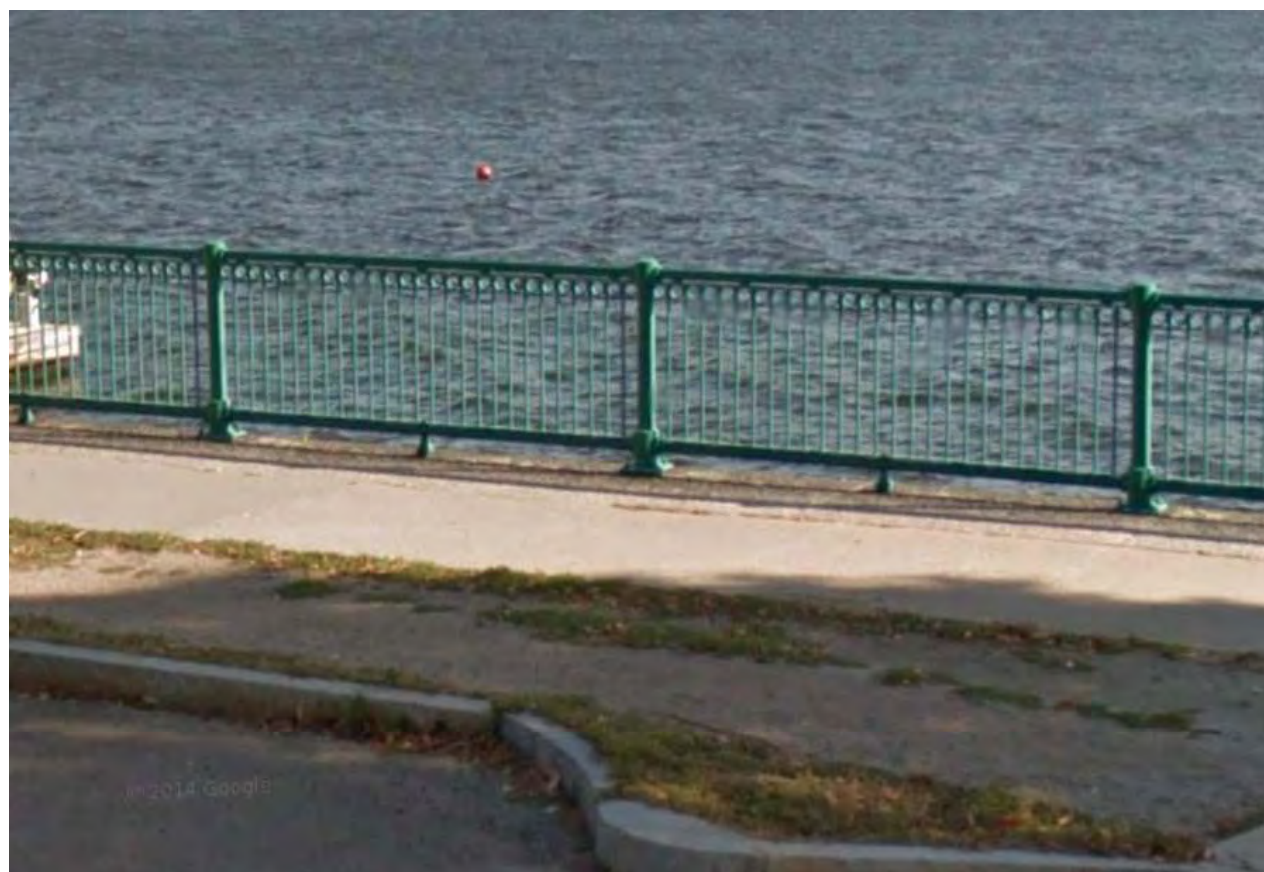

# Work in Winthrop Highlands





## Existing Conditions – Winthrop Highlands



- Rusted railing
- Broken sidewalk

- Degraded seawall
- Rusted chain link fence
- Non-accessible



# Proposed Concept – Winthrop Highlands

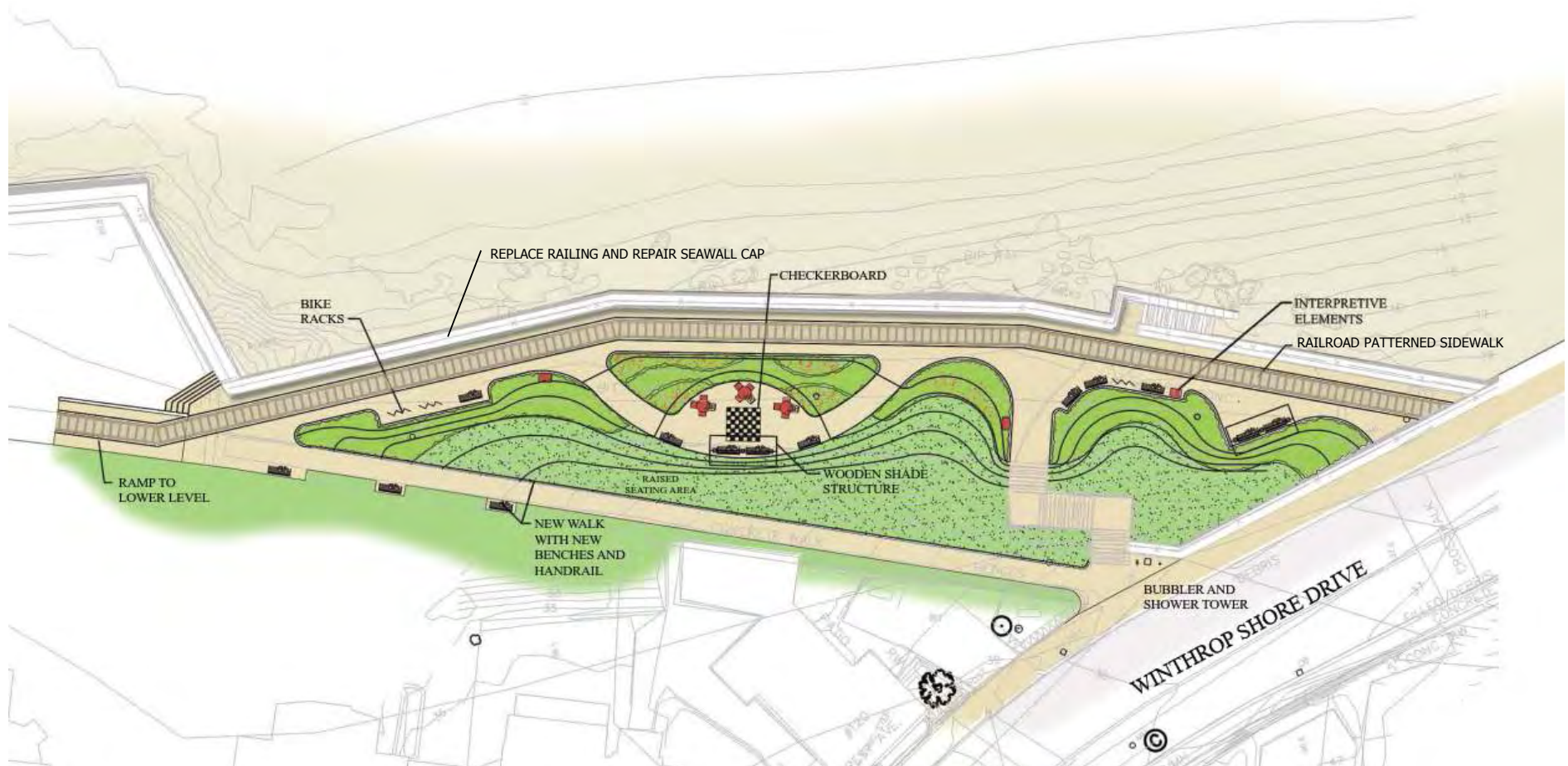



# Design Elements



## Perspective – Looking North





## Perspective – Raised Seating Area





## Schedule/Next Steps

- **Public Comment Period** Through Nov. 9, 2016
- **Complete design:** 2016
- **Bid & award:** early 2017
- **Pre-construction Public Meeting:** 2017
- **Construction:** 2017-2018



# Questions and Answers

## Proposed Rendering of Winthrop Shore Drive



## Additional Information

### **For more information:**

<http://www.mass.gov/eea/agencies/dcr/public-outreach/public-meetings/>

### **If you have comments:**

*Submit Online:* <http://www.mass.gov/eea/agencies/dcr/public-outreach/submit-public-comments/>

*Write:* Department of Conservation and Recreation  
Office of Public Outreach  
251 Causeway Street, Suite 600  
Boston, MA 02114

*Deadline:* Wednesday Nov. 9, 2016

*Note:* Public comments submitted to DCR may be posted on the DCR website in their entirety.

**If you have other questions or concerns, or wish to subscribe to a DCR general information or project-specific listserv:** contact DCR's Office of Community Relations at 617-626-4973 or [Mass.Parks@state.ma.us](mailto:Mass.Parks@state.ma.us).



# Winthrop Beach – ca 1900-1910

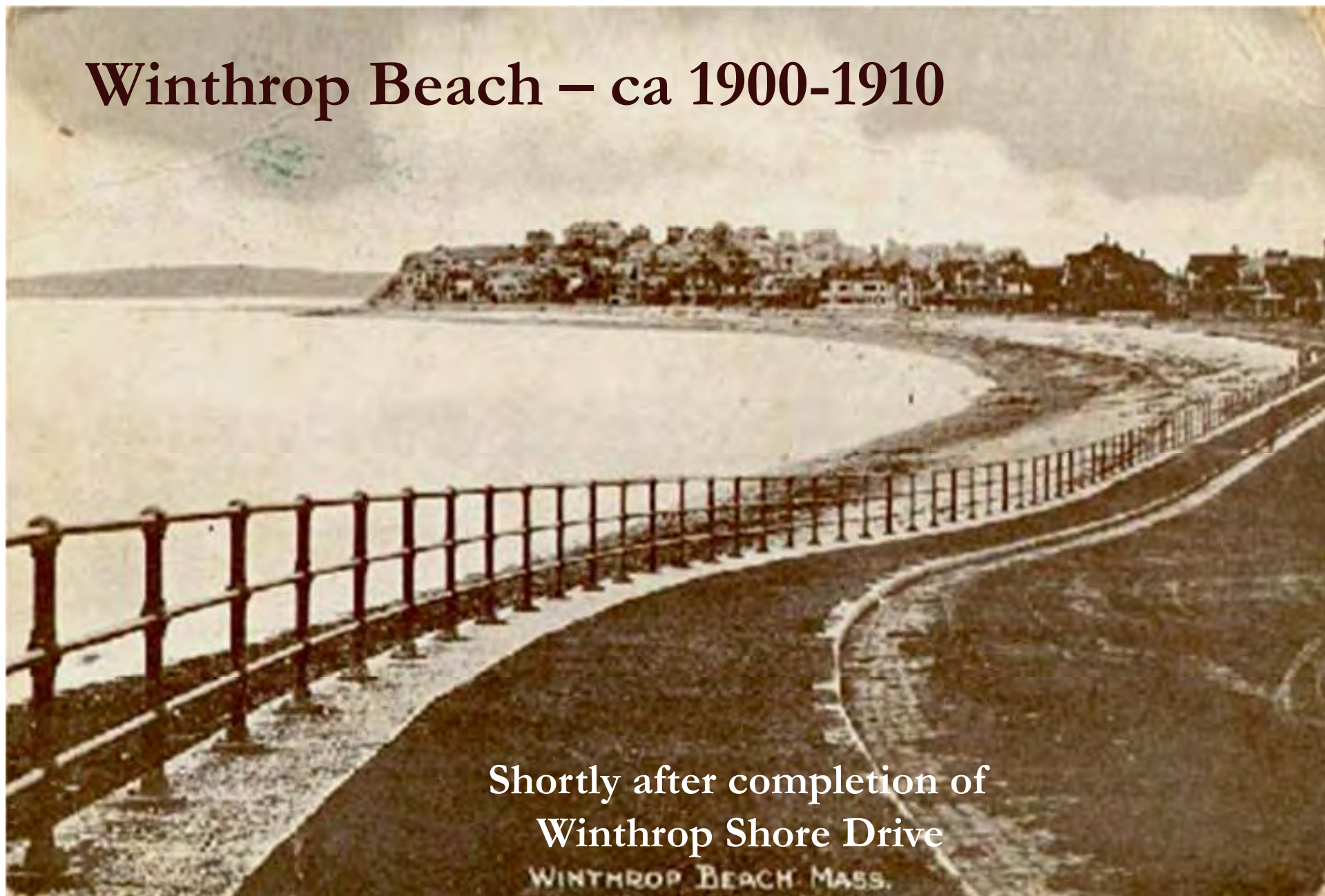

Shortly after completion of  
Winthrop Shore Drive

WINTHROP BEACH MASS.

# **New Stormwater Management System - Advantages**

- **Similar to system in place at Revere Beach in operation for 8 years**
- **Chambers set at same elevation allowing for water to spread evenly to maximize exfiltration rate**
- **Does not rely on discharge at beach – if outlet is clogged it will not affect water draining from roadway**
- **Ability to correct low spots in roadway and ensure drainage to new catch basins**

## Accessibility Improvements – Sidewalks/Roadway

- Narrowing of traveling roadways to 11' provides sufficient space for 6' walkway on residential side (as opposed to current 5'), allowing 3' of passable space in areas of obstructions, such as hydrants, sign-posts, and utility poles at street corners
- New intersection design at all cross-streets, including raised crosswalks to meet slope requirements for accessibility
- New wheelchair ramps on each side of the roadway.

# Emergency Response Routes

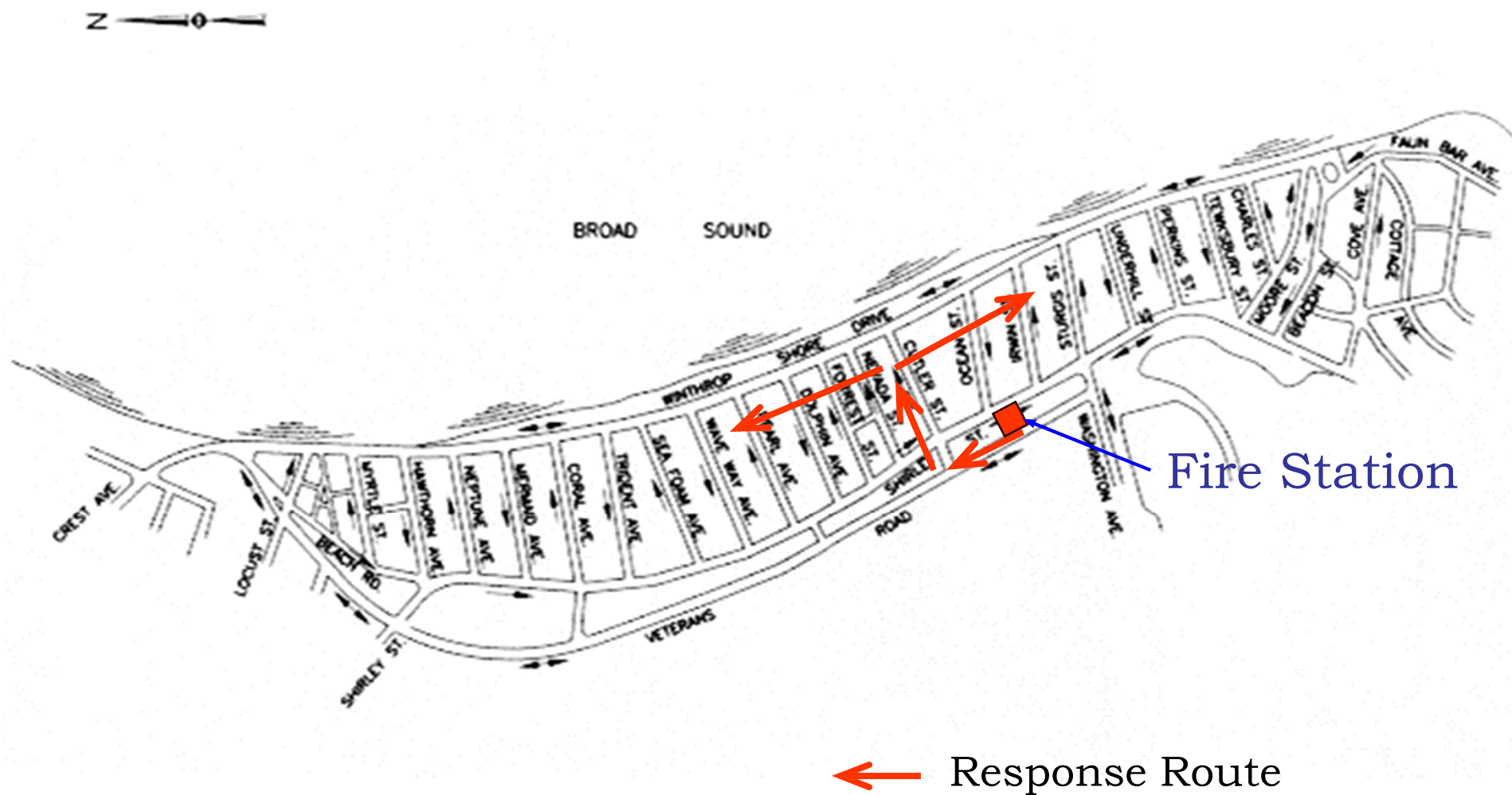



## Reconstruct Roadway

- Slightly narrower travel lanes help reduce speed
- Full depth reconstruction is anticipated to provide a 20-year design life





# Special Accessible Parking Spaces

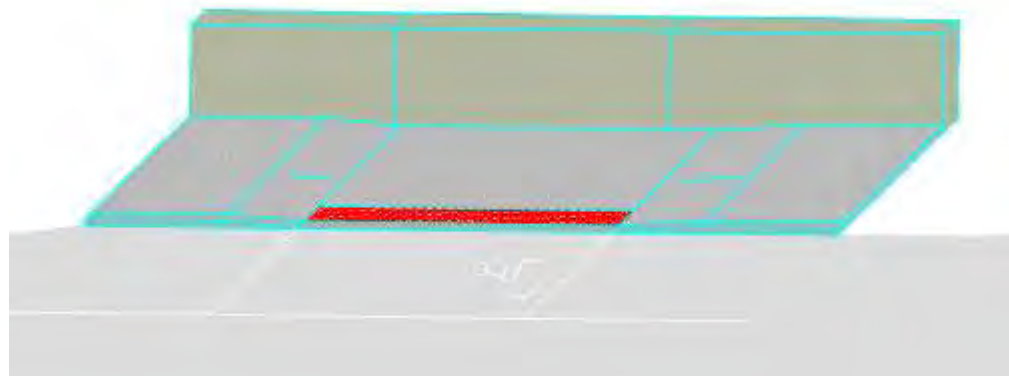

Regular Stall

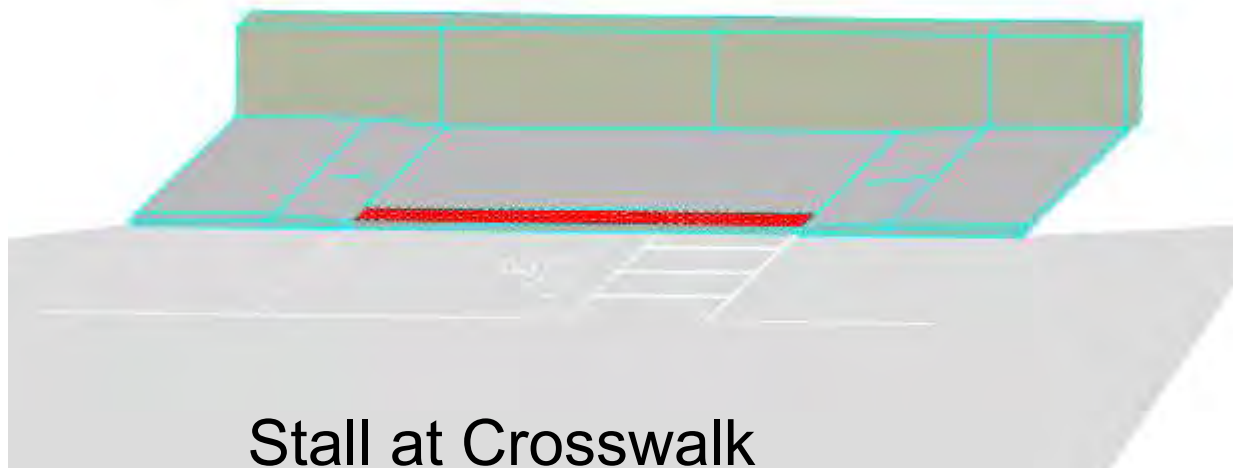

Stall at Crosswalk

# Traffic Management Plan During Construction Temporary Detour (Work Zone North of Cutler Street)

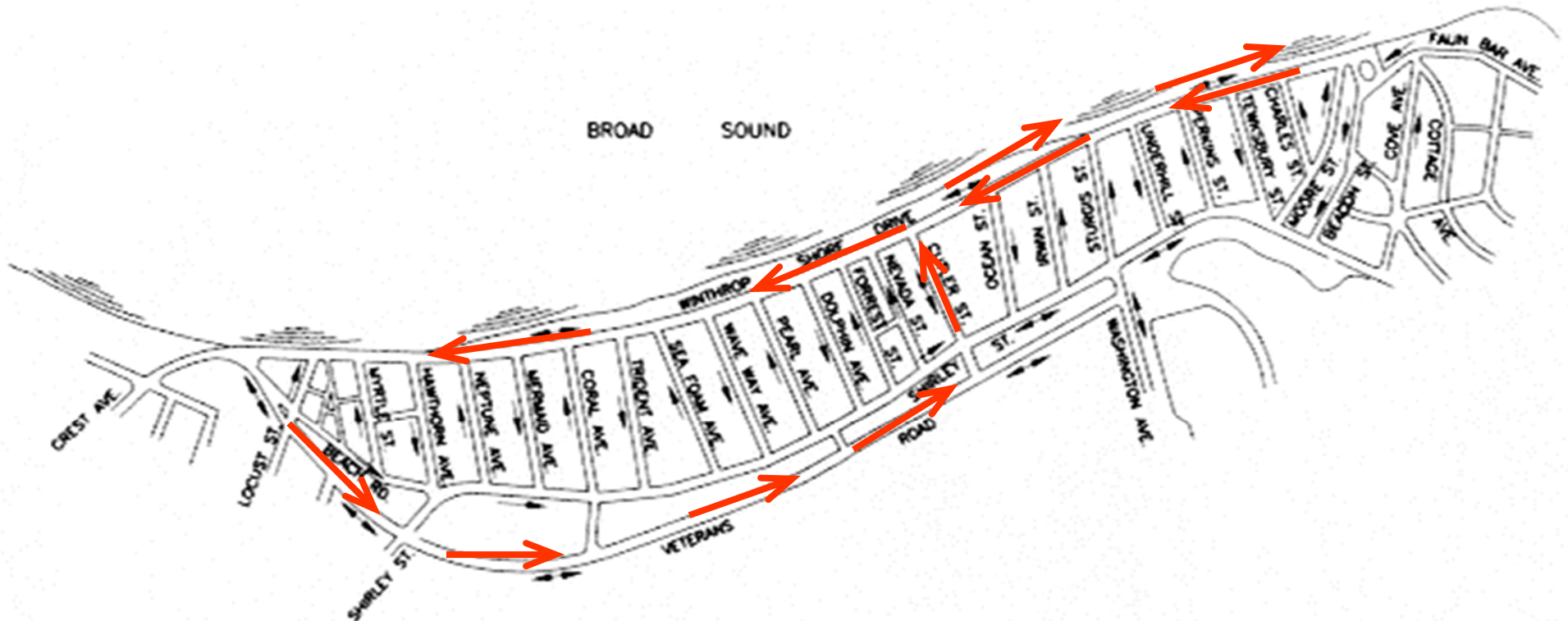

← Detour Route

# Traffic Management Plan During Construction Temporary Detour (Work Zone South of Cutler Street)

