

MALDEN RIVER WORKS

FOR WATERFRONT EQUITY + RESILIENCE

What is Malden River Works?

Malden River Works is a project led by a new coalition of community leaders of color, youth, environmental advocates, and government stakeholders to bring a new climate resilient public park for all on the Malden River.

Where is it located?



Where is it located?

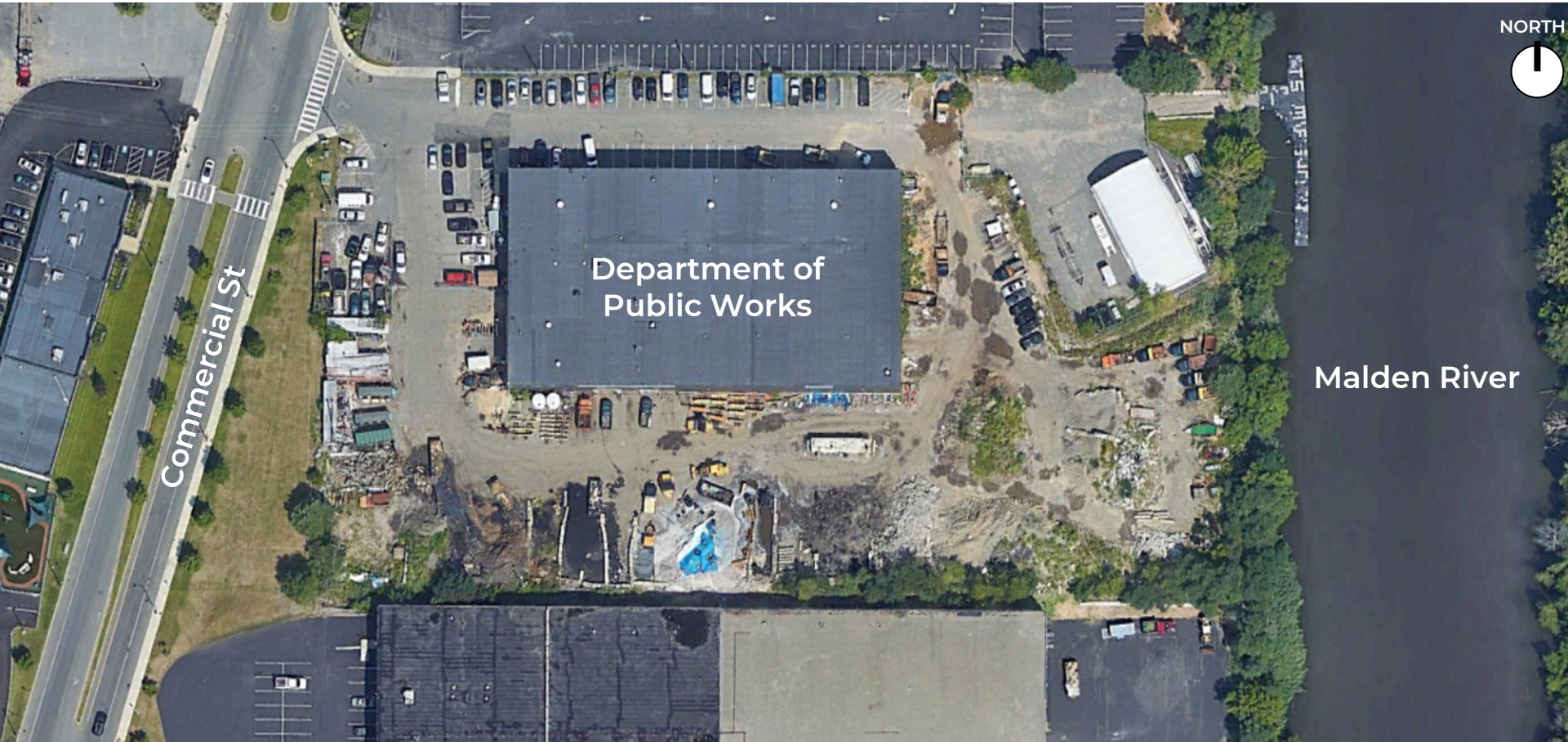

NORTH



Commercial St

Department of
Public Works

Malden River

Where is it located?

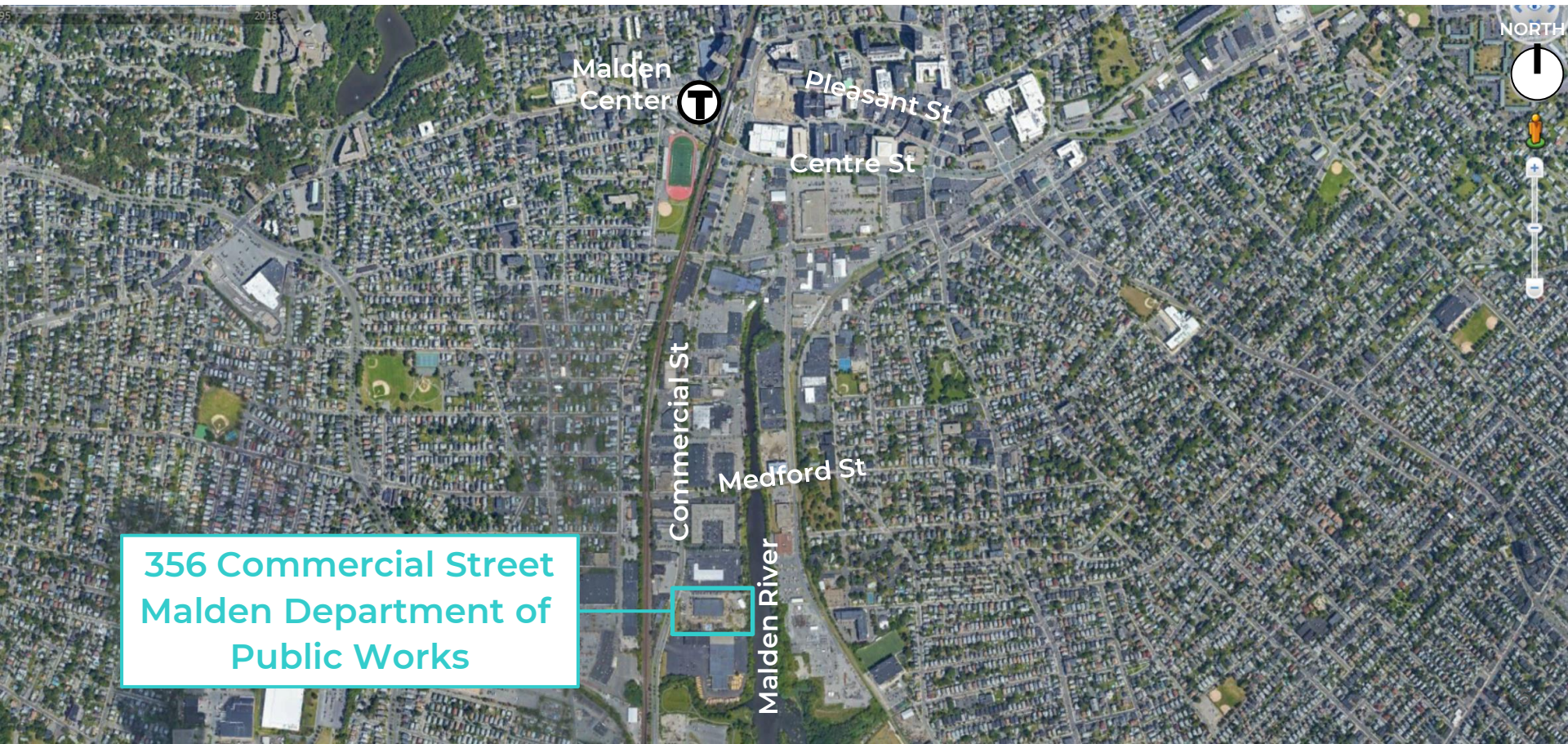

356 Commercial Street
Malden Department of
Public Works

Who is involved?

The people of Malden!

5 Public Meetings

- October 2019 – 90 attendees
- January 2020 – 85 attendees
- May 2020 – 75 attendees (virtual)
- August 2020 – 55 attendees (virtual)
- February 2021 – 68 attendees (virtual)



Who is involved?

The project is led by the **Malden River Works Steering Committee**, representing Malden's communities of color, environmental advocates, and city government stakeholders:



Marcia
Manong
(Chairperson)



Souad Akib



Carlos Aragon
Aldana



Linda Cline



Khalil Kaba



Laura Le



Emmanuel
Marsh



Ramon
Norales



Karen Buck
Friends of the
Malden River

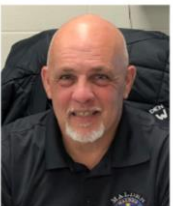

Bobby Knox
DPW Director



Barbara
Murphy
City Council



Evan Spetrini
Malden
Redevelopment
Authority

Who is involved?

The **Malden River Works Project Team** assists the Steering Committee, representing community outreach, planning, and design specialists:



Marcia
Manong



Karen Buck
Friends of the
Malden River



Evan Spetrini
Malden
Redevelopment
Authority



Kathleen
Vandiver
MIT



Amber
Christoffersen
Mystic River
Watershed
Association



Marie Law
Adams
MIT

What does the new park look like?

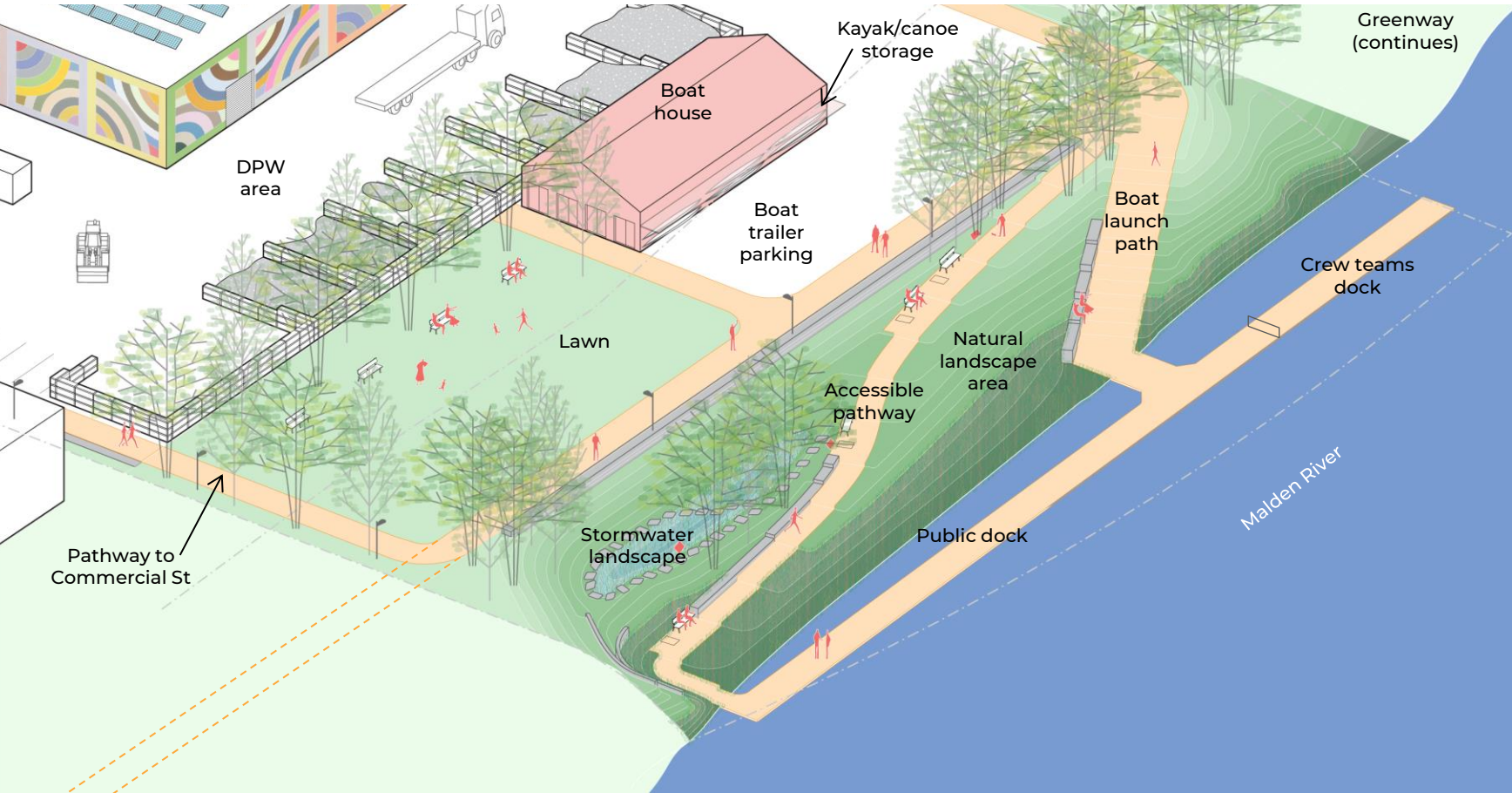

What can I do at the new park?



Enjoy a flexible lawn with views of the river and artwork that celebrates Malden's communities!¹⁰

What can I do at the new park?



... make your way to the river along an accessible, gently sloping pathway!¹

What can I do at the new park?



...experience and learn about nature and the Malden River ecosystem...

What about climate change?

Climate change will bring hotter summer days, more frequent storms and flooding, and sea level rise to the area.

The park is designed to help Malden adapt to climate change by:

- holding and filtering storm water using plants (rain gardens) to reduce flooding from rain
- planting trees for shade and to reduce temperatures
- creating an elevated lawn to reduce flood risk from the river

What's the timeline?

The design team is working on figuring it out! We will know more by June, check back then.

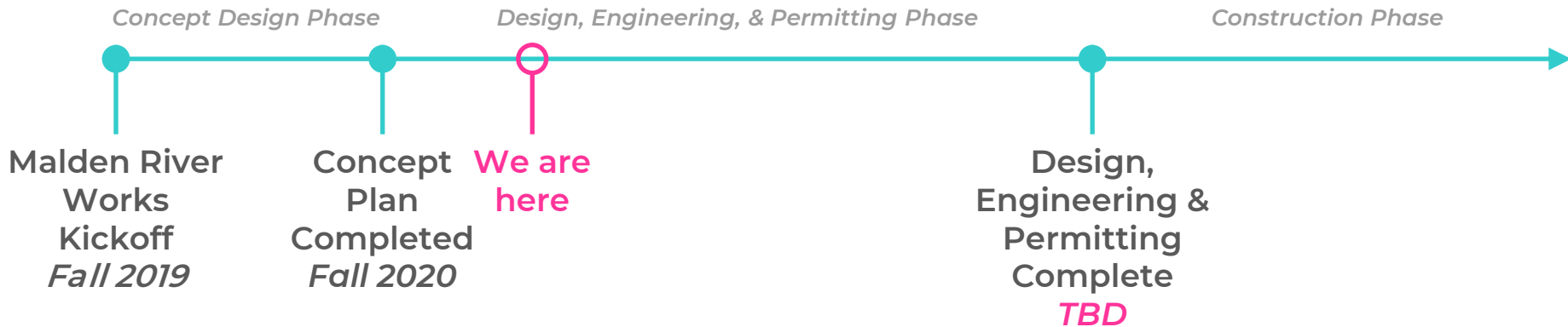

How much will it cost?

The design team is working on figuring it out! With a 25% complete design in June, there will be enough detail to provide a cost estimate.

The design is funded by:

- MVP Action Grant + 25% match
- MIT Leventhal City Prize and donated staff & volunteer time
- MAPC & Barr Foundation Accelerating Climate Resiliency Grant

Need to secure funding for construction:

- Currently reviewing grant opportunities, including EPA Brownfields

What's the latest?

LEGEND

- | | | | |
|--|------------------------------|--------------------|---------------------|
| 1 Malden River Greenway path | 5 Public pathway | 9 Bench seating | 13 Parking |
| 2 Flexible lawn | 6 Boathouse | 10 Boat ramp | 14 DPW building |
| 3 Green stormwater infrastructure (bioswale or bioretention) | 7 Permeable paved plaza | 11 Public dock | 15 Material storage |
| 4 Riparian zone | 8 Wheelchair accessible path | 12 Crew teams dock | 16 Salt shed |

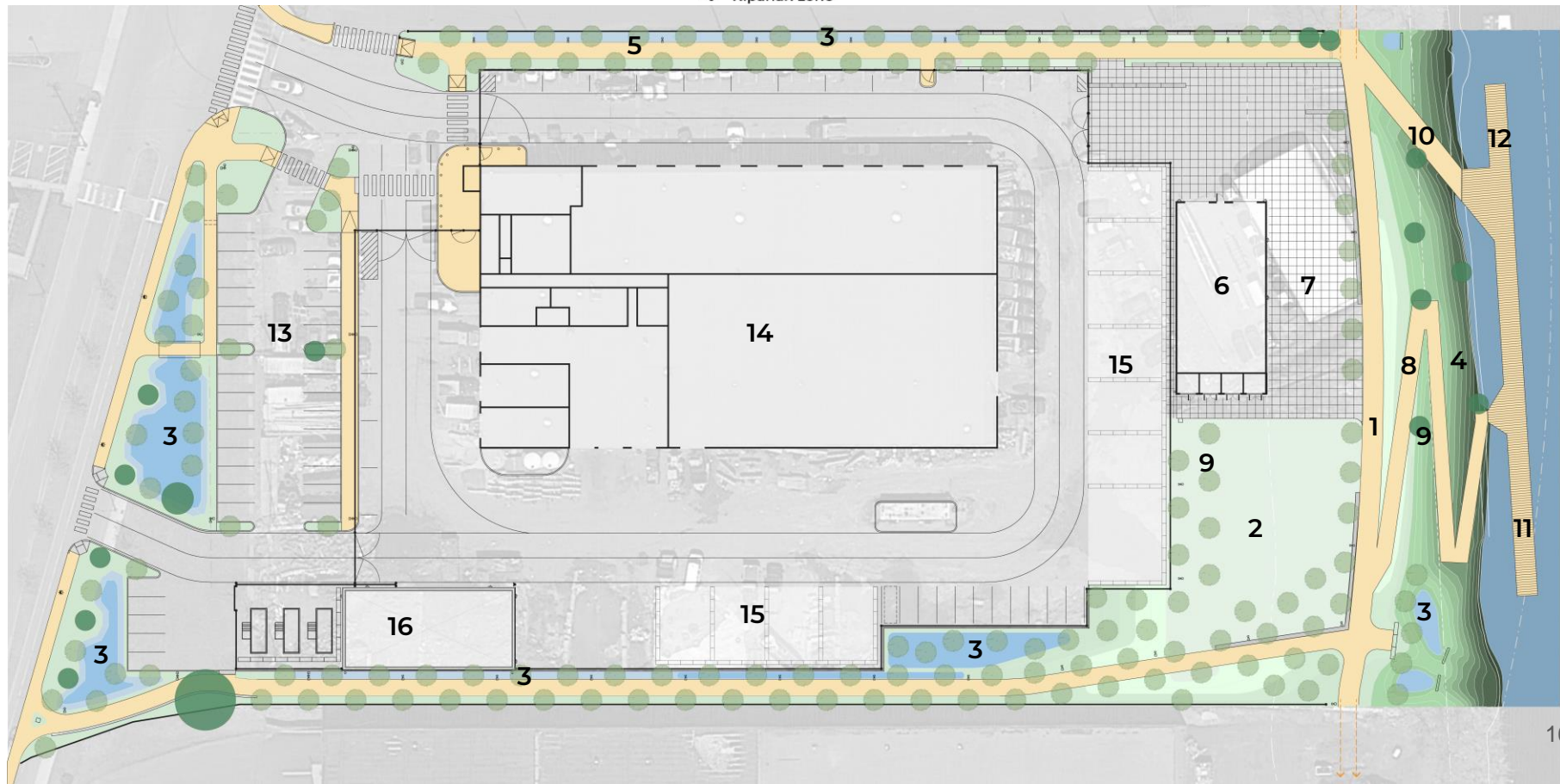

Where can I learn more?

Visit: www.maldenriverworks.org

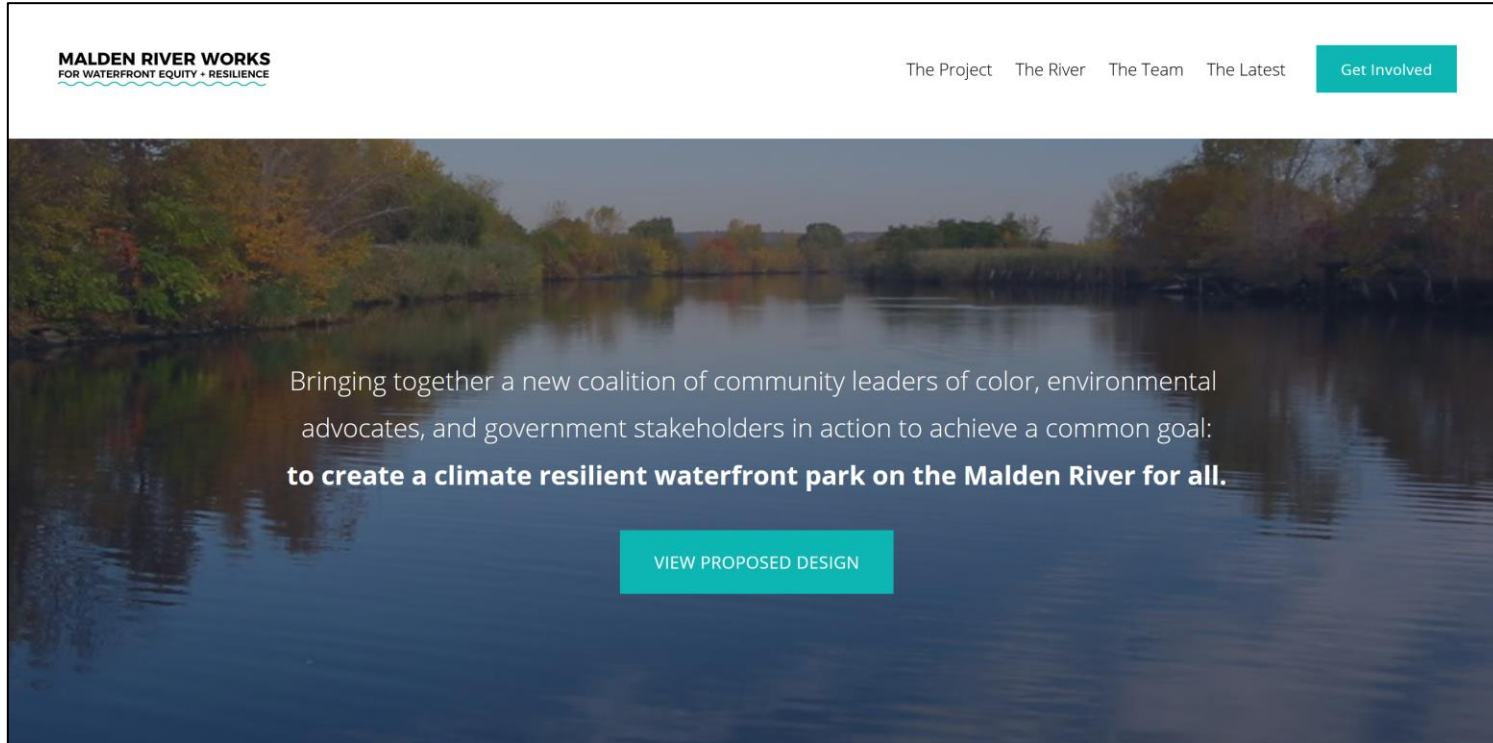

How can I get involved?

Upcoming focus areas in the design include:

- How can the park support arts, culture, and education?
- Stewardship: ensuring that the park will be cared for and maintained

Joining conversations about these topics is one way to get involved in Malden River Works! See how on the next slide.

How can I get involved?

Visit: www.maldenriverworks.org and click **here**

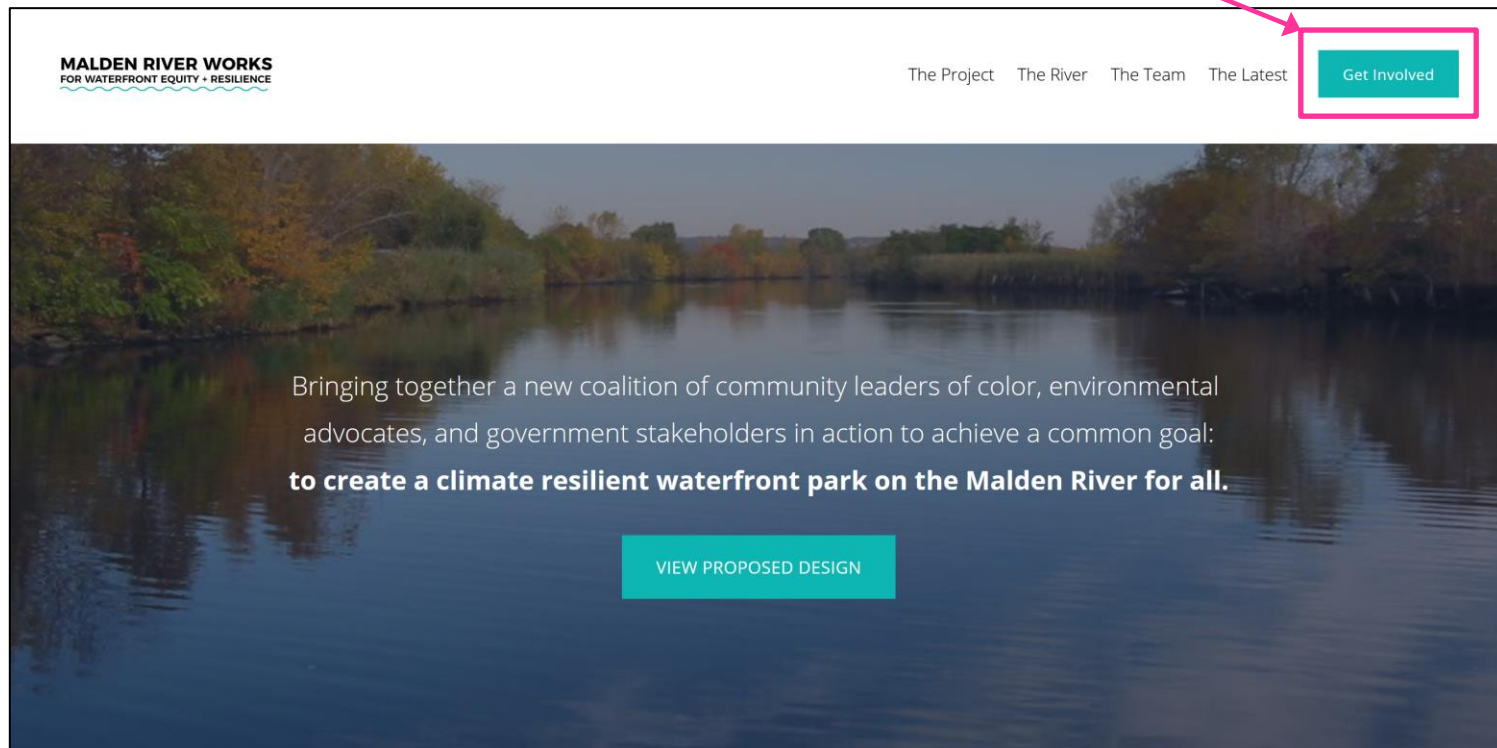

MALDEN RIVER WORKS

FOR WATERFRONT EQUITY + RESILIENCE

Thank you!