



November 12, 2021

Mr. Charles O'Brien
Director of Facilities Management and Capital Planning
Massachusetts Trial Courts
Suffolk County Courthouse
3 Pemberton Square, Suite 106
Boston, MA 02108

Ref: AC Unit Duct Inspection Mold Sampling Assessments
Roderick L. Ireland Courthouse, 50 State Street, Springfield, Massachusetts
October 4 – October 21, 2021
TRC Project 458085

Dear Mr. O'Brien:

Attached please find the report of AC unit duct inspection mold sampling conducted by TRC Environmental Corporation (TRC) during the period from 10/4/21 to 10/21/21.

Please don't hesitate to contact us if you have questions or if we may be of further assistance.

Sincerely,
TRC

A handwritten signature in cursive script that reads "Ann D. Eckmann".

Ann D. Eckmann, CIH
Industrial Hygiene Group Leader

Reviewed by:

A handwritten signature in cursive script that reads "Harry M. Neill".

Harry M. Neill, CIH
Director, Indoor Air Quality and Microbiological Services

Enc.



Results of Microbial Sampling during Duct Inspection

**Roderick L. Ireland Courthouse
50 State Street
Springfield, Massachusetts**

Prepared for:

Facilities Management and Capital Planning
Massachusetts Trial Courts
Suffolk County Courthouse
3 Pemberton Square, Suite 106
Boston, Massachusetts 02108

Prepared by:

TRC Environmental Corporation
300 Wildwood Avenue, Suite 230
Woburn, Massachusetts 01801

Report Date:

November 12, 2021

TRC Project:

458085.0000.0000

CONTENTS

EXECUTIVE SUMMARY

1.0 INTRODUCTION AND BACKGROUND INFORMATION	1
2.0 INVESTIGATIVE STRATEGY	2
2.1 Tape Lift Sampling	2
2.2 Settled Dust Sampling	2
2.3 Results Interpretation	2
2.4 Test Locations	3
3.0 RESULTS AND DISCUSSION	4
4.0 RECOMMENDATIONS	6
5.0 LIMITATIONS	7

Appendix 1 Summary of the Microbial Sampling Results

Appendix 2 Analytical Laboratory Reports

Appendix 3 Approximate Ventilation Zone Drawings

EXECUTIVE SUMMARY

During the period from 10/4/21 to 10/21/21, TRC Environmental Corporation (TRC) was retained by Massachusetts Trial Courts/Facilities Management and Capital Planning to collect samples from the interior surfaces of ventilation ducts for determination of mold* growth during inspections of supply and return air ventilation ducts in the Roderick L. Ireland Courthouse, 50 State Street, Springfield, Massachusetts.

Inspections of the ducts were performed by DCAMM's contractor, Air Duct Services & Restoration, Braintree, Massachusetts. TRC's scope of work was limited to the collection of samples in locations where Air Duct Services & Restoration gained access to interior duct surfaces at access panels or through terminal louvers/diffusers of the duct system.

TRC understands that the purpose of the sampling was to provide information to relevant parties regarding the potential presence of mold in ventilation ducts.

Background Information

There are four primary air handling units, AHU-1, AHU-2, AHU-3 and AHU-4 that service the Courthouse. Building maintenance staff refer to these as AC1, AC2, AC3 and AC4, respectively, and the air handling units will be described using the latter terms in this report. Unit AC1 services all the courtrooms. Unit AC2 services all Floor 4 locations outside of the Floor 4 courtrooms. Unit AC3 services the west side of building locations outside of the courtrooms on the Ground floor through Floor 3, and unit AC4 services the east side of building locations outside of the courtrooms on the Ground floor through Floor 3. TRC understands that supply and return air moved by these air handling units are fully ducted. Exhaust fans, smaller ventilation units and fan coil units may also serve specific areas throughout the Courthouse. Note that while internal duct insulation was observed in some of the inspected duct locations, no internal insulation was observed at many of the inspected duct locations.

Note that mold/fungi are ubiquitous in the environment. While some amounts of settled mold spores and airborne mold are expected in typical indoor environments, a concern may arise when there are building conditions such as dampness/condensation that cause mold to grow on indoor substrates or within air handling systems. Therefore, the detection of mold growth on the surface samples is a potential concern; however, *the results of surface sampling for mold in air ducts should be interpreted with caution because mold detected on a duct surface is not necessarily correlated with airborne concentrations of mold in the occupied space.*

Results

Mold growth was identified in a portion of the samples collected from supply and/or return air ducts on every floor of the building. Many of the test locations included uninsulated ducts, which appeared to be more prevalent than those with internal insulation. Proportionately, the greatest number of positive mold growth results were from ducts associated with AC3 and AC4, which service the east and west sides, respectively of the Ground floor through Floor 3. Proportionately, the least amount of positive mold growth results were from ducts associated with AC2 (Floor 4 locations outside of the courtrooms) and AC1 (servicing courtrooms on all floors). These results are not predictive of, or correlated with, all locations within the duct system or airborne mold spore concentrations in the building.

Recommendations

Based on the surface sampling results, it would be prudent to conduct duct maintenance procedures to include duct cleaning and removal of internal duct insulation where it is present. Cleaning methods, materials and scheduling should be described in a written work plan to ensure that a) the work is conducted with minimum possible disruption and protection of building occupants, and b) the cleaning and post-cleaning inspection methods are consistent with current industry standards. These standards include, but are not necessarily limited to, the National Air Duct Cleaning Association (NADCA) document "Assessment, Cleaning & Restoration of HVAC Systems" and the American National Standards Institute (ANSI) Institute of Inspection, Cleaning and Restoration Certification (IICRC) document "ANSI/IIRC S520: Standard and Reference Guide for Professional Mold Remediation".

*For the purposes of this report, the terms "mold" and "fungi" may be used interchangeably.



1.0 INTRODUCTION AND BACKGROUND INFORMATION

During the period from October 4, 2021 through October 21, 2021, TRC Environmental Corporation (TRC) collected samples of surface dust for microbial analysis at the Roderick L. Ireland Courthouse, 50 State Street, Springfield, Massachusetts (the Courthouse). The sampling was conducted in conjunction with inspections of ventilation ducts performed by ductwork being performed by DCAMM's contractor, Air Duct Services & Restoration, Braintree, Massachusetts. The sampling was requested by Facilities Management and Capital Planning/Massachusetts Trial Courts due to concerns about indoor air quality and to assess the possible presence of mold on interior surfaces of the ventilation ducts.

TRC's scope of work was limited to the collection of samples in locations where Air Duct Services & Restoration gained access to interior duct surfaces at access panels or through terminal louvers/diffusers of the duct system. The samples were submitted to an independent laboratory to determine if mold* growth is present in the sampled locations.

Ventilation in the Courthouse is primarily serviced by four air handling unit units, referred to in this report as AC1, AC2, AC3 and AC4. Appendix 1 contains a summary of the sample locations and test results. Appendix 2 contains the associated analytical laboratory reports. Appendix 3 contains site plans depicting the approximately ventilation zones serviced by the air handling units as reported to TRC by the Massachusetts Trial Courts/Facilities Management and Capital Planning and Air Duct Services & Restoration during the duct inspection.

*For the purposes of this report, the terms "mold" and "fungi" may be used interchangeably.

2.0 INVESTIGATIVE STRATEGY

All collected samples were submitted to EMSL Analytical, Inc. (EMSL) in Woburn, Massachusetts where they were analyzed using direct microscopic fungal examination methods. EMSL participates in the American Industrial Hygiene Association (AIHA) Environmental Microbiology Laboratory Accreditation Program (EMLAP), certification #180179).

The laboratory reports the quantity of spores detected on the samples, and the presence of fungal growth structures. Mold growth is present when growth structures are reported on the laboratory report and are indicated by asterisks (*---*) on the sample results.

Depending on the ability to access the interior duct surface, samples were variously collected from side walls, collars and lower horizontal surfaces within the ducts.

2.1 Tape Lift Sampling

Surface (tape-lift) sampling of potential or suspect mold contamination on interior duct surfaces was conducted using the tape-lift method. Tape-lift sampling is a technique that is used to collect material to determine the presence of fungal growth on a surface. Tape-lift sampling was performed using clear transparent tape, which was applied to a suspect surface and then transferred to a microscopic slide.

2.2 Settled Dust Sampling

In a few locations, surface debris was collected into clean plastic bags for submittal to the laboratory.

2.3 Results Interpretation

The following information was used to interpret the surface sampling results.

Tape-Lift and Settled Dust Samples – Laboratory Report Interpretation		
Estimated Result	Number of Spores Observed on Sample Area	Indication of Growth
Rare	1 – 10	Not likely, especially if no growth structures detected on sample
Low	11 - 100	Possible, not necessarily likely if no growth structures detected on sample
Medium	101 – 1,000	A probable source, not necessarily at the test location if no growth structures detected on sample
High	> 1,000	A likely source, not necessarily at the test location if no growth structures detected on sample
<p>Notes: A potential source exists if growth structures are detected on the sample; however, small, isolated findings of mold growth structures may be due to being drawing into the air distribution system from the outdoor air, or by tracking or otherwise carrying mold into the building.</p> <p>Mold growth structures are denoted by asterisks (*---*) around the mold result in the laboratory report.</p> <p>The spore population mix is also important in results interpretation. When one type of spore predominates, or species consistent with long-term water damage are reported, an indoor source may exist.</p>		

Additional notes on spore types:

Note that certain spore types (e.g., *Stachybotrys* sp., *Ulocladium* sp.) are associated with long-term water damage in buildings. None of these spore types were detected on surface samples during this assessment.

***Aspergillus/Penicillium* sp.**

Very common fungi that can be found in decaying plant materials and soils. They can grow well on a wide range of building materials in indoor environments and certain species of these spore types suggest the presence of high humidity conditions and/or water-damaged building materials.

Note that although *Aspergillus/Penicillium* spore types were detected during TRC's previous assessments of the Courthouse room surfaces where excess relative humidity during the summer months was determined to be the likely cause of mold on building surfaces, no *Aspergillus/Penicillium* spore types were detected in any of the surface samples collected from the ventilation ducts during this assessment.

***Aureobasidium* sp.**

Very common indoor and outdoor fungi. Commonly associated with soils, fresh water, estuaries, fruit and wood. Indoors the spores are frequently found where moisture accumulates, especially bathrooms and kitchens, on shower curtains, tile grout, window sills, textiles, and liquid wastes.

Basidiospores

Very common outdoor fungi associated with wood or wooded areas and also includes the mushrooms and shelf fungi. Spores can easily be spread with wind/airflow. The spores are released in the outdoor environment, especially during periods of high humidity and following rain.

***Cladosporium* sp.**

One of the most common indoor and outdoor species. Commonly found in soil and plant debris as well as on the leaf surfaces of living plants. The outdoor airborne concentrations are lower in the winter and often relatively high in the summer, especially in high humidity. It can grow well on a wide range of building materials in indoor environments and is a spore type consistent with periodic condensation conditions.

2.4 Test Locations

TRC collected samples in locations accessed for inspection by Air Duct Services & Restoration, as requested by Facilities Management and Capital Planning/Massachusetts Trial Courts.

3.0 RESULTS AND DISCUSSION

A summary of the sampling results is included as Appendix 1 and the laboratory analytical reports are included as Appendix 2. Appendix 3 contains site plans indicating the approximately air handling unit zones as described by the Massachusetts Trial Courts/Facilities Management and Capital Planning.

The results are further summarized below:

Summary of Ventilation Ducts Surface Sampling Results Roderick L. Ireland Courthouse, Springfield, Massachusetts October 4 – October 21, 2021				
Description	AC1	AC2	AC3	AC4
General Service Zone	All courtrooms	Floor 4 locations outside of courtrooms	Ground through Floor 3 east side locations outside courtrooms	Ground through Floor 3 west (river) side locations outside courtrooms
Number of Samples Collected	8 – supply air 6 – return air 14 total	11 supply air 11 return air 22 total	23 supply air 28 return air 51 total	20 supply air 18 return air 38 total
Number with identified fungal growth structures	3 – supply air 2 – return air 5 total	4 supply air 0 return air 4 total	23 supply air 14 return air 37 total	20 supply air 5 return air 25 total
Number with normal spore deposition	5 – supply air 4 – return air 9 total	7 supply air 10 return air 17 total	0 supply air 14 return air 14 total	0 supply air 13 return air 13 total
Percent of total with no fungal growth detected	64 %	82%	27%	34%
Additional results	---	Medium deposition of <i>Cladosporium</i> sp. on one return air sample with no growth structures reported	4 of the test locations had “low” mold growth reported	4 of the test locations had “low” mold growth reported Medium deposition of <i>Cladosporium</i> sp. on one return air sample with no growth structures reported
Comments	AC1 ducts sampled on Floors 3 and 4.	AC2 ducts sampled on Floor 4, the dedicated service zone.	AC3 ducts sampled on Garage Level, Plaza, Floor 2 and Floor 3.	AC4 ducts sampled on Garage Level, Plaza and Floor 3.

The results suggest that supply air ducts are more likely than return air ducts to have sample results showing the presence of mold growth.

Note that the results of surface sampling for mold in air ducts should be interpreted with caution because mold detected on a duct surface is not correlated with airborne concentrations of mold in the occupied space. These results are not predictive of, or correlated with, airborne mold spore concentrations in the building.

For example, while *Aspergillus/Penicillium* was the predominant spore type detected during TRC's initial assessment of the Courthouse, when excess relative humidity during the summer months was determined to be the likely cause of mold growth on room surfaces, no *Aspergillus/Penicillium* spore types were detected in any of the samples collected from interior ventilation duct surfaces during this assessment. *Cladosporium* sp. was detected both on room surface samples and interior duct surface samples during this and previous samplings conducted by TRC at the Courthouse. *Aureobasidium* sp. was detected only on interior duct surfaces during this assessment but was not detected during previous samplings conducted by TRC at the Courthouse.

4.0 RECOMMENDATIONS

Based on the surface sampling results, it would be prudent to conduct duct maintenance procedures to include duct cleaning and removal of internal duct insulation where it is present.

Cleaning methods, materials and scheduling should be described in a written work plan to ensure that a) the work is conducted with minimum possible disruption to and protection of building occupants, and b) the cleaning and post-cleaning inspection methods are consistent with current industry standards for protecting workers and the building environment from the potential release of excess mold spores during duct cleaning.

At minimum, the following industry standards should be considered in developing the work plan:

- National Air Duct Cleaning Association (NADCA), ACR, "Assessment, Cleaning, & Restoration of HVAC Systems," ACR 2013.
- Recognition, Evaluation, and Control of Indoor Mold, Second Edition, American Industrial Hygiene Association
- New York City Department of Health and Mental Hygiene, Bureau of Environmental & Occupational Disease Epidemiology, "Guidelines on Assessment and Remediation of Fungi in Indoor Environments".
- American Conference of Governmental Industrial Hygienists (ACGIH), "Bioaerosols: Assessment and Control", Chapter 15: Remediation of Microbial Contamination.
- American National Standards Institute (ANSI) Institute of Inspection, Cleaning and Restoration Certification (IICRC), "ANSI/IIRC S520: Standard and Reference Guide for Professional Mold Remediation Third Edition".

5.0 LIMITATIONS

The purpose of TRC's sampling was to collect and analyze sampled of surface dust within ducts in locations inspected by Air Duct Services & Restoration. TRC's sampling was limited to immediately accessible locations at the inspection access points. These results are not necessarily predictive of, or correlated with, all locations within the duct system.

TRC has performed the tasks set forth above in a thorough and professional manner consistent with industry standards. TRC cannot guarantee and does not warrant that this limited assessment has revealed all potential adverse environmental conditions affecting the site.

No expressed or implied representation or warranty is included in this report except that the services were performed within the limits of the scope of work authorized by the client and the encountered site conditions.

Appendix 1 Summary of the Microbial Air and Surface Sampling Results

Table 1. AC1 Summary of Surface Sampling Results Roderick L. Ireland Courthouse, Springfield, Massachusetts October 4 – October 12, 2021									
Date	Floor	Access Location	Duct Ventilation Zone	Insulated?	Supply or Return Ductwork Sampled	Access Type	Sample ID	Mold Growth Reported by Laboratory?	Comments/General Impression
10/12/2021	3	Hall at stair #2	AC1	Uninsulated	Return	Acess panel	TL-3	No	
10/12/2021	3	Women's room 389	AC1	Uninsulated	Supply	Acess panel	TL-1	No	
10/12/2021	3	Men's room 390	AC1	Uninsulated	Supply	Acess panel	TL-2	No	
10/12/2021	3	Hall at stair #3	AC1	Uninsulated	Supply	Acess panel	TL-5	No	
10/13/2021	3	Hall at room 320	AC1	Uninsulated	Return	Acess panel	TL-1	Yes	<i>Cladosporium</i>
10/12/2021	3	Hall at stair #1	AC1	Uninsulated	Return	Acess panel	TL-7	Yes	<i>Aureobasidium, Cladosporium</i>
10/4/2021	4	Courtroom 1	AC1	Uninsulated	Return	Lateral louver	B-1	No	
10/5/2021	4	Hall at stair #1	AC1	Uninsulated	Return	Acess panel	TL-2	No	
10/5/2021	4	Hall at courtroom 2	AC1	Insulated	Supply	Acess panel	TL-3	No	
10/5/2021	4	Hall at room 419	AC1	Insulated	Supply	Acess panel	TL-5	No	
10/6/2021	4	Hall at stair #2	AC1	Insulated	Supply	Louver	TL-1	No	
10/6/2021	4	Hall at stair #2	AC1	Uninsulated	Return	Acess panel	TL-2	Yes	<i>Cladosporium</i>
10/4/2021	4	Hall at elevator #2	AC1	Insulated	Supply	Access panel	TL-3	Yes	<i>Aureobasidium, Cladosporium</i>
10/6/2021	4	Hall at room 453	AC1	Insulated	Supply	Acess panel	TL-3	Yes	<i>Cladosporium</i>

Table 2. AC2 Summary of Surface Sampling Results Roderick L. Ireland Courthouse, Springfield, Massachusetts October 4 – October 7, 2021									
Date	Floor	Access Location	Duct Ventilation Zone	Insulated?	Supply or Return Ductwork Sampled	Access Type	Sample ID	Mold Growth Reported by Laboratory?	Comments/General Impression
10/7/2021	4	Jury Pool room 446 southwest near stair #1	AC2	Insulated	Return	Louver	TL-2	No	
10/4/2021	4	Room 427	AC2	Uninsulated	Return	Access panel	B-2	No	
10/4/2021	4	Registry of Probate	AC2	Uninsulated	Return	Louver	TL-7	No	
10/5/2021	4	Room 426	AC2	Uninsulated	Return	Access panel	TL-1	No	Medium deposition of <i>Cladosporium</i> but no fungal growth structures
10/6/2021	4	Registry of Deeds room 400 at room 408A	AC2	Uninsulated	Return	Louver	TL-7	No	
10/6/2021	4	Registry of Deeds room 450	AC2	Uninsulated	Return	Louver	TL-8	No	
10/6/2021	4	Registry of Deeds hall at room 415	AC2	Uninsulated	Return	Louver	TL-9	No	
10/7/2021	4	Registry of Deeds room 411	AC2	Uninsulated	Return	Louver	TL - 1	No	
10/7/2021	4	Jury Pool room 446 at men's room	AC2	Uninsulated	Return	Louver	TL-3	No	
10/7/2021	4	Jury Pool room 446 at 446D	AC2	Uninsulated	Return	Louver	TL-5	No	
10/7/2021	4	Jury Pool room 446 - 446D	AC2	Uninsulated	Return	Louver	TL-7	No	
10/4/2021	4	Probate at room 444	AC2	Insulated	Supply	Access panel	TL-4	No	

Table 2. AC2 Summary of Surface Sampling Results Roderick L. Ireland Courthouse, Springfield, Massachusetts October 4 – October 7, 2021									
Date	Floor	Access Location	Duct Ventilation Zone	Insulated?	Supply or Return Ductwork Sampled	Access Type	Sample ID	Mold Growth Reported by Laboratory?	Comments/General Impression
10/4/2021	4	Registry of Probate	AC2	Insulated	Supply	Louver	TL-5	No	
10/6/2021	4	Registry of Deeds room 403	AC2	Insulated	Supply	Access panel	TL-6	No	
10/7/2021	4	Jury Pool room 446 north corner	AC2	Insulated	Supply	Louver	TL-6	No	
10/4/2021	4	Room 426	AC2	Uninsulated	Supply	Louver	TL-1	No	
10/4/2021	4	Room 427	AC2	Uninsulated	Supply	Louver	TL-2	No	
10/4/2021	4	Registry of Probate	AC2	Uninsulated	Supply	Louver	TL-6	No	
10/5/2021	4	Room 426	AC2	Insulated	Supply	Access panel	TL-4	Yes	<i>Cladosporium</i>
10/7/2021	4	Jury Pool room 446 at center of room	AC2	Insulated	Supply	Louver	TL-4	Yes	<i>Cladosporium</i>
10/6/2021	4	Registry of Deeds room 407	AC2	Uninsulated	Supply	Louver	TL-4	Yes	<i>Cladosporium</i>
10/6/2021	4	Registry of Deeds room 400 at room 405	AC2	Uninsulated	Supply	Louver	TL-5	Yes	<i>Cladosporium</i>

Table 3. AC3 Summary of Surface Sampling Results Roderick L. Ireland Courthouse, Springfield, Massachusetts October 13 – October 21, 2021									
Date	Floor	Access Location	Duct Ventilation Zone	Insulated?	Supply or Return Ductwork Sampled	Access Type	Sample ID	Mold Growth Reported by Laboratory?	Comments/General Impression
10/18/2021	2	Room 230	AC3	Uninsulated	Return	Louver	TL-5	No	
10/18/2021	2	Room 224	AC3	Uninsulated	Return	Louver	TL-2	Yes	<i>Aureobasidium, Cladosporium</i>
10/18/2021	2	Room 223	AC3	Uninsulated	Return	Louver	TL-4	Yes	<i>Aureobasidium, Cladosporium</i>
10/18/2021	2	Room 228	AC3	Uninsulated	Return	Louver	TL-9	Yes	<i>Cladosporium</i>
10/18/2021	2	Clerk of District Court front left side	AC3	Uninsulated	Return	Louver	TL-11	Yes	<i>Aureobasidium, Cladosporium, low</i>
10/18/2021	2	Clerk of District Court room 216	AC3	Uninsulated	Return	Louver	TL-12	Yes	<i>Aureobasidium, Cladosporium</i>
10/18/2021	2	Clerk of District Court room 211	AC3	Uninsulated	Return	Louver	TL-14	Yes	<i>Cladosporium, low</i>
10/18/2021	2	Clerk of District Court room 221	AC3	Uninsulated	Return	Louver	TL-17	Yes	<i>Aureobasidium, Cladosporium</i>
10/18/2021	2	Clerk of District Court room 219	AC3	Uninsulated	Return	Louver	TL-18	Yes	<i>Aureobasidium, Cladosporium</i>
10/18/2021	2	Room 224	AC3	Insulated	Supply	Louver	TL-1	Yes	<i>Cladosporium</i>
10/18/2021	2	Room 230	AC3	Insulated	Supply	Louver	TL-6	Yes	<i>Cladosporium</i>
10/18/2021	2	Room 228	AC3	Insulated	Supply	Louver	TL-8	Yes	<i>Aureobasidium, Cladosporium</i>
10/18/2021	2	Clerk of District Court Civil front left side at lobby	AC3	Insulated	Supply	Louver	TL-10	Yes	<i>Cladosporium</i>
10/18/2021	2	Clerk of District Court room 211	AC3	Insulated	Supply	Louver	TL-15	Yes	<i>Cladosporium</i>

Table 3. AC3 Summary of Surface Sampling Results Roderick L. Ireland Courthouse, Springfield, Massachusetts October 13 – October 21, 2021									
Date	Floor	Access Location	Duct Ventilation Zone	Insulated?	Supply or Return Ductwork Sampled	Access Type	Sample ID	Mold Growth Reported by Laboratory?	Comments/General Impression
10/18/2021	2	Room 223	AC3	Uninsulated	Supply	Louver	TL-3	Yes	<i>Aureobasidium, Basidiospores, Cladosporium</i>
10/18/2021	2	Elevator #5 Lobby	AC3	Uninsulated	Supply	Louver	TL-7	Yes	<i>Aureobasidium, Cladosporium</i>
10/18/2021	2	Clerk of District Court Civil 216	AC3	Uninsulated	Supply	Louver	TL-13	Yes	<i>Cladosporium</i>
10/18/2021	2	Clerk of District Court room 221	AC3	Uninsulated	Supply	Louver	TL-16	Yes	<i>Cladosporium</i>
10/18/2021	2	Clerk of District Court room 219	AC3	Uninsulated	Supply	Louver	TL-19	Yes	<i>Cladosporium</i>
10/13/2021	3	Room 323	AC3	Uninsulated	Return	Louver	TL-3	No	
10/13/2021	3	Room 320B	AC3	Uninsulated	Return	Louver	TL-5	No	
10/13/2021	3	Room 376	AC3	Uninsulated	Return	Louver	TL-7	No	
10/13/2021	3	Room 378A	AC3	Uninsulated	Return	Louver	TL-9	No	
10/13/2021	3	Room 347	AC3	Insulated	Return	Louver	TL-2	Yes	<i>Aureobasidium, Cladosporium</i>
10/13/2021	3	Room 332	AC3	Uninsulated	Return	Louver	B-2	Yes	<i>Aureobasidium, Cladosporium, low</i>
10/13/2021	3	Room 332	AC3	Insulated	Supply	Louver	B-1	Yes	<i>Aureobasidium, Cladosporium, low</i>
10/13/2021	3	Room 323 attorney booth	AC3	Uninsulated	Supply	Louver	TL-4	Yes	<i>Cladosporium</i>
10/13/2021	3	Room 320B	AC3	Uninsulated	Supply	Louver	TL-6	Yes	<i>Cladosporium</i>
10/13/2021	3	Room 376	AC3	Uninsulated	Supply	Louver	TL-8	Yes	<i>Cladosporium</i>

Table 3. AC3 Summary of Surface Sampling Results Roderick L. Ireland Courthouse, Springfield, Massachusetts October 13 – October 21, 2021									
Date	Floor	Access Location	Duct Ventilation Zone	Insulated?	Supply or Return Ductwork Sampled	Access Type	Sample ID	Mold Growth Reported by Laboratory?	Comments/General Impression
10/19/2021	Garage Level	Room G42 at outside air intake	AC3	Uninsulated	Return	Access panel	TL-3	No	
10/19/2021	Garage Level	Room G42A	AC3	Uninsulated	Return	Access panel	TL-4	No	
10/19/2021	Garage Level	Room G42A at Paint shop	AC3	Uninsulated	Return	Access panel	TL-5	No	
10/19/2021	Garage Level	Room G42A	AC3	Uninsulated	Return	Access panel	TL-2	Yes	<i>Cladosporium</i>
10/19/2021	Garage Level	Room G42A at room G43	AC3	Uninsulated	Supply	Access panel	TL-1	Yes	<i>Cladosporium</i>
10/20/2021	Plaza	Room 142	AC3	Uninsulated	Return	Louver	TL-6	No	
10/20/2021	Plaza	Room 166	AC3	Uninsulated	Return	Louver	TL-7	No	
10/21/2021	Plaza	Room 131	AC3	Uninsulated	Return	Louver	TL-1	No	
10/21/2021	Plaza	Room 122	AC3	Uninsulated	Return	Louver	TL-2	No	
10/21/2021	Plaza	Room 124	AC3	Uninsulated	Return	Louver	TL-6	No	
10/21/2021	Plaza	Room 110B	AC3	Uninsulated	Return	Louver	TL-12	No	
10/21/2021	Plaza	Room 121B	AC3	Uninsulated	Return	Louver	TL-4	Yes	<i>Cladosporium</i> , low
10/21/2021	Plaza	Hall at room 140A	AC3	Uninsulated	Return	Louver	TL-8	Yes	<i>Aureobasidium</i> , <i>Cladosporium</i>
10/21/2021	Plaza	Room 131	AC3	Uninsulated	Return	Louver	TL-10	Yes	<i>Aureobasidium</i> , <i>Cladosporium</i> , low
10/20/2021	Plaza	Room 142	AC3	Insulated	Supply	Louver	TL-5	Yes	<i>Aureobasidium</i> , <i>Cladosporium</i>
10/21/2021	Plaza	Room 131	AC3	Insulated	Supply	Louver	TL-9	Yes	<i>Aureobasidium</i> , <i>Cladosporium</i>

Table 3. AC3 Summary of Surface Sampling Results Roderick L. Ireland Courthouse, Springfield, Massachusetts October 13 – October 21, 2021									
Date	Floor	Access Location	Duct Ventilation Zone	Insulated?	Supply or Return Ductwork Sampled	Access Type	Sample ID	Mold Growth Reported by Laboratory?	Comments/General Impression
10/21/2021	Plaza	Room 110B	AC3	Insulated	Supply	Louver	TL-11	Yes	<i>Aureobasidium</i> , <i>Cladosporium</i>
10/20/2021	Plaza	Room 166	AC3	Uninsulated	Supply	Louver	TL-8	Yes	<i>Cladosporium</i>
10/21/2021	Plaza	Room 121	AC3	Uninsulated	Supply	Louver	TL-3	Yes	<i>Cladosporium</i>
10/21/2021	Plaza	Elevator #5 lobby	AC3	Uninsulated	Supply	Louver	TL-5	Yes	<i>Cladosporium</i>
10/21/2021	Plaza	Room 124 attorney booth	AC3	Uninsulated	Supply	Louver	TL-7	Yes	<i>Aureobasidium</i> , <i>Cladosporium</i>
10/21/2021	Plaza	Room 108	AC3	Uninsulated	Supply	Louver	TL-13	Yes	<i>Aureobasidium</i> , <i>Cladosporium</i>

Table 4. AC4 Summary of Surface Sampling Results Roderick L. Ireland Courthouse, Springfield, Massachusetts October 12 – October 21, 2021									
Date	Floor	Access Location	Duct Ventilation Zone	Insulated?	Supply or Return Ductwork Sampled	Access Type	Sample ID	Mold Growth Reported by Laboratory?	Comments/General Impression
10/12/2021	3	Hall at room 381	AC4	Uninsulated	Return	Access panel	TL-6	No	
10/14/2021	3	Room 381	AC4	Uninsulated	Return	Louver	B-1	No	
10/14/2021	3	Clerk of Court Criminal	AC4	Uninsulated	Return	Louver	B-2	No	
10/14/2021	3	Clerk of Superior Court secretary pool	AC4	Uninsulated	Return	Louver	B-3	No	
10/14/2021	3	Clerk of Superior Court Civil room 300	AC4	Uninsulated	Return	Louver	B-4	No	
10/14/2021	3	Law Library	AC4	Uninsulated	Return	Louver	B-5	No	
10/14/2021	3	Room 350	AC4	Uninsulated	Return	Louver	TL-2	Yes	<i>Cladosporium</i>
10/14/2021	3	Room 371	AC4	Uninsulated	Return	Louver	TL-4	Yes	<i>Cladosporium</i> , low
10/14/2021	3	Room 370	AC4	Uninsulated	Return	Louver	TL-5	Yes	<i>Cladosporium</i>
10/14/2021	3	Room 371	AC4	Insulated	Supply	Louver	TL-3	Yes	<i>Cladosporium</i>
10/14/2021	3	Room 370	AC4	Insulated	Supply	Louver	TL-6	Yes	<i>Cladosporium</i>
10/14/2021	3	Law Library	AC4	Insulated	Supply	Louver	TL-11	Yes	<i>Cladosporium</i>
10/12/2021	3	Hall at Law Library	AC4	Uninsulated	Supply	Linear diffuser	TL-4	Yes	<i>Aureobasidium</i> , <i>Cladosporium</i>
10/14/2021	3	Room 350	AC4	Uninsulated	Supply	Louver	TL-1	Yes	<i>Cladosporium</i>
10/14/2021	3	Room 380	AC4	Uninsulated	Supply	Louver	TL-7	Yes	<i>Cladosporium</i>
10/14/2021	3	Hall at room 343	AC4	Uninsulated	Supply	Louver	TL-8	Yes	<i>Cladosporium</i>
10/14/2021	3	Clerk of Superior Court Criminal	AC4	Uninsulated	Supply	Louver	TL-9	Yes	<i>Cladosporium</i>

Table 4. AC4 Summary of Surface Sampling Results Roderick L. Ireland Courthouse, Springfield, Massachusetts October 12 – October 21, 2021									
Date	Floor	Access Location	Duct Ventilation Zone	Insulated?	Supply or Return Ductwork Sampled	Access Type	Sample ID	Mold Growth Reported by Laboratory?	Comments/General Impression
10/14/2021	3	Clerk of Superior Court Secretary Pool	AC4	Uninsulated	Supply	Louver	TL-10	Yes	<i>Cladosporium</i>
10/20/2021	Garage Level	Room G42 at AC4	AC4	Uninsulated	Return	Access panel	TL-3	No	
10/20/2021	Garage Level	Room G42	AC4	Uninsulated	Return	Access panel	TL-4	No	
10/20/2021	Garage Level	Room G42 at AC4	AC4	Uninsulated	Supply	Access panel	TL-1	Yes	<i>Aureobasidium, Cladosporium</i> , low
10/20/2021	Garage Level	Room G42 hall at doors to garage	AC4	Uninsulated	Supply	Access panel	TL-2	Yes	<i>Aureobasidium, Cladosporium</i>
10/19/2021	Plaza	Room 138B	AC4	Uninsulated	Return	Louver	TL-6	No	
10/19/2021	Plaza	Room 167A	AC4	Uninsulated	Return	Louver	TL-9	No	
10/19/2021	Plaza	Room 167	AC4	Uninsulated	Return	Louver	TL-10	No	
10/20/2021	Plaza	Room 114A	AC4	Uninsulated	Return	Louver	TL-9	No	
10/20/2021	Plaza	Room 138A	AC4	Uninsulated	Return	Louver	TL-12	No	Medium deposition of <i>Cladosporium</i> but no growth
10/19/2021	Plaza	Room 147	AC4	Uninsulated	Return	Louver	TL-12	Yes	<i>Aureobasidium, Cladosporium</i> , low
10/21/2021	Plaza	Room 110B at room 108	AC4	Uninsulated	Return	Louver	TL-15	Yes	<i>Aureobasidium, Cladosporium</i> , low
10/19/2021	Plaza	Room 138	AC4	Uninsulated	Supply	Louver	TL-7	Yes	<i>Cladosporium</i>
10/19/2021	Plaza	Room 167A	AC4	Uninsulated	Supply	Louver	TL-8	Yes	<i>Aureobasidium, Cladosporium</i>
10/19/2021	Plaza	Room 167	AC4	Uninsulated	Supply	Louver	TL-11	Yes	<i>Cladosporium</i>

Table 4. AC4 Summary of Surface Sampling Results Roderick L. Ireland Courthouse, Springfield, Massachusetts October 12 – October 21, 2021									
Date	Floor	Access Location	Duct Ventilation Zone	Insulated?	Supply or Return Ductwork Sampled	Access Type	Sample ID	Mold Growth Reported by Laboratory?	Comments/General Impression
10/19/2021	Plaza	Room 147	AC4	Uninsulated	Supply	Louver	TL-13	Yes	<i>Cladosporium</i>
10/20/2021	Plaza	Room 119	AC4	Uninsulated	Supply	Louver	TL-10	Yes	<i>Aureobasidium</i> , <i>Cladosporium</i>
10/20/2021	Plaza	Room 114	AC4	Uninsulated	Supply	Louver	TL-11	Yes	<i>Cladosporium</i>
10/21/2021	Plaza	Room 110B at room 107	AC4	Uninsulated	Supply	Louver	TL-14	Yes	<i>Aureobasidium</i> , <i>Cladosporium</i>
10/21/2021	Plaza	Room 103	AC4	Uninsulated	Supply	Louver	TL-16	Yes	<i>Aureobasidium</i> , <i>Cladosporium</i>
10/21/2021	Plaza	Hall at room 102	AC4	Uninsulated	Supply	Louver	TL-17	Yes	<i>Aureobasidium</i> , <i>Cladosporium</i>

Appendix 2 Analytical Laboratory Reports



EMSL Analytical, Inc.

5 Constitution Way, Unit A Woburn, MA 01801

Tel/Fax: (781) 933-8411 / (781) 933-8412

<http://www.EMSL.com> / bostonlab@emsl.com

EMSL Order: 132107478

Customer ID: COVI50

Customer PO: 458085

Project ID:

Attention: Ann D. Eckmann

TRC

300 Wildwood Avenue

Woburn, MA 01801

Phone: (781) 933-2555

Fax:

Collected Date: 10/04/2021

Received Date: 10/06/2021

Analyzed Date: 10/07/2021

Project: 458085

Test Report: Microscopic Examination of Fungal Spores, Fungal Structures, Hyphae, and Other Particulates from Bulk Samples (EMSL Method MICRO-SOP-200)

Lab Sample Number: Client Sample ID: Sample Location:	132107478-0008 B-1 4th Floor, Courtroom 1, Duct at Lateral Return Louver	132107478-0009 B-2 4th Floor, Room 427, Metal Return Duct			
Spore Types	Category	Category			
Alternaria (Ulocladium)	-	-			
Ascospores	-	-			
Aspergillus/Penicillium	-	-			
Basidiospores	Rare	Rare			
Bipolaris++	-	-			
Chaetomium++	-	-			
Cladosporium	Rare	Rare			
Curvularia	-	-			
Epicoccum	-	-			
Fusarium++	-	-			
Ganoderma	-	-			
Myxomycetes++	Rare	Rare			
Pithomyces++	-	-			
Rust	-	-			
Scopulariopsis/Microascus	-	-			
Stachybotrys/Memnoniella	-	-			
Unidentifiable Spores	-	-			
Zygomycetes	-	-			
Aureobasidium++	Rare	-			
Hyphal Fragment	-	-			
Insect Fragment	-	-			
Pollen	-	-			
Fibrous Particulate	-	-			

Category: Count/per area analyzed - Rare: 1 to 10 Low: 11 to 100 Medium: 101 to 1000 High: >1000

- Denotes Not Detected.

++ Includes other spores with similar morphology; see EMSL's fungal glossary for each specific category.

* = Sample contains fruiting structures and/or hyphae associated with the spores.

No discernable field blank was submitted with this group of samples.

Steve Grise, Laboratory Manager
or other Approved Signatory

EMSL maintains liability limited to cost of analysis. Interpretation and use of test results are the responsibility of the client. This report relates only to the samples reported above, and may not be reproduced, except in full, without written approval by EMSL. EMSL bears no responsibility for sample collection activities or analytical method limitations. The report reflects the samples as received. Results are generated from the field sampling data (sampling volumes and areas, locations, etc.) provided by the client on the Chain of Custody. Samples are within quality control criteria and met method specifications unless otherwise noted.

Samples analyzed by EMSL Analytical, Inc. Woburn, MA IHA-LAP, LLC-EMLAP Accredited #180179

Initial report from: 10/07/2021 09:24 AM

For information on the fungi listed in this report, please visit the Resources section at www.emsl.com



EMSL Analytical, Inc.

5 Constitution Way, Unit A Woburn, MA 01801

Tel/Fax: (781) 933-8411 / (781) 933-8412

<http://www.EMSL.com> / bostonlab@emsl.com

EMSL Order: 132107478

Customer ID: COVI50

Customer PO: 458085

Project ID:

Attention: Ann D. Eckmann

TRC

300 Wildwood Avenue

Woburn, MA 01801

Phone: (781) 933-2555

Fax:

Collected Date: 10/04/2021

Received Date: 10/06/2021

Analyzed Date: 10/07/2021

Project: 458085

Test Report: Microscopic Examination of Fungal Spores, Fungal Structures, Hyphae, and Other Particulates from Tape Samples (EMSL Method MICRO-SOP-200)

Lab Sample Number: Client Sample ID: Sample Location:	132107478-0001 TL-1 4th Floor, Room 426, Metal Supply Duct	132107478-0002 TL-2 4th Floor, Room 427, Metal Supply Duct	132107478-0003 TL-3 4th Floor, Hall at Elevator H2, Insulated Supply Duct	132107478-0004 TL-4 4th Floor, Probate Outside Room 444, Insulated Supply Duct	132107478-0005 TL-5 4th Floor, Registry of Probate, Insulated Supply Duct
Spore Types	Category	Category	Category	Category	Category
Alternaria (Ulocladium)	-	-	-	Rare	-
Ascospores	Rare	-	-	-	-
Aspergillus/Penicillium	-	-	-	-	-
Basidiospores	-	Rare	-	-	-
Bipolaris++	-	-	-	-	-
Chaetomium++	-	-	-	-	-
Cladosporium	Rare	Rare	*Low*	Rare	Rare
Curvularia	-	-	-	-	-
Epicoccum	Rare	-	-	-	-
Fusarium++	-	-	-	-	-
Ganoderma	-	-	-	-	-
Myxomycetes++	-	Low	-	-	Low
Pithomyces++	-	-	-	-	-
Rust	-	-	-	-	-
Scopulariopsis/Microascus	-	-	-	-	-
Stachybotrys/Memnoniella	-	-	-	-	-
Unidentifiable Spores	-	-	-	-	-
Zygomycetes	-	-	-	-	-
Aureobasidium++	-	-	*High*	Rare	Rare
Hyphal Fragment	-	-	-	-	-
Insect Fragment	-	-	-	-	-
Pollen	Medium	Medium	-	High	Medium
Fibrous Particulate	-	-	-	-	-

Category: Count/per area analyzed - Rare: 1 to 10 Low: 11 to 100 Medium: 101 to 1000 High: >1000

- Denotes Not Detected.

++ Includes other spores with similar morphology; see EMSL's fungal glossary for each specific category.

* = Sample contains fruiting structures and/or hyphae associated with the spores.

No discernable field blank was submitted with this group of samples.

Steve Grise, Laboratory Manager
or other Approved Signatory

EMSL maintains liability limited to cost of analysis. Interpretation and use of test results are the responsibility of the client. This report relates only to the samples reported above and may not be reproduced, except in full, without written approval by EMSL. EMSL bears no responsibility for sample collection activities or analytical method limitations. The report reflects the samples as received. Results are generated from the field sampling data (sampling volumes and areas, locations, etc.) provided by the client on the Chain of Custody. Samples are within quality control criteria and met method specifications unless otherwise noted.

Samples analyzed by EMSL Analytical, Inc. Woburn, MA IHA-LAP, LLC-EMLAP Accredited #180179

Initial report from: 10/07/2021 09:24 AM

For information on the fungi listed in this report, please visit the Resources section at www.emsl.com



EMSL Analytical, Inc.

5 Constitution Way, Unit A Woburn, MA 01801

Tel/Fax: (781) 933-8411 / (781) 933-8412

<http://www.EMSL.com> / bostonlab@emsl.com

EMSL Order: 132107478

Customer ID: COVI50

Customer PO: 458085

Project ID:

Attention: Ann D. Eckmann

TRC

300 Wildwood Avenue

Woburn, MA 01801

Phone: (781) 933-2555

Fax:

Collected Date: 10/04/2021

Received Date: 10/06/2021

Analyzed Date: 10/07/2021

Project: 458085

Test Report: Microscopic Examination of Fungal Spores, Fungal Structures, Hyphae, and Other Particulates from Tape Samples (EMSL Method MICRO-SOP-200)

Lab Sample Number: Client Sample ID: Sample Location:	132107478-0006 TL-6 4th Floor, Registry of Probate, Metal Supply Duct	132107478-0007 TL-7 4th Floor, Registry of Probate, Metal Return Duct			
Spore Types	Category	Category			
Alternaria (Ulocladium)	-	-			
Ascospores	-	-			
Aspergillus/Penicillium	-	-			
Basidiospores	Rare	Rare			
Bipolaris++	-	-			
Chaetomium++	-	-			
Cladosporium	Rare	Rare			
Curvularia	-	-			
Epicoccum	-	-			
Fusarium++	-	-			
Ganoderma	-	-			
Myxomycetes++	Rare	-			
Pithomyces++	-	Rare			
Rust	-	-			
Scopulariopsis/Microascus	-	-			
Stachybotrys/Memnoniella	-	-			
Unidentifiable Spores	-	-			
Zygomycetes	-	-			
Aureobasidium++	-	-			
Hyphal Fragment	-	-			
Insect Fragment	-	-			
Pollen	-	-			
Fibrous Particulate	-	-			

Category: Count/per area analyzed - Rare: 1 to 10 Low: 11 to 100 Medium: 101 to 1000 High: >1000

- Denotes Not Detected.

++ Includes other spores with similar morphology; see EMSL's fungal glossary for each specific category.

* = Sample contains fruiting structures and/or hyphae associated with the spores.

Steve Grise, Laboratory Manager
or other Approved Signatory

No discernable field blank was submitted with this group of samples.

EMSL maintains liability limited to cost of analysis. Interpretation and use of test results are the responsibility of the client. This report relates only to the samples reported above and may not be reproduced, except in full, without written approval by EMSL. EMSL bears no responsibility for sample collection activities or analytical method limitations. The report reflects the samples as received. Results are generated from the field sampling data (sampling volumes and areas, locations, etc.) provided by the client on the Chain of Custody. Samples are within quality control criteria and met method specifications unless otherwise noted.

Samples analyzed by EMSL Analytical, Inc. Woburn, MA IHA-LAP, LLC-EMLAP Accredited #180179

Initial report from: 10/07/2021 09:24 AM

For information on the fungi listed in this report, please visit the Resources section at www.emsl.com



EMSL ANALYTICAL, INC.
TESTING LABS • PRODUCTS • TRAINING

Microbiology Chain of Custody Form

EMSL Order Number / Lab Use Only

EMSL Analytical, Inc.
200 Route 130 North
Cinnaminson, NJ 08077

132107478

PHONE: (800) 220-3675

EMAIL: CinnMicroLab@emsl.com

If Bill-To is the same as Report-To leave this section blank. Third-party billing requires written authorization.

Customer Information	Customer ID:	Billing ID:
	Company Name: TRE	Company Name:
	Contact Name: Am Eckmann / Mike McCarter	Billing Contact:
	Street Address: 300 W. Dwyer Ave	Street Address:
	City, State, Zip: Woburn MA 01801	City, State, Zip:
	Country:	Country:
	Phone: 603 396 2000	Phone:
Email(s) for Report: Aeckmann@TREcorporations.com / mcmccarter@TREcorporations.com	Email(s) for Invoice: aeckmann@TREcorporations.com	

Project Name/No: 458085		Purchase Order:
EMSL LIMS Project ID: (If applicable, EMSL will provide)	State Samples Collected:	Zip Code Samples Collected:
State of Connecticut (CT) must select project location:		
<input type="checkbox"/> Commercial (Taxable) <input type="checkbox"/> Residential (Non-taxable)		
Sampled By Name: Michael McCarter	Sampled By Signature: <i>[Signature]</i>	No. of Samples in Shipment

Sterile, Sodium Thiosulfate Preserved Bottle Used: <input type="checkbox"/>		Biocide Used in Source (specify)
Public Water Supply Samples: <input type="checkbox"/> Note: All results may automatically be reported to DOH if required by State.		
Turn-Around-Time (TAT) Please call ahead for large projects and/or turnaround times 6 Hours or Less. *32 Hour TAT available for select tests only; samples must be submitted by 11:30am.		
<input type="checkbox"/> 3 Hour <input type="checkbox"/> 6 Hour <input checked="" type="checkbox"/> 24 Hour <input type="checkbox"/> 32 Hour <input type="checkbox"/> 48 Hour <input type="checkbox"/> 72 Hour <input type="checkbox"/> 96 Hour <input type="checkbox"/> 1 Week <input type="checkbox"/> 2 Week		

MICROBIOLOGY TEST CODES			
M001 Air-O-Cell	M174 MoldSnap	M012 Pseudomonas aeruginosa (P/A***)	M115 Sewage Screen - Water (P/A***)
M030 Micro 5	M032 Allergenco-D	M024 Pseudomonas aeruginosa (MFT*)	M116 Sewage Screen - Water (MPN**)
M041 Fungal Direct Examination		M015 Heterotrophic Plate Count	M117 Sewage Screen - Swab (P/A***)
M169 Pollen ID & Enumeration		M017 Total Coliform & E. Coli (Colilert P/A***)	M013 Sewage Screen - Swab (MFT*)
M280 Dust Characterization Level-1		M018 Total Coliform & E. Coli (MFT*)	M730 Methicillin-resistant Staph. aureus (MRSA)
M281 Dust Characterization Level-2		M114 Total Coliform & E. Coli Enumeration (Colilert MPN**)	M031 Rapid-growing non-TB Mycobacteria Detection & Enumeration
M005 Viable Fungi-Air Samples (Genus ID & Count)		M019 Fecal Coliform (MFT*)	M014 Endotoxin Analysis
M006 Viable Fungi-Air Samples (Includes Penicillium, Aspergillus, Cladosporium, Stachybotrys Species ID & Count)		M020 Fecal Streptococcus (MFT*)	M044 Group Allergen (Cat, Dog, Cockroach, Dust Mite)
M007 Culturable Fungi-Surface Samples (Genus ID & Count)		M029 Enterococci (MFT*)	M095 Bacteroides
M008 Culturable Fungi-Surface Samples (Includes Penicillium, Aspergillus, Cladosporium, Stachybotrys Species ID & Count)		M129 Enterococci (Enterolert P/A***)	Other - See Analytical Price Guide for Test Code
M009 Bacteria Culture Gram Stain & Count		M180 Real Time qPCR-ERMI 36 Panel	Legionella Analysis Please use EMSL Legionella COC
M010 Bacteria Count & ID - 3 Most Prominent		M025 Sewage Screen - Water (MFT*)	
M011 Bacteria Count & ID - 5 Most Prominent			

Sample #	Sample Location/Description	Sample Type (Matrix)	Potable / Non-Potable (Only for Water)	Test Code	Volume/Area	Date / Time Collected	Temperature (Lab Use Only)
Example: Sample 1	Kitchen	Water	Potable	M017	1,000 ml	1/1/2021 3:30pm	
	See next page						

REC'D **RHB 0850 DRP 34**
EMSL-BOSTON **OCT 06 2021**

Special Instructions and/or Regulatory Requirements (Sample Specifications, Processing Methods, Limits of Detection, etc.)	
--	--

Method of Shipment:		Sample Condition Upon Receipt:	
Relinquished by: <i>[Signature]</i>	Date/Time: 10-4-21	Received by:	Date/Time:
Relinquished by:	Date/Time:	Received by:	Date/Time:

Controlled Document - COC-34 Micro R13 03/02/2021

☐ AGREE TO ELECTRONIC SIGNATURE (By checking, I consent to signing this Chain of Custody document by electronic signature.)

EMSL Analytical, Inc.'s Laboratory Terms and Conditions are incorporated into this Chain of Custody by reference in their entirety. Submission of samples to EMSL Analytical, Inc. constitutes acceptance and acknowledgment of all terms and conditions by Customer.

132107478

Page 2 Of 2



EMSL Analytical, Inc.

5 Constitution Way, Unit A Woburn, MA 01801

Tel/Fax: (781) 933-8411 / (781) 933-8412

<http://www.EMSL.com> / bostonlab@emsl.com

EMSL Order: 132107480

Customer ID: COVI50

Customer PO: 458085

Project ID:

Attention: Ann D. Eckmann

TRC

300 Wildwood Avenue

Woburn, MA 01801

Phone: (781) 933-2555

Fax:

Collected Date: 10/05/21

Received Date: 10/06/2021

Analyzed Date: 10/07/2021

Project: 458085 - Springfield

Test Report: Microscopic Examination of Fungal Spores, Fungal Structures, Hyphae, and Other Particulates from Tape Samples (EMSL Method MICRO-SOP-200)

Lab Sample Number: Client Sample ID: Sample Location:	132107480-0001 TL-1 4th Floor, Room 426, Metal Return Duct	132107480-0002 TL-2 4th Floor, Hall at Stair 1, Metal Return Duct	132107480-0003 TL-3 4th Floor, Hall at Courtroom 2, Insulated Supply Duct	132107480-0004 TL-4 4th Floor, Hall at Men's 427B, Insulated Supply Duct 427B	132107480-0005 TL-5 4th Floor, Hall at Room 419, Insulated Supply Duct
Spore Types	Category	Category	Category	Category	Category
Alternaria (Ulocladium)	-	-	-	-	-
Ascospores	-	-	-	-	-
Aspergillus/Penicillium	-	-	-	-	-
Basidiospores	-	Rare	-	-	Rare
Bipolaris++	-	-	-	-	-
Chaetomium++	-	-	-	-	-
Cladosporium	Medium	Rare	Low	*High*	Rare
Curvularia	-	-	-	-	-
Epicoccum	-	-	-	-	-
Fusarium++	-	-	-	-	-
Ganoderma	-	-	-	-	-
Myxomycetes++	Rare	Rare	Rare	-	-
Pithomyces++	-	-	-	-	-
Rust	-	-	-	-	-
Scopulariopsis/Microascus	-	-	-	-	-
Stachybotrys/Memnoniella	-	-	-	-	-
Unidentifiable Spores	-	-	-	-	-
Zygomycetes	-	-	-	-	-
Aureobasidium++	-	-	-	*Low*	-
Hyphal Fragment	-	-	-	-	-
Insect Fragment	-	-	-	-	-
Pollen	-	-	Low	-	Rare
Fibrous Particulate	-	-	-	-	-

Category: Count/per area analyzed - Rare: 1 to 10 Low: 11 to 100 Medium: 101 to 1000 High: >1000

- Denotes Not Detected.

++ Includes other spores with similar morphology; see EMSL's fungal glossary for each specific category.

* = Sample contains fruiting structures and/or hyphae associated with the spores.

No discernable field blank was submitted with this group of samples.

Steve Grise, Laboratory Manager
or other Approved Signatory

EMSL maintains liability limited to cost of analysis. Interpretation and use of test results are the responsibility of the client. This report relates only to the samples reported above and may not be reproduced, except in full, without written approval by EMSL. EMSL bears no responsibility for sample collection activities or analytical method limitations. The report reflects the samples as received. Results are generated from the field sampling data (sampling volumes and areas, locations, etc.) provided by the client on the Chain of Custody. Samples are within quality control criteria and met method specifications unless otherwise noted.

Samples analyzed by EMSL Analytical, Inc. Woburn, MA AIHA-LAP, LLC-EMLAP Accredited #180179

Initial report from: 10/07/2021 09:23 AM

For information on the fungi listed in this report, please visit the Resources section at www.emsl.com



EMSL ANALYTICAL, INC.
TESTING LABS • PRODUCTS • TRAINING

Microbiology Chain of Custody Form

EMSL Order Number / Lab Use Only

EMSL Analytical, Inc.
200 Route 130 North
Cinnaminson, NJ 08077

PHONE: (800) 220-3675

EMAIL: CinnMicroLab@emsl.com

132107480

If Bill-To is the same as Report-To leave this section blank. Third-party billing requires written authorization.

Customer Information	Customer ID:	Billing ID:
	Company Name: <u>TRC</u>	Company Name:
	Contact Name: <u>Ann Edmunds / Mike McCarty</u>	Billing Contact:
	Street Address: <u>300 W. 12th Ave</u>	Street Address:
	City, State, Zip: <u>Woburn MA 01801</u>	City, State, Zip:
	Phone: <u>603-396-2600</u>	Phone:
Email(s) for Report: <u>aeckman@TRCcompanies.com / mcarter@TRCcompanies.com</u>	Email(s) for Invoice: <u>aeckman@TRCcompanies.com</u>	

Project Name/No: <u>458085 - Springfield</u>		Purchase Order:
EMSL LIMS Project ID: (If applicable, EMSL will provide)	State Samples Collected:	Zip Code Samples Collected:
Sampled By Name: <u>Michael McCarty</u>		Sampled By Signature: <u>[Signature]</u>
Sterile, Sodium Thiosulfate Preserved Bottle Used: <input type="checkbox"/> Biocide Used in Source (specify)		No. of Samples in Shipment

Public Water Supply Samples: <input type="checkbox"/> Note: All results may automatically be reported to DOH if required by State.	
Turn-Around-Time (TAT) Please call ahead for large projects and/or turnaround times 6 hours or Less. *32 Hour TAT available for select tests only; samples must be submitted by 11:30am.	
<input type="checkbox"/> 3 Hour	<input type="checkbox"/> 6 Hour <input checked="" type="checkbox"/> 24 Hour <input type="checkbox"/> 32* Hour <input type="checkbox"/> 48 Hour <input type="checkbox"/> 72 Hour <input type="checkbox"/> 96 Hour <input type="checkbox"/> 1 Week <input type="checkbox"/> 2 Week

MICROBIOLOGY TEST CODES			
M001 Air-O-Cell	M174 MoldSnap	M012 Pseudomonas aeruginosa (P/A***)	M115 Sewage Screen - Water (P/A***)
M030 Micro 5	M032 Allergenco-D	M024 Pseudomonas aeruginosa (MFT*)	M116 Sewage Screen - Water (MPN**)
M041 Fungal Direct Examination		M015 Heterotrophic Plate Count	M117 Sewage Screen - Swab (P/A***)
M169 Pollen ID & Enumeration		M017 Total Coliform & E. Coli (Colilert P/A***)	M013 Sewage Screen - Swab (MFT*)
M280 Dust Characterization Level-1		M018 Total Coliform & E. Coli (MFT*)	M730 Methicillin-resistant Staph. aureus (MRSA)
M281 Dust Characterization Level-2		M114 Total Coliform & E. Coli Enumeration (Colilert MPN**)	M031 Rapid-growing non-TB Mycobacteria Detection & Enumeration
M005 Viable Fungi-Air Samples (Genus ID & Count)		M019 Fecal Coliform (MFT*)	M014 Endotoxin Analysis
M006 Viable Fungi-Air Samples (Includes Penicillium, Aspergillus, Cladosporium, Stachybotrys Species ID & Count)		M020 Fecal Streptococcus (MFT*)	M044 Group Allergen (Cat, Dog, Cockroach, Dust Mite)
M007 Culturable Fungi-Surface Samples (Genus ID & Count)		M029 Enterococci (MFT*)	M095 Bacteroides
M008 Culturable Fungi-Surface Samples (Includes Penicillium, Aspergillus, Cladosporium, Stachybotrys Species ID & Count)		M129 Enterococci (Enterolert P/A***)	Other - See Analytical Price Guide for Test Code
M009 Bacteria Culture Gram Stain & Count		M180 Real Time qPCR-ERMI 36 Panel	Legionella Analysis Please use EMSL Legionella COC
M010 Bacteria Count & ID - 3 Most Prominent		M025 Sewage Screen - Water (MFT*)	
M011 Bacteria Count & ID - 5 Most Prominent		*MFT= Membrane Filtration Technique	
		**MPN = Most Probable Number	
		***P/A = Presence/Absence	

Sample #	Sample Location/Description	Sample Type (Matrix)	Potable / Non-Potable (Only for Water)	Test Code	Volume/Area	Date / Time Collected	Temperature (Lab Use Only)
Example: Sample 1	Kitchen	Water	Potable	M017	1,000 ml	1/1/2021 3:30pm	

Special Instructions and/or Regulatory Requirements (Sample Specifications, Processing Methods, Limits of Detection, etc.)

Method of Shipment: <u>Drop off @ Lab</u>	Sample Condition Upon Receipt:
Relinquished by: <u>[Signature]</u>	Date/Time: <u>10/5/21</u>
Relinquished by:	Date/Time:
Received by:	Date/Time:
Received by:	Date/Time:

Controlled Document - COC-34 Micro R13 03/02/2021



AGREE TO ELECTRONIC SIGNATURE (By checking, I consent to signing this Chain of Custody document by electronic signature.)

EMSL Analytical, Inc.'s Laboratory Terms and Conditions are incorporated into this Chain of Custody by reference in their entirety. Submission of samples to EMSL Analytical, Inc. constitutes acceptance and acknowledgment of all terms and conditions by Customer.



EMSL Analytical, Inc.

5 Constitution Way, Unit A Woburn, MA 01801
 Tel/Fax: (781) 933-8411 / (781) 933-8412
<http://www.EMSL.com> / bostonlab@emsl.com

EMSL Order: 132107765
Customer ID: COVI50
Customer PO: 458085
Project ID:

Attention: Ann D. Eckmann
 TRC
 300 Wildwood Avenue
 Woburn, MA 01801

Phone: (781) 933-2555

Fax:

Collected Date: 10/06/2021

Received Date: 10/15/2021

Analyzed Date: 10/18/2021

Project: 458085 - Springfield

Test Report: Microscopic Examination of Fungal Spores, Fungal Structures, Hyphae, and Other Particulates from Tape Samples (EMSL Method MICRO-SOP-200)

Lab Sample Number: Client Sample ID: Sample Location:	132107765-0001 TL-1 4th Floor Hall at Stair 2, Insulated Return Duct	132107765-0002 TL-2 4th Floor Hall at Stair 2, Uninsulated Return Duct	132107765-0003 TL-3 4th Floor Hall at Women's 453, Insulated Supply Duct	132107765-0004 TL-4 4th Floor Registry of Deeds Room 407, Uninsulated Supply Duct	132107765-0005 TL-5 4th Floor Registry of Deeds Room 400 at Room 405, Uninsulated Supply Duct
Spore Types	Category	Category	Category	Category	Category
Alternaria (Ulocladium)	-	-	-	-	-
Ascospores	-	-	-	-	-
Aspergillus/Penicillium	-	-	-	-	-
Basidiospores	Low	-	-	-	-
Bipolaris++	-	-	-	-	-
Chaetomium++	-	-	-	-	-
Cladosporium	Low	*Medium*	*High*	*Medium*	*Medium*
Curvularia	-	-	-	-	-
Epicoccum	-	-	-	-	-
Fusarium++	-	-	-	-	-
Ganoderma	-	-	-	-	-
Myxomycetes++	Low	-	-	-	-
Pithomyces++	-	-	-	-	-
Rust	-	-	-	-	-
Scopulariopsis/Microascus	-	-	-	-	-
Stachybotrys/Memnoniella	-	-	-	-	-
Unidentifiable Spores	-	-	-	-	-
Zygomycetes	-	-	-	-	-
Aureobasidium++	-	-	*Medium*	-	-
Hyphal Fragment	-	-	-	-	-
Insect Fragment	-	-	-	-	-
Pollen	Low	-	Medium	-	Low
Fibrous Particulate	-	-	-	-	-

Category: Count/per area analyzed - Rare: 1 to 10 Low: 11 to 100 Medium: 101 to 1000 High: >1000

- Denotes Not Detected.

++ Includes other spores with similar morphology; see EMSL's fungal glossary for each specific category.

* = Sample contains fruiting structures and/or hyphae associated with the spores.

No discernable field blank was submitted with this group of samples.

Steve Grise, Laboratory Manager
 or other Approved Signatory

EMSL maintains liability limited to cost of analysis. Interpretation and use of test results are the responsibility of the client. This report relates only to the samples reported above and may not be reproduced, except in full, without written approval by EMSL. EMSL bears no responsibility for sample collection activities or analytical method limitations. The report reflects the samples as received. Results are generated from the field sampling data (sampling volumes and areas, locations, etc.) provided by the client on the Chain of Custody. Samples are within quality control criteria and met method specifications unless otherwise noted.

Samples analyzed by EMSL Analytical, Inc. Woburn, MA IHA-LAP, LLC-EMLAP Accredited #180179

Initial report from: 10/18/2021 09:56 AM

For information on the fungi listed in this report, please visit the Resources section at www.emsl.com



EMSL Analytical, Inc.

5 Constitution Way, Unit A Woburn, MA 01801

Tel/Fax: (781) 933-8411 / (781) 933-8412

<http://www.EMSL.com> / bostonlab@emsl.com

EMSL Order: 132107765

Customer ID: COVI50

Customer PO: 458085

Project ID:

Attention: Ann D. Eckmann

TRC

300 Wildwood Avenue

Woburn, MA 01801

Phone: (781) 933-2555

Fax:

Collected Date: 10/06/2021

Received Date: 10/15/2021

Analyzed Date: 10/18/2021

Project: 458085 - Springfield

Test Report: Microscopic Examination of Fungal Spores, Fungal Structures, Hyphae, and Other Particulates from Tape Samples (EMSL Method MICRO-SOP-200)

Lab Sample Number: Client Sample ID: Sample Location:	132107765-0006 TL-6 4th Floor Registry of Deeds Room 403, Insulated Supply Duct	132107765-0007 TL-7 4th Floor Registry of Deeds Room 300 at 408B, Uninsulated Return Duct	132107765-0008 TL-8 4th Floor Registry of Deeds Room 450, Uninsulated Return Duct	132107765-0009 TL-9 4th Floor Registry of Deeds Hall at Room 415, Uninsulated Return Duct	
Spore Types	Category	Category	Category	Category	
Alternaria (Ulocladium)	-	-	-	-	
Ascospores	-	-	-	-	
Aspergillus/Penicillium	-	-	-	-	
Basidiospores	-	-	-	-	
Bipolaris++	-	-	-	-	
Chaetomium++	-	-	-	-	
Cladosporium	Low	Low	Low	Low	
Curvularia	-	-	-	-	
Epicoccum	-	-	-	-	
Fusarium++	-	-	-	-	
Ganoderma	-	-	-	-	
Myxomycetes++	-	Low	Low	Low	
Pithomyces++	-	-	-	-	
Rust	-	-	-	-	
Scopulariopsis/Microascus	-	-	-	-	
Stachybotrys/Memnoniella	-	-	-	-	
Unidentifiable Spores	-	-	-	-	
Zygomycetes	-	-	-	-	
Aureobasidium++	-	-	-	-	
Hyphal Fragment	-	-	-	-	
Insect Fragment	-	-	-	-	
Pollen	Medium	-	-	Low	
Fibrous Particulate	-	-	-	-	

Category: Count/per area analyzed - Rare: 1 to 10 Low: 11 to 100 Medium: 101 to 1000 High: >1000

- Denotes Not Detected.

++ Includes other spores with similar morphology; see EMSL's fungal glossary for each specific category.

* = Sample contains fruiting structures and/or hyphae associated with the spores.

No discernable field blank was submitted with this group of samples.

Steve Grise, Laboratory Manager
or other Approved Signatory

EMSL maintains liability limited to cost of analysis. Interpretation and use of test results are the responsibility of the client. This report relates only to the samples reported above and may not be reproduced, except in full, without written approval by EMSL. EMSL bears no responsibility for sample collection activities or analytical method limitations. The report reflects the samples as received. Results are generated from the field sampling data (sampling volumes and areas, locations, etc.) provided by the client on the Chain of Custody. Samples are within quality control criteria and met method specifications unless otherwise noted.

Samples analyzed by EMSL Analytical, Inc. Woburn, MA IHA-LAP, LLC-EMLAP Accredited #180179

Initial report from: 10/18/2021 09:56 AM

For information on the fungi listed in this report, please visit the Resources section at www.emsl.com



EMSL ANALYTICAL, INC.
TESTING LABS • PRODUCTS • TRAINING

Microbiology Chain of Custody Form

EMSL Order Number / Lab Use Only

132107765

EMSL Analytical, Inc.

200 Route 130 North

Cinnaminson, NJ 08077

PHONE: (800) 220-3675

EMAIL: CinnMicroLab@emsl.com

If Bill-To is the same as Report-To leave this section blank. Third-party billing requires written authorization.

Customer Information	Customer ID:		Billing ID:				
	Company Name: TRC		Company Name:				
	Contact Name: AM ECHMAN / Michael McCarter		Billing Contact:				
	Street Address: 300 Wildwood Ave		Street Address:				
	City, State, Zip: Woburn MA 01801	Country:	City, State, Zip:	Country:			
Phone: 603 346 2600		Phone:					
Email(s) for Report: aeckman@TRCcompanies.com / mcmccarter@TRCcompanies.com		Email(s) for Invoice: aeckman@TRCcompanies.com					
Project Information							
Project Name/No: 4580P5-Springfield		Purchase Order:					
EMSL LIMS Project ID: (If applicable, EMSL will provide)	State Samples Collected: 10/1/21	Zip Code Samples Collected:	State of Connecticut (CT) must select project location: <input type="checkbox"/> Commercial (Taxable) <input type="checkbox"/> Residential (Non-taxable)				
Sampled By Name: Michael McCarter	Sampled By Signature: [Signature]	No. of Samples in Shipment					
Sterile, Sodium Thiosulfate Preserved Bottle Used: <input type="checkbox"/> Biocide Used in Source (specify)							
Public Water Supply Samples: <input type="checkbox"/> Note: All results may automatically be reported to DOH if required by State.							
Turn-Around-Time (TAT) Please call ahead for large projects and/or turnaround times 6 Hours or Less. *32 Hour TAT available for select tests only, samples must be submitted by 11:30am.							
<input type="checkbox"/> 3 Hour	<input type="checkbox"/> 6 Hour	<input checked="" type="checkbox"/> 24 Hour	<input type="checkbox"/> 32* Hour	<input type="checkbox"/> 48 Hour <input type="checkbox"/> 72 Hour <input type="checkbox"/> 96 Hour <input type="checkbox"/> 1 Week <input type="checkbox"/> 2 Week			
MICROBIOLOGY TEST CODES							
M001 Air-O-Cell	M174 MoldSnap	M012 Pseudomonas aeruginosa (P/A***)	M115 Sewage Screen - Water (P/A***)				
M030 Micro 5	M032 Allergenco-D	M024 Pseudomonas aeruginosa (MFT*)	M116 Sewage Screen - Water (MPN**)				
M041 Fungal Direct Examination		M015 Heterotrophic Plate Count	M117 Sewage Screen - Swab (P/A***)				
M169 Pollen ID & Enumeration		M017 Total Coliform & E. Coli (Colilert P/A***)	M013 Sewage Screen - Swab (MFT*)				
M280 Dust Characterization Level-1		M018 Total Coliform & E. Coli (MFT*)	M730 Methicillin-resistant Staph. aureus (MRSA)				
M281 Dust Characterization Level-2		M114 Total Coliform & E. Coli Enumeration (Colilert MPN**)	M031 Rapid-growing non-TB Mycobacteria Detection & Enumeration				
M005 Viable Fungi-Air Samples (Genus ID & Count)		M019 Fecal Coliform (MFT*)	M014 Endotoxin Analysis				
M006 Viable Fungi-Air Samples (Includes Penicillium, Aspergillus, Cladosporium, Stachybotrys Species ID & Count)		M020 Fecal Streptococcus (MFT*)	M044 Group Allergen (Cat, Dog, Cockroach, Dust Mite)				
M007 Culturable Fungi-Surface Samples (Genus ID & Count)		M029 Enterococci (MFT*)	M095 Bacteroides				
M008 Culturable Fungi-Surface Samples (Includes Penicillium, Aspergillus, Cladosporium, Stachybotrys Species ID & Count)		M129 Enterococci (Enterolert P/A***)	Other - See Analytical Price Guide for Test Code				
M009 Bacteria Culture Gram Stain & Count		M180 Real Time qPCR-ERMI 36 Panel	Legionella Analysis Please use EMSL Legionella COC				
M010 Bacteria Count & ID - 3 Most Prominent		M025 Sewage Screen - Water (MFT*)					
M011 Bacteria Count & ID - 5 Most Prominent		*MFT= Membrane Filtration Technique					
		**MPN = Most Probable Number					
		***P/A = Presence/Absence					
Sample #	Sample Location/Description	Sample Type (Matrix)	Potable / Non-Potable (Only for Water)	Test Code	Volume/Area	Date / Time Collected	Temperature (Lab Use Only)
Example: Sample 1	Kitchen	Water	Potable	M017	1,000 ml	1/1/2021 3:30pm	
	See Attached						
Special Instructions and/or Regulatory Requirements (Sample Specifications, Processing Methods, Limits of Detection, etc.)							
Method of Shipment: Droped Samples @ Lab				Sample Condition Upon Receipt			
Relinquished by: [Signature]		Date/Time: 10-15-21		Received by: [Signature]		Date/Time: OCT 15 2021	
Relinquished by:		Date/Time:		Received by:		Date/Time:	

Controlled Document - COC-34 Micro R13 03/02/2021

☐ AGREE TO ELECTRONIC SIGNATURE (By checking, I consent to signing this Chain of Custody document by electronic signature.)

EMSL Analytical, Inc.'s Laboratory Terms and Conditions are incorporated into this Chain of Custody by reference in their entirety. Submission of samples to EMSL Analytical, Inc. constitutes acceptance and acknowledgment of all terms and conditions by Customer.

EMAIL CinnMicroLab@emsl.com

Additional Pages of the Chain of Custody are only necessary if needed for additional sample information

Special Instructions and/or Regulatory Requirements (Sample Specifications, Processing Methods, Limits of Detection, etc.)

Controlled Document - COC-34 Micro R13 3/02/2021

Page 2 Of 2



EMSL Analytical, Inc.

5 Constitution Way, Unit A Woburn, MA 01801
 Tel/Fax: (781) 933-8411 / (781) 933-8412
<http://www.EMSL.com> / bostonlab@emsl.com

EMSL Order: 132107764
 Customer ID: COVI50
 Customer PO: 458085
 Project ID:

Attention: Ann D. Eckmann
 TRC
 300 Wildwood Avenue
 Woburn, MA 01801

Phone: (781) 933-2555

Fax:

Collected Date: 10/07/2021

Received Date: 10/15/2021

Analyzed Date: 10/18/2021

Project: 458085 - Springfield

Test Report: Microscopic Examination of Fungal Spores, Fungal Structures, Hyphae, and Other Particulates from Tape Samples (EMSL Method MICRO-SOP-200)

Lab Sample Number: Client Sample ID: Sample Location:	132107764-0001 TL-1 4th Floor Registry of Deeds Room 411, Uninsulated Duct, Return	132107764-0002 TL-2 4th Floor Room 446 at Stair 1, Insulated Return Duct	132107764-0003 TL-3 4th Floor Room 446 at Men's Room, Uninsulated Return	132107764-0004 TL-4 4th Floor Room 446 at Center of Room, Insulated Supply Duct	132107764-0005 TL-5 4th Floor Room 446 at Room 446D, Uninsulated Return Duct
Spore Types	Category	Category	Category	Category	Category
Alternaria (Ulocladium)	-	-	-	-	-
Ascospores	-	-	-	-	-
Aspergillus/Penicillium	-	-	-	-	-
Basidiospores	Rare	Rare	Rare	-	Rare
Bipolaris++	-	-	-	-	-
Chaetomium++	-	-	-	-	-
Cladosporium	Low	Rare	Low	*High*	Low
Curvularia	-	-	-	-	-
Epicoccum	-	-	-	-	-
Fusarium++	-	-	-	-	-
Ganoderma	-	-	-	-	-
Myxomycetes++	Rare	-	Rare	-	Rare
Pithomyces++	-	-	-	-	-
Rust	-	-	-	-	-
Scopulariopsis/Microascus	-	-	-	-	-
Stachybotrys/Memnoniella	-	-	-	-	-
Unidentifiable Spores	-	-	-	-	-
Zygomycetes	-	-	-	-	-
Hyphal Fragment	-	-	-	-	-
Insect Fragment	-	-	-	-	-
Pollen	-	Medium	Low	-	-
Fibrous Particulate	-	-	-	-	-

Category: Count/per area analyzed - Rare: 1 to 10 Low: 11 to 100 Medium: 101 to 1000 High: >1000

- Denotes Not Detected.

++ Includes other spores with similar morphology; see EMSL's fungal glossary for each specific category.

* = Sample contains fruiting structures and/or hyphae associated with the spores.

No discernable field blank was submitted with this group of samples.

Steve Grise, Laboratory Manager
 or other Approved Signatory

EMSL maintains liability limited to cost of analysis. Interpretation and use of test results are the responsibility of the client. This report relates only to the samples reported above and may not be reproduced, except in full, without written approval by EMSL. EMSL bears no responsibility for sample collection activities or analytical method limitations. The report reflects the samples as received. Results are generated from the field sampling data (sampling volumes and areas, locations, etc.) provided by the client on the Chain of Custody. Samples are within quality control criteria and met method specifications unless otherwise noted.

Samples analyzed by EMSL Analytical, Inc. Woburn, MA AIHA-LAP, LLC-EMLAP Accredited #180179

Initial report from: 10/18/2021 09:53 AM

For information on the fungi listed in this report, please visit the Resources section at www.emsl.com



EMSL Analytical, Inc.

5 Constitution Way, Unit A Woburn, MA 01801

Tel/Fax: (781) 933-8411 / (781) 933-8412

<http://www.EMSL.com> / bostonlab@emsl.com

EMSL Order: 132107764

Customer ID: COVI50

Customer PO: 458085

Project ID:

Attention: Ann D. Eckmann

TRC

300 Wildwood Avenue

Woburn, MA 01801

Phone: (781) 933-2555

Fax:

Collected Date: 10/07/2021

Received Date: 10/15/2021

Analyzed Date: 10/18/2021

Project: 458085 - Springfield

Test Report: Microscopic Examination of Fungal Spores, Fungal Structures, Hyphae, and Other Particulates from Tape Samples (EMSL Method MICRO-SOP-200)

Lab Sample Number: Client Sample ID: Sample Location:	132107764-0006 TL-6 4th Floor Room 446 North Corner, Insulated Supply Duct	132107764-0007 TL-7 4th Floor Room 446-Room 446D, Uninsulated Return			
Spore Types	Category	Category			
Alternaria (Ulocladium)	-	-			
Ascospores	-	-			
Aspergillus/Penicillium	-	-			
Basidiospores	-	-			
Bipolaris++	-	-			
Chaetomium++	-	-			
Cladosporium	-	Low			
Curvularia	-	-			
Epicoccum	-	-			
Fusarium++	-	-			
Ganoderma	-	-			
Myxomycetes++	-	-			
Pithomyces++	-	-			
Rust	-	-			
Scopulariopsis/Microascus	-	-			
Stachybotrys/Memnoniella	-	-			
Unidentifiable Spores	-	-			
Zygomycetes	-	-			
Hyphal Fragment	-	-			
Insect Fragment	-	-			
Pollen	Medium	Low			
Fibrous Particulate	-	-			

Category: Count/per area analyzed - Rare: 1 to 10 Low: 11 to 100 Medium: 101 to 1000 High: >1000

- Denotes Not Detected.

++ Includes other spores with similar morphology; see EMSL's fungal glossary for each specific category.

* = Sample contains fruiting structures and/or hyphae associated with the spores.

No discernable field blank was submitted with this group of samples.

Steve Grise, Laboratory Manager
or other Approved Signatory

EMSL maintains liability limited to cost of analysis. Interpretation and use of test results are the responsibility of the client. This report relates only to the samples reported above and may not be reproduced, except in full, without written approval by EMSL. EMSL bears no responsibility for sample collection activities or analytical method limitations. The report reflects the samples as received. Results are generated from the field sampling data (sampling volumes and areas, locations, etc.) provided by the client on the Chain of Custody. Samples are within quality control criteria and met method specifications unless otherwise noted.

Samples analyzed by EMSL Analytical, Inc. Woburn, MA IHA-LAP, LLC-EMLAP Accredited #180179

Initial report from: 10/18/2021 09:53 AM

For information on the fungi listed in this report, please visit the Resources section at www.emsl.com



EMSL ANALYTICAL, INC.
TESTING LABS • PRODUCTS • TRAINING

Microbiology Chain of Custody Form

EMSL Order Number / Lab Use Only

132107764

EMSL Analytical, Inc.
200 Route 130 North
Cinnaminson, NJ 08077

PHONE: (800) 220-3675

EMAIL: CinnMicroLab@emsl.com

If Bill-To is the same as Report-To leave this section blank. Third-party billing requires written authorization.

Customer Information	Customer ID:	Billing ID:
	Company Name: <i>TRE</i>	Company Name:
	Contact Name: <i>Amelchman / Mike McCarter</i>	Billing Contact:
	Street Address: <i>300 W. 12th Ave</i>	Street Address:
	City, State, Zip: <i>Wichita KS 67201</i>	City, State, Zip: Country:
	Phone: <i>603-396-2600</i>	Phone:
Email(s) for Report: <i>amelchman@tre.com / mcmccarter@tre.com</i>	Email(s) for Invoice: <i>amelchman@tre.com</i>	

Project Name: <i>458085 - Springs 012</i>		Purchase Order:
EMSL LIMS Project ID: (If applicable, EMSL will provide)	State Samples Collected: <i>MA</i>	Zip Code Samples Collected:
State of Connecticut (CT) must select project location:	<input type="checkbox"/> Commercial (Taxable) <input type="checkbox"/> Residential (Non-taxable)	
Sampled By Name: <i>Michael McCarter</i>	Sampled By Signature: <i>[Signature]</i>	No. of Samples in Shipment:
Sterile, Sodium Thiosulfate Preserved Bottle Used: <input type="checkbox"/> Biocide Used in Source (specify):		
Public Water Supply Samples: <input type="checkbox"/> Note: All results may automatically be reported to DOH if required by State.		
Turn-Around-Time (TAT) Please call ahead for large projects and/or turnaround times 8 Hours or Less. *32 Hour TAT available for select tests only; samples must be submitted by 11:30am.		
<input type="checkbox"/> 3 Hour <input type="checkbox"/> 6 Hour <input checked="" type="checkbox"/> 24 Hour <input type="checkbox"/> 32* Hour <input type="checkbox"/> 48 Hour <input type="checkbox"/> 72 Hour <input type="checkbox"/> 96 Hour <input type="checkbox"/> 1 Week <input type="checkbox"/> 2 Week		

MICROBIOLOGY TEST CODES			
M001 Air-O-Cell	M174 MoldSnap	M012 Pseudomonas aeruginosa (P/A***)	M115 Sewage Screen - Water (P/A***)
M030 Micro 5	M032 Allergenco-D	M024 Pseudomonas aeruginosa (MFT*)	M116 Sewage Screen - Water (MPN**)
M041 Fungal Direct Examination		M015 Heterotrophic Plate Count	M117 Sewage Screen - Swab (P/A***)
M169 Pollen ID & Enumeration		M017 Total Coliform & E. Coli (Colilert P/A***)	M013 Sewage Screen - Swab (MFT*)
M280 Dust Characterization Level-1		M018 Total Coliform & E. Coli (MFT*)	M730 Methicillin-resistant Staph. aureus (MRSA)
M281 Dust Characterization Level-2		M114 Total Coliform & E. Coli Enumeration (Colilert MPN**)	M031 Rapid-growing non-TB Mycobacteria Detection & Enumeration
M005 Viable Fungi-Air Samples (Genus ID & Count)		M019 Fecal Coliform (MFT*)	M014 Endotoxin Analysis
M006 Viable Fungi-Air Samples (Includes Penicillium, Aspergillus, Cladosporium, Stachybotrys Species ID & Count)		M020 Fecal Streptococcus (MFT*)	M044 Group Allergen (Cat, Dog, Cockroach, Dust Mite)
M007 Culturable Fungi-Surface Samples (Genus ID & Count)		M029 Enterococci (MFT*)	M095 Bacteroides
M008 Culturable Fungi-Surface Samples (Includes Penicillium, Aspergillus, Cladosporium, Stachybotrys Species ID & Count)		M129 Enterococci (Enterolert P/A***)	Other - See Analytical Price Guide for Test Code
M009 Bacteria Culture Gram Stain & Count		M180 Real Time qPCR-ERMI 36 Panel	Legionella Analysis Please use EMSL Legionella COC
M010 Bacteria Count & ID - 3 Most Prominent		M025 Sewage Screen - Water (MFT*)	
M011 Bacteria Count & ID - 5 Most Prominent		*MFT= Membrane Filtration Technique	
		**MPN = Most Probable Number	
		***P/A = Presence/Absence	

Sample #	Sample Location/Description	Sample Type (Matrix)	Potable / Non-Potable (Only for Water)	Test Code	Volume/Area	Date / Time Collected	Temperature (Lab Use Only)
Example: Sample 1	Kitchen	Water	Potable	M017	1,000 ml	1/1/2021 3:30pm	

Special Instructions and/or Regulatory Requirements (Sample Specifications, Processing Methods, Limits of Detection, etc.)

Method of Shipment: <i>Drop 2 all @ Lab</i>	Sample Condition Upon Receipt:
Relinquished by: <i>Michael McCarter</i>	Date/Time: <i>10-15-21</i>
Relinquished by:	Date/Time:
Received by: <i>[Signature]</i>	Date/Time: <i>10-15-21</i>
Received by:	Date/Time:

Controlled Document - COC-34 Micro R13 03/02/2021

☐ AGREE TO ELECTRONIC SIGNATURE (By checking, I consent to signing this Chain of Custody document by electronic signature.)

EMSL Analytical, Inc.'s Laboratory Terms and Conditions are incorporated into this Chain of Custody by reference in their entirety. Submission of samples to EMSL Analytical, Inc. constitutes acceptance and acknowledgment of all terms and conditions by Customer.



EMSL Analytical, Inc.

5 Constitution Way, Unit A Woburn, MA 01801

Tel/Fax: (781) 933-8411 / (781) 933-8412

<http://www.EMSL.com> / bostonlab@emsl.com

EMSL Order: 132107762

Customer ID: COVI50

Customer PO: 458085

Project ID:

Attention: Ann D. Eckmann

TRC

300 Wildwood Avenue

Woburn, MA 01801

Phone: (781) 933-2555

Fax:

Collected Date: 10/12/2021

Received Date: 10/15/2021

Analyzed Date: 10/18/2021

Project: 458085 - Springfield

Test Report: Microscopic Examination of Fungal Spores, Fungal Structures, Hyphae, and Other Particulates from Tape Samples (EMSL Method MICRO-SOP-200)

Lab Sample Number: Client Sample ID: Sample Location:	132107762-0001 TL-1 3rd Floor Women's Room 389, Uninsulated Supply Duct	132107762-0002 TL-2 3rd Floor Men's Room 390, Uninsulated Supply Duct	132107762-0003 TL-3 3rd Floor Hall at Stair 2, Uninsulated Return Duct	132107762-0004 TL-4 3rd Floor Hall at Law Library, Return at Linear Diffuser, Uninsulated	132107762-0005 TL-5 3rd Floor Hall at Stair 3, Uninsulated Supply Duct
Spore Types	Category	Category	Category	Category	Category
Alternaria (Ulocladium)	-	-	-	-	-
Ascospores	-	-	-	-	-
Aspergillus/Penicillium	-	-	-	Low	-
Basidiospores	-	Rare	-	-	-
Bipolaris++	-	-	-	-	-
Chaetomium++	-	-	-	-	-
Cladosporium	-	Rare	Low	*Medium*	Rare
Curvularia	-	-	-	-	-
Epicoccum	-	-	-	-	-
Fusarium++	-	-	-	-	-
Ganoderma	-	-	-	-	-
Myxomycetes++	-	-	-	-	Rare
Pithomyces++	-	-	-	-	-
Rust	-	-	-	-	-
Scopulariopsis/Microascus	-	-	-	-	-
Stachybotrys/Memnoniella	-	-	-	-	-
Unidentifiable Spores	-	-	-	-	-
Zygomycetes	-	-	-	-	-
Aureobasidium++	-	Low	-	*Medium*	Rare
Hyphal Fragment	-	-	-	-	-
Insect Fragment	-	-	-	-	-
Pollen	-	-	-	-	-
Fibrous Particulate	-	-	-	-	-

Sample Comment: 132107762-0001 - None Detected

Category: Count/per area analyzed - Rare: 1 to 10 Low: 11 to 100 Medium: 101 to 1000 High: >1000

- Denotes Not Detected.

++ Includes other spores with similar morphology; see EMSL's fungal glossary for each specific category.

* = Sample contains fruiting structures and/or hyphae associated with the spores.

No discernable field blank was submitted with this group of samples.

Steve Grise, Laboratory Manager
or other Approved Signatory

EMSL maintains liability limited to cost of analysis. Interpretation and use of test results are the responsibility of the client. This report relates only to the samples reported above and may not be reproduced, except in full, without written approval by EMSL. EMSL bears no responsibility for sample collection activities or analytical method limitations. The report reflects the samples as received. Results are generated from the field sampling data (sampling volumes and areas, locations, etc.) provided by the client on the Chain of Custody. Samples are within quality control criteria and met method specifications unless otherwise noted.

Samples analyzed by EMSL Analytical, Inc. Woburn, MA IHA-LAP, LLC-EMLAP Accredited #180179

Initial report from: 10/18/2021 09:59 AM

For information on the fungi listed in this report, please visit the Resources section at www.emsl.com



EMSL Analytical, Inc.

5 Constitution Way, Unit A Woburn, MA 01801

Tel/Fax: (781) 933-8411 / (781) 933-8412

<http://www.EMSL.com> / bostonlab@emsl.com

EMSL Order: 132107762

Customer ID: COVI50

Customer PO: 458085

Project ID:

Attention: Ann D. Eckmann

TRC

300 Wildwood Avenue

Woburn, MA 01801

Phone: (781) 933-2555

Fax:

Collected Date: 10/12/2021

Received Date: 10/15/2021

Analyzed Date: 10/18/2021

Project: 458085 - Springfield

Test Report: Microscopic Examination of Fungal Spores, Fungal Structures, Hyphae, and Other Particulates from Tape Samples (EMSL Method MICRO-SOP-200)

Lab Sample Number: Client Sample ID: Sample Location:	132107762-0006 TL-6 3rd Floor Hall at Room 381, Uninsulated Return Duct	132107762-0007 TL-7 3rd Floor Hall at Stair 1, Uninsulated Return Duct			
Spore Types	Category	Category			
Alternaria (Ulocladium)	-	-			
Ascospores	-	-			
Aspergillus/Penicillium	-	-			
Basidiospores	-	-			
Bipolaris++	-	-			
Chaetomium++	-	-			
Cladosporium	Low	*High*			
Curvularia	-	-			
Epicoccum	-	-			
Fusarium++	-	-			
Ganoderma	-	-			
Myxomycetes++	-	-			
Pithomyces++	-	-			
Rust	-	-			
Scopulariopsis/Microascus	-	-			
Stachybotrys/Memnoniella	-	-			
Unidentifiable Spores	-	-			
Zygomycetes	-	-			
Aureobasidium++	-	*Medium*			
Hyphal Fragment	-	-			
Insect Fragment	-	-			
Pollen	-	-			
Fibrous Particulate	-	-			

Category: Count/per area analyzed - Rare: 1 to 10 Low: 11 to 100 Medium: 101 to 1000 High: >1000

- Denotes Not Detected.

++ Includes other spores with similar morphology; see EMSL's fungal glossary for each specific category.

* = Sample contains fruiting structures and/or hyphae associated with the spores.

No discernable field blank was submitted with this group of samples.

Steve Grise, Laboratory Manager
or other Approved Signatory

EMSL maintains liability limited to cost of analysis. Interpretation and use of test results are the responsibility of the client. This report relates only to the samples reported above and may not be reproduced, except in full, without written approval by EMSL. EMSL bears no responsibility for sample collection activities or analytical method limitations. The report reflects the samples as received. Results are generated from the field sampling data (sampling volumes and areas, locations, etc.) provided by the client on the Chain of Custody. Samples are within quality control criteria and met method specifications unless otherwise noted.

Samples analyzed by EMSL Analytical, Inc. Woburn, MA IHA-LAP, LLC-EMLAP Accredited #180179

Initial report from: 10/18/2021 09:59 AM

For information on the fungi listed in this report, please visit the Resources section at www.emsl.com



EMSL ANALYTICAL, INC.
TESTING LABS • PRODUCTS • TRAINING

Microbiology Chain of Custody Form

EMSL Order Number / Lab Use Only

132107762

EMSL Analytical, Inc.
200 Route 130 North
Cinnaminson, NJ 08077

PHONE: (800) 220-3675

EMAIL: CinnMicroLab@emsl.com

If Bill-To is the same as Report-To leave this section blank. Third-party billing requires written authorization.

Customer Information	Customer ID:	Billing ID:
	Company Name: <u>TRE</u>	Company Name:
	Contact Name: <u>AM Eckmann / Michael McCarter</u>	Billing Contact:
	Street Address: <u>300 W. 12th Ave</u>	Street Address:
	City, State, Zip: <u>Woburn MA 01801</u> Country:	City, State, Zip: Country:
	Phone: <u>603-396-2600</u>	Phone:
Email(s) for Report: <u>aeckmann@trecomp.com / m.mccarter@trecomp.com</u>	Email(s) for Invoice:	

Project Name/No: <u>458085 Springfield</u>		Purchase Order:
EMSL LIMS Project ID: (If applicable, EMSL will provide)	State Samples Collected:	Zip Code Samples Collected:
State of Connecticut (CT) must select project location: <input type="checkbox"/> Commercial (Taxable) <input type="checkbox"/> Residential (Non-taxable)		
Sampled By Name: <u>Michael McCarter</u>	Sampled By Signature: <u>[Signature]</u>	No. of Samples in Shipment
Sterile, Sodium Thiosulfate Preserved Bottle Used: <input type="checkbox"/> Biocide Used in Source (specify)		
Public Water Supply Samples: <input type="checkbox"/> Note: All results may automatically be reported to DOH if required by State.		
Turn-Around-Time (TAT) Please call ahead for large projects and/or turnaround times 8 hours or less. *32 Hour TAT available for select tests only; samples must be submitted by 11:30am.		
<input type="checkbox"/> 3 Hour	<input type="checkbox"/> 6 Hour	<input checked="" type="checkbox"/> 24 Hour <input type="checkbox"/> 32* Hour <input type="checkbox"/> 48 Hour <input type="checkbox"/> 72 Hour <input type="checkbox"/> 96 Hour <input type="checkbox"/> 1 Week <input type="checkbox"/> 2 Week

MICROBIOLOGY TEST CODES			
M001 Air-O-Cell	M174 MoldSnap	M012 Pseudomonas aeruginosa (P/A***)	M115 Sewage Screen - Water (P/A***)
M030 Micro 5	M032 Allergenco-D	M024 Pseudomonas aeruginosa (MFT*)	M116 Sewage Screen - Water (MPN**)
M041 Fungal Direct Examination		M015 Heterotrophic Plate Count	M117 Sewage Screen - Swab (P/A***)
M169 Pollen ID & Enumeration		M017 Total Coliform & E. Coli (Colilert P/A***)	M013 Sewage Screen - Swab (MFT*)
M280 Dust Characterization Level-1		M018 Total Coliform & E. Coli (MFT*)	M730 Methicillin-resistant Staph. aureus (MRSA)
M281 Dust Characterization Level-2		M114 Total Coliform & E. Coli Enumeration (Colilert MPN**)	M031 Rapid-growing non-TB Mycobacteria Detection & Enumeration
M005 Viable Fungi-Air Samples (Genus ID & Count)		M019 Fecal Coliform (MFT*)	M014 Endotoxin Analysis
M006 Viable Fungi-Air Samples (Includes Penicillium, Aspergillus, Cladosporium, Stachybotrys Species ID & Count)		M020 Fecal Streptococcus (MFT*)	M044 Group Allergen (Cat, Dog, Cockroach, Dust Mite)
M007 Culturable Fungi-Surface Samples (Genus ID & Count)		M029 Enterococci (MFT*)	M095 Bacteroides
M008 Culturable Fungi-Surface Samples (Includes Penicillium, Aspergillus, Cladosporium, Stachybotrys Species ID & Count)		M129 Enterococci (Enterolert P/A***)	Other - See Analytical Price Guide for Test Code
M009 Bacteria Culture Gram Stain & Count		M180 Real Time qPCR-ERMI 36 Panel	Legionella Analysis Please use EMSL Legionella COC
M010 Bacteria Count & ID - 3 Most Prominent		M025 Sewage Screen - Water (MFT*)	
M011 Bacteria Count & ID - 5 Most Prominent		*MFT= Membrane Filtration Technique	
		**MPN = Most Probable Number	
		***P/A = Presence/Absence	

Sample #	Sample Location/Description	Sample Type (Matrix)	Potable / Non-Potable (Only for Water)	Test Code	Volume/Area	Date / Time Collected	Temperature (Lab Use Only)
Example: Sample 1	Kitchen	Water	Potable	M017	1,000 ml	1/1/2021 3:30pm	
	<u>See Attached</u>						

Special Instructions and/or Regulatory Requirements (Sample Specifications, Processing Methods, Limits of Detection, etc.)

Method of Shipment: <u>Drop @ Lab</u>	Sample Condition Upon Receipt:
Relinquished by: <u>[Signature]</u>	Date/Time: <u>10-15-21</u>
Relinquished by:	Date/Time:
Received by: <u>[Signature]</u>	Date/Time: <u>10-15-21</u>
Received by:	Date/Time:

Controlled Document - COC-34 Micro R13 03/02/2021



AGREE TO ELECTRONIC SIGNATURE (By checking, I consent to signing this Chain of Custody document by electronic signature.)

EMSL Analytical, Inc.'s Laboratory Terms and Conditions are incorporated into this Chain of Custody by reference in their entirety. Submission of samples to EMSL Analytical, Inc. constitutes acceptance and acknowledgment of all terms and conditions by Customer.



EMSL ANALYTICAL, INC.
TESTING LABS • PRODUCTS • TRAINING

Microbiology Chain of Custody Form

Emsl Order Number Lab Use Only

132107762

EMSL Analytical, Inc.
200 Route 130 North
Cinnaminson, NJ 08077

P.O. Box 10000 (800) 220-3675

✉ CinnMicroLab@emsl.com

Additional Pages of the Chain of Custody are only necessary if needed for additional sample information.

Special Instructions and/or Regulatory Requirements (Sample Specifications, Processing Methods, Limits of Detection, etc.)

Sample #	Sample Location/Description	Sample Type (Matrix)	Potable / Non- Potable (Only for Water)	Test Code	Volume/Area	Date / Time Collected	Temperature (Lab Use Only)
TL-1	3rd Floor Women's Rm 389 uninsulated supply duct	-	-	M041	-	10/12/21 12:00 PM	
TL-2	3rd Floor men's Rm 390 uninsulated supply duct						
TL-3	3rd floor Hall @ stair H2 uninsulated return duct						
TL-4	3rd floor Hall @ Law Library return @ linear diffuser, insulated						
TL-5	3rd floor Hall @ Stair 3 uninsulated supply duct						
TL-6	3rd floor Hall @ Room 381 uninsulated return duct						
TL-7	3rd floor Hall @ Stair H1 uninsulated return duct					9:15 PM	

Method of Shipment:

1) Fe^{2+} 2) La^{3+}

Sample Condition Upon Receipt

Relinquished by:

nd mat

Date/Time

10-15-21

Received by

by **REC'D**
by **FMSI - RYKTON**

OCT 15 Date: T

Date/Time

Relinquished by:

Date/Time:

Received by

Date/Time

Controlled Document - COC-34 Micro R13 3/02/2021



AGREE TO ELECTRONIC SIGNATURE (By checking, I consent to signing this Chain of Custody document by electronic signature.)

EMSL Analytical, Inc.'s Laboratory Terms and Conditions are incorporated into this Chain of Custody by reference in their entirety. Submission of samples to EMSL Analytical, Inc. constitutes acceptance and acknowledgment of all terms and conditions by Customer.

Page of



EMSL Analytical, Inc.

5 Constitution Way, Unit A Woburn, MA 01801

Tel/Fax: (781) 933-8411 / (781) 933-8412

<http://www.EMSL.com> / bostonlab@emsl.com

EMSL Order: 132107767

Customer ID: COVI50

Customer PO: 458085

Project ID:

Attention: Ann D. Eckmann

TRC

300 Wildwood Avenue

Woburn, MA 01801

Phone: (781) 933-2555

Fax:

Collected Date: 10/13/2021

Received Date: 10/15/2021

Analyzed Date: 10/18/2021

Project: 458085 - Springfield

Test Report: Microscopic Examination of Fungal Spores, Fungal Structures, Hyphae, and Other Particulates from Bulk Samples (EMSL Method MICRO-SOP-200)

Lab Sample Number: Client Sample ID: Sample Location:	132107767-0010 B-1 3rd Floor Room 332, Insulation, Supply Duct	132107767-0011 B-2 3rd Floor Room 332, Uninsulated Return Duct			
Spore Types	Category	Category			
Alternaria (Ulocladium)	-	-			
Ascospores	-	-			
Aspergillus/Penicillium	-	-			
Basidiospores	-	-			
Bipolaris++	-	-			
Chaetomium++	-	-			
Cladosporium	*Low*	*Low*			
Curvularia	-	-			
Epicoccum	-	-			
Fusarium++	-	-			
Ganoderma	-	-			
Myxomycetes++	-	-			
Pithomyces++	-	-			
Rust	-	-			
Scopulariopsis/Microascus	-	-			
Stachybotrys/Memnoniella	-	-			
Unidentifiable Spores	-	-			
Zygomycetes	-	-			
Aureobasidium++	*Low*	*Low*			
Hyphal Fragment	-	-			
Insect Fragment	-	-			
Pollen	-	-			
Fibrous Particulate	-	-			

Category: Count/per area analyzed - Rare: 1 to 10 Low: 11 to 100 Medium: 101 to 1000 High: >1000

- Denotes Not Detected.

++ Includes other spores with similar morphology; see EMSL's fungal glossary for each specific category.

* = Sample contains fruiting structures and/or hyphae associated with the spores.

No discernable field blank was submitted with this group of samples.

Steve Grise, Laboratory Manager
or other Approved Signatory

EMSL maintains liability limited to cost of analysis. Interpretation and use of test results are the responsibility of the client. This report relates only to the samples reported above, and may not be reproduced, except in full, without written approval by EMSL. EMSL bears no responsibility for sample collection activities or analytical method limitations. The report reflects the samples as received. Results are generated from the field sampling data (sampling volumes and areas, locations, etc.) provided by the client on the Chain of Custody. Samples are within quality control criteria and met method specifications unless otherwise noted.

Samples analyzed by EMSL Analytical, Inc. Woburn, MA IHA-LAP, LLC-EMLAP Accredited #180179

Initial report from: 10/18/2021 09:57 AM

For information on the fungi listed in this report, please visit the Resources section at www.emsl.com



EMSL Analytical, Inc.

5 Constitution Way, Unit A Woburn, MA 01801

Tel/Fax: (781) 933-8411 / (781) 933-8412

<http://www.EMSL.com> / bostonlab@emsl.com

EMSL Order: 132107767

Customer ID: COVI50

Customer PO: 458085

Project ID:

Attention: Ann D. Eckmann

TRC

300 Wildwood Avenue

Woburn, MA 01801

Phone: (781) 933-2555

Fax:

Collected Date: 10/13/2021

Received Date: 10/15/2021

Analyzed Date: 10/18/2021

Project: 458085 - Springfield

Test Report: Microscopic Examination of Fungal Spores, Fungal Structures, Hyphae, and Other Particulates from Tape Samples (EMSL Method MICRO-SOP-200)

Lab Sample Number: Client Sample ID: Sample Location:	132107767-0001 TL-1 3rd Floor Hall at Room 320, Uninsulated Return Duct	132107767-0002 TL-2 3rd Floor Room 347, Insulated Return Duct	132107767-0003 TL-3 3rd Floor Room 323, Uninsulated Return Duct	132107767-0004 TL-4 3rd Floor Room 323, Attorney Booth, Uninsulated Supply Duct	132107767-0005 TL-5 3rd Floor Room 320B, Uninsulated Return Duct
Spore Types	Category	Category	Category	Category	Category
Alternaria (Ulocladium)	-	-	-	-	-
Ascospores	-	-	-	-	-
Aspergillus/Penicillium	-	-	-	-	-
Basidiospores	-	-	-	-	-
Bipolaris++	-	-	-	-	-
Chaetomium++	-	-	-	-	-
Cladosporium	*High*	*High*	Rare	*High*	Low
Curvularia	-	-	-	-	-
Epicoccum	-	-	-	-	-
Fusarium++	-	-	-	-	-
Ganoderma	-	-	-	-	-
Myxomycetes++	-	-	Low	Low	Low
Pithomyces++	-	-	Rare	-	-
Rust	-	-	-	-	-
Scopulariopsis/Microascus	-	-	-	-	-
Stachybotrys/Memnoniella	-	-	-	-	-
Unidentifiable Spores	-	-	-	-	-
Zygomycetes	-	-	-	-	-
Aureobasidium++	-	*Low*	-	-	-
Hyphal Fragment	-	-	-	-	-
Insect Fragment	-	-	-	-	-
Pollen	-	-	Rare	-	-
Fibrous Particulate	-	-	-	-	-

Category: Count/per area analyzed - Rare: 1 to 10 Low: 11 to 100 Medium: 101 to 1000 High: >1000

- Denotes Not Detected.

++ Includes other spores with similar morphology; see EMSL's fungal glossary for each specific category.

* = Sample contains fruiting structures and/or hyphae associated with the spores.

No discernable field blank was submitted with this group of samples.

Steve Grise, Laboratory Manager
or other Approved Signatory

EMSL maintains liability limited to cost of analysis. Interpretation and use of test results are the responsibility of the client. This report relates only to the samples reported above and may not be reproduced, except in full, without written approval by EMSL. EMSL bears no responsibility for sample collection activities or analytical method limitations. The report reflects the samples as received. Results are generated from the field sampling data (sampling volumes and areas, locations, etc.) provided by the client on the Chain of Custody. Samples are within quality control criteria and met method specifications unless otherwise noted.

Samples analyzed by EMSL Analytical, Inc. Woburn, MA AIHA-LAP, LLC-EMLAP Accredited #180179

Initial report from: 10/18/2021 09:57 AM

For information on the fungi listed in this report, please visit the Resources section at www.emsl.com



EMSL Analytical, Inc.

5 Constitution Way, Unit A Woburn, MA 01801

Tel/Fax: (781) 933-8411 / (781) 933-8412

<http://www.EMSL.com> / bostonlab@emsl.com

EMSL Order: 132107767

Customer ID: COVI50

Customer PO: 458085

Project ID:

Attention: Ann D. Eckmann

TRC

300 Wildwood Avenue

Woburn, MA 01801

Phone: (781) 933-2555

Fax:

Collected Date: 10/13/2021

Received Date: 10/15/2021

Analyzed Date: 10/18/2021

Project: 458085 - Springfield

Test Report: Microscopic Examination of Fungal Spores, Fungal Structures, Hyphae, and Other Particulates from Tape Samples (EMSL Method MICRO-SOP-200)

Lab Sample Number: Client Sample ID: Sample Location:	132107767-0006 TL-6 3rd Floor Room 320B, Uninsulated Supply Duct	132107767-0007 TL-7 3rd Floor Room 376, Uninsulated Return Duct	132107767-0008 TL-8 3rd Floor Room 376, Uninsulated Supply Duct	132107767-0009 TL-9 3rd Floor Room 378A, Uninsulated Return Duct	
Spore Types	Category	Category	Category	Category	
Alternaria (Ulocladium)	-	-	-	-	
Ascospores	-	-	-	-	
Aspergillus/Penicillium	-	-	-	-	
Basidiospores	-	-	-	-	
Bipolaris++	-	-	-	-	
Chaetomium++	-	-	-	-	
Cladosporium	*High*	Low	*High*	Rare	
Curvularia	-	-	-	-	
Epicoccum	-	-	-	-	
Fusarium++	-	-	-	-	
Ganoderma	-	-	-	-	
Myxomycetes++	-	Low	-	Rare	
Pithomyces++	-	-	-	-	
Rust	-	-	-	-	
Scopulariopsis/Microascus	-	-	-	-	
Stachybotrys/Memnoniella	-	-	-	-	
Unidentifiable Spores	-	-	-	-	
Zygomycetes	-	-	-	-	
Aureobasidium++	-	-	-	-	
Hyphal Fragment	-	-	-	-	
Insect Fragment	-	-	-	-	
Pollen	-	-	-	-	
Fibrous Particulate	-	-	-	-	

Category: Count/per area analyzed - Rare: 1 to 10 Low: 11 to 100 Medium: 101 to 1000 High: >1000

- Denotes Not Detected.

++ Includes other spores with similar morphology; see EMSL's fungal glossary for each specific category.

* = Sample contains fruiting structures and/or hyphae associated with the spores.

No discernable field blank was submitted with this group of samples.

Steve Grise, Laboratory Manager
or other Approved Signatory

EMSL maintains liability limited to cost of analysis. Interpretation and use of test results are the responsibility of the client. This report relates only to the samples reported above and may not be reproduced, except in full, without written approval by EMSL. EMSL bears no responsibility for sample collection activities or analytical method limitations. The report reflects the samples as received. Results are generated from the field sampling data (sampling volumes and areas, locations, etc.) provided by the client on the Chain of Custody. Samples are within quality control criteria and met method specifications unless otherwise noted.

Samples analyzed by EMSL Analytical, Inc. Woburn, MA IHA-LAP, LLC-EMLAP Accredited #180179

Initial report from: 10/18/2021 09:57 AM

For information on the fungi listed in this report, please visit the Resources section at www.emsl.com

EMSL

EMSL ANALYTICAL, INC.
TESTING LABS • PRODUCTS • TRAINING

Microbiology Chain of Custody Form

EMSL Order Number / Lab Use Only

132107767

EMSL Analytical, Inc.
200 Route 130 North
Cinnaminson, NJ 08077

PHONE: (800) 220-3675

EMAIL: CinnMicroLab@emsl.com

If Bill-To is the same as Report-To leave this section blank. Third-party billing requires written authorization.

Customer Information	Customer ID:	Billing ID:
	Company Name: <u>TRC</u>	Company Name:
	Contact Name: <u>Michael McCarter</u>	Billing Contact:
	Street Address: <u>300 W. Woodward Ave</u>	Street Address:
	City, State, Zip: <u>Woburn MA 01801</u>	City, State, Zip:
	Phone: <u>603 346 2600</u>	Phone:
Email(s) for Report: <u>mcarter@trcsolutions.com / m.mccarter@trcsolutions.com</u>	Email(s) for Invoice:	

Project Information

Project Name/No: <u>458085 str. mfg. or ? mfg</u>	Purchase Order:
EMSL LIMS Project ID: (If applicable, EMSL will provide)	State of Connecticut (CT) must select project location: <input type="checkbox"/> Commercial (Taxable) <input type="checkbox"/> Residential (Non-taxable)
State: <u>MA</u> Samples Collected:	Zip Code: <u>MA</u> Samples Collected:
Sampled By Name: <u>Michael McCarter</u>	Sampled By Signature: <u>[Signature]</u>
Sterile, Sodium Thiosulfate Preserved Bottle Used: <input type="checkbox"/> Biocide Used in Source (specify):	
Public Water Supply Samples: <input type="checkbox"/> Note: All results may automatically be reported to DOH if required by State.	
Turn-Around-Time (TAT) Please call ahead for large projects and/or turnaround times 8 hours or less. *32 Hour TAT available for select tests only; samples must be submitted by 11:30am.	
<input type="checkbox"/> 3 Hour <input type="checkbox"/> 6 Hour <input checked="" type="checkbox"/> 24 Hour <input type="checkbox"/> 32* Hour <input type="checkbox"/> 48 Hour <input type="checkbox"/> 72 Hour <input type="checkbox"/> 96 Hour <input type="checkbox"/> 1 Week <input type="checkbox"/> 2 Week	

MICROBIOLOGY TEST CODES

M001 Air-Q-Cell	M174 MoldSnap	M012 Pseudomonas aeruginosa (PIA***)	M115 Sewage Screen - Water (PIA***)
M030 Micro 5	M032 Allergenco-D	M024 Pseudomonas aeruginosa (MFT*)	M116 Sewage Screen - Water (MPN**)
M041 Fungal Direct Examination		M015 Heterotrophic Plate Count	M117 Sewage Screen - Swab (PIA***)
M169 Pollen ID & Enumeration		M017 Total Coliform & E. Coli (Colilert PIA***)	M013 Sewage Screen - Swab (MFT*)
M280 Dust Characterization Level-1		M018 Total Coliform & E. Coli (MFT*)	M730 Methicillin-resistant Staph. aureus (MRSA)
M281 Dust Characterization Level-2		M114 Total Coliform & E. Coli Enumeration (Colilert MPN**)	M031 Rapid-growing non-TB Mycobacteria Detection & Enumeration
M005 Viable Fungi-Air Samples (Genus ID & Count)		M019 Fecal Coliform (MFT*)	M014 Endotoxin Analysis
M006 Viable Fungi-Air Samples (Includes Penicillium, Aspergillus, Cladosporium, Stachybotrys Species ID & Count)		M020 Fecal Streptococcus (MFT*)	M044 Group Allergen (Cat, Dog, Cockroach, Dust Mite)
M007 Culturable Fungi-Surface Samples (Genus ID & Count)		M029 Enterococci (MFT*)	M095 Bacteroides
M008 Culturable Fungi-Surface Samples (Includes Penicillium, Aspergillus, Cladosporium, Stachybotrys Species ID & Count)		M129 Enterococci (Enterolert PIA***)	Other - See Analytical Price Guide for Test Code
M009 Bacteria Culture Gram Stain & Count		M180 Real Time qPCR-ERMI 36 Panel	Legionella Analysis Please use EMSL Legionella COC
M010 Bacteria Count & ID - 3 Most Prominent		M025 Sewage Screen - Water (MFT*)	
M011 Bacteria Count & ID - 5 Most Prominent		*MFT= Membrane Filtration Technique	
		**MPN = Most Probable Number	
		***PIA = Presence/Absence	

Sample #	Sample Location/Description	Sample Type (Matrix)	Potable / Non-Potable (Only for Water)	Test Code	Volume/Area	Date / Time Collected	Temperature (Lab Use Only)
Example: Sample 1	Kitchen	Water	Potable	M017	1,000 ml	1/1/2021 3:30pm	
	<u>See Attached</u>						

Special Instructions and/or Regulatory Requirements (Sample Specifications, Processing Methods, Limits of Detection, etc.)

Method of Shipment: <u>Overnight</u>	Sample Condition Upon Receipt:
Relinquished by: <u>[Signature]</u>	Date/Time: <u>10-15-21</u>
Relinquished by: <u>[Signature]</u>	Date/Time: <u>10-15-21</u>

Controlled Document - COC-34 Micro R13 03/02/2021

☐ AGREE TO ELECTRONIC SIGNATURE (By checking, I consent to signing this Chain of Custody document by electronic signature.)

EMSL Analytical, Inc.'s Laboratory Terms and Conditions are incorporated into this Chain of Custody by reference in their entirety. Submission of samples to EMSL Analytical, Inc. constitutes acceptance and acknowledgment of all terms and conditions by Customer.



EMSL ANALYTICAL, INC.
TESTING LABS • PRODUCTS • TRAINING

Microbiology Chain of Custody Form

EMSL Order Number Lab Use Only

EMSL Analytical, Inc.
200 Route 130 North
Cinnaminson, NJ 08077

☎ (800) 220-3675

CinnMicroLab@emsl.com

132107767

Additional Pages of the Chain of Custody are only necessary if needed for additional sample information.

Special Instructions and/or Regulatory Requirements (Sample Specifications, Processing Methods, Limits of Detection, etc.)

Sample #	Sample Location/Description	Sample Type (Matrix)	Potable / Non- Potable (Only for Water)	Test Code	Volume/Area	Date / Time Collected	Temperature (Lab Use Only)
TL-1	3rd floor Hallway Room 320 uninsulated RETURN DUCT	-	-	M041	-	10/13/21 4:50 pm	
TL-2	3rd floor Room 347 insulated RETURN DUCT						
TL-3	3rd floor Room 332 323 un insulated RETURN DUCT						
TL-4	3rd floor Room 332 Get it attorney Room uninsulated SUPPLY DUCT 323 un						
TL-5	3rd floor Room 320 B uninsulated RETURN DUCT						
TL-6	3rd floor Room 320 B uninsulated SUPPLY DUCT						
TL-7	3rd floor Room 376 uninsulated RETURN DUCT						
TL-8	3rd floor Room 376 uninsulated SUPPLY DUCT						
TL-9	3rd floor Room 378A uninsulated RETURN DUCT						
B1	3rd floor Room 332 insulation, SUPPLY DUCT						
D2	3rd floor Room 332 uninsulated RETURN DUCT						

Method of Shipment

Sample Condition Upon Receipt

Relinquished by:

Date/Time

Received by

Date/Time

Relinquished by

Date/Time

Received by

Date/Time

Controlled Document - COC-34 Micro R13 3/02/2021



AGREE TO ELECTRONIC SIGNATURE (By checking, I consent to signing this Chain of Custody document by electronic signature.)

EMSL Analytical, Inc.'s Laboratory Terms and Conditions are incorporated into this Chain of Custody by reference in their entirety. Submission of samples to EMSL Analytical, Inc. constitutes acceptance and acknowledgment of all terms and conditions by Customer.

Page of



EMSL Analytical, Inc.

5 Constitution Way, Unit A Woburn, MA 01801

Tel/Fax: (781) 933-8411 / (781) 933-8412

<http://www.EMSL.com> / bostonlab@emsl.com

EMSL Order: 132107766

Customer ID: COVI50

Customer PO: 458085

Project ID:

Attention: Ann D. Eckmann

TRC

300 Wildwood Avenue

Woburn, MA 01801

Phone: (781) 933-2555

Fax:

Collected Date: 10/14/2021

Received Date: 10/15/2021

Analyzed Date: 10/18/2021

Project: 458085 - Springfield

Test Report: Microscopic Examination of Fungal Spores, Fungal Structures, Hyphae, and Other Particulates from Bulk Samples (EMSL Method MICRO-SOP-200)

Lab Sample Number: Client Sample ID: Sample Location:	132107766-0012 B-1 3rd Floor Room 381, Uninsulated Return Duct	132107766-0013 B-2 3rd Floor Clerk of Court Criminal, Uninsulated Return Duct	132107766-0014 B-3 3rd Floor Clerk of Superior Court Secretary Pool, Uninsulated Return Duct	132107766-0015 B-4 3rd Floor Clerk of Superior Court Civil Room 300, Uninsulated Return Duct	132107766-0016 B-5 3rd Floor Law Library, Uninsulated Return
Spore Types	Category	Category	Category	Category	Category
Alternaria (Ulocladium)	-	-	-	-	-
Ascospores	-	-	-	-	-
Aspergillus/Penicillium	-	-	-	-	-
Basidiospores	-	-	-	-	-
Bipolaris++	-	-	-	-	-
Chaetomium++	-	-	-	-	-
Cladosporium	Low	Low	Low	Low	Low
Curvularia	-	-	-	-	-
Epicoccum	-	-	-	-	-
Fusarium++	-	-	-	-	-
Ganoderma	-	-	-	-	-
Myxomycetes++	-	-	-	-	-
Pithomyces++	-	-	-	-	-
Rust	-	-	-	-	-
Scopulariopsis/Microascus	-	-	-	-	-
Stachybotrys/Memnoniella	-	-	-	-	-
Unidentifiable Spores	-	-	-	-	-
Zygomycetes	-	-	-	-	-
Hyphal Fragment	-	-	-	-	-
Insect Fragment	-	-	-	-	-
Pollen	-	-	-	-	-
Fibrous Particulate	-	-	-	-	-

Category: Count/per area analyzed - Rare: 1 to 10 Low: 11 to 100 Medium: 101 to 1000 High: >1000

- Denotes Not Detected.

++ Includes other spores with similar morphology; see EMSL's fungal glossary for each specific category.

* = Sample contains fruiting structures and/or hyphae associated with the spores.

Steve Grise, Laboratory Manager
or other Approved Signatory

No discernable field blank was submitted with this group of samples.

EMSL maintains liability limited to cost of analysis. Interpretation and use of test results are the responsibility of the client. This report relates only to the samples reported above, and may not be reproduced, except in full, without written approval by EMSL. EMSL bears no responsibility for sample collection activities or analytical method limitations. The report reflects the samples as received. Results are generated from the field sampling data (sampling volumes and areas, locations, etc.) provided by the client on the Chain of Custody. Samples are within quality control criteria and met method specifications unless otherwise noted.

Samples analyzed by EMSL Analytical, Inc. Woburn, MA IHA-LAP, LLC-EMLAP Accredited #180179

Initial report from: 10/18/2021 09:55 AM

For information on the fungi listed in this report, please visit the Resources section at www.emsl.com



EMSL Analytical, Inc.

5 Constitution Way, Unit A Woburn, MA 01801

Tel/Fax: (781) 933-8411 / (781) 933-8412

<http://www.EMSL.com> / bostonlab@emsl.com

EMSL Order: 132107766

Customer ID: COVI50

Customer PO: 458085

Project ID:

Attention: Ann D. Eckmann
TRC
300 Wildwood Avenue
Woburn, MA 01801

Phone: (781) 933-2555

Fax:

Collected Date: 10/14/2021

Received Date: 10/15/2021

Analyzed Date: 10/18/2021

Project: 458085 - Springfield

Test Report: Microscopic Examination of Fungal Spores, Fungal Structures, Hyphae, and Other Particulates from Tape Samples (EMSL Method MICRO-SOP-200)

Lab Sample Number: Client Sample ID: Sample Location:	132107766-0001 TL-01 3rd Floor Room 350, Uninsulated Supply Duct	132107766-0002 TL-02 3rd Floor Room 350, Uninsulated Return Duct	132107766-0003 TL-03 3rd Floor Room 371, Insulated Supply Duct	132107766-0004 TL-04 3rd Floor Room 371, Uninsulated Return Duct	132107766-0005 TL-05 3rd Floor Room 370, Uninsulated Return Duct
Spore Types	Category	Category	Category	Category	Category
Alternaria (Ulocladium)	-	-	-	-	-
Ascospores	-	-	-	-	-
Aspergillus/Penicillium	-	-	-	-	-
Basidiospores	-	-	-	-	-
Bipolaris++	-	-	-	-	-
Chaetomium++	-	-	-	-	-
Cladosporium	*High*	*Medium*	*High*	*Low*	*High*
Curvularia	-	-	-	-	-
Epicoccum	-	-	-	Rare	-
Fusarium++	-	-	-	-	-
Ganoderma	-	-	-	-	-
Myxomycetes++	-	-	-	-	-
Pithomyces++	-	-	-	-	-
Rust	-	-	-	-	-
Scopulariopsis/Microascus	-	-	-	-	-
Stachybotrys/Memnoniella	-	-	-	-	-
Unidentifiable Spores	-	-	-	-	-
Zygomycetes	-	-	-	-	-
Hyphal Fragment	-	-	-	-	-
Insect Fragment	-	-	-	-	-
Pollen	-	-	-	Low	-
Fibrous Particulate	-	-	-	-	-

Category: Count/per area analyzed - Rare: 1 to 10 Low: 11 to 100 Medium: 101 to 1000 High: >1000

- Denotes Not Detected.

++ Includes other spores with similar morphology; see EMSL's fungal glossary for each specific category.

* = Sample contains fruiting structures and/or hyphae associated with the spores.

No discernable field blank was submitted with this group of samples.

Steve Grise, Laboratory Manager
or other Approved Signatory

EMSL maintains liability limited to cost of analysis. Interpretation and use of test results are the responsibility of the client. This report relates only to the samples reported above and may not be reproduced, except in full, without written approval by EMSL. EMSL bears no responsibility for sample collection activities or analytical method limitations. The report reflects the samples as received. Results are generated from the field sampling data (sampling volumes and areas, locations, etc.) provided by the client on the Chain of Custody. Samples are within quality control criteria and met method specifications unless otherwise noted.

Samples analyzed by EMSL Analytical, Inc. Woburn, MA IHA-LAP, LLC-EMLAP Accredited #180179

Initial report from: 10/18/2021 09:55 AM

For information on the fungi listed in this report, please visit the Resources section at www.emsl.com



EMSL Analytical, Inc.

5 Constitution Way, Unit A Woburn, MA 01801

Tel/Fax: (781) 933-8411 / (781) 933-8412

<http://www.EMSL.com> / bostonlab@emsl.com

EMSL Order: 132107766

Customer ID: COVI50

Customer PO: 458085

Project ID:

Attention: Ann D. Eckmann

TRC

300 Wildwood Avenue

Woburn, MA 01801

Phone: (781) 933-2555

Fax:

Collected Date: 10/14/2021

Received Date: 10/15/2021

Analyzed Date: 10/18/2021

Project: 458085 - Springfield

Test Report: Microscopic Examination of Fungal Spores, Fungal Structures, Hyphae, and Other Particulates from Tape Samples (EMSL Method MICRO-SOP-200)

Lab Sample Number: Client Sample ID: Sample Location:	132107766-0006 TL-06 3rd Floor Room 370, Insulated Supply	132107766-0007 TL-07 3rd Floor Room 380, Uninsulated Supply Duct	132107766-0008 TL-08 3rd Floor Hall at Room 343, Uninsulated Supply Duct	132107766-0009 TL-09 3rd Floor Clerk of Superior Court Criminal, Uninsulated Supply Duct	132107766-0010 TL-10 3rd Floor Clerk of Superior Court Secretary Pool, Uninsulated Supply Duct
Spore Types	Category	Category	Category	Category	Category
Alternaria (Ulocladium)	-	-	-	-	-
Ascospores	-	-	-	-	-
Aspergillus/Penicillium	-	-	-	-	-
Basidiospores	-	-	-	-	-
Bipolaris++	-	-	-	-	-
Chaetomium++	-	-	-	-	-
Cladosporium	*High*	*High*	*High*	*Medium*	*Medium*
Curvularia	-	-	-	-	-
Epicoccum	-	-	-	-	-
Fusarium++	-	-	-	-	-
Ganoderma	-	-	-	-	-
Myxomycetes++	-	-	-	-	-
Pithomyces++	-	-	-	-	-
Rust	-	-	-	-	-
Scopulariopsis/Microascus	-	-	-	-	-
Stachybotrys/Memnoniella	-	-	-	-	-
Unidentifiable Spores	-	-	-	-	-
Zygomycetes	-	-	-	-	-
Hyphal Fragment	-	-	-	-	-
Insect Fragment	-	-	-	-	-
Pollen	-	-	-	-	-
Fibrous Particulate	-	-	-	-	-

Category: Count/per area analyzed - Rare: 1 to 10 Low: 11 to 100 Medium: 101 to 1000 High: >1000

- Denotes Not Detected.

++ Includes other spores with similar morphology; see EMSL's fungal glossary for each specific category.

* = Sample contains fruiting structures and/or hyphae associated with the spores.

No discernable field blank was submitted with this group of samples.

Steve Grise, Laboratory Manager
or other Approved Signatory

EMSL maintains liability limited to cost of analysis. Interpretation and use of test results are the responsibility of the client. This report relates only to the samples reported above and may not be reproduced, except in full, without written approval by EMSL. EMSL bears no responsibility for sample collection activities or analytical method limitations. The report reflects the samples as received. Results are generated from the field sampling data (sampling volumes and areas, locations, etc.) provided by the client on the Chain of Custody. Samples are within quality control criteria and met method specifications unless otherwise noted.

Samples analyzed by EMSL Analytical, Inc. Woburn, MA IHA-LAP, LLC-EMLAP Accredited #180179

Initial report from: 10/18/2021 09:55 AM

For information on the fungi listed in this report, please visit the Resources section at www.emsl.com



EMSL Analytical, Inc.

5 Constitution Way, Unit A Woburn, MA 01801

Tel/Fax: (781) 933-8411 / (781) 933-8412

<http://www.EMSL.com> / bostonlab@emsl.com

EMSL Order: 132107766

Customer ID: COVI50

Customer PO: 458085

Project ID:

Attention: Ann D. Eckmann

TRC

300 Wildwood Avenue

Woburn, MA 01801

Phone: (781) 933-2555

Fax:

Collected Date: 10/14/2021

Received Date: 10/15/2021

Analyzed Date: 10/18/2021

Project: 458085 - Springfield

Test Report: Microscopic Examination of Fungal Spores, Fungal Structures, Hyphae, and Other Particulates from Tape Samples (EMSL Method MICRO-SOP-200)

Lab Sample Number:	132107766-0011				
Client Sample ID:	TL-11				
Sample Location:	3rd Floor Law Library, Insulated Supply Duct				
Spore Types	Category				
Alternaria (Ulocladium)	-				
Ascospores	-				
Aspergillus/Penicillium	-				
Basidiospores	-				
Bipolaris++	-				
Chaetomium++	-				
Cladosporium	*High*				
Curvularia	-				
Epicoccum	-				
Fusarium++	-				
Ganoderma	-				
Myxomycetes++	-				
Pithomyces++	-				
Rust	-				
Scopulariopsis/Microascus	-				
Stachybotrys/Memnoniella	-				
Unidentifiable Spores	-				
Zygomycetes	-				
Hyphal Fragment	-				
Insect Fragment	-				
Pollen	-				
Fibrous Particulate	-				

Category: Count/per area analyzed - Rare: 1 to 10 Low: 11 to 100 Medium: 101 to 1000 High: >1000

- Denotes Not Detected.

++ Includes other spores with similar morphology; see EMSL's fungal glossary for each specific category.

* = Sample contains fruiting structures and/or hyphae associated with the spores.

No discernable field blank was submitted with this group of samples.

Steve Grise, Laboratory Manager
or other Approved Signatory

EMSL maintains liability limited to cost of analysis. Interpretation and use of test results are the responsibility of the client. This report relates only to the samples reported above and may not be reproduced, except in full, without written approval by EMSL. EMSL bears no responsibility for sample collection activities or analytical method limitations. The report reflects the samples as received. Results are generated from the field sampling data (sampling volumes and areas, locations, etc.) provided by the client on the Chain of Custody. Samples are within quality control criteria and met method specifications unless otherwise noted.

Samples analyzed by EMSL Analytical, Inc. Woburn, MA IHA-LAP, LLC-EMLAP Accredited #180179

Initial report from: 10/18/2021 09:55 AM

For information on the fungi listed in this report, please visit the Resources section at www.emsl.com

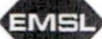

EMSL ANALYTICAL, INC.
TESTING LABS • PRODUCTS • TRAINING

Microbiology Chain of Custody Form

EMSL Order Number / Lab Use Only

132107766

EMSL Analytical, Inc.
200 Route 130 North
Cinnaminson, NJ 08077

PHONE: (800) 220-3675

EMAIL: CinnMicroLab@emsl.com

If Bill-To is the same as Report-To leave this section blank. Third-party billing requires written authorization.

Customer Information	Customer ID:	Billing Information	Billing ID:	
	Company Name: <u>TLC</u>		Company Name:	
	Contact Name: <u>Ann Eckman / Mike McCarter</u>		Billing Contact:	
	Street Address: <u>300 W. 12th Ave</u>		Street Address:	
	City, State, Zip: <u>Woburn MA 01801</u>		City, State, Zip:	Country:
	Phone: <u>603 396 2600</u>		Phone:	Country:
Email(s) for Report: <u>aeckman@trecapex.com / mmccarter@trecapex.com</u>		Email(s) for Invoice: <u>aeckman@trecapex.com</u>		

Project Information		Purchase Order:
Project Name/No: <u>48508T Springfield</u>		
EMSL LIMS Project ID: (If applicable, EMSL will provide)	State Samples Collected:	Zip Code Samples Collected:
State of Connecticut (CT) must select project location:	<input type="checkbox"/> Commercial (Taxable) <input type="checkbox"/> Residential (Non-taxable)	
Sampled By Name: <u>Michael McCarter</u>	Sampled By Signature: <u>[Signature]</u>	No. of Samples in Shipment
Sterile, Sodium Thiosulfate Preserved Bottle Used: <input type="checkbox"/> Biocide Used in Source (specify)		
Public Water Supply Samples: <input type="checkbox"/> Note: All results may automatically be reported to DOH if required by State.		
Turn-Around-Time (TAT) Please call ahead for large projects and/or turnaround times 3 hours or less. *32 Hour TAT available for select tests only, samples must be submitted by 11:30am.		
<input type="checkbox"/> 3 Hour <input type="checkbox"/> 6 Hour <input checked="" type="checkbox"/> 24 Hour <input type="checkbox"/> 32 Hour <input type="checkbox"/> 48 Hour <input type="checkbox"/> 72 Hour <input type="checkbox"/> 96 Hour <input type="checkbox"/> 1 Week <input type="checkbox"/> 2 Week		

MICROBIOLOGY TEST CODES			
M001 Air-O-Cell	M174 MoldSnap	M012 Pseudomonas aeruginosa (PIA***)	M115 Sewage Screen - Water (PIA***)
M030 Micro 5	M032 Allergenco-D	M024 Pseudomonas aeruginosa (MFT*)	M116 Sewage Screen - Water (MPN**)
M041 Fungal Direct Examination		M015 Heterotrophic Plate Count	M117 Sewage Screen - Swab (PIA***)
M169 Pollen ID & Enumeration		M017 Total Coliform & E. Coli (Colilert PIA***)	M013 Sewage Screen - Swab (MFT*)
M280 Dust Characterization Level-1		M018 Total Coliform & E. Coli (MFT*)	M730 Methicillin-resistant Staph. aureus (MRSA)
M281 Dust Characterization Level-2		M114 Total Coliform & E. Coli Enumeration (Colilert MPN**)	M031 Rapid-growing non-TB Mycobacteria Detection & Enumeration
M005 Viable Fungi-Air Samples (Genus ID & Count)		M019 Fecal Coliform (MFT*)	
M006 Viable Fungi-Air Samples (Includes Penicillium, Aspergillus, Gladosporium, Stachybotrys Species ID & Count)		M020 Fecal Streptococcus (MFT*)	M014 Endotoxin Analysis
M007 Culturable Fungi-Surface Samples (Genus ID & Count)		M029 Enterococci (MFT*)	M044 Group Allergen (Cat, Dog, Cockroach, Dust Mite)
M008 Culturable Fungi-Surface Samples (Includes Penicillium, Aspergillus, Gladosporium, Stachybotrys Species ID & Count)		M129 Enterococci (Enterolert PIA***)	M095 Bacteroides
M009 Bacteria Culture Gram Stain & Count		M180 Real Time qPCR-ERMI 36 Panel	Other - See Analytical Price Guide for Test Code
M010 Bacteria Count & ID - 3 Most Prominent		M025 Sewage Screen - Water (MFT*)	Legionella Analysis Please use EMSL Legionella COC
M011 Bacteria Count & ID - 5 Most Prominent		*MFT= Membrane Filtration Technique **MPN = Most Probable Number ***PIA = Presence/Absence	

Sample #	Sample Location/Description	Sample Type (Matrix)	Potable / Non-Potable (Only for Water)	Test Code	Volume/Area	Date / Time Collected	Temperature (Lab Use Only)
Example: Sample 1	Kitchen	Water	Potable	M017	1,000 ml	1/1/2021 3:30pm	
	<u>See Attached</u>						

Special Instructions and/or Regulatory Requirements (Sample Specifications, Processing Methods, Limits of Detection, etc.)

Method of Shipment: <u>Drop @ Lab</u>	Sample Condition Upon Receipt:
Relinquished by: <u>[Signature]</u>	Received by: <u>[Signature]</u>
Date/Time: <u>10-15-21</u>	Date/Time: <u>OCT 15 2021</u>
Relinquished by: <u>[Signature]</u>	Received by: <u>[Signature]</u>
Date/Time: <u>10-15-21</u>	Date/Time: <u>OCT 15 2021</u>

Controlled Document - COC-34 Micro R13 03/02/2021



AGREE TO ELECTRONIC SIGNATURE (By checking, I consent to signing this Chain of Custody document by electronic signature.)

EMSL Analytical, Inc.'s Laboratory Terms and Conditions are incorporated into this Chain of Custody by reference in their entirety. Submission of samples to EMSL Analytical, Inc. constitutes acceptance and acknowledgment of all terms and conditions by customer.

EMSL Order Number / Lab Use Only

132107766

EMAIL CinnMicroLab@emsl.com

Additional Pages of the Chain of Custody are only necessary if needed for additional sample information.

Special Instructions and/or Regulatory Requirements (Sample Specifications, Processing Methods, Limits of Detection, etc.)

Method of Shipment:

Relinquished by:

Date/Time

Relinquished by:

Date/Time

Sample Condition Upon Receipt

Received by

Received by:

Date/Time

Date/Time

Controlled Document - GOC-34 Micro R13 3/02/2021

7

AGREE TO ELECTRONIC SIGNATURE (By checking, I consent to signing this Chain of Custody document by electronic signature.)

EMSL Analytical, Inc.'s Laboratory Terms and Conditions are incorporated into this Chain of Custody by reference in their entirety. Submission of samples to EMSL Analytical, Inc. constitutes acceptance and acknowledgment of all terms and conditions by Customer.

Page of



EMSL Analytical, Inc.

5 Constitution Way, Unit A Woburn, MA 01801

Tel/Fax: (781) 933-8411 / (781) 933-8412

<http://www.EMSL.com> / bostonlab@emsl.com

EMSL Order: 132107950

Customer ID: COVI50

Customer PO: 485085

Project ID:

Attention: Ann D. Eckmann

TRC

300 Wildwood Avenue

Woburn, MA 01801

Phone: (781) 933-2555

Fax:

Collected Date: 10/18/2021

Received Date: 10/22/2021

Analyzed Date: 10/25/2021

Project: 485085 - Springfield

Test Report: Microscopic Examination of Fungal Spores, Fungal Structures, Hyphae, and Other Particulates from Tape Samples (EMSL Method MICRO-SOP-200)

Lab Sample Number: Client Sample ID: Sample Location:	132107950-0001 TL-01 2nd Floor, Room 224 - Insulated Supply Duct	132107950-0002 TL-02 2nd Floor, Room 224 - Uninsulated Return Duct	132107950-0003 TL-03 2nd Floor, Room 223 - Uninsulated Supply Duct	132107950-0004 TL-04 2nd Floor, Room 223 - Uninsulated Return Duct	132107950-0005 TL-05 2nd Floor, Room 230 - Uninsulated Return Duct
Spore Types	Category	Category	Category	Category	Category
Alternaria (Ulocladium)	-	-	-	-	-
Ascospores	-	-	-	-	-
Aspergillus/Penicillium	-	-	-	-	-
Basidiospores	-	-	*High*	-	-
Bipolaris++	-	-	-	-	-
Chaetomium++	-	-	-	-	-
Cladosporium	*High*	*Medium*	*High*	*Medium*	Low
Curvularia	-	-	-	-	-
Epicoccum	-	-	-	-	-
Fusarium++	-	-	-	-	-
Ganoderma	-	-	-	-	-
Myxomycetes++	-	-	-	-	Low
Pithomyces++	-	-	-	-	-
Rust	-	-	-	-	-
Scopulariopsis/Microascus	-	-	-	-	-
Stachybotrys/Memnoniella	-	-	-	-	-
Unidentifiable Spores	-	-	-	-	-
Zygomycetes	-	-	-	-	-
Aureobasidium++	-	*High*	*Low*	*Medium*	Low
Hyphal Fragment	-	-	-	-	-
Insect Fragment	-	-	-	-	-
Pollen	-	-	-	-	-
Fibrous Particulate	-	-	-	-	-

Category: Count/per area analyzed - Rare: 1 to 10 Low: 11 to 100 Medium: 101 to 1000 High: >1000

- Denotes Not Detected.

++ Includes other spores with similar morphology; see EMSL's fungal glossary for each specific category.

* = Sample contains fruiting structures and/or hyphae associated with the spores.

No discernable field blank was submitted with this group of samples.

Steve Grise, Laboratory Manager
or other Approved Signatory

EMSL maintains liability limited to cost of analysis. Interpretation and use of test results are the responsibility of the client. This report relates only to the samples reported above and may not be reproduced, except in full, without written approval by EMSL. EMSL bears no responsibility for sample collection activities or analytical method limitations. The report reflects the samples as received. Results are generated from the field sampling data (sampling volumes and areas, locations, etc.) provided by the client on the Chain of Custody. Samples are within quality control criteria and met method specifications unless otherwise noted.

Samples analyzed by EMSL Analytical, Inc. Woburn, MA IHA-LAP, LLC-EMLAP Accredited #180179

Initial report from: 10/25/2021 08:40 AM

For information on the fungi listed in this report, please visit the Resources section at www.emsl.com



EMSL Analytical, Inc.

5 Constitution Way, Unit A Woburn, MA 01801

Tel/Fax: (781) 933-8411 / (781) 933-8412

<http://www.EMSL.com> / bostonlab@emsl.com

EMSL Order: 132107950

Customer ID: COVI50

Customer PO: 485085

Project ID:

Attention: Ann D. Eckmann

TRC

300 Wildwood Avenue

Woburn, MA 01801

Phone: (781) 933-2555

Fax:

Collected Date: 10/18/2021

Received Date: 10/22/2021

Analyzed Date: 10/25/2021

Project: 485085 - Springfield

Test Report: Microscopic Examination of Fungal Spores, Fungal Structures, Hyphae, and Other Particulates from Tape Samples (EMSL Method MICRO-SOP-200)

Lab Sample Number: Client Sample ID: Sample Location:	132107950-0006 TL-06 2nd Floor, Room 230 - Insulated Supply Duct	132107950-0007 TL-07 2nd Floor, Elevator #5 Lobby - Uninsulated Supply Duct	132107950-0008 TL-08 2nd Floor, Room 228 - Insulated Supply Duct	132107950-0009 TL-09 2nd Floor, Room 228 - Uninsulated Return Duct	132107950-0010 TL-10 2nd Floor, Clerk of District Court Civil - Insulated Supply Duct
Spore Types	Category	Category	Category	Category	Category
Alternaria (Ulocladium)	-	-	-	-	-
Ascospores	-	-	-	-	-
Aspergillus/Penicillium	-	-	-	-	-
Basidiospores	-	-	-	-	-
Bipolaris++	-	-	-	-	-
Chaetomium++	-	-	-	-	-
Cladosporium	*High*	*High*	*High*	*Medium*	*High*
Curvularia	-	-	-	-	-
Epicoccum	-	-	Rare	-	-
Fusarium++	-	-	-	-	-
Ganoderma	-	-	-	-	-
Myxomycetes++	-	-	-	Low	-
Pithomyces++	-	-	-	Rare	-
Rust	-	-	-	-	-
Scopulariopsis/Microascus	-	-	-	-	-
Stachybotrys/Memnoniella	-	-	-	-	-
Unidentifiable Spores	-	-	-	-	-
Zygomycetes	-	-	-	-	-
Aureobasidium++	-	*Medium*	*Low*	-	-
Hyphal Fragment	-	-	-	-	-
Insect Fragment	-	-	-	-	-
Pollen	-	-	-	-	-
Fibrous Particulate	-	-	-	-	-

Category: Count/per area analyzed - Rare: 1 to 10 Low: 11 to 100 Medium: 101 to 1000 High: >1000

- Denotes Not Detected.

++ Includes other spores with similar morphology; see EMSL's fungal glossary for each specific category.

* = Sample contains fruiting structures and/or hyphae associated with the spores.

No discernable field blank was submitted with this group of samples.

Steve Grise, Laboratory Manager
or other Approved Signatory

EMSL maintains liability limited to cost of analysis. Interpretation and use of test results are the responsibility of the client. This report relates only to the samples reported above and may not be reproduced, except in full, without written approval by EMSL. EMSL bears no responsibility for sample collection activities or analytical method limitations. The report reflects the samples as received. Results are generated from the field sampling data (sampling volumes and areas, locations, etc.) provided by the client on the Chain of Custody. Samples are within quality control criteria and met method specifications unless otherwise noted.

Samples analyzed by EMSL Analytical, Inc. Woburn, MA IHA-LAP, LLC-EMLAP Accredited #180179

Initial report from: 10/25/2021 08:40 AM

For information on the fungi listed in this report, please visit the Resources section at www.emsl.com



EMSL Analytical, Inc.

5 Constitution Way, Unit A Woburn, MA 01801

Tel/Fax: (781) 933-8411 / (781) 933-8412

<http://www.EMSL.com> / bostonlab@emsl.com

EMSL Order: 132107950

Customer ID: COVI50

Customer PO: 485085

Project ID:

Attention: Ann D. Eckmann

TRC

300 Wildwood Avenue

Woburn, MA 01801

Phone: (781) 933-2555

Fax:

Collected Date: 10/18/2021

Received Date: 10/22/2021

Analyzed Date: 10/25/2021

Project: 485085 - Springfield

Test Report: Microscopic Examination of Fungal Spores, Fungal Structures, Hyphae, and Other Particulates from Tape Samples (EMSL Method MICRO-SOP-200)

Lab Sample Number: Client Sample ID: Sample Location:	132107950-0011 TL-11 2nd Floor, Clerk of District Court Civil - Uninsulated Return Duct	132107950-0012 TL-12 2nd Floor, 216 - Uninsulated Return Duct	132107950-0013 TL-13 2nd Floor, 216 - Uninsulated Supply Duct	132107950-0014 TL-14 2nd Floor, 211 - Uninsulated Return Duct	132107950-0015 TL-15 2nd Floor, 211 - Insulated Supply Duct
Spore Types	Category	Category	Category	Category	Category
Alternaria (Ulocladium)	-	-	-	-	-
Ascospores	-	-	-	-	-
Aspergillus/Penicillium	-	-	-	-	-
Basidiospores	-	-	-	-	-
Bipolaris++	-	-	-	-	-
Chaetomium++	-	-	-	-	-
Cladosporium	*Low*	*Medium*	*High*	*Low*	*High*
Curvularia	-	-	-	-	-
Epicoccum	-	-	-	-	-
Fusarium++	-	-	-	-	-
Ganoderma	-	-	-	-	-
Myxomycetes++	Low	-	-	Low	-
Pithomyces++	-	-	-	-	-
Rust	-	-	-	-	-
Scopulariopsis/Microascus	-	-	-	-	-
Stachybotrys/Memnoniella	-	-	-	-	-
Unidentifiable Spores	-	-	-	-	-
Zygomycetes	-	-	-	-	-
Aureobasidium++	*Low*	*Low*	-	Rare	-
Hyphal Fragment	-	-	-	-	-
Insect Fragment	-	-	-	-	-
Pollen	-	-	-	-	Low
Fibrous Particulate	-	-	-	-	-

Category: Count/per area analyzed - Rare: 1 to 10 Low: 11 to 100 Medium: 101 to 1000 High: >1000

- Denotes Not Detected.

++ Includes other spores with similar morphology; see EMSL's fungal glossary for each specific category.

* = Sample contains fruiting structures and/or hyphae associated with the spores.

No discernable field blank was submitted with this group of samples.

Steve Grise, Laboratory Manager
or other Approved Signatory

EMSL maintains liability limited to cost of analysis. Interpretation and use of test results are the responsibility of the client. This report relates only to the samples reported above and may not be reproduced, except in full, without written approval by EMSL. EMSL bears no responsibility for sample collection activities or analytical method limitations. The report reflects the samples as received. Results are generated from the field sampling data (sampling volumes and areas, locations, etc.) provided by the client on the Chain of Custody. Samples are within quality control criteria and met method specifications unless otherwise noted.

Samples analyzed by EMSL Analytical, Inc. Woburn, MA IHA-LAP, LLC-EMLAP Accredited #180179

Initial report from: 10/25/2021 08:40 AM

For information on the fungi listed in this report, please visit the Resources section at www.emsl.com



EMSL Analytical, Inc.

5 Constitution Way, Unit A Woburn, MA 01801

Tel/Fax: (781) 933-8411 / (781) 933-8412

<http://www.EMSL.com> / bostonlab@emsl.com

EMSL Order: 132107950

Customer ID: COVI50

Customer PO: 485085

Project ID:

Attention: Ann D. Eckmann

TRC

300 Wildwood Avenue

Woburn, MA 01801

Phone: (781) 933-2555

Fax:

Collected Date: 10/18/2021

Received Date: 10/22/2021

Analyzed Date: 10/25/2021

Project: 485085 - Springfield

Test Report: Microscopic Examination of Fungal Spores, Fungal Structures, Hyphae, and Other Particulates from Tape Samples (EMSL Method MICRO-SOP-200)

Lab Sample Number: Client Sample ID: Sample Location:	132107950-0016 TL-16 2nd Floor, 221 - Uninsulated Supply Duct	132107950-0017 TL-17 2nd Floor, 221 - Uninsulated Return Duct	132107950-0018 TL-18 2nd Floor, 219 - Uninsulated Return Duct	132107950-0019 TL-19 2nd Floor, 219 - Insulated Supply Duct	
Spore Types	Category	Category	Category	Category	
Alternaria (Ulocladium)	-	-	-	-	
Ascospores	-	-	-	-	
Aspergillus/Penicillium	-	-	-	-	
Basidiospores	-	-	-	-	
Bipolaris++	-	-	-	-	
Chaetomium++	-	-	-	-	
Cladosporium	*High*	*Medium*	*Medium*	*High*	
Curvularia	-	-	-	-	
Epicoccum	-	-	-	-	
Fusarium++	-	-	-	-	
Ganoderma	-	-	-	-	
Myxomycetes++	-	-	-	-	
Pithomyces++	-	-	-	-	
Rust	-	-	-	-	
Scopulariopsis/Microascus	-	-	-	-	
Stachybotrys/Memnoniella	-	-	-	-	
Unidentifiable Spores	-	-	-	-	
Zygomycetes	-	-	-	-	
Aureobasidium++	-	*Medium*	*Medium*	-	
Hyphal Fragment	-	-	-	-	
Insect Fragment	-	-	-	-	
Pollen	Medium	-	-	-	
Fibrous Particulate	-	-	-	-	

Category: Count/per area analyzed - Rare: 1 to 10 Low: 11 to 100 Medium: 101 to 1000 High: >1000

- Denotes Not Detected.

++ Includes other spores with similar morphology; see EMSL's fungal glossary for each specific category.

* = Sample contains fruiting structures and/or hyphae associated with the spores.

No discernable field blank was submitted with this group of samples.

Steve Grise, Laboratory Manager
or other Approved Signatory

EMSL maintains liability limited to cost of analysis. Interpretation and use of test results are the responsibility of the client. This report relates only to the samples reported above and may not be reproduced, except in full, without written approval by EMSL. EMSL bears no responsibility for sample collection activities or analytical method limitations. The report reflects the samples as received. Results are generated from the field sampling data (sampling volumes and areas, locations, etc.) provided by the client on the Chain of Custody. Samples are within quality control criteria and met method specifications unless otherwise noted.

Samples analyzed by EMSL Analytical, Inc. Woburn, MA IHA-LAP, LLC-EMLAP Accredited #180179

Initial report from: 10/25/2021 08:40 AM

For information on the fungi listed in this report, please visit the Resources section at www.emsl.com

EMSL

EMSL ANALYTICAL, INC.
TESTING LABS • PRODUCTS • TRAINING

Microbiology Chain of Custody Form

EMSL Order Number / Lab Use Only

132107950

EMSL Analytical, Inc.
200 Route 130 North
Cinnaminson, NJ 08077

PHONE: (800) 220-3675

EMAIL: CinnMicroLab@emsl.com

If Bill-To is the same as Report-To leave this section blank. Third-party billing requires written authorization.

Customer Information	Customer ID:	Billing ID:
	Company Name: TRE	Company Name:
	Contact Name: Ann Beckman / Michael McCarter	Billing Contact:
	Street Address: 300 W. Lincoln Ave	Street Address:
	City, State, Zip: WILMINGTON DE 19801	City, State, Zip: Country:
	Phone: 610-390-2600	Phone:
Email(s) for Report: gordon@TRE.com / mcmccarter@TRE.com	Email(s) for Invoice:	

Project Name/No: 458085 Scarf		Purchase Order:
EMSL LIMS Project ID: (If applicable, EMSL will provide)	State Samples Collected: MD	Zip Code Samples Collected:
State of Connecticut (CT) must select project location:		
<input type="checkbox"/> Commercial (Taxable) <input type="checkbox"/> Residential (Non-taxable)		
Sampled By Name: Michael McCarter	Sampled By Signature: Michael McCarter	No. of Samples in Shipment
Sterile, Sodium Thiosulfate Preserved Bottle Used: <input type="checkbox"/> Biocide Used in Source (specify)		
Public Water Supply Samples: <input type="checkbox"/> Note: All results may automatically be reported to DOH if required by State.		
Turn-Around-Time (TAT) Please call ahead for large projects and/or turnaround times 8 Hours or Less. *32 Hour TAT available for select tests only; samples must be submitted by 11:30am.		
<input type="checkbox"/> 3 Hour <input type="checkbox"/> 6 Hour <input checked="" type="checkbox"/> 24 Hour <input type="checkbox"/> 32* Hour <input type="checkbox"/> 48 Hour <input type="checkbox"/> 72 Hour <input type="checkbox"/> 96 Hour <input type="checkbox"/> 1 Week <input type="checkbox"/> 2 Week		

MICROBIOLOGY TEST CODES			
M001 Air-O-Cell	M174 MoldSnap	M012 Pseudomonas aeruginosa (P/A***)	M115 Sewage Screen - Water (P/A***)
M030 Micro 5	M032 Allergenco-D	M024 Pseudomonas aeruginosa (MFT*)	M116 Sewage Screen - Water (MPN**)
M041 Fungal Direct Examination		M015 Heterotrophic Plate Count	M117 Sewage Screen - Swab (P/A***)
M169 Pollen ID & Enumeration		M017 Total Coliform & E. Coli (Colilert P/A***)	M013 Sewage Screen - Swab (MFT*)
M280 Dust Characterization Level-1		M018 Total Coliform & E. Coli (MFT*)	M730 Methicillin-resistant Staph. aureus (MRSA)
M281 Dust Characterization Level-2		M114 Total Coliform & E. Coli Enumeration (Colilert MPN**)	M031 Rapid-growing non-TB Mycobacteria Detection & Enumeration
M005 Viable Fungi-Air Samples (Genus ID & Count)		M019 Fecal Coliform (MFT*)	M014 Endotoxin Analysis
M006 Viable Fungi-Air Samples (Includes Penicillium, Aspergillus, Cladosporium, Stachybotrys Species ID & Count)		M020 Fecal Streptococcus (MFT*)	M044 Group Allergen (Cat, Dog, Cockroach, Dust Mite)
M007 Culturable Fungi-Surface Samples (Genus ID & Count)		M029 Enterococci (MFT*)	M095 Bacteroides
M008 Culturable Fungi-Surface Samples (Includes Penicillium, Aspergillus, Cladosporium, Stachybotrys Species ID & Count)		M129 Enterococci (Enterolert P/A***)	Other - See Analytical Price Guide for Test Code
M009 Bacteria Culture Gram Stain & Count		M180 Real Time qPCR-ERMI 36 Panel	Legionella Analysis Please use EMSL Legionella COC
M010 Bacteria Count & ID - 3 Most Prominent		M025 Sewage Screen - Water (MFT*)	
M011 Bacteria Count & ID - 5 Most Prominent		*MFT= Membrane Filtration Technique	
		**MPN = Most Probable Number	
		***P/A = Presence/Absence	

Sample #	Sample Location/Description	Sample Type (Matrix)	Potable / Non-Potable (Only for Water)	Test Code	Volume/Area	Date / Time Collected	Temperature (Lab Use Only)
Example: Sample 1	Kitchen	Water	Potable	M017	1,000 ml	1/1/2021 3:30pm	
	See Attached						

Special Instructions and/or Regulatory Requirements (Sample Specifications, Processing Methods, Limits of Detection, etc.)

Method of Shipment: Drop @ Lab	Sample Condition Upon Receipt:		
Relinquished by: [Signature]	Date/Time: 10/26/21	Received by:	Date/Time:
Relinquished by:	Date/Time:	Received by:	Date/Time:

Controlled Document - COC-34 Micro R13 03/02/2021

☐ AGREE TO ELECTRONIC SIGNATURE (By checking, I consent to signing this Chain of Custody document by electronic signature.)

EMSL Analytical, Inc.'s Laboratory Terms and Conditions are incorporated into this Chain of Custody by reference in their entirety. Submission of samples to EMSL Analytical, Inc. constitutes acceptance and acknowledgment of all terms and conditions by Customer.



EMSL ANALYTICAL, INC.
TESTING LABS • PRODUCTS • TRAINING

Microbiology Chain of Custody Form

EMSL Order Number Lab Use Only

132107950

EMSL Analytical, Inc.
200 Route 130 North
Cinnaminson, NJ 08077

(800) 220-3675

CinnMicroLab@emsl.com

Additional Pages of this Chain of Custody are only necessary if needed for additional sample information

Special Instructions and/or Regulatory Requirements (Sample Specifications, Processing Methods, Limits of Detection, etc.)

Sample #	Sample Location/Description	Sample Type (Matrix)	Potable / Non-Potable (Only for Water)	Test Code	Volume/Area	Date / Time Collected	Temperature (Lab Use Only)
TL-1	2nd Floor Room 224 Insulated Supply Duct	-	-	M411	-	10-18-21 445 pm	
TL-2	2nd Floor Room 224 Uninsulated Return Duct						
TL-3	2nd Floor Room 223 Uninsulated Supply Duct						
TL-4	2nd Floor Room 223 Uninsulated Return Duct						
TL-5	2nd Floor Room 230 Uninsulated Return Duct						
TL-6	2nd Floor Room 230 Insulated Supply Duct						
TL-7	2nd Floor Elevator #5 Lobby Uninsulated Supply Duct						
TL-8	2nd Floor Room 228 Insulated Supply Duct						
TL-9	2nd Floor Room 228 Uninsulated Return Duct						
TL-10	2nd Floor Clerk of District Court Civil Insulated Supply						
TL-11	2nd Floor Clerk of District Court Civil Uninsulated Return Duct						
TL-12	2nd Floor Room 216 Uninsulated Return Duct						
TL-13	2nd Floor Room 216 Uninsulated Supply Duct						
TL-14	2nd Floor Room 211 Uninsulated Return Duct						
TL-15	2nd Floor Room 211 Insulated Supply Duct						
TL-16	2nd Floor Room 221 Uninsulated Supply Duct						
TL-17	2nd Floor Room 221 Uninsulated Return Duct						
TL-18	2nd Floor Room 219 Uninsulated Return Duct						
TL-19	2nd Floor Room 219 Insulated Supply					9:55 pm	

REC'D *KIRBY 0830*
EMSL-BOSTON OCT 22 2021

Method of Shipment

Sample Condition Upon Receipt

Relinquished by <i>Dr. P. Lab</i> <i>[Signature]</i>	Date/Time <i>10/24/21</i>	Received by	Date/Time
Relinquished by	Date/Time	Received by	Date/Time

Continued Document - CCG-34 Micro R13 3/02/2021



AGREE TO ELECTRONIC SIGNATURE (By checking, I consent to signing this Chain of Custody document by electronic signature.)

EMSL Analytical, Inc.'s Laboratory Terms and Conditions are incorporated into this Chain of Custody by reference in their entirety. Submission of samples to EMSL Analytical, Inc. constitutes acceptance and acknowledgment of all terms and conditions by Customer.

Page of



EMSL Analytical, Inc.

5 Constitution Way, Unit A Woburn, MA 01801

Tel/Fax: (781) 933-8411 / (781) 933-8412

<http://www.EMSL.com> / bostonlab@emsl.com

EMSL Order: 132107948

Customer ID: COVI50

Customer PO: 485085

Project ID:

Attention: Ann D. Eckmann

TRC

300 Wildwood Avenue

Woburn, MA 01801

Phone: (781) 933-2555

Fax:

Collected Date: 10/19/2021

Received Date: 10/22/2021

Analyzed Date: 10/25/2021

Project: 485085 - Springfield

Test Report: Microscopic Examination of Fungal Spores, Fungal Structures, Hyphae, and Other Particulates from Tape Samples (EMSL Method MICRO-SOP-200)

Lab Sample Number: Client Sample ID: Sample Location:	132107948-0001 TL-01 Garage Level, Room G42A - Uninsulated Supply Duct	132107948-0002 TL-02 Garage Level, Room G42 - Uninsulated Return Duct	132107948-0003 TL-03 Garage Level, Room G42 - Uninsulated Return Duct at Outside Air Intake	132107948-0004 TL-04 Garage Level, Room G42A - Uninsulated Return Duct	132107948-0005 TL-05 Garage Level, Room G42A at Paint Shop - Uninsulated Return Duct
Spore Types	Category	Category	Category	Category	Category
Alternaria (Ulocladium)	-	-	-	Rare	Rare
Ascospores	-	-	-	-	-
Aspergillus/Penicillium	-	-	-	-	-
Basidiospores	-	-	Rare	Rare	Low
Bipolaris++	-	-	-	-	-
Chaetomium++	-	-	-	-	-
Cladosporium	*High*	*Medium*	-	Low	Low
Curvularia	-	-	-	-	-
Epicoccum	-	-	-	-	-
Fusarium++	-	-	-	-	-
Ganoderma	-	-	-	-	-
Myxomycetes++	-	-	Rare	-	Low
Pithomyces++	-	-	-	-	-
Rust	-	-	-	-	-
Scopulariopsis/Microascus	-	-	-	-	-
Stachybotrys/Memnoniella	-	-	-	-	-
Unidentifiable Spores	-	-	-	-	-
Zygomycetes	-	-	-	-	-
Aureobasidium++	-	-	-	Low	-
Hyphal Fragment	-	-	-	-	-
Insect Fragment	-	-	-	-	-
Pollen	-	-	Low	Low	-
Fibrous Particulate	-	-	-	-	-

Category: Count/per area analyzed - Rare: 1 to 10 Low: 11 to 100 Medium: 101 to 1000 High: >1000

- Denotes Not Detected.

++ Includes other spores with similar morphology; see EMSL's fungal glossary for each specific category.

* = Sample contains fruiting structures and/or hyphae associated with the spores.

No discernable field blank was submitted with this group of samples.

Steve Grise, Laboratory Manager
or other Approved Signatory

EMSL maintains liability limited to cost of analysis. Interpretation and use of test results are the responsibility of the client. This report relates only to the samples reported above and may not be reproduced, except in full, without written approval by EMSL. EMSL bears no responsibility for sample collection activities or analytical method limitations. The report reflects the samples as received. Results are generated from the field sampling data (sampling volumes and areas, locations, etc.) provided by the client on the Chain of Custody. Samples are within quality control criteria and met method specifications unless otherwise noted.

Samples analyzed by EMSL Analytical, Inc. Woburn, MA IHA-LAP, LLC-EMLAP Accredited #180179

Initial report from: 10/25/2021 09:50 AM

For information on the fungi listed in this report, please visit the Resources section at www.emsl.com



EMSL Analytical, Inc.

5 Constitution Way, Unit A Woburn, MA 01801

Tel/Fax: (781) 933-8411 / (781) 933-8412

<http://www.EMSL.com> / bostonlab@emsl.com

EMSL Order: 132107948

Customer ID: COVI50

Customer PO: 485085

Project ID:

Attention: Ann D. Eckmann

TRC

300 Wildwood Avenue

Woburn, MA 01801

Phone: (781) 933-2555

Fax:

Collected Date: 10/19/2021

Received Date: 10/22/2021

Analyzed Date: 10/25/2021

Project: 485085 - Springfield

Test Report: Microscopic Examination of Fungal Spores, Fungal Structures, Hyphae, and Other Particulates from Tape Samples (EMSL Method MICRO-SOP-200)

Lab Sample Number: Client Sample ID: Sample Location:	132107948-0006 TL-06 Plaza, Room 138B - Uninsulated Return Duct	132107948-0007 TL-07 Plaza, Room 138B - Uninsulated Supply Duct	132107948-0008 TL-08 Plaza, Room 167A - Uninsulated Supply Duct	132107948-0009 TL-09 Plaza, Room 167A - Uninsulated Return Duct	132107948-0010 TL-10 Plaza, Room 167 Northeast Corner - Uninsulated Return Duct
Spore Types	Category	Category	Category	Category	Category
Alternaria (Ulocladium)	-	-	-	-	-
Ascospores	-	-	-	-	-
Aspergillus/Penicillium	-	-	-	-	-
Basidiospores	-	-	-	Low	-
Bipolaris++	-	-	-	-	-
Chaetomium++	-	-	-	-	-
Cladosporium	Low	*High*	*Medium*	Low	Low
Curvularia	-	-	-	-	-
Epicoccum	-	-	-	Rare	-
Fusarium++	-	-	-	-	-
Ganoderma	-	-	-	-	-
Myxomycetes++	Low	-	-	Low	Low
Pithomyces++	Rare	-	-	-	-
Rust	-	-	-	-	-
Scopulariopsis/Microascus	-	-	-	-	-
Stachybotrys/Memnoniella	-	-	-	-	-
Unidentifiable Spores	-	-	-	-	-
Zygomycetes	-	-	-	-	-
Aureobasidium++	-	-	*Medium*	-	-
Hyphal Fragment	-	-	-	-	-
Insect Fragment	-	-	-	-	-
Pollen	Low	Low	-	-	Low
Fibrous Particulate	-	-	-	-	-

Category: Count/per area analyzed - Rare: 1 to 10 Low: 11 to 100 Medium: 101 to 1000 High: >1000

- Denotes Not Detected.

++ Includes other spores with similar morphology; see EMSL's fungal glossary for each specific category.

* = Sample contains fruiting structures and/or hyphae associated with the spores.

No discernable field blank was submitted with this group of samples.

Steve Grise, Laboratory Manager
or other Approved Signatory

EMSL maintains liability limited to cost of analysis. Interpretation and use of test results are the responsibility of the client. This report relates only to the samples reported above and may not be reproduced, except in full, without written approval by EMSL. EMSL bears no responsibility for sample collection activities or analytical method limitations. The report reflects the samples as received. Results are generated from the field sampling data (sampling volumes and areas, locations, etc.) provided by the client on the Chain of Custody. Samples are within quality control criteria and met method specifications unless otherwise noted.

Samples analyzed by EMSL Analytical, Inc. Woburn, MA IHA-LAP, LLC-EMLAP Accredited #180179

Initial report from: 10/25/2021 09:50 AM

For information on the fungi listed in this report, please visit the Resources section at www.emsl.com



EMSL Analytical, Inc.

5 Constitution Way, Unit A Woburn, MA 01801

Tel/Fax: (781) 933-8411 / (781) 933-8412

<http://www.EMSL.com> / bostonlab@emsl.com

EMSL Order: 132107948

Customer ID: COVI50

Customer PO: 485085

Project ID:

Attention: Ann D. Eckmann

TRC

300 Wildwood Avenue

Woburn, MA 01801

Phone: (781) 933-2555

Fax:

Collected Date: 10/19/2021

Received Date: 10/22/2021

Analyzed Date: 10/25/2021

Project: 485085 - Springfield

Test Report: Microscopic Examination of Fungal Spores, Fungal Structures, Hyphae, and Other Particulates from Tape Samples (EMSL Method MICRO-SOP-200)

Lab Sample Number: Client Sample ID: Sample Location:	132107948-0011 TL-11 Plaza, Room 167 East Corner - Uninsulated Supply Duct	132107948-0012 TL-12 Plaza, Room 147 - Uninsulated Return Duct	132107948-0013 TL-13 Plaza, Room 147 - Uninsulated Supply Duct		
Spore Types	Category	Category	Category		
Alternaria (Ulocladium)	-	-	-		
Ascospores	-	-	-		
Aspergillus/Penicillium	-	-	-		
Basidiospores	Rare	-	-		
Bipolaris++	-	-	-		
Chaetomium++	-	-	-		
Cladosporium	*High*	*Low*	*High*		
Curvularia	-	-	-		
Epicoccum	-	-	-		
Fusarium++	-	-	-		
Ganoderma	-	-	-		
Myxomycetes++	Low	Low	Low		
Pithomyces++	-	-	-		
Rust	-	-	-		
Scopulariopsis/Microascus	-	-	-		
Stachybotrys/Memnoniella	-	-	-		
Unidentifiable Spores	-	-	-		
Zygomycetes	-	-	-		
Aureobasidium++	-	*Low*	-		
Hyphal Fragment	-	-	-		
Insect Fragment	-	-	-		
Pollen	Rare	-	-		
Fibrous Particulate	-	-	-		

Category: Count/per area analyzed - Rare: 1 to 10 Low: 11 to 100 Medium: 101 to 1000 High: >1000

- Denotes Not Detected.

++ Includes other spores with similar morphology; see EMSL's fungal glossary for each specific category.

* = Sample contains fruiting structures and/or hyphae associated with the spores.

No discernable field blank was submitted with this group of samples.

Steve Grise, Laboratory Manager
or other Approved Signatory

EMSL maintains liability limited to cost of analysis. Interpretation and use of test results are the responsibility of the client. This report relates only to the samples reported above and may not be reproduced, except in full, without written approval by EMSL. EMSL bears no responsibility for sample collection activities or analytical method limitations. The report reflects the samples as received. Results are generated from the field sampling data (sampling volumes and areas, locations, etc.) provided by the client on the Chain of Custody. Samples are within quality control criteria and met method specifications unless otherwise noted.

Samples analyzed by EMSL Analytical, Inc. Woburn, MA IHA-LAP, LLC-EMLAP Accredited #180179

Initial report from: 10/25/2021 09:50 AM

For information on the fungi listed in this report, please visit the Resources section at www.emsl.com

EMSL

EMSL ANALYTICAL, INC.
TESTING LABS • PRODUCTS • TRAINING

Microbiology Chain of Custody Form

EMSL Order Number / Lab Use Only

132107948

EMSL Analytical, Inc.
200 Route 130 North
Cinnaminson, NJ 08077

PHONE (800) 220-3675

EMAIL: CinnMicroLab@emsl.com

If B&T is the same as Report-To leave this section blank. Third-party billing requires written authorization.

Customer Information	Customer ID:	Billing ID:
	Company Name: <u>TRC</u>	Company Name:
	Contact Name: <u>Mr. Behnam / Mike McCarter</u>	Billing Contact:
	Street Address: <u>300 W. Wood Ave</u>	Street Address:
	City, State, Zip: <u>Woburn MA 01801</u> Country:	City, State, Zip: Country:
	Phone: <u>603-346-7600</u>	Phone:
Email(s) for Report: <u>becknam@trc.com / mccarter@trc.com</u>	Email(s) for Invoice:	

Project Information		Purchase Order:
Project Name/No: <u>458055 Springfield</u>		
EMSL LIMS Project ID: (If applicable, EMSL will provide)	State Samples Collected: <u>MA</u> Zip Code Samples Collected:	State of Connecticut (CT) must select project location: <input type="checkbox"/> Commercial (Taxable) <input type="checkbox"/> Residential (Non-taxable)
Sampled By Name: <u>Michael McCarter</u>	Sampled By Signature: <u>[Signature]</u>	No. of Samples in Shipment:
Sterile, Sodium Thiosulfate Preserved Bottle Used: <input type="checkbox"/> Biocide Used in Source (specify):		
Public Water Supply Samples: <input type="checkbox"/> Note: All results may automatically be reported to DOH if required by State.		
Turn-Around-Time (TAT) Please call ahead for large projects and/or turnaround times 3 hours or less. *32 Hour TAT available for select tests only; samples must be submitted by 11:30am. <input type="checkbox"/> 3 Hour <input type="checkbox"/> 5 Hour <input checked="" type="checkbox"/> 24 Hour <input type="checkbox"/> 32* Hour <input type="checkbox"/> 48 Hour <input type="checkbox"/> 72 Hour <input type="checkbox"/> 96 Hour <input type="checkbox"/> 1 Week <input type="checkbox"/> 2 Week		

MICROBIOLOGY TEST CODES			
M001 Air-O-Cell	M174 MoldSnap	M012 Pseudomonas aeruginosa (P/A***)	M115 Sewage Screen - Water (P/A***)
M030 Micro 5	M032 Allergenco-D	M024 Pseudomonas aeruginosa (MFT*)	M116 Sewage Screen - Water (MPN**)
M041 Fungal Direct Examination		M015 Heterotrophic Plate Count	M117 Sewage Screen - Swab (P/A***)
M169 Pollen ID & Enumeration		M017 Total Coliform & E. Coli (Colilert P/A***)	M013 Sewage Screen - Swab (MFT*)
M280 Dust Characterization Level-1		M018 Total Coliform & E. Coli (MFT*)	M730 Methicillin-resistant Staph. aureus (MRSA)
M281 Dust Characterization Level-2		M114 Total Coliform & E. Coli Enumeration (Colilert MPN**)	M031 Rapid-growing non-TB Mycobacteria Detection & Enumeration
M005 Viable Fungi-Air Samples (Genus ID & Count)		M019 Fecal Coliform (MFT*)	M014 Endotoxin Analysis
M006 Viable Fungi-Air Samples (Includes Penicillium, Aspergillus, Cladosporium, Stachybotrys Species ID & Count)		M020 Fecal Streptococcus (MFT*)	M044 Group Allergen (Cat, Dog, Cockroach, Dust Mite)
M007 Culturable Fungi-Surface Samples (Genus ID & Count)		M029 Enterococci (MFT*)	M095 Bacteroides
M008 Culturable Fungi-Surface Samples (Includes Penicillium, Aspergillus, Cladosporium, Stachybotrys Species ID & Count)		M129 Enterococci (Enterolert P/A***)	Other - See Analytical Price Guide for Test Code
M009 Bacteria Culture Gram Stain & Count		M180 Real Time qPCR-ERMI 36 Panel	Legionella Analysis Please use EMSL Legionella COC
M010 Bacteria Count & ID - 3 Most Prominent		M025 Sewage Screen - Water (MFT*)	
M011 Bacteria Count & ID - 5 Most Prominent		*MFT= Membrane Filtration Technique	
		**MPN = Most Probable Number	
		***P/A = Presence/Absence	

Sample #	Sample Location/Description	Sample Type (Matrix)	Potable / Non-Potable (Only for Water)	Test Code	Volume/Area	Date / Time Collected	Temperature (Lab Use Only)
Example: Sample 1	Kitchen	Water	Potable	M017	1,000 ml	1/1/2021 3:30pm	
	<u>See Attached</u>						

Special Instructions and/or Regulatory Requirements (Sample Specifications, Processing Methods, Limits of Detection, etc.)

Method of Shipment: <u>Express @ LAA</u>	Sample Condition Upon Receipt:
Relinquished by: <u>[Signature]</u>	Received by: <u>[Signature]</u>
Date/Time: <u>10/24/21</u>	Date/Time:
Relinquished by: <u>[Signature]</u>	Received by: <u>[Signature]</u>
Date/Time:	Date/Time:

Controlled Document - COC-34 Micro R13 03/02/2021

☐ AGREE TO ELECTRONIC SIGNATURE (By checking, I consent to signing this Chain of Custody document by electronic signature.)

EMSL Analytical, Inc.'s Laboratory Terms and Conditions are incorporated into this Chain of Custody by reference in their entirety. Submission of samples to EMSL Analytical, Inc. constitutes acceptance and acknowledgment of all terms and conditions by Customer.



EMSL Analytical, Inc.

5 Constitution Way, Unit A Woburn, MA 01801

Tel/Fax: (781) 933-8411 / (781) 933-8412

<http://www.EMSL.com> / bostonlab@emsl.com

EMSL Order: 132107947

Customer ID: COVI50

Customer PO: 485085

Project ID:

Attention: Ann D. Eckmann

TRC

300 Wildwood Avenue

Woburn, MA 01801

Phone: (781) 933-2555

Fax:

Collected Date: 10/20/2021

Received Date: 10/22/2021

Analyzed Date: 10/25/2021

Project: 485085 - Springfield

Test Report: Microscopic Examination of Fungal Spores, Fungal Structures, Hyphae, and Other Particulates from Tape Samples (EMSL Method MICRO-SOP-200)

Lab Sample Number: Client Sample ID: Sample Location:	132107947-0001 TL-01 Garage Level, Room G42 - Uninsulated Supply Duct at AC4	132107947-0002 TL-02 Garage Level, Room G42 Hall at Door to Garage - Uninsulated Supply Duct	132107947-0003 TL-03 Garage Level, Room G42 - Uninsulated Return at AC4	132107947-0004 TL-04 Garage Level, Room G42C - Uninsulated Return Duct	132107947-0005 TL-05 Plaza, Room 142 - Insulated Supply Duct
Spore Types	Category	Category	Category	Category	Category
Alternaria (Ulocladium)	-	-	-	-	-
Ascospores	-	-	-	-	-
Aspergillus/Penicillium	-	-	-	-	-
Basidiospores	-	-	-	Low	-
Bipolaris++	-	-	-	-	-
Chaetomium++	-	-	-	-	-
Cladosporium	*Low*	*Medium*	Low	Low	*High*
Curvularia	-	-	-	Rare	-
Epicoccum	-	-	Low	-	-
Fusarium++	-	-	-	-	-
Ganoderma	-	-	-	-	-
Myxomycetes++	-	-	Low	Rare	-
Pithomyces++	-	-	-	-	-
Rust	-	-	-	-	-
Scopulariopsis/Microascus	-	-	-	-	-
Stachybotrys/Memnoniella	-	-	-	-	-
Unidentifiable Spores	-	-	-	-	-
Zygomycetes	-	-	-	-	-
Aureobasidium++	*Low*	*Low*	Low	Rare	*Medium*
Hyphal Fragment	-	-	-	-	-
Insect Fragment	-	-	-	-	-
Pollen	-	Low	Low	Low	-
Fibrous Particulate	-	-	-	-	-

Category: Count/per area analyzed - Rare: 1 to 10 Low: 11 to 100 Medium: 101 to 1000 High: >1000

- Denotes Not Detected.

++ Includes other spores with similar morphology; see EMSL's fungal glossary for each specific category.

* = Sample contains fruiting structures and/or hyphae associated with the spores.

No discernable field blank was submitted with this group of samples.

Steve Grise, Laboratory Manager
or other Approved Signatory

EMSL maintains liability limited to cost of analysis. Interpretation and use of test results are the responsibility of the client. This report relates only to the samples reported above and may not be reproduced, except in full, without written approval by EMSL. EMSL bears no responsibility for sample collection activities or analytical method limitations. The report reflects the samples as received. Results are generated from the field sampling data (sampling volumes and areas, locations, etc.) provided by the client on the Chain of Custody. Samples are within quality control criteria and met method specifications unless otherwise noted.

Samples analyzed by EMSL Analytical, Inc. Woburn, MA AIHA-LAP, LLC-EMLAP Accredited #180179

Initial report from: 10/25/2021 09:51 AM

For information on the fungi listed in this report, please visit the Resources section at www.emsl.com



EMSL Analytical, Inc.

5 Constitution Way, Unit A Woburn, MA 01801

Tel/Fax: (781) 933-8411 / (781) 933-8412

<http://www.EMSL.com> / bostonlab@emsl.com

EMSL Order: 132107947

Customer ID: COVI50

Customer PO: 485085

Project ID:

Attention: Ann D. Eckmann

TRC

300 Wildwood Avenue

Woburn, MA 01801

Phone: (781) 933-2555

Fax:

Collected Date: 10/20/2021

Received Date: 10/22/2021

Analyzed Date: 10/25/2021

Project: 485085 - Springfield

Test Report: Microscopic Examination of Fungal Spores, Fungal Structures, Hyphae, and Other Particulates from Tape Samples (EMSL Method MICRO-SOP-200)

Lab Sample Number: Client Sample ID: Sample Location:	132107947-0006 TL-06 Plaza, Room 142 - Uninsulated Return Duct	132107947-0007 TL-07 Plaza, Room 166 - Uninsulated Return Duct	132107947-0008 TL-08 Plaza, Room 166 - Uninsulated Supply Duct	132107947-0009 TL-09 Plaza, Room 114A - Uninsulated Return Duct	132107947-0010 TL-10 Plaza, Room 119 - Uninsulated Supply Duct
Spore Types	Category	Category	Category	Category	Category
Alternaria (Ulocladium)	-	-	-	-	-
Ascospores	-	-	-	-	-
Aspergillus/Penicillium	-	-	-	-	-
Basidiospores	Rare	-	-	-	-
Bipolaris++	-	-	-	-	-
Chaetomium++	-	-	-	-	-
Cladosporium	Low	Low	*Medium*	Low	*High*
Curvularia	-	-	-	-	-
Epicoccum	-	-	-	-	-
Fusarium++	-	-	-	-	-
Ganoderma	-	-	-	-	-
Myxomycetes++	Rare	Low	Low	Low	-
Pithomyces++	-	-	-	-	-
Rust	-	-	-	-	-
Scopulariopsis/Microascus	-	-	-	-	-
Stachybotrys/Memnoniella	-	-	-	-	-
Unidentifiable Spores	-	-	-	-	-
Zygomycetes	-	-	-	-	-
Aureobasidium++	-	Rare	Low	Low	*Low*
Hyphal Fragment	-	-	-	-	-
Insect Fragment	-	-	-	-	-
Pollen	-	-	-	-	-
Fibrous Particulate	-	-	-	-	-

Category: Count/per area analyzed - Rare: 1 to 10 Low: 11 to 100 Medium: 101 to 1000 High: >1000

- Denotes Not Detected.

++ Includes other spores with similar morphology; see EMSL's fungal glossary for each specific category.

* = Sample contains fruiting structures and/or hyphae associated with the spores.

No discernable field blank was submitted with this group of samples.

Steve Grise, Laboratory Manager
or other Approved Signatory

EMSL maintains liability limited to cost of analysis. Interpretation and use of test results are the responsibility of the client. This report relates only to the samples reported above and may not be reproduced, except in full, without written approval by EMSL. EMSL bears no responsibility for sample collection activities or analytical method limitations. The report reflects the samples as received. Results are generated from the field sampling data (sampling volumes and areas, locations, etc.) provided by the client on the Chain of Custody. Samples are within quality control criteria and met method specifications unless otherwise noted.

Samples analyzed by EMSL Analytical, Inc. Woburn, MA IHA-LAP, LLC-EMLAP Accredited #180179

Initial report from: 10/25/2021 09:51 AM

For information on the fungi listed in this report, please visit the Resources section at www.emsl.com



EMSL Analytical, Inc.

5 Constitution Way, Unit A Woburn, MA 01801
 Tel/Fax: (781) 933-8411 / (781) 933-8412
<http://www.EMSL.com> / bostonlab@emsl.com

EMSL Order: 132107947
 Customer ID: COVI50
 Customer PO: 485085
 Project ID:

Attention: Ann D. Eckmann
 TRC
 300 Wildwood Avenue
 Woburn, MA 01801

Phone: (781) 933-2555

Fax:

Collected Date: 10/20/2021

Received Date: 10/22/2021

Analyzed Date: 10/25/2021

Project: 485085 - Springfield

Test Report: Microscopic Examination of Fungal Spores, Fungal Structures, Hyphae, and Other Particulates from Tape Samples (EMSL Method MICRO-SOP-200)

Lab Sample Number: Client Sample ID: Sample Location:	132107947-0011 TL-11 Plaza, Room 114 - Uninsulated Supply Duct	132107947-0012 TL-12 Plaza, Room 138A - Uninsulated Return Duct			
Spore Types	Category	Category			
Alternaria (Ulocladium)	-	-			
Ascospores	-	-			
Aspergillus/Penicillium	-	-			
Basidiospores	-	-			
Bipolaris++	-	-			
Chaetomium++	-	-			
Cladosporium	*Medium*	Medium			
Curvularia	-	-			
Epicoccum	-	-			
Fusarium++	-	-			
Ganoderma	-	-			
Myxomycetes++	-	Rare			
Pithomyces++	-	-			
Rust	-	-			
Scopulariopsis/Microascus	-	-			
Stachybotrys/Memnoniella	-	-			
Unidentifiable Spores	-	-			
Zygomycetes	-	-			
Aureobasidium++	Low	-			
Hyphal Fragment	-	-			
Insect Fragment	-	-			
Pollen	High	Low			
Fibrous Particulate	-	-			

Category: Count/per area analyzed - Rare: 1 to 10 Low: 11 to 100 Medium: 101 to 1000 High: >1000

- Denotes Not Detected.

++ Includes other spores with similar morphology; see EMSL's fungal glossary for each specific category.

* = Sample contains fruiting structures and/or hyphae associated with the spores.

No discernable field blank was submitted with this group of samples.

Steve Grise, Laboratory Manager
 or other Approved Signatory

EMSL maintains liability limited to cost of analysis. Interpretation and use of test results are the responsibility of the client. This report relates only to the samples reported above and may not be reproduced, except in full, without written approval by EMSL. EMSL bears no responsibility for sample collection activities or analytical method limitations. The report reflects the samples as received. Results are generated from the field sampling data (sampling volumes and areas, locations, etc.) provided by the client on the Chain of Custody. Samples are within quality control criteria and met method specifications unless otherwise noted.

Samples analyzed by EMSL Analytical, Inc. Woburn, MA IHA-LAP, LLC-EMLAP Accredited #180179

Initial report from: 10/25/2021 09:51 AM

For information on the fungi listed in this report, please visit the Resources section at www.emsl.com



EMSL ANALYTICAL, INC.
TESTING LABS • PRODUCTS • TRAINING

Microbiology Chain of Custody Form

EMSL Order Number / Lab Use Only

132107947

EMSL Analytical, Inc.
200 Route 130 North
Cinnaminson, NJ 08077

PHONE (800) 220-3675

EMAIL CinnMicroLab@emsl.com

If B&T is the same as Report-To leave this section blank. Third-party billing requires written authorization.

Customer Information	Customer ID:	Billing ID:
	Company Name: <u>TRC</u>	Company Name:
	Contact Name: <u>AM Echman / Mike McCarty</u>	Billing Contact:
	Street Address: <u>300 W. 10th St</u>	Street Address:
	City, State, Zip: <u>Woburn MA 01801</u> Country:	City, State, Zip: Country:
	Phone: <u>603 346 2600</u>	Phone:
Email(s) for Report: <u>ecchman@trcny.com / mcmccarty@trcny.com</u>	Email(s) for Invoice:	

Project Name/No: <u>4P505 Springfield</u>		Purchase Order:
EMSL LIMS Project ID: (If applicable, EMSL will provide)	State Samples Collected: <u>MA</u> Zip Code Samples Collected:	State of Connecticut (CT) must select project location: <input type="checkbox"/> Commercial (Taxable) <input type="checkbox"/> Residential (Non-taxable)
Sampled By Name: <u>Michael McCarty</u>	Sampled By Signature: <u>Michael McCarty</u>	No. of Samples in Shipment:

Sterile, Sodium Thiosulfate Preserved Bottle Used: <input type="checkbox"/> Biocide Used in Source (specify):	
Public Water Supply Samples: <input type="checkbox"/> Note: All results may automatically be reported to DOH if required by State.	
Turn-Around-Time (TAT) Please call ahead for large projects and/or turnaround times 3 hours or less. 72 hour TAT available for select tests only; samples must be submitted by 11:30am. <input type="checkbox"/> 3 Hour <input type="checkbox"/> 6 Hour <input checked="" type="checkbox"/> 24 Hour <input type="checkbox"/> 32 Hour <input type="checkbox"/> 48 Hour <input type="checkbox"/> 72 Hour <input type="checkbox"/> 96 Hour <input type="checkbox"/> 1 Week <input type="checkbox"/> 2 Week	

MICROBIOLOGY TEST CODES			
M001 Air-O-Cell	M174 MoldSnap	M012 Pseudomonas aeruginosa (P/A***)	M115 Sewage Screen - Water (P/A***)
M030 Micro 5	M032 Allergenco-D	M024 Pseudomonas aeruginosa (MFT*)	M116 Sewage Screen - Water (MPN**)
M041 Fungal Direct Examination		M015 Heterotrophic Plate Count	M117 Sewage Screen - Swab (P/A***)
M169 Pollen ID & Enumeration		M017 Total Coliform & E. Coli (Colilert P/A***)	M013 Sewage Screen - Swab (MFT*)
M280 Dust Characterization Level-1		M018 Total Coliform & E. Coli (MFT*)	M730 Methicillin-resistant Staph. aureus (MRSA)
M281 Dust Characterization Level-2		M114 Total Coliform & E. Coli Enumeration (Colilert MPN**)	M031 Rapid-growing non-TB Mycobacteria Detection & Enumeration
M005 Viable Fungi-Air Samples (Genus ID & Count)		M019 Fecal Coliform (MFT*)	
M006 Viable Fungi-Air Samples (Includes Penicillium, Aspergillus, Cladosporium, Stachybotrys Species ID & Count)		M020 Fecal Streptococcus (MFT*)	M014 Endotoxin Analysis
M007 Culturable Fungi-Surface Samples (Genus ID & Count)		M029 Enterococci (MFT*)	M044 Group Allergen (Cat, Dog, Cockroach, Dust Mite)
M008 Culturable Fungi-Surface Samples (Includes Penicillium, Aspergillus, Cladosporium, Stachybotrys Species ID & Count)		M129 Enterococci (Enterolert P/A***)	M095 Bacteroides
M009 Bacteria Culture Gram Stain & Count		M180 Real Time qPCR-ERMI 36 Panel	Other - See Analytical Price Guide for Test Code
M010 Bacteria Count & ID - 3 Most Prominent		M025 Sewage Screen - Water (MFT*)	Legionella Analysis Please use EMSL Legionella COC
M011 Bacteria Count & ID - 5 Most Prominent		*MFT = Membrane Filtration Technique	
		**MPN = Most Probable Number	
		***P/A = Presence/Absence	

Sample #	Sample Location/Description	Sample Type (Matrix)	Potable / Non-Potable (Only for Water)	Test Code	Volume/Area	Date / Time Collected	Temperature (Lab Use Only)
Example: Sample 1	Kitchen	Water	Potable	M017	1,000 ml	1/1/2021 3:30pm	
	<u>See Attached</u>						

REC'D RTR 0830
EMSL-BOSTON OCT 22 2021
Dur Rex

Special Instructions and/or Regulatory Requirements (Sample Specifications, Processing Methods, Limits of Detection, etc.)

Method of Shipment: <u>Direct @ Lab</u>	Sample Condition Upon Receipt:
Relinquished by: <u>[Signature]</u> Date/Time: <u>10/21/21</u>	Received by: Date/Time:
Relinquished by: Date/Time:	Received by: Date/Time:

Controlled Document - COC-34 Micro R13 03/02/2021

☐ AGREE TO ELECTRONIC SIGNATURE (By checking, I consent to signing this Chain of Custody document by electronic signature.)

EMSL Analytical, Inc.'s Laboratory Terms and Conditions are incorporated into this Chain of Custody by reference in its entirety. Submission of samples to EMSL Analytical, Inc. constitutes acceptance and acknowledgment of all terms and conditions by Customer.



EMSL Analytical, Inc.

5 Constitution Way, Unit A Woburn, MA 01801

Tel/Fax: (781) 933-8411 / (781) 933-8412

<http://www.EMSL.com> / bostonlab@emsl.com

EMSL Order: 132107949

Customer ID: COVI50

Customer PO: 485085

Project ID:

Attention: Ann D. Eckmann

TRC

300 Wildwood Avenue

Woburn, MA 01801

Phone: (781) 933-2555

Fax:

Collected Date: 10/21/2021

Received Date: 10/22/2021

Analyzed Date: 10/25/2021

Project: 485085 - Springfield

Test Report: Microscopic Examination of Fungal Spores, Fungal Structures, Hyphae, and Other Particulates from Tape Samples (EMSL Method MICRO-SOP-200)

Lab Sample Number: Client Sample ID: Sample Location:	132107949-0001 TL-01 Plaza, Room 131 - Uninsulated Return Duct	132107949-0002 TL-02 Plaza, Hall at Room 122 - Uninsulated Return Duct	132107949-0003 TL-03 Plaza, Room 121 - Uninsulated Supply Duct	132107949-0004 TL-04 Plaza, Room 121B - Uninsulated Return Duct	132107949-0005 TL-05 Plaza, Elevator #5 Lobby - Uninsulated Supply Duct
Spore Types	Category	Category	Category	Category	Category
Alternaria (Ulocladium)	-	-	-	-	-
Ascospores	-	-	-	-	-
Aspergillus/Penicillium	-	-	-	Low	-
Basidiospores	-	-	-	-	-
Bipolaris++	-	-	-	-	-
Chaetomium++	-	-	-	-	-
Cladosporium	Low	Low	*Medium*	*Low*	*High*
Curvularia	-	-	-	-	-
Epicoccum	-	-	-	-	-
Fusarium++	-	-	-	-	-
Ganoderma	-	-	-	-	-
Myxomycetes++	Low	-	-	-	-
Pithomyces++	-	-	-	-	-
Rust	-	-	-	-	-
Scopulariopsis/Microascus	-	-	-	-	-
Stachybotrys/Memnoniella	-	-	-	-	-
Unidentifiable Spores	-	-	-	-	-
Zygomycetes	-	-	-	-	-
Aureobasidium++	Low	Low	Low	Low	-
Hyphal Fragment	-	-	-	-	-
Insect Fragment	-	-	-	-	-
Pollen	-	-	-	-	-
Fibrous Particulate	-	-	-	-	-

Category: Count/per area analyzed - Rare: 1 to 10 Low: 11 to 100 Medium: 101 to 1000 High: >1000

- Denotes Not Detected.

++ Includes other spores with similar morphology; see EMSL's fungal glossary for each specific category.

* = Sample contains fruiting structures and/or hyphae associated with the spores.

No discernable field blank was submitted with this group of samples.

Steve Grise, Laboratory Manager
or other Approved Signatory

EMSL maintains liability limited to cost of analysis. Interpretation and use of test results are the responsibility of the client. This report relates only to the samples reported above and may not be reproduced, except in full, without written approval by EMSL. EMSL bears no responsibility for sample collection activities or analytical method limitations. The report reflects the samples as received. Results are generated from the field sampling data (sampling volumes and areas, locations, etc.) provided by the client on the Chain of Custody. Samples are within quality control criteria and met method specifications unless otherwise noted.

Samples analyzed by EMSL Analytical, Inc. Woburn, MA IHA-LAP, LLC-EMLAP Accredited #180179

Initial report from: 10/25/2021 08:39 AM

For information on the fungi listed in this report, please visit the Resources section at www.emsl.com



EMSL Analytical, Inc.

5 Constitution Way, Unit A Woburn, MA 01801
 Tel/Fax: (781) 933-8411 / (781) 933-8412
<http://www.EMSL.com> / bostonlab@emsl.com

EMSL Order: 132107949
 Customer ID: COVI50
 Customer PO: 485085
 Project ID:

Attention: Ann D. Eckmann
 TRC
 300 Wildwood Avenue
 Woburn, MA 01801

Phone: (781) 933-2555

Fax:

Collected Date: 10/21/2021

Received Date: 10/22/2021

Analyzed Date: 10/25/2021

Project: 485085 - Springfield

Test Report: Microscopic Examination of Fungal Spores, Fungal Structures, Hyphae, and Other Particulates from Tape Samples (EMSL Method MICRO-SOP-200)

Lab Sample Number: Client Sample ID: Sample Location:	132107949-0006 TL-06 Plaza, Room 124 - Uninsulated Return Duct	132107949-0007 TL-07 Plaza, Room 124 Attorney Booth - Uninsulated Supply Duct	132107949-0008 TL-08 Plaza, Hall at Room 140A - Uninsulated Return Duct	132107949-0009 TL-09 Plaza, Room 131 - Insulated Supply Duct	132107949-0010 TL-10 Plaza, Room 131 - Uninsulated Return Duct
Spore Types	Category	Category	Category	Category	Category
Alternaria (Ulocladium)	-	-	-	-	-
Ascospores	-	-	-	-	-
Aspergillus/Penicillium	-	-	-	-	Rare
Basidiospores	-	-	-	-	Low
Bipolaris++	-	-	-	-	-
Chaetomium++	-	-	-	-	-
Cladosporium	Low	*Medium*	*Medium*	*High*	*Low*
Curvularia	-	-	-	-	Rare
Epicoccum	-	-	-	-	-
Fusarium++	-	-	-	-	-
Ganoderma	-	-	-	-	-
Myxomycetes++	-	-	-	-	-
Pithomyces++	-	-	-	-	-
Rust	-	-	-	-	-
Scopulariopsis/Microascus	-	-	-	-	-
Stachybotrys/Memnoniella	-	-	-	-	-
Unidentifiable Spores	-	-	-	-	-
Zygomycetes	-	-	-	-	-
Aureobasidium++	Low	*Medium*	*Low*	*Medium*	*Low*
Hyphal Fragment	-	-	-	-	-
Insect Fragment	-	-	-	-	-
Pollen	Low	-	-	-	-
Fibrous Particulate	-	-	-	-	-

Category: Count/per area analyzed - Rare: 1 to 10 Low: 11 to 100 Medium: 101 to 1000 High: >1000

- Denotes Not Detected.

++ Includes other spores with similar morphology; see EMSL's fungal glossary for each specific category.

* = Sample contains fruiting structures and/or hyphae associated with the spores.

No discernable field blank was submitted with this group of samples.

Steve Grise, Laboratory Manager
 or other Approved Signatory

EMSL maintains liability limited to cost of analysis. Interpretation and use of test results are the responsibility of the client. This report relates only to the samples reported above and may not be reproduced, except in full, without written approval by EMSL. EMSL bears no responsibility for sample collection activities or analytical method limitations. The report reflects the samples as received. Results are generated from the field sampling data (sampling volumes and areas, locations, etc.) provided by the client on the Chain of Custody. Samples are within quality control criteria and met method specifications unless otherwise noted.

Samples analyzed by EMSL Analytical, Inc. Woburn, MA IHA-LAP, LLC-EMLAP Accredited #180179

Initial report from: 10/25/2021 08:39 AM

For information on the fungi listed in this report, please visit the Resources section at www.emsl.com



EMSL Analytical, Inc.

5 Constitution Way, Unit A Woburn, MA 01801

Tel/Fax: (781) 933-8411 / (781) 933-8412

<http://www.EMSL.com> / bostonlab@emsl.com

EMSL Order: 132107949

Customer ID: COVI50

Customer PO: 485085

Project ID:

Attention: Ann D. Eckmann

TRC

300 Wildwood Avenue

Woburn, MA 01801

Phone: (781) 933-2555

Fax:

Collected Date: 10/21/2021

Received Date: 10/22/2021

Analyzed Date: 10/25/2021

Project: 485085 - Springfield

Test Report: Microscopic Examination of Fungal Spores, Fungal Structures, Hyphae, and Other Particulates from Tape Samples (EMSL Method MICRO-SOP-200)

Lab Sample Number: Client Sample ID: Sample Location:	132107949-0011 TL-11 Plaza, Room 110B at Room 108 - Insulated Supply Duct	132107949-0012 TL-12 Plaza, Room 110B at Room 109 - Uninsulated Return Duct	132107949-0013 TL-13 Plaza, Room 108 - Uninsulated Supply Duct	132107949-0014 TL-14 Plaza, Room 110B at Room 107 - Uninsulated Supply Duct	132107949-0015 TL-15 Plaza, Room 110B at Room 108 - Uninsulated Return Duct
Spore Types	Category	Category	Category	Category	Category
Alternaria (Ulocladium)	-	-	-	-	-
Ascospores	-	-	-	-	-
Aspergillus/Penicillium	-	-	-	-	-
Basidiospores	-	-	-	-	-
Bipolaris++	-	-	-	-	-
Chaetomium++	-	-	-	-	-
Cladosporium	*High*	Low	*High*	*Medium*	*Low*
Curvularia	-	-	-	-	-
Epicoccum	-	-	-	-	-
Fusarium++	-	-	-	-	-
Ganoderma	-	-	-	-	-
Myxomycetes++	-	-	-	-	-
Pithomyces++	-	-	-	-	-
Rust	-	-	-	-	-
Scopulariopsis/Microascus	-	-	-	-	-
Stachybotrys/Memnoniella	-	-	-	-	-
Unidentifiable Spores	-	-	-	-	-
Zygomycetes	-	-	-	-	-
Aureobasidium++	*Low*	Low	*Low*	*High*	*Low*
Hyphal Fragment	-	-	-	-	-
Insect Fragment	-	-	-	-	-
Pollen	-	-	-	-	Low
Fibrous Particulate	-	-	-	-	-

Category: Count/per area analyzed - Rare: 1 to 10 Low: 11 to 100 Medium: 101 to 1000 High: >1000

- Denotes Not Detected.

++ Includes other spores with similar morphology; see EMSL's fungal glossary for each specific category.

* = Sample contains fruiting structures and/or hyphae associated with the spores.

No discernable field blank was submitted with this group of samples.

Steve Grise, Laboratory Manager
or other Approved Signatory

EMSL maintains liability limited to cost of analysis. Interpretation and use of test results are the responsibility of the client. This report relates only to the samples reported above and may not be reproduced, except in full, without written approval by EMSL. EMSL bears no responsibility for sample collection activities or analytical method limitations. The report reflects the samples as received. Results are generated from the field sampling data (sampling volumes and areas, locations, etc.) provided by the client on the Chain of Custody. Samples are within quality control criteria and met method specifications unless otherwise noted.

Samples analyzed by EMSL Analytical, Inc. Woburn, MA IHA-LAP, LLC-EMLAP Accredited #180179

Initial report from: 10/25/2021 08:39 AM

For information on the fungi listed in this report, please visit the Resources section at www.emsl.com



EMSL Analytical, Inc.

5 Constitution Way, Unit A Woburn, MA 01801

Tel/Fax: (781) 933-8411 / (781) 933-8412

<http://www.EMSL.com> / bostonlab@emsl.com

EMSL Order: 132107949

Customer ID: COVI50

Customer PO: 485085

Project ID:

Attention: Ann D. Eckmann

TRC

300 Wildwood Avenue

Woburn, MA 01801

Phone: (781) 933-2555

Fax:

Collected Date: 10/21/2021

Received Date: 10/22/2021

Analyzed Date: 10/25/2021

Project: 485085 - Springfield

Test Report: Microscopic Examination of Fungal Spores, Fungal Structures, Hyphae, and Other Particulates from Tape Samples (EMSL Method MICRO-SOP-200)

Lab Sample Number: Client Sample ID: Sample Location:	132107949-0016 TL-16 ¹⁰³ Plaza, Room 69 - Uninsulated Supply Duct	132107949-0017 TL-17 Plaza, Hall at Room 102 - Uninsulated Supply Duct			
Spore Types	Category	Category			
Alternaria (Ulocladium)	-	-			
Ascospores	-	-			
Aspergillus/Penicillium	-	-			
Basidiospores	-	-			
Bipolaris++	-	-			
Chaetomium++	-	-			
Cladosporium	*High*	*Medium*			
Curvularia	-	-			
Epicoccum	-	-			
Fusarium++	-	-			
Ganoderma	-	-			
Myxomycetes++	-	-			
Pithomyces++	-	-			
Rust	-	-			
Scopulariopsis/Microascus	-	-			
Stachybotrys/Memnoniella	-	-			
Unidentifiable Spores	-	-			
Zygomycetes	-	-			
Aureobasidium++	*Low*	*High*			
Hyphal Fragment	-	-			
Insect Fragment	-	-			
Pollen	-	-			
Fibrous Particulate	-	-			

Category: Count/per area analyzed - Rare: 1 to 10 Low: 11 to 100 Medium: 101 to 1000 High: >1000

- Denotes Not Detected.

++ Includes other spores with similar morphology; see EMSL's fungal glossary for each specific category.

* = Sample contains fruiting structures and/or hyphae associated with the spores.

No discernable field blank was submitted with this group of samples.

Steve Grise, Laboratory Manager
or other Approved Signatory

EMSL maintains liability limited to cost of analysis. Interpretation and use of test results are the responsibility of the client. This report relates only to the samples reported above and may not be reproduced, except in full, without written approval by EMSL. EMSL bears no responsibility for sample collection activities or analytical method limitations. The report reflects the samples as received. Results are generated from the field sampling data (sampling volumes and areas, locations, etc.) provided by the client on the Chain of Custody. Samples are within quality control criteria and met method specifications unless otherwise noted.

Samples analyzed by EMSL Analytical, Inc. Woburn, MA IHA-LAP, LLC-EMLAP Accredited #180179

Initial report from: 10/25/2021 08:39 AM

For information on the fungi listed in this report, please visit the Resources section at www.emsl.com



EMSL ANALYTICAL, INC.
TESTING LABS • PRODUCTS • TRAINING

Microbiology Chain of Custody Form

EMSL Order Number / Lab Use Only

132107949

EMSL Analytical, Inc.
200 Route 130 North
Cinnaminson, NJ 08077

PHONE: (800) 220-3675

EMAIL: CinnMicroLab@emsl.com

If Bill-To is the same as Report-To leave this section blank. Third-party billing requires written authorization.

Customer Information	Customer ID:	Billing ID:
	Company Name: <u>TRC</u>	Company Name:
	Contact Name: <u>Michael McCarty</u>	Billing Contact:
	Street Address: <u>300 W. Queen Ave</u>	Street Address:
	City, State, Zip: <u>Woburn MA 01801</u>	City, State, Zip: _____ Country: _____
	Phone: <u>603 396 2600</u>	Phone: _____
Email(s) for Report: <u>accham@delapens.com / mcmccart@delapens.com</u>	Email(s) for Invoice: _____	

Project Name/No: <u>485055 Springfield</u>		Purchase Order:
EMSL LIMS Project ID: (If applicable, EMSL will provide)	State Samples Collected: <u>MA</u>	Zip Code Samples Collected: _____
State of Connecticut (CT) must select project location: <input type="checkbox"/> Commercial (Taxable) <input type="checkbox"/> Residential (Non-taxable)		
Sampled By Name: <u>Michael McCarty</u>	Sampled By Signature: <u>[Signature]</u>	No. of Samples in Shipment: _____
Sterile, Sodium Thiosulfate Preserved Bottle Used: <input type="checkbox"/> Biocide Used in Source (specify): _____		
Public Water Supply Samples: <input type="checkbox"/> Note: All results may automatically be reported to DOH if required by State.		
Turn-Around-Time (TAT) Please call ahead for large projects and/or turnaround times 3-hours or less. *32 Hour TAT available for select tests only; samples must be submitted by 11:30am.		
<input type="checkbox"/> 3 Hour	<input type="checkbox"/> 5 Hour	<input checked="" type="checkbox"/> 24 Hour <input type="checkbox"/> 32* Hour <input type="checkbox"/> 48 Hour <input type="checkbox"/> 72 Hour <input type="checkbox"/> 96 Hour <input type="checkbox"/> 1 Week <input type="checkbox"/> 2 Week

MICROBIOLOGY TEST CODES			
M001 Air-Q-Cell	M174 MoldSnap	M012 Pseudomonas aeruginosa (PIA***)	M115 Sewage Screen - Water (PIA***)
M030 Micro 5	M032 Allergenco-D	M024 Pseudomonas aeruginosa (MFT*)	M116 Sewage Screen - Water (MPN**)
M041 Fungal Direct Examination		M015 Heterotrophic Plate Count	M117 Sewage Screen - Swab (PIA***)
M169 Pollen ID & Enumeration		M017 Total Coliform & E. Coli (Colilert PIA***)	M013 Sewage Screen - Swab (MFT*)
M280 Dust Characterization Level-1		M018 Total Coliform & E. Coli (MFT*)	M730 Methicillin-resistant Staph. aureus (MRSA)
M281 Dust Characterization Level-2		M114 Total Coliform & E. Coli Enumeration (Colilert MPN**)	M031 Rapid-growing non-TB Mycobacteria Detection & Enumeration
M005 Viable Fungi-Air Samples (Genus ID & Count)		M019 Fecal Coliform (MFT*)	M014 Endotoxin Analysis
M006 Viable Fungi-Air Samples (Includes Penicillium, Aspergillus, Cladosporium, Stachybotrys Species ID & Count)		M020 Fecal Streptococcus (MFT*)	M044 Group Allergen (Cat, Dog, Cockroach, Dust Mite)
M007 Culturable Fungi-Surface Samples (Genus ID & Count)		M029 Enterococci (MFT*)	M095 Bacteroides
M008 Culturable Fungi-Surface Samples (Includes Penicillium, Aspergillus, Cladosporium, Stachybotrys Species ID & Count)		M129 Enterococci (Enterolert PIA***)	Other - See Analytical Price Guide for Test Code
M009 Bacteria Culture Gram Stain & Count		M180 Real Time qPCR-ERMI 36 Panel	Legionella Analysis Please use EMSL Legionella COC
M010 Bacteria Count & ID - 3 Most Prominent		M025 Sewage Screen - Water (MFT*)	
M011 Bacteria Count & ID - 5 Most Prominent		*MFT= Membrane Filtration Technique	
		**MPN = Most Probable Number	
		***PIA = Presence/Absence	

Sample #	Sample Location/Description	Sample Type (Matrix)	Potable / Non-Potable (Only for Water)	Test Code	Volume/Area	Date / Time Collected	Temperature (Lab Use Only)
Example: Sample 1	Kitchen	Water	Potable	M017	1,000 ml	1/1/2021 3:30pm	
	<u>See Attached</u>						

Special Instructions and/or Regulatory Requirements (Sample Specifications, Processing Methods, Limits of Detection, etc.)

Method of Shipment: <u>Drop 2 Lab</u>	Sample Condition Upon Receipt:
Relinquished by: <u>[Signature]</u>	Received by: _____ Date/Time: _____
Relinquished by: _____	Received by: _____ Date/Time: _____

Controlled Document - COC-34 Micro R13 03/02/2021

☐ AGREE TO ELECTRONIC SIGNATURE (By checking, I consent to signing this Chain of Custody document by electronic signature.)

EMSL Analytical, Inc.'s Laboratory Terms and Conditions are incorporated into this Chain of Custody by reference in their entirety. Submission of samples to EMSL Analytical, Inc. constitutes acceptance and acknowledgment of all terms and conditions by Customer.

Page 1 of 1



EMSL ANALYTICAL, INC.
TESTING LABS • PRODUCTS • TRAINING

Microbiology Chain of Custody Form

EMSL Order Number Lab Use Only

132107949

EMSL Analytical, Inc.
200 Route 130 North
Cinnaminson, NJ 08077

Phone (800) 220-3675

Email CinnMicroLab@emsl.com

Additional Pages of the Chain of Custody are only necessary if needed for additional sample information.

Special Instructions and/or Regulatory Requirements (Sample Specifications, Processing Methods, Limits of Detection, etc.)

Sample #	Sample Location/Description	Sample Type (Matrix)	Potable / Non-Potable (Only for Water)	Test Code	Volume/Area	Date / Time Collected	Temperature (Lab Use Only)
TL-1	Plaza Room 131 uninsulated RETURN DUCT	-	-	M-41	-	10-21-21 4:45pm	
TL-2	Plaza Hall @ Room 122 uninsulated RETURN DUCT						
TL-3	Plaza Room 121 uninsulated SUPPLY DUCT						
TL-4	Plaza Room 121 B uninsulated RETURN DUCT						
TL-5	Plaza ELEVATOR H/S Lobby uninsulated SUPPLY DUCT						
TL-6	Plaza Room 124 uninsulated RETURN DUCT						
TL-7	Plaza Room 124 ATTORNEY BOOTH uninsulated SUPPLY DUCT						
TL-8	Plaza Hall @ Room 140A uninsulated RETURN DUCT						
TL-9	Plaza Room 131 insulated SUPPLY DUCT						
TL-10	Plaza Room 131 uninsulated RETURN DUCT						
TL-11	Plaza Room 110B @ Room 108 insulated SUPPLY DUCT						
TL-12	Plaza Room 110B @ Room 109 uninsulated RETURN DUCT						
TL-13	Plaza Room 108 uninsulated SUPPLY DUCT						
TL-14	Plaza Room 110B @ Room 107 uninsulated SUPPLY DUCT						
TL-15	Plaza Room 110B @ Room 108 uninsulated RETURN DUCT						
TL-16	Plaza Room 103 uninsulated SUPPLY DUCT						
TL-17	Plaza Hall @ Room 102 uninsulated SUPPLY DUCT						

REC'D RINS 0830
EMSL-BOSTON OCT 22 2021

Method of Shipment

Dep @ Lab

Sample Condition Upon Receipt

Relinquished by

Muel M. [Signature]

Date/Time

10-21-21

Received by

Date/Time

Relinquished by

Date/Time

Received by

Date/Time

Controlled Document - CQC-34 (Rev R13) 3/02/2021



AGREE TO ELECTRONIC SIGNATURE (By checking, I consent to signing this Chain of Custody document by electronic signature.)

EMSL Analytical, Inc.'s Laboratory Terms and Conditions are incorporated into this Chain of Custody by reference in their entirety. Submission of samples to EMSL Analytical, Inc. constitutes acceptance and acknowledgment of all terms and conditions by Customer.

Page 1 of 1

Appendix 3 Approximate Ventilation Zone Drawings



300 Wildwood Avenue, Suite 230
Woburn, MA 01801
Tel: 781.933.2555
Fax 781.932.9402
www.TRCCompanies.com

TRC Project 458085

Client:
Massachusetts Trial Courts
Facilities Management
& Capital Planning
Suffolk County Courthouse
3 Pemberton Square, Suite 106
Boston, MA 02108

Site:
Roderick L. Ireland Courthouse
50 State Street
Springfield, Massachusetts

Approximate Ventilation Zones
as Reported by Client

Garage Level

NOT TO SCALE

Date: 11.11.21

Edited by: HAJ

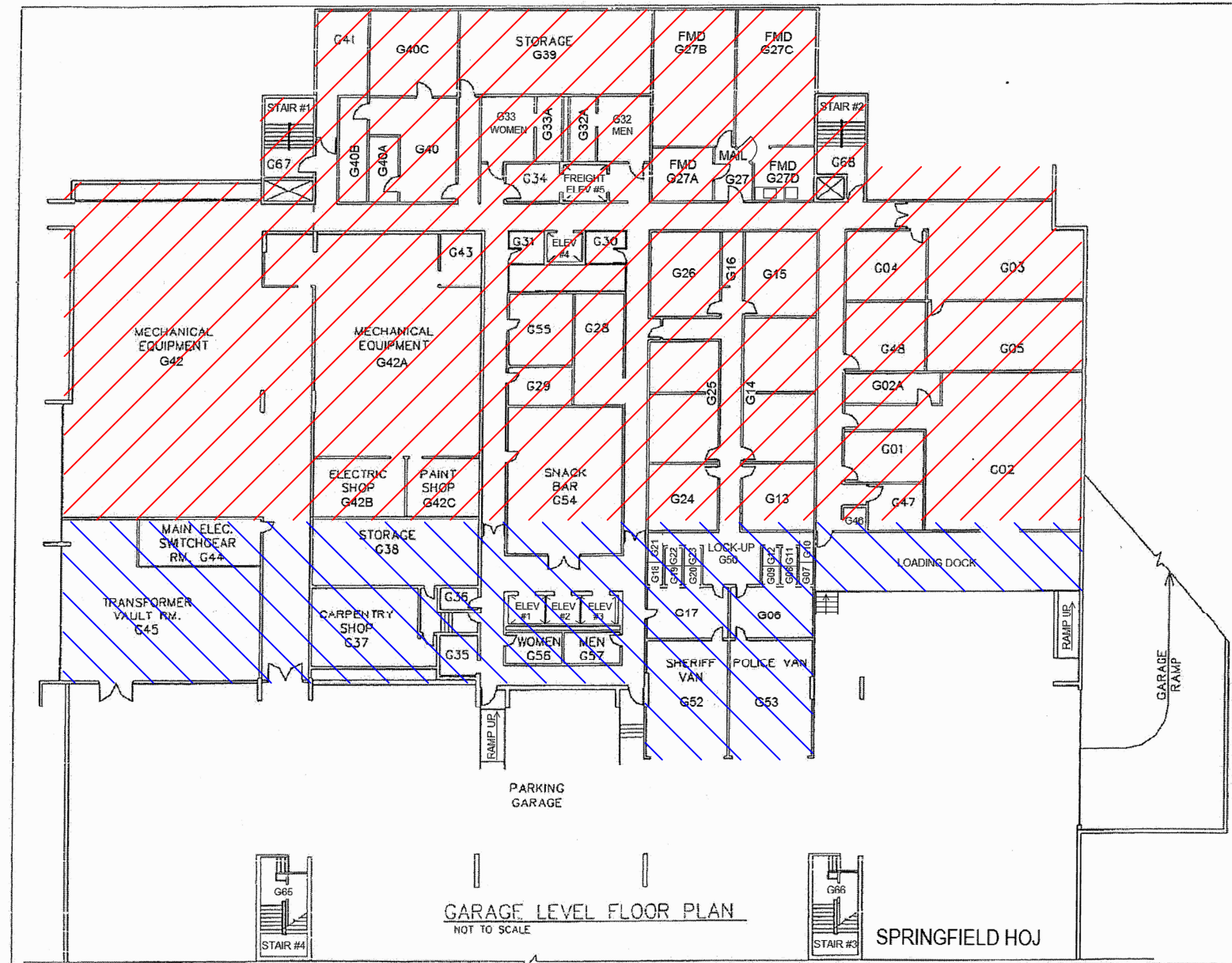

AC 3

AC 4



300 Wildwood Avenue, Suite 230
Woburn, MA 01801
Tel: 781.933.2555
Fax 781.932.9402
www.TRCCompanies.com

TRC Project 458085

Client:
Massachusetts Trial Courts
Suffolk County Courthouse
3 Pemberton Square, Suite 106
Boston, MA 02108

Site:
Roderick L. Ireland Courthouse
50 State Street
Springfield, Massachusetts

Approximate Ventilation Zones
as Reported by Client

Plaza Level

NOT TO SCALE

Date: 11.11.21

Edited by: HAJ

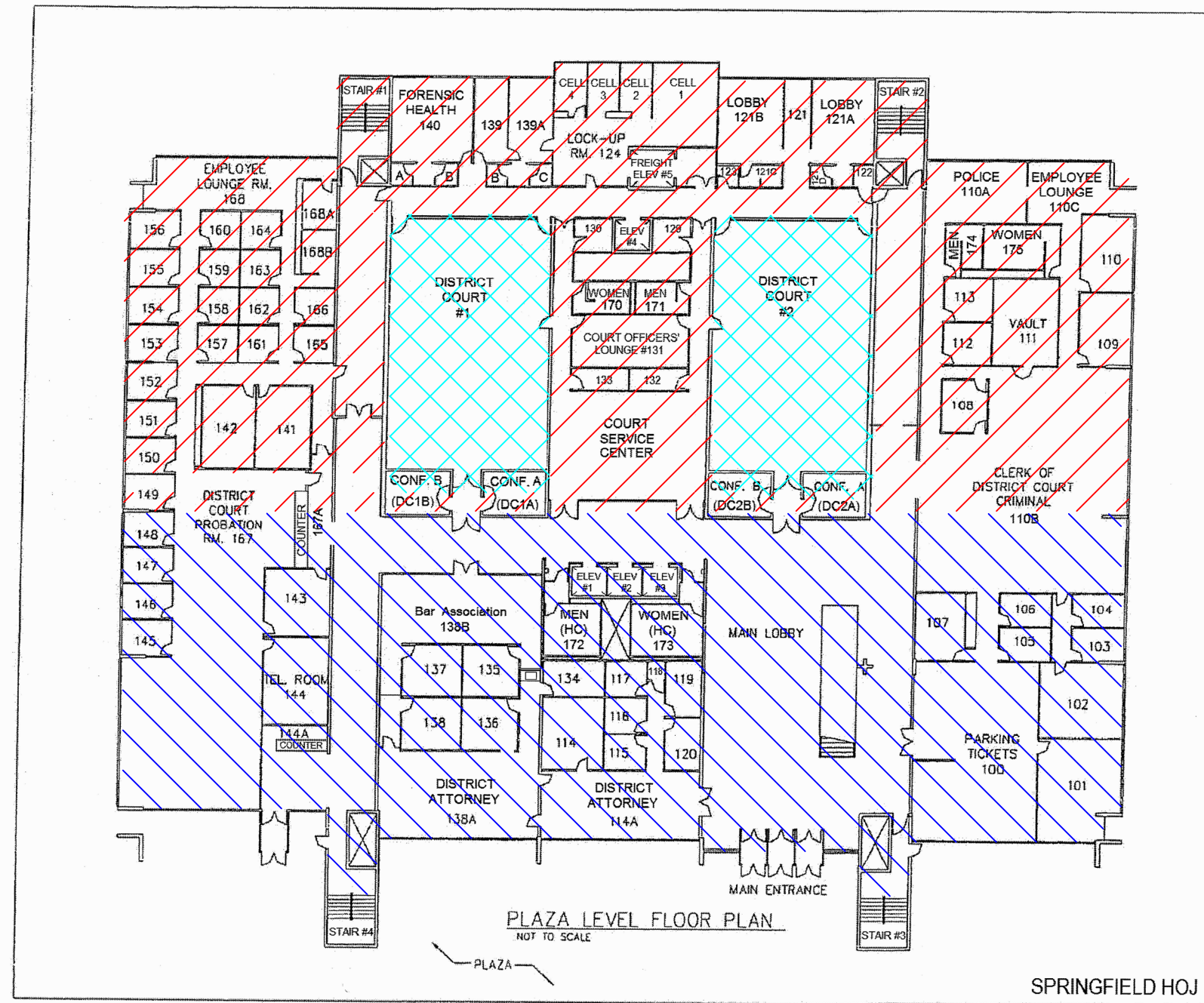

AC 3

AC 4

AC 1



300 Wildwood Avenue, Suite 230
Woburn, MA 01801
Tel: 781.933.2555
Fax 781.932.9402
www.TRCCompanies.com

TRC Project 458085

Client:
Massachusetts Trial Courts
Facilities Management
& Capital Planning
Suffolk County Courthouse
3 Pemberton Square, Suite 106
Boston, MA 02108

Site:
Roderick L. Ireland Courthouse
50 State Street
Springfield, Massachusetts

Approximate Ventilation Zones
as Reported by Client

Second Floor

NOT TO SCALE

Date: 11.11.21

Edited by: HAJ

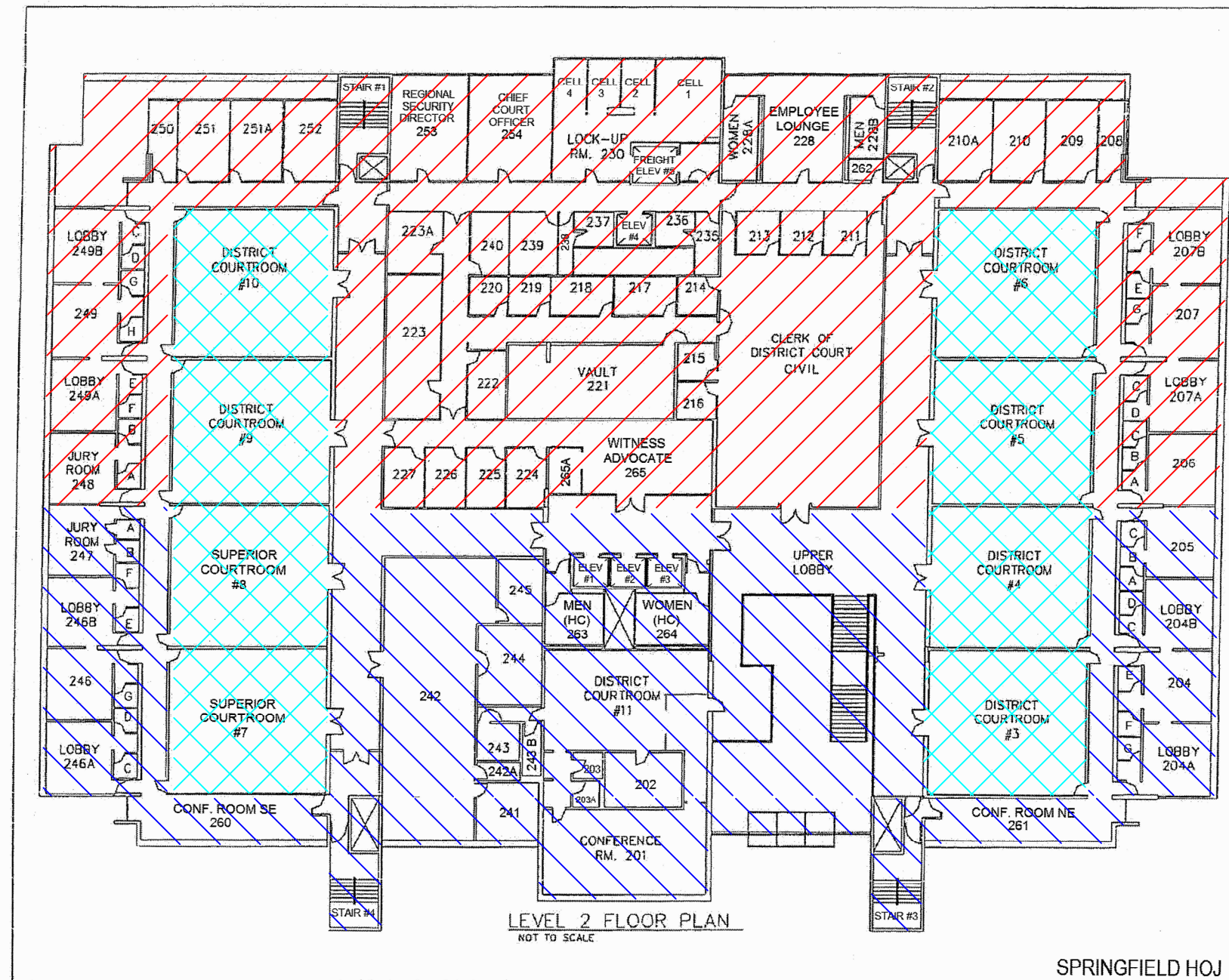

AC 3

AC 4

AC 1



300 Wildwood Avenue, Suite 230
Woburn, MA 01801
Tel: 781.933.2555
Fax 781.932.9402
www.TRCCompanies.com

TRC Project 458085

Client:
Massachusetts Trial Courts
Suffolk County Courthouse
3 Pemberton Square, Suite 106
Boston, MA 02108

Site:
Roderick L. Ireland Courthouse
50 State Street
Springfield, Massachusetts

Approximate Ventilation Zones
as Reported by Client

Third Floor

NOT TO SCALE

Date: 11.11.21

Edited by: HAJ

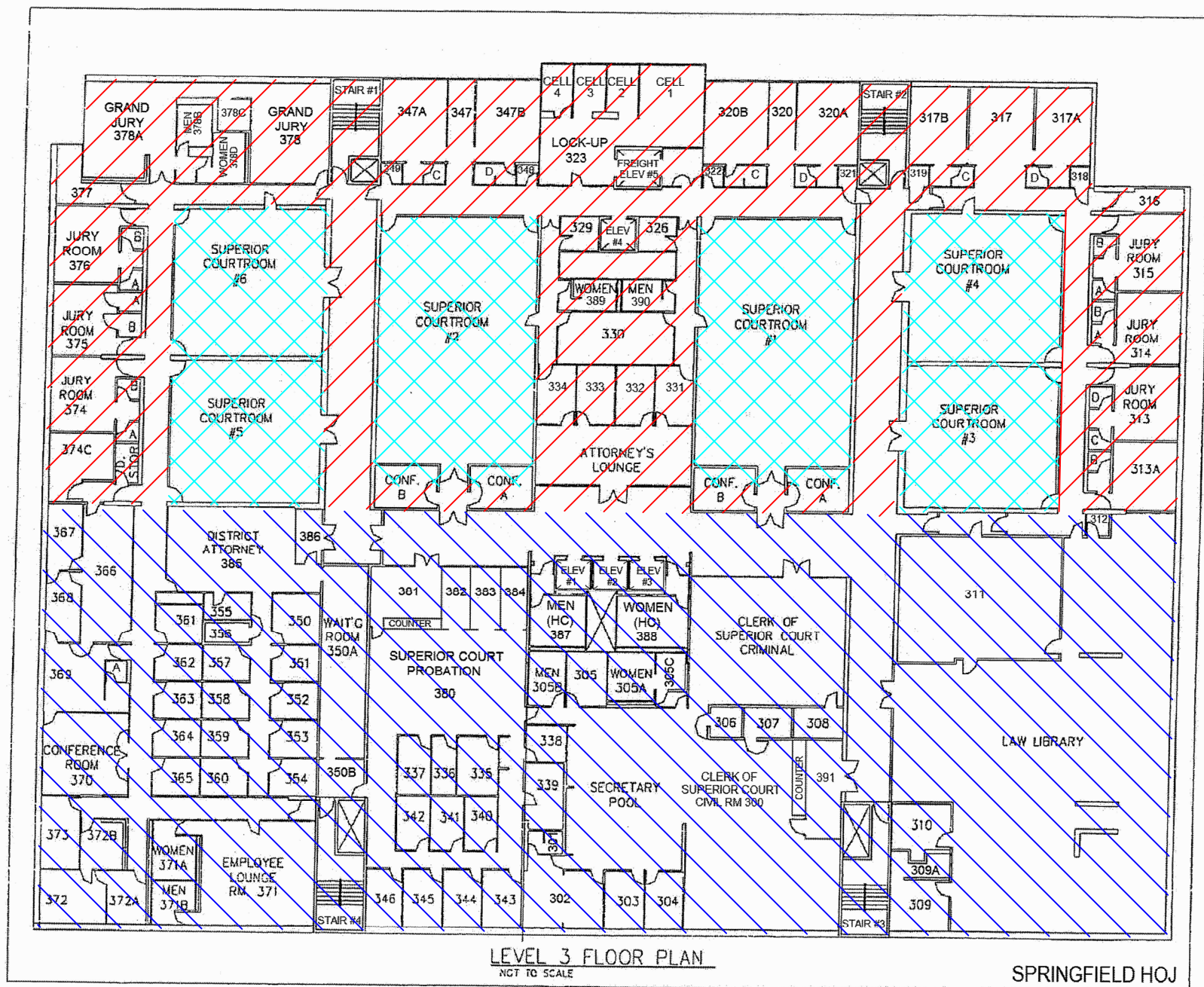

- AC 3
- AC 4
- AC 1



300 Wildwood Avenue, Suite 230
Woburn, MA 01801
Tel: 781.933.2555
Fax 781.932.9402
www.TRCCompanies.com

TRC Project 458085

Client:
Massachusetts Trial Courts
Suffolk County Courthouse
3 Pemberton Square, Suite 106
Boston, MA 02108

Site:
Roderick L. Ireland Courthouse
50 State Street
Springfield, Massachusetts

Approximate Ventilation Zones
as Reported by Client

Fourth Floor

NOT TO SCALE

Date: 11.11.21

Edited by: HAJ



AC 2

AC 1