Report from Acting Highway Administrator:

Update on 3 Major Construction Projects

June 19, 2017

-
- MassDOT Highway Division delivers a more than \$1B capital budget each year to ensure a reliable, safe and efficient transportation network for our customer.
 - Working with abutters, municipalities and elected officials, MassDOT takes steps to mitigate the impacts of construction on the communities we serve by:
 - using traveler information tools,
 - offering alternative modes of transportation,
 - anticipating and managing logistical challenges, and
 - sharing as much information as possible with customers as quickly as possible.
 - The following projects occurring this construction season highlight these efforts:
 - Commonwealth Avenue Bridge Project
 - Sumner Toll Plaza Demolition and Roadway Reconstruction
 - Fore River Bridge

-
- Project will use accelerated bridge construction to replace the full superstructure over two intensive construction windows: Summer 2017 (eastbound portion of the bridge) and Summer 2018 (westbound portion of the bridge)
 - During Summer 2017 construction, there will be an 18 ½ day intensive closure window which will have significant impacts to local/regional vehicular traffic and Green Line/Commuter Rail travelers.
 - **This construction window will occur from July 26th – August 14th**
 - Initial lane reductions to 3 lanes in each direction on I-90 begin on July 7th
 - I-90 is reduced to 2 lanes in each direction on July 28th
 - This window was carefully selected timeframe to minimize traffic impacts, based on traffic volumes, MBTA ridership, Boston University summer break, and special events in the area.
-

Project Schedule

Facility	Traffic Impact	Notes
MBTA Green "B" Line (Blandford St to Babcock St)	Closed from Blandford St to Babcock St for 18½ days	<i>Shuttle bus service between Blandford St and Babcock St</i>
MBTA Bus Routes CT2 and 47	Detoured from normal routes for 17 ½ days	<i>Detour maps will be provided</i>
Commonwealth Avenue (Packard's Corner to Kenmore)	Closed to private vehicular traffic for 17½ days	<i>Bridge open to only buses, emergency vehicles, peds/bikes</i>
BU Bridge	Closed to private vehicular traffic for 17½ days	<i>Bridge open to only buses, emergency vehicles, peds/bikes</i>
I-90	Traffic shift for 9½ days	<i>2 lanes each direction during peak period</i>
MBTA Commuter Rail (Worcester Line)	Closed from Boston Landing to South Station for 2 weekends	<i>Shuttle bus service from Boston Landing to Reservoir Station (Yawkey Way during Sox games)</i>
Amtrak (Lake Shore Line)	Closed for 2 weekends	<i>Shuttle bus service from Albany, NY to Boston</i>

	Wed	Thurs	*Fri*	*Sat*	*Sun*	*Mon*	*Tues*	*Wed*	*Thurs*	*Fri*	*Sat*	*Sun*	Mon	Tues	Wed	Thurs	Fri	Sat	Sun	Mon
	26-Jul	27-Jul	28-Jul	29-Jul	30-Jul	31-Jul	1-Aug	2-Aug	3-Aug	4-Aug	5-Aug	6-Aug	7-Aug	8-Aug	9-Aug	10-Aug	11-Aug	12-Aug	13-Aug	14-Aug
MBTA Green Line Bus Diversion	9:00 PM	x	x	x	x	x	x	x	x	x	x	x	x	x	x	x	x	x	x	5:00 AM
Comm Ave CLOSED to private vehicular traffic		7:00 PM	x	x	x	x	x	x	x	x	x	x	x	x	x	x	x	x	x	5:00 AM
BU Bridge CLOSED to private vehicular traffic		7:00 PM	x	x	x	x	x	x	x	x	x	x	x	x	x	x	x	x	x	5:00 AM
MBTA CT2 & 47 Detours		7:00 PM	x	x	x	x	x	x	x	x	x	x	x	x	x	x	x	x	x	5:00 AM
I-90 Lane Reductions			9:00 PM	x	x	x	x	x	x	x	x	x	5:00 AM							
Commuter Rail Bus Diversion				x	x						x	x								

Shuttle to
Yawkey

Shuttle to
Yawkey

* = Red Sox Home Games

I-90 “Cross Over” and Dry Run

MassDOT will use “zipper barrier” and other traffic control devices to channelize traffic to one side of I-90

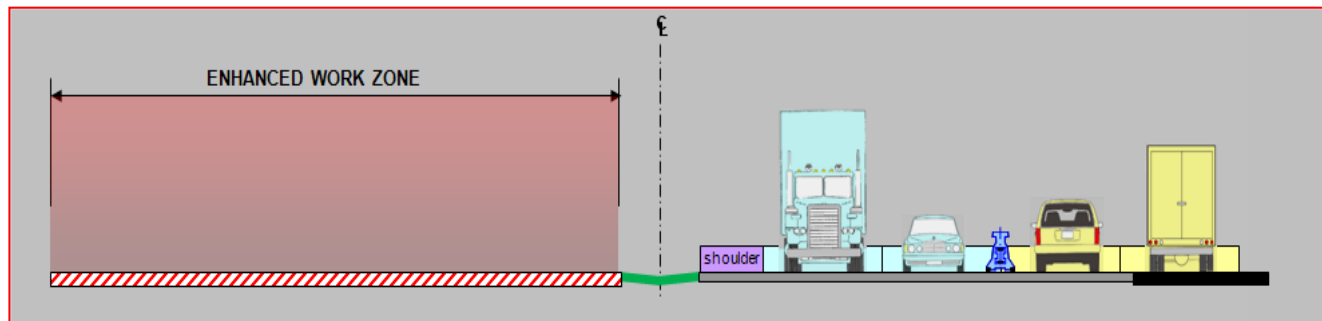

Completed

- 3 Public meetings 2 legislative briefings
- Targeted stakeholder briefings
- Dedicated Project Email Address
- Active Project Website (www.mass.gov/massdot/commavebridge)
- Email to E-ZPass holders (for Dry-run)
- Door to door flyers / business outreach
- Printed materials (brochures, flyers) available in multiple languages

Ongoing

- 2 Business Working Group Meetings
- Working Group meets bi-weekly with 5 subcommittees
- Outreach to Taxis/TNCs
- Coordination with Hubway for additional pickup locations
- Coordination with Waze/Google for road closures

Upcoming

- 2 additional Public Meetings
- Real Time Traffic Monitoring System active during shutdown
- Email Red Sox season ticket holders
- MBTA Marketing Campaign
- Keolis Rail Mail
- Emails to E-Zpass holders
- VMS Board advertisements

Immediate Next Steps

- Two Additional Public Meetings Scheduled

July 11th @ 6:30 p.m.

Boston University's Jacob Sleeper Auditorium (CGS 129)
871 Commonwealth Avenue, Boston

July 13th @ 6:30 p.m.

Newton Town Hall
(Room TBD)

- More information can be found at
www.mass.gov/massdot/commavebridge

- MassDOT crews and contractors demolished the Sumner toll booths on the weekend of May 5 – May 7th
 - Initial demolition phase was completed ahead of schedule
- The first traffic configuration proved problematic for traffic both for local traffic in the AM Peak and regional 1A traffic in the PM Peak.



Sumner Toll Plaza Demolition

- Starting on May 8, MassDOT held daily phone calls with Massport, State Police and the City of Boston to resolve traffic issues.
- A series of modifications were made to the traffic control plan, including improved signage and the addition of an adjustable “swing lane” to balance the regional/local needs.
- Changes have matched the levels of traffic flow prior to toll demolition, and in some cases improved

June 1, 2017: Typical vs. Actual

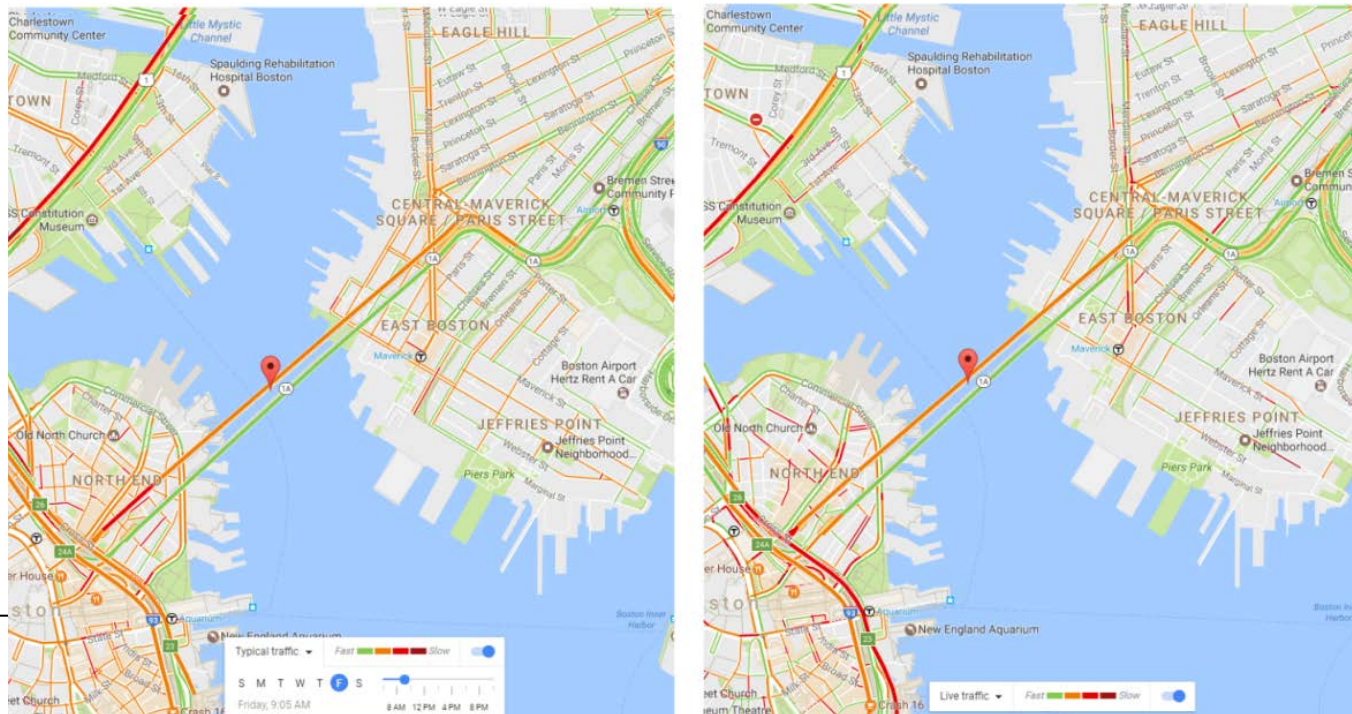

- On Friday, June 2nd, MassDOT and its contractors reduced traffic on Route 3A at the Fore River Bridge to 1 lane in each direction.
- This was necessary in order to begin shifting traffic from the temporary bridge onto the newly constructed bridge
- A deliberate process began months in advance to inform all impacted stakeholders, collaborate with municipal officials, and develop alternative travel options for drivers.



Outreach

- Legislative Briefing at State House
- Three (3) Briefings for impacted municipalities of Braintree, Quincy, and Weymouth.
- On site visit and briefing on the new bridge for municipals officials and legislative delegation
- Onsite Press Event on May 18th –
- Two Public Information Meetings
- Notifications via GovDelivery Email Service,
- Updated Project Website

Traffic Mitigation

- Identifying most likely alternate route
- Signal optimization and police detail plan along that route
- Real-Time Traffic Management System for driver
- Additional Ferry Service from Hingham
- No other work zones in the vicinity of the project
- Daily calls with the impacted municipalities



Appendix