

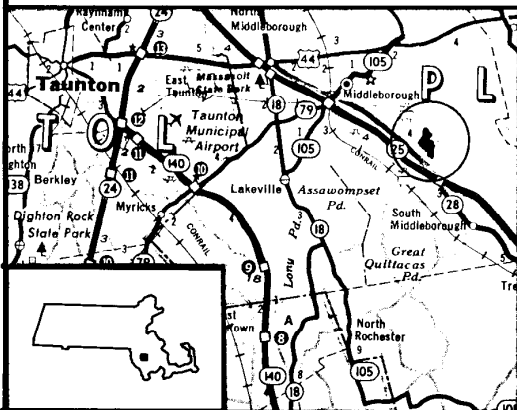

LOCATION



TISPAQUIN POND
MIDDLEBOROUGH
Area = 194 Acres

NOT TO BE USED FOR NAVIGATIONAL PURPOSES

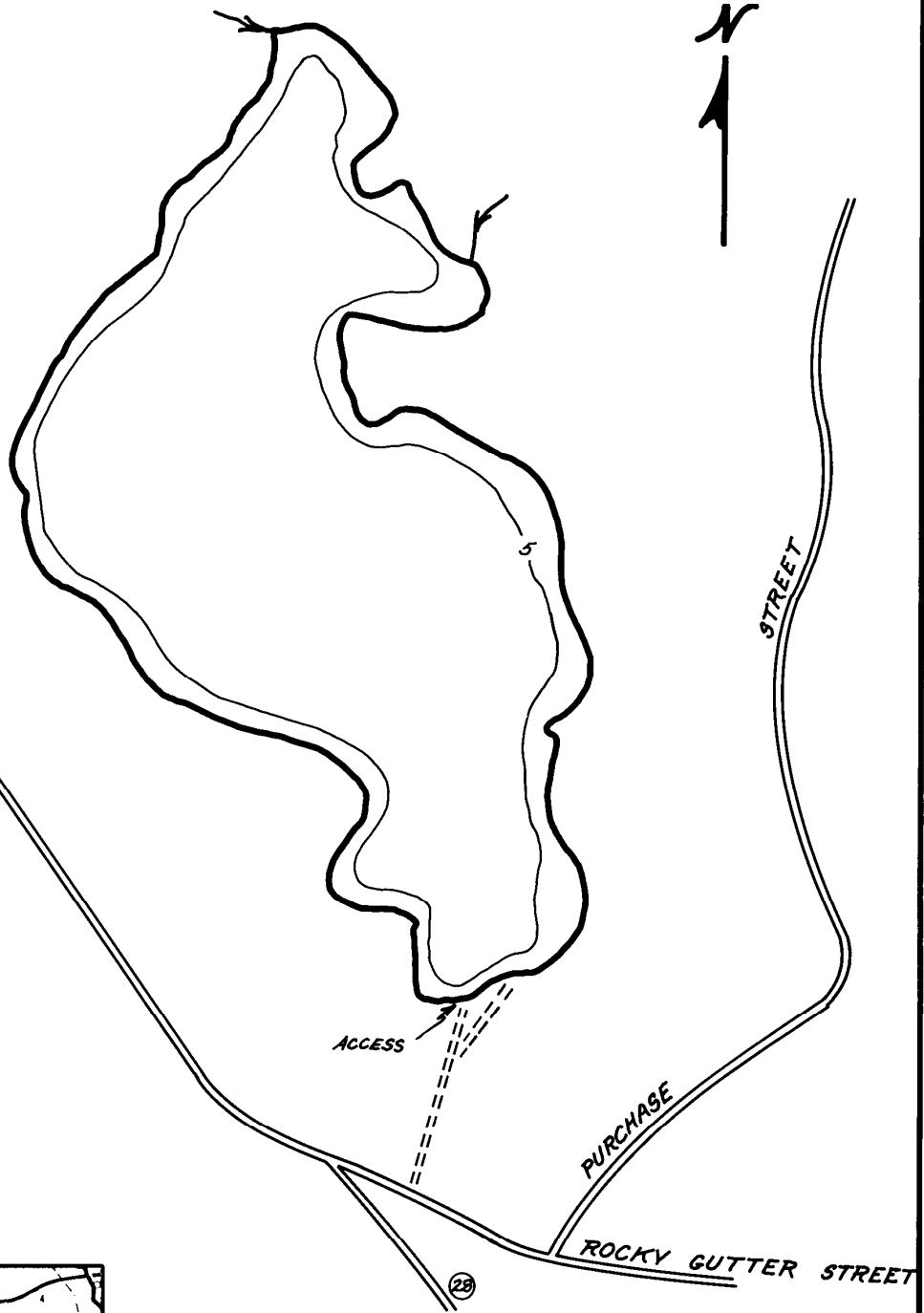

TISPAQUIN POND
(Middleborough)

General Information:

This is a relatively infertile, 194-acre, warm water pond characterized by clear water with a transparency of six feet. Average depth is seven feet, but maximum depth is only eight feet. The bottom is sand and rubble, and emergent aquatic vegetation is scant. The three miles of shoreline are light to moderately developed with year round homes, children's summer camps and a private camping area.

The pond is located one mile north of the Route 28 and 25 rotary. Access is via Eldan Street off Rocky Gutter Road. An unpaved launch area is suitable for car top boats and canoes.

Fish Populations:

The general fish population was last sampled in July of 1980. The 10 species observed, listed in order of abundance, are yellow perch, pumpkinseed, largemouth bass, golden shiner, brown bullhead, chain pickerel, white perch, bluegill, white sucker and redbfin pickerel.

Fishing:

This pond has a good largemouth bass population with numerous fish 12 inches or better. Chain pickerel are less numerous and display average growth rates. Yellow perch are the dominant species and are stunted to the point that most of them are less than eight inches. Pumpkinseeds are also abundant. We encourage anglers to take yellow perch to control their numbers. If the population were reduced, growth rates would undoubtedly improve and bigger perch would be available.

March 1993